

# ANGUS SOUTH

Item #	Construction Details ANGUS SOUTH: LOT 22 Model Type & Elevation : 40-05 RASPBERRY ELEVATION A Purchasers Names : OTTO KOOPMANS AND GABRIELLE KOOPMANS		
		Date	Note
Included	<i>Rough-in for 3 Piece in basement</i>		Bonus Package
Included	<del>3 piece stainless steel kitchen appliances with white top loading washer and dryer</del>	-	Bonus Package
Included	Chimney Hood Fan		Bonus Package
Included	Natural finish laminate flooring on main floor in non tiles areas as per plan <b>SEE ITEM #38</b>		Bonus Package
Included	9' main floor ceilings, 8 ft ceilings on second and basement		Bonus Package
Included	Carpet Grade Stairs with Oak pickets <b>SEE ITEM #4 UPGRADED TO OAK STAIRS PAINTED WHITE PICKETS, ALSO SEE ITEM #38 STAIN ALSO ITEM #56 RAILINGS UPGRADE</b>		Bonus Package
Included	<del>Glass shower (framed) in Master Ensuite as per plan</del> <b>SEE ITEM #16 UPGRADED TO FRAMELESS</b>	-	Bonus Package
1/	MAIN FLOOR ONLY - SMOOTH CEILINGS	2-Feb-17	COLOURS
2/	GREAT ROOM - ADD OPT 30" (B30ONTRE) GAS FIREPLACE INCLUDES STD PAINT GRADE MANTLE AND BUMPED OUT FOUNDATION	2-Feb-17	COLOURS
3/	GREAT ROOM - FIREPLACE - ADD HEAT ACTIVATED FAN KIT	2-Feb-17	COLOURS
4/	STAIRS - OAK STAIRCASE IN LIEU OF CARPET GRADE	2-Feb-17	COLOURS
5/	FRAMING/TRIM - BASEMENT DOOR AND POWDER ROOM ON MAIN FLOOR - UPGRADE TO 8FT INTERIOR DOORS	2-Feb-17	COLOURS
6/	OPT GARAGE MAN DOOR, IF GRADE PERMITS	2-Feb-17	COLOURS
7/	GARAGE MAN DOOR - UPGRADE TO 7FT DOOR IN LIEU OF STD DOOR	2-Feb-17	COLOURS
8/	KITCHEN ELECTRICAL - ADD LED STRIP LIGHTING UNDER CABINET UPPERS ON SEPARATE SWITCH - SEE ITEM #49	2-Feb-17	COLOURS
9/	GREAT ROOM - ADD (1) PLUG ABOVE FIREPLACE ALONG WITH STD CABLE	2-Feb-17	COLOURS
10/	GREAT ROOM - REINFORCE STD CEILING LIGHT	2-Feb-17	COLOURS
11/	MASTER ENSUITE - ADD PLUG (SEE SKETCH FOR LOCATION)	2-Feb-17	COLOURS
12/	KITCHEN/BREAKFAST - ELECTRICAL - (4) LED POTLIGHTS IN KITCHEN BREAKFAST AREA ON SEPARATE SWITCH - KEEP STD LIGHT	2-Feb-17	COLOURS
13/	HALLWAY TO MUD RM - ELECTRICAL - (2) LED POTLIGHTS ON SEPARATE SWITCH **DELETE STD LIGHT IF THERE IS ONE	2-Feb-17	COLOURS
14/	KITCHEN ELECTRICAL - SHIFT STD LIGHT IN KITCHEN COOKING AREA TO BE INSTALLED ABOVE KITCHEN ISLAND. ADD (1) CAPPED LIGHT ABOVE KITCHEN ISLAND SPACED EVENLY WITH STD LIGHT; BOTH ON SAME SWITCH	2-Feb-17	COLOURS
15/	FRONT HALL CLOSET - UPGRADE TO DOUBLE DOORS IN LIEU OF MIRROR SLIDERS	2-Feb-17	COLOURS
16/	MASTER ENSUITE - FRAMELESS GLASS SHOWER IN LIEU OF STD FRAMED	2-Feb-17	COLOURS
17/	TRIM - UPGRADE #1 STEP BASEBOARD AND CASING	2-Feb-17	COLOURS
18/	MASTER BDRM, BEDROOMS 2,3,4 - UPGRADE #1 CARPET UNDERPAD	2-Feb-17	COLOURS
19/	MASTER BDRM AND GREAT ROOM - ADD EXTRA WINDOW OPERATOR (1) MASTER BEDROOM (1) GREAT ROOM	2-Feb-17	COLOURS

COLOURS  
FEBRUARY 2 2017

PAGE 10 of 3



# ANGUS SOUTH

Item #	Construction Details ANGUS SOUTH: LOT 22 Model Type & Elevation : 40-05 RASPBERRY ELEVATION A Purchasers Names : OTTO KOOPMANS AND GABRIELLE KOOPMANS		
		Date	Note
20/	KITCHEN - PLUMBING - ADD WATERLINE TO FRIDGE ✓	2-Feb-17	COLOURS
21/	MASTER ENSUITE - PLUMBING - UPGRADE (2) SINKS TO CONTRAC CATENA UNDERMOUNT RECTANGULAR SINKS MODEL #4210 CIY IN LIEU OF STD OVAL ✓	2-Feb-17	COLOURS
22/	KITCHEN SINK - UPGRADE TO BLANCO STELLAR U SUPER SINGLE MODEL #401028 IN LIEU OF STD ✓	2-Feb-17	COLOURS
23/	KITCHEN FAUCET - UPGRADE TO MOEN BRANTFORD SRS FINISH MODEL #7185 IN LIEU OF STD ✓	2-Feb-17	COLOURS
24/	PLUMBING - UPGRADE TOILETS (1) MASTER (1) MAIN (1) POWDER - CONTRAC CRISTA MODEL #4721NFVU/4722BHV 2 PC IN WHITE IN LIEU OF STD ✓	2-Feb-17	COLOURS
25/	MASTER ENSUITE - PLUMBING - UPGRADE TO RIZON BY MOEN IN CHROME (2) SINGLE HANDLE LAV FAUCET WITH LIFT ROD DRAIN MODEL #6900 ✓	2-Feb-17	COLOURS
26/	MASTER ENSUITE - PLUMBING - UPGRADE TO RIZON BY MOEN IN CHROME ROMAN TUB FAUCET MODEL T 935/4796 (SEE SKETCH) ✓	2-Feb-17	COLOURS
27/	MASTER ENSUITE - PLUMBING - SHOWER UPGRADE TO RIZON BY MOEN IN CHROME POSI TEMP SHOWER WITH 3 FUNCTION TRANSFER VALVE/TRIM AND SLIDE BAR WITH HAND SHOWER MODEL 2812EP/3372/T4171/62320/3669EP/A725 ADD SINGLE FUNCTION 8" RAIN SHOWER WITH IMMERSION MODEL #6360 IN LIEU OF STD SHOWER HEAD INSTALL FROM CEILING WITH 6" ARM MODEL #116651 **NOTE-INSTALL RAIN SHOWER IN THE CENTER OF THE CEILING STD POT LIGHT WILL BE OFF CENTER SEE SKETCH ✓	2-Feb-17	COLOURS
28/	MASTER ENSUITE - PLUMBING - UPGRADE TO RIZON IN CHROME (1) PIVOTING PAPER HOLDER MODEL YB 2408 (1) 24" TOWEL BAR MODEL #YB2424 ✓	2-Feb-17	COLOURS
29/	MAIN BATH - PLUMBING - UPGRADE TO RIZON BY MOEN IN CHROME (1) SINGLE HANDLE LAV FAUCET WITH LIFT ROD DRAIN MODEL #6900 (SEE SKETCH) ✓	2-Feb-17	COLOURS
30/	MAIN BATH - PLUMBING- RIZON IN CHROME (1) PIVOTING PAPER HOLDER MODEL #YB 2408 (1) 24" TOWEL BAR MODEL #YB 2424 (SEE SKETCH) ✓		
31/	MAIN BATH - PLUMBING - RIZON CHROME UPGRADE SHOWER TO ECO PERFORMANCE POSI TEMP TUB/SHOWER FAUCET MODEL #T2813EP/62320 ✓	2-Feb-17	COLOURS
32/	MASTER ENSUITE - TILES - UPGRADE #4 FLOOR TILES *** NOTE - INSTALL STACKED ✓	2-Feb-17	COLOURS
33/	MASTER ENSUITE - TILES - UPGRADE #5 WALL TILES *** NOTE - INSTALL VERTICAL ✓	2-Feb-17	COLOURS
34/	MASTER ENSUITE - ADD NICHE IN SHOWER APPROX 24" WIDE X 18" HIGH **NOTE - INSTALL ON THE WALL THAT IS OPPOSITE ✓	2-Feb-17	COLOURS
35/	MASTER ENSUITE - TILES UPGRADE SHOWER JAMB TO WHITE QUARTZ ✓	2-Feb-17	COLOURS
36/	MAIN BATH - TILES - UPGRADE #4 FLOOR TILES *** NOTE - INSTALL STACKED AND UPGRADE #1 WALL TILE ✓	2-Feb-17	COLOURS
37/	KITCHEN BACKSPLASH - TILES - UPGRADE #6 ***INCLUDES BEHIND CHIMNEY ✓	2-Feb-17	COLOURS

COLOURS  
FEBRUARY 2 2017

PAGE 20 of 3

5

# ANGUS SOUTH

Item #	Construction Details ANGUS SOUTH: LOT 22 Model Type & Elevation : 40-05 RASPBERRY ELEVATION A Purchasers Names : OTTO KOOPMANS AND GABRIELLE KOOPMANS		
		Date	Note
38/	HARDWOOD AND RAILINGS - UPGRADE #3 HARDWOOD ON MAIN FLOOR GREAT RM, DINING RM, STUDY **NOTE PRICE INCLUDES STAIN OAK STAIRS AND PAINT GRADE PICKETS IN WHITE ✓	2-Feb-17	COLOURS
39/	HARDWOOD - UPGRADE #3 ON 2ND FLOOR HALLWAY IN LIEU OF CARPET ✓	2-Feb-17	COLOURS
40/	HARDWOOD - UPGRADE #3 IN KITCHEN/BREAKFAST AND FOYER IN LIEU OF TILE ✓	2-Feb-17	COLOURS
41/	KITCHEN COUNTERTOP - UPGRADE #2 KEYSTONE - SEE UPGRADED SINK - ITEM #22 ✓	2-Feb-17	COLOURS
42/	KITCHEN COUNTERTOP - PROVISIONS FOR SLIDE IN STOVE ✓	2-Feb-17	COLOURS
43/	MASTER ENSUITE COUNTERTOP - UPGRADE #2 KEYSTONE - SEE UPGRADED SINKS - ITEM #21 ✓	2-Feb-17	COLOURS
44/	MAIN BATH COUNTERTOP - UPGRADE #1 KEYSTONE QUARTZ INCLUDES OVAL UNDERMOUNT SINK ✓	2-Feb-17	COLOURS
45/	KITCHEN CABINETS - UPGRADE #1 ✓	2-Feb-17	COLOURS
46/	KITCHEN CABINETS - HARDWARE - UPGRADE #1 ✓	2-Feb-17	COLOURS
47/	KITCHEN CABINETS - KITCHEN UPGRADES APPROX 80cm WIDE PANTRY IN LIEU OF UPPER AND LOWER CABINET 24" DEEP *** NOTE - CABINETS BOTH SIDES OF FRIDGE TO BE EQUAL SIZE, IF POSSIBLE ✓	2-Feb-17	COLOURS
48/	KITCHEN CABINETS - 24" DEEP UPPER OVER FRIDGE WITH 2 SIDE PANELS ✓	2-Feb-17	COLOURS
49/	KITCHEN CABINETS - ADD LIGHT VALANCE UNDER UPPERS - SEE ITEM #8 ✓	2-Feb-17	COLOURS
50/	KITCHEN CABINETS - ADD 2 SETS OF POT AND PAN DRAWERS ***NOTE - MOVE STD BANK OF DRAWERS TO BE INSTALLED ON THE KITCHEN ISLAND (SEE SKETCH) ✓	2-Feb-17	COLOURS
51/	KITCHEN CABINETS - ADD 2 BIN RECYCLE INSTALL ON KITCHEN ISLAND ✓	2-Feb-17	COLOURS
52/	KITCHEN CABINETS - BLUM MOTION DRAWERS 2 SETS OF POT AND PAN DRAWERS AND 1 BANK OF DRAWERS ✓	2-Feb-17	COLOURS
53/	KITCHEN CABINETS - ADD 5 DUMMY DOORS BACK OF KITCHEN ISLAND ✓	2-Feb-17	COLOURS
54/	MASTER ENSUITE CABINETS - UPGRADE #2 VANITY ✓	2-Feb-17	COLOURS
55/	MASTER ENSUITE CABINETS - ADD 2 BANK OF DRAWERS ONE ON EACH VANITY (1) BANK OF DRAWERS MAIN BATH VANITY ✓ 3 BANK OF DRAWERS IN TOTAL	2-Feb-17	COLOURS
56/	RAILINGS - UPGRADE #3 RAILING 2 RINGS (NO FLUTES) GROOVED OAK HANDRAIL 3-1/4" SQUARE OAK POSTS **PAINT GRADE PICKETS ✓	2-Feb-17	COLOURS

COLOURS  
FEBRUARY 2 2017

PAGE 3 of 3

8

## ZANCOR HOMES COLOUR CHART

CABINETRY / COUNTERTOPS						
DOOR STYLE	HARDWARE	COUNTERTOP	EDGE			
Kitchen	SHAKER MDF VANILLA MILKSHAKE (1)	H-1400-128	K 101 (2)	C		
Island	SHAKER MDF VANILLA MILKSHAKE (1)	H-1400-128	K 101 (2)	C		
Servery	NA					
Master Ensuite	EURO HIGH GLOSS ANTRACITE (2)	H 800 BC	K 609 (2)	H		
Main	CONT SLAB MDF VANILLA MILKSHAKE	H 800 BC	K 319 (1)	H		
Twin	NA					
Ensuite ###	NA					
Powder Room	NA					
laundry	NA					
Basement Bath	NA					
TILES						
Main Foyer	NA		INSERTS	THRESHOLDS		
Basement Foyer	NA					
Powder Room	CORTE MILA SILVER 13 X 13					
Mud Room	CORTE MILA SILVER 13 X 13					
Main Hall	NA					
Kitchen Floor	NA					
Breakfast Floor	NA					
Kitchen Bk.Splash	ORIENTAL WHITE/GREY FRAME MARBLE HONEYCOMB MOSAIC UP# 6					
Laundry	CORTE MILA CASABLANCA 13 X 13		INCL	CHIMNEY		
Mstr Ensuite Floor	GEORGETTE PEARL 12" X 24" STACKED UP # 4					
Mstr Ensuite Shower	LUMINA LINE 10" X 30" INSTALL VERTICAL UP # 5		NA	BIANC CARR		
Shower Niche	TILE AND WHITE QUARTZ					
Master Shower Floor	2 X 2 WHITE					
Master Shower Jamb	WHITE QUARTZ					
Main Bath Floor	GEORGETTE LIGHT 12" X 24" STACKED UP # 4			BIANC CARR		
Main Bath Tub Wall	WEAVE TENDER GREY 8 X 10 UP # 1		NA			
Twin Bath Floor	NA					
Twin Ensuite Tub Wall	NA					
Ensuite ### Bath Floor	NA					
Ensuite ### Bath Wall	NA					
Basement Ensuite Floor	NA					
Basement Ensuite Wall	NA					
HARDWOOD / CARPET						
Living Room	NA					
Dining Room	MARQUEE HARDWOOD CANYON HILLS WIREBRUSH OAK EE 14032 UP # 3					
Family/Great Room	MARQUEE HARDWOOD CANYON HILLS WIREBRUSH OAK EE 14032 UP # 3					
Den/Study/parlour/Library	MARQUEE HARDWOOD CANYON HILLS WIREBRUSH OAK EE 14032 UP # 3					
Kitchen *(Waiver)	MARQUEE HARDWOOD CANYON HILLS WIREBRUSH OAK EE 14032 UP # 3					
Main Foyer *(Waiver)	MARQUEE HARDWOOD CANYON HILLS WIREBRUSH OAK EE 14032 UP # 3					
Main Hall	MARQUEE HARDWOOD CANYON HILLS WIREBRUSH OAK EE 14032 UP # 3					
Upper Hall	MARQUEE HARDWOOD CANYON HILLS WIREBRUSH OAK EE 14032 UP # 3					
Master Bedroom	MARQUEE HARDWOOD CANYON HILLS WIREBRUSH OAK EE 14032 UP # 3					
Bedroom 2	MARQUEE HARDWOOD CANYON HILLS WIREBRUSH OAK EE 14032 UP # 3					
Bedroom 3	MARQUEE HARDWOOD CANYON HILLS WIREBRUSH OAK EE 14032 UP # 3					
Bedroom 4	MARQUEE HARDWOOD CANYON HILLS WIREBRUSH OAK EE 14032 UP # 3					
Carpet Underpad	UPGRADE					
Basement Foyer	NA					
FIREPLACES						
LOCATION	GREAT ROOM	Opt: Surround	NA	MANTLE	NA	NF 8
LOCATION	NA	Opt: Surround	NA	MANTLE	NA	NA
MIRRORS & ACCESSORIES						
Mirrors	STANDARD	Opt: Crown Moulding	NA	PLASTER MOULDING		
Bathroom Accessories	DELETE ALL	Location	NA	NA		
Purchaser has reviewed the colour chart						
SITE & LOT						
ANGUS SOUTH 22						

Any upgrades in the colour chart must be accompanied with a PES. It is the responsibility of all Trades to inform the builder of any discrepancies on sketches, PES and/or colour charts PRIOR to installation.

\*\*\*FOR TRADE USE\*\*\*

\*\* PAGE 1 OF 2 \*\*

Purchaser Initial Vendor

# ZANCOR HOMES COLOUR CHART

STAIRS, RAILING & PICKETS & STAIR STAIN			
Stair Stain / Species:	STAIN OAK STAIRS TO MATCH CANYON HILLS		
White Paint Req'd	PICKETS TO BE PAINT GRADE PAINTED WHITE		
Main to 2nd Railing Details:	UP # 3 2 RINGS (NO FLUTES) GROOVED OAK HANDRAIL 3 1/4" SQUARE OAK POST		
Main to top of Basement door Railing	UP # 3 2 RINGS (NO FLUTES) GROOVED OAK HANDRAIL 3 1/4" SQUARE OAK POST		
TRIM			
Casing/Baseboards	UPGRADE # 1 STEP		
Interior Doors	STANDARD		
Interior Door Hardware	STANDARD		
Exterior Door Hardware	STANDARD		
H			
Kitchen/Breakfast	BIRCH WHITE	Master Beds	BIRCH WHITE
Living Room	NA	Bedroom 2	BIRCH WHITE
Dining Room	BIRCH WHITE	Bedroom 3	BIRCH WHITE
Family/Great room	BIRCH WHITE	Bedroom 4	BIRCH WHITE
Den/Study	BIRCH WHITE	Master Ens.	BIRCH WHITE
Main/Upper Hall	BIRCH WHITE	Main	BIRCH WHITE
Laundry	BIRCH WHITE	Twin	NA
Powder Room	BIRCH WHITE	Basement	NA
PLUMBING- UPGRADES TO BE DETAILED ON PES			
	FIXTURES	FAUCETS	NOTES
Kitchen	UPGRADE	UPGRADE	SEE PES
Powder Room	STANDARD	STANDARD	
Master Ensuite	UPGRADE	UPGRADE	SEE PES
Main	UPGRADE	UPGRADE	SEE PES
2nd Ensuite	NA	NA	
BASEMENT	NA	NA	
Other			
ZANCOR APPLIANCE REQUIREMENTS-UPGRADES TO BE DETAILED ON PES			
Appliance Package received in 'Schedule E'		YES / NO Package Name:	
	UPG (SEE PES)	DECLINED	NOTES
GAS LINE BBQ	STANDARD		
WATERLINE to Fridge	UPGRADE		
Hood Fan Venting SIZE	6" STANDARD		
ELECTRICAL for Built-in Oven	NA		
ELECTRICAL for Built-in Micro / OTR	NA		
ELECTRICAL for Gas Stove / Cooktop	NA		
ELECTRICAL for Bar Fridge	NA		
DISCLAIMER		INITIALS	
Colours of all materials are as close as possible to Builders selection but not necessarily identical due to dye lot variances in manufacturing/manufacturers. Due to construction progress some items may have been pre-selected or installed. In this event the Vendor's selection must be accepted by the purchaser			
Any changes to the colour chart after signing are subject to a \$55000 administration fee plus costs			
Purchaser has checked and acknowledged accuracy of colour and selections before signing.			
SITE: ANGUS SOUTH	40-5-ARASPBERRY	LOT: 22	
PURCHASER(S):	Otto Koopmans Gabrielle Koopmans		
HOME #/CELL #	705-791-1146		
EMAIL:			
DÉCOR NOTES			
***FOR TRADE USE***			
Any upgrades in the colour chart must be accompanied with a PES.			
It is the responsibility of all Trades to inform the builder of any discrepancies on sketches, PES and/or colour charts PRIOR to installation.			
ZANCOR HOMES		Purchaser Signature Date	
		Purchaser Signature Date	
		DÉcor Consultant Signature Date	
*** PAGE 2 OF 2 ***		Vendor Signature Date	

Lot 22. Dec 30/16

4005 Raspberry

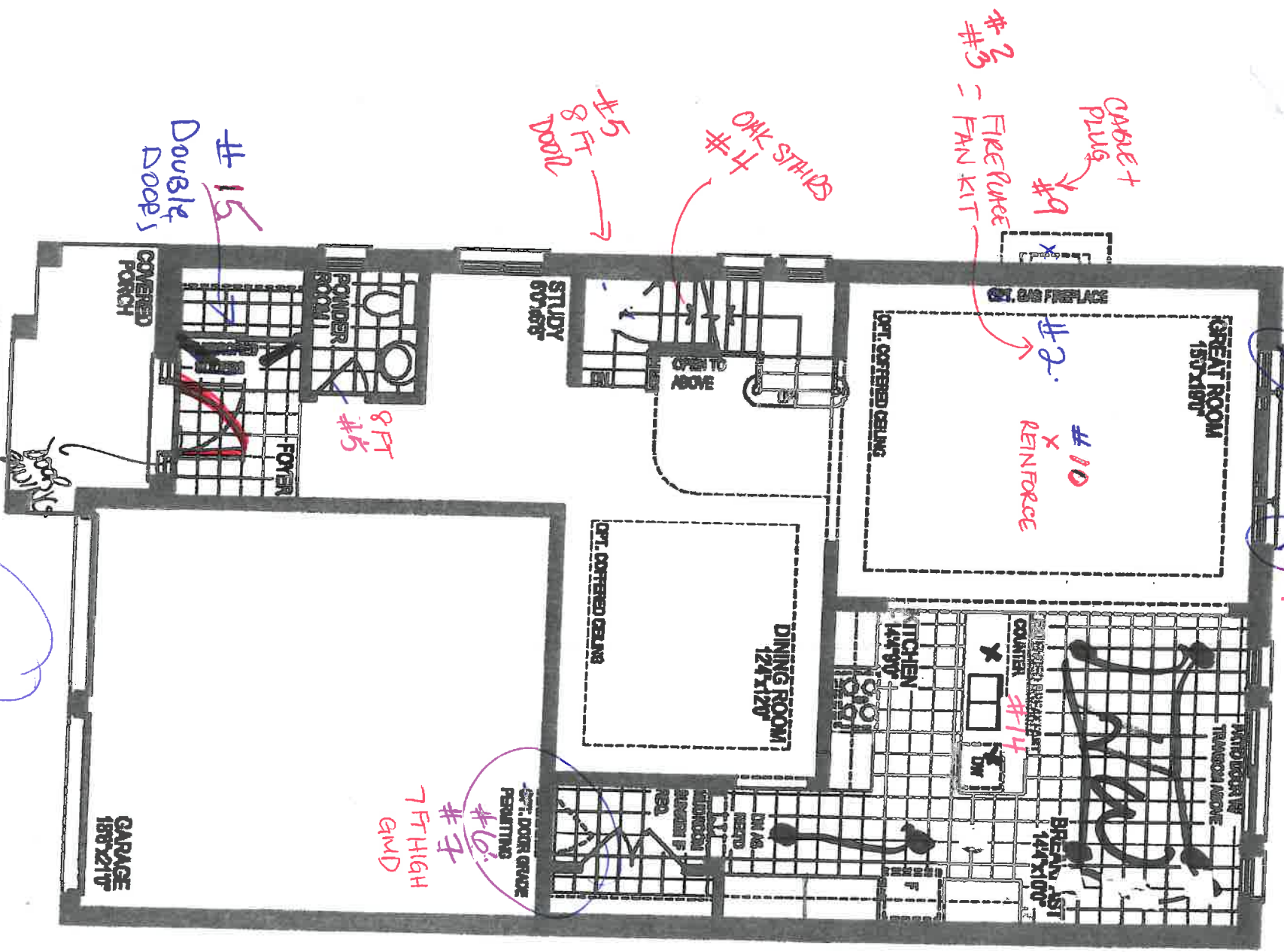

GROUND FLOOR PLAN, EL. 'A'



\*SMOOTH CEILINGS\*  
(MAIN ONLY)

alk/or

20122 Due 30/1/4005 Raspberry

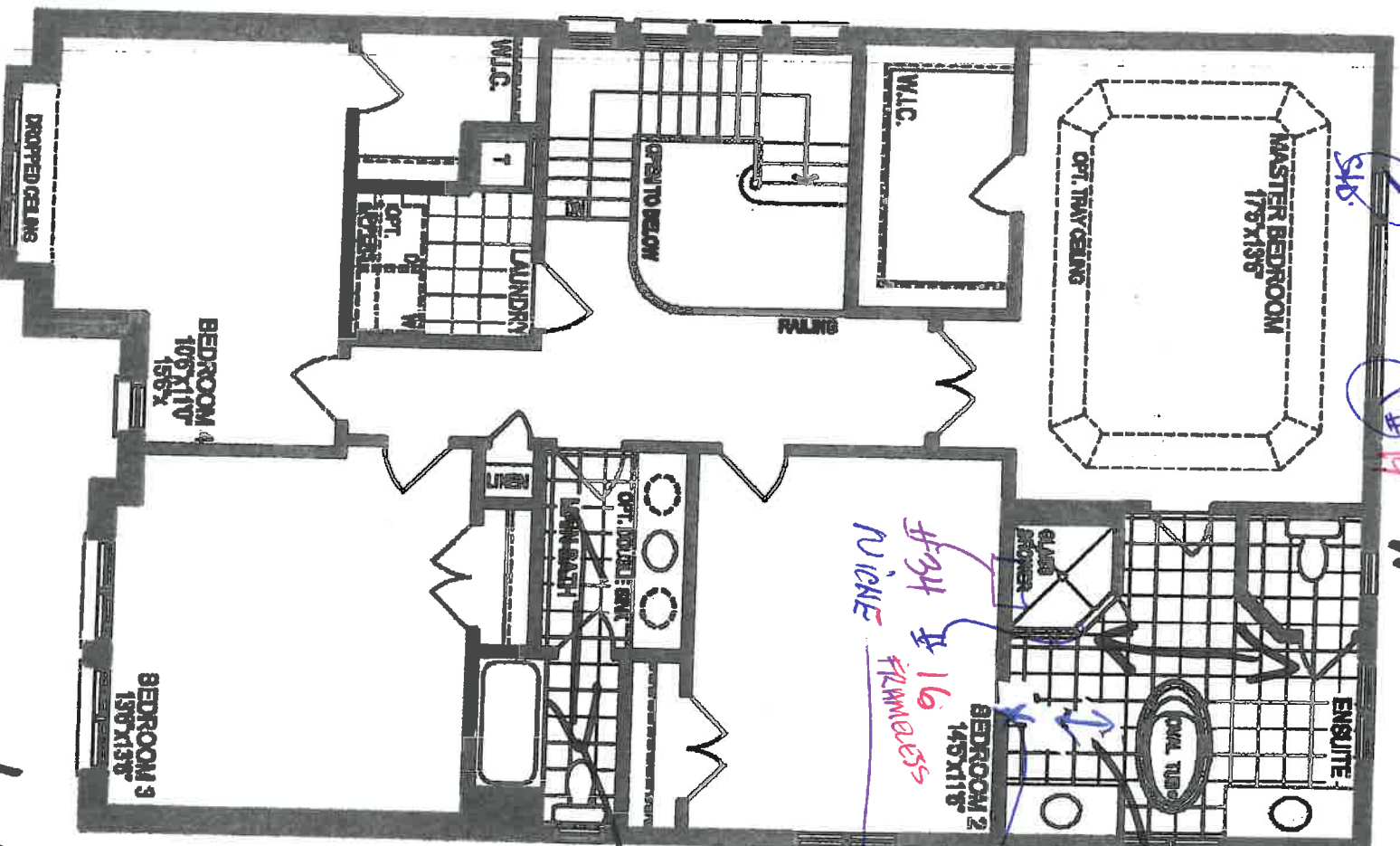

SECOND FLOOR PLAN, EL. 'A'

# THE RASPB

[Unit 4005]

2760 sq. ft.	2740
Elev. A	Elev. A
Optional Tandem Garage	2645 sq. ft.
	2630

Prices and specifications are subject to change without notice. Sizes and location may vary. Location of furnace and water required at front entries, rear entries and garage man door floor space may vary from the stated floor area. All stated dimensions may change with style chosen. See Sales presentation.

FEB 02 2017

renderings are artist's concept. E

RASPBERRY 4005

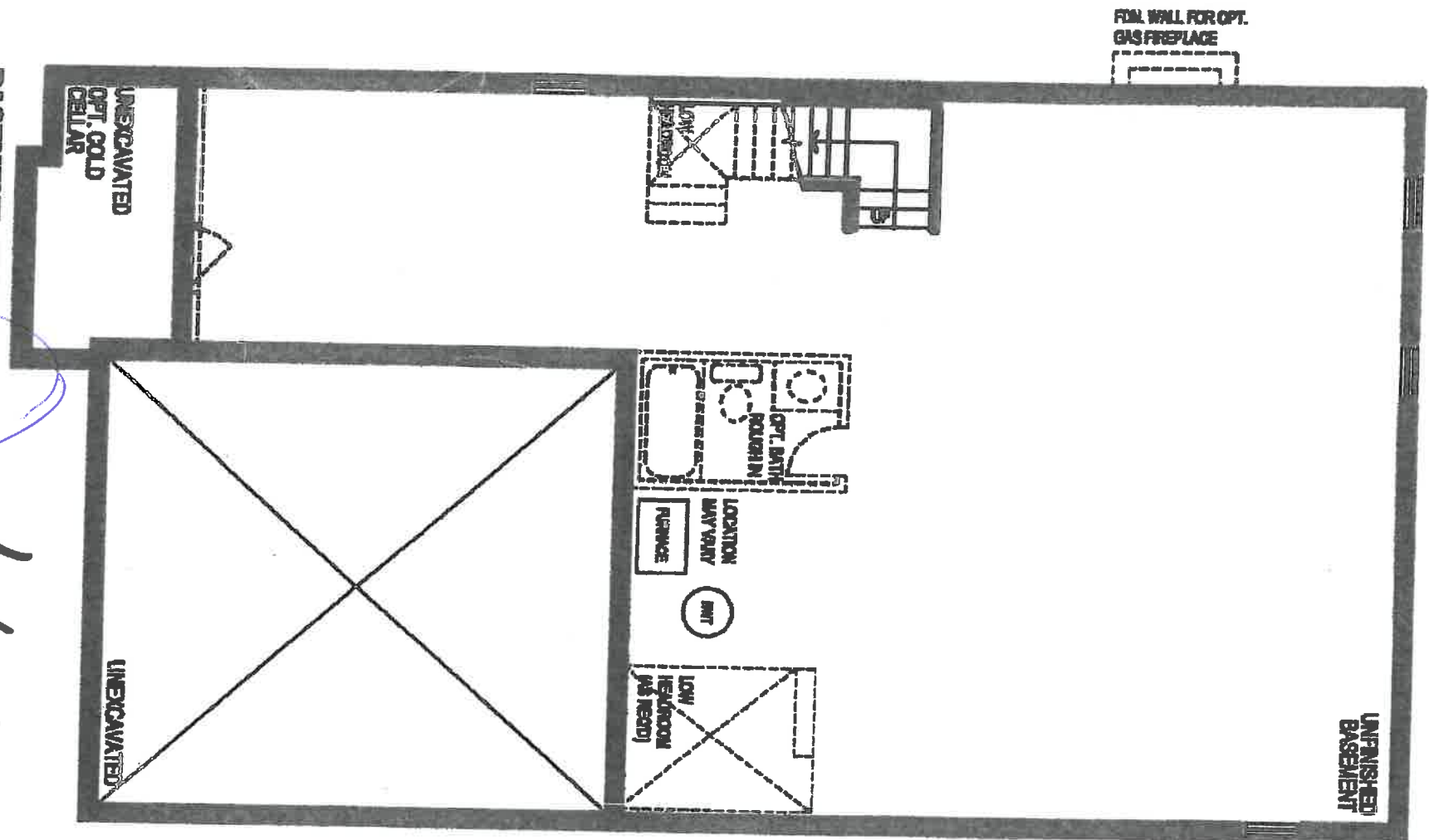

2/2/16



Lot 122  
Due 30/16

FEB 02 2017

4008

- ① 80cm wide Pantry 24" Dep
- ② 24" Dep upper 2 Side Panels
- ③ Recycle Bin
- ④ STD BANK of DRAWER'S wide as possible
- ⑤ Pot & Pan DRAWERS ②
- ⑥ 5-Dummy Door's

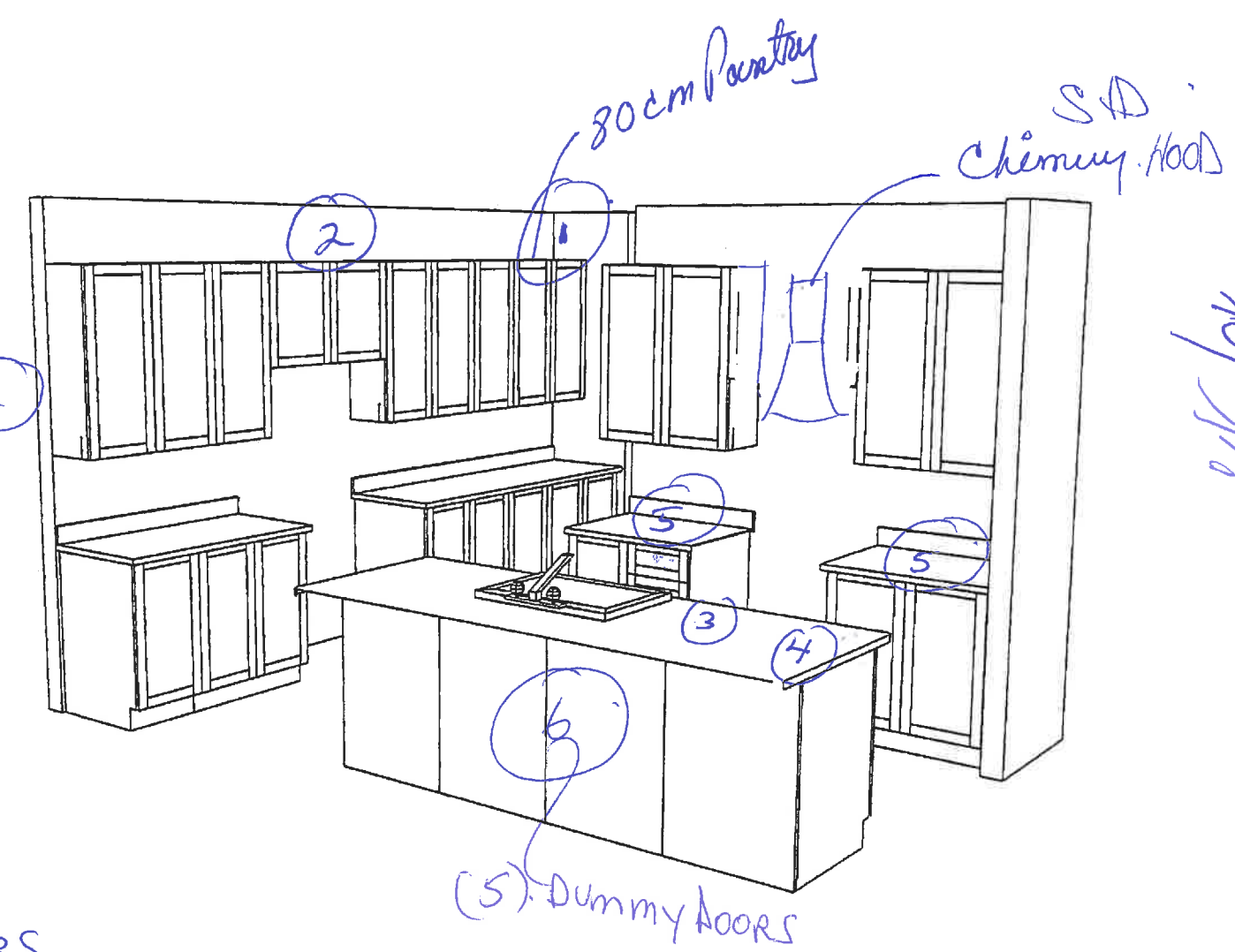

2/1/10

Light valance.

Blum motion DRAWERS

1-BD.  
2-Sets Pot DRAWERS

NEW IMAGE KITCHENS INC			
Scale:	Approved by:	Drawn by:	VANCE
Date: 6/2/15		Revised:	
ZANCOR HOMES			Drawing number:
ANGUS SOUTH 4005			

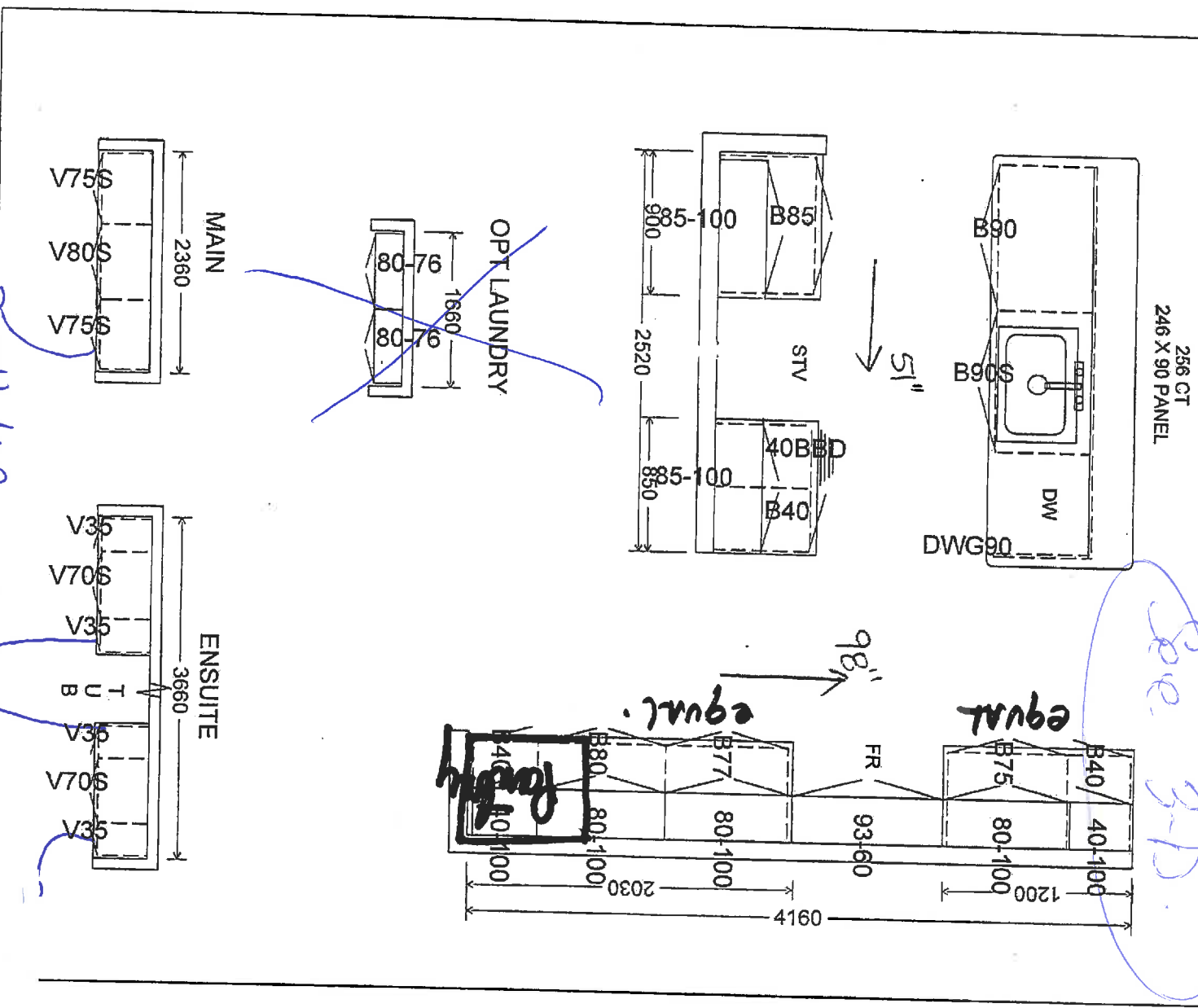

Lo122

STANDARD CABINET HARDWARE  
(New Image Kitchens)  
Dec 30/16

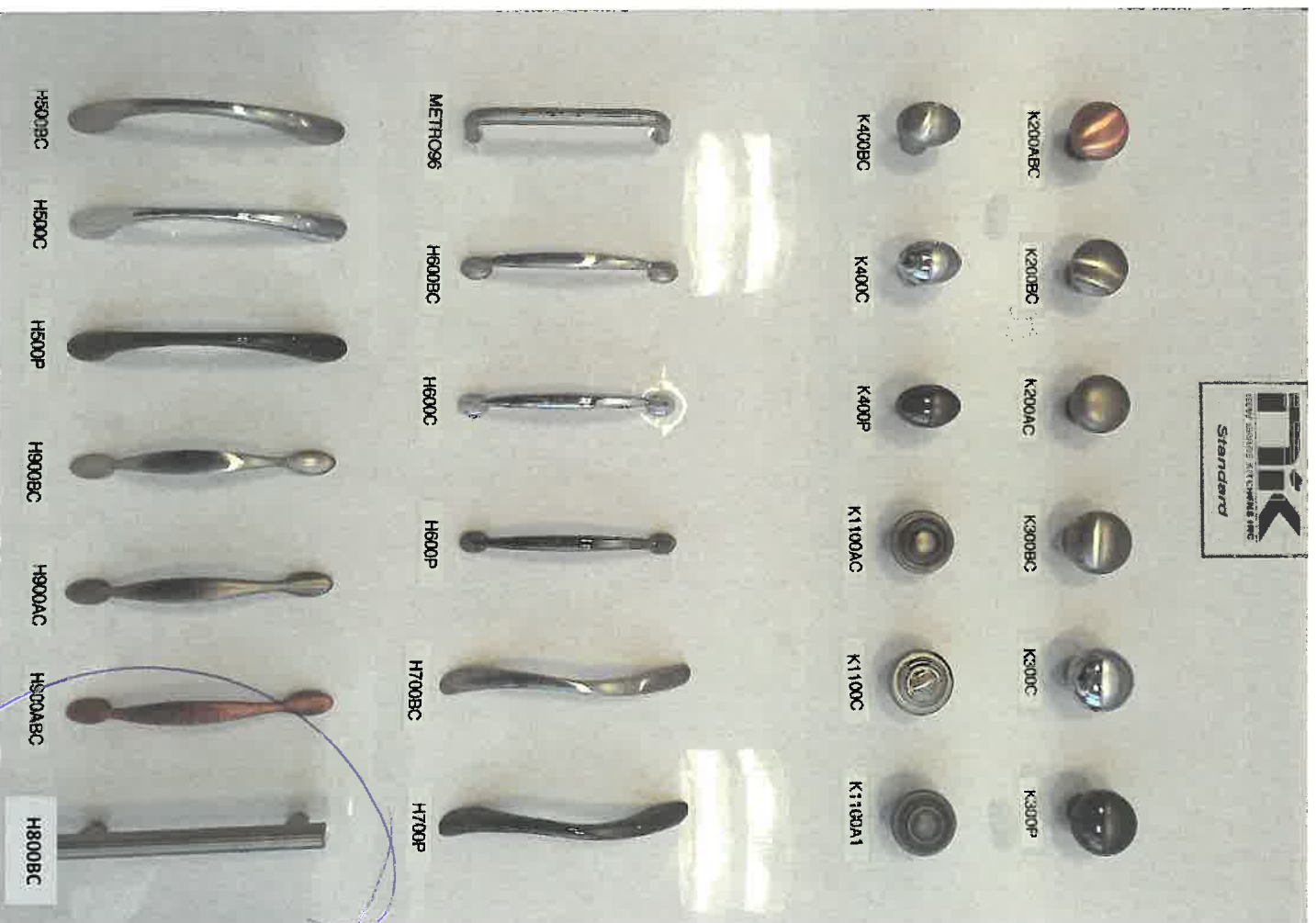

metal  
main

all pk

# UPGRADE CABINET HARDWARE \$500 (Kitchen) / \$150 per Bathroom

(New Image Kitchens)

Lot 22  
Dec 30/16



Kitchen

MEK

10622

Dec 30 / 16

ZANCOR HOMES  
EDGE PROFILES (INTERSTONE / REDSTONE)

STANDARD

12 to 14 in

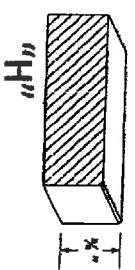
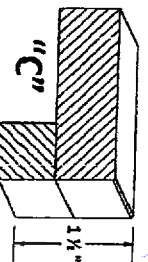

1/2 inch  
max

24 / 012

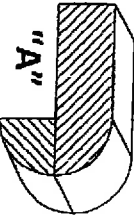
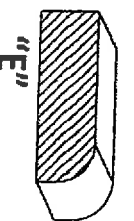
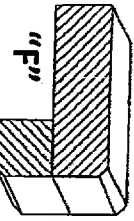
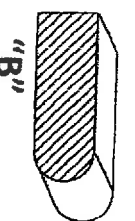
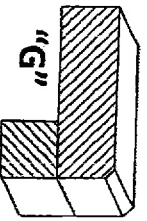
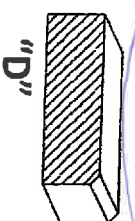
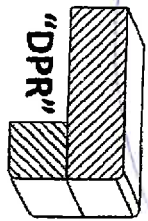

UPGRADES

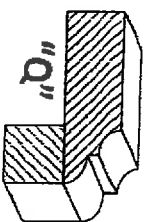
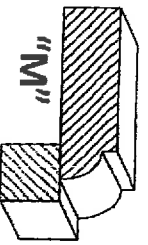
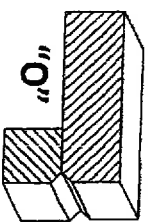
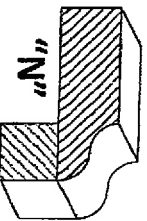
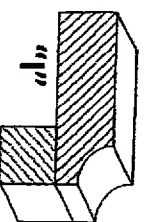
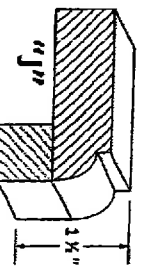
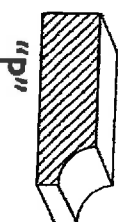
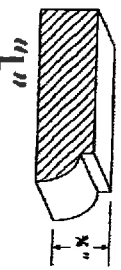

ANGUS SOUTH - INTERIOR RAILINGS (BOLTON)

- \*STANDARD - 1-5/16" TURNED OAK PICKET, 2-1/2" OVAL OAK HANDRAIL, 2-3/4" TURNED OAK POST
- UPG 1 - 1-5/16" SQUARE OAK PICKET, 2-1/2" OVAL OAK HANDRAIL, 2-3/4" SQUARE OAK POST
- UPG 2 - 1-3/4" TURNED OAK PICKET, 2-1/2" OVAL OAK HANDRAIL, 3-1/4" TURNED OAK POST

\*METAL PICKETS COME WITH 2-3/4" GROOVED OAK HANDRAIL, 3-1/4" SQUARE OAK POST

- UPG 3 - METAL (BLACK) SINGLE COLLAR w/ALT PLAIN
- UPG 3 - METAL (BLACK) BIRDSNEST w/ALT PLAIN
- UPG 4 - METAL (BLACK) SINGLE COLLAR w/ALT DBL
- UPG 4 - METAL (BLACK) STAMPED w/ALT PLAIN
- UPG 5 - METAL (BLACK) STAMPED w/ALT DBL

**WOOD PICKETS** (\* Available in Paint Grade)

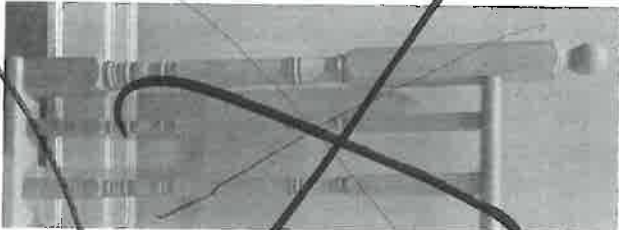

**STANDARD**  
1-5/16" Turned Oak Posts  
Turned Oak Posts



**UPGRADE 1**  
1-5/16" Square Oak Pickets, Chamfered Edges  
Oval Oak handrail  
2-3/4" Square Oak Post, Chamfered Edges

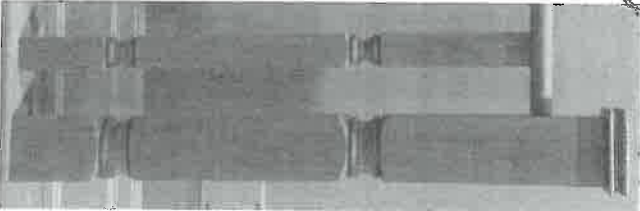

**UPGRADE 2**  
1-3/4" Turned Oak Posts  
Oval Oak handrail  
2-3/4" Turned Oak Posts

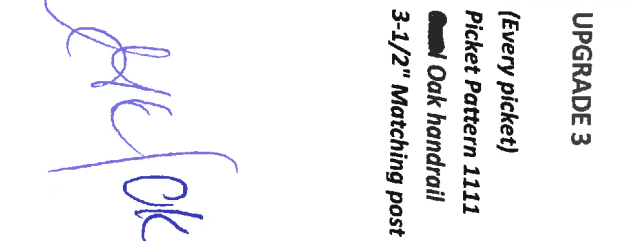

**UPGRADE 3**  
(Every picket)  
Picket Pattern 1111  
Oval Oak handrail  
3-1/2" Matching post

Angus South  
L0122  
R03016

\*PRICES ARE SUBJECT TO  
CHANGE WITHOUT NOTICE E.O.E.\*



TOILETS - CONTRAC (Baypoint)



\*PRICES ARE IN LIEU OF STANDARD\*

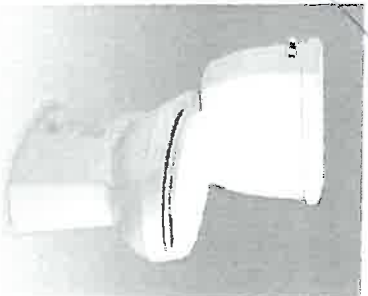

Contrac CRISTA  
4721NFVU / 4722BHV

Smooth close seat  
Elongated Bowl  
Comfort Height  
2 Piece  
1.28Gpf / 4.8L



1-maid  
1-master  
1-bowels

OK OK

10/22  
Dec 30/16

*HK/OK*

# Rizon™

Traditional | Transitional | Modern

*Polished smooth with clean, horizontal lines, the Rizon collection features a modern style with simple edges and soft curves.*

*Lo/22*  
*24230/K*



Single Handle Lav Faucet  
with Lift Rod Drain

Model 6900

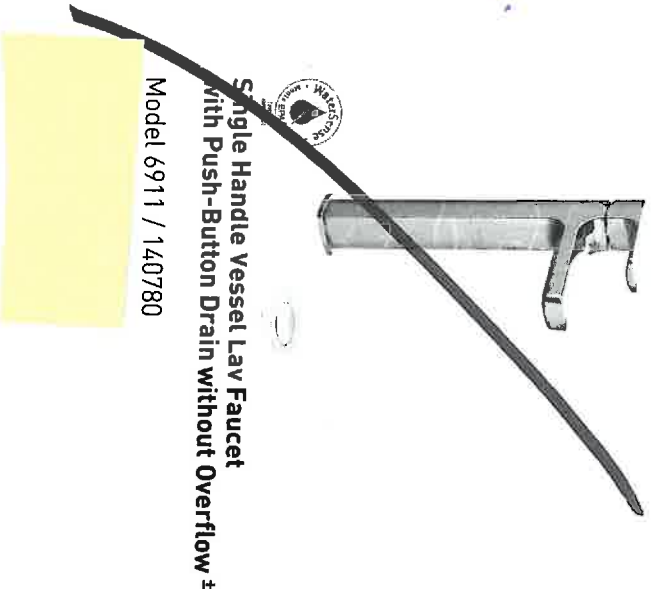

Single Handle Vessel Lav Faucet  
with Push-Button Drain without Overflow ±

Model 6911 / 140780

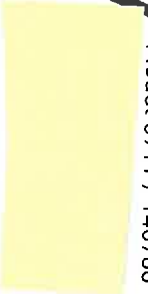

Two Handle Adjustable Widespread  
[8" - 16"] Lav Faucet  
with Lift Rod Drain

Model T6920 / 69000



## FINISH OPTIONS:



C BN

To order, combine the model number with one of these finish letter(s):  
LifeShine® Brushed Nickel (BN).  
To order Chrome (C) model, use model number only.  
- Deckplate sold separately - 165006 series  
± Single hole installation only

# Rizon™

Traditional | Transitional | Modern

*Polished smooth with clean, horizontal lines, the Rizon collection features a modern style with simple edges and soft curves.*

10122.

Dec 30/16.

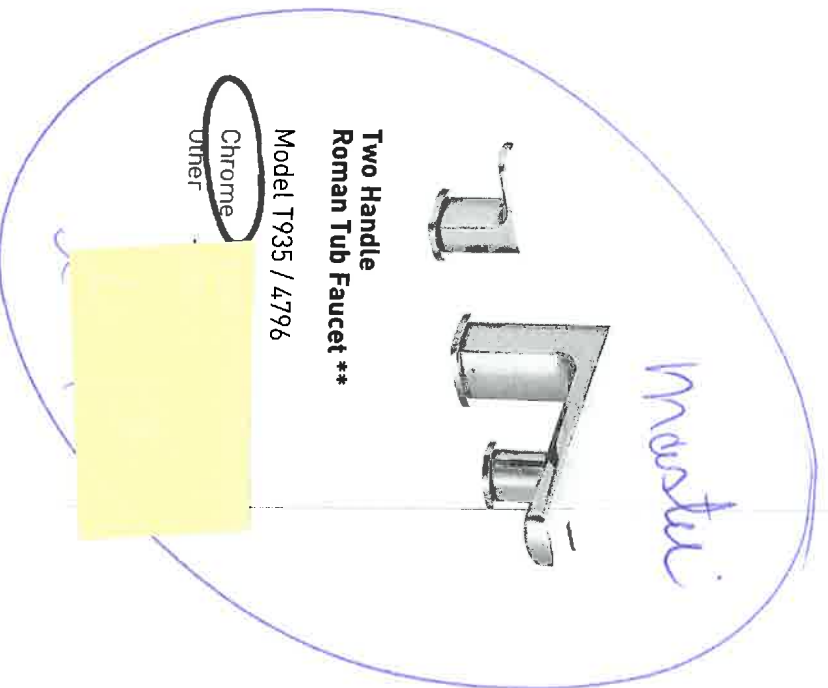

**Two Handle  
Roman Tub Faucet \*\***

Model T935 / 4796

Chrome  
Utter



**Two Handle Roman Tub Faucet  
with Hand Shower \*\***

Model T936 / 9796

Chrome  
Other

## FINISH OPTIONS:



C BN

To order, combine the model number with one of these finish letter(s):  
LifeShine® Brushed Nickel (BN).

To order Chrome (C) model, use model number only.

\*\* Tub drain assembly sold separately – T90331 series

jack ok

# Rizon™

Traditional | Transitional | Modern

Polished smooth with clean, horizontal lines, the Rizon collection features a modern style with simple edges and soft curves.

Job 22.

Due 30/16

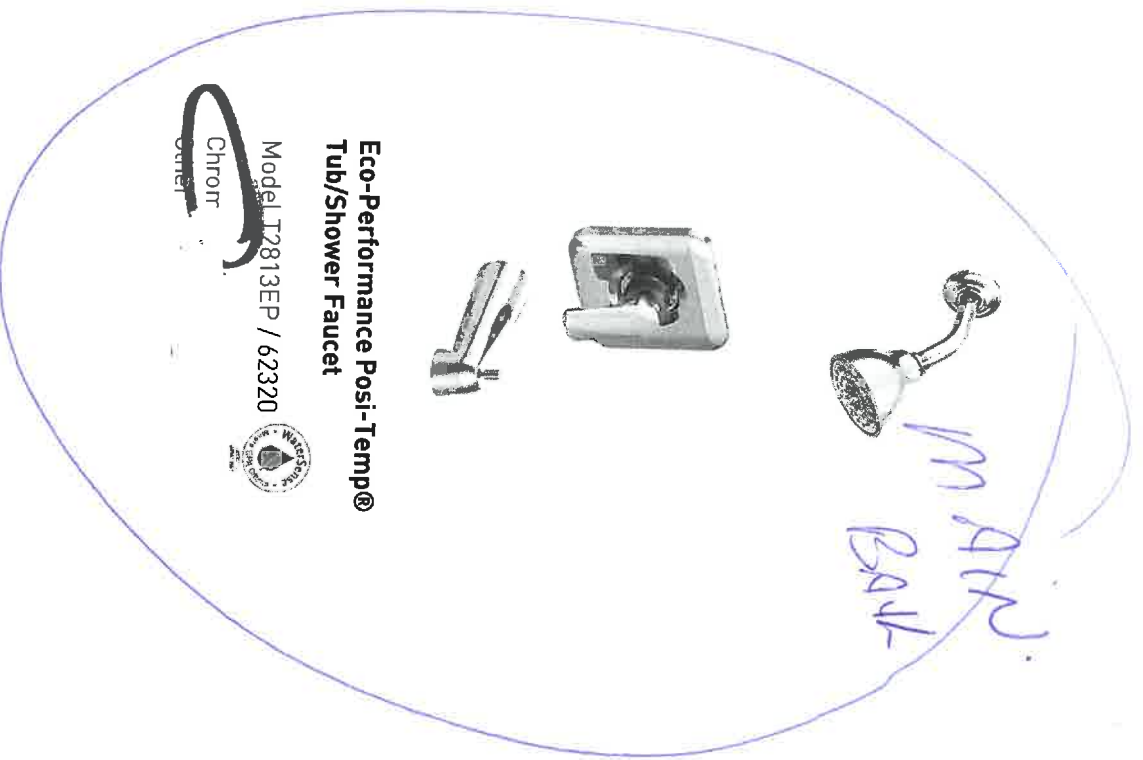

Eco-Performance Posi-Temp®  
Tub/Shower Faucet

Model T2813EP / 62320

Chrom  
Other

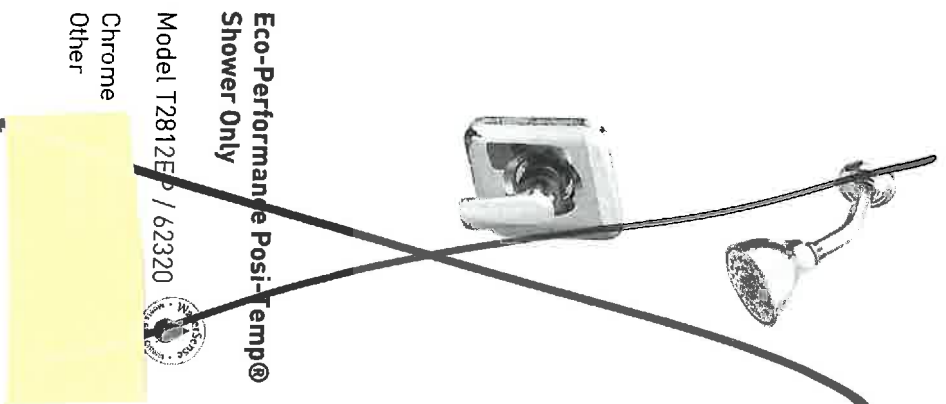

Eco-Performance Posi-Temp®  
Shower Only

Model T2812EP / 62320

Chrome  
Other



## FINISH OPTIONS:



C BN

To order, combine the model number with one of these finish letter(s):  
LifeShine® Brushed Nickel (BN).  
To order Chrome (C) model, use model number only.

# Method™

Traditional | Transitional | Modern

6/122

Dec 30/16

2pk 1-main 1-inmate

Pivoting

~~Toilet Tank Lever  
Model YB2401  
Chrome  
Other~~

Double Robe Hook  
Model YB2403  
Chrome  
Other

Pivoting Paper Holder  
Model YB2408

~~18" Towel Bar  
Model YB2418  
Chrome  
Other~~

24" Towel Bar  
Model YB2424

9" Towel Bar  
Model YB2486  
Chrome  
Other

FINISH OPTIONS:

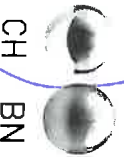

To order, combine the model number with one of these finish letter(s):  
Chrome (CH), Lifeshine® Brushed Nickel (BN).

**PROOFIT**  
INSTALLATION SYSTEM

gler

Traditional | Transitional | Modern  
Polished smooth with clean, horizontal lines, the Rizon collection  
features a modern style with simple edges and soft curves.

Rizon™

Lot 22.

Dec 30/16

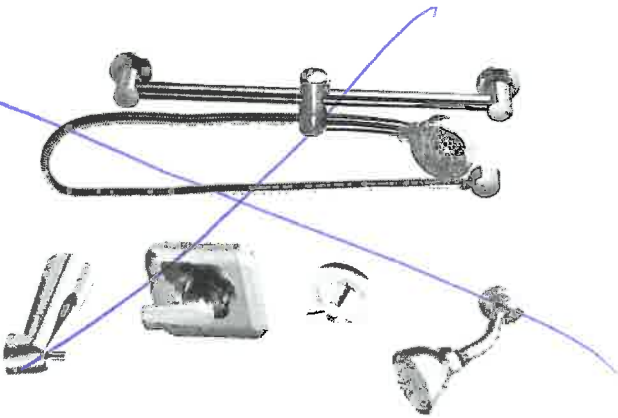

Posi-Temp® Tub/Shower Faucet  
with 3 Function Transfer Valve/Trim  
and Slide Bar with Hand Shower \*

Model T2813EP / 3372 / 128284 / 62320 /  
T4171 / 3669EP / A725

Chrome  
Other

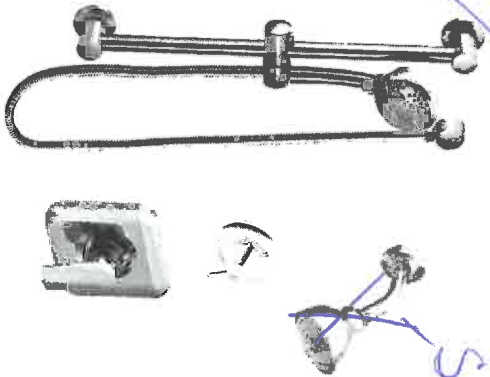

Posi-Temp® Shower Only  
with 3 Function Transfer Valve/Trim  
and Slide Bar with Hand Shower \*

Model T2812EP / 3372 / T4171 / 62320 /  
3669EP / A725

Chrome  
Other



FINISH OPTIONS:

C BN

To order, combine the model number with one of these finish letter(s):  
LifeShine® Brushed Nickel (BN).  
To order Chrome (C) model, use model number only.  
\* Please see vertical spa guide for installation #700106

See Rizon Shower

gler

~~Add \$650 to shower head price if coming from ceiling~~

# Rainshowers with Immersion™

Traditional | Transitional | Modern

Loft 22  
Dec 30/16



**Waterhill™ Single Function  
10\" Rainshower with Immersion™ \***

Model S112

S112EP is not available in WR  
Longer Shower Arm Required

Chrome -  
Other -

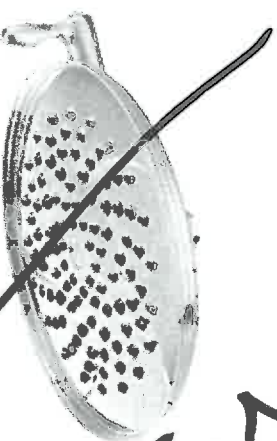

**Isabel™ Two Function  
9\" Rainshower with Immersion™ \***

Model S1311

Not available in WR

Chrome -  
Other -

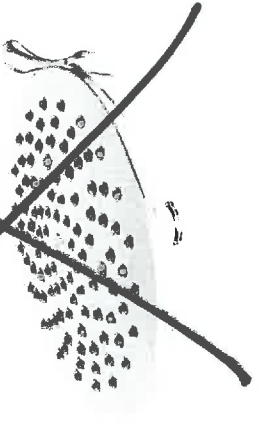

**Velocity™ Two Function  
8\" Rainshower with Immersion™ \***

Model S6120

Not available in NL or WR

Chrome -  
Other -



**Single Function  
8\" Rainshower with Immersion™ \***

Model S6360

Available in C, BN and NL

Chrome -  
Other -

## FINISH OPTIONS:



C BN NL ORB



WR

To order, combine the model in  
LifeShine® Brushed Nickel (BN)  
Polished Nickel (NL) & Wrought Iron (WR).

To order Chrome (C) model, use model number only.

\* To order the Eco-Performance (EP) version, use EP suffix in  
addition to finish

se finish letter(s):  
(ORB). LifeShine®

# Showering Accessories

Traditional | Transitional | Modern

10/22  
Due 30/16

## 16" Overhead Shower Arm

Model 151380  
Not available in WR  
Chrome  
Other

## 12" Straight Shower Arm

Model 226651  
Chrome  
Other

## Round Shower Flange

Model A 2199  
Chrome  
Other

## Round Shower Flange

Model 1 7572  
Available in C and RN  
Chrome  
Other

## FINISH OPTIONS:

C BN ORB WR

## 8" Curved Shower Arm

Model 123815  
Not available in WR  
Chrome  
Other

## 6" Straight Shower Arm

Model 116651

## Round Shower Flange

Model 137188  
Available in C and BN  
Chrome  
Other

note  
Shower  
Install  
under  
ceiling.

To order, combine the model number with one of these finish letter(s):  
LifeShine® Brushed Nickel (BN), Oil Rubbed Bronze (ORB) & Wrought Iron (WR).  
To order Chrome (C) model, use model number only.  
\*\* To order the Eco-Performance (EP) version, add "EP"  
after the model number



## APPLIANCE SPEC INFORMATION SHEET

STE & LOT:

88 Angus St

DATE:

Dec 19/16

SITING:

☐

Standard

☐

Reverse

### RANGE

☒ 30" (STD)

Slide in Stov

☐ 36"

☐ 48"

☐ GAS

☐ AMPS

☐ COOKTOP (APRON)

☐ AMPS

☐ COOKTOP (DROPIN)

☐ AMPS

### REFRIGERATOR

☒ STANDARD OPENING 36" X 72"

☐ BUILT IN FRIDGE

☐ WATERLINE REQUIRED

☐ PANELLED/INTEGRATED

☐ FLUSH INSET

### WALL OVENS

☐ 30"

☐ SINGLE

☐ AMPS

☐ DOUBLE

☐ AMPS

☐ STEAM OVEN

☐ AMPS

☐ WARMING DRAWER

☐ AMPS

### MICROWAVES

☐ BUILT IN MICRO

☐ AMPS

☐ MICRO TRIM KIT

☐ MODEL

☐ OVER THE RANGE

☐ AMPS

### HOOD FANS

☒ CHIMNEY (CENTRE VENT)

☐ UNDER CABINET

☐ FLUSH INSET

☐ 6 INCH (STD)

☐ 8 INCH

☐ 10 INCH

### DISHWASHER

☒ 24" (STD SIZE)

### LAUNDRY

☐ FRONT LOADING SIDE BY SIDE

☐ STACKABLE

Additional charges may apply for cabinetry, electrical and plumbing in order to accommodate the specs given by the homeowner.

**NOTE:** It is the Purchaser's responsibility to coordinate delivery, installation and hook up of appliances and to ensure they are installed as per Manufacturers specifications after closing.

Purchaser acknowledges responsibility for providing correct specification for such appliances. The purchaser agrees to deliver forthwith to the Builder the manufacturer's appliance specifications where the size exceeds the standard openings.

**If specs not received, the standard openings as determined by Zancor Homes will be provided. If rework/repair is required due to late specs received, additional costs will be applied.**

Appliance Specs not received, DUE BY:

Jan 15/17

Appliance Specs RECEIVED

Purchaser Signature

[Signature]

Date

Dec 30/16

Purchaser Signature

[Signature]

Date

Dec 30/16

SEARS

60122  
Angus OK

↑ / APPLIANCES / MAJOR APPLIANCES / STOVES & OVENS / STOVES / SLIDE-IN STOVES / 4.6 CU.FT. 30" S/C CONVECTION SLIDE-IN RANGE - STAINLESS

See th. Jan 11/17

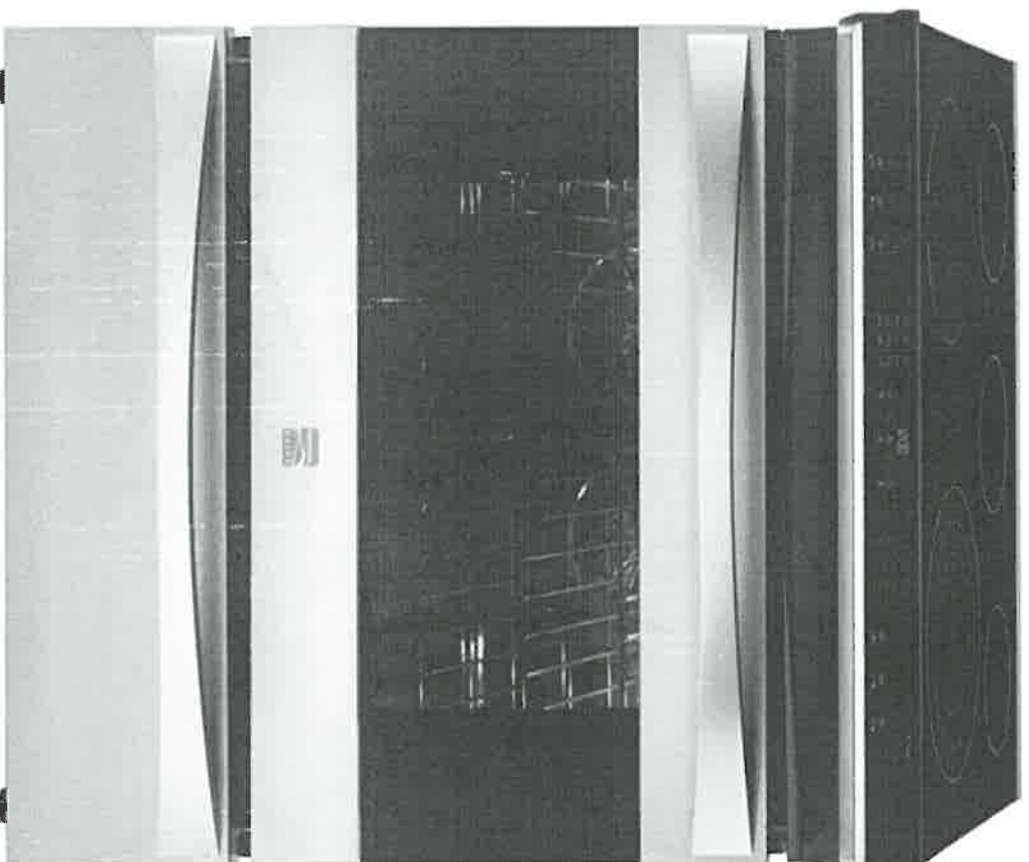

## 4.6 cu.ft. 30" S/C Convection Slide-In Range - Stainless

Kenmore Elite

Item # 5201563\_1

TOP

**\$2,199.99**

COMPARE AT \$2399.99

Online:

✓ In Stock

Qty

1

Slide in  
Stove OK

ADD TO CART

⊕ ADD TO WISHLIST



SHARE

Lot 22  
Jan 7/17

Description    Product Details    **Attributes**

Control Panel Lighting	None
Product height (in.)	35.75
Oven Interior Width (in.)	24.12
Convection Fan	2 Speed
Energy Star Qualified	No
Drip Trays	Not Applicable
Oven Interior Depth (in.)	18.75
Oven Interior Height (in.)	17.5
Oven Type	Self-Clean Convection
Product weight (lb.)	144.0
Cooktop Material	Black Glass
Product depth (in.)	26.25
Cutout Depth (in.)	21.6

TOP

Wheels/Legs

Adjustable Wheels With Locks

FRIGO

OK

Jan 7/17

10/22

Product weight (lb.)	312.0
Reversible Doors	No
Controls	Digital
Product depth (in.)	32.88
Shelf suspension	cantilever
Interior Lights	One
Reference ID	646-73133-000
Product width (in.)	32.75
Defrost System	Frost Free
Icemaker/Dispenser	Electrnc Water/Cubed/Crshed Ice
Can Rack	No
Total capacity (cu. ft.)	24.2
Door Finish	stainless steel
Dairy Compartments	One

Reviews Q&A

YOU MIGHT LIKE

TOP

SEARS

OK

↑ / APPLIANCES / MAJOR APPLIANCES / REFRIGERATORS & FREEZERS / REFRIGERATORS / FRENCH DOOR / 24.2 CU.FT. FRENCH DOOR, ICE & WATER DISPENSER -

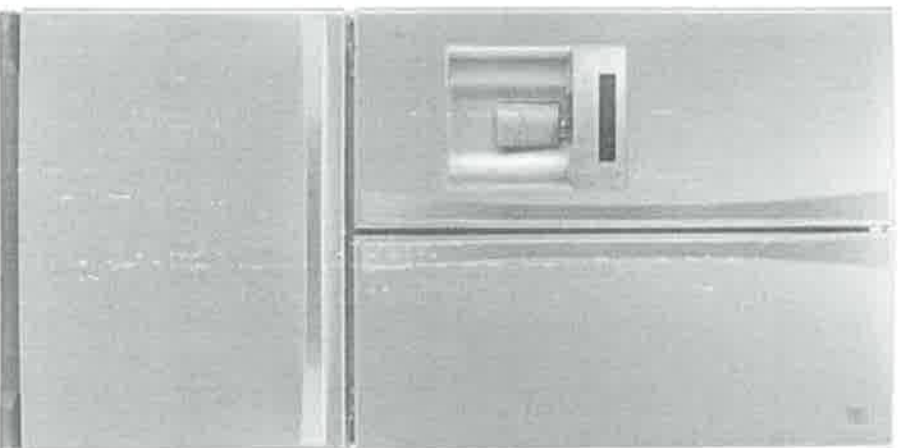

10122  
Jan 3 / 17



24.2 cu.Ft. French Door, Ice & Water Dispenser -

Kenmore Elite

Item # 5214414\_1

**\$2,999.99**

TOP

COMPARE AT \$3149.99

Online:

✓ In Stock



ADD TO CART

ADD TO WISHLIST SHARE

FRIDGE

60122

OK Jan 2/17

Description	Product Details	Attributes
Number of freezer shelves	None	
Number of freezer door bins	None	
Filter Part No	9002	
Product Height (In.)-Excluding hinge cover	68.38	
Crispers	2 W/Humidity Control	
Product depth without handles (In.)	32.88	
Door Colour	Stainless Steel	
Freezer light	Yes	
Fridge Snack Bin	None	
Product height (In.)	68.38	
Filtered Water	Yes	
Freezer capacity (cu. ft.)	8	
Energy Star Qualified	Yes	
Number of Pullout Baskets	2	
Cabinet Colour	Grey	

FRIDGE

Reference ID

622-42563-000

Oven Window

Extra Large

Cutout Width (in.)

30.00

Specialty Racks

None

Product width (in.)

30.0

Expandable Elements

1

Small Appliance Outlet(s)

None

Energide Rating

0

Oven Lights

2

Oven Accessories Included

Temperature Probe

Type of Timer

Prc Touch Control

Cutout Height (in.)

36.00

LOB 22 Mays 5.  
OK Sold.  
Jan 7/17

Reviews Q&A

YOU MIGHT LIKE

TOP

Dishwashers

10622

Dec 30/16

Enclosure Requirements

**⚠ WARNING**

**Avoid Scalding or Electrical Shock Hazard!**  
Make sure the water supply and electrical supply are shut off before installation or service.

**Avoid Electrical Shock/Fire Hazard!**  
Do not allow the electrical and supply lines to touch.

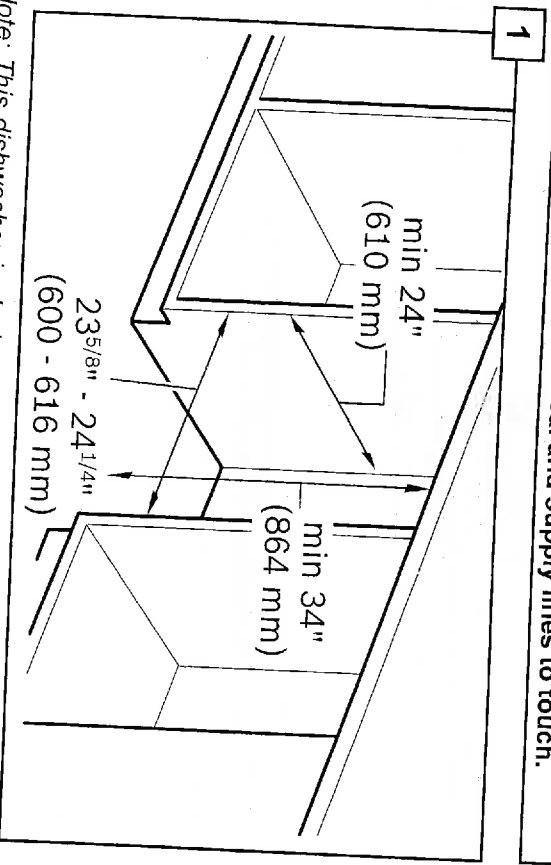

**Note:** This dishwasher is designed to be enclosed on the top, back and both sides by standard residential kitchen cabinetry. **Select a location** as close to the sink as possible for easy access to water supply and drain lines.

**For proper dishwasher operation** and appearance, ensure that the enclosure is square and has the dimensions shown.

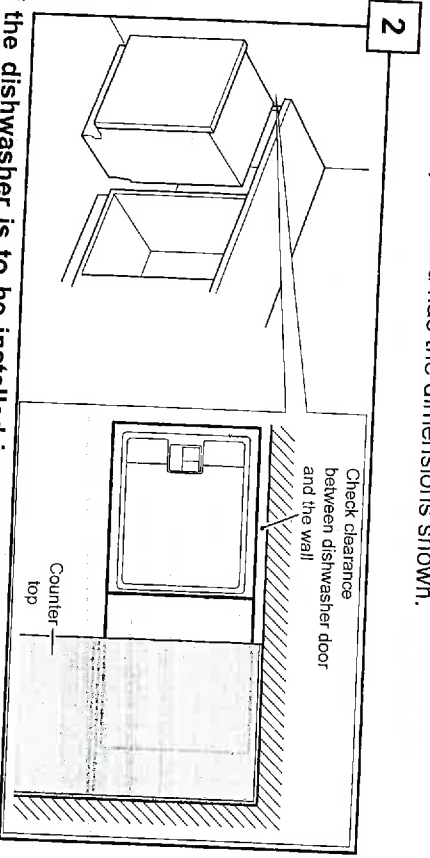

**If the dishwasher is to be installed in a corner,** ensure that there is adequate clearance to open the door as shown.

OK/OK



## CHIMNEY HOOD FAN

Maxair MXR-T03-30

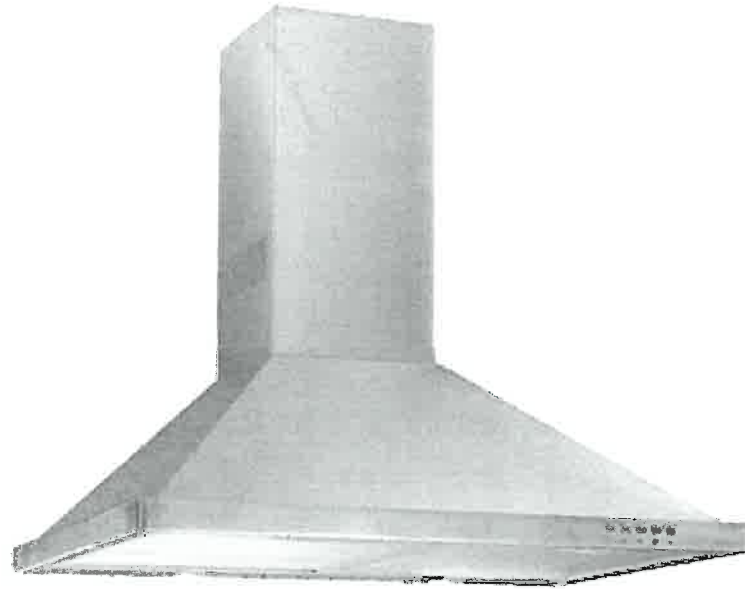

L0122

Dec 30/16

APK/OK

**\*\*NOTE – This is supplied from our electrician. Changes to a different hood fan will have to be purchased through an appliance company of homeowners choice.**

**\*Subject to change without notice E.O. & E.**

**INTERIOR FINISHES ACKNOWLEDGEMENT / HARDWOOD WAIVER**

Purchaser accepts and acknowledges that the Builder reserves the right to substitute materials with those of equal or better quality where the manufacture, scheduling or delivery of materials may directly impact the Builder's ability to meet its' contractual obligations under the Agreement of Purchase and Sale.

**PORCELAIN & NATURAL STONES:** Due to the properties of natural stones including but not limited to **marble, granite, quartz**, no two pieces are exactly the same. Variations in colour, tone, granularity (pitting, fissures) and pattern are to be expected, including various lighting may affect the overall finished look. Stone should never be cleaned with lemon oil or vinegar. The purchaser acknowledges colour and product variations as well as natural imperfections that may exist with the selection of natural stone materials and shall not hold the Vendor liable for provision of same.

**STONE COUNTERTOP JOINTS:** Purchaser is aware that one joint will be at each corner and on either side of slide-in-range (if applicable). It will also be where the length of the counter top exceeds the length of a stone slab. Slabs are usually approximately 5'x 8'.

**CERAMIC TILES:** Due to manufacturing, shade (dye lots), product variations may exist that can affect the overall look of the finished product. Although every effort will be made to ensure the colours and materials selected are as close as possible to the samples, the purchaser acknowledges that the sample tiles supplied in the Design Centre may not be identical to the materials installed in the home.

**STAIR STAINS:** Due to the natural properties of wood, many variables can affect the overall look of the finished product. Factors including but not limited to wood type, knotting, graining, density, age, humidity, and air temperature can result in substantial variations in stain intensity. The purchaser accepts that although the Vendor will do their best to match stain the unfinished stairs as close as possible to the pre-finished floors, it is not possible to have an identical match and that there MAY be shade differences between the two products.

**CABINETRY:** Due to the natural properties of wood, slight variations apparent with cabinetry are to be expected. This includes but not limited to wood species, wood grain, colour, finish, product variations, and natural imperfections are all factors that may affect the overall look of the finished product. Such factors make exact colour matching impossible. The type and intensity of lighting in the areas of designated cabinetry placement may also highlight characteristics of cabinetry finish. All cabinets shall be finished with a white melamine interior box unless a finished interior is upgraded. Due to building specifications and/or on-site conditions, certain cabinetry upgrades may not be possible. The purchaser acknowledges that the Builder cannot guarantee the cabinetry finish or provision of certain upgrades and shall not hold the Builder liable for provision of same.

**UPGRADES/EXTRAS:** All upgrades and additional selections indicated on the colour chart must be accompanied by an upgrades/extras sheet (PES) and full payment otherwise the selection will be invalid. All colour charts and upgrades/extras will not proceed until verified and signed by an authorized signing officer at the Vendor's head office. **CHANGES WILL NOT BE PERMITTED UPON COMPLETION AND SUBMISSION OF THE COLOUR CHART.**

**HARDWOOD FLOORING:** Due to the natural properties of wood, many variables can affect the overall look of the finished product. Variations include but not limited to wood type, colour/stain and wood grain are significant factors that make exact colour matching impossible. The purchaser acknowledges that the hardwood flooring is a pre-finished product in a controlled environment. Expansion, compression and cupping are characteristics of hardwood flooring once installed in the home. The purchaser acknowledges these may become apparent over time and despite the Builders' efforts to install the hardwood flooring materials in keeping with good workmanship, the Builder shall not be responsible nor held liable for minor variances of fluctuation in hardwood flooring materials.

**HARDWOOD WAIVER:**

I/We understand hardwood flooring is classified as a porous material and as such not recommended by the Builder in certain areas. I/We understand there is a concern due to possible water and other substances being frequently splashed or spilled onto the floor and in contravention of Ontario Building Code Section 9.30.1.2(1).

**"Finished flooring bathrooms, kitchens, public entrance halls, laundry & general storage areas shall consist of resilient flooring, felled-synthetic-fibre floor coverings, concrete, terrazzo, ceramic tile, mastic or other types of flooring providing similar degrees of water resistance."**

I/We are prepared to assume full responsibility for any damage caused to the hardwood floor or subfloor due to moisture absorbency in the mentioned areas, and agree to waive any claims against the Township of residence, TARION and/or the Builder in relation to the matter.

**\*\*SEE COLOUR CHART FOR LOCATIONS\*\***

SITE August South

LOT 22

DATE 24/03/16