



CONSTRUCTION SUMMARY

Belle Aire Shores - Zancor Homes (Innisfil) Ltd.

PURCHASER: Unknown Lot165

TEL: RES.: 416-8437

LOT / PHASE	HOUSE TYPE	PRINT DATE
165 / 1	Unknown	31-Aug-17

Ref#	Quantity - Description	Approved	Notes
2370	SMOOTH CEILINGS THROUGHOUT MAIN AND SECOND FLOOR AND BASEMENT	31Aug17	
2375	19.00 - ELECTRICAL - LED POTLIGHTS (6) IN GREAT ROOM ON EXISTING SWITCH, DELETE STD LIGHT (6) IN DINING ROOM ON SEP SWITCH, STD LIGHT TO REMAIN**INSTALL INSIDE COFFERED (7) IN KITCHEN/BREAK ON SEP SWITCH, STD LIGHT TO BE OVER ISLAND	31Aug17	
2376	12.00 - ELECTRICAL - LED POTLIGHTS (1) AT POWDER ROOM LANDING ON SAME SWITCH AS SCONCES (6) IN LIVING ROOM ON SEP SWITCH **INSTALL INSIDE COFFERED BOX (5) IN MAIN/SIDE HALL ON EXISTING SWITCH, DELETE STD LIGHT (2) HALL, SEP SWITCH	31Aug17	
2675	BONUS: Granite kitchen countertops with undermount sink 3 Piece stainless steel appliances with white top loading washer and dryer Stainless steel under cabinet hood fan Extended uppers in kitchen (39-1/2") BBQ Gas line	04May17	
2676	BONUS: Air Conditioning (42ft and 50ft lots ONLY) 9ft main floor ceilings, 8ft ceilings on second floor 3-1/4 inch by ¾ inch natural prefinished engineered hardwood on main floor in non-tiled areas, excludes bedrooms Natural finished oak stair	04May17	
2677	3.00 - ELECTRICAL - SWITCHES FOR POTS ON MAIN FLOOR TOTAL ADDITIONAL (3)	31Aug17	
2678	ELECTRICAL - MAIN FLOOR (2) WALL SCONCE ROUGHINS AT POWDER ROOM LANDING APPROX 67 INCHES ABOVE FLOOR **ON SAME SWITCH AS POTLIGHT (1) DOOR JAMB WITH LIGHT AND SWITCH FOR MUDROOM CLOSET (1) DOOR JAMB WITH LIGHT AND SWITCH FOR MAIN HALL CLOSET	31Aug17	
2679	ELECTRICAL - MAIN FLOOR (1) CAPPED LIGHT ABOVE ISLAND TO BE SWITCHED WITH THE STANDARD LIGHT Two lights total above island, STD plus 1	31Aug17	
2680	ELECTRICAL - POWDER ROOM (1) POTLIGHT IN CENTRE ON SAME SWITCH AS STANDARD LIGHT OVER VANITY	31Aug17	
2682	13.00 - ELECTRICAL - LED POTLIGHTS SECOND FLOOR (4) IN UPPER HALL ON SEP SWITCH, STANDARD TO LOCATED OVER STAIR LANDING (6) IN MASTER BED ON EXISTING SWITCH, DELETE STANDARD LIGHT (3) IN MASTER BED CLOSET ON SEP SWITCH, STD REMAINS	31Aug17	
2683	ELECTRICAL - SECOND FLOOR (2) LED POTS IN LAUNDRY ROOM ON EXISTING SWITCH (2) WALL SCONCES ON STAIR LANDING TO BE ON SAME SWITCH AS STANDARD LIGHT **65 Inches from floor, 16 inches in from wall	31Aug17	
2684	ELECTRICAL - MASTER ENSUITE (2) LED POTLIGHTS ON SEP SWITCH, INSTALL STD LIGHT OVER TUB (1) LED POT IN WATER CLOSET, DELETE STD (3) WALL SCONCES APPROX 65 INCHES ABOVE FLOOR, DELETE STD VANITY LIGHTS	31Aug17	
2685	ELECTRICAL - SECOND FLOOR (3) ADDITIONAL SWITCHES REQUIRED FOR POTLIGHTS	31Aug17	
2687	ELECTRICAL - DOOR JAMB SWITCH WITH LIGHT IN LINEN CLOSET ON SECOND FLOOR	31Aug17	
2689	ELECTRICAL - KITCHEN ISLAND PLUG ON SIDE OF ISLAND	31Aug17	
2690	ELECTRICAL - UNDER CABINET LIGHTING ON SEP SWITCH	31Aug17	



CONSTRUCTION SUMMARY  
Belle Aire Shores - Zancor Homes (Innisfil) Ltd.

PURCHASER: Unknown Lot165

TEL: RES.: 416-8437

LOT / PHASE	HOUSE TYPE	PRINT DATE
165 / 1	Unknown	31-Aug-17

Re# Quantity - Description

Approved Notes

2692	FRAMELESS GLASS SHOWER IN MASTER ENSUITE AND BASEMENT BATHROOM	31Aug17	
2693	INTERIOR HARDWARE - UPGRADE 3 **LINEA	31Aug17	
2694	TRIM - UPGRADE 1 CASING & BASEBOARDS INCLUDES BASEMENT *STEP STYLE	31Aug17	
2695	GAS LINE TO STOVE **INCLUDES 15 AMP PLUG, STD TO ALSO REMAIN	31Aug17	
2696	WATERLINE TO FRIDGE - MAIN FLOOR AND BASEMENT	31Aug17	
2697	HARDWOOD - UPGRADE 4 ON MAIN FLOOR VINTAGE SCULPTED 4-3/8, COLOUR - HIGHLAND	31Aug17	
2698	HARDWOOD - UPGRADE 4 IN UPPER HALL VINTAGE SCULPTED 4-3/8, COLOUR - HIGHLAND	31Aug17	
2699	HARDWOOD - UPGRADE 4 IN BEDROOMS VINTAGE SCULPTED 4-3/8, COLOUR - HIGHLAND	31Aug17	
2700	RAILINGS - UPGRADE 3 SINGLE COLLAR WITH ALT PLAIN **TWO FLIGHTS, MAIN TO BASEMENT AND MAIN TO SECOND	31Aug17	
4361	CABINETRY - KITCHEN UPGRADE 3	31Aug17	
4362	CABINETRY - KITCHEN UPGRADES POT DRAWERS (X2) ADDITIONAL BANK OF DRAWERS 36 INCH CANOPY PANEL FOR DISHWASHER & FRIDGE CROWN MOULDING ISLAND POSTS (X4) LIGHT VALANCE ANTISLAM DOORS AND DRWERS	31Aug17	
4363	CABINETRY - BATHROOM UPGRADES BASEMENT UPGRADE 2 POWDER UPGRADE 2 BED 2 BATH UPGRADE 1 TWIN BATH UPGRADE 1 LAUNDRY UPGRADE 1 ENSUITE UPGRADE 2	31Aug17	
4364	CABINETRY - VANITY EXTRAS ENSUITE - (X3) SETS OF BANK OF DRAWERS TWIN BATH - BANK OF DRAWERS TOP DRAWERS X6 TWIN BATH - PANTRY MODIFIED POWDER ROOM	31Aug17	
4426	APPLIANCES - COAST STOVE - KITCHEN AID 36" KDRS467VSS FRIDGE - KITCHEN AID KBFN406EPA DISHWASHER - KITCHEN AID KDTE204EPA HOODFAN - SIRIUS SU901X INSERT WASHER/DRYER - MAYTAG YMED5500FC & MHW5500FC	31Aug17	
4427	STAIN STAIRS TO MATCH HARDWOOD	31Aug17	
4429	HVAC - 6 INCH VENT IN BASEMENT FOR FUTURE STOVE	31Aug17	



CONSTRUCTION SUMMARY

Belle Aire Shores - Zancor Homes (Innisfil) Ltd.

PURCHASER: Unknown Lot165

TEL: RES.: 416-8437

LOT / PHASE	HOUSE TYPE	PRINT DATE
165 / 1	Unknown	31-Aug-17

Ref#	Quantity - Description	Approved	Notes
4430	ELECTRICAL - 40 AMP STOVE PLUG IN BASEMENT FRIDGE PLUG IN BASEMENT DISHWASHER ELECTRICAL IN BASEMENT HOOD FAN ELECTRICAL IN BASEMENT	31 Aug 17	
4431	WATERLINE FOR FUTURE DISHWASHER IN BASEMENT	31 Aug 17	
4467	COUNTERTOPS - KITCHEN & POWDER - WHITE AMA CMP MASTER ENSUITE & LAUNDRY - SMOKE GREY CMP ENSUITE 2 & BASEMENT - CENIZA CMP TWIN 3/4 - BOTTICINO CMP	31 Aug 17	
4468	PLUMBING / COUNTERTOPS POWDER & MASTER ENSUITE - OVAL UNDERMOUNTS (CONTRAC 4220CFY) ALL OTHER BATHROOMS - RECTANGLE UNDERMOUNTS (CONTRAC 4210CITY)	31 Aug 17	
4499	200 AMP SERVICE	03 Aug 17	
4500	OAK STAIRS TO BASEMENT - upgrade stair to oak with vincer stringers and risers. Includes finished basement foyer, standard tile and door to finished basement. Where applicable standard railing will apply	03 Aug 17	
4501	LARGER BASEMENT WINDOWS	03 Aug 17	
4502	FINISHED BASEMENT - Includes finished basement bathroom with FRAMELESS GLASS SHOWER, 1 bedroom with EGRESS WINDOW, 2 additional basement windows 30 x 24, closed off storage and furnace area **Includes HARDWOOD and standard tiles	03 Aug 17	
4503	BASEMENT - DELETE ONE WINDOW AS PER BASEMENT SKETCH	03 Aug 17	
4504	9 FOOT CEILING HEIGHT ON THE SECOND FLOOR ***Windows will increased approximately 8 inches  **8 FOOT DOORS ON THE MAIN FLOOR, 2ND FLOOR AND BASEMENT IF POSSIBLE	03 Aug 17	
4505	COFFERED CEILINGS IN - DINING ROOM - TO BE APPROX 18 INCHES WIDE LIVING ROOM - TO BE APPROX 18 INCHES WIDE	03 Aug 17	
4506	TRAY CEILING IN MASTER BEDROOM	03 Aug 17	
4507	WINDOWS - ADD WINDOW IN MASTER BEDROOM CLOSET ***SAME SIZE AS ENSUITE WINDOW IF POSSIBLE, 30 X 24	03 Aug 17	
4508	POWDER ROOM - 1. SHIFT BUFFET NICHE WA;; INTO DINING ROOM AND EXTEND POWDER ROOM 2. RELOCATE PLUMBING AND INSTALL VANITY WALL TO WALL	03 Aug 17	
4509	MASTER BEDROOM CLOSET - DELETE WALL AND CREATE ONE LARGE CLOSET SHIFT CLOSET ENTRY DOOR	03 Aug 17	
4510	8 FOOT GARDEN DOORS IN LIEU OF SLIDERS **TO HAVE SIDELITES	03 Aug 17	
4540	VICHY PLUMBING IN ENSUITE2, 3/4 & POWDER **MATCHING ACCESSORIES INCLUDES **TOILET PAPER HOLDER & TOWEL BAR	31 Aug 17	
4541	FIREPLACE MANTLE - FAMILY ROOM DAVINCI VILLA NOVA WITH RAISED HEARTH	31 Aug 17	
4542	PLASTER Moulding - STYLE M8 THROUGHOUT MAIN FLOOR AND UPPER HALL Family, main hall, dining, llibing, powder, foyer, upper hall	31 Aug 17	



CONSTRUCTION SUMMARY

Belle Aire Shores - Zancor Homes (Innisfil) Ltd.

PURCHASER: Unknown Lot165

TEL: RES: 416-8437

LOT / PHASE	HOUSE TYPE	PRINT DATE
165 / 1	Unknown	31-Aug-17

Ref#	Quantity - Description	Approved	Notes
4543	TILES - UPGRADED MAIN FOYER BASEMENT FOYER POWDER ROOM MUD ROOM KITCHEN, BREAKFAST & BACKSPLASH	31Aug17	
4544	TILES - MASTER ENSUITE	31Aug17	
4545	TILES - TWIN BATHROOM	31Aug17	
4546	TILES - ENSUITE 2	31Aug17	
4547	TILES - BASEMENT BATHROOM	31Aug17	
4590	INFINITY DRAIN IN MASTER ENSUITE SHOWER	11Aug17	
4591	GARAGE MAN DOOR - RELOCATE GMD AS PER SKETCH	11Aug17	
4592	MASTER ENSUITE - MOEN JETS SHOWERING SYSTEM TO FOLLOW WITH FINISHES	11Aug17	
4748	8 INCH VENT FOR HOOD FAN IN MAIN FLOOR KITCHEN	31Aug17	
4749	PLUMBING - MASTER ENSUITE - MOEN 90 DEGREES 4 PIECE ROMAN TUB SINGLE LEVER FAUCETS (X2) RAINHEAD, SLIDEBAR, 4 JETS ***SEE MOEN SHEETS ATTACHED	31Aug17	
4750	ELECTRICAL - LED POTLIGHTS IN BASEMENT (6)+(6) IN REC ROOM, SEP SWITCHES (7) IN KITCHEN AREA (4)+(5) HALL	31Aug17	

This Document is Extremely Time Sensitive - Printed 31 Aug 17 at 15:47



ZANCOR HOMES COLOUR CHART

CABINETRY / COUNTERTOPS						
	DOOR STYLE	HARDWARE	COUNTERTOP	EDGE		
Kitchen / Island	ALGONQUIN MDF - MOCHA GLAZE		WHITE AMA			
DOOR HARDWARE	4124-1026					
DRAWER HARDWARE	4119-1026					
Master Ensuite	RENESSANCE MAPLE - TIMBER GREY	4140-1014	SMOKE GREY CMP			
Ensuite 2	CAMBRIDGE MDF - FOG GREY	4150-1014	BOTTINCINO MARBLE			
Twin 3/4	CAMBRIDGE MDF - WHITE	K400C	CENIZA CMP			
Powder Room	ALGONQUIN MDF - STONE GREY	4124-1026	WHITE AMA			
Laundry	CAMBRIDGE MDF - CONCRETE GREY	4124-1026	SMOKE GREY CMP			
Basement Bath	ALGONQUIN MDF - STONE GREY	4124-1026	CENIZA CMP			
TILES		INSERTS	THRESHOLDS			
Main Foyer	PLATINUM CERAMIC PLAT - 48 X 24 - TMAR					
Basement Foyer	PLATINUM CERAMIC PLAT - 18 X 36 - TMAR					
Powder Room	STYLE TECH METAL 24 X 24 FLGR-ST-01-24					
Mud Room	PLATINUM CERAMIC PLAT - 18 X 36 - TMAR					
Main Hall	HARDWOOD					
Kitchen Floor	PLATINUM CERAMIC PLAT - 18 X 36 - TMAR					
Breakfast Floor	PLATINUM CERAMIC PLAT - 18 X 36 - TMAR					
Kitchen Bk Splash	PLATINUM CERAMIC PLAT - 18 X 36 - TMAR					
Laundry 2ND FLOOR	GEORGETTE LIGHT 12 X 24 RON-GRGT-LIGHT-12 X 24	BRICK				
Mstr Ensuite Floor	LIVING APUANO 31 X 71 ITAL-LV-APAUNO-31.1 X 71					
Mstr Ensuite Shower	LIVING APUANO 31 X 71 ITAL-LV-APAUNO-31.1 X 71					
Master Shower Floor	LIVING APUANO 31 X 71 ITAL-LV-APAUNO-31.1 X 71					
Master Shower Jamb	EXTEND TILE AND ROB TO MATCH REMAINING					
Twin 3/4 Bath Floor	ERAMOSIA SILVER RON-ERMISLV 12 X 24	BRICK				
Twin 3/4 Ensuite Tub Wall	TAVELLA SATIN TALCO TNL-T-77670 3 X 6	BRICK				
Ensuite 2 Floor	STYLE TECH METAL 24 X 24 FLGR-ST-01-24					
Ensuite 2 Shower Wall	DIAMONTE POLVERE TNL-T-432DI 4 X 12	STACK				
Ensuite 2 Shower Floor	ROB TO MATCH					
Ensuite 2 Shower Jamb	EXTEND TILE AND ROB TO MATCH REMAINING					
Basement Ensuite Floor	ERAMOSIA SILVER RON-ERMISLV 12 X 24	BRICK				
Basement Ensuite Wall	TAVELLA SATIN TALCO TNL-T-77670 3 X 6	BRICK				
HARDWOOD / CARPET						
Living Room	VINTAGE SCULPTED OAK - 4-3/8 HIGHLAND					
Dining Room	VINTAGE SCULPTED OAK - 4-3/8 HIGHLAND					
Family/Great Room	VINTAGE SCULPTED OAK - 4-3/8 HIGHLAND					
Main Hall	VINTAGE SCULPTED OAK - 4-3/8 HIGHLAND					
Upper Hall	VINTAGE SCULPTED OAK - 4-3/8 HIGHLAND					
Master Bedroom	VINTAGE SCULPTED OAK - 4-3/8 HIGHLAND					
Bedroom 2	VINTAGE SCULPTED OAK - 4-3/8 HIGHLAND					
Bedroom 3	VINTAGE SCULPTED OAK - 4-3/8 HIGHLAND					
Bedroom 4	VINTAGE SCULPTED OAK - 4-3/8 HIGHLAND					
Carpet Underpad	N/A					
Basement Foyer	TILE					
FIREPLACES						
LOCATION	FAMILY ROOM	Opt. Surround	N/A	MANTLE	DAVINCI - VILLA NOVA	
LOCATION	N/A	Opt. Surround	N/A	HEARTH	RAISED HEARTH	
MIRRORS & ACCESSORIES			PLASTER MOULDING			
Mirrors	YES	Opt. Crown Moulding	M8			
Bathroom Accessories	UPGRADE	Location	SEE EXTRAS			
Purchaser has reviewed the colour chart				SITE & LOT		
***FOR TRADE USE***				INNISFIL 165		
Any upgrades in the colour chart must be accompanied with a PES. It is the responsibility of all Trades to inform the builder of any discrepancies on sketches, PES and/or colour charts PRIOR to installation.						
** PAGE 1 OF 2 **		Purchaser Initial		Vendor		

ZANCOR HOMES COLOUR CHART

STAIRS, RAILING & PICKETS & STAIR STAIN			
Stair Stain / Species:	STAIN TO MATCH HARDWOOD AS CLOSE AS POSSIBLE		
White Paint Req'd	N/A		
Main to Basement Railing Details:	SINGLE COLLAR WITH ALT PLAIN, GROOVED HANDRAIL, SQUARE POSTS		
2nd to Main Railing Details:	SINGLE COLLAR WITH ALT PLAIN, GROOVED HANDRAIL, SQUARE POSTS		
TRIM			
Casing/Baseboards	UPGRADE 1 - STEP		
Interior Doors	STANDARD - EXTENDED HEIGHT		
Interior Door Hardware	UPGRADE 3 LINEA		
Exterior Door Hardware	STD		
PAINT - TO BE DETERMINED			
Kitchen/Breakfast		Master Beds	
Living Room		Bedroom 2	
Dining Room		Bedroom 3	
Family/Great room		Bedroom 4	
Den/Study		Master Ens.	
Main/Upper Hall		Main	
Laundry		Twin	
Powder Room		Basement	
PLUMBING- UPGRADES TO BE DETAILED ON PES			
Kitchen	FIXTURES	FAUCETS	NOTES
Powder Room	UPGRADE	UPGRADE	
Master Ensuite	UPGRADE	UPGRADE	
Twin	UPGRADE	UPGRADE	
2nd Ensuite	UPGRADE	UPGRADE	
BASEMENT	UPGRADE	UPGRADE	
Other			
ZANCOR APPLIANCE REQUIREMENTS-UPGRADES TO BE DETAILED ON PES			
Appliance Package received in 'Schedule E'		YES / NO Package Name:	
GAS LINE	UPG (SEE PES)	DECLINED	NOTES
WATERLINE to Fridge	YES		
Hood Fan Venting SIZE	6" BASEMENT		
Hood Fan Venting SIZE	8" KITCHEN		
ELECTRICAL for Built-in Micro / OTR			
ELECTRICAL for Gas Stove / Cooktop	YES		
ELECTRICAL for Bar Fridge			
DISCLAIMER		INITIALS	
Colours of all materials are as close as possible to Builders selection but not necessarily identical due to dye lot variances in manufacturing/manufacturers. Due to construction progress some items may have been pre-selected or installed. In this event the Vendor's selection must be accepted by the purchaser			
Any changes to the colour chart after signing are subject to a \$5000 administration fee plus costs			
Purchaser has checked and acknowledged accuracy of colour and selections before signing.			
SITE:	INNISFIL	LOT: 165	
PURCHASER(S):	NICOLE CORTELLUCCI		
HOME #/CELL #	Purchaser Signature		
EMAIL:	Date		
DÉCOR NOTES	Purchaser Signature		
	Date		
	Purchaser Signature		
Date			
DÉcor Consultant Signature			Date
Vendor Signature			Date

\*\*\*FOR TRADE USE\*\*\*

Any upgrades in the colour chart must be accompanied with a PES.

It is the responsibility of all Trades to inform the builder of any discrepancies on sketches, PES and/or colour charts PRIOR to installation.





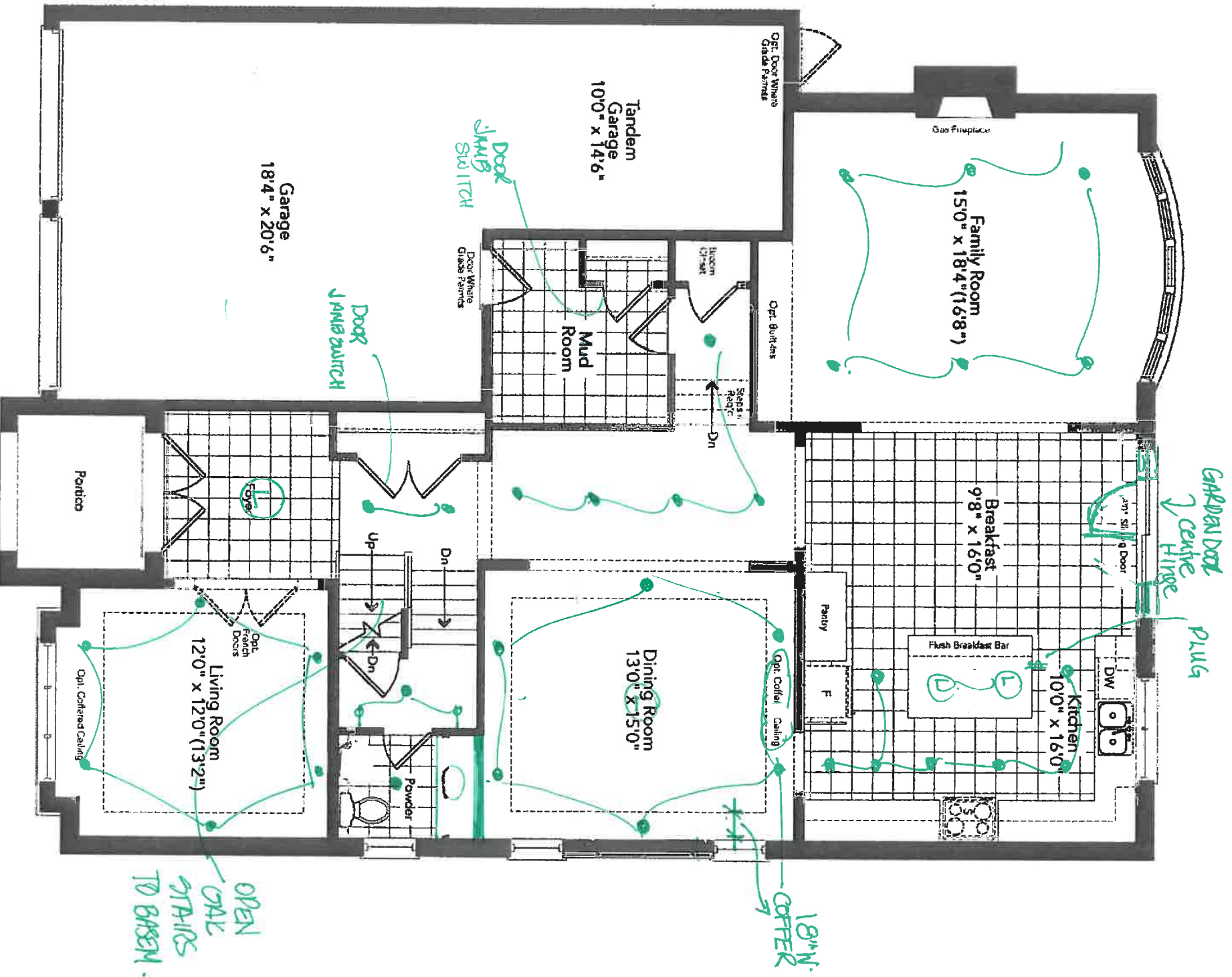

Ground Floor  
Elevation A (B)

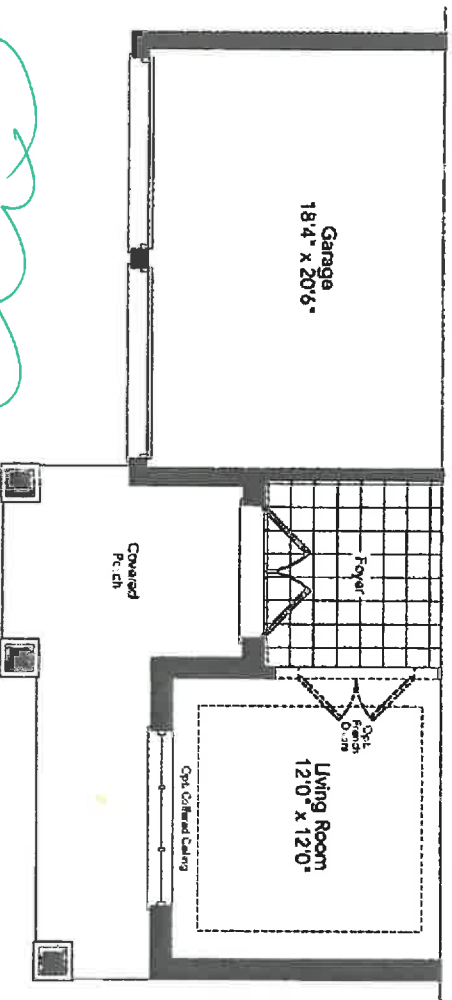

Partial Ground & Optional  
Ground Floor Elevation B

- SMOOTH CEILINGS  
- 8 FT INTERIORS  
DOORS

LOT 165

RIDGE  
50-04





165 INNSFIL

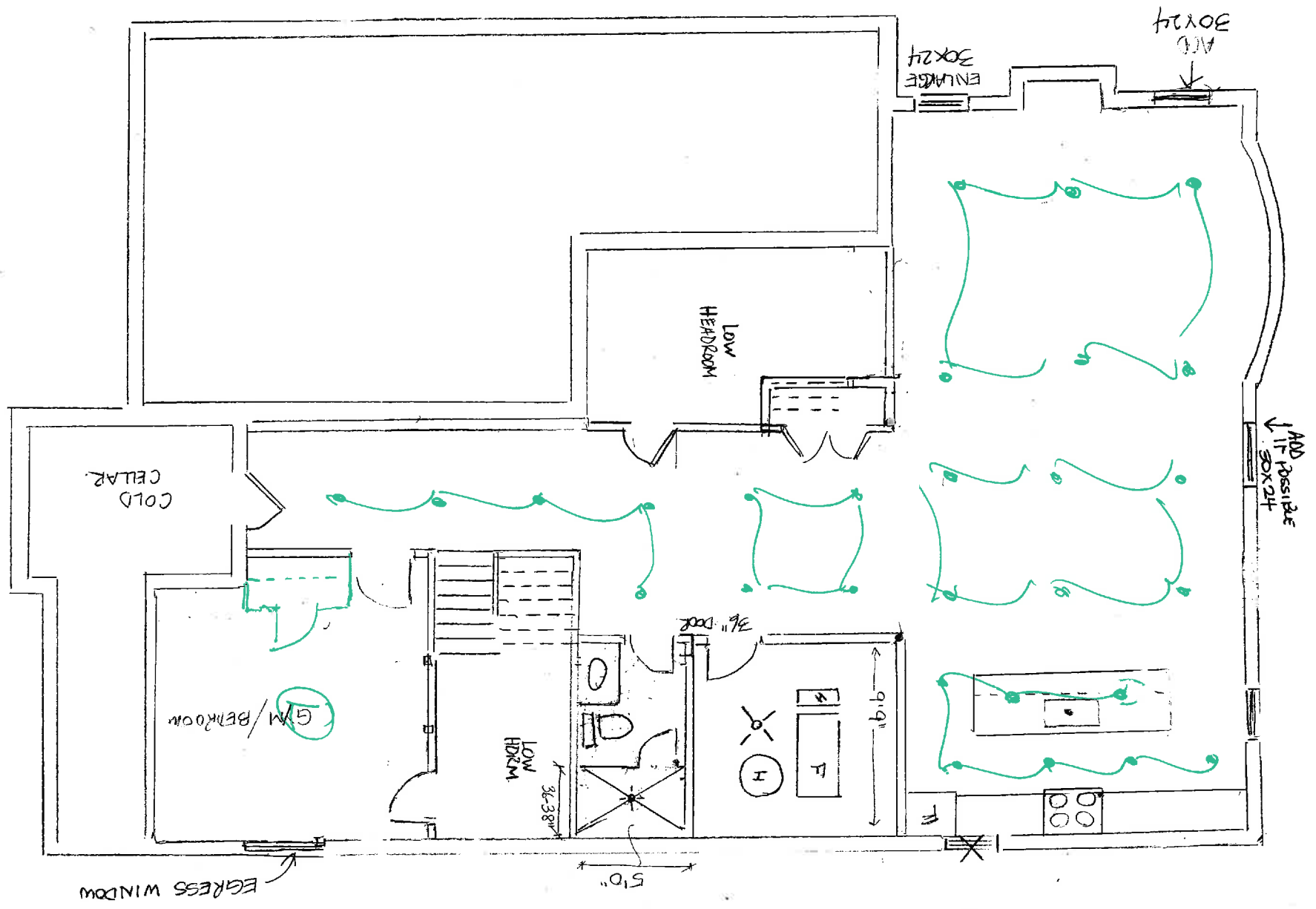

## Section 1

Reviewed by:

**Drawn by:** VINCE

**Secret**  
**Date:**

Date: 6/18/17

**Revised:**

一、

**Dealing with Difficulties**

1

DOORS: ALGONQUIN MDF  
COLOUR: MOCHA GLAZE  
HRDWDOORS: 4124-1026  
HRDWDRAWER: 4119-1026  
CT: BY OTHER

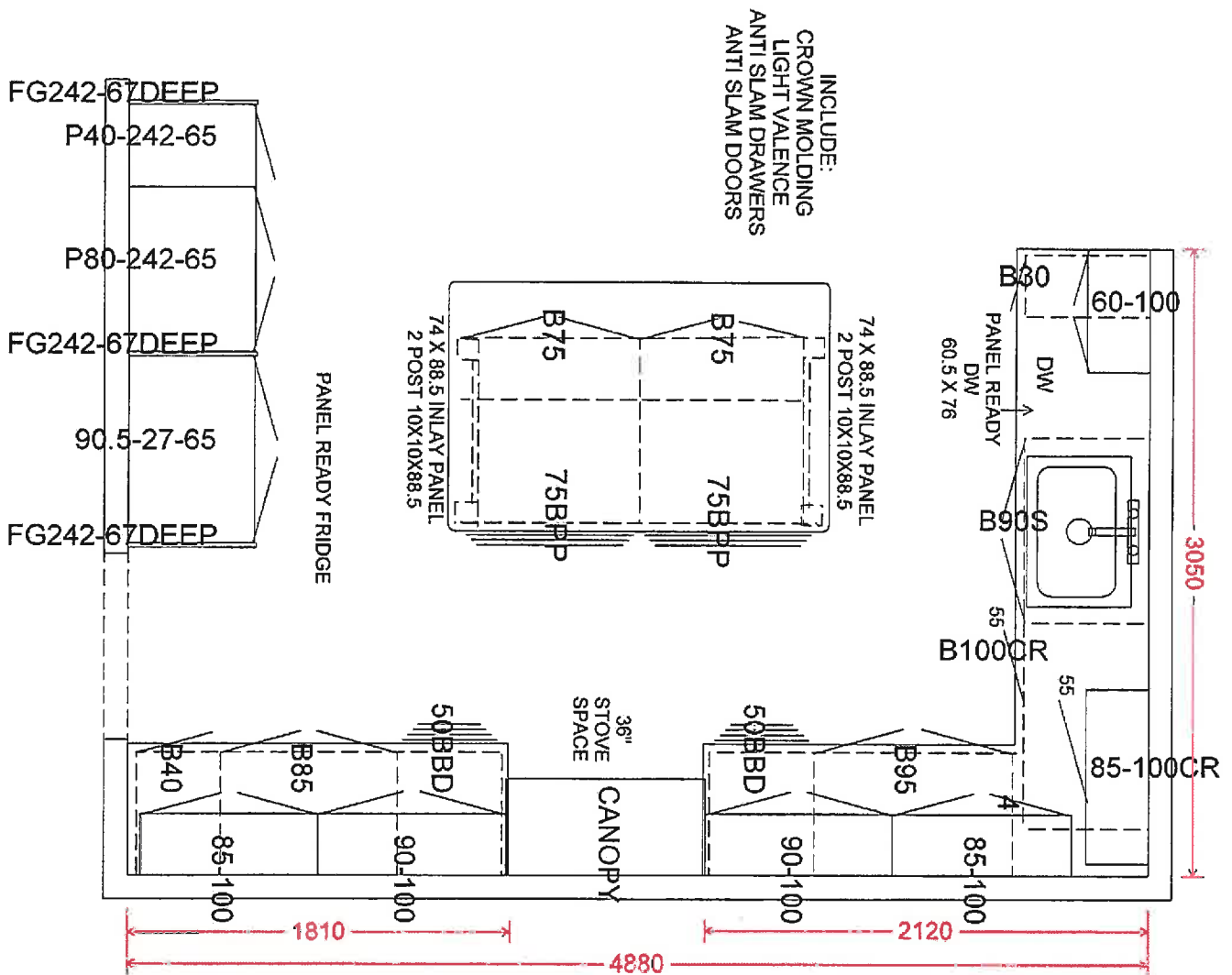

NEW IMAGE KITCHENS INC			
Scale:	Approved by:		Drawn by: VANCE
Date: 2/18/17			Revised:
NICOLE CORTELLUCCI			
LOT 185 INNISFIL 50-04			Drawing number:

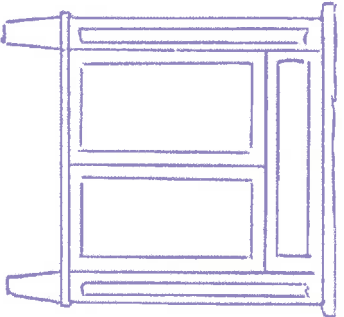
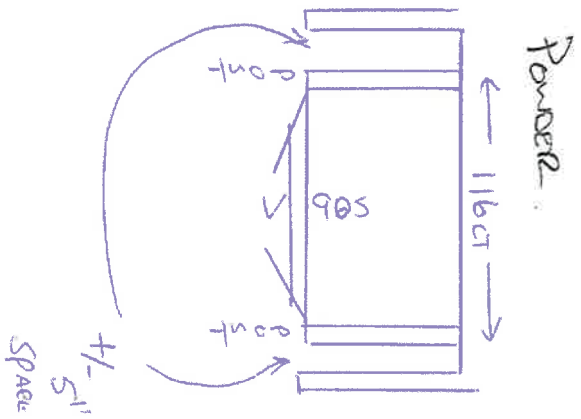
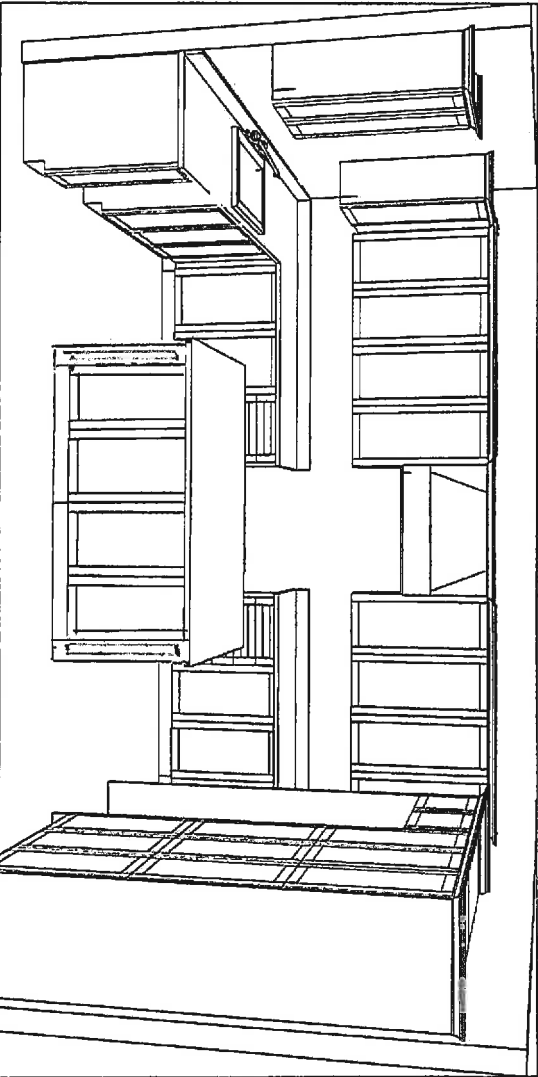

+/- 5" SPACE

NEW IMAGE KITCHENS INC			
Scale:	Approved by:	Drawn by:	VNCS
Date: 09/01/17		Revised:	
NICOLE CORTELLUCCI		Drawing number:	
LOT 165 INNUSFIL 50-04			

BASEMENT

DOORS: ALGONQUIN MDF  
COLOUR: STONE GREY  
HRDW: 4124-1026  
C/T: BY OTHER

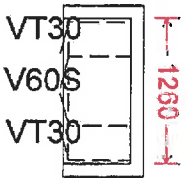

POWDER

DOORS: ALGONQUIN MDF  
COLOUR: STONE GREY  
HRDW: 4124-1026  
C/T: BY OTHER

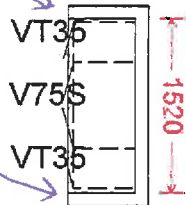

BEDROOM 2

DOORS: CAMBRIDGE MDF  
COLOUR: FOG GREY  
HRDW: 4150-1014  
C/T: BY OTHER

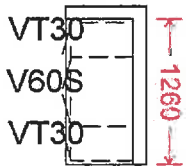

SHARED

DOORS: CAMBRIDGE MDF  
COLOUR: WHITE  
HRDW: K400C  
C/T: BY OTHER

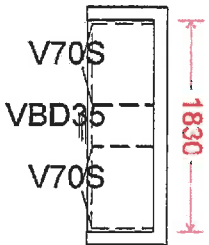

LAUNDRY

DOORS: CAMBRIDGE MDF  
COLOUR: CONCRETE GREY  
HRDW: 4124-1026  
C/T: BY OTHER

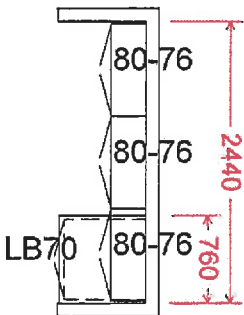

ENSUITE

DOORS: RENESANCE MAPLE  
COLOUR: TIMBER GREY  
HRDW: 4140-1014  
C/T: BY OTHER

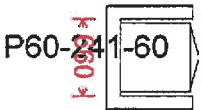
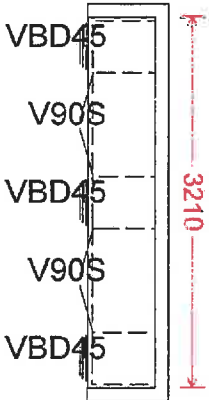



ZANCOR HOMES  
EDGE PROFILES (INTERSTONE / REDSTONE)

165 Inmish1

STANDARD

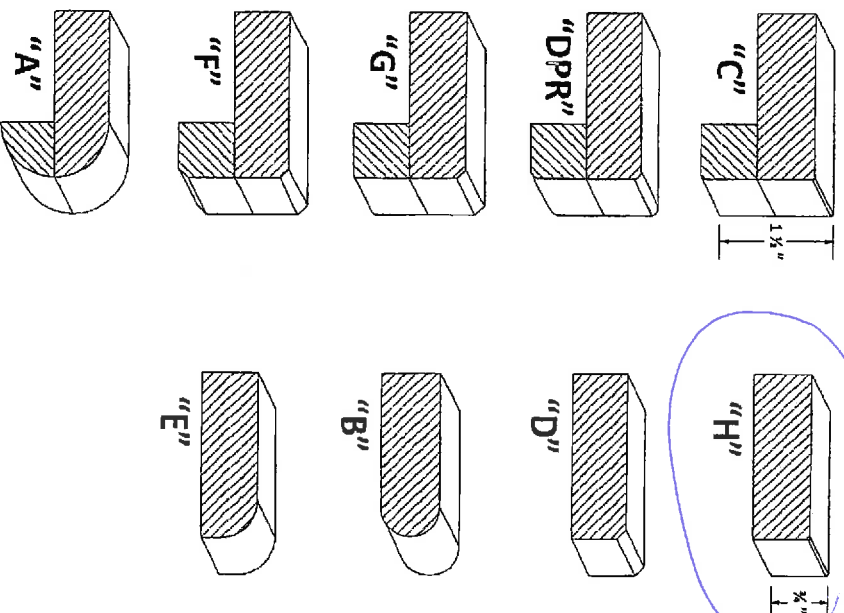

UPGRADES

Kitchen

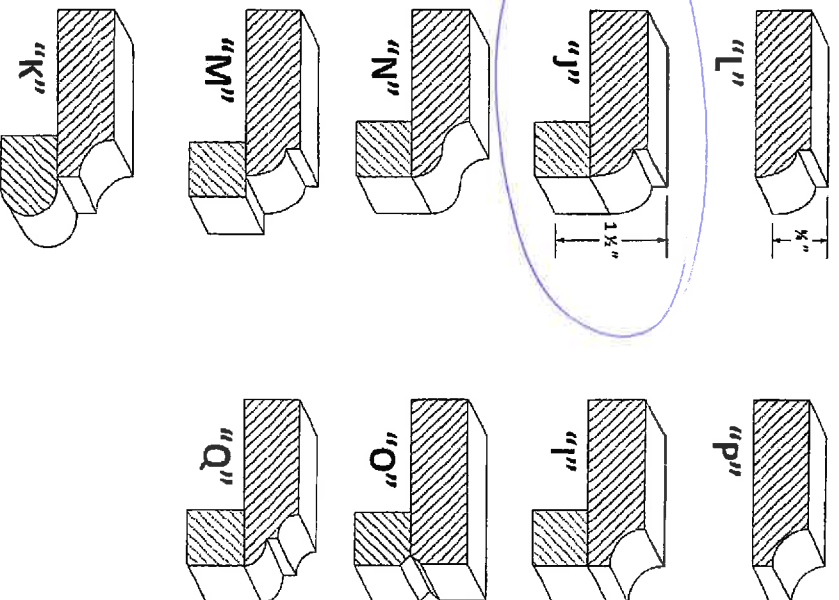

LOT / SITE

165 Inmish1

PURCHASER SIGNATURE

MOEN VICHY – CHROME FAUCETS



EN suite 2  
TWIN 3/4



EN suite 2, 3/4,  
Pouder.

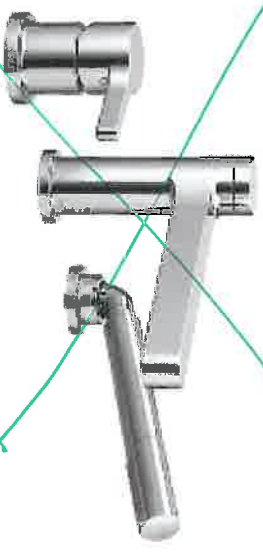

EN suite 2, 3/4, Pouder.

165 1000

90°™

Traditional | Transitional | Modern  
*Geometric forms, squared corners and straight lines create an urban focal point for today's contemporary baths.*

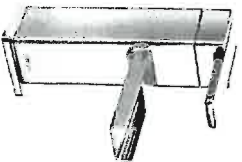

**Single Handle Open Waterway  
Lav Faucet with Lift Rod Drain ~**

Model S6705



**Single Handle Lav Faucet  
with Lift Rod Drain ~**

Model S6700

X2



**Single Handle Vessel Lav Faucet  
with Push-Button Drain  
without Overflow ~**

Model S6711 / 140780

Master ensuite

**FINISH OPTIONS:**



C BN

To order, combine the model number with one of these finish letter(s):  
LifeShine® Brushed Nickel (BN).

To order Chrome (C) model, use model number only.  
~ Deckplate sold separately - 147204 series

67 65 157

900™

Traditional | Transitional | Modern  
*Geometric forms, squared corners and straight lines create an urban focal point for today's contemporary baths.*

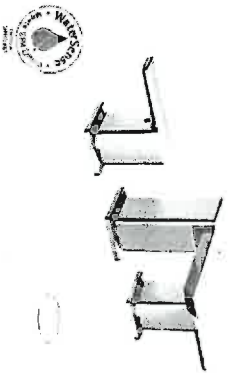

**Two Handle  
Adjustable Widespread  
(8" - 16") Lav Faucet  
with Lift Rod Drain**

Model TS6720 / 69000

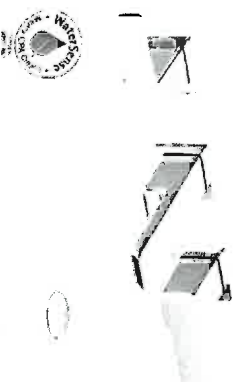

**Two Handle  
Wallmount Lav Faucet  
with Push-Button Drain  
without Overflow**

Model TS6730 / 9700 / 140780

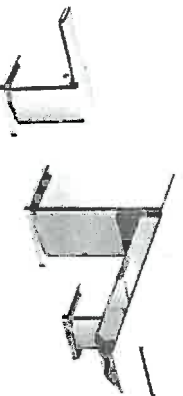

**Two Handle  
Roman Tub Faucet**

Model TS903 / 4796  
Tub Drain Half Kits Available\*\*



**Two Handle Roman Tub Faucet  
with Hand Shower**

Model TS904 / 9796  
Tub Drain Half Kits Available\*\*

**FINISH OPTIONS:**



To order, combine the model number with one of these finish letter(s):  
LifeShine® Brushed Nickel (BN).  
To order Chrome (C) model, use model number only.  
\*\* T90331 / 140680

at 105 mn



# 900™

Traditional | Transitional | Modern  
*Geometric forms, squared corners and straight lines create an urban focal point for today's contemporary baths.*



## ExactTemp® ¾" Thermostatic Vertical Spa with 4 Body Sprays \*

Model TS3100 / S6340EP / S133 / S3600 (x3) / S3371 /  
TS3300 (x3) / S3879FP / A721 / S1300 (x4) / TS1320 (x4)

## ExactTemp® ¾" Thermostatic Shower Only \*

Model TS3100 / TS3300 / S6340EP / S133 /  
S3371 / S3600

### FINISH OPTIONS:



To order, combine the model number with one of these finish letter(s):  
LifeShine® Brushed Nickel (BN).  
To order Chrome (C) model, use model number only.  
\* Please see vertical spa guide for installation #700106

# 900™

Traditional | Transitional | Modern

*Geometric forms, squared corners and straight lines create an urban focal point for today's contemporary baths.*



**Toilet Tank Lever**  
Model YB8801



**Robe Hook**  
Model YB8803



**Cabinet Knob**  
Model YB8805



**Drawer Pull**  
Model YB8807



**Pivoting Paper Holder**  
Model YB8808



**Mini Towel Bar**  
Model YB8886

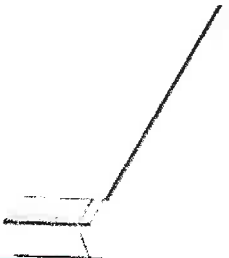

**18" Towel Bar**  
Model YB8818

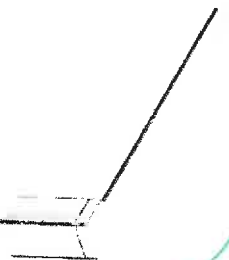

**24" Towel Bar**  
Model YB8824



**Designer Grab Bar**  
Models:

- 12" - YG8812
- 18" - YG8818
- 24" - YG8824
- 36" - YG8836

*Grab Bar*

## FINISH OPTIONS:



CH BN

To order, combine the model number with one of these finish letter(s):  
Chrome (CH), LifeShine® Brushed Nickel (BN).

*Lot 165 mm.*

DAVINCI MANTLE - VILLA NOVA  
FAMILY ROOM + *hearth*



*165 1 1/2"*



COAST Wholesale  
APPLIANCES

COAST WHOLESALE APPLIANCES INC  
#1 - 1748 CREDITSTONE ROAD, VAUGHAN, ON  
L4K 5V8 \*\*\* TOLL FREE 1-888-745-0622  
PH:(905)303-6909 FX:(905)856-5325



CHBA  
MEMBER  
Since 1978

"Innovative Products for Builders, Designers & Home Owners"

Sold NICOLE CORTELLUCCI

To: LOT 165 BELLE AIRE SHORES  
INNISFIL  
ON L9L 9L9

Ship NICOLE CORTELLUCCI

To: LOT 165 BELLE AIRE SHORES  
INNISFIL  
ON L9L 9L9

SALES ORDER  
QUOTATION

Sales Representatives		P.O.#	Terms	Prov. Tax #	Customer #	Quote #
F8 WAYNE W/18.7		LOT 165 BELLE AIRE SHO	CASH SALES		JK256	1898768-01
Quantity	Model / Description	Shipping Location	Date Quoted	Date Required		Document Type
Quoted		WOODBRIIDGE WHSE	04 MAY 17	15 SEP 17		SALES PROPOSAL
1	KDRS467VSS	KITCHENAID SS 36" DUAL FUEL RANGE FREESTANDING,COMMERCIAL STYLE,6 BURNERS				
1	KBFN406EPA	KITCHENAID 20.8CUFT FRENCH DR BTM MOUNT CUSTOM PANELS REQUIRED				
1	KDTE204EPA	KITCHENAID DISHWASHER FULLY INTEGRATED CUSTOM PANELS REQ'D				
1	MHW5500FC	MAYTAG MAXIMA 5.2 CUFT FRONT LOAD WASHER METALIC SLATE, 11 CYCLES,				
1	YMED5500FC	MAYTAG MAXIMA7.4CUFT DRYER METALIC SLATE 9 CYCLES 5 TEMP				
2	48372	EZ FLO STAINLESS STEEL BRAIDED 6" WASHING MACHINE FILL HOSE				
1	INSTALLATION HOOKUP	INSTALLATION - HOOKUP WATERLINE TO FRIDG				
1	INSTALLATION-HOOKUP	INSTALL OF FRIDGE, PANELS & HARDWARE				
1	INSTALLATION-HOOKUP	INSTALLATION - HOOKUP OF GASLINE TO RANGE				
1	INSTALLATION/DISH	INSTALLATION OF DISHWASHER				
1	INSTALLATION LAUNDRY	INSTALL OF DW PANEL & HARDWARE				
1	PFA	STANDARD INSTALLATION LAUNDRY				
1	BA FRIDGE BASE	PACKAGE FREIGHT ALLOWANCE INCLUDED				
1	BA RANGE BASE	CONTRACT BUILDERS ALLOW FRIDGE BASE				
1	BA RANGE BASE	CONTRACT BUILDERS ALLOW RANGE BASE				
						SUBTOTAL
						PST
						DEL/FUEL S/C
						HST
						TOTAL

"Quote Valid for 15 Days from Quote Date"

SUBTOTAL	
PST	
DEL/FUEL S/C	
HST	
TOTAL	

LOT 165 NW





COAST Wholesale  
APPLIANCES

COAST WHOLESALE APPLIANCES INC  
#1 - 1748 CREDITSTONE ROAD, VAUGHAN, ON  
L4K 5V8 \*\*\* TOLL FREE 1-888-745-0622  
PH:(905)303-6909 FX:(905)856-5325



CHBA  
MEMBER  
Since 1978

"Innovative Products for Builders, Designers & Home Owners"

**Sold** NICOLE CORTELLUCCI

**To:** LOT 165 BELLE AIRE SHORES  
INNISFIL  
ON L9L 9L9

**Ship** NICOLE CORTELLUCCI

**To:** LOT 165 BELLE AIRE SHORES  
INNISFIL  
ON L9L 9L9

SALES ORDER  
QUOTATION

Sales Representatives		P.O.#	Terms	Prov.Tax #	Customer #	Quote #
F8 W/AYNE W/18,7		LOT 165 BELLE AIRE SHO	CASH SALES		JK256	1898768-01
Quantity		Shipping Location	Date Quoted	Date Required		Document Type
Quoted	Model / Description	WOODBRIDGE WHSE	04 MAY 17	15 SEP 17		SALES PROPOSAL

1	BA D/W BASE	CONTRACT BUILDERS ALLOW D/W BASE
1	BA WASHER BASE	CONTRACT BUILDERS ALLOW WASHER BASE
1	BA DRYER BASE	CONTRACT BUILDERS ALLOW DRYER BASE
1	BA HOSES	BA HOSES
1	BA	BUILDERS ALLOWANCE
1	SU901X	CREDIT FOR INSTALL STANDARD PACKAGE
		SIRIUS PROFESSIONAL POWER PACK HOOD FAN
		SS,1100CFM
1	INSTALLATION/H/FAN	INSTALLATION OF HOOD FAN

SUBTOTAL
PST
DEL/FUEL
HST
TOTAL

"Quote Valid for 15 Days from Quote Date"

Sales Copy

NOW 16 LOCATIONS TO SERVE YOU

www.coastappliances.com

LOT 165 INN



SU901  
SU901

#### SU901

- Dual Motor (1100 CFM) - EBM  
Pressure: 800 Pa
- Noise level: 66 dBA/5.1 sones



- Lighting: 2x20W Dichroic lamps



- Control panel: 4 speed push-button + timer delay off timer + light switch

- grease filter: commercial style baffle filters

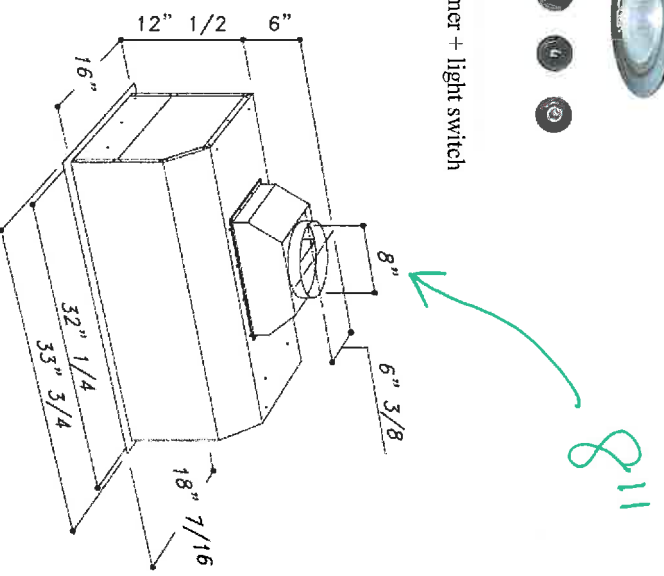

Sirius

165 mm

# KitchenAid® 30" (76.2 cm), 36" (91.4 cm), and 48" (121.9 cm) Commercial-Style Dual Fuel Convection Ranges

## PRODUCT MODEL NUMBERS

KDRS407V	KDRS483V	KDRU767V
KDRS463V	KDRU763V	KDRU783V
KDRS467V		

## ELECTRICAL CONNECTION

To properly install your range, you must determine the type of electrical connection you will be using and follow the instructions provided for it here.

- Range must be connected to the proper electrical voltage and frequency as specified on the model/serial/rating plate. The model/serial/rating plate is located on the right vertical surface of the oven door frame. Refer to the illustrations in "Product Dimensions" of the "Location Requirements" section.

- This range may be manufactured with a 4-wire power supply cord or may not include a power supply cord. If your range does not include a power supply cord, use a 4-wire power supply cord rated at 250 volts, 40 or 50 amps, and investigated for use with ranges

Range Rating*	Specified Rating of Power Supply Cord Kit and Circuit Protection	Range Size
120/240 Volts	120/208 Volts	Amps
8-8-16.5 kW	7.8-12.5 kW	40 or 50**
16.6-22.5 kW	12.6-18.5 kW	50
		30" (76.2 cm) 36" (91.4 cm) 48" (121.9 cm)

\*The NEC calculated load is less than the total connected load listed on the model/serial/rating plate.

\*\*If connecting to a 50-amp circuit, use a 50-amp rated cord with kit. For 50-amp rated cord kits, use kits that specify use with a nominal 13/8" (34.9 mm) diameter connection opening.

- A circuit breaker is recommended.

- Wire sizes and connections must conform with the rating of the range.

- The Tech Sheet is located behind the kick plate in a clear plastic bag.

## TYPE OF GAS

### Natural Gas:

This range is factory set for use with Natural gas. The model/serial/rating plate located on the right vertical surface of the oven door frame has information on the types of gas that can be used. If the types of gas listed do not include the type of gas available, check with the local gas supplier.

### LP Gas Conversion:

Conversion must be done by a qualified service technician.

No attempt shall be made to convert the range cooktop from the gas specified on the model/serial/rating plate for use with a different gas without consulting the serving gas supplier. To convert to LP gas, use the LP gas conversion kit provided with your range and see the "Gas Conversions" section. The parts for this kit are in the literature package supplied with the range.

## GAS SUPPLY LINE

- Provide a gas supply line of 3/4" (1.9 cm) rigid pipe to the range location. A smaller size pipe on longer runs may result in insufficient gas supply. With LP gas, piping or tubing size can be 1/2" (1.3 cm) minimum. Usually, LP gas suppliers determine the size and materials used in the system.

**NOTE:** Pipe-joint compounds that resist the action of LP gas must be used. Do not use TEFLON®† tape.

†®TEFLON is a registered trademark of Chemours.

## Flexible metal appliance connector:

- If local codes permit, a new CSA design-certified, 4-5 ft (122-152.4 cm) long, 5/8" (1.6 cm) or 3/4" (1.9 cm) I.D. flexible metal appliance connector may be used for connecting range to the gas supply line.



- A 1/2" (1.3 cm) male pipe thread is needed for connection to the female pipe threads of the inlet to the range pressure regulator.
- Do not kink or damage the flexible metal tubing when moving the range.

**IMPORTANT:** All connections must be wrench-tightened. Do not make connections to the gas regulator too tight. Making the connections too tight may crack the regulator and cause a gas leak. Do not allow the regulator to turn or move when tightening fittings.

- Must include a shut-off valve:

The supply line must be equipped with a manual shut-off valve. This valve should be located in the same room but external to the range opening such as an adjacent cabinet. It should be in a location that allows ease of opening and closing. Do not block access to shut-off valve. The valve is for turning on or shutting off gas to the range.

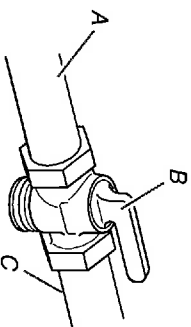

- A. Gas supply line
- B. Shut-off valve "open" position
- C. To range

## PRODUCT DIMENSIONS

30" (76.2 cm) models

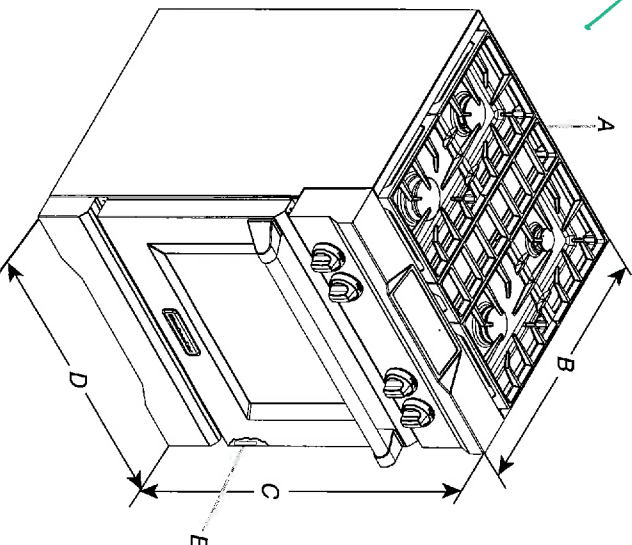

- A. Optional backguard may be installed.
- B. 27 3/4" (70.5 cm) depth with control panel (See NOTE)
- C. 35 3/4" (90.8 cm) cooktop height when sitting on the wheels
- D. 30" (76.2 cm) width
- E. Model/serial/rating plate location

PRODUCT DIMENSIONS CONTINUED

36" (91.4 cm) models

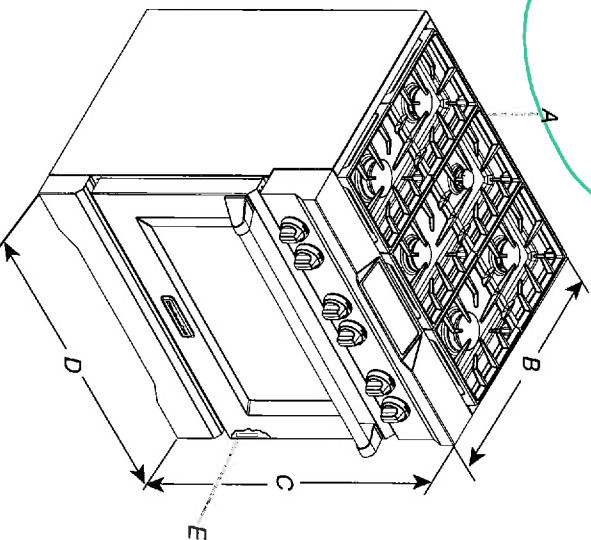

- A. Optional backguard may be installed.
- B. 27<sup>3</sup>/<sub>4</sub>" (70.5 cm) depth with control panel (See NOTE)
- C. 35<sup>3</sup>/<sub>4</sub>" (90.8 cm) cooktop height when sitting on the wheels
- D. 36" (91.4 cm) width
- E. Model/serial/rating plate location

48" (121.9 cm) models

NOTE: The following illustration is for dimension planning purposes only, and the locations and appearances of the features shown may not match those of your model.

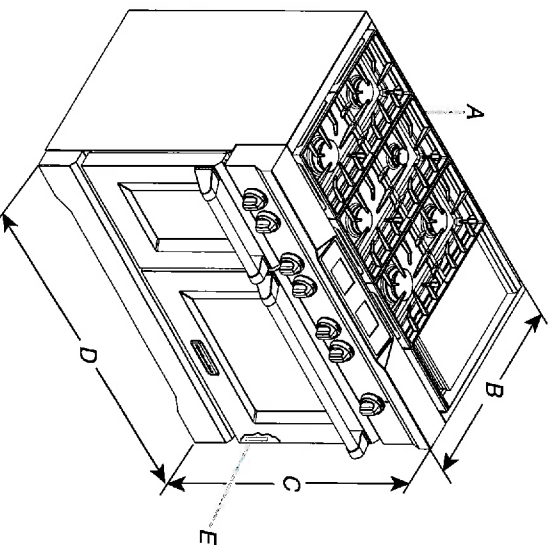

- A. Optional backguard may be installed.
- B. 27<sup>3</sup>/<sub>4</sub>" (70.5 cm) depth with control panel (See NOTE)
- C. 35<sup>3</sup>/<sub>4</sub>" (90.8 cm) cooktop height when sitting on the wheels
- D. 48" (121.9 cm) width
- E. Model/serial/rating plate location

NOTE: When installed in a 24" (61.0 cm) base cabinet with 25" (63.5 cm) countertop, front of oven door protrudes 1<sup>1</sup>/<sub>8</sub>" (4.8 cm) beyond 24" (61.0 cm) base cabinet.

CABINET DIMENSIONS

Cabinet opening dimensions shown are for 25" (64.0 cm) countertop depth, 24" (61.0 cm) base cabinet depth, and 36" (91.4 cm) countertop height. Dimensions must be met in order to ensure a flush fit to back wall.

IMPORTANT: If installing a range hood or hood liner above the range, follow the range hood or hood liner installation instructions for dimensional clearances above the cooktop surface.

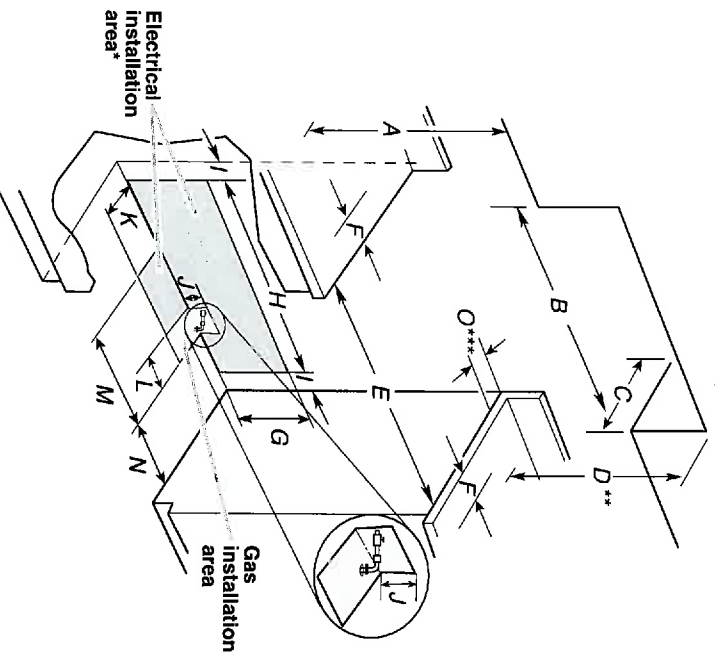

- A. 18" (45.7 cm) upper cabinet to countertop
- B. 30" (76.2 cm) model: 30" (76.2 cm) min. upper cabinet width
- C. 36" (91.4 cm) model: 36" (91.4 cm) min. upper cabinet width
- D. 48" (121.9 cm) model: 48" (121.9 cm) min. upper cabinet width
- E. 33" (83 cm) max. upper cabinet depth
- F. For minimum clearance to top of range\*\*
- G. 30 1/4" (76.8 cm) on 30" (76.2 cm) models
- H. 36 1/4" (92.1 cm) on 36" (91.4 cm) models
- I. 48 1/4" (122.6 cm) on 48" (121.9 cm) models
- J. 6" (15.2 cm) min. clearance from both sides of range to side wall or other combustible material
- K. 15" (38.1 cm)
- L. 22" (55.9 cm) on 30" (76.2 cm) models
- M. 28" (71.1 cm) on 36" (91.4 cm) models
- N. 40" (101.6 cm) on 48" (121.9 cm) models
- O. 1 1/2" (3.8 cm)
- P. 3" (7.6 cm)
- Q. 5" (12.7 cm)
- R. 6" (15.2 cm) on 30" (76.2 cm) models
- S. 14" (35.5 cm) on 36" (91.4 cm) models
- T. 24" (61.0 cm) on 48" (121.9 cm) models
- U. 10 1/2" (26.7 cm)

\* Receptacle must be rotated 90° for Canadian installation.

Minimum Clearances

30" (76.2 cm) models: 30" (76.2 cm) minimum clearance between the top of the cooking platform and the bottom of an uncovered wood or metal cabinet

36" (91.4 cm) models: 42" (106.7 cm) minimum clearance between the top of the cooking platform and the bottom of an uncovered wood or metal cabinet

48" (121.9 cm) models: 42" (106.7 cm) minimum clearance between the top of the cooking platform and the bottom of an uncovered wood or metal cabinet

165 INN



# KitchenAid® Bottom Mount Built-in Refrigerator

FOR THE WAY IT'S MADE.™

## PRODUCT MODEL NUMBERS

KBBL206E	KBBR306E	KBFN502E
KBBL306E	KBFN402E	KBFN506E
KBBR206E	KBFN406E	

**IMPORTANT:** Observe all governing codes and ordinances.

**Electrical:** A 115 Volt, 60 Hz., AC only 15- or 20-amp fused, grounded electrical supply is required. It is recommended that a separate circuit serving only your refrigerator be provided. Use an outlet that cannot be turned off by a switch. Do not use an extension cord.

A grounded 3 prong electrical outlet should be placed within 4' (10.2 cm) of the right side cabinets or end panel.

**Location:** Do not install in a location where the temperature will fall below 55°F (13°C). It is recommended that you do not install the refrigerator near an oven, radiator, or other heat source.

■ Floor must support the refrigerator weight, more than 600 lbs. (272 kg), door panels, and contents of the refrigerator.

■ Ceiling height must allow for side tipping radius. See "Tipping Radius."

■ Location should permit door to open fully. See "Door Swing Dimensions."

■ Location must permit top grille removal. See "Opening Dimensions."

### Water Supply:

A cold water supply with water pressure between 30 and 120 psi (207 and 827 kPa) is required to operate the water dispenser and ice maker. If you have questions about your water pressure, call a licensed, qualified plumber.

### Reverse Osmosis Water Supply

**IMPORTANT:** The pressure of the water supply coming out of a reverse osmosis system going to the water inlet valve of the refrigerator needs to be between 30 and 120 psi (207 and 827 kPa).

■ All installations must meet local plumbing code requirements.

■ The water shutoff should be located in the base cabinet on either side of the refrigerator or some other easily accessible area. The right-hand side is recommended. The access hole through the cabinet must be within ½" (12.7 mm) of the rear wall.

**NOTE:** If the water shutoff valve is in the back wall behind the refrigerator, it must be at an angle so that the tube is not kinked when the refrigerator is pushed into its final location.

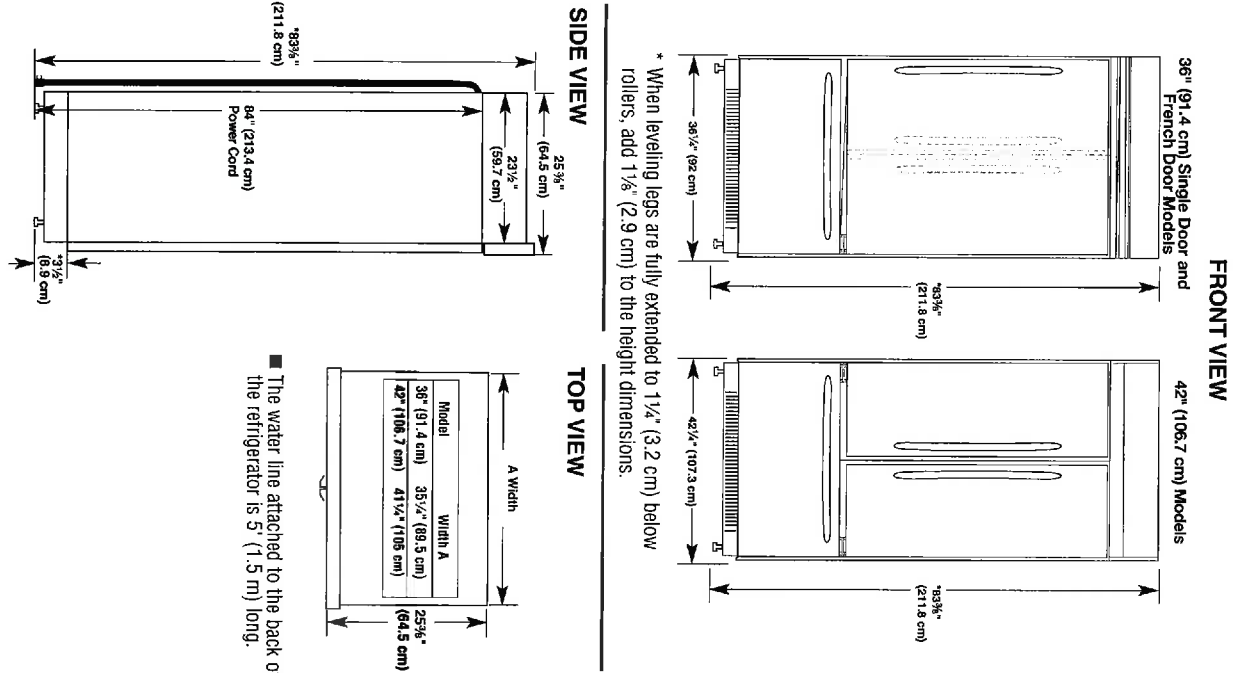
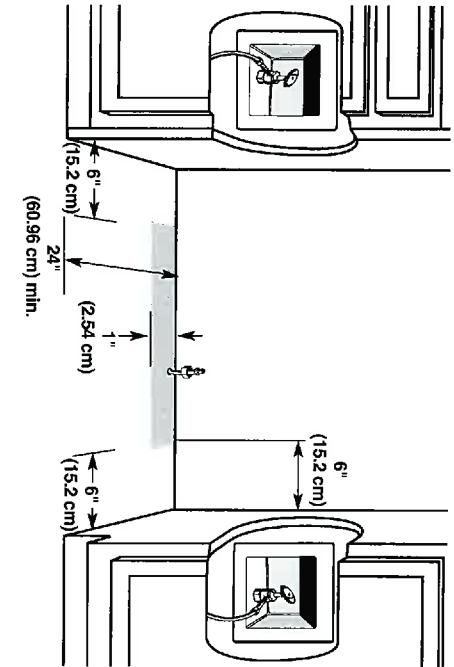

## PRODUCT DIMENSIONS

■ Height dimensions are shown with the leveling legs extended to 1/8" (3 mm) below the rollers.

■ Width dimensions were measured from trim edge to trim edge.

### FRONT VIEW

36" (91.4 cm) Single Door and French Door Models

42" (106.7 cm) Models

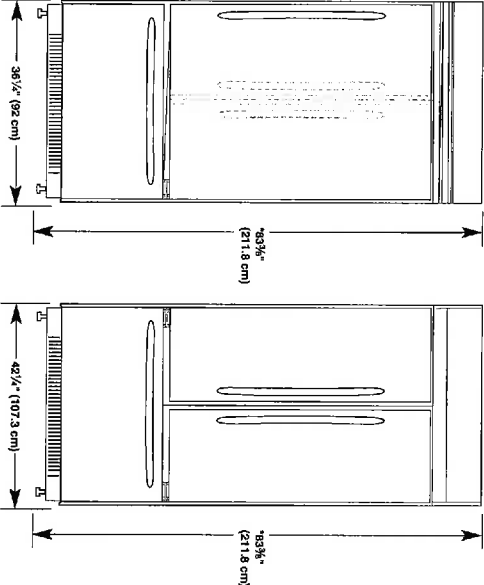

\* When leveling legs are fully extended to 1/4" (3.2 cm) below rollers, add 1 5/8" (2.9 cm) to the height dimensions.

### SIDE VIEW

### TOP VIEW

A Width		Width A		25%* (64.5 cm)	
Model					
36" (91.4 cm)		35 1/2" (89.5 cm)			
42" (106.7 cm)		41 1/2" (105 cm)			

■ The water line attached to the back of the refrigerator is 5" (12.7 cm) long.

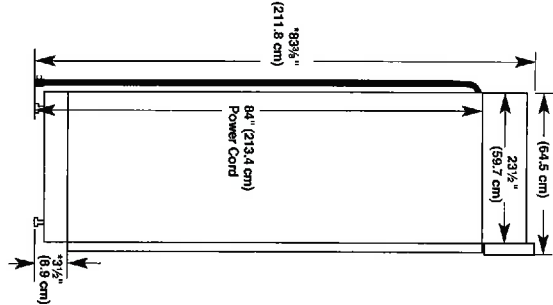

A Width		Width A		25%* (64.5 cm)	
Model					
36" (91.4 cm)		35 1/2" (89.5 cm)			
42" (106.7 cm)		41 1/2" (105 cm)			

A Width		Width A		25%* (64.5 cm)	
Model					
36" (91.4 cm)		35 1/2" (89.5 cm)			
42" (106.7 cm)		41 1/2" (105 cm)			

A Width		Width A		25%* (64.5 cm)	
Model					
36" (91.4 cm)		35 1/2" (89.5 cm)			
42" (106.7 cm)		41 1/2" (105 cm)			

A Width		Width A		25%* (64.5 cm)	
Model					
36" (91.4 cm)		35 1/2" (89.5 cm)			
42" (106.7 cm)		41 1/2" (105 cm)			

A Width		Width A		25%* (64.5 cm)	
Model					
36" (91.4 cm)		35 1/2" (89.5 cm)			
42" (106.7 cm)		41 1/2" (105 cm)			

A Width		Width A		25%* (64.5 cm)	
Model					
36" (91.4 cm)		35 1/2" (89.5 cm)			
42" (106.7 cm)		41 1/2" (105 cm)			

A Width		Width A		25%* (64.5 cm)	
Model					
36" (91.4 cm)		35 1/2" (89.5 cm)			
42" (106.7 cm)		41 1/2" (105 cm)			

A Width		Width A		25%* (64.5 cm)	
Model					
36" (91.4 cm)		35 1/2" (89.5 cm)			
42" (106.7 cm)		41 1/2" (105 cm)			

A Width		Width A		25%* (64.5 cm)	
Model					
36" (91.4 cm)		35 1/2" (89.5 cm)			
42" (106.7 cm)		41 1/2" (105 cm)			

A Width		Width A		25%* (64.5 cm)	
Model					
36" (91.4 cm)		35 1/2" (89.5 cm)			
42" (106.7 cm)		41 1/2" (105 cm)			

A Width		Width A		25%* (64.5 cm)	
Model					
36" (91.4 cm)		35 1/2" (89.5 cm)			
42" (106.7 cm)		41 1/2" (105 cm)			

A Width		Width A		25%* (64.5 cm)	
Model					
36" (91.4 cm)		35 1/2" (89.5 cm)			
42" (106.7 cm)		41 1/2" (105 cm)			

A Width		Width A		25%* (64.5 cm)	
Model					
36" (91.4 cm)		35 1/2" (89.5 cm)			
42" (106.7 cm)		41 1/2" (105 cm)			

A Width		Width A		25%* (64.5 cm)	
Model					
36" (91.4 cm)		35 1/2" (89.5 cm)			
42" (106.7 cm)		41 1/2" (105 cm)			

A Width		Width A		25%* (64.5 cm)	
Model					
36" (91.4 cm)		35 1/2" (89.5 cm)			
42" (106.7 cm)		41 1/2" (105 cm)			

A Width		Width A		25%* (64.5 cm)	
Model					
36" (91.4 cm)		35 1/2" (89.5 cm)			
42" (106.7 cm)		41 1/2" (105 cm)			

A Width		Width A		25%* (64.5 cm)	
Model					
36" (91.4 cm)		35 1/2" (89.5 cm)			
42" (106.7 cm)		41 1/2" (105 cm)			

A Width		Width A		25%* (64.5 cm)	
Model					
36" (91.4 cm)		35 1/2" (89.5 cm)			
42" (106.7 cm)		41 1/2" (105 cm)			

A Width		Width A		25%* (64.5 cm)	
Model					
36" (91.4 cm)		35 1/2" (89.5 cm)			
42" (106.7 cm)		41 1/2" (105 cm)			

A Width		Width A		25%* (64.5 cm)	
Model					
36" (91.4 cm)		35 1/2" (89.5 cm)			
42" (106.7 cm)		41 1/2" (105 cm)			

A Width		Width A		25%* (64.5 cm)	
Model					
36" (91.4 cm)		35 1/2" (89.5 cm)			
42" (106.7 cm)		41 1/2" (105 cm)			

A Width		Width A		25%* (64.5 cm)	
Model					
36" (91.4 cm)		35 1/2" (89.5 cm)			
42" (106.7 cm)		41 1/2" (105 cm)			

A Width		Width A		25%* (64.5 cm)	
Model					
36" (91.4 cm)		35 1/2" (89.5 cm)			
42" (106.7 cm)		41 1/2" (105 cm)			

A Width		Width A		25%* (64.5 cm)	
Model					
36" (91.4 cm)		35 1/2" (89.5 cm)			
42" (106.7 cm)		41 1/2" (105 cm)			

A Width		Width A		25%* (64.5 cm)	
Model					
36" (91.4 cm)		35 1/2" (89.5 cm)			
42" (106.7 cm)		41 1/2" (105 cm)			

A Width		Width A		25%* (64.5 cm)	
Model					
36" (91.4 cm)		35 1/2" (89.5 cm)			
42" (106.7 cm)		41 1/2" (105 cm)			

A Width		Width A		25%* (64.5 cm)	
Model					
36" (91.4 cm)		35 1/2" (89.5 cm)			
42" (106.7 cm)		41 1/2" (105 cm)			

A Width		Width A		25%* (64.5 cm)	
Model					
36" (91.4 cm)		35 1/2" (89.5 cm)			
42" (106.7 cm)		41 1/2" (105 cm)			

A Width		Width A		25%* (64.5 cm)	
Model					
36" (91.4 cm)		35 1/2" (89.5 cm)			
42" (106.7 cm)		41 1/2" (105 cm)			

A Width		Width A		25%* (64.5 cm)	
Model					
36" (91.4 cm)		35 1/2" (89.5 cm)			
42" (106.7 cm)		41 1/2" (105 cm)			

A Width		Width A		25%* (64.5 cm)	
Model					
36" (91.4 cm)		35 1/2" (89.5 cm)			
42" (106.7 cm)		41 1/2" (105 cm)			

A Width		Width A		25%* (64.5 cm)	
Model					
36" (91.4 cm)		35 1/2" (89.5 cm)			
42" (106.7 cm)		41 1/2" (105 cm)			

A Width		Width A		25%* (64.5 cm)	
Model					
36" (91.4 cm)		35 1/2" (89.5 cm)			
42" (106.7 cm)		41 1/2" (105 cm)			

A Width		Width A		25%* (64.5 cm)	
Model					
36" (91.4 cm)		35 1/2" (89.5 cm)			
42" (106.7 cm)		41 1/2" (105 cm)			

A Width		Width A		25%* (64.5 cm)	
Model					
36" (91.4 cm)		35 1/2" (89.5 cm)			
42" (106.7 cm)		41 1/2" (105 cm)			

A Width		Width A		25%* (64.5 cm)	
Model					
36" (91.4 cm)		35 1/2" (89.5 cm)			
42" (106.7 cm)		41 1/2" (105 cm)			

A Width		Width A		25%* (64.5 cm)	
Model					
36" (91.4 cm)		35 1/2" (89.5 cm)			
42" (106.7 cm)		41 1/2" (105 cm)			

A Width		Width A		25%* (64.5 cm)	
Model					
36" (91.4 cm)		35 1/2" (89.5 cm)			
42" (106.7 cm)		41 1/2" (105 cm)			

A Width		Width A		25%* (64.5 cm)	
Model					
36" (91.4 cm)		35 1/2" (89.5 cm)			
42" (106.7 cm)		41 1/2" (105 cm)			

The water line attached to the back of the refrigerator is 5' (1.5 m) long.

OPENING DIMENSIONS

To avoid tipping during use, the solid soffit must be within 1" (2.5 cm) maximum above the refrigerator. If the solid soffit is higher than 1" (2.5 cm) or one is not available, then the refrigerator must be braced.

If anti-tip boards are needed, they must be installed to the rear wall studs so that the bottom of the anti-tip board is 84" (213.4 cm) from the floor.

**NOTE:** Do not remove the foam gasket on top of the compressor cover unless removal is necessary to fit the unit under a soffit. Removal of the gasket will cause loss in cooling efficiency.

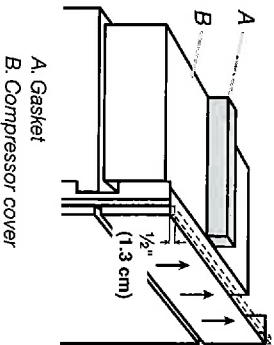

**NOTE:** If installing under a solid soffit, after installation raise the leveling legs so that the gasket is pressed snugly against the soffit.

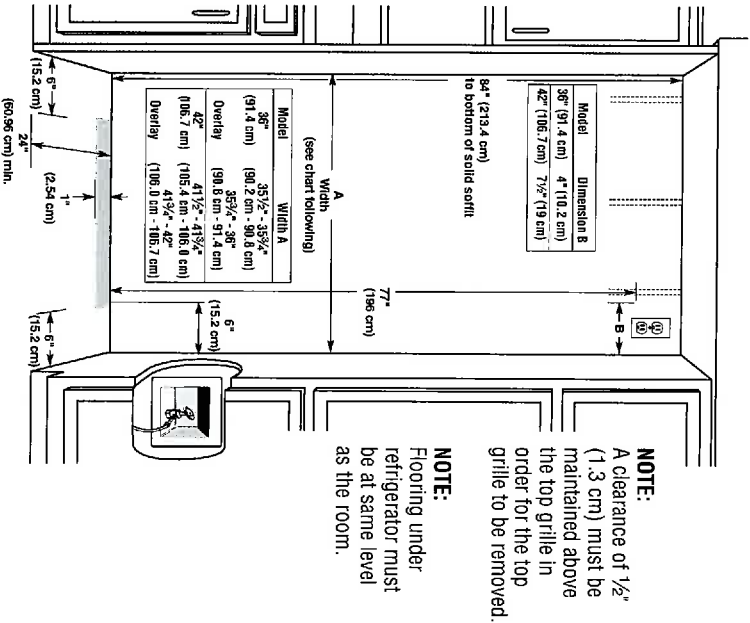

TIPPING RADIUS

Be sure there is adequate ceiling height to stand the refrigerator upright when it is moved into place.

- The dolly wheel height must be added to the tipping radius when a dolly is used.
- If needed, the tipping radius can be reduced. See "Reduce Tipping Radius."

Side Tipping Radius (36" [91.4 cm] Models)

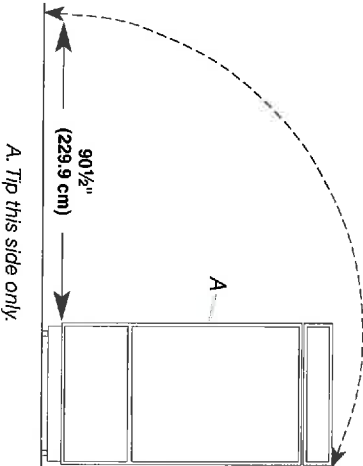

Side Tipping Radius (42" [106.7 cm] Models)

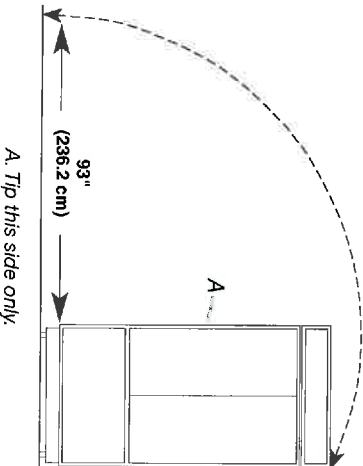

FOR THE WAY IT'S MADE.  
Under

## PRODUCT DIMENSIONS

KDTE104D, KDFE304D, KDTE204D, KOTE404D, KDTE704D,  
KOTM354D, KDFE204E, KDFE454C, KDTE104E, KDTE204E,  
KDTE254E, KOTM354E, KOTM384E, KOTM404E, KOTM504E,  
KOTM704E, KOTM804E

**Electrical Requirements:** 120-volt, 60 Hz, AC-only, 15- or 20-amp, fused electrical supply. Copper wire only. A time delay fuse or circuit breaker and separate circuit is recommended.

**If direct wiring dishwasher:** Use flexible, armored or nonmetallic, sheathed copper wire with grounding wire that meets the wiring requirements for your home and local codes and ordinances.

**Use a UL Listed or CSA Approved conduit connector.**  
**If connecting dishwasher with a power supply cord:**

Use power supply cord kit (Part Number 4317824) marked for use with dishwashers. Follow the kit instructions for installing the power supply cord. Power supply cord must plug into a grounded 3 prong outlet located in the cabinet next to the dishwasher opening. Outlet must meet all local codes and ordinances.

**Water Supply Requirements:** A hot water line with 20 to 120 psi (138 to 862 kPa) water pressure. Water temperature must be 120°F (49°C) water at dishwasher. Use 3/8" O.D. copper tubing with compression fitting or flexible braided water supply line

**Note:**  $\frac{1}{2}$ " minimum plastic tubing is not recommended.

Use a 90° elbow with  $\frac{3}{4}$ " hose connection with rubber washer (Part Number W10273460). Do not solder within 6" (15.2 cm) from water inlet valve.

**Drain Requirements**—A new drain hose is supplied with your dishwasher. If this is not long enough, use a new drain hose with a maximum length of 12' (3.7 m) (Part Number 3385556) that meets all current AHAM/APMO test standards, is resistant to heat and detergent, and fits the 1" (2.5 cm) drain connector of the dishwasher.



air gap

Use 1/2" (1.3 cm) minimum I.D. drain line fittings.

If required, the air gap should be installed in accordance with the air gap installation instructions. When connecting the air gap, a rubber hose (not provided) will be needed to connect to the waste tee or disposer inlet.

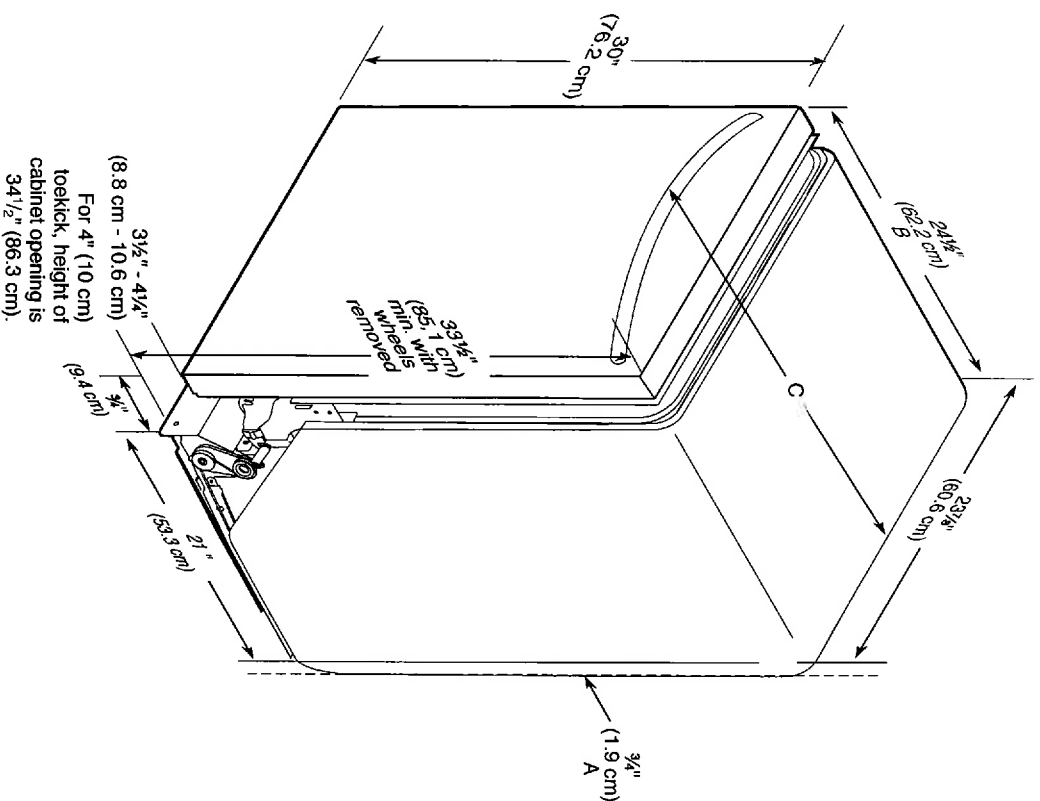
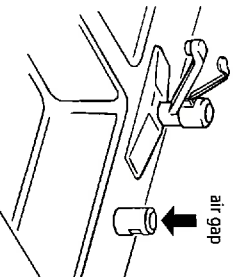

- A. Insulation may be compressed (not used on all models).
- B. For panel-ready models, dishwasher depth is 24" (60 cm) not including the  $\frac{3}{4}$ " (1.9 cm) custom door panel.
- C. Door handles may protrude forward of the face of the dishwasher; varies by model.

Because Whirlpool Corporation policy includes a continuous commitment to improve our products, we reserve the right to change materials and specifications without notice.

Dimensions are for planning purposes only. For complete details, see Installation Instructions packed with product. Specifications subject to change without notice.

W1074197A-D-KA  
12/16

## CABINET CUTOUT DIMENSIONS

**NOTE:** Shaded areas of cabinet walls show where utility connections may be installed.

\*Measure from the lowest point on the underside of the countertop. May be reduced to 33½" (85.1 cm) be removing the rear leveling legs from dishwasher.

**\*\*Minimum, measured from narrowest point of opening.**

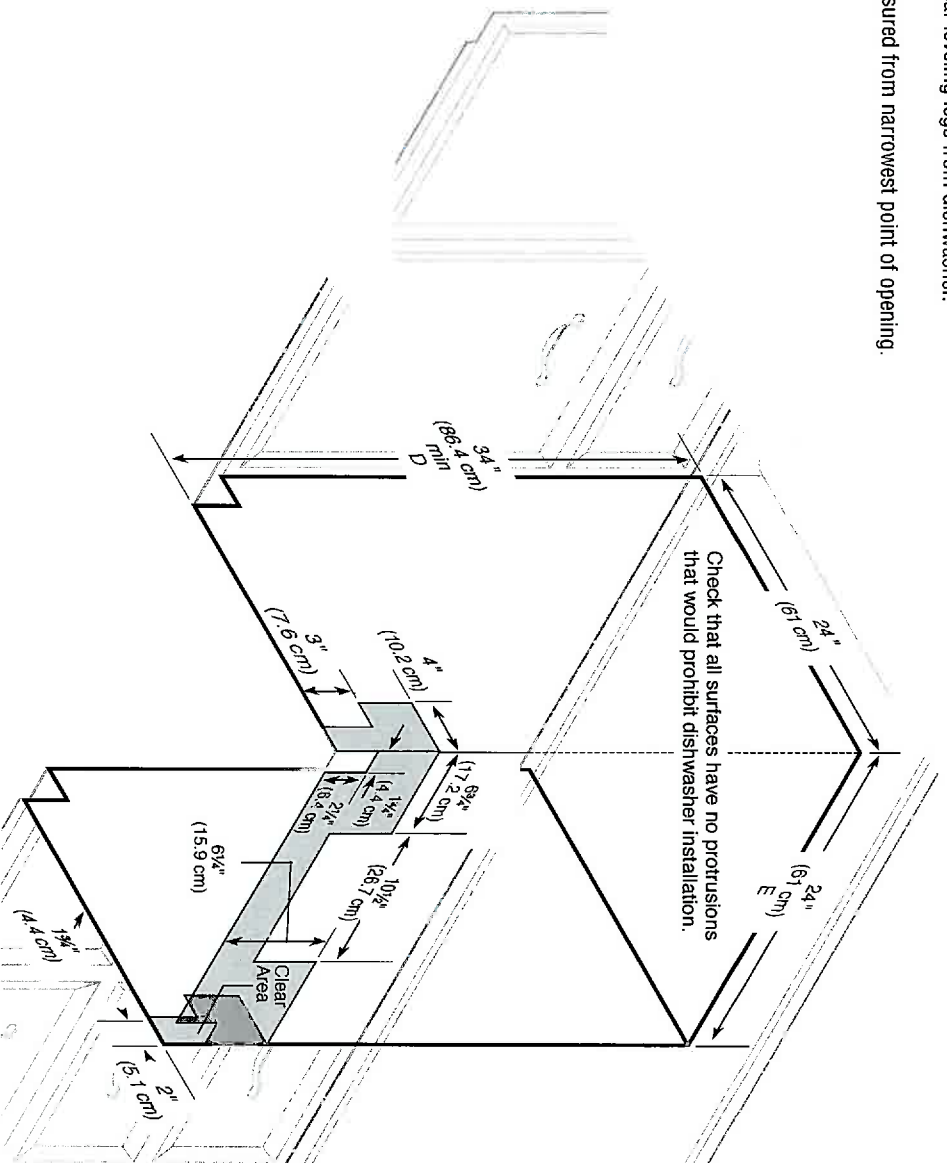

165/22