



CONSTRUCTION SUMMARY

Belle Aire Shores - Zancor Homes (Innisfil) Ltd.

PURCHASER: INVENTORY

TEL: RES.: 416-8437

| LOT / PHASE | HOUSE TYPE | PRINT DATE |
|-------------|---------------------------|------------|
| 141 / 1 | CUNNINGHAM (36-04) ELEV B | 11-Oct-17 |

| Ref# | Quantity - Description | Approved | Notes |
|---|--|----------|--|
| 2400 | BONUS: Granite kitchen countertops with undermount sink 3 Piece stainless steel appliances with white top loading washer and dryer Stainless steel under cabinet hood fan Extended uppers in kitchen (39-1/2") BBQ Gas line | 28Apr17 | |
| 2401 | BONUS: Air Conditioning (42ft and 50ft lots ONLY) 9ft main floor ceilings, 8ft ceilings on second floor 3-1/4 inch by ¾ inch natural prefinished engineered hardwood on main floor in non-tiled areas, excludes bedrooms Natural finished oak stair | 28Apr17 | |
| 2402 | TRAY CEILING IN MASTER ENSUITE **INCLUDES SMOOTH FINISH | 26May17 | |
| 2403 | 4.00 - LARGER BASEMENT WINDOWS 30 X 24 | 26May17 | |
| 2650 | NO GARAGE MAIN DOOR DUE TO GRADE | 26May17 | INSTALL GARAGE MAIN DOOR WITH DECK AND STEPS. HOMEOWNER IS AWARE THAT THEY MAY LOSE A PARKING SPACE. |
| 26May17 Note: INSTALL GARAGE MAIN DOOR WITH DECK AND STEPS. HOMEOWNER IS AWARE THAT THEY MAY LOSE A PARKING SPACE. | | | |
| 5137 | ELECTRICAL - LED POTLIGHTS MAIN FLOOR (4) MAIN HALL, DELETE STD (7) GREAT ROOM, DELETE STD (4) DINING ON SEP SWITCH, STD REMAINS (5) KITCHEN, DELETE STD (2) OVER KITCHEN ISLAND ON SEP SWITCH | 27Sep17 | |
| 5138 | ELECTRICAL - LED POTLIGHTS 2ND FLOOR (7) UPPER HALL, DELETE STD (4) MASTER BED SEP SWITCH, STD TO REMAIN | 27Sep17 | |
| 5139 | ELECTRICAL - CAPPED LIGHT WITH SEP SWITCH OVER TUB IN MASTER ENSUITE | 27Sep17 | |
| 5140 | FRAMELESS GLASS SHOWER IN MASTER ENSUITE | 27Sep17 | |
| 5141 | SMOOTH CEILINGS THROUGHOUT | 27Sep17 | |
| 5223 | CABINETRY - KITCHEN - UPGRADE 2 MASTER ENSUITE - UPGRADE 1 TWIN BATH - UPGRADE 1 | 11Oct17 | |
| 5224 | PLUMBING - BLANCO STELLAR UI-3/4 UNDERMOUNT SINK | 11Oct17 | |
| 5225 | TILE - KITCHEN BACKSPLASH *BRICK PATTERN - UPGRADE 5 | 11Oct17 | |
| 5226 | TILE - UPGRADE 4 FOYER POWDER ROOM KITCHEN/BREAKFAST LAUNDRY @ SECOND FLOOR | 11Oct17 | |
| 5227 | TILE - MASTER ENSUITE FLOOR UPGRADE 4 MASTER SHOWER WALL UPGRADE 3 *BRICK TWIN BATH FLOOR UPGRADE 4 TWIN TUB WALL UPGRADE 4 *BRICK | 11Oct17 | |



CONSTRUCTION SUMMARY

PURCHASER: **INVENTORS** Belle Aire Shores - Zancor Homes (Innisfil) Ltd.

TEL: RES.: 416-8437

| LOT / PHASE | HOUSE TYPE | PRINT DATE |
|-------------|---------------------------|------------|
| 141 / 1 | CUNNINGHAM (36-04) ELEV B | 11-Oct-17 |

| Ref# | Quantity - Description | Approved | Notes |
|------|--|----------|-------|
| 5228 | HARDWOOD - UPGRADE 4 DINING GREAT ROOM MAIN HALL UPPER HALL IN LIEU OF CARPET | 11Oct17 | |
| 5229 | STAIN STAIRS TO MATCH HARDWOOD AS CLOSE AS POSSIBLE | 11Oct17 | |
| 5231 | CARPET - UPGRADE 1 ON SECOND FLOOR | 11Oct17 | |
| 5232 | COUNTERTOPS - KITCHEN - UPGRADE 4 | 11Oct17 | |
| 5233 | CABINETS - KITCHEN POTS & PANS DRAWERS 2 PLAIN GLASS DOORS WITH MATCHING INTERIOR DEEP UPPERS WITH GABLES CROWN MOULDING | 11Oct17 | |
| | | 11Oct17 | |
| 5235 | PLUMBING - UPGRADED BATHROOM ACCESSORIES IN LIEU OF STANDARD WHITE CERAMIC POWDER MASTER TWIN | 11Oct17 | |
| 5236 | PLUMBING - UPGRADE KITCHEN FAUCET MOEN BRANTFORD 7185 | 11Oct17 | |

This Document is Extremely Time Sensitive - Printed 11 Oct 17 at 15:25

CABINETRY / COUNTERTOPS

FOR TRADE USE

to installation,

OCT 10 2017

ZANCOR HOMES COLOUR CHART

| STAIRS, RAILING & PICKETS & STAIR STAIN | | | |
|--|---|------------------------|-------------------|
| Stair Stain / Species: | STAIN STAIRS TO MATCH AS CLOSE AS POSSIBLE | | |
| White Paint Req'd | N/A | | |
| Main to 2nd Railing Details: | STANDARD TURNED OAK | | |
| Main to Basement Railing Details: | N/A | | |
| TRIM | | | |
| Casing/Baseboards | STANDARD | | |
| Interior Doors | STANDARD | | |
| Interior Door Hardware | STANDARD | | |
| Exterior Door Hardware | STANDARD | | |
| PAINT | | | |
| Kitchen/Breakfast | WARM GREY | Master Beds | WARM GREY |
| Main Floor | WARM GREY | Bedroom 2 | WARM GREY |
| Dining Room | WARM GREY | Bedroom 3 | WARM GREY |
| Great room | WARM GREY | Loft -2nd Floor | WARM GREY |
| Upper Hall | WARM GREY | Master Ens. | WARM GREY |
| Powder Room | WARM GREY | Twin Bath | WARM GREY |
| Laundry - 2nd Floor | WARM GREY | | |
| PLUMBING- UPGRADES TO BE DETAILED ON PES | | | |
| Kitchen | FIXTURES | FAUCETS | NOTES |
| Powder Room | UPGRADED | UPGRADED | |
| Master Ensuite | STANDARD | STANDARD | |
| Twin Bath | STANDARD | STANDARD | |
| ZANCOR APPLIANCE REQUIREMENTS-UPGRADES TO BE DETAILED ON PES | | | |
| Appliance Package received in 'Schedule E' | | YES / NO Package Name: | |
| GAS LINE | UPG (SEE PES) | DECLINED | NOTES |
| WATERLINE to Fridge | NO | NO | |
| Hood Fan Venting SIZE | NO | NO | |
| ELECTRICAL for Built-in Oven | YES 6" | NO | BUILDERS STANDARD |
| ELECTRICAL for Built-in Micro / OTR | NO | NO | |
| ELECTRICAL for Gas Stove / Cooktop | NO | NO | |
| ELECTRICAL for Bar Fridge | NO | NO | |
| DISCLAIMER | | | |
| Colours of all materials are as close as possible to Builders selection but not necessarily identical due to dye lot variances in manufacturing/manufacturers. Due to construction progress some items may have been pre-selected or installed. In this event the Vendor's selection must be accepted by the purchaser | | | |
| Any changes to the colour chart after signing are subject to a \$50000 administration fee plus costs | | | |
| Purchaser has checked and acknowledged accuracy of colour and selections before signing. | | | |
| SITE: | INNISFIL | LOT: 141 | |
| PURCHASER(S): | INVENTORY | | |
| HOME #/CELL # | | | |
| EMAIL: | | | |
| DÉCOR NOTES | <div> <div>Purchaser Signature</div> <div>Date</div> </div> | | |
| <div> <div> <div>***FOR TRADE USE***</div> <div>Any upgrades in the colour chart must be accompanied with a PES.</div> </div> <div>  <div> <div>Décor Consultant Signature</div> <div>Date</div> </div> </div> </div> | | | |
| <div> <div>*** PAGE 2 OF 2 ***</div> <div> <div>Vendor Signature</div> <div>Date</div> </div> </div> | | OCT 10 2017 | |

Elevation A 2108 sq.ft.

Elevation B 2081 sq.ft.

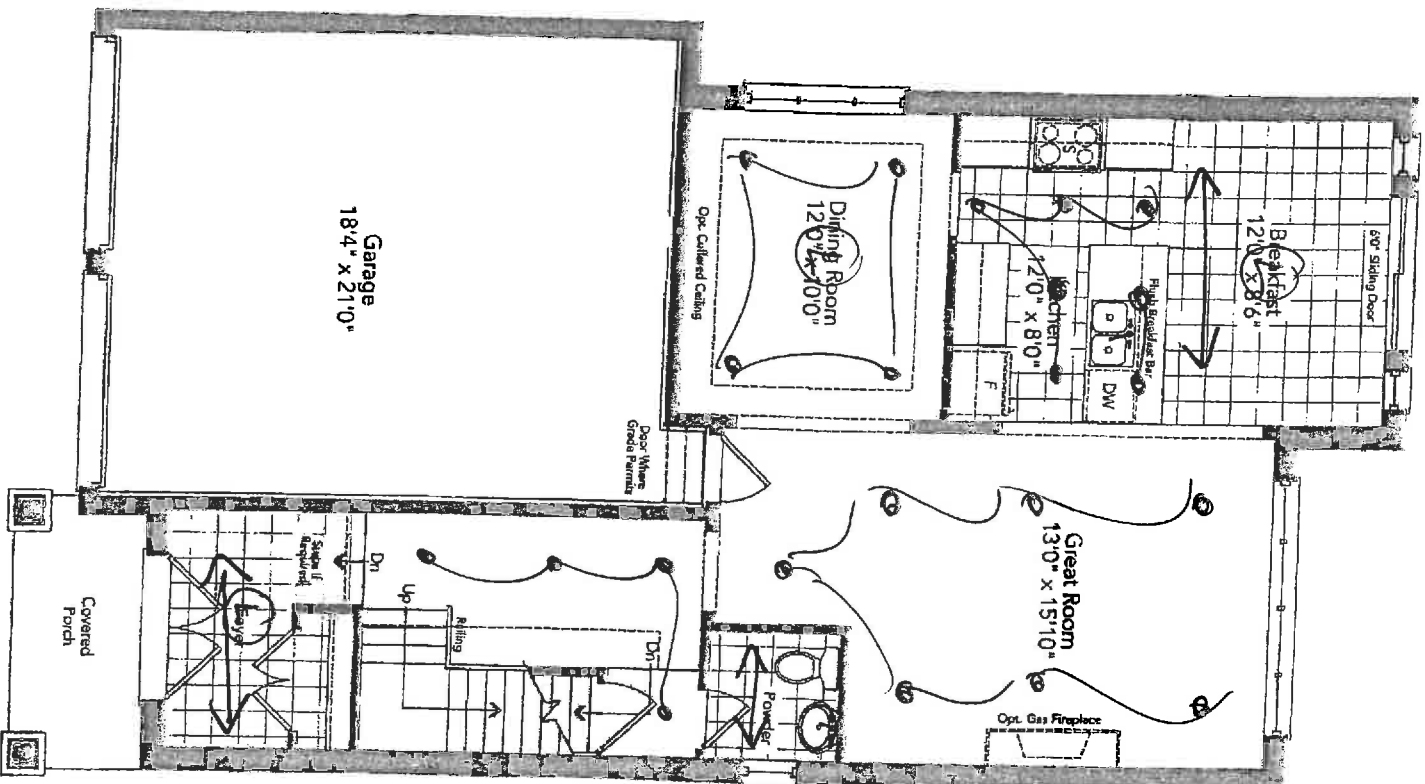

~~Ground Floor~~
~~Elevation A~~

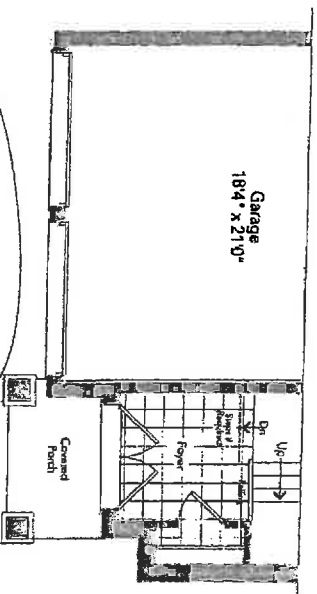

Partial Ground Floor
Elevation B

107

141

(B)

INNISFIL

MODEL: 36-04

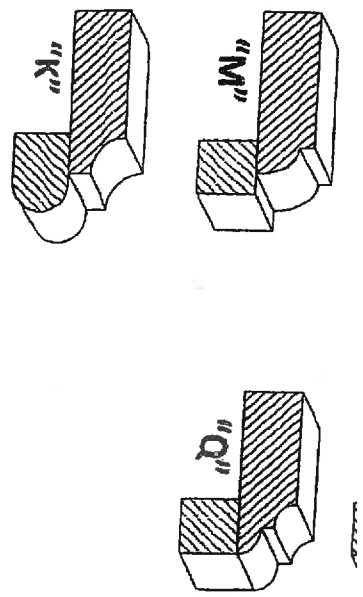
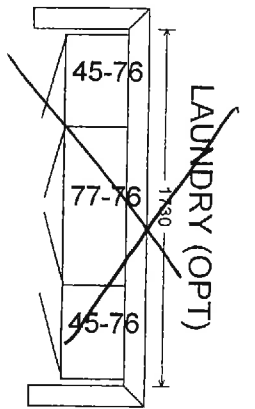
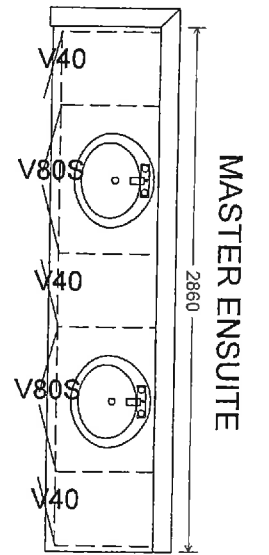
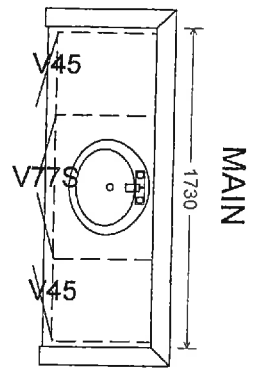
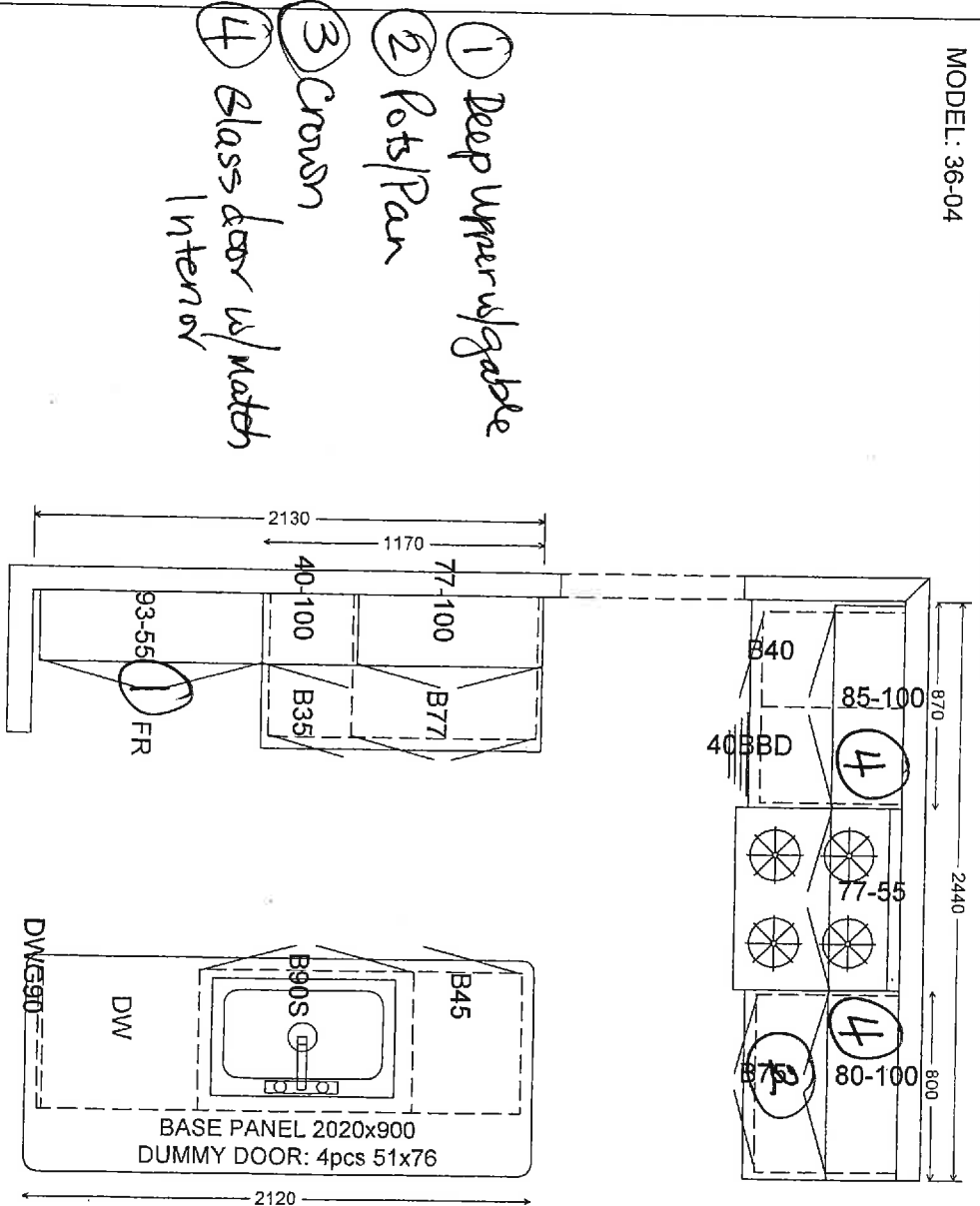

141-INNISFIL
LOT / SITE

PURCHASER SIGNATURE

Butterfly Island



Pik
Standard

MASTER
ENSLAVE

of
Twin

15777

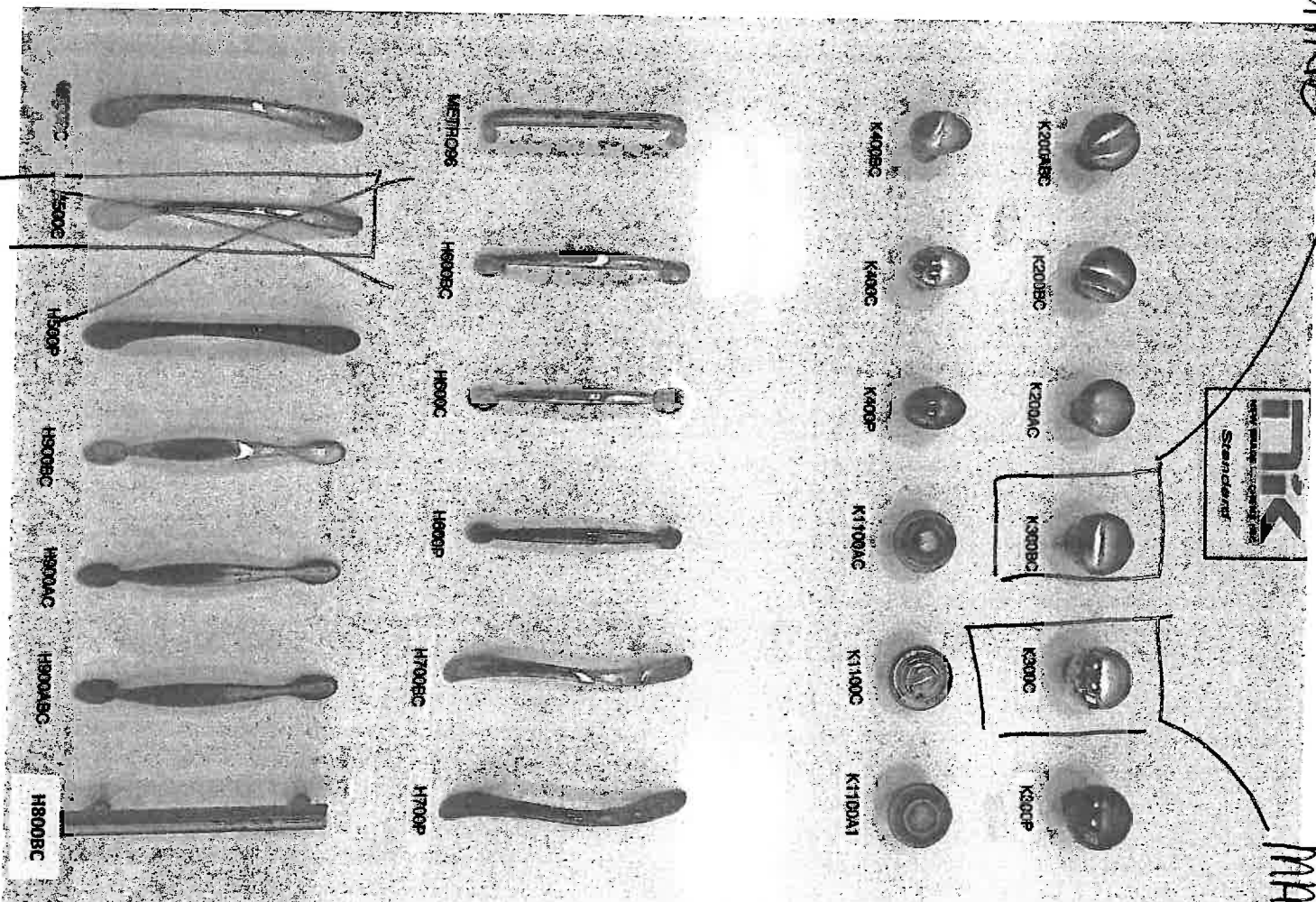

10/11/41
10/10/41

FAUCET

LOT 141
14415AL

Brantford™

Traditional | Transitional | Modern

Like the best decorative appointments, Brantford kitchen faucets make a traditionally styled space feel truly finished with a polished look.

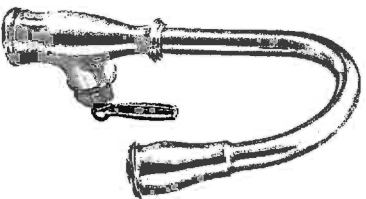

Single Handle Pull-down
Kitchen Faucet **

Model 7185

Chrome -

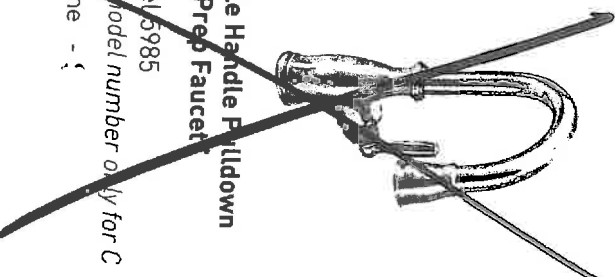

Single Handle Pull-down
Bar/Prep Faucet

Model 6985

Use model number only for C

Chrome -

Other

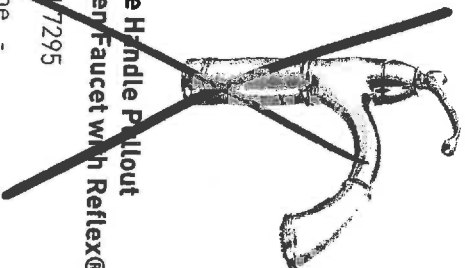

Single Handle Pull-out
Kitchen Faucet with Reflex® ±

Model 7295

Chrome -

Other

FINISH OPTIONS:



To order, combine the model number with one of these finish letter(s):
Chrome (C), Spot Resistant Stainless Steel (SRS) & Oil Rubbed Bronze (ORB).

* Deckplate sold separately - 141002 series

** Deckplate included

± Single hole installation only

BLANCO STELLAR®
Undermount

LOT 141 INULSTEL - X KITCHEN / ISLAND SINK.

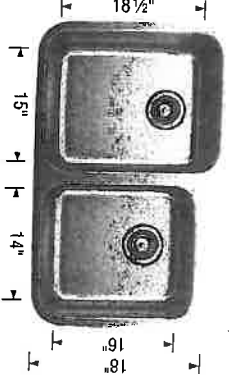
| BLANCO STELLAR® U 1 3/4 | | 401026 | |
|---|-----------------------|----------|-----------------------------|
|  | Sink Specifications | Model N° | Optional Accessories |
| | Undermount | | 406470 Crockery Basket (LB) |
| | Minimum Cabinet Size* | | 406497 Grid (LB) |
| | 36" (915 mm) | | 406496 Grid (SB) |
| | Bowl Depth | | 517666 CapFlow™ |
| | Main 9" (230 mm) | | 230694 Magnetic Caddy |
| | Secondary 7" (178 mm) | | |
| | Cubed Weight | | |
| | 76 lb. (34 Kg) | | |

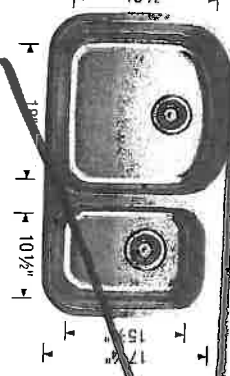
| BLANCO STELLAR® U 1 1/2 | | 401027 | |
|---|-----------------------|----------|-----------------------------|
|  | Sink Specifications | Model N° | Optional Accessories |
| | Undermount | | 406470 Crockery Basket (LB) |
| | Minimum Cabinet Size* | | 406498 Grid (LB) |
| | 36" (915 mm) | | 517666 CapFlow™ |
| | Bowl Depth | | 230694 Magnetic Caddy |
| | Main 9" (230 mm) | | |
| | Secondary 7" (178 mm) | | |
| | Cubed Weight | | |
| | 76 lb. (34 Kg) | | |

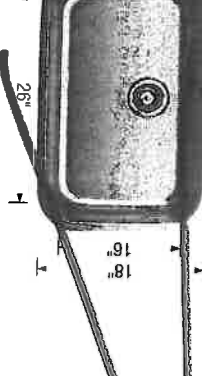
| BLANCO STELLAR® U SUPER SINGLE | | 401028 | |
|---|-----------------------|----------|------------------------|
|  | Sink Specifications | Model N° | Optional Accessories |
| | Undermount | | 406470 Crockery Basket |
| | Minimum Cabinet Size* | | 406499 Grid |
| | 30" (760 mm) | | 517666 CapFlow™ |
| | Bowl Depth | | 230694 Magnetic Caddy |
| | Main 9" (230 mm) | | |
| | Cubed Weight | | |
| | 32 lb. (15 kg) | | |

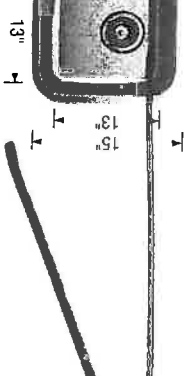
| BLANCO STELLAR® U BAR | | 401029 | |
|---|-----------------------|----------|----------------------|
|  | Sink Specifications | Model N° | Optional Accessories |
| | Undermount | | 517666 CapFlow™ |
| | Minimum Cabinet Size* | | |
| | 18" (455 mm) | | |
| | Bowl Depth | | |
| | Main 9" (230 mm) | | |
| | Cubed Weight | | |
| | 27 lb. (12 kg) | | |

* Depending on cabinet construction, a different cabinet size may be required. Consult the cabinet manufacturer. See page 160 for important installation information.

1945

Moen GENTA Chrome Accessories

In lieu of standard white ceramic accessories

1x Powder Room (Mini Towel Bar & Paperholder)

2x Full Bathrooms (Towel Bar & Paperholder)

Mini Towel Holder BH3886CH

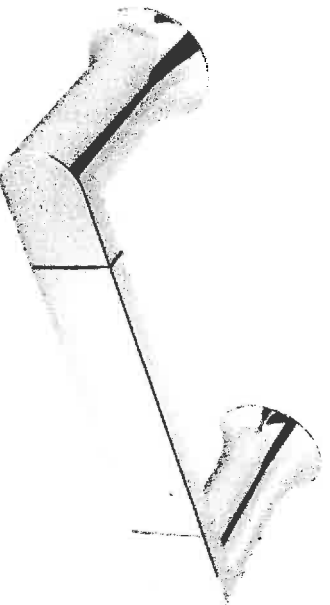

Towel Holder BH3824CH

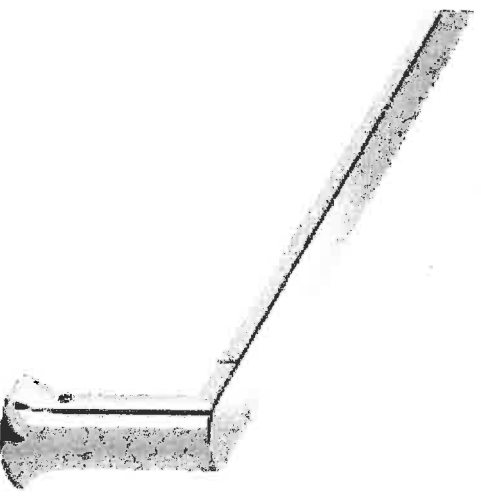

Toilet Paper Holder BH3808CH

