

CONSTRUCTION SUMMARY OF EXTRAS
Printed 2019-05-29 / 2:43 PM / Page 1 of 1

Site:

INNISFIL PHASE 2

Lot:

156N

Model:

GALLEY (36-05) ELEV. A REVISED

Purchaser:

COREY S. BUTLER & VENISSA SOROA BUTLER

Phone/Email:

416-919-5189 / VENISSABUTLER@GMAIL.COM



Appointment:

STRUCTURALS & COLOURS





DESCRIPTION		DATE SELECTED
	SCHEDULE E - 3-1/4 INCH STAINED HARDWOOD ON MAIN FLOOR INCLUDING KITCHEN/BREAKFAST AREA	INCLUDED IN APS
	SCHEDULE E - 3-1/4 INCH STAINED HARDWOOD IN UPPER HALL	INCLUDED IN APS
	SCHEDULE E - 12 X 24 CERAMIC TILE IN ALL TILED AREAS (EXCLUDING KITCHEN)	INCLUDED IN APS
	SCHEDULE E - 5 INCH BASEBOARDS	INCLUDED IN APS
	SCHEDULE E - 3 INCH CASING	INCLUDED IN APS
	SCHEDULE E - STAIN STAIRS	INCLUDED IN APS
	SCHEDULE E - SQUARE OAK PICKETS & POSTS SEE # 13	INCLUDED IN APS
	SCHEDULE E - SMOOTH CEILINGS THROUGHOUT	INCLUDED IN APS
	SCHEDULE E - BACKSPLASH IN KITCHEN FROM BUILDERS STANDARD SAMPLES	INCLUDED IN APS
	SCHEDULE E - KITCHEN TO HAVE STANDARD BANK OF DRAWERS IN ISLAND	INCLUDED IN APS
	SCHEDULE E - GRANITE TOP IN ALL BATHROOMS	INCLUDED IN APS
	SCHEDULE E - GARAGE DOORS TO BE INSTALLED ON ALL GARAGE ENTRIES	INCLUDED IN APS
#2	KITCHEN CABINETS - DISHWASHER PANEL	MAY 15 2019
#3	KITCHEN CABINETS - COOKTOP WITH POT DRAWERS BELOW	MAY 15 2019
#4	KITCHEN CABINETS - BUILT IN WALL OVEN WITH MICROWAVE **ELECTRICAL SOLD SEPARATE	MAY 15 2019
#5	KITCHEN CABINETS - UPGRADE 2	MAY 15 2019
#6	KITCHEN - CABINET - BUILT IN FRIDGE	MAY 15 2019
#7	COUNTERTOP - COOKTOP CUTOUT	MAY 15 2019
#10	ELECTRICAL - KITCHEN APPLIANCES (WALL OVEN, MICRO)	MAY 15 2019
	WALL OVEN 240V/40 AMP; COOKTOPM 120V/15 AMP SEE SPECS	
#11	KITCHEN HANDLES - UPGRADE LIKE MODEL HOME LOT 6 INNISFIL **ALL DOORS TO HAVE HANDLES, ALL DRAWERS TO HAVE KNOBS	MAY 15 2019
#12	KITCHEN CABINET - TWO TONE **ISLAND TO BE DIFFERENT COLOUR	MAY 15 2019
#13	RAILINGS - SINGLE COLLAR ALT DOUBLE **PRICE DIFFERENCE FROM UPGRADE IN DEAL	MAY 15 2019
#14	CARPET - UPGRADE 1	MAY 15 2019
#15	INTERIOR DOORS - 8 FOOT HIGH ON MAIN FLOOR, STANDARD STYLE	MAY 15 2019
#16	INTERIOR DOOR HANDLES - THE WAVE, ORB	MAY 15 2019
#18	GAS LINE TO COOKTOP **INCLUDES 15 AMP PLUG	MAY 15 2019
#19	FRAMELESS GLASS SHOWER IN MASTER ENSUITE	MAY 15 2019
#20	MASTER ENSUITE SHOWER JAMB	MAY 15 2019
#21	PLUMBING MASTER ENSUITE - CHATEAU FAUCET - 8 INCH WIDESPREAD (2 TOTAL)	MAY 15 2019
#22	PLUMBING - KITCHEN FAUCET - MOEN ARBOR MATTE BLACK	MAY 15 2019
#23	PLUMBING - UPGRADE TO RECTANGLE UNDERMOUNT SINKS IN ALL BATHROOMS	MAY 15 2019
#24	KITCHEN - DELETE UPPER FOR FUTURE CHIMNEY **CENTRE VENT	MAY 15 2019
#25	PLUMBING - WATERLINE TO FRIDGE	MAY 15 2019

ZANCOR HOMES COLOUR CHART

CABINETRY / COUNTERTOPS				
	DOOR STYLE	HARDWARE	COUNTERTOP	EDGE
Kitchen	ALGONQUING MDF - ALMOND (2)	UPGRADE	TAN BROWN GRANITE	
Island	ALGONQUING MDF - ESPRESSO PAINT (2)	UPGRADE	TAN BROWN GRANITE	
Powder Room	N/A		N/A	
Master Ensuite	SLAB MEL - CHOCOLATE BROWN	H800BC	NOBLE GREY MARBLE (1)	
Ensuite 4	SLAB OAK - MAYFLOWER BROWN STAIN	K1100AC	PERLATO MARBLE (1)	
Twin 2/3	SLAB OAK - MAYFLOWER BROWN STAIN	K1100AC	PERLATO MARBLE (1)	
Laundry				
TILES				
Main Foyer	ESPARATA CREAM 18 X 18 (1)			
Basement Foyer	N/A			
Powder Room	ESPARATA CREAM 18 X 18 (1)			
Mud Room	ESPARATA CREAM 18 X 18 (1)			
Kitchen	HARDWOOD			
Breakfast	HARDWOOD			
Kitchen Bk.Splash	COLOURS & DIMENSIONS 3 X 6 - BISCUIT BRIGHT (1)			
Laundry	CALCATTA GRIS 20 X 20 (1)			
Mstr Ensuite Floor	NEW BYZANTINE GRIS 12 X 24 (1)			
Mstr Ensuite Shower WALL	UNIWALL IVORY 8 X 10			
Master Shower Floor	BONE 2 X 2			
Master Shower JAMB	MARMOLINE IVORY			
Ensuite 4 Floor	CALCATTA GRIS 20 X 20 (1)			
Ensuite 4 Tub Wall	CINQ WHITE 8 X 10			
Twin 2/3 Floor	CALCATTA GRIS 20 X 20 (1)			
Twin 2/3 Tub Wall	CINQ WHITE 8 X 10			
HARDWOOD / CARPET				
Kitchen/ Breakfast	VINTAGE OAK 3-1/4" - ANTIQUE BROWN			
Family Room	VINTAGE OAK 3-1/4" - ANTIQUE BROWN			
Dining Room	VINTAGE OAK 3-1/4" - ANTIQUE BROWN			
Main hall	VINTAGE OAK 3-1/4" - ANTIQUE BROWN			
Library	N/A			
Upper Hall	VINTAGE OAK 3-1/4" - ANTIQUE BROWN			
Master Bedroom	UPGRADE 1 CARPET - LANDSLIDE 721 MANUSCRIPT			
Bedroom 2	UPGRADE 1 CARPET - LANDSLIDE 721 MANUSCRIPT			
Bedroom 3	UPGRADE 1 CARPET - LANDSLIDE 721 MANUSCRIPT			
Bedroom 4	UPGRADE 1 CARPET - LANDSLIDE 721 MANUSCRIPT			
FIREPLACES				
LOCATION	N/A	MANTLE	N/A	
MIRRORS & ACCESSORIES		PLASTER MOULDING		
Mirrors	YES	Opt. Crown Moulding	N/A	
Bathroom Accessories	DELETE	Location	N/A	
Purchaser has reviewed the colour chart			SITE & LOT	
FOR TRADE USE			INNISFIL	156N
Any upgrades in the colour chart must be accompanied with a PES. It is the responsibility of all Trades to inform the builder of any discrepancies on sketches, PES and/or colour charts <u>PRIOR</u> to installation.				
** PAGE 1 OF 2 **			Purchaser Initial	Vendor

ZANCOR HOMES COLOUR CHART

STAIRS, RAILING & PICKETS & STAIR STAIN				
Stair Stain / Species:	STAIN STAIRS TO MATCH HARDWOOD AS CLOSE AS POSSIBLE			
Main to 2nd Railing Details:	METAL - SINGLE COLLAR WITH ALT DOUBLE, BLACK, SQUARE OAK POST, GROOVED HANDRAIL			
Main to Basement Railing Details:	N/A			
TRIM				
Casing/Baseboards	3" X 5" COLONIAL			
Interior Doors	8 FOOT ON MAIN FLOOR - STANDARD STYLE			
Interior Door Hardware	THE WAVE, OIL RUBBED BRONZE (1)			
Exterior Door Hardware	STANDARD			
PAINT				
THROUGHOUT	CAMEO WHITE			
PLUMBING- UPGRADES TO BE DETAILED ON PES				
	FIXTURES	FAUCETS	NOTES	
Kitchen	UNDERMOUNT SINK	UPGRADE		
Powder room	STANDARD	STANDARD		
Master Ensuite	UNDERMOUNT SINK	UPGRADE	RECTANGLE UNDERMOUNT SINK, WIDESPREAD FAUCET	
Ensuite 2	UNDERMOUNT SINK	STANDARD	RECTANGLE UNDERMOUNTS	
Ensuite 3	UNDERMOUNT SINK	STANDARD	RECTANGLE UNDERMOUNTS	
ZANCOR APPLIANCE REQUIREMENTS-UPGRADES TO BE DETAILED ON PES				
Appliance Package received in 'Schedule E'		YES / NO Package Name:		
	UPG (SEE PES)	DECLINED	NOTES	
GAS LINE	YES			
WATERLINE to Fridge	YES			
Hood Fan Venting SIZE	6 INCH			
ELECTRICAL for Built-in Oven	YES			
ELECTRICAL for Built-in Micro / OTR	YES			
ELECTRICAL for Gas Stove / Cooktop	YES			
ELECTRICAL for Bar Fridge	NO			
DISCLAIMER			INITIALS	
Colours of all materials are as close as possible to Builders selection but not necessarily identical due to dye lot variances in manufacturing/manufacturers. Due to construction progress some items may have been pre-selected or installed. In this event the Vendor's selection must be accepted by the purchaser			OK. 	
Any changes to the colour chart after signing are subject to a \$5000 administration fee plus costs			 	
Purchaser has checked and acknowledged accuracy of colour and selections before signing.				
SITE:	INNISFIL	LOT: 156N		
PURCHASER(S):	COREY BUTLER VENISSA BUTLER		MAY 15 2019	
HOME #/CELL #	416-919-5189		Date	
EMAIL:	COREYKEYS@GMAIL.COM		MAY 15 2019	
DÉCOR NOTES		Date		
FOR TRADE USE		Date		
Any upgrades in the colour chart must be accompanied with a PES.		D décor Consultant Signature Date		
It is the responsibility of all Trades to inform the builder of any discrepancies on sketches, PES and/or colour charts PRIOR to installation.		Vendor Signature Date		

Elevation A & B 2297 sq.ft.

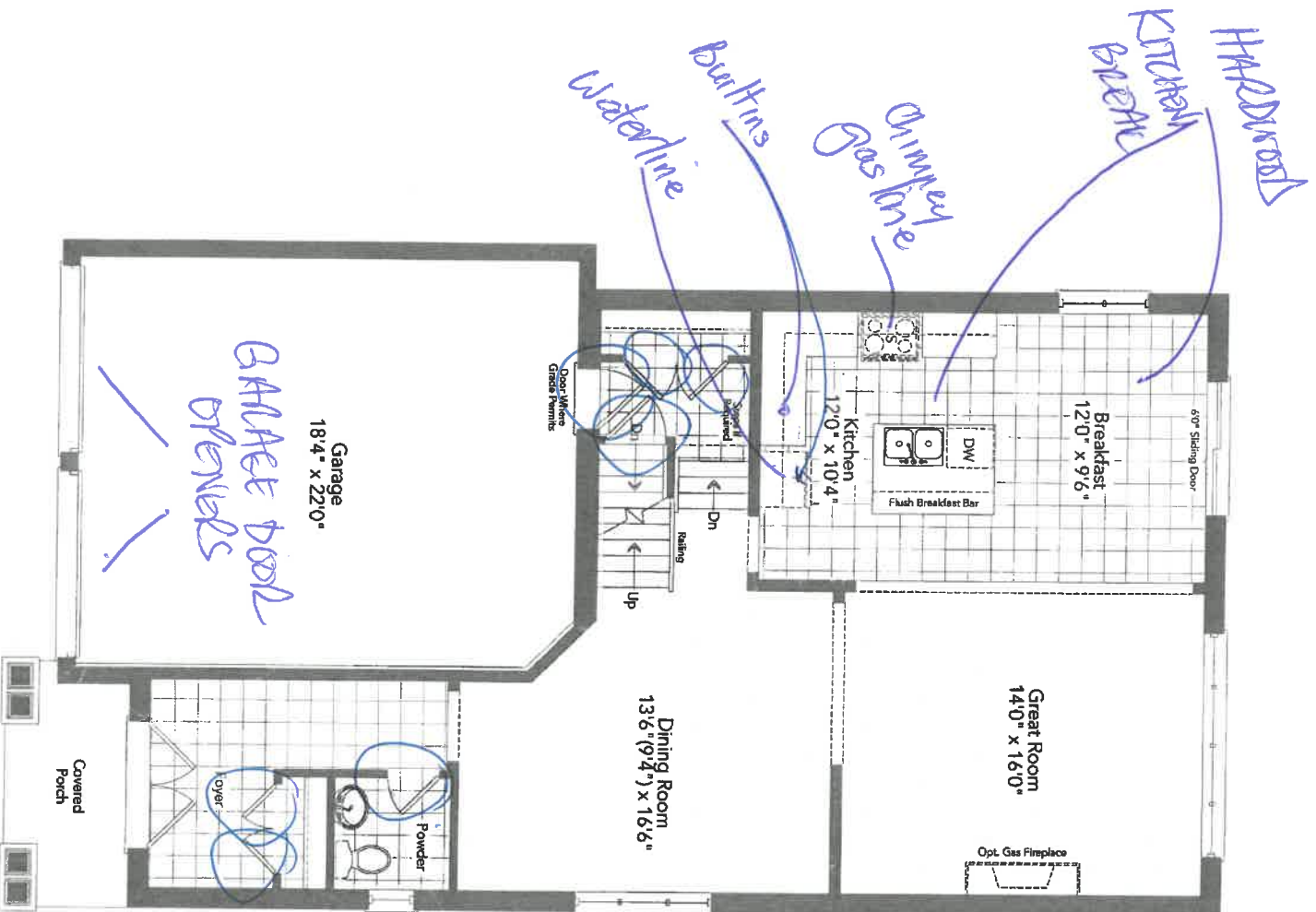

Ground Floor
Elevation A

* Revised exterior - see front elevation *

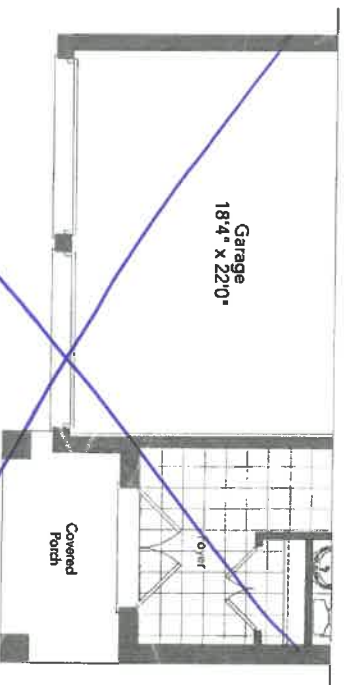

Partial Ground Floor
Elevation B

- * Smooth ceilings
- * 3" casing
- * 5" baseboard
- * 8 foot doors

156N
May 15/19

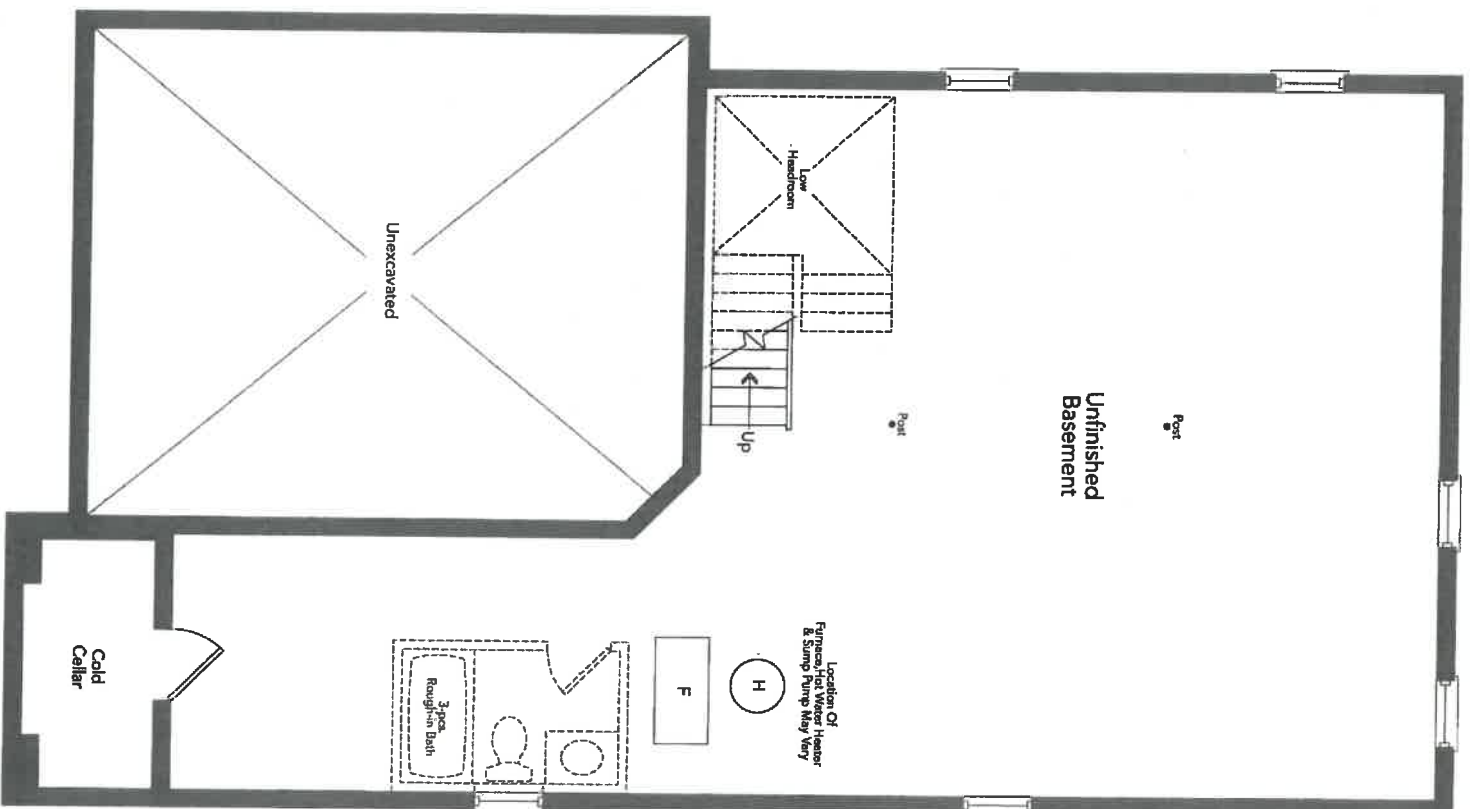

Basement
Elevation A

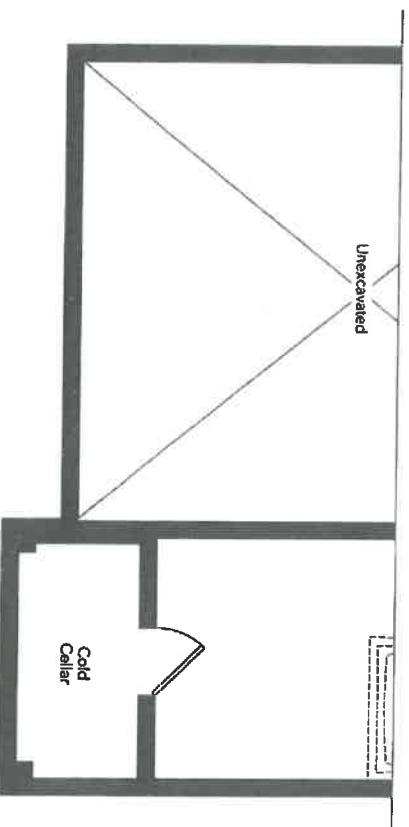

Partial Basement
Elevation B

GALLEY 36-05

156N
 May 15/19

INTERIOR FINISHES ACKNOWLEDGEMENT / WAIVER

Purchaser accepts and acknowledges that the Builder reserves the right to substitute materials with those of equal or better quality where the manufacture, scheduling or delivery of materials may directly impact the Builder's ability to meet its contractual obligations under the Agreement of Purchase and Sale.

UPGRADES/EXTRAS: All upgrades and additional selections indicated on the colour chart must be accompanied by an upgrades/extras sheet (PES) and full payment otherwise the selection will be invalid. All colour charts and upgrades/extras will not proceed until verified and signed by an authorized signing officer at the Vendor's head office. **CHANGES WILL NOT BE PERMITTED UPON COMPLETION AND SUBMISSION OF THE COLOUR CHART.**

PORCELAIN & NATURAL STONES: Due to the properties of natural stones including but not limited to **marble, granite, quartz**, no two pieces are exactly the same. Variations in colour, tone, granularity (pitting, fissures) and pattern are to be expected, including various lighting may affect the overall finished look. Stone tops are sealed at time of installation and should never be cleaned with lemon oil or vinegar. Stones are porous materials, therefore any spilled substance require immediate attention. Stone countertops require regular seal re-application as part of home maintenance. Purchaser acknowledges colour and product variations as well as natural imperfections may exist with the selection of natural stone materials and shall not hold the Vendor liable for provision of same.

STONE COUNTERTOP JOINTS: Purchaser is aware that one joint will be at each corner and on either side of slide-in-range (if applicable). It will also be where the length of the counter top exceeds the length of a stone slab. Slabs are usually approximately 5' x 8'.

CERAMIC TILES: Due to manufacturing, shade (dye lots), product variations may exist that can affect the overall look of the finished product. Although every effort will be made to ensure the colours and materials selected are as close as possible to the samples, the purchaser acknowledges that the sample tiles supplied in the Design Centre may not be identical to the materials installed in the home.

STAIR STAINS: Due to the natural properties of wood, many variables can affect the overall look of the finished product. Factors including but not limited to wood type, knotting, graining, density, age, humidity, and air temperature can result in substantial variations in stain intensity. The purchaser accepts that although the Vendor will do their best to match stain the unfinished stairs as close as possible to the pre-finished floors, it is not possible to have an identical match and that there MAY be shade differences between the two products.

CABINETRY: Due to the natural properties of wood, slight variations apparent with cabinetry are to be expected. This includes but not limited to wood species, wood grain, colour, finish, product variations, and natural imperfections are all factors that may affect the overall look of the finished product. Such factors make exact colour matching impossible. The type and intensity of lighting in the areas of designated cabinetry placement may also highlight characteristics of cabinetry finish. All cabinets shall be finished with a white melamine interior box unless a finished interior is upgraded. Due to building specifications and/or on-site conditions, certain cabinetry upgrades may not be possible. The purchaser acknowledges that the Builder cannot guarantee the cabinetry finish or provision of certain upgrades and shall not hold the Builder liable for provision of same.

UPGRADES/EXTRAS: All upgrades and additional selections indicated on the colour chart must be accompanied by an upgrades/extras sheet (PES) and full payment otherwise the selection will be invalid. All colour charts and upgrades/extras will not proceed until verified and signed by an authorized signing officer at the Vendor's head office. **CHANGES WILL NOT BE PERMITTED UPON COMPLETION AND SUBMISSION OF THE COLOUR CHART.**

HARDWOOD / LAMINATE FLOORING: Due to the properties of wood and laminate, many variables can affect the overall look of the finished product. Variations include but not limited to wood type or laminate finish, colour/stain and wood grain are significant factors that make exact colour matching impossible. The purchaser acknowledges that the hardwood flooring is a pre-finished product in a controlled environment. Expansion, compression and cupping are characteristics of hardwood flooring once installed in the home. The purchaser acknowledges these may become apparent over time and despite the Builders' efforts to install the hardwood flooring materials in keeping with good workmanship, the Builder shall not be responsible nor held liable for minor variances of fluctuation in hardwood flooring materials.

HARDWOOD / LAMINATE WAIVER:

I/We understand hardwood flooring is classified as a porous material and as such not recommended by the Builder in certain areas. I/We understand there is a concern due to possible water and other substances being frequently splashed or spilled onto the floor and in contravention of Ontario Building Code Section 9.30.1.2(1).

"Finished flooring bathrooms, kitchens, public entrance halls, laundry & general storage areas shall consist of resilient flooring, felted-synthetic-fibre floor coverings, concrete, terrazzo, ceramic tile, mastic or other types of flooring providing similar degrees of water resistance."

I/We are prepared to assume full responsibility for any damage caused to the hardwood floor or subfloor due to moisture absorbency in the mentioned areas, and agree to waive any claims against the Township of residence, TARION and/or the Builder in relation to the matter.

****SEE COLOUR CHART FOR LOCATIONS****

SITE 1mst1 LOT 156N DATE May 15/19

156N.

Revised:

Drawing number:

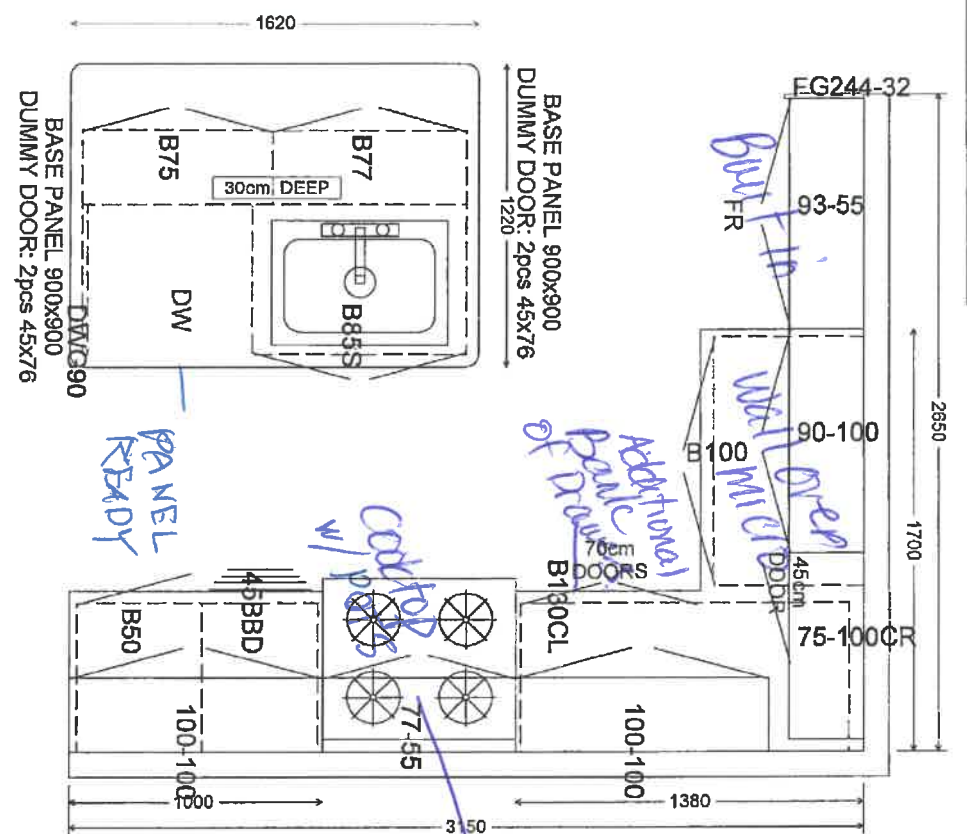

- ② Built in fridge
- ③ Fount in wall oven/micro
- ④ Cooktop w/ pots
- ⑤ Panel ready Dishwasher
- ⑥ Delete upper above stove
- ⑦ Turn tone

New Image Kitchens Inc.		Drawn by: WJEP
Scale: 24/217	Approved by:	Revised
BELLE AIR SHORES, INNISFIL		Drawing number:

MODEL: 36-05

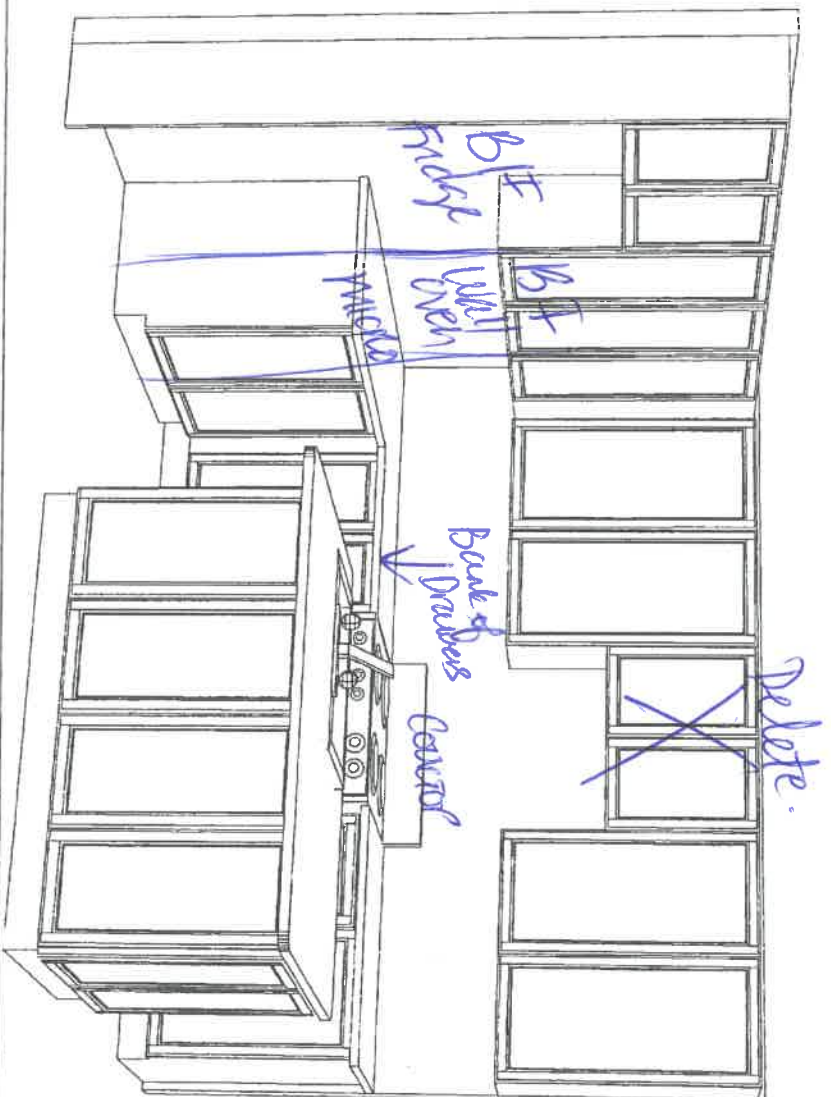
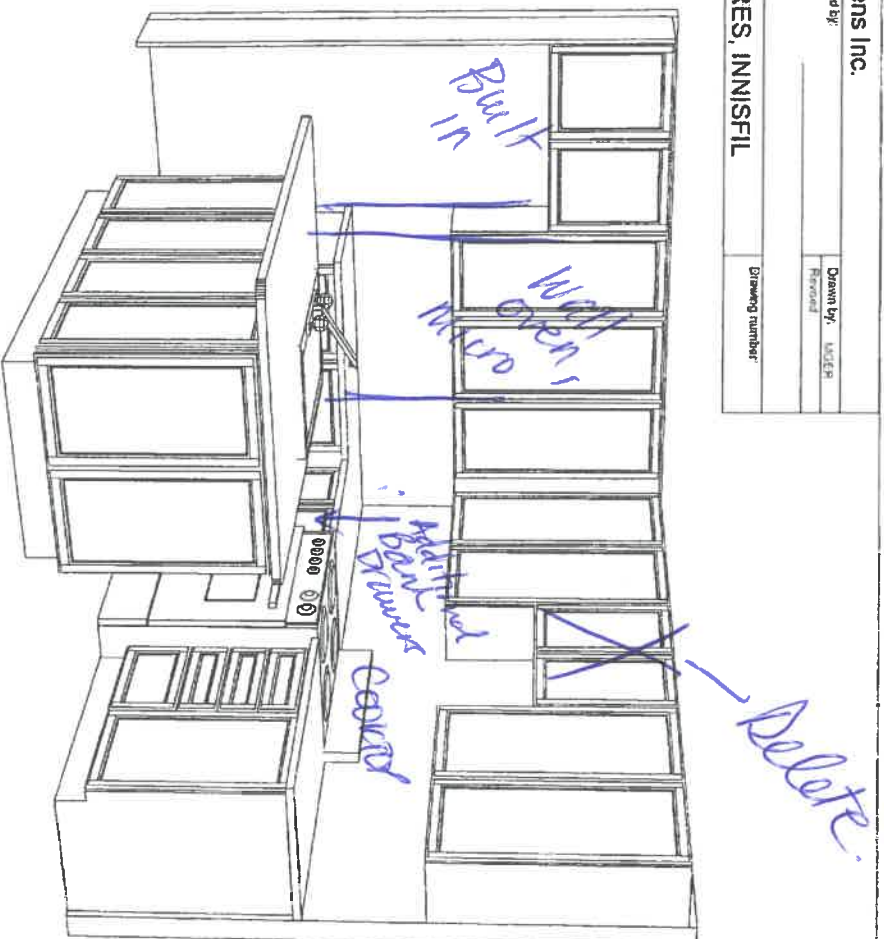

(Handwritten signature/initials)

BEN
May 15/19



APPLIANCE ACKNOWLEDGEMENT

Wayne@East
905-303-6909

- ▶ NOTE: Any upgraded appliances are to be paid by the Purchaser, directly to the appliances company.
- ▶ Additional charges to the Purchaser may apply for cabinetry, electrical and plumbing in order to accommodate the specs given by the homeowner.
- ▶ It is the Purchaser's responsibility to provide Zancor Homes with the correct specification for each appliance where it exceeds the standard openings. Zancor Homes will not be responsible for appliances not fitting due to late changes.
- ▶ It is the Purchaser's responsibility to coordinate delivery, installation and hook up of appliances and to ensure they are installed as per Manufacturers specifications after closing.
- ▶ Standard appliance openings are approximate and the minimum required. Sizes may vary due to onsite condition and/or when modifications have been made to the cabinetry.

STANDARD OPENINGS ACCEPTED BY PURCHASER:

Y 
HOMEOWNER SIGNATURE

- Fridge** ▶ 36" (+/-) x 74" (+/-)
**Space above the fridge is required due to proper air flow
- Stove** ▶ 30"
- Dishwasher** ▶ 24"
- Hood Fan Opening** ▶ 30"
- Hood fan Vent** ▶ 6"

Appliance Specs are DUE (if not received during appointment)
2 WEEKS FROM SIGNED DATE ABOVE
Specs that require changes/modifications after this date will not be accepted

UPGRADE APPLIANCE OPENING REQUIREMENTS:

Y 
HOMEOWNER SIGNATURE

- FRIDGE**
- ☒ Built-In
- ☐ Paneled / Integrated
- ☐ Flush Inset
- ☒ Water Line Required

- RANGE**
- ☐ 36"
- ☐ 48"
- ☒ Gas
- ☐ Induction
- ☐ Cooktop (Apron front)
- ☒ Cooktop (Dropin)
- **Cut-out charge required for cooktop

- HOOD FAN & VENT**
- ☐ Under Cabinet
- ☒ Chimney (centre vent)
- ☐ Insert / Liner
- ☒ 6 Inch
- ☐ 8 Inch
- ☐ 10 Inch

- WALL OVEN & MICRO**
- ☒ Single Oven
- ☐ Double Oven
- ☐ Steam Oven
- ☐ Warming Drawer
- ☐ Over the Range Microwave
- ☒ Built-in Microwave (*trim kit required)

DATE May 15/19 SITE (mish) LOT 156A

** Any upgrades checked in this appliance form must be accompanied with specs provided by the Purchaser.
It is the responsibility of the trades to inform the Builder of any discrepancies with specs, sketches, extras and/or colour chart PRIOR to production/installation. **

ZANCOR HOMES
EDGE PROFILES (INTERSTONE / REDSTONE)

STANDARD
KITCHENS

STANDARD
VANITIES

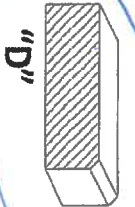
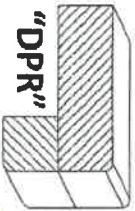
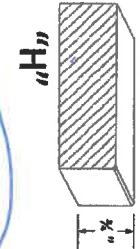
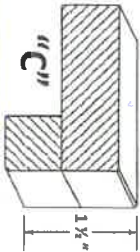

OP
AB

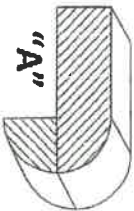
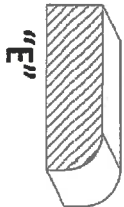
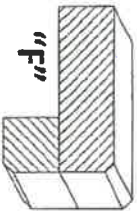
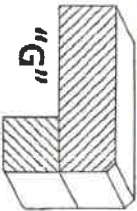

UPGRADE
KITCHENS

UPGRADE
VANITIES

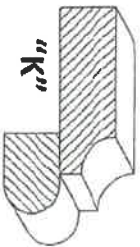
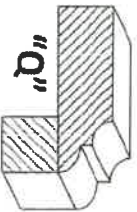
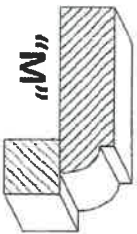
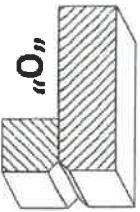
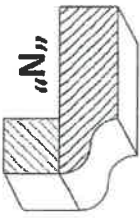
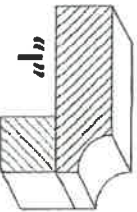
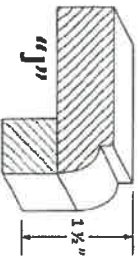
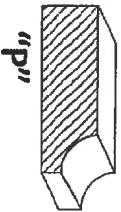
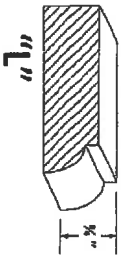

156N finish

LOT / SITE

May 15/19

PURCHASER SIGNATURE

36" Built-In French Door Bottom-Freezer

Benchmark® Series – Stainless Steel B36BT930NS



B36BT930NS
Stainless Steel

The 36" French door built-in refrigerator works efficiently to keep food fresh longer, and prevent the transfer of flavors and odors.

Features & Benefits

Remotely monitor and control your refrigerator with the Home Connect™ app.

Bright LED lighting illuminates the entire interior.

Dual evaporators prevent odor transfer and optimize freshness.

Optiflex® hinge allows for flush-mount doors, without damaging surrounding cabinetry.

ENERGY STAR® qualified for energy efficiency.

General Properties

Home Connect™ (Wi-Fi Enabled)	Yes
Reversible door hinge	No
Water filter	Yes
Lighting	LED side wall theater
Defrost process refrigerator section	Frost-free
Number of shelves - refrigerator	3
Adjustable shelves - refrigerator	2
Shelf material - refrigerator	Glass w/ metal trim
Type of shelves - refrigerator	Full width
Gallon storage bins	2
Humidity control drawer	Yes - 1
Defrost process freezer section	Automatic
Number of drawers - freezer	2
Ice maker	Yes
Quick ice	No
Capacity	
Total capacity	19.4 cu. ft.



Technical Details

Watts (W)	350 W
Current (A)	15 A
Volts (V)	120 V
Frequency (Hz)	60 Hz
Power cord length (in.)	118"
Plug type	120V-3 prong
Dimensions & Weight	
Appliance dimensions (H x W x D) (in.)	84" x 35 3/4" x 24"
Required cutout size (H x W x D) (in.)	84" x 36" x 25"
Net weight (lbs)	540 lbs
Efficiency	
ENERGY STAR® qualified	Yes
Energy consumption (kWh/yr)	585 kWh

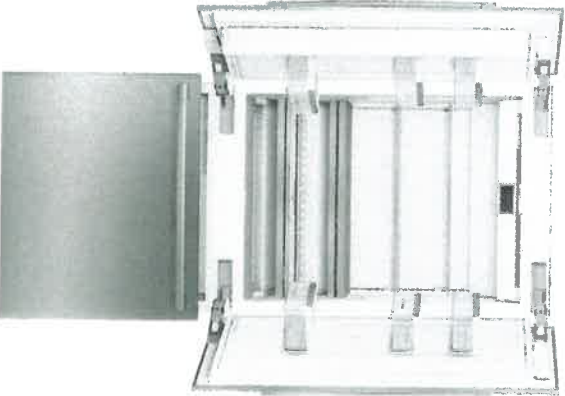

Accessories: To purchase Bosch accessories, cleaners & parts please visit www.bosch-home.com/us/store or call 1-800-944-2904 (Mon to Fri 5 am to 6 pm PST, Sat 6 am to 3 pm PST).
Notes: All height, width and depth dimensions are shown in inches. BSH reserves the absolute and unrestricted right to change product materials and specifications, at any time, without notice. Consult the product's installation instructions for final dimensional data and other details prior to making cutout.
Warranties: Please see Use & Care manual or Bosch website for statement of limited warranty.
For more information on our entire line of products, go to www.bosch-home.com/us or call 1-800-944-2904
© BSH Home Appliances Corporation. All rights reserved. Bosch is a registered trademark of Robert Bosch GmbH.

156N MAY 18 2018

30" Speed Combination Oven

800 Series – Stainless Steel HBL8752UC

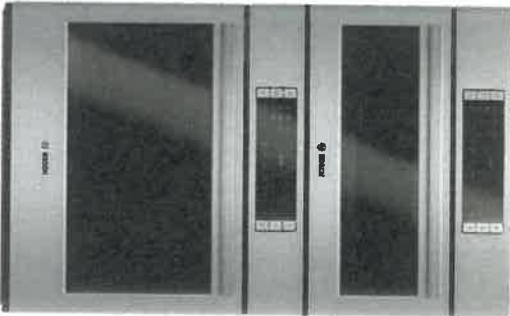

HBL8752UC
Stainless Steel

Also available in:

Black HBL8742UC
Stainless Steel

The Bosch speed combination oven allows for faster cooking results and features a QuietClose® door.

Features & Benefits

Cooks faster than a traditional oven and can be used as a microwave.

Dampened hinges softly and quietly guide the QuietClose® door shut.

A full-extension telescopic rack offers safe access to the oven cavity.

The wall oven is designed to be installed flush with cabinetry.

General Properties

Cooking modes – upper cavity	Speed oven; 12 Auto Programs (including Auto Defrost, Melt Butter, Soften Ice Cream, Pizza), 9 Sensor Cook Programs, 9 SpeedChef® Programs, Hi & Lo Broil, European Convection, Keep Warm, Frozen Foods
Cooking modes – lower cavity	Bake, Variable Broil (hi & low), Roast, Warm, Sabbath, Proof Dough, Convection Bake, Convection Broil, Convection Roast, Pizza, Multi Rack Genuine European Convection, Convection Conversion, Temperature Probe, Fast Preheat

Cleaning type	Self Clean
Telescopic rack	1
Illumination type	Halogen (Upper and Lower)
Interior lights	1 Upper / 2 Lower

Oven Performance	
Microwave power – upper cavity	1000 W
Bake / broil element wattages – upper cavity	600 / 1,750 W
Convection element wattages – upper cavity	1,700 W
Bake / broil element wattages – lower cavity	2,400 / 3,800 W
Convection element wattages – lower cavity	2,000 W

Technical Details	
Watts (W)	9,600 W
Circuit breaker (A)	40 A
Volts (V); Frequency (Hz)	240 / 208 V; 60 Hz
Power cord length (in)	50"
Plug type	Fixed Connection, No Plug
Energy source	Electric

Dimensions & Weight

Overall appliance dimensions (HxWxD)(in)	49" x 29 3/4" x 24 1/2"
Required cutout size – Standard (HxWxD) (in)	48 5/8" x 28 1/2" x 23 1/2"
Required cutout size – Flush (HxWxD) (in)	49 1/8" x 30" x 24 1/2"
Oven cavity size – upper	1.6 cu. ft.
Overall upper oven interior dimensions (HxWxD) (in.)	9 7/8" x 16 1/2" x 16 1/2"
Turntable – Metal Max. Cookware – upper	12 3/4" dia.
Turntable – Ceramic Max. Cookware – upper	12 1/2" dia.
Rack – Rectangular Cookware Max. – upper	15" x 12"
Oven cavity size – lower	4.6 cu. ft.
Overall lower oven interior dimensions (HxWxD) (in)	17 13/16" x 24 1/8" x 18"
Usable lower oven interior dimensions (HxWxD) (in)	12 5/16" x 23 1/4" x 15 1/4"
Net weight (lbs)	259 lbs

Accessories–Included

Upper Oven: Metal Turntable, Square rack, Ceramic Cooking Tray
Lower Oven: 1 Telescopic and 2 Standard Oven Racks, Meat Probe

Accessories–Optional

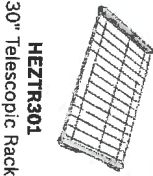

HEZTR301
30" Telescopic Rack

156N



*Wall oven only

MAY 18 2018

Accessories: To purchase Bosch accessories, cleaners & parts please visit www.bosch-home.com/us/store or call 1-800-944-2904 (Mon to Fri 9 am to 6 pm PST, Sat 9 am to 3 pm PST).
Notes: All height, width and depth dimensions are shown in inches. BSH reserves the absolute and unrestricted right to change product materials and specifications, at any time, without notice. Consult the product's installation instructions for final dimensional data and other details prior to making cutout.
Warranties: Please see Use & Care manual or Bosch website for statement of limited warranty.
For more information on our entire line of products, go to www.bosch-home.com/us or call 1-800-944-2904
© BSH Home Appliances Corporation. All rights reserved. Bosch is a registered trademark of Robert Bosch GmbH.

30" Speed Combination Oven

800 Series – Stainless Steel HBL8752UC



Installation Details

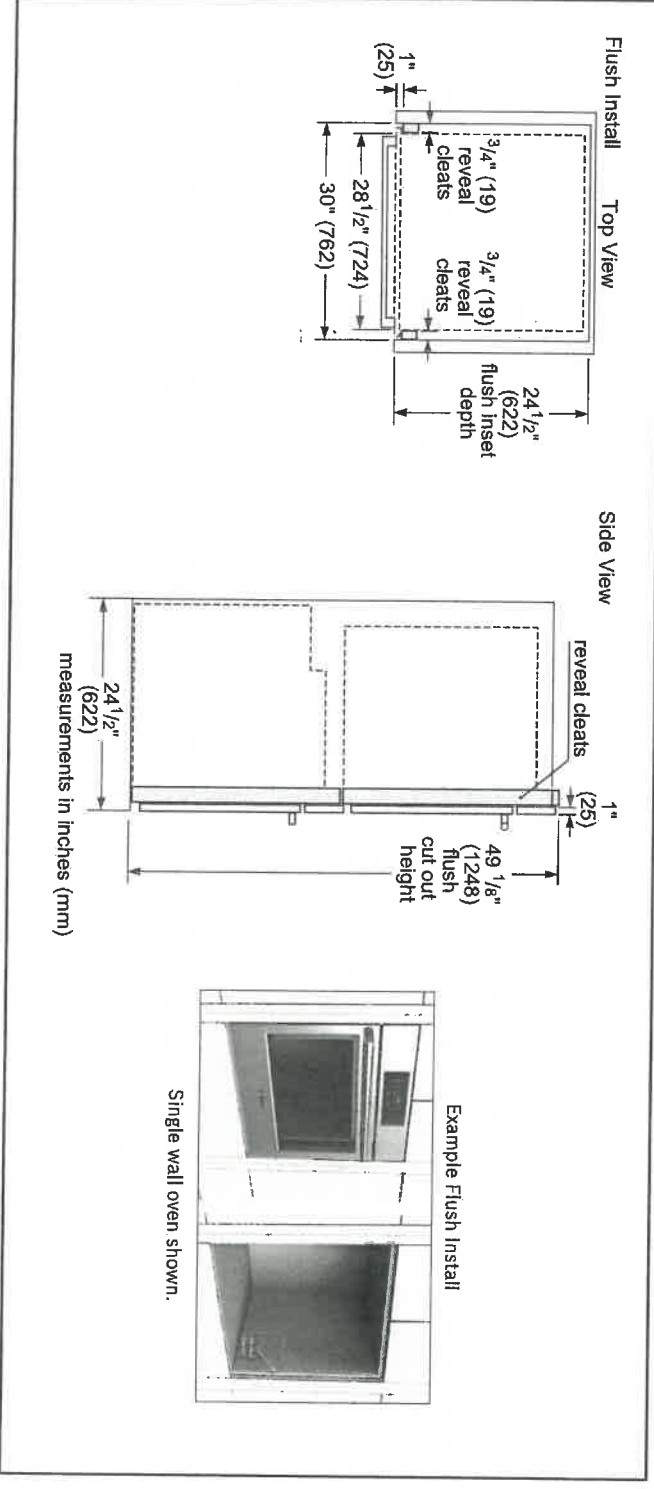
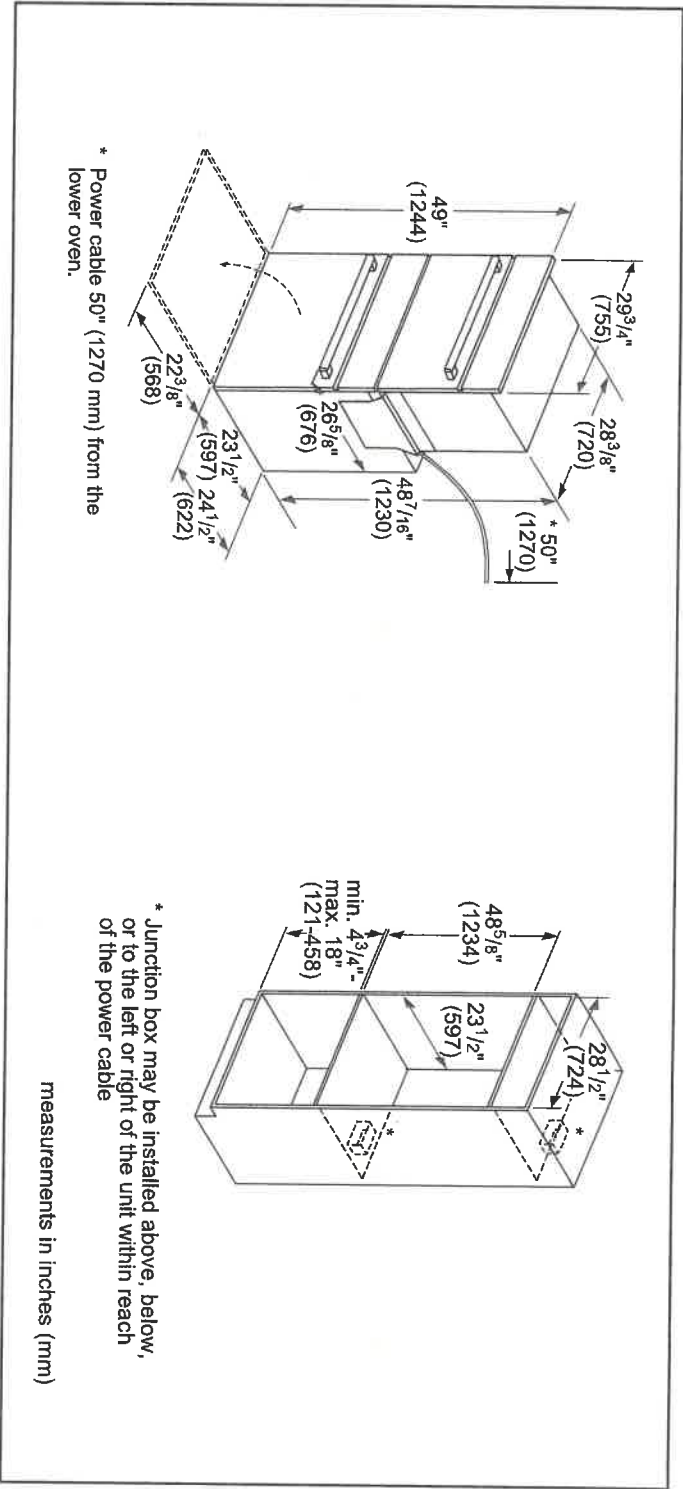

Accessories: To purchase Bosch accessories, cleaners & parts please visit www.bosch-home.com/us/store or call 1-800-944-2904 (Mon to Fri 5 am to 6 pm PST, Sat 6 am to 3 pm PST).
Notes: All height, width and depth dimensions are shown in inches. BSH reserves the absolute and unrestricted right to change product materials and specifications, at any time, without notice. Consult the product's installation instructions for final dimensional data and other details prior to making cutout.
Warranties: Please see Use & Care manual or Bosch website for statement of limited warranty.
For more information on our entire line of products, go to www.bosch-home.com/us or call 1-800-944-2904
© BSH Home Appliances Corporation. All rights reserved. Bosch is a registered trademark of Robert Bosch GmbH.

156N MAY 18 2018

30" Speed Combination Oven

800 Series – Stainless Steel HBL8752UC



Installation Details

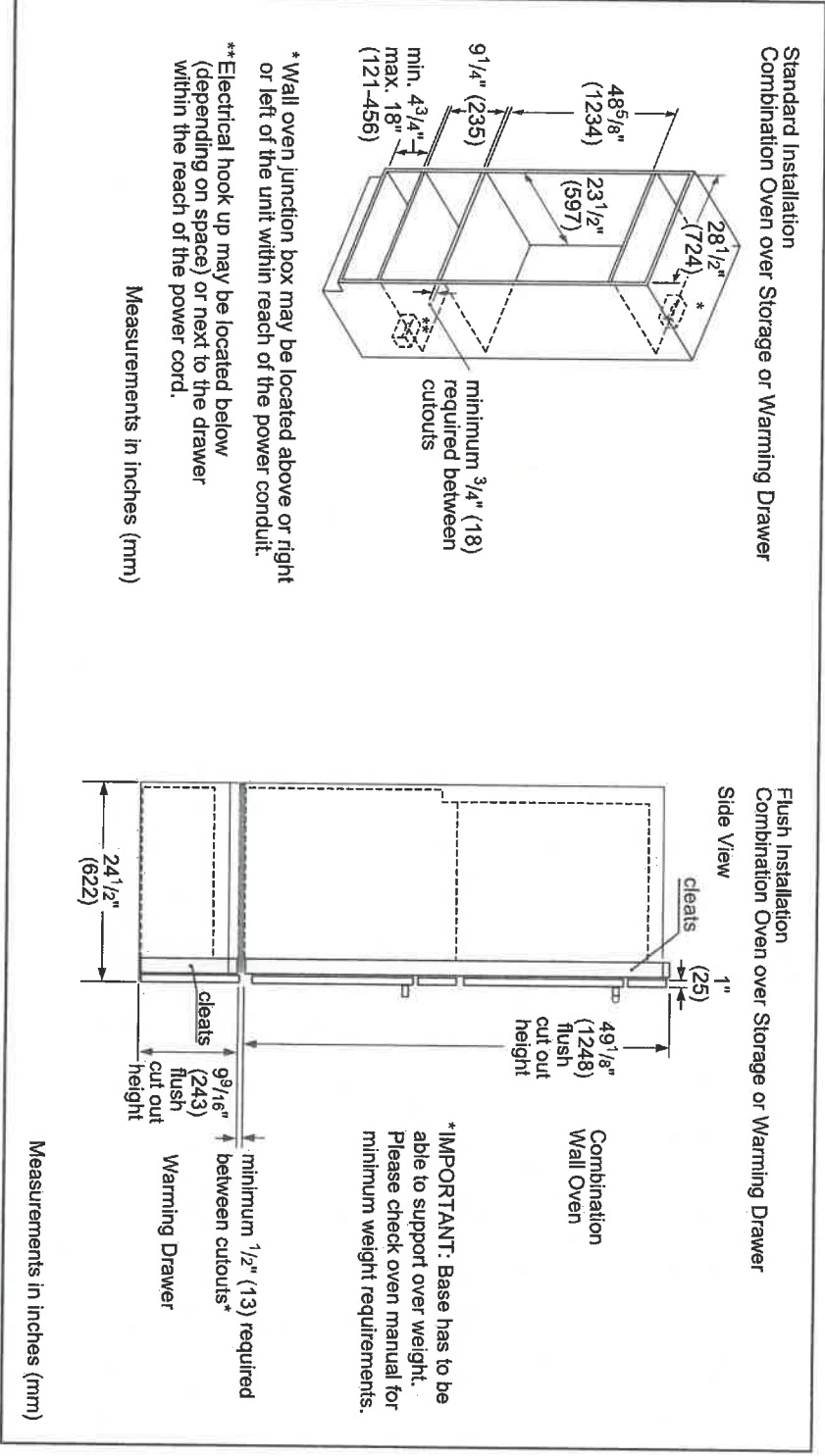

150N

MAY 18 2018

Accessories: To purchase Bosch accessories, cleaners & parts please visit www.bosch-home.com/us/store or call 1-800-944-2904 (Mon to Fri 5 am to 6 pm PST, Sat 6 am to 3 pm PST).
Notes: All height, width and depth dimensions are shown in inches. BSH reserves the absolute and unrestricted right to change product materials and specifications, at any time, without notice. Consult the product's installation instructions for final dimensional data and other details prior to making cutout.
Warranties: Please see Use & Care manual or Bosch website for statement of limited warranty.
For more information on our entire line of products, go to www.bosch-home.com/us or call 1-800-944-2904
© BSH Home Appliances Corporation. All rights reserved. Bosch is a registered trademark of Robert Bosch GmbH.

30" Gas Cooktop

Benchmark® Series – Stainless Steel NGMP056UC



BOSCH
Invented for life

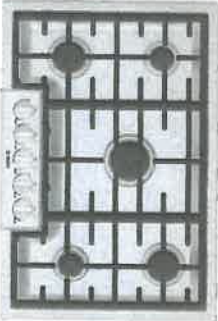

NGMP056UC
Stainless Steel

The 30" Benchmark® Series gas cooktop features a dual-stacked burner that delivers both a low simmer and high heat flame.

Features & Benefits

- Dual stacked burner designed for faster boil time (20,000 BTUs) and a low simmer
- OptiSim® Burner – simmer delicate sauces and melt chocolate without scorching
- Electronic re-ignition will automatically re-ignite the burner in case the flame goes out
- Continuous grates make moving heavy pots easier
- Distinctive red LED light indicates burners are on

General Properties	
Knob material	Metal
Sealed burners	Yes
Grate material	Cast iron
Element Performance	
Total BTU load (NG / LP)	51,000 / 43,200
Power of front left burner (NG / LP)	10,000 / 9,100
Power of back left burner (NG / LP)	5,500 / 5,000
Power of center burner (NG / LP)	20,000 / 15,000
Power of back right burner (NG / LP)	10,000 / 9,100
Power of front right burner (NG / LP)	5,500 / 5,000

Dimensions & Weight	
Overall appliance dimensions (HxWxD)	3 13/16" x 31" x 21 1/4"
Required cutout size (HxWxD)	3 13/16" x 28 15/16" x 19 1/8"
Minimum distance from counter front	1 7/8"
Minimum distance from rear wall	3"
Net weight	38 lbs
Accessories – Included	
Included	LP conversion kit

Technical Details	
Watts	360 W
Circuit breaker	15 A
Volts	120 V
Frequency	60 Hz
Plug type	3 prong
Power cord length	60"
Energy source	Gas
Convertible to LP (kit required)	Yes



1570N
MAY 18 2018

For help and assistance with Bosch accessories please call 1-800-944-2904 Mon-Fri 5am to 6pm PST Sat 6am to 3pm PST
Notes: All height, width and depth dimensions are shown in inches. BSH reserves the absolute and unrestricted right to change product materials and specifications, at any time, without notice. Consult the product's installation instructions for final dimensional data and other details prior to making cutout. Applicable product warranty can be found in accompanying product literature or you may contact your account manager for further details.
Warranties: Bosch warrants that the Product is free from defects in materials and workmanship for a period of three hundred and sixty-five (365) days from the date of purchase. The foregoing timeline begins to run upon the date of purchase, and shall not be stalled, tolled, extended, or suspended, for any reason whatsoever. This Product is also warranted to be free from cosmetic defects in material and workmanship (such as scratches of stainless steel, paint/porcelain blemishes, chip, dents, or other damage) to the finish of the Product, for a period of thirty (30) days from the date of purchase or closing date for new construction. This cosmetic warranty excludes slight color variations due to inherent differences in painted and porcelain parts, as well as differences caused by kitchen lighting, product location, or other similar factors. This cosmetic warranty specifically excludes any display, floor, "As Is", or "B" stock appliances.
For more information on our entire line of products, go to www.bosch-home.ca or call 1-800-944-2904
© BSH Home Appliances Limited. All rights reserved. Bosch is a registered trademark of Robert Bosch GmbH.

30" Gas Cooktop

Benchmark® Series – Stainless Steel NGMP056UC



Installation Details

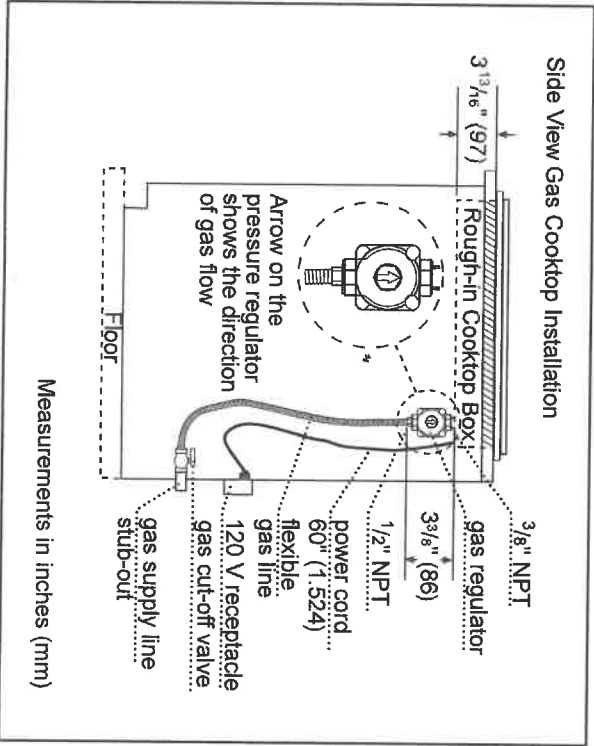
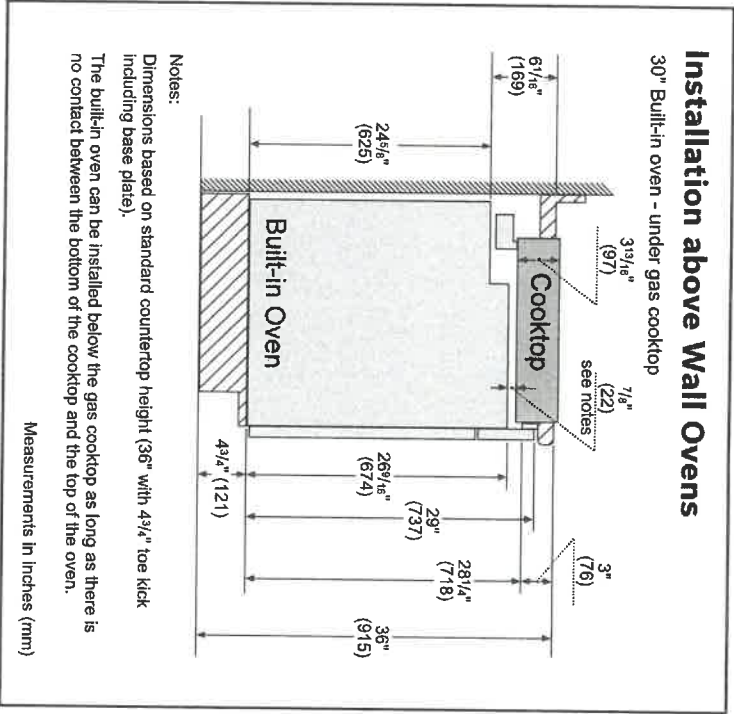
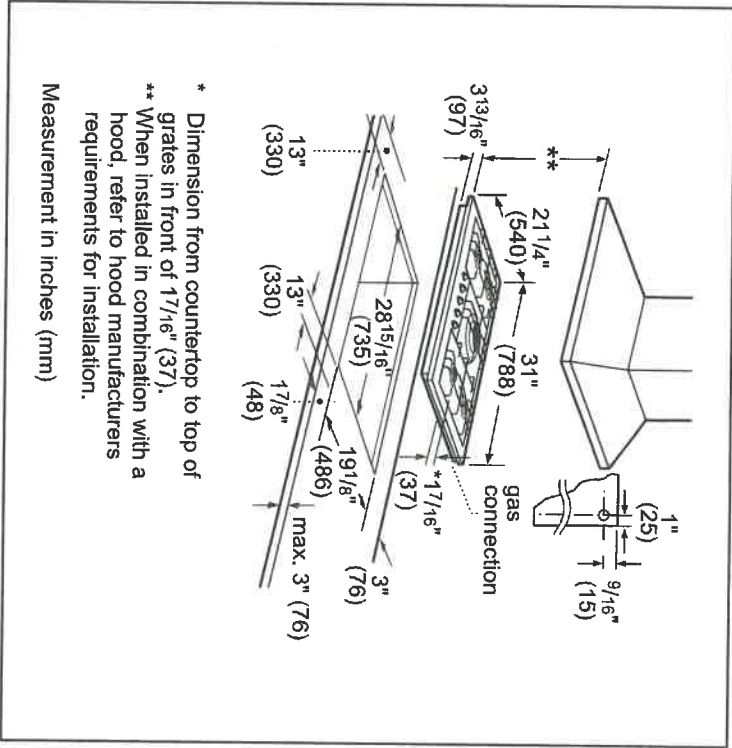

150N
MAY 18 2018

For help and assistance with Bosch accessories please call 1-800-944-2904 Mon-Fri 5am to 6pm PST Sat 6am to 3pm PST
Notes: All height, width and depth dimensions are shown in inches. BSH reserves the absolute and unrestricted right to change product materials and specifications, at any time, without notice. Consult the product's installation instructions for final dimensional data and other details prior to making cutout. Applicable product warranty can be found in accompanying product literature or you may contact your account manager for further details.
Warranties: Bosch warrants that the Product is free from defects in materials and workmanship for a period of three hundred and sixty-five (365) days from the date of purchase. The foregoing timeline begins to run upon the date of purchase, and shall not be stalled, tolled, extended, or suspended, for any reason whatsoever. This Product is also warranted to be free from cosmetic defects in material and workmanship (such as scratches of stainless steel, paint/porcelain blemishes, chip, dents, or other damage) to the finish of the Product, for a period of thirty (30) days from the date of purchase or closing date for new construction. This cosmetic warranty excludes slight color variations due to inherent differences in painted and porcelain parts, as well as differences caused by kitchen lighting, product location, or other similar factors. This cosmetic warranty specifically excludes any display, floor, "As Is", or "B" stock appliances.
For more information on our entire line of products, go to www.boschhome.ca or call 1-800-944-2904
© BSH Home Appliances Limited. All rights reserved. Bosch is a registered trademark of Robert Bosch GmbH.

30" Gas Cooktop

Benchmark® Series – Stainless Steel NGMP056UC



Installation Details

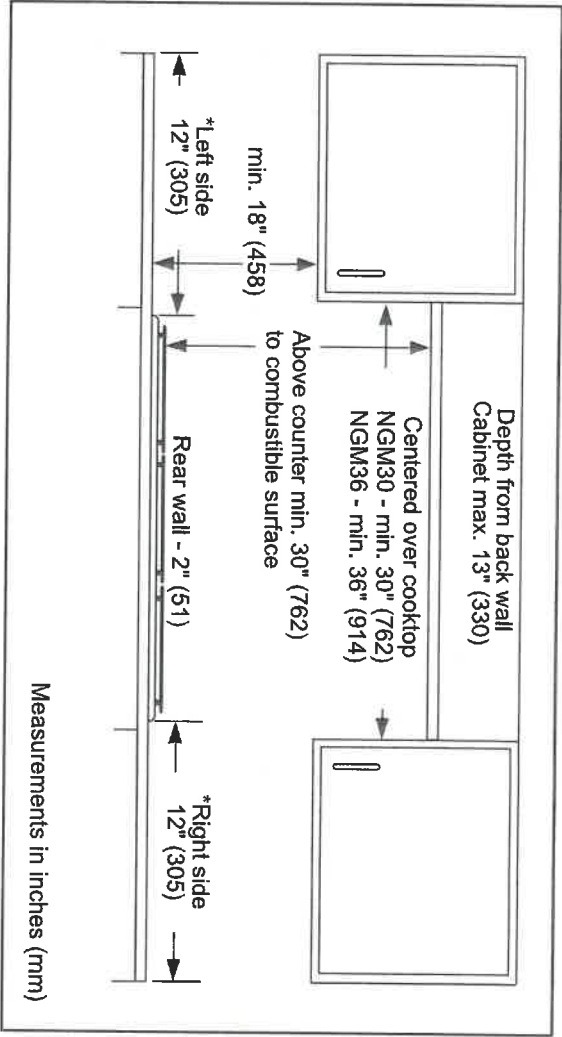

15704

Warranty
MAY 18 2018

For help and assistance with Bosch accessories please call 1-800-944-2904 Mon-Fri 9am to 6pm PST Sat 9am to 3pm PST

Notes: All height, width and depth dimensions are shown in inches. BSH reserves the absolute and unrestricted right to change product materials and specifications, at any time, without notice. Consult the product's installation instructions for final dimensional data and other details prior to making cutout. Applicable product warranty can be found in accompanying product literature or you may contact your account manager for further details.

Warranties: Bosch warrants that the Product is free from defects in materials and workmanship for a period of three hundred and sixty-five (365) days from the date of purchase. The foregoing timeline begins to run upon the date of purchase, and shall not be stalled, tolled, extended, or suspended, for any reason whatsoever. This Product is also warranted to be free from cosmetic defects in material and workmanship (such as scratches of stainless steel, paint/porcelain blemishes, chip, dents, or other damage) to the finish of the Product, for a period of thirty (30) days from the date of purchase or closing date for new construction. This cosmetic warranty excludes slight color variations due to inherent differences in painted and porcelain parts, as well as differences caused by kitchen lighting, product location, or other similar factors. This cosmetic warranty specifically excludes any display, floor, "As Is", or "B" stock appliances.

For more information on our entire line of products, go to www.bosch-home.ca or call 1-800-944-2904

© BSH Home Appliances Limited. All rights reserved. Bosch is a registered trademark of Robert Bosch GmbH.

✓ **VENTMAR** | **CHEF**

SPECIFICATION SHEET
VCS550 SERIES

MODEL	VCS550
VOLTS	120 VCA
Hz	60
AMPS	3.9
CFM (LOW SPEED)	200
CFM (HIGH SPEED)	550*
SONES (LOW SPEED)	1.5
SONES (HIGH SPEED)	11
DUCTING SIZES	VERTICAL: 6" ROUND OR 3 1/4" x 10" HORIZONTAL: 3 1/4" x 10"
2 LED MODULES	2 x 6, 5 WATTS
WARRANTY	5 YEARS (EXCEPT LED MODULES, 3 YEARS)

- *OPTIONAL AIR FLOW REDUCERS:
(LIMITS THE AIRFLOW OF THE HOOD UNDER 300 CFM)
- ARP6 (WITH 6" ROUND DUCTS)
 - ARP310 (WITH 3 1/4" x 10" DUCTS)

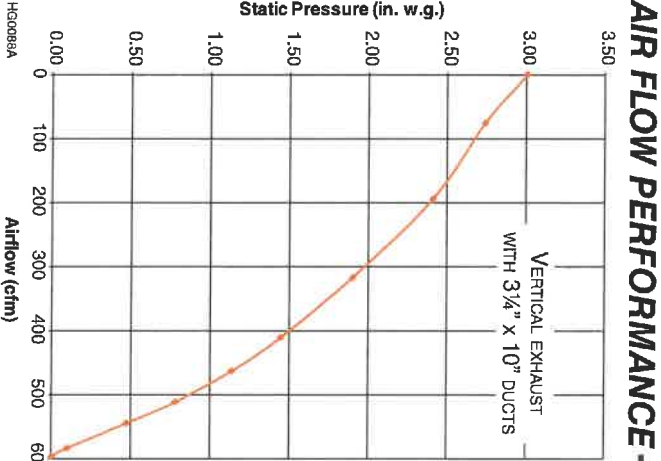

PROJECT

LOCATION

MODEL No.

QTY.

SUBMITTED BY

DATE

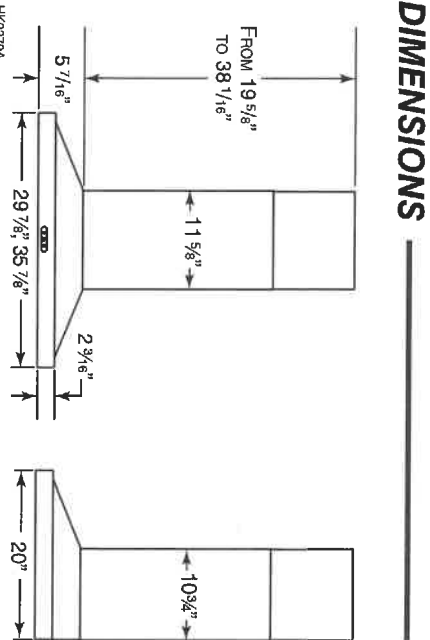

REQUIREMENTS & STANDARDS

- Complies with CSA C22.2 no. 113 Standard
- Complies with UL 507 requirements
- HVI certified

OPTION

- Non-duct kits models HRKBSS (stainless steel) and HRKBLS (black stainless steel)



HVI-2100 CERTIFIED RATINGS comply with new testing technologies and procedures prescribed by the Home Ventilating Institute, for off-the-shelf products, as they are available to consumers. Product performance is rated at 0.1 in. (2.54 mm) static pressure, based on tests conducted in a state-of-the-art test laboratory. Sones are a measure of humanly-perceived loudness, based on laboratory measurements.



RANGE HOOD AIRFLOW HAS BEEN TESTED BY AN INDEPENDANT LABORATORY DESIGNATED BY THE HOME VENTILATING INSTITUTE (HVI). THE MAXIMUM AIRFLOW OF THE BLOWER IS 600 CFM.

REMARKS

156N

24" Custom Panel Dishwasher

300 Series DLX – Custom Panel SHV863WD3N

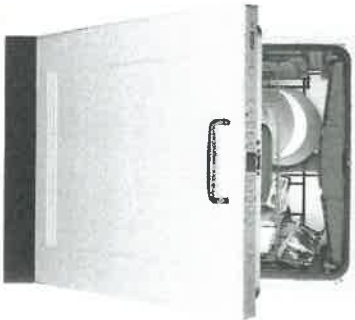

SHV863WD3N
Custom Panel

The 3rd rack provides the perfect space for silverware and large utensils while its V shape leaves room below for taller items.

Features & Benefits

44 dBA: Quietest dishwasher brand in North America.*

A 3rd rack adds versatility and offers 30% more loading area.

FlexSpace™ Tines fold back to fit your larger pots & pans.

RackMatic® offers 3 height levels, for 9 possible rack positions.

Speed60® gets your dishes dirty to dry in about an hour.

General Properties

Number of wash cycles	5
Number of options	5
dBA	44
Third rack	Standard 3rd Rack
Rack adjustability	Rackmatic®
Tub material	Stainless Steel
Control type	Buttons
Concealed heating element	Yes
Leak protection system	24/7 AquaStop®
Water softener	No
Five-level wash	Yes
ChildLock	No
Special features	InfLight®, Extra Dry Option
Efficiency	
Water usage per cycle	3.5
Energy efficiency class	Tier 1
ENERGY STAR® qualified	Yes
Total annual energy consumption (kWh)	269
Total annual water consumption (g)	623.5
Capacity	
Number of place settings	16

Technical Details

Watts (W)	1440 W
Current (A)	12 Amps
Volts (V)	120 V
Frequency (Hz)	60 Hz
Power cord length	N/A
Minimum water pressure (lb/sin)	14
Length outlet hose (in)	79"
Dimensions & Weight	
Overall appliance dimensions (HxWxD) (in)	33 7/8" x 23 9/16" x 23 1/16"
Required cutout size (HxWxD) (in)	33 7/8" x 23 5/8" x 24"
Adjustable feet	Yes
Net weight (lbs)	88 lbs

Accessories—Optional

Drain Hose Extension Kit	SGZ1010UC
Stainless Steel Door with Stainless Steel Straight Bosch Bar Handle	SHZ1008UC
Stainless Steel Straight Bosch Bar Handle	SMZ1007UC
Dishwasher Accessory Kit	SMZ5000
Anti-Tarnish Silverware Cassette	SMZ5002UC
Power Cord with Cold Plug	SMZPC002UC



*Based on an average of sound ratings of 24" Full Size Stainless Steel Tub dishwashers contained in major brands US & Canadian websites. Major brands defined as Trachline Top 5 Market Share (US & Canada) December 2016.

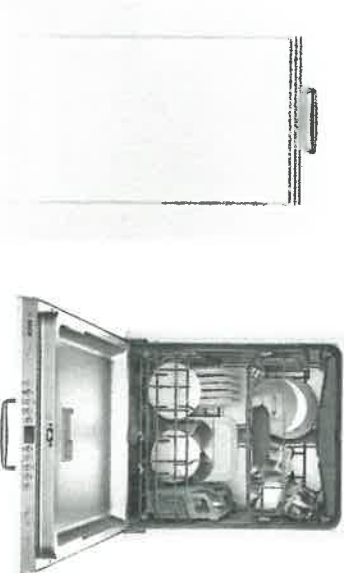

1560N
MAY 18 2018

For help and assistance with Bosch accessories please call 1-800-944-2904 Mon-Fri 5am to 6pm PST Sat 6am to 3pm PST

Notes: All height, width and depth dimensions are shown in inches. BSH reserves the absolute and unrestricted right to change product materials and specifications, at any time, without notice. Consult the product's installation instructions for final dimensional data and other details prior to making cutout. Applicable product warranty can be found in accompanying product literature or you may contact your account manager for further details.

Warranties: Bosch warrants that the Product is free from defects in materials and workmanship for a period of three hundred and sixty-five (365) days from the date of purchase. The foregoing timeline begins to run upon the date of purchase, and shall not be stalled, tolled, extended, or suspended, for any reason whatsoever. This Product is also warranted to be free from cosmetic defects in material and workmanship (such as scratches of stainless steel, paint/porcelain blemishes, chip, dents, or other damage) to the finish of the Product, for a period of thirty (30) days from the date of purchase or closing date for new construction. This cosmetic warranty excludes slight color variations due to inherent differences in painted and porcelain parts, as well as differences caused by kitchen lighting, product location, or other similar factors. This cosmetic warranty specifically excludes any display, floor, "As Is", or "B" stock appliances.

For more information on our entire line of products, go to www.boschhome.ca or call 1-800-944-2904

© BSH Home Appliances Limited. All rights reserved. Bosch is a registered trademark of Robert Bosch GmbH.

24" Custom Panel Dishwasher

300 Series DLX – Custom Panel SHV863WD3N



Installation Details

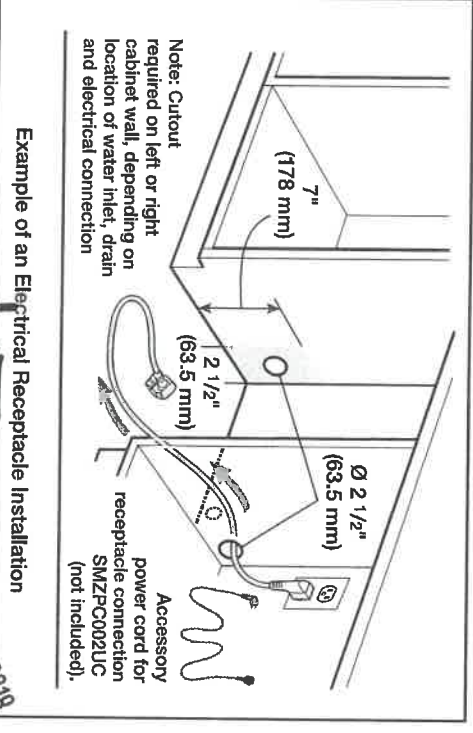
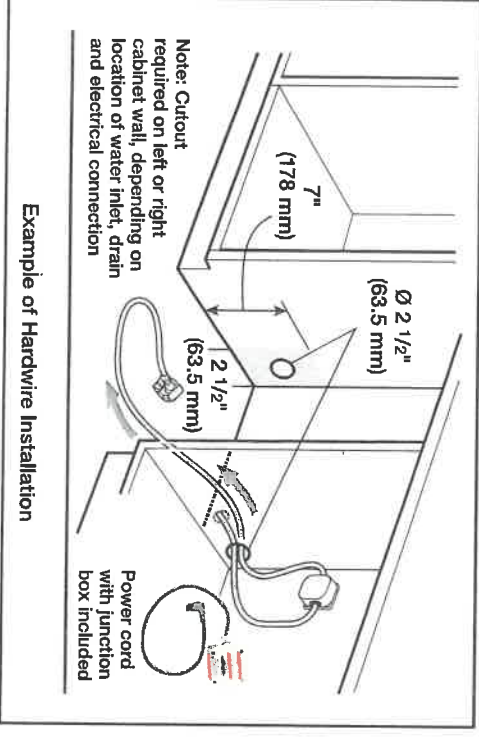
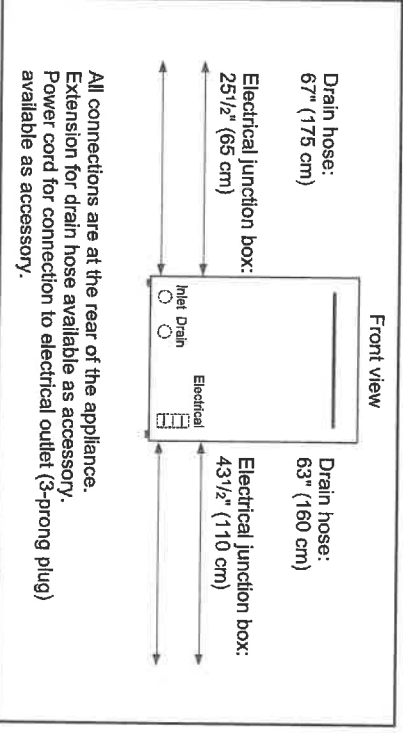
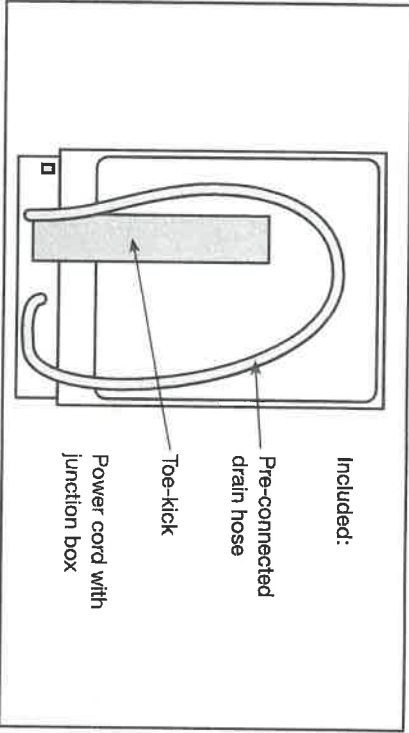
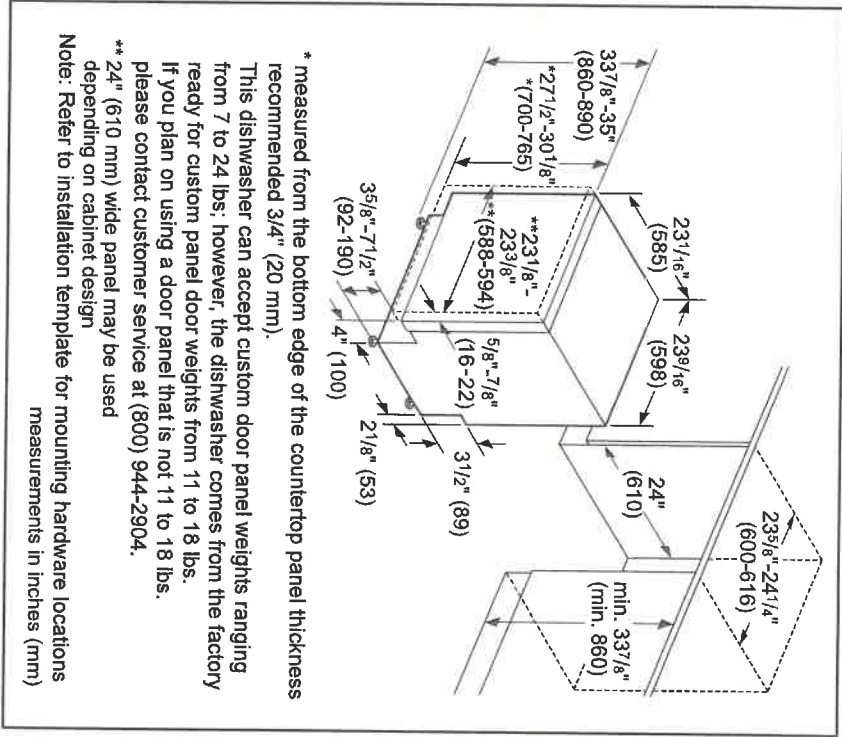

For help and assistance with Bosch accessories please call 1-800-944-2904 Mon-Fri 5am to 6pm PST Sat 6am to 3pm PST

Notes: All height, width and depth dimensions are shown in inches. BSH reserves the absolute and unrestricted right to change product materials and specifications, at any time, without notice. Consult the product's installation instructions for final dimensional data and other details prior to making cutout. Applicable product warranty can be found in accompanying product literature or you may contact your account manager for further details.

Warranties: Bosch warrants that the Product is free from defects in materials and workmanship for a period of three hundred and sixty-five (365) days from the date of purchase. The foregoing timeline begins to run upon the date of purchase, and shall not be stalled, tolled, extended, or suspended, for any reason whatsoever. This Product is also warranted to be free from cosmetic defects in material and workmanship (such as scratches or stainless steel, paint/porcelain blemishes, chip, dents, or other damage) to the finish of the Product, for a period of thirty (30) days from the date of purchase or closing date for new construction. This cosmetic warranty excludes slight color variations due to inherent differences in painted and porcelain parts, as well as differences caused by kitchen lighting, product location, or other similar factors. This cosmetic warranty specifically excludes any display, floor, "As Is", or "B" stock appliances.

For more information on our entire line of products, go to www.bosch-home.ca or call 1-800-944-2904

© BSH Home Appliances Limited. All rights reserved. Bosch is a registered trademark of Robert Bosch GmbH.

24" Custom Panel Dishwasher

300 Series DLX – Custom Panel SHV863WD3N



Installation Details

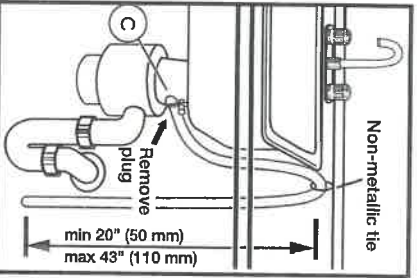
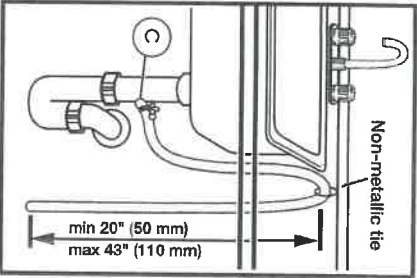

Note: Plumbing installations will vary - refer to local codes. Drain hose included is 79 (201 cm) and can be extended to a maximum of 155 3/4" (396 cm).

Always use the approved drain hose extension kit (SGZ1010UC).

Ensure a portion of the drain hose is raised between min. 20" (50 cm) and max. 43" (110 cm) above the cabinet floor.

1564
MAY 18 2018

For help and assistance with Bosch accessories please call 1-800-944-2904 Mon-Fri 9am to 6pm PST Sat 9am to 3pm PST

Notes: All height, width and depth dimensions are shown in inches. BSH reserves the absolute and unrestricted right to change product materials and specifications, at any time, without notice. Consult the product's installation instructions for final dimensional data and other details prior to making cutout. Applicable product warranty can be found in accompanying product literature or you may contact your account manager for further details.

Warranties: Bosch warrants that the Product is free from defects in materials and workmanship for a period of three hundred and sixty-five (365) days from the date of purchase. The foregoing timeline begins to run upon the date of purchase, and shall not be stalled, tolled, extended, or suspended, for any reason whatsoever. This Product is also warranted to be free from cosmetic defects in material and workmanship (such as scratches of stainless steel, paint/porcelain blemishes, chip, dents, or other damage) to the finish of the Product, for a period of thirty (30) days from the date of purchase or closing date for new construction. This cosmetic warranty excludes slight color variations due to inherent differences in painted and porcelain parts, as well as differences caused by kitchen lighting, product location, or other similar factors. This cosmetic warranty specifically excludes any display, floor, "As Is", or "B" stock appliances.

For more information on our entire line of products, go to www.bosch-home.ca or call 1-800-944-2904

© BSH Home Appliances Limited. All rights reserved. Bosch is a registered trademark of Robert Bosch GmbH.



FRONT LOAD WASHER

5.1 Cu. Ft. I.E.C.

EFLS627U TT/IW

Perfect Steam™ Washer with LuxCare® Wash, SmartBoost™ and iQ-Touch™ Controls

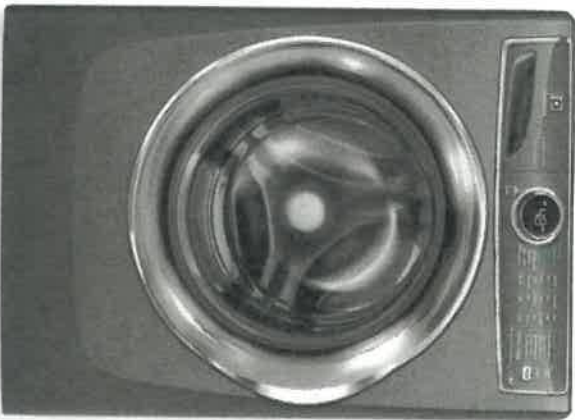

SIGNATURE FEATURES



THE MOST EFFECTIVE STAIN-REMOVING WASHER WITH SMARTBOOST™

Unlike other washers, our washer with SmartBoost™ premixes water and detergent before the cycle begins, maximizing the cleaning power of the detergent.



WORLD'S 1ST ADAPTIVE DISPENSER™ DESIGNED TO ACCEPT PODS®

Get the ultimate clean no matter what type of detergent you prefer with the Adaptive Dispenser™.



PERFECT STEAM™ REMOVES TOUGH STAINS

Unlike many washers, our Perfect Steam™ rises from the bottom, gently lifting dirt and stains from fibers.



THOROUGH CLEANING WITH THE LUXCARE® WASH SYSTEM

Our LuxCare® Wash System offers a thorough clean with improved wash actions, temperature control, and smart load sensing.

PRODUCT DIMENSIONS

Height	38"
Width	27"
Depth	32"

MORE EASY-TO-USE FEATURES

15-MINUTE FAST WASH¹

Quickly deep cleans the items you need most.

SOLID SOIL LEVEL CLEANS CAKED-ON STAINS

The solid soil level gives you a deeper clean to get rid of those tough stains that get caked on, like mud or dirt.

SANITIZE OPTION

Certified to kill and remove 99% of bacteria and 95% of allergens.²

STAINSOAK™ OPTION ELIMINATES PRE-TREAT

Unlike other washers, it starts by premixing water, detergent, and stain remover before the cycle begins to create a powerful, yet gentle cleaning solution. Then, the temperature, tumbling actions, and time are optimized based on the stain you select.

ENERGY STAR®-CERTIFIED

Electrolux washers meet strict criteria to guarantee high-quality energy efficient performance — without sacrificing clean.

ACTIVEWEAR CYCLE

Takes care of delicate and expensive activewear garments.

10-YEAR MOTOR WARRANTY

PLUS LIFETIME TUB WARRANTY
Rest easy knowing your washer is backed by a 10-year motor and lifetime tub warranty.

PERFECT BALANCE® SYSTEM & SECOND FLOOR GUARANTEE

Balances loads for smooth, quiet operation. So quiet you can even run your washer on the second floor or near bedrooms without noticing it.³

FITS MORE ROOMS WITH REVERSIBLE WASHER DOOR

With reversible washer door, four-way venting, and a standard 27" platform, our products are designed to fit just about anywhere you want to put them.

EXTRA LARGE CAPACITY

Easily cleans a king-sized comforter with extra large 5.1 cu. ft. drum.

Available in:



1501

¹Test time based on 3 lb. DDT load.
²Our products meet the NSF® testing standards.
³We tested an unconventional load line construction with no vibration.
MAY 18 2018

FRONT LOAD WASHER

EFLS627U TT/IW



27" FRONT LOAD WASHER	
Capacity I.E.C.	5.1 Cu.Ft.

FEATURES

Pull-to-Open Door	Yes
iQ-Touch™ Controls	Yes
Perfect Steam™ Wash System	Yes
Balance System	Perfect Balance®
Sound System	Luxury-Quiet™
Lighting	Luxury-Design®
Adaptive Dispenser™	Yes
Wash System	LuxCare®
Integral Water Heater	Yes
Wash Drum	Stainless Steel
Automatic Temperature Control	Yes
Automatic Water Level Adjustment	Yes
Auto Prewash Detergent Dispenser (Liquid/Powder)	Yes
Auto Bleach Dispenser (Liquid Only)	Yes
Auto Detergent Dispenser (Liquid/Powder/PODS™)	Yes
Auto Fabric Softener Dispenser (Liquid Only)	Yes
Tumble Speed (RPM)	Variable
Spin Speed (RPM)	1,300
Reversible Door	Yes
Adjustable Leveling Legs	Yes
ENERGY STAR®	Yes
NSF® Certified/Sanitize	Yes

CYCLES

Heavy Duty, Whites, Whites, Normal, Adwarear, Colors, 15-Min. Fast Wash, Delicates, Rinse & Spin, Clean Washer

9

OPTIONS

Wash/Rinse Temperature Combinations	7
Temperature Selections	5
Add Steam	Yes
Spin Speed Selections	5
Soil Level Selections	5
Delay Start	Yes
End-of-Cycle Chime	On/Off

INSTALLATION OPTIONS

Freestanding, Under Counter*, Stacked (Under Dryer), Pedestal, Hidden (In Closet), Second Floor	Yes
---	-----

ACCESSORIES

Luxury-Glide® Pedestal with Spacious Storage Drawer-Island White - PN# EFW025T11T	Optional
Island White - PN# EFW025T11W	Optional
Dryer Stacking Kit - PN# STACK17X	Optional
Drain Hose Extension Kit - PN# 137098000	Optional

SPECIFICATIONS

Colour -	
Titanium	TT
Island White	IW
Power Supply Location	Top Right Rear
Water Inlet Location	Top Left Rear
Voltage Rating	120V/60Hz
Connected Load (kW Rating)@ 120 Volts†	1.2
Watts @ 120 Volts	1,200
Amps @ 120 Volts	12
Shipping Weight (Approx.)	247 Lbs.

* Side-by-side units in under-counter installation require custom-built surrounding and/or cabinetry.
† An electrical supply with grounded three-wire, 120V/60Hz is required for models TT and IW.
NOTE: Always consult local and national electric and plumbing codes, refer to Product Installation Index for detailed installation instructions or the web at electroluxappliances.ca
Specifications subject to change.

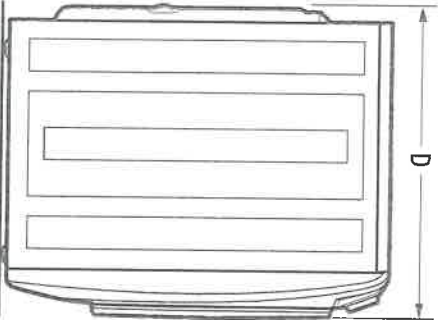
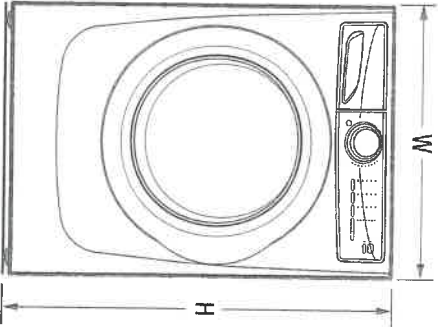

PRODUCT DIMENSIONS

Height (without 1.5" Pedestal)	38"
Width (1.5" Pedestal)	53-1/4"
Width	27"
Depth (to Centre of Arc Not including Hose)	32"
Depth (With Door 90° Open)	50-5/8"

Electrolux Major Appliances, N.A.

CANADA • 5855 Terry Fox Way • Mississauga, ON L5V 3E4 • 1-800-265-8352 • electroluxappliances.ca
EFLS627U 05/18

MAY 1 8 2018



High standards of quality at Electrolux Home Products, Inc. mean we are constantly working to improve our products. We reserve the right to change specifications or discontinue models without notice.
Printed in Canada

FRONT LOAD WASHER

EFLS627U TT /NW

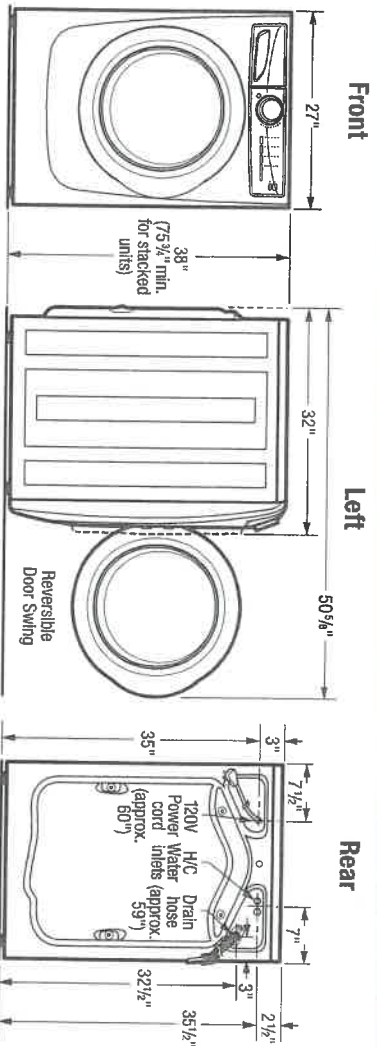

15" Pedestal Drawer Installation

Elevates washer height to 53 1/4". For detailed pedestal installation, refer to instructions included with pedestal or on web. Pedestal installation may require modified utility hookup locations. For details, refer to Product Installation Guide on web.

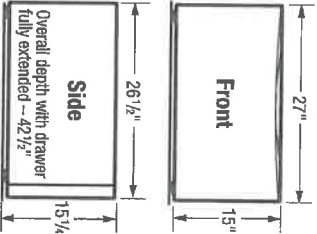

Built-In Installations

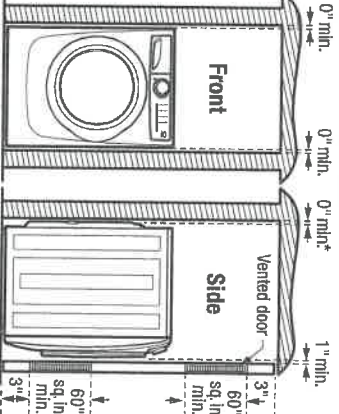

*Installation with steam dryer requires additional 3/4" hose clearance.

Closet Installation: If washer and dryer are installed in same closet, door(s) MUST be vented with 120 sq. in. minimum (lowered opening, equally divided, located 3" from top and bottom of door. Lowered door(s) with equivalent air openings for full-length of door is acceptable. Air openings MUST remain unobstructed with door(s) installed.

Installation Clearances:

Washer can be built in alone or with dryer (side by side or stacked) in closet, recess or under counter installation with 0" minimum clearance required around sides and back of unit(s). To achieve 0" minimum rear clearance when installed with dryer, dryer MUST be vented straight back or with quick-turn 90° elbow. Steam dryer requires additional 1/4" steam hose clearance at back of unit(s). Installation of closet door(s) requires additional 1" minimum clearance between front of unit(s) and door(s). Location of plumbing, exhaust and utility hookups MUST be considered when planning any built-in installation. For additional installation details, refer to Product Installation Guides on web.

Under Counter Installation:

Installation of washer alone or side by side with dryer under counter, requires custom-built countertop and/or cabinetry to accommodate unit(s) height.

Stacking Units:

Stacking dryer above washer requires use of optional Stacking Kit (PN# STACKKITX) with modified utility hookup locations for dryer. For complete installation details, refer to instructions included with Stacking Kit or on web.

Front Load Washer Specifications

- Product Weight – 237 Lbs. / Shipping Weight – 247 Lbs.
- An electrical supply with grounded three-prong receptacle is required. The power supply circuit must be installed in accordance with current edition of National Electrical Code (ANSI/NFPA 70) and local codes & ordinances. (Do not use same circuit as dryer.)
- Voltage Rating – 120V/60Hz
- Connected Load (KW Rating) @ 120 Volts = 1.2 KW
- Amps @ 120V = 12A
- Equipped with 120V 3-wire power supply cord, approx. 60" long.
- Always consult local and national electric & plumbing codes.
- To maximize detergent effectiveness, ambient temperature should never be below 60°F.
- Can be installed alone, with or without optional 15" pedestal drawer, or stacked beneath matching Electrolux Dryer, which requires installation of optional dryer stacking kit. (For installation details, refer to instructions included with optional pedestal or stacking kit or on web.)
- Can be built in alone or with matching Electrolux Dryer (side by side or stacked) in closet, recess or under counter installation with 0" minimum clearance required around sides and back of unit(s). To achieve 0" minimum rear clearance when installed with dryer, dryer MUST be vented straight back or with quick-turn 90° elbow. Steam dryer requires additional 3/4" steam hose clearance at back of unit(s). Installation of closet door(s) requires additional 1" minimum clearance between front of unit(s) and door(s). Location of plumbing, exhaust and utility hookups MUST be considered when planning any built-in installation.
- Under-counter installation requires custom-built countertop and/or cabinetry to accommodate unit(s) height.

- Do NOT install in area exposed to dripping water or outdoor weather conditions, or where gasoline or other flammables, including automobiles, are kept or stored.
- For garage installation, washer MUST be located minimum 18" above floor.
- Floor MUST be solid with 1" maximum slope. To ensure vibration or movement does not occur, reinforcement of floor may be necessary. Do NOT install on carpeted surface.
- Leveling legs supplied to level washer properly and reduce excessive noise and vibration.
- H/C water faucets MUST be installed within 42" of washer's water inlet and MUST be 3/4" garden hose type, to connect to 48-1/2" inlet hoses.
- Water pressure MUST be between 20 and 120 psi with NOT more than 10 psi pressure difference between hot and cold.
- Drain required with standpipe diameter of 1 -1/4" min. and height of 24" min./ 96" max. above floor, capable of eliminating 17 gallons per minute. Attached 59" drain hose can reach 79"-high standpipe.

Note: For planning purposes only. Refer to Product Installation Guide on the web at electroluxappliances.ca for detailed instructions.

Optional Accessories

- Pedestal Drawers – Titanium (PN# EPWD25UTT), Island White (PN# EPWD25UW).
- Dryer Stacking Kit – (PN# STACKKITX).
- Drain Hose Extension Kit – (PN# 137098000).

Electrolux Major Appliances, N.A.

CANADA • 5855 Terry Fox Way • Mississauga, ON L5V 3E4 • 1-800-265-8352 • electroluxappliances.ca
EFLS627U 05/18

© 2018 Electrolux Major Appliances, N.A.

150N MAY 18 2018



High standards of quality at Electrolux Home Products, Inc. mean we are constantly working to improve our products. We reserve the right to change specifications or discontinue models without notice.

Printed in Canada



ELECTRIC FRONT LOAD DRYER

8.0 Cu. Ft.

EFMC627U TT/IW

Perfect Steam™ Dryer with Instant Refresh™ and IQ-Touch™ Controls

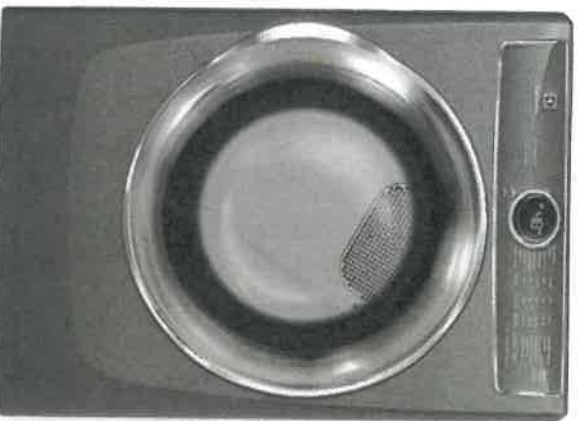

SIGNATURE FEATURES



PREDICTIVE DRY™ MORE ACCURATELY PREDICTS DRY TIMES

Knows after 90 seconds a more accurate time your clothes will be dried to perfection so you don't have to keep checking on your load.



HELP PREVENT OVER- OR UNDER- DRYING WITH LUXCARE® DRY SYSTEM

A more precise sensor for a better dry to protect your clothes from over-drying, but also to help make sure you don't have wet clothes left in the load.



INSTANT REFRESH™ CYCLE REVIVES FABRICS

Remove wrinkles and quickly refresh items with steam in 10 minutes.



15-MINUTE FAST DRY¹

Quickly dry the items you need most.

PRODUCT DIMENSIONS

Height	38"
Width	27"
Depth	31-1/2"

MORE EASY-TO-USE FEATURES

ENERGY STAR®-CERTIFIED

Rigorously tested to do more with less. Electrolux dryers meet strict criteria to guarantee high-quality energy efficient performance.

PERFECT STEAM™ WRINKLE RELEASE OPTION

Gently releases wrinkles and reduces static to keep clothes looking their best.

EXTENDED TUMBLE OPTION KEEPS CLOTHES TANGLE-FREE

Gently tumbles your clothes without heat to keep them tangle-free — perfect for when you cannot remove clothes right after the cycle ends.

LUXCARE® LINT SHIELD HELPS AVOID MESSSES

Traps lint so it doesn't make a mess, even if you empty it while there are clothes in the dryer.

ACTIVEWEAR CYCLE

Takes care of delicate and expensive activewear garments.

EXTRA-LARGE CAPACITY DRYER

Dry more in each load with our 8.0 cu. ft. dryers.

PLATINUM STAR® LIMITED WARRANTY

Our exclusive limited warranty that includes three-year coverage on parts and one year on labour.*

9 CYCLES TO CARE FOR EVERY FABRIC

Perfectly dry every item with tailored cycles for towels, allergen, delicates, and more.

FITS MORE ROOMS WITH REVERSIBLE DOOR

Enjoy easy loading no matter how your washer and dryer are configured.

OPTIONAL PEDESTALS AND STACKING KIT FOR MORE INSTALLATION OPTIONS

Raise your units with optional pedestal drawers that provide extra storage. Or use the optional stacking kit for convenient placement in small spaces.

Available in:



156N

MAY 18 2018

*Fastest time based on smallest load/first dry cycle selected for various load compositions. Eligibility based on product registration with Electrolux North America within 60 days of purchase. Products must have been purchased on or after July 1, 2013. See limited warranty for details. Limited time offer.

ELECTRIC FRONT LOAD DRYER

EFMC627U TT/IW



27" ELECTRIC FRONT LOAD DRYER

Capacity D.O.E. 8.0 Cu.Ft.

FEATURES

Pull-to-Open Door	Yes
16-Touch™ Controls	Yes
Perfect Steam™ Dry System	Yes
Dry System	Predictive Dry™
Sound System	Luxury-Quiet™
Lighting	Luxury-Design® LED
Tumble System	Gentle Tumble™
Moisture Sensor	Yes
Dryer Drum	Stainless Steel
Tumble Speed (RPM)	50
Reversible Door	Yes
Adjustable Leveling Legs	Yes
ENERGY STAR®	Yes

CYCLES

Timed Dry (30, 45, 60, 75), Allergen, Heavy Duty/Towels, Normal,™ 15-Min, Fast Dry, Activewear, Mixed Load, Delicates, Instant Refresh

OPTIONS

Temperature Selections	5
Add Steam	Yes
Electronic Auto Dry System	Yes
Manual Timed Dry Selections	4
Delay Start (Hours)	12
End-of-Cycle Chime	On/Off
Extended Tumble	Yes
Anti-Static	Yes
Line Dry	Yes
Dryness Levels	5

INSTALLATION OPTIONS

Freestanding, Under Counter*, Stacked (Above Washer), Pedestal, Hidden (In Closet), Second Floor	Yes
4-Way Dryer Venting	Yes

ACCESSORIES

Luxury-Glide® Pedestal with Spacious Storage Drawer—Titanium — PN# EFMD257JDT	Optional
Island White — PN# EFMD257JWW	Optional
Dryer Stacking Kit — PN# STACKD7X	Optional
Drying Rack — PN# A04940701	Optional
Assembly Hose Kit — PN# 5394195002	Optional

SPECIFICATIONS

Colour — Titanium	TT
Island White	IW
Maximum Exhaust Duct Length** (Ft.)	125
Power Supply Connection Location	Rear
Voltage Rating	240V/60 Hz/30A
Connected Load (KW Rating) @ 240 Volts	6.0
Amps @ 240 Volts	25
Heating Element @ 240 Volts (Watts)	5,400
Shipping Weight (Approx.)	140 Lbs.

*Side-by-Side units in under-counter installation require custom-built countertop and/or cabinet.
**Dryer ducts should be properly sized, sealed, supported, and installed according to the manufacturer's instructions.
*Based on web site information and national electric and plumbing codes. Refer to product installation guide for detailed installation instructions on the web at electroluxappliances.ca.
NOTE: Always consult local and national electric and plumbing codes. Refer to product installation guide for detailed installation instructions on the web at electroluxappliances.ca.
Specifications subject to change.

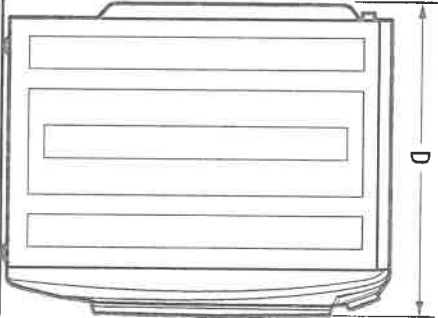
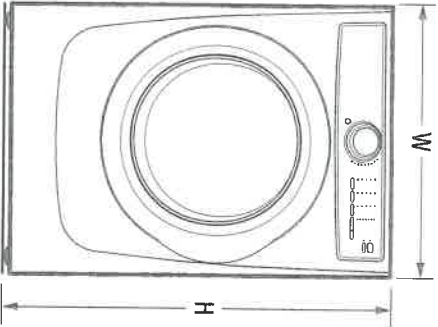

PRODUCT DIMENSIONS

Height (without 15" Pedestal)	38"
Height (with 15" Pedestal)	53-1/4"
Width	27"
Depth (to Centre of Arc Not including Hose)	31-1/2"
Depth (with Door 90° Open)	50-5/8"

Electrolux Major Appliances, N.A.

CANADA • 5855 Terry Fox Way • Mississauga, ON L5V 3E4 • 1-800-265-8352 • electroluxappliances.ca
EFMC627U 05/18

15704

MAY 18 2018



High standards of quality at Electrolux Home Products, Inc. mean we are constantly working to improve our products. We reserve the right to change specifications or discontinue models without notice.
Printed in Canada

ELECTRIC FRONT LOAD DRYER

EFMC627U TT/1W

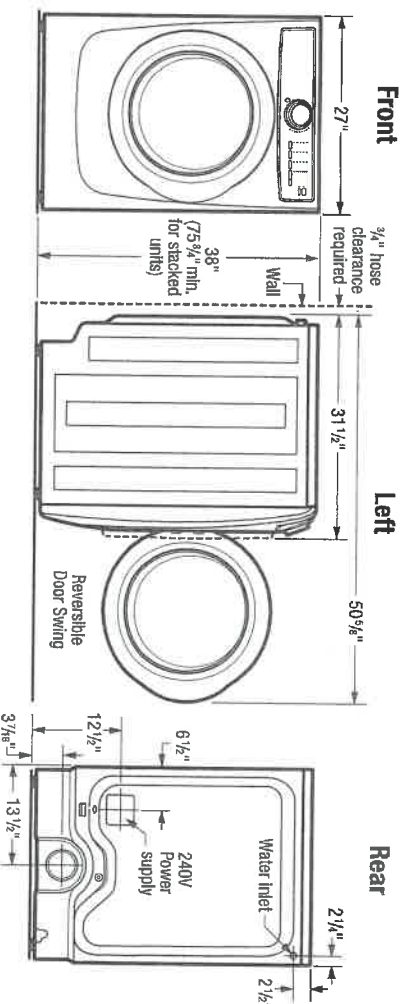

15" Pedestal Drawer Installation

Elevates dryer height to 53 1/4". For detailed pedestal installation, refer to instructions included with pedestal or on web. Pedestal installation may require modified utility hookup locations. For details, refer to Product Installation Guide on web.

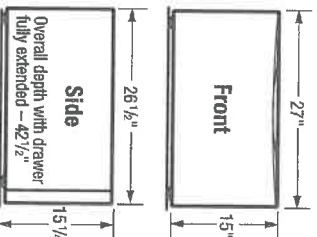

Built-In Installations

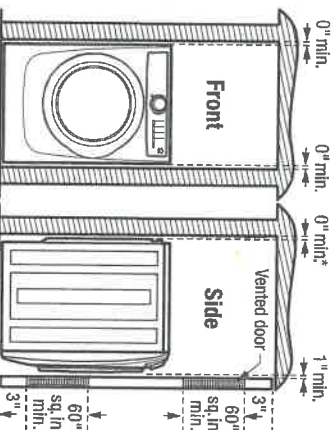

*Steam dryer requires additional 3/4" hose clearance.

Closet Installation:

If washer and dryer are installed in same closet, door(s) MUST be vented with 120 sq. in. minimum louvered opening, equally divided, located 3" from top and bottom of door. Louvered door(s) with equivalent air openings for full-length of door is acceptable. Air openings MUST remain unobstructed with door(s) installed.

Stacking Units:

Stacking dryer above washer requires use of optional Stacking Kit (PN# STACKIT7X) with modified utility hookup locations for dryer. For complete installation details, refer to instructions included with Stacking Kit or on web.

Under Counter Installation:

Installation of dryer alone or side by side with washer under counter, requires custom-built countertop and/or cabinetry to accommodate unit(s) height.

Electric Dryer Specifications

- Product Weight – 130 Lbs. / Shipping Weight – 140 Lbs.
- Voltage Rating – 240 / 60 Hz / 30A
- Single phase 3- or 4-wire cable, 240 Volt, 60 Hertz AC only electrical supply with ground required on separate circuit fused on both sides of line. *(Do not use same circuit as washer.)*
- Connected Load (kW Rating) @ 240 Volts = 6.0 kW
- Amps @ 240V = 25A
- Dryer MUST employ a 3-conductor NEMA 10-30 type SRDT or 4-conductor NEMA 14-30 type SRDT or ST (as required), rated at 240 volt AC minimum, 30 amp power supply cord marked for use with clothes dryers *(not supplied)*.
- Grounding through neutral link prohibited in specific applications and certain locales, requiring use of 4-wire system. *(For detailed electrical requirements, refer to Product Installation Guide on web.)*
- Always consult local and national electric & plumbing codes.
- Can be installed alone, with or without optional 15" pedestal drawer, or stacked above matching Electrolux Washer, which requires installation of optional dryer stacking kit. *(For installation details, refer to instructions included with optional Pedestal or stacking kit or on web.)*
- Can be built in alone or with matching Electrolux Washer *(side by side or stacked)* in closet, recess or under counter installation with 0" minimum clearance required around sides and back of unit(s). To achieve 0" minimum rear clearance, dryer MUST be vented straight back or with quick-turn 90° elbow. Steam dryer requires additional 3/4" steam hose clearance at back of unit(s). Installation of closet door(s) requires additional 1" minimum clearance between front of unit(s) and door(s). Location of plumbing, exhaust and utility hookups MUST be considered when planning any built-in installation.
- Under-counter installation requires custom-built countertop and/or cabinetry to accommodate unit(s) height.

- Do NOT install in area exposed to dripping water or outdoor weather conditions, or where gasoline or other flammables, including automobiles, are kept or stored.
- For garage installation, dryer MUST be located minimum 18" above floor.
- Floor MUST be solid with 1" maximum slope. To ensure vibration or movement does not occur, reinforcement of floor may be necessary. Do NOT install on carpeted surface.

- Dryer MUST exhaust to outside of building, NOT into any concealed space.
- Dryer equipped for 4-way venting and approved for up to 125-foot-equivalent of duct length, determined by length of run and number of elbows needed.
- Exhaust installation requires minimum 4"-diameter rigid or semi-rigid metal duct with approved, unobstructed vent hood having swing-out damper(s). If installing rigid metal duct (preferred), do not exceed MAXIMUM venting run length of 125 ft., allow deductions for elbows and vents. If installing semi-rigid metal duct, do not exceed MAXIMUM venting run length of 8 ft., always allow deductions for elbows and vents. *(Refer to Product Installation Guide on web for additional information).*
- Do NOT use flexible plastic or metal foil duct and/or restrict in possible.
- Leveling legs supplied to level dryer properly and reduce process noise and vibration.

- Water inlet hose for steam setting connects to cold water supply with "Y" connector and requires 3/4" clearance between back of unit and wall.

Note: For planning purposes only. Refer to Product Installation Guide on the web at electroluxappliances.ca for detailed instructions.

Optional Accessories

- Pedestal Drawers – Titanium (PN# EPWD257UTT), Island White (PN# EPWD257UW).
- Dryer Stacking Kit – (PN# STACKIT7X).
- Drying Rack – (PN# A04840701).
- Assembly Hose Kit – (PN# 5304495002).

Electrolux Major Appliances, N.A.

CANADA • 5855 Terry Fox Way • Mississauga, ON L5V 3E4 • 1-800-265-8352 • electroluxappliances.ca
EFMC627U 05/18

MAY 18 2018



High standards of quality at Electrolux Home Products, Inc. mean we are constantly working to improve our products. We reserve the right to change specifications or discontinue models without notice.

Printed in Canada