

CONSTRUCTION SUMMARY OF EXTRAS  
Printed 2020-12-01 / 9:08 AM / Page 1 of 2

Site:

Lot:

Model:

Purchaser:

Phone/Email:

KING VILLAGE  
2-12  
TH-05 (A-1)  
F. CORTELLUCCI  
SIMONE 416-843-7270



DESCRIPTION		DATE SELECTED
#1	APPLIANCES - SEE SPECS	NOV 26 2020
KITCHEN		
#2	KITCHEN - CATEGORY 4 CABINETS (CLASSIC GREY)	NOV 26 2020
#3	KITCHEN - BUILT-IN FRIDGE - PANEL READY	NOV 26 2020
#4	KITCHEN - STRAIGHT PANTRY CABINET BESIDE FRIDGE 26" DEEP (IN LIEU OF BASE & UPPER)	NOV 26 2020
#5	KITCHEN - 4 INTERIOR PULL OUT DRAWERS (SOFT CLOSE)	NOV 26 2020
#6	KITCHEN - 1 SPICE PULL OUT UNITS WITH 2 BASKETS	NOV 26 2020
#7	KITCHEN - MAGIC CORNER WITH ANTI SLIP BASKET	NOV 26 2020
#8	KITCHEN - 1 SET OF POT DRAWERS (SOFT CLOSE) AND 1 SET IN LIEU OF STANDARD BANK (2 SETS TOTAL)	NOV 26 2020
#9	KITCHEN - 2 DUMMY DOORS FOR BASE (DOWN TO THE FLOOR)	NOV 26 2020
#10	KITCHEN - 2 BIN GARBAGE RECYCLER IN ISLAND (STANDARD)	NOV 26 2020
#11	KITCHEN - INCREASE UPPER CABINET DEPTH TO BE 13-3/4"	NOV 26 2020
#12	KITCHEN - UPPER L-SHAPED CORNER CABINET	NOV 26 2020
#13	KITCHEN - DISHWASHER PANEL	NOV 26 2020
#14	KITCHEN - 24 INCH TALL CABINET WITH 1 EXTERIOR DRAWER TO ACCOMMODATE WINE FRIDGE	NOV 26 2020
#15	KITCHEN - SINGLE DUMMY DOOR PANEL ON BACK OF ISLAND & DUMMY DOOR ON ENDS	NOV 26 2020
#16	KITCHEN - 2-1/4" WIDE RAIL IN MATTE BLACK w/GREY SMOKED GLASS INSERT, LAMINATE INTERIOR COLOUR TBD, 5 PCES PF 10MM CLEAR GLASS SHELVES, LED PUCK LIGHTS ON TOP	NOV 26 2020
#17	KITCHEN - 100" HIGH CABINETS OVERALL WITH 8 INCH HIGH STEP FLAT CROWN TO CEILING	NOV 26 2020
#18	KITCHEN - VALANCE BOX WITH CUT-OUTS	NOV 26 2020
#19	KITCHEN - CONVERT STD BANK INTO POT DRAWERS	NOV 26 2020
#20	KITCHEN - PANEL FOR WINE FRIDGE	NOV 26 2020
#21	KITCHEN - 3 INCH WIDE COLUMNS WITH 3/4" DETAIL ON EITHER SIDE OF FRIDGE	NOV 26 2020
#22	KITCHEN - AUTOSIZED HANDLE AND APPLIANCE HANDLES	NOV 26 2020
#23	KITCHEN - COUNTERTOP UPGRADE 5 **TO BE TAGGED	NOV 26 2020
#24	KITCHEN - UPGRADE SINK TO BLANCO SUPER SINGLE 401518	NOV 26 2020
#25	KITCHEN - BACKSPLASH - UPGRADE 5 **INCLUDES BEHIND CHIMNEY	NOV 26 2020
#26	QTK TOTAL (WHOLE HOUSE - KITCHEN & BATHS)	NOV 26 2020
LAUNDRY		
#27	LAUNDRY - 39-1/2" UPPEERS , 1-1/2" FLOATING SHELF & HANGING ROD ABOVE SINK CABINET	NOV 26 2020
#28	TILES - LAUNDRY UPGRADE 2	NOV 26 2020
#29	LAUNDRY COUNTERTOP - STONE - UPGRADE 3	NOV 26 2020
#30	LAUNDRY - UPGRADE SINK TO BLANCO 401802 HORIZON	NOV 26 2020
#31	LAUNDRY FAUCET - UPGRADE TO MOEN RILEY PULL DOWN	NOV 26 2020
MASTER ENSUITE		
#32	MASTER ENSUITE - SHOWER NICHE	NOV 26 2020
#33	MASTER ENSUITE - CABINETS CATEGORY 2	NOV 26 2020
#34	MASTER ENSUITE - COUNTERTOP UPGRADE 3 **INCLUDES RECTANGLE UNDERMOUNTS	NOV 26 2020
#35	TILES - MASTER ENSUITE FLOOR & WALL - UPGRADE 5 **INSTALL FLOOR TILE ONLY IN CHEVRON PATTERN	NOV 26 2020
#36	TILES - MASTER ENSUITE SHOWER FLOOR & SHOWER JAMB	NOV 26 2020

CONSTRUCTION SUMMARY OF EXTRAS

Printed 2020-12-01 / 9:08 AM / Page 2 of 2

Site: KING VILLAGE  
Lot: 2-12  
Model: TH-05 (A-1)  
Purchaser: F. CORTELLUCCI  
Phone/Email: SIMONE 416-843-7270



DESCRIPTION		DATE SELECTED
MAIN BATH		
#37	MAIN BATH - CABINET'S CATEGORY 2	NOV 26 2020
#38	MAIN BATH - COUNTERTOP UPGRADE 3 **INCLUDES RECTANGLE UNDERMOUNTS	NOV 26 2020
#39	TILES - MAIN BATH FLOOR AND WALL - UPGRADE 3	NOV 26 2020
TILES / HARDWOOD		
#40	HARDWOOD - MAIN FLOOR STANDARD AREAS - UPGRADE 3	NOV 26 2020
#41	HARDWOOD - KITCHEN IN LIEU OF TILE UPGRADE 3	NOV 26 2020
#42	HARDWOOD - BREAKFAST IN LIEU OF TILE UPGRADE 3	NOV 26 2020
#43	HARDWOOD - IN ALL BEDROOMS IN LIEU OF CARPET	NOV 26 2020
#44	TILES - FOYER UPGRADE 5	NOV 26 2020
#45	TILES - POWDER ROOM & MUDROOM UPGRADE 5	NOV 26 2020
POWDER ROOM		
#46	POWDER ROOM - UPGRADE PEDESTAL SINK TO AVENUE MADISON CONE LCB-1717A-W	NOV 26 2020
ELECTRICAL		
#47	ELECTRICAL - POTLIGHTS (6) IN GREAT ROOM **N/C INCLUDED IN APS	NOV 26 2020
#48	ELECTRICAL - POTLIGHTS (3) IN MAIN HALL **N/C INCLUDED IN APS	NOV 26 2020
#49	ELECTRICAL - POTLIGHTS (1) IN POWDER ROOM ON SAME SWITCH AS STD **N/C INCLUDED IN APS	NOV 26 2020
#50	ELECTRICAL - POTLIGHTS (2) MUDROOM, DELETE STD	NOV 26 2020
#51	ELECTRICAL - POTLIGHTS (5) KITCHEN AROUND ISLAND, MOVE STANDARD OVER ISLAND AND ADD 1 ADDITIONAL CAPPED LIGHTS (3 OVER ISLAND IN TOTAL)	NOV 26 2020
#52	ELECTRICAL - POTLIGHTS (4) MASTER BEDROOM, SEP SWITCH, STD REMAINS	NOV 26 2020
#53	ELECTRICAL - POTLIGHTS (3) MASTER ENSUITE ON SEP SWITCH FROM STANDARD	NOV 26 2020
#54	ELECTRICAL - POTLIGHTS (4) IN MASTER BEDROOM WALK IN CLOSET, DELETE STD	NOV 26 2020
#55	ELECTRICAL - POTLIGHTS (5) IN UPPER HALL, STD LIGHT TO OVER THE STAIR LANDING	NOV 26 2020
#56	ELECTRICAL - POTLIGHTS (2) IN LAUNDRY, DELETE STD LIGHT	NOV 26 2020
#57	ELECTRICAL - PLUG FOR BAR FRIDGE IN KITCHEN	NOV 26 2020
#58	ELECTRICAL - PLUG FOR MICROWAVE IN KITCHEN	NOV 26 2020
#59	ELECTRICAL - PUCK LIGHTS IN KITCHEN & WIRING FOR LED STRIP LIGHTING IN GLASS UNITS **QTK TO PROVIDE THE LIGHTING FOR THE LED STRIPS	NOV 26 2020
#60	HVAC - GAS LINE TO STOVE **INCLUDES 15 AMP PLUG	NOV 26 2020
#61	PAINT - UPGRADE (SEE COLOUR CHART)	NOV 26 2020
#62	TRIM - UPGRADE 1	NOV 26 2020
#63	TRIM - INTERIOR HANDLES - MATTE BLACK HALIFAX	NOV 26 2020
#64	TRIM - UPGRADE DOOR STYLE TO LIVINGSTON STYLE	NOV 26 2020
#65	DELETE WALL BETWEEN TOILET AREA AND VANITY IN MAIN BATH	NOV 26 2020
#66	INTERIOR DOORS - 8 FEET DOORS ON MAIN FLOOR & 7 FOOT ON SECOND **INCLUDING GARAGE MAN DOOR	NOV 26 2020
#67	TRAY CEILING IN MASTER BEDROOM	NOV 26 2020
#68	WAFFLE CEILING IN GREAT ROOM	NOV 26 2020
#69	MIRRORS - DO NOT INSTALL MIRROR IN POWDER ROOM	NOV 26 2020

ZANCOR HOMES COLOUR CHART

CABINETRY / COUNTERTOPS					
	DOOR STYLE	HARDWARE	COUNTERTOP	EDGE	
Kitchen	5801 FB - CLASSIC GREY (CAT 4)	DOORS DH09410	TBD		
Island	5801 FB - CLASSIC GREY (CAT 4)	DRAWERS DH09170	TBD		
Powder Room	PEDESTAL				
Master Ensuite	1022 - MERCURY OLMO AMBIENCE (3)		QUARZITE - DOVE		
Ensuite 2	1022 REFLECTION (2)		EMERSTONE HAVEN GRIS (3)		
Laundry UPPERS & LOWERS	1022 LAM - TUNDRA (CAT 2)		EMERSTONE PURE EXTRA (3)		
TILES					
Main Foyer	ROMA STATUARIO 12 X 24 **STACKED (5)				
Basement Foyer	N/A				
Powder Room	ROMA STATUARIO 12 X 24 **STACKED (5)				
Mud Room	ROMA STATUARIO 12 X 24 **STACKED (5)				
Kitchen	HARDWOOD				
Breakfast	HARDWOOD				
Kitchen Bk.Splash	ETERNA VOLKAS WHITE HERRINGBONE (MATTE) (5)				
Laundry	SILKSTONE AVORIO 12 X 24 (3) **STACKED				
Mstr Ensuite Floor	ROMA STATUARIO 12 X 24 (5) **CHEVRON				
Mstr Ensuite Shower WALL	ROMA STATUARIO 12 X 24 (5) **STACKED				
Master Shower Floor	ETERNA VOLKAS WHITE HERRINGBONE (MATTE) (5)				
Master Shower JAMB	MARMOLINE - SNOW				
Main Bath Floor	SILKSTONE AVORIO 12 X 24 (3) **STACKED				
Main Bath Wall	SILKSTONE AVORIO 12 X 24 (3) **STACKED				
HARDWOOD / CARPET					
Kitchen	HARDWOOD - VINTAGE WHITE OAK (UV URETHANE OIL) 5 INCH - ATLANTIS in lieu of tile (3)				
Breakfast	HARDWOOD - VINTAGE WHITE OAK (UV URETHANE OIL) 5 INCH - ATLANTIS in lieu of tile (3)				
Family Room	HARDWOOD - VINTAGE WHITE OAK (UV URETHANE OIL) 5 INCH - ATLANTIS (3)				
Main hall	HARDWOOD - VINTAGE WHITE OAK (UV URETHANE OIL) 5 INCH - ATLANTIS (3)				
Upper Hall	HARDWOOD - VINTAGE WHITE OAK (UV URETHANE OIL) 5 INCH - ATLANTIS (3)				
Master Bedroom	HARDWOOD - VINTAGE WHITE OAK (UV URETHANE OIL) 5 INCH - ATLANTIS (3) in lieu of carpet				
Bedroom 2	HARDWOOD - VINTAGE WHITE OAK (UV URETHANE OIL) 5 INCH - ATLANTIS (3) in lieu of carpet				
Bedroom 3	HARDWOOD - VINTAGE WHITE OAK (UV URETHANE OIL) 5 INCH - ATLANTIS (3) in lieu of carpet				
FIREPLACES					
LOCATION	GREAT ROOM	MANTLE	N/A		
MIRRORS & ACCESSORIES		PLASTER MOULDING			
Mirrors	YES		N/A		
Bathroom Accessories	NO	Opt. Crown Moulding	N/A		
Purchaser has reviewed the colour chart			SITE & LOT		
***FOR TRADE USE***			KING VILLAGE 2-12		
Any upgrades in the colour chart must be accompanied with a PES. It is the responsibility of all Trades to inform the builder of any discrepancies on sketches, PES and/or colour charts <u>PRIOR</u> to installation.					
** PAGE 1 OF 2 **			Purchaser Initial	Vendor	

ZANCOR HOMES COLOUR CHART

STAIRS, RAILING & PICKETS & STAIR STAIN									
Stair Stain / Species:		STAIN STAIRS TO MATCH HARDWOOD AS CLOSE AS POSSIBLE							
Railings PICKET DETAILS:		METAL - ALL PLAIN METAL PICKETS							
Railings POST & HANDRAIL DETAILS:		SQUARE OAK POST WITH REVEAL & SQUARE OAK HANDLE							
TRIM									
Casing/Baseboards		UPGRADE 1 - STEP STYLE							
Interior Doors		STANDARD STYLE							
Interior Door Hardware		STANDARD							
Exterior Door Hardware		STANDARD							
PAINT									
ALL BATHROOMS		TBD							
Main Floor		TBD							
Upper Hall		TBD							
All Bedrooms		TBD							
PLUMBING- UPGRADES TO BE DETAILED ON PES									
		FIXTURES	FAUCETS	NOTES					
Kitchen		UPGRADE SINK	STANDARD						
Powder room		UPGRADE PEDESTAL	STANDARD						
Master Ensuite		UPGRADE SINK	STANDARD						
Main Bath		UPGRADE SINK	STANDARD						
LAUNDRY		UPGRADE SINK	UPGRADE						
ZANCOR APPLIANCE REQUIREMENTS-UPGRADES TO BE DETAILED ON PES									
Appliance Package received in 'Schedule E'		YES / NO Package Name:							
		UPG (SEE PES)	DECLINED	NOTES					
GAS LINE TO STOVE		NO							
WATERLINE to Fridge		YES							
Hood Fan Venting SIZE		6 INCH							
ELECTRICAL for Built-in Oven		NO							
ELECTRICAL for Built-in Micro / OTR		YES							
ELECTRICAL for Gas Stove / Cooktop		NO							
ELECTRICAL for Bar Fridge		YES							
DISCLAIMER				INITIALS					
Colours of all materials are as close as possible to Builders selection but not necessarily identical due to dye lot variances in manufacturing/manufacturers. Due to construction progress some items may have been pre-selected or installed. In this event the Vendors's selection must be accepted by the purchaser									
Any changes to the colour chart after signing are subject to a \$5000 administration fee plus costs									
Purchaser has checked and acknowledged accuracy of colour and selections before signing.									
SITE:		KING VILLAGE	LOT: 2-12						
PURCHASER(S):		F. CORTELLUCCI							
HOME #/CELL #				Purchaser Signature		Date			
EMAIL:									
DÉCOR NOTES				Purchaser Signature		Date			
***FOR TRADE USE***									
Any upgrades in the colour chart must be accompanied with a PES. It is the responsibility of all trades to inform the builder of any discrepancies on sketches, PES and/or colour charts PRIOR to installation.									
				Décor Consultant Signature		Date			
				Vendor Signature		Date			

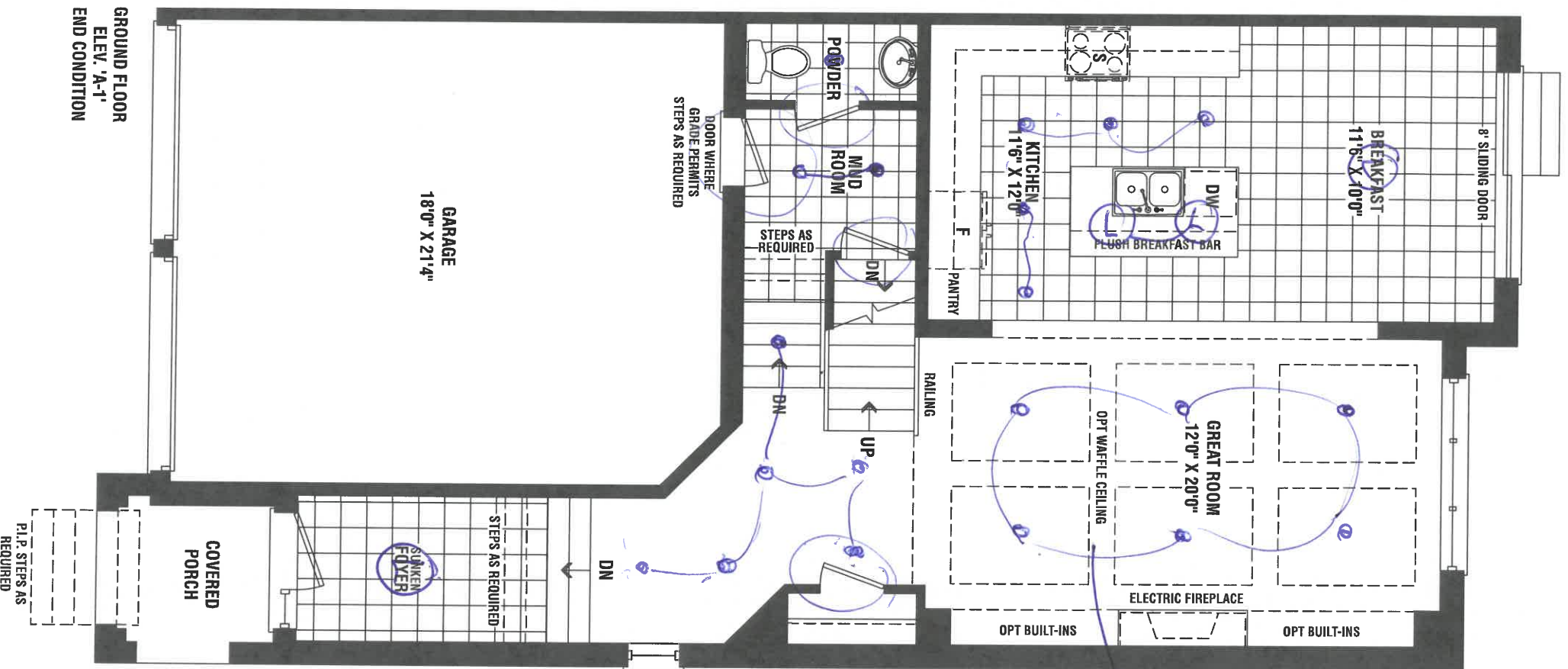

TH-5

2-12

WAFFLE

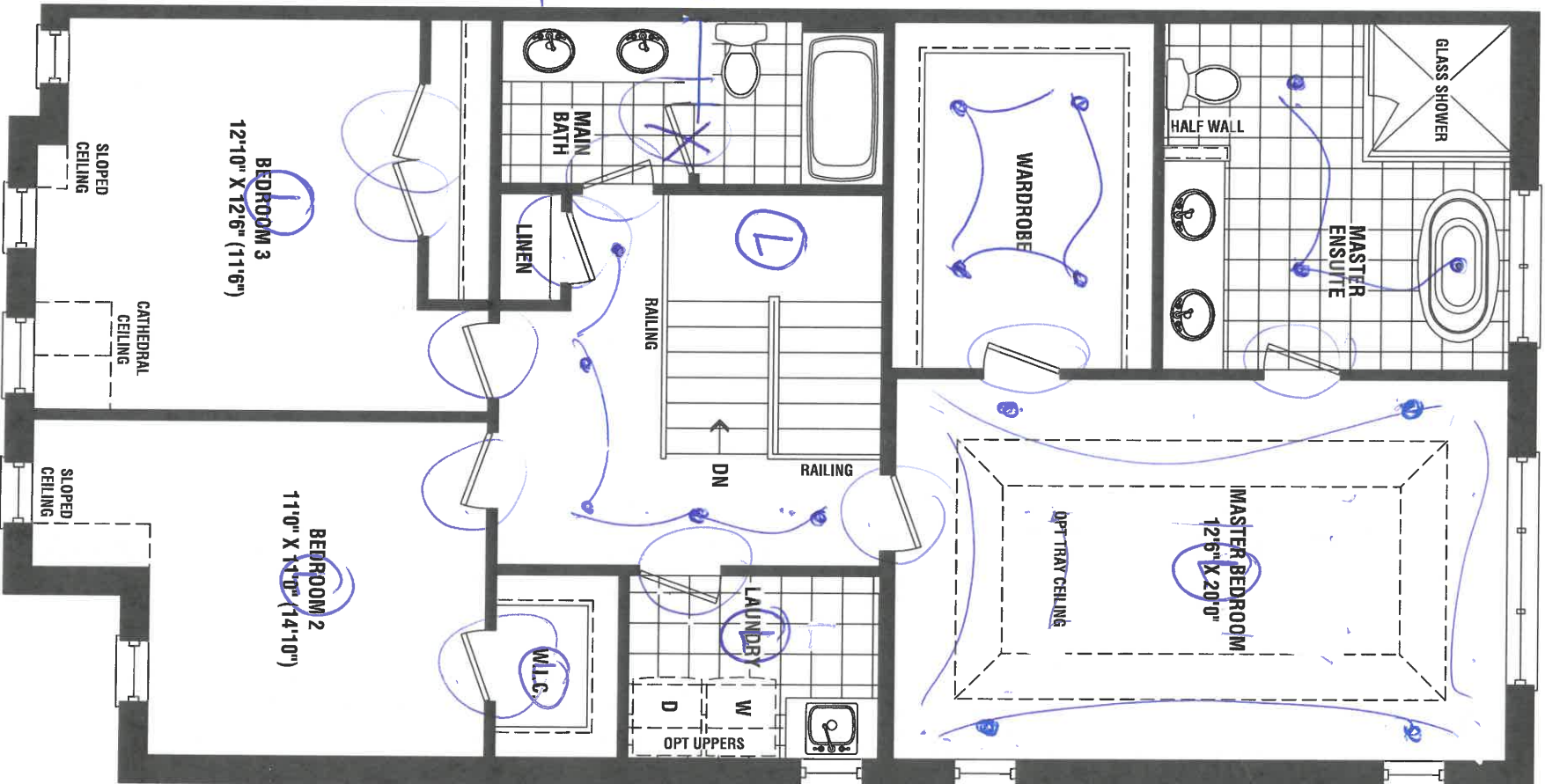

SECOND FLOOR  
ELEV. 'A-1'  
END CONDITION

TH-5

2-12

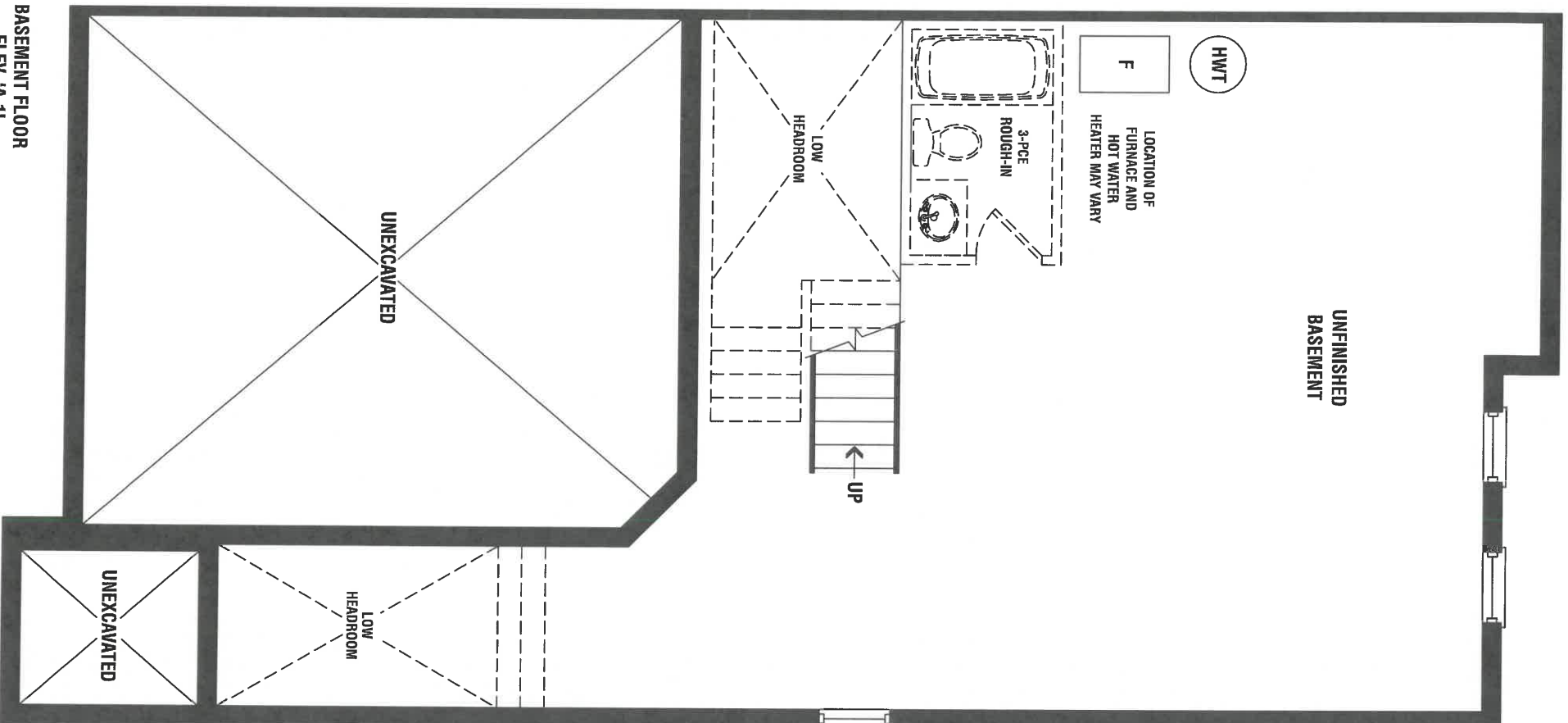

BASEMENT FLOOR  
ELEV. 'A-1'  
END CONDITION

TH-5

2-12

# MADISON

## LCM-1717A-W



### CONE PEDESTAL

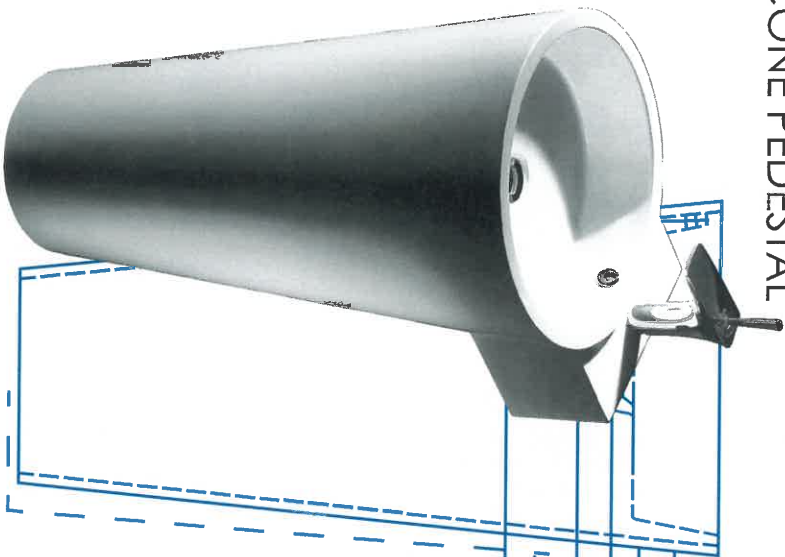

#### PRODUCT FEATURES:

- Cultured marble
- Avenue white
- Single hole faucet drilling
- Rear overflow with chrome ring
- Template supplied
- Wall secured hardware included
- Faucet not included



#### OVERALL DIMENSIONS:

- 17" (W) x 20 7/8" (D) x 33 1/2" (H)
- 430mm (W) x 530mm (D) x 850mm (H)



#### COMPLIANCE CERTIFICATIONS:

- Meets or exceeds the following:  
IAPMO cUPC  
CSAB 45.5-11/IAPMO Z124-2011



#### SHIPPING:

- Cube: 8.94
- GW: 73.85 lbs

#### Notes:

Dimensions of fixtures are nominal and may vary within the range of tolerance established by ASME standard A11.2.19.2. These measurements are subject to change or cancellation. No responsibility is assumed for use of superseded or voided pages.

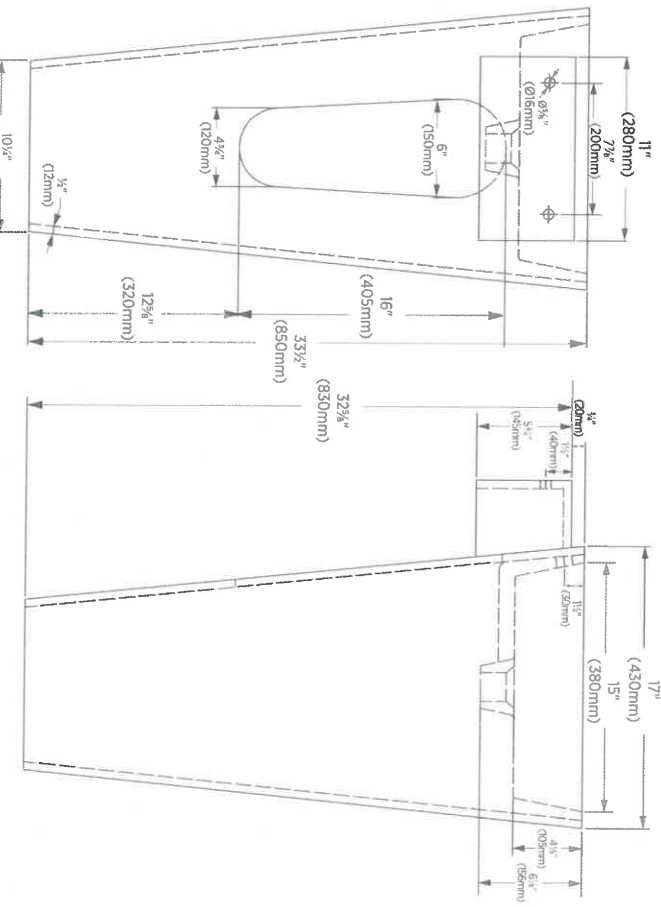
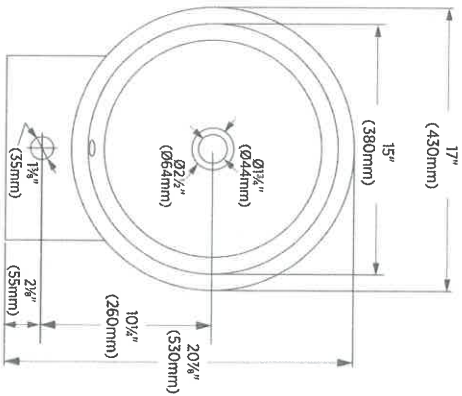

avenue

11.17.16



5970 Chedworth Way  
Unit B, Mississauga  
Ontario, Canada  
L5R 4G5



www.avenuecanada.com

2-12  
Powder Room



Sink Specifications

QUATRUS R15 LAUNDRY

Colour	SKU
brushed finish	401802

Design and planning tips

- Min cabinet size: 27 in ( 685 mm )
- Bowl Depth: 12 in ( 305.0 mm )

Specifications:

Sink template, Mounting clips, Installation instructions, 3 1/2" (90 mm) stainless steel strainers

Sink can be installed as a topmount or undermount.

Depending on cabinet construction, a different cabinet size may be required. Consult the cabinet manufacturer.

Codes/Standards: ASME A112.19.3-2017/ CSA B45.4-17

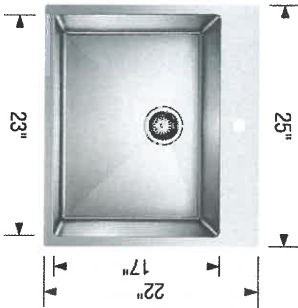

Optional Accessories

Laundry Rack	401952
CapFlow	517666

Warranty

Limited lifetime warranty on all sinks and faucets. One-year warranty on all accessories and soap dispensers.

Code/Standards Compliance

BLANCO sinks and faucets are third-party tested and certified to CSA, cUPC, ANSI/ASME, IAPMO and NSF standards and listed by applicable certification bodies. For more information on individual product listings, contact our office or listing organization.

 Need support? Learn more by watching our sink & faucet How-to videos:  
<https://www.blanco.com/ca-en/support/how-to-videos/how-to-videos-for-sinks/>

 BLANCO Canada Inc  
100 Corporation Drive  
Brampton ON L6S 6B5

Tel & Fax  
Tel: 905-494-2400 Toll free: 1-877-425-2626  
Fax: 905-494-2425 Toll free: 1-877-825-2626

*While BLANCO strives to provide accurate information, all images and dimensions in this document are intended for reference only and are subject to change at any time without notice. This document is not intended for use as an installation guide. For technical installation details, refer to installation instructions provided with the product. BLANCO assumes no responsibility for the use of superseded or voided specifications.*

2-12  
Laundry  
\*with Moen Riley Pull down faucet



Sink Specifications

Colour                      SKU  
brushed finish                      401518

Design and planning tips

- Min cabinet size: 36 in ( 915 mm )
- Bowl Depth: 9 in ( 230.0 mm )

Specifications:

Sink template, Mounting clips, Installation instructions, 3 1/2" (90 mm) stainless steel strainers

Depending on cabinet construction, a different cabinet size may be required. Consult the cabinet manufacturer.

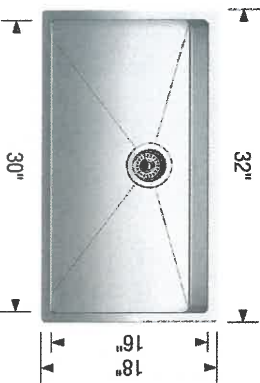

Optional Accessories

Elevated Grid	406346
CapFlow	517666
Workstation	406344
Sink Grid	406347
Cutting Board	406345

Warranty

Limited lifetime warranty on all sinks and faucets. One-year warranty on all accessories and soap dispensers.

Code/Standards Compliance

BLANCO sinks and faucets are third-party tested and certified to CSA, cUPC, ANSI/ASME, IAPMO and NSF standards and listed by applicable certification bodies. For more information on individual product listings, contact our office or listing organization.



Need support? Learn more by watching our sink & faucet How-to videos:  
<https://www.blanco.com/ca-en/support/how-to-videos/how-to-videos-for-sinks/>



BLANCO Canada Inc  
100 Corporation Drive  
Brampton ON L6S 6B5

Tel & Fax  
Tel: 905-494-2400 Toll free: 1-877-425-2626  
Fax: 905-494-2425 Toll free: 1-877-825-2626

*While BLANCO strives to provide accurate information, all images and dimensions in this document are intended for reference only and are subject to change at any time without notice. This document is not intended for use as an installation guide. For technical installation details, refer to installation instructions provided with the product. BLANCO assumes no responsibility for the use of superseded or voided specifications.*

2-12  
Kitchen

COLLETTE  
21½" RECTANGULAR UNDERMOUNT SINK

☐ 4220CIY Undermount Sink

Product Specs:

- Vitreous china
- Front overflow hole
- Template and mounting hardware supplied

Overall Dimensions (W x D x H):

(OD): 545mm(21½") x 355mm(14") x 190mm(7½")  
(ID): 485mm(19") x 295mm(11¾") x 140mm(5½")

Compliance Certifications:

- Meets or exceeds the following:
- IAPMO cUPC
  - ASME A112.19.2 / CSA B45.1-2013

Shipping:

Cube 1.64  
GW 25 lbs

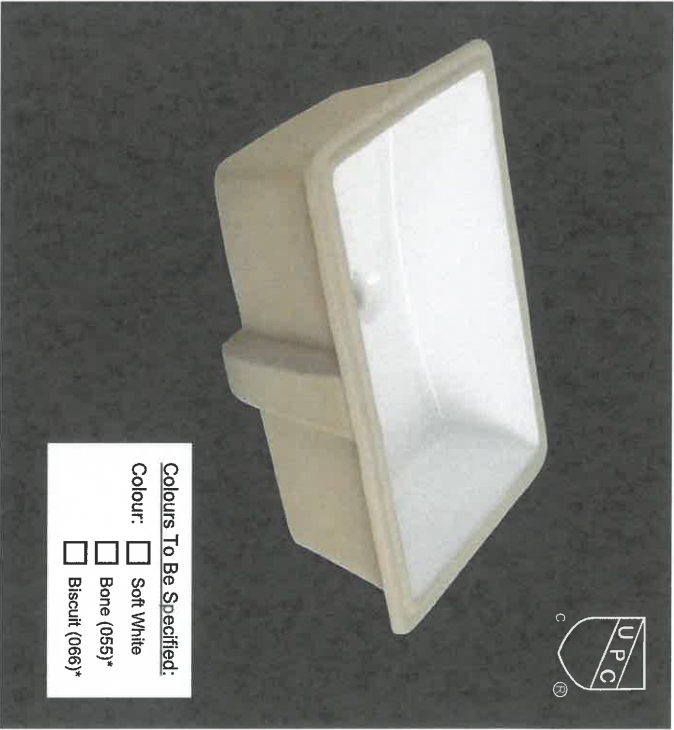

Notes:

Dimensions of fixtures are nominal and may vary within the range of tolerances established by ASME standard A112.19.2. These measurements are subject to change or cancellation. No responsibility is assumed for use of superseded or voided pages.

\*Bone and Biscuit available through Direct Import (CI) only.

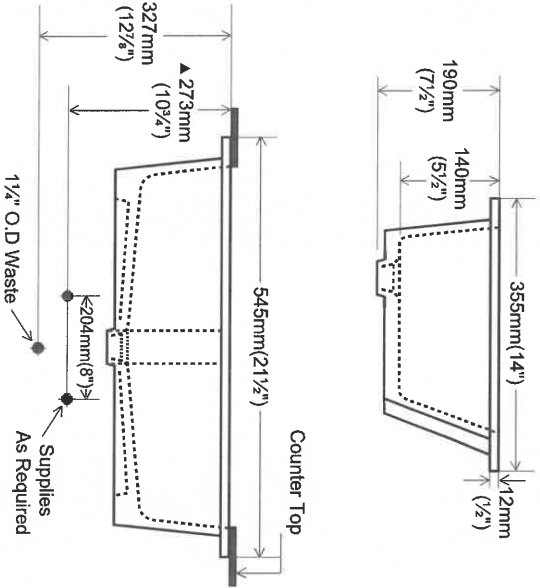
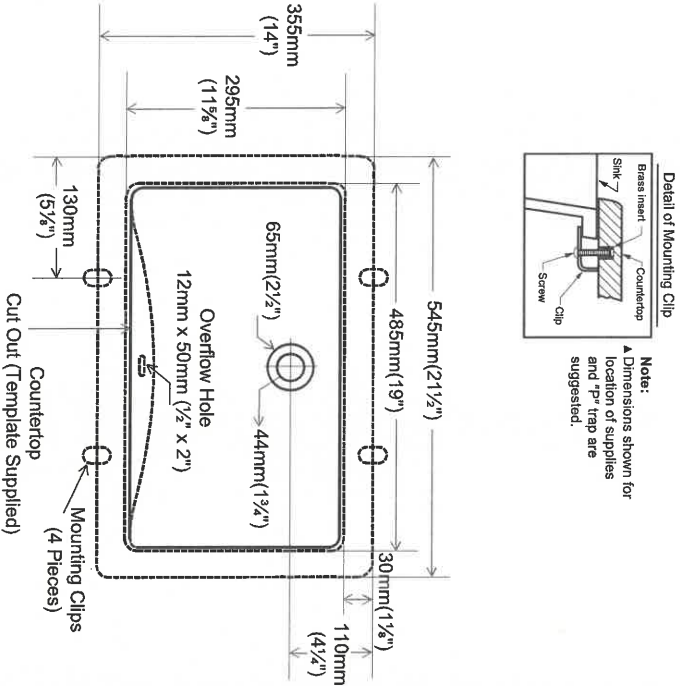

2-12 All Bathrooms

JENN-AIR® DETAILED PLANNING DIMENSIONS

1 of 4

**36" FULLY INTEGRATED BOTTOM-FREEZER REFRIGERATORS**  
(BASE UNIT REQUIRES SUITE-COORDINATING PANEL KIT OR CUSTOM PANELS AND HANDLES)  
JB36NXXFRE, JB36NXXFLE – 35¾" x 83½" x 24" (without door/handles)

PRODUCT DIMENSIONS

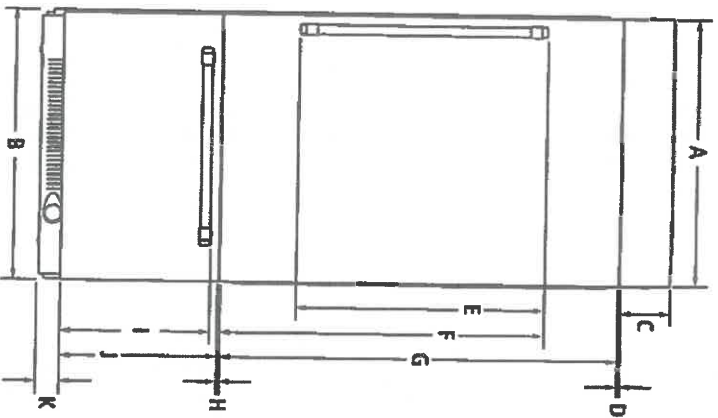

FRONT VIEW

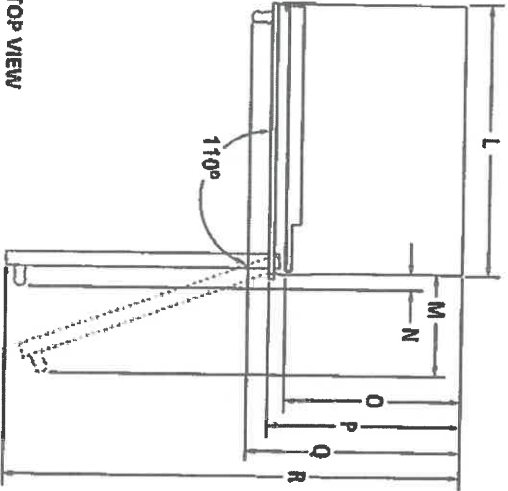

TOP VIEW

MODEL #	JB36NXXFRE	JB36NXXFLE
A	Width of door	35 in 88.9 cm
B	Overall width	35¾ 90.8
C	Height of top grille and bracket	6½ 16.5
D	Space between door and top grille	¾ 0.8
E	Height of door handle	32¾ 82.2
	Pro-Style® Stainless	37¾ 96.0
F	Height to top of door handle	42¾ 107.6
	Pro-Style® Stainless	44¾ 114.0
G	Height of door	52¾ 133.0
H	Space between door and drawer	¼ 0.3
I	Height to top of drawer handle	19¾ 49.2
	Pro-Style® Stainless	19¾ 48.7
J	Height of drawer	20¼ 52.1
K	Height of bottom grille	3 7.6
L	Width of recessed refrigerator	35 88.9
M	Width from side of refrigerator to handle – door fully open 110°	13¼ 33.6
	Pro-Style® Stainless	12¾ 32.1
N	Width from side of refrigerator to handle – door open 90°	2 5.1
	Pro-Style® Stainless	1½ 3.9
O	Depth without door panel kit	24 61.0
P	Depth with door	24¾ 62.9
	Pro-Style® Stainless panel kit	24¾ 62.9
	Euro-Style Stainless panel kit	24¾ 62.9
Q	Depth with handle	27¾ 69.5
	Pro-Style® Stainless	26¾ 68.3
	Euro-Style Stainless	58¾ 148.9
R	Depth with door open 90°	

2-12

**IMPORTANT:** Dimensional specifications are provided for planning purposes only.  
**Do not make any cutouts based on this information.** Refer to the Installation or Use & Care Guide before selecting cabinetry, verifying electrical/gas connections, making cutouts or beginning installation.  
All Jenn-Air® appliances are appropriately UL, CUL or CSA approved.



8107Adzw714

JENN-AIR® DETAILED PLANNING DIMENSIONS

2 of 4

36" FULLY INTEGRATED BOTTOM-FREEZER REFRIGERATORS  
(BASE UNIT REQUIRES SUITE-COORDINATING PANEL KIT OR CUSTOM PANELS AND HANDLES)  
JB36NXFXRE, JB36NXFXLE – 35¾" x 83⅞" x 24" (without door/handles)

DIMENSIONS AS INSTALLED

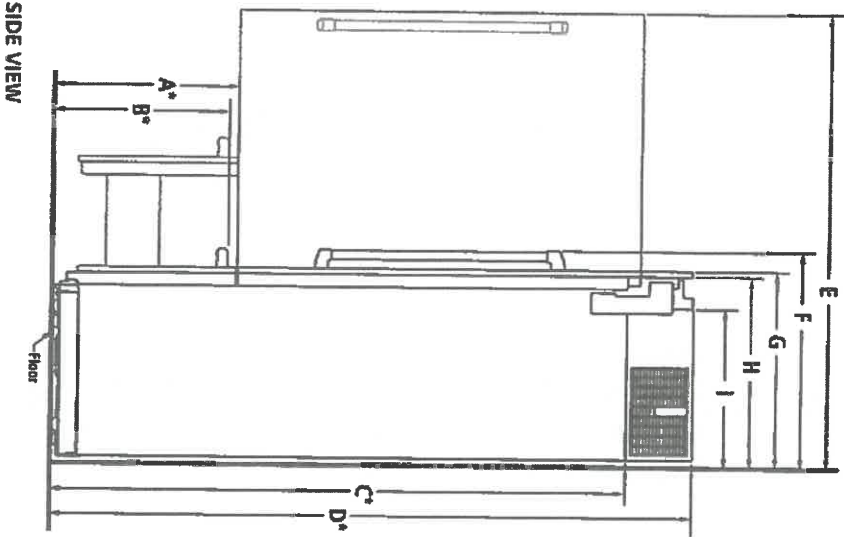

MODEL #	JB36NXFXRE JB36NXFXLE	
	in	cm
A* Height to top of drawer (min.)	23 ½	59.7
B* Height to top of drawer handle (min.)		
Pro-Style® Stainless	22 ¾	56.8
Euro-Style Stainless	22 ¼	56.3
C* Height to top of door (min.)	74 ¾	188.9
D* Height to top of grille and bracket (min.)	83 ⅞	211.1
E Depth with door open 90° (min.)	58 ¾	148.9
F Depth with handle (min.)		
Pro-Style® Stainless	27 ¾	69.5
Euro-Style Stainless	26 ¾	68.3
G Depth with door (min.)		
Pro-Style® Stainless panel kit	24 ¾	62.9
Euro-Style Stainless panel kit	24 ¾	62.9
Custom panel (¾"/1.9 cm)	24 ¾	62.9
H Depth without door panel kit (min.)	24	61.0
I Depth of compressor (min.)	19 ¾	50.5

\*Add 1 ½" (3.2 cm) to the height dimension when leveling legs are fully extended.

2-12

**IMPORTANT:** Dimensional specifications are provided for planning purposes only.  
Do not make any cutouts based on this information. Refer to the Installation or Use & Care Guide before selecting cabinetry, verifying electrical/gas connections, making cutouts or beginning installation.  
All Jenn-Air® appliances are appropriately UL, CUL or CSA approved.

## JENN-AIR® DETAILED PLANNING DIMENSIONS

3 of 4

### 36" FULLY INTEGRATED BOTTOM-FREEZER REFRIGERATORS (BASE UNIT REQUIRES SUITE-COORDINATING PANEL KIT OR CUSTOM PANELS AND HANDLES) JB36NXXFRE, JB36NXXFYLE - 35 3/4" x 83 1/8" x 24" (without door/handles)

#### 3 STYLES FOR DOOR PANEL INSTALLATION

##### STANDARD INTEGRATED GRILLE INSTALLATION

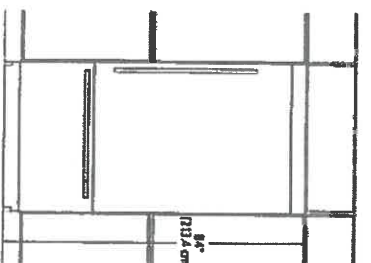

FRONT VIEW

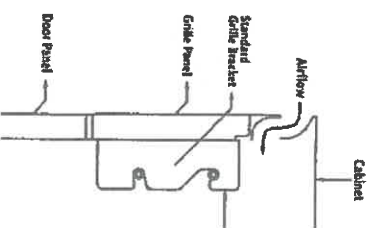

SIDE VIEW - STAINLESS STEEL  
PANEL KIT

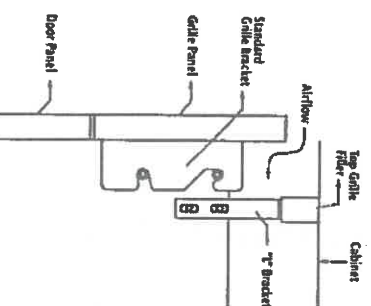

SIDE VIEW - CUSTOM PANEL

- Attach the standard custom grille with the standard grille bracket provided with the refrigerator.
- The standard grille panel height allows for an air gap critical to refrigerator performance

##### FULLY INTEGRATED GRILLE INSTALLATION

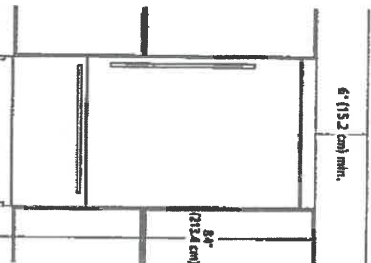

FRONT VIEW - OPEN TO CEILING  
(OPTION 1)

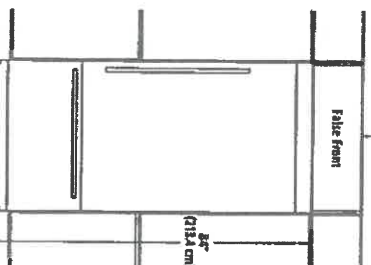

FRONT VIEW - FALSE FRONT  
(OPTION 2)

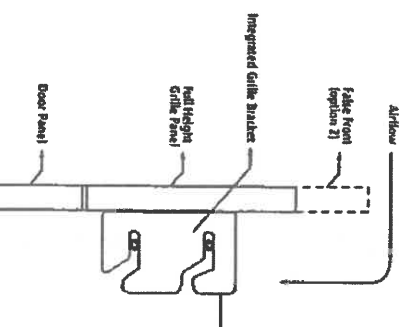

SIDE VIEW - CUSTOM PANEL

- Attach the full-height grille with the integrated grille bracket provided with the refrigerator
- Requires a minimum of 6" (15.2 cm) of open space above the refrigerator, which must not be blocked in any way, including soffits.

##### ARMOIRE-STYLE INSTALLATION\*

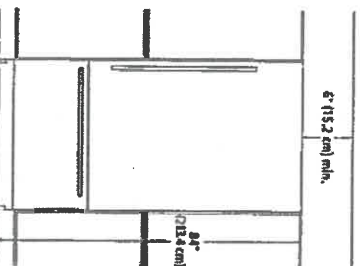

FRONT VIEW - OPEN TO CEILING  
(OPTION 1)

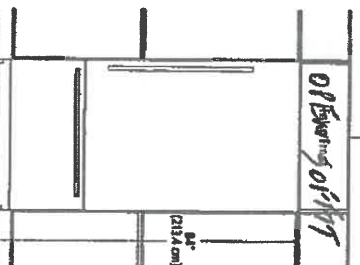

FRONT VIEW - FALSE FRONT  
(OPTION 2)

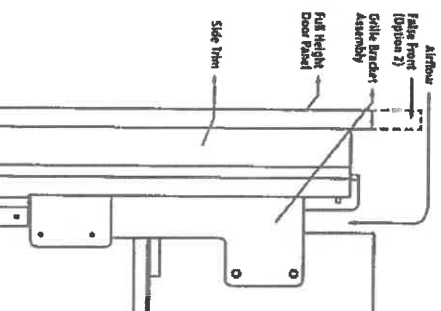

SIDE VIEW - CUSTOM PANEL

- Attach the grille bracket assembly and grille panel provided in the armoire-style panel kit.
- Requires a minimum of 6" (15.2 cm) of open space above the refrigerator, which must not be blocked in any way, including soffits.

\* Refer to the Armoire Kit installation instructions for additional dimensions and installation details.

2-12

**IMPORTANT:** Dimensional specifications are provided for planning purposes only. Do not make any cutouts based on this information. Refer to the Installation or Use & Care Guide before selecting cabinetry, verifying electrical/gas connections, making cutouts or beginning installation. All Jenn-Air® appliances are appropriately UL, CUL or CSA approved.



8107AdZW714

JENN-AIR® DETAILED PLANNING DIMENSIONS

36" FULLY INTEGRATED BOTTOM-FREEZER REFRIGERATORS  
(BASE UNIT REQUIRES SUITE-COORDINATING PANEL KIT OR CUSTOM PANELS AND HANDLES)  
JB36NXXFXRE, JB36NXXFXLE – 35¾" x 83⅝" x 24" (without door/handles)

OPENING/CLEARANCE DIMENSIONS

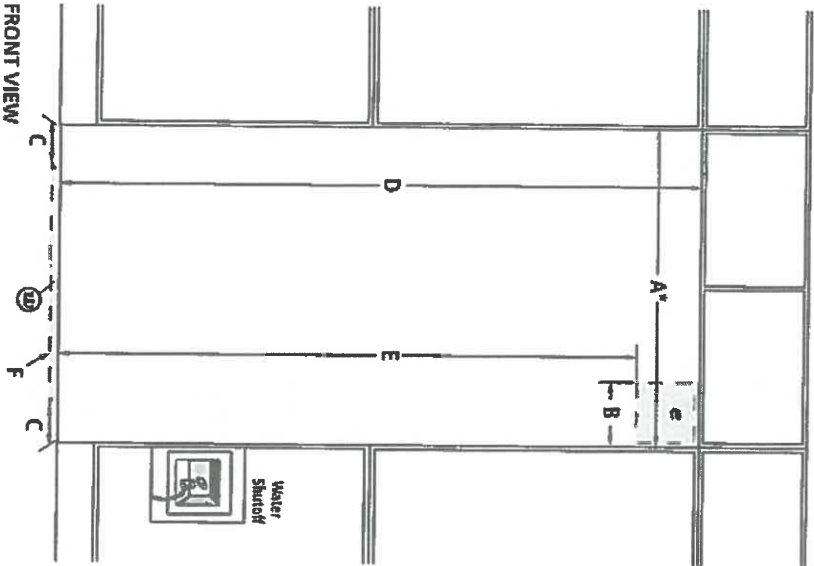

MODEL #	JB36NXXFXRE JB36NXXFXLE	
A*	Width (min.)	36 in 91.4 cm
B	Width of recommended electrical location	4 10.2
C	Distance from side of cabinet to recommended water connection location	6 15.2
D	Height (min.)	84 213.4
E	Height to recommended electrical location	77 195.6
F	Depth of recommended water connection location (max.)	1 2.5
e	Recommended electrical connection location	
w	Recommended water connection location	

\* Minimum width must extend behind the face of the cabinet for at least 2" (5.1 cm).

ELECTRICAL REQUIREMENTS

115 volt, 60 Hz, AC only, 15- or 20-amp fused, grounded circuit is required. A dedicated circuit is recommended. Use an outlet that cannot be turned off by a switch. Do not use an extension cord.

WATER PRESSURE REQUIREMENTS

A cold water supply with water pressure between 30 and 120 psi (207 and 827 kPa) is required to operate the ice maker. Call a licensed, qualified plumber with any questions about the water pressure.

Reverse Osmosis Water Supply

**IMPORTANT:** The pressure of the water coming out of a reverse osmosis system going to the water inlet valve of the refrigerator needs to be between 30 and 120 psi (207 and 827 kPa).

If a reverse osmosis water filtration system is connected to the cold water supply, the water pressure to the reverse osmosis system needs to be a minimum of 40 to 60 psi (276 to 414 kPa).

LOCATION REQUIREMENTS

Floor must be able to support refrigerator (more than 600 lb (272 kg)), door panels and contents of the refrigerator and must be at the same level as flooring in the room.

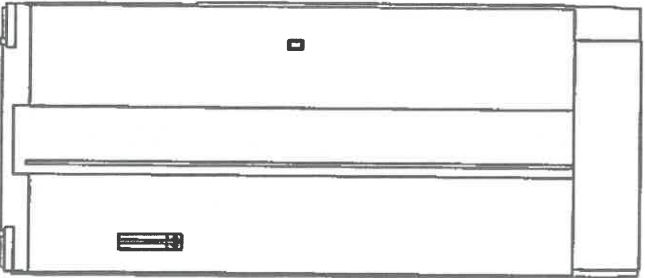

BACK VIEW

**IMPORTANT:** Dimensional specifications are provided for planning purposes only.  
**Do not make any cutouts based on this information.** Refer to the Installation or Use & Care Guide before selecting cabinetry, verifying electrical/gas connections, making cutouts or beginning installation.  
All Jenn-Air® appliances are appropriately UL, CUL or CSA approved.

2-12

## Custom Overlay Panels

Custom overlay panels allow you to blend the exterior of your refrigerator into the overall kitchen décor and to use custom handles for additional design flexibility.

In some cases, your cabinet manufacturer may choose to work with one panel routed for the different dimensions. Follow these panel dimension and placement instructions to be sure that the custom overlay panels will fit properly.

### IMPORTANT:

- This installation does not require filler or backer panels.
- The required thickness for all panels is  $\frac{3}{4}$ " (1.91 cm).

### Bottom Mount

- For 36" (91.4 cm) Single-door Bottom Mount models, the weight of the refrigerator door overlay panel cannot exceed 60 lbs (27.2 kg) and the freezer drawer overlay panel cannot exceed 25 lbs (11.3 kg).
- For 36" (91.4 cm) or 42" (106.7 cm) French Door models, the weight of each refrigerator door cannot exceed 38 lbs (17.2 kg) and the freezer drawer overlay panel cannot exceed 30 lbs (13.6 kg).
- For all models, the weight at the top grille overlay panel cannot exceed 7 lbs (3.2 kg).

### Side-by-Side

- The weight of the refrigerator door overlay panel cannot exceed 66 lbs (29.9 kg) for 48" models or 65 lbs (29.5 kg) for 42" models.
- The weight of the freezer door overlay panel cannot exceed 50 lbs (23 kg) for 48" models or 49 lbs (22.2 kg) for 42" models.
- The weight of the top grille overlay panel cannot exceed 8 lbs (3.6 kg) for 48" models or 7 lbs (3.2 kg) for 42" models.

### A CAUTION

#### Pinch Hazard

Installation of door panels with less than a  $\frac{3}{4}$ " (0.95 cm) gap between the door panel and the adjacent cabinet increases the risk of potential pinching.

## Overlay Panel Dimensions

### 36" (91.4 cm) Single-Door Model - Door and Drawer Panels

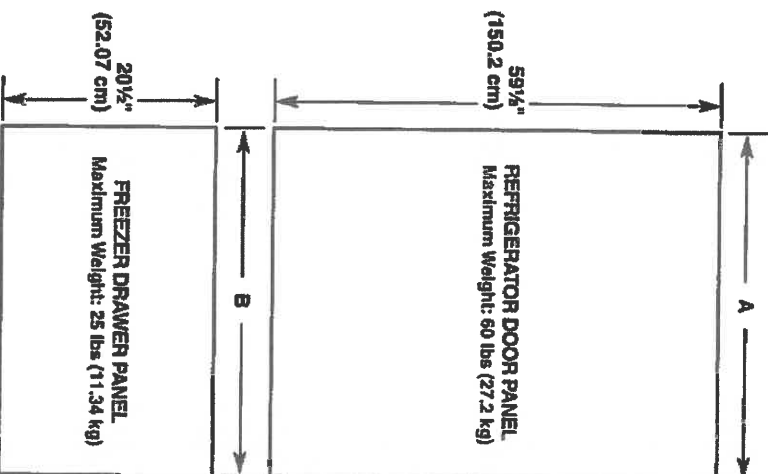

Model		36" Bottom Mount	
Reveal		$\frac{1}{4}$ "	$\frac{1}{8}$ "
A	35 1/4" (89.54 cm)	35 3/4" (90.81 cm)	
B	35 1/4" (89.54 cm)	35 3/4" (90.81 cm)	

2-12

DIMENSIONS

JENNAIR® GAS RANGES  
PRODUCT



MODEL #	30" GAS RANGE		36" GAS RANGE	
	in	cm	in	cm
A Overall width	29 3/4	75.9	<del>35 3/4</del>	<del>91.1</del>
B Rear Vent Height	3	7.6	<del>3</del>	<del>7.6</del>
C Bull nose Height	2 1/8	5.4	<del>2 1/8</del>	<del>5.4</del>
D Control Panel Height	7 1/2	19.1	<del>7 1/2</del>	<del>19.1</del>
E Door Height	20 1/8	52.6	<del>20 1/8</del>	<del>52.6</del>
F Door Bottom to Handle Top: RISE™	20	50.8	<del>20</del>	<del>50.8</del>
F Door Bottom to Handle Top: NOIR™	20 3/8	52.4	<del>20 3/8</del>	<del>52.4</del>
G Toe-Kick Height	6 1/16	17	<del>6 1/16</del>	<del>17</del>

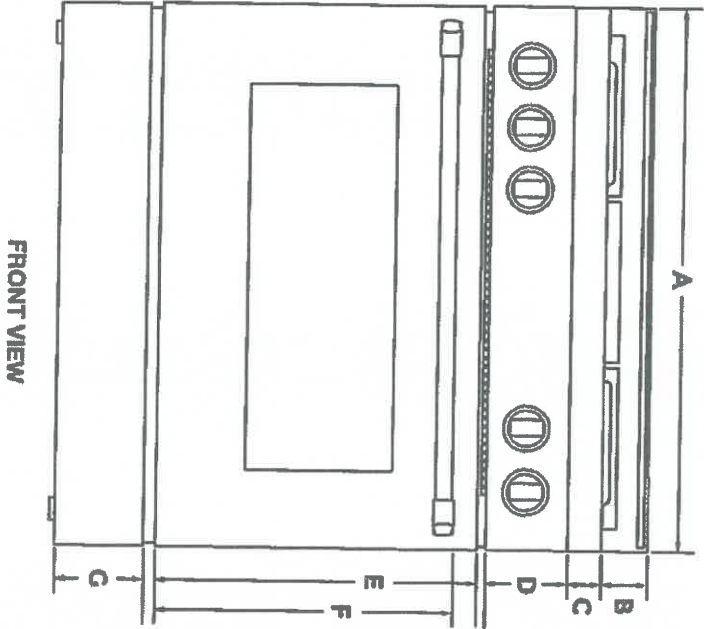

2-12

**IMPORTANT:** Dimensional specifications are provided for planning purposes only.  
Do not make any cutouts based on this information. Refer to the Installation Guide before selecting cabinetry, verifying electrical/gas connections, making cutouts or beginning installation. All Jennair® appliances are appropriately UL, CUL or CSA approved.

DIMENSIONS

JENNAIR® GAS RANGES  
PRODUCT

MODEL #	30" GAS RANGE		36" GAS RANGE	
	in	cm	in	cm
H	Depth with Control Panel Overhang	27 <sup>11</sup> / <sub>16</sub>	70.3	<del>27<sup>11</sup>/<sub>16</sub></del> <del>70.3</del>
I	Depth with Handle: RISE™	29 <sup>3</sup> / <sub>16</sub>	75.7	<del>29<sup>3</sup>/<sub>16</sub></del> <del>75.7</del>
I	Depth with Handle: NOIR™	29 <sup>3</sup> / <sub>16</sub>	74.5	<del>29<sup>3</sup>/<sub>16</sub></del> <del>74.5</del>
J	Depth with Door Fully Open	46 <sup>1</sup> / <sub>2</sub>	118.1	<del>46<sup>1</sup>/<sub>2</sub></del> <del>118.1</del>

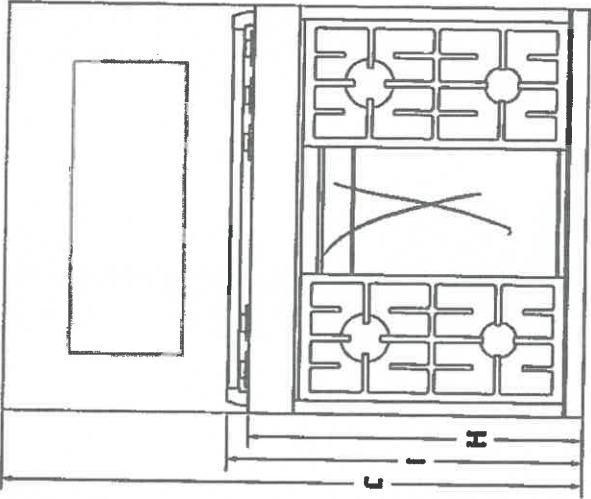

TOP VIEW

2-12

DIMENSIONS

JENNAIR® GAS RANGES  
OPENING AND CLEARANCE

MODEL #		30" GAS RANGE		36" GAS RANGE		48" GAS RANGE	
		in (min.)	cm (min.)	in (min.)	cm (min.)	in (min.)	cm (min.)
A	Combustible Area Above Cooking Surface Width	30	76.2	<del>86</del>	<del>91.4</del>	<del>48</del>	<del>121.9</del>
B*	Bottom of Cabinet Height Above Cooking Surface	42	106.7	<del>58</del>	<del>147.3</del>	<del>58</del>	<del>147.3</del>
C	Bottom of Cabinet Height Above Countertop	18	45.7	<del>18</del>	<del>45.7</del>	<del>18</del>	<del>45.7</del>
D	Distance to Fixed Wall or Combustible Material	12	30.5	<del>12</del>	<del>30.5</del>	<del>12</del>	<del>30.5</del>
E	Opening Width	30	76.2	<del>36</del>	<del>91.4</del>	<del>48</del>	<del>121.9</del>

\*If installing a hood or hood liner above the range, follow the hood or hood liner instructions for dimensional clearances above the cooking surface.

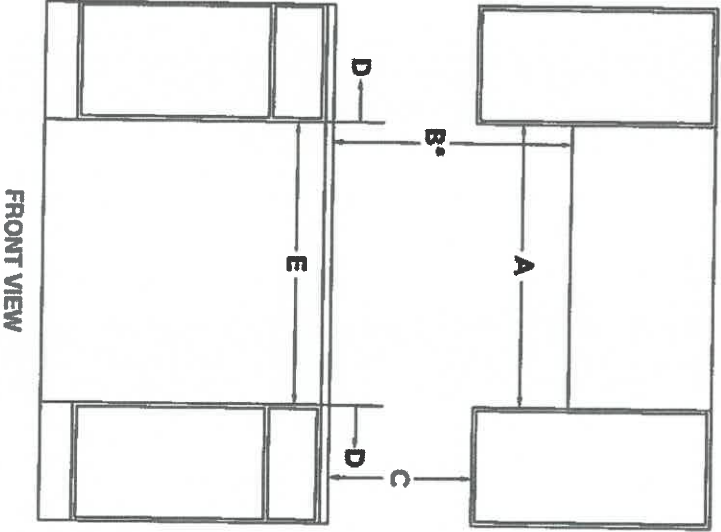

FRONT VIEW

2-12

DIMENSIONS

JENNAIR® GAS RANGES  
OPENING AND CLEARANCE

MODEL #	30" GAS RANGE		36" GAS RANGE		48" GAS RANGE	
	in	cm	in	cm	in	cm
F Upper Cabinet Depth	13 (max.)	33 (max.)	<del>13 (max.)</del>	<del>33 (max.)</del>	<del>13 (max.)</del>	<del>33 (max.)</del>
G* Distance to Fixed Wall or Combustible Material	1½	3.8	<del>1½</del>	<del>3.8</del>	<del>1½</del>	<del>3.8</del>

\*If the back wall is constructed of a combustible material and a backsplash is not installed, a 1½" (3.8 cm) minimum clearance is required.

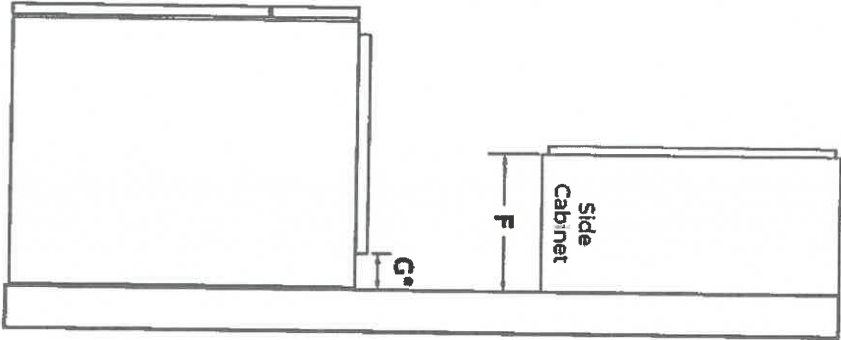

2-12

DIMENSIONS

JENNAIR® GAS RANGES  
ELECTRICAL REQUIREMENTS

MODEL #	30" GAS RANGE		36" GAS RANGE		48" GAS RANGE	
	in	cm	in	cm	in	cm
A	Electrical Zone Width	22	55.9	<del>36</del> 71.1	40	101.6
B	Electrical Zone Height	15	38.1	<del>5</del> 38.1	<del>18</del> 45.7	58.1
C	Electrical Zone Depth	5	12.7	<del>5</del> 12.7	5	12.7

ELECTRIC REQUIREMENTS CHECKLIST

- A 240 V, 60 Hz, AC only 15 A, fused grounded circuit is required.
- A dedicated circuit is recommended.

RECOMMENDED ELECTRICAL ZONE

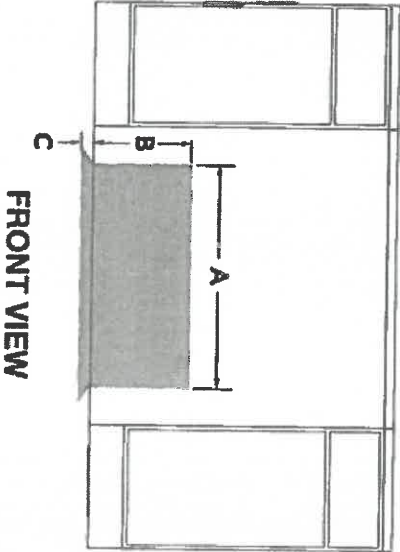

WIDTH TO ELECTRICAL CONDUIT

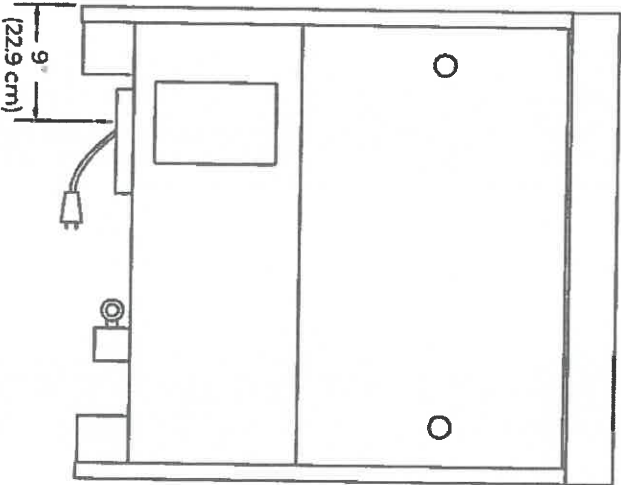

BACK VIEW

NOTE: IF YOU HAVE QUESTIONS ABOUT YOUR ELECTRICAL SUPPLY,  
CALL A LICENSED, QUALIFIED ELECTRICIAN.

DIMENSIONS

JENNAIR® GAS RANGES

GAS REQUIREMENTS

MODEL #	30" DUAL-FUEL RANGE		36" DUAL-FUEL RANGE		48" DUAL-FUEL RANGE	
	in	cm	in	cm	in	cm
A Gas Opening Width	3	7.6	<del>17</del>	<del>28</del>	<del>21</del>	<del>53.3</del>
B Gas Opening Height	3	7.6	<del>5</del>	<del>7.6</del>	<del>8</del>	<del>7.6</del>
C Gas Opening Depth	5	12.7	<del>5</del>	<del>12.7</del>	<del>8</del>	<del>12.7</del>
D Distance from Side Cabinet to Gas Opening	9	22.9	<del>9</del>	<del>22.9</del>	<del>9</del>	<del>22.9</del>
E Width to Gas Inlet	12 3/4	32.4	<del>12 3/4</del>	<del>32.4</del>	<del>12 3/4</del>	<del>32.4</del>

RECOMMENDED GAS ZONE

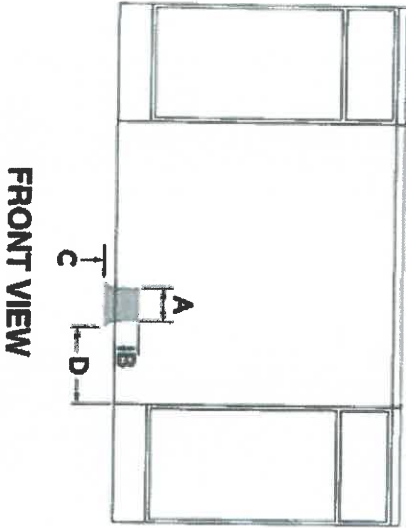

WIDTH TO GAS INLET

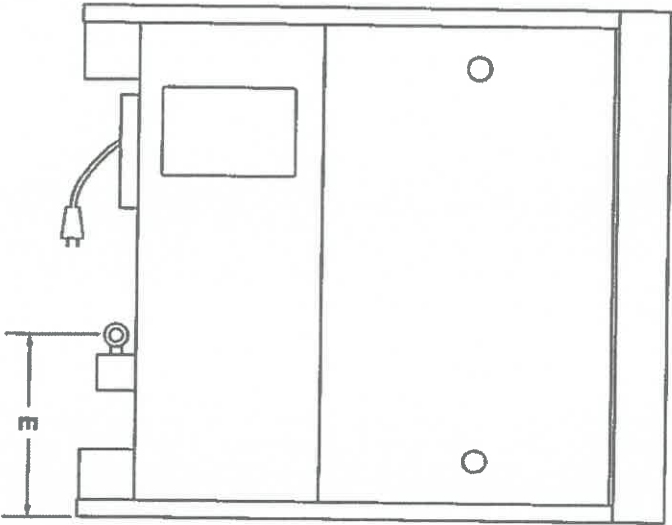

NOTE: IF YOU HAVE QUESTIONS ABOUT YOUR GAS SUPPLY,  
CALL A LICENSED, QUALIFIED SERVICE TECHNICIAN.



## Product and Cabinet Opening Dimensions

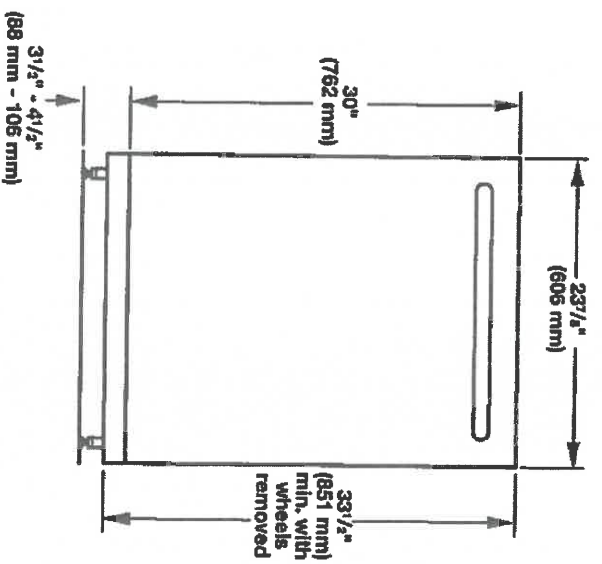

For 4" (100 mm) toe kick, height of cabinet opening is 34½" (863 mm).

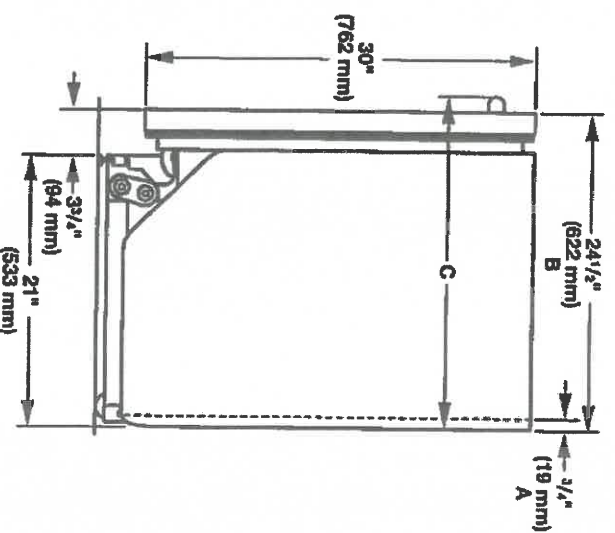

- A. Insulation may be compressed (not used on all models).
- B. For panel-ready models, dishwasher depth is 24" (610 mm), not including the 3/4" (19 mm) custom door panel.
- C. Door handles may protrude forward of the face of the dishwasher, varies by model.

**Check that all surfaces have no protrusions that would prohibit dishwasher installation.**

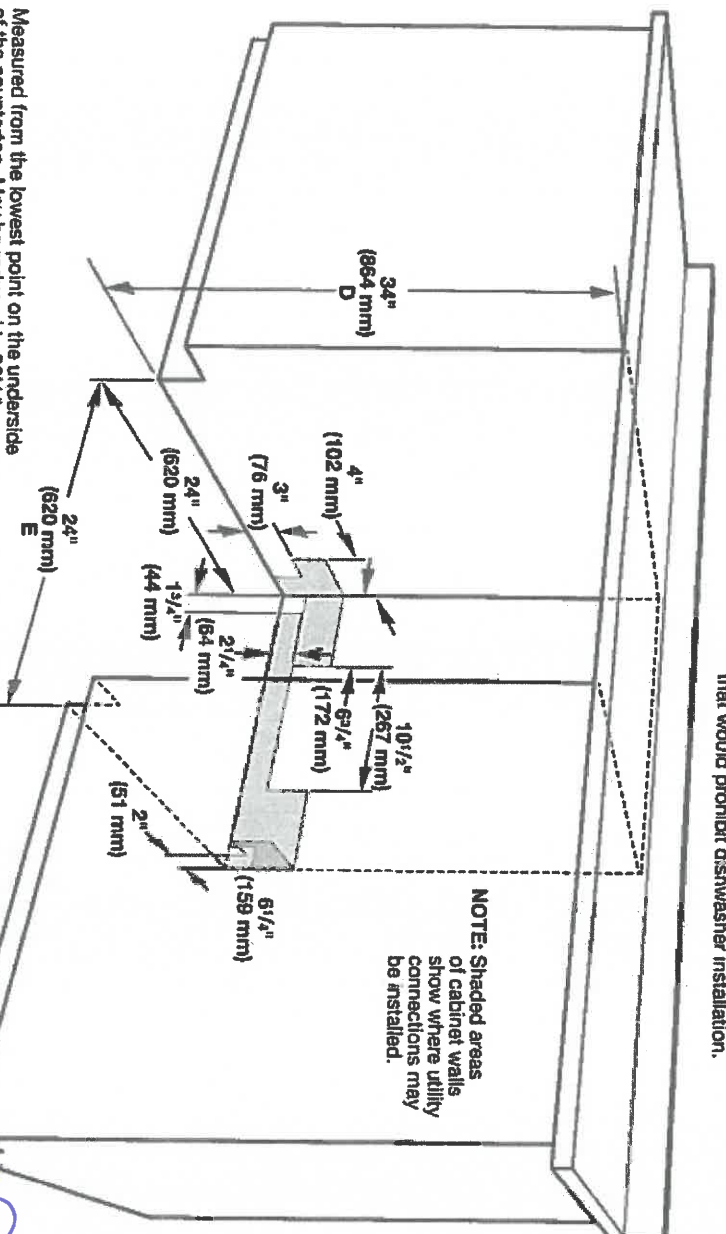

**NOTE:** Shaded areas of cabinet walls show where utility connections may be installed.

- D. Measured from the lowest point on the underside of the countertop. May be reduced to 33 1/2" (851 mm) by removing the wheels and perforated area of insulation (blanket) on dishwasher.

# INSTALLATION INSTRUCTIONS FOR CUSTOM PANEL AND KICK PLATE ATTACHMENT UNDERCOUNTER DISHWASHER STAINLESS STEEL TUB

**IMPORTANT:** Before installing your dishwasher, please use this instruction sheet as a supplement to the installation instructions.

## Custom Panel Models Only

Gather these additional tools and parts before starting attachment of the custom panel. Read and follow the instructions provided in this instruction sheet.

### Additional Tools Needed:

- $\frac{3}{16}$ " drill bit
- Torx® T15® screwdriver

### Additional Parts Supplied with Custom Panel Models:

- 4 – Plastic studs (attached to each other by runners)
- 4 – Short screws (10-16 hex-head screw)
- 4 – Long screws (8-18 Torx® head screws)
- 1 – Template (located inside Use and Care Guide bag assembly)
- 1 – Instruction sheet (located inside Use and Care Guide bag assembly)
- Custom tape packet (part number W10366978)

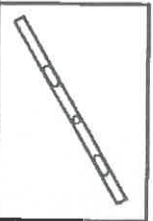

**NOTE:** The screws supplied are used for only  $\frac{3}{16}$ " (19 mm) thick wooden panel. If the wooden panel is less than  $\frac{1}{2}$ " (19 mm) thick, customer must purchase screws locally.

Make sure all these parts are included in the literature package. If parts are not included, call 1-800-422-1230. In Canada, call 1-800-807-6777.

## Install Custom Panel

### Custom panel dimensions

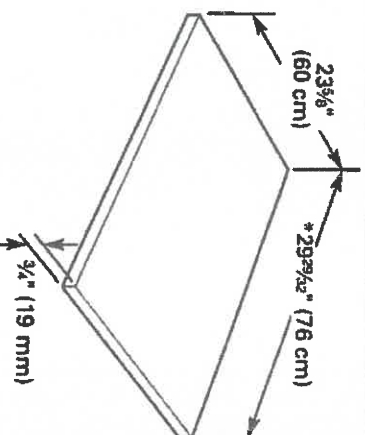

\*This dimension is for 4" (102 mm) toe kick. If the installation needs a higher toe kick, adjust the height of the wood panel accordingly except on models with fan-assisted dry. Fan models may have a duct at the bottom of the door that would be exposed if you shorten the door panel for toe kick heights above 4" (102 mm). Toe kick heights greater than 6" (152 mm) are not recommended for this product.

### Follow Steps Below:

A customer supplied door panel and handle (together) must weigh no more than 16 lbs (7.3 kg) and must be made to specific dimensions. It is recommended that a cabinetmaker cut the customer panel because of the precise dimensions needed.

### NOTES:

- The handle for the custom panel is not included.
- All mounting hardware supplied is for a  $\frac{3}{4}$ " (19 mm) thick wood panel. If a thinner wood panel or materials other than wood are used, it is the customer's responsibility to obtain the proper length screws and adjust the pilot holes accordingly.
- If a custom wooden kick plate is to be installed over the dishwashers' metal access panel, the height must not exceed 3" (76 mm) from the bottom of the metal access panel.

**IMPORTANT:** Use a moisture-resistant sealer on both sides and all edges of the panel and any wooden kick plates to avoid damage from moisture.

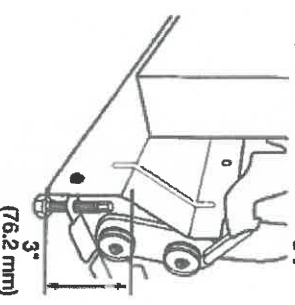

# 24" Speed Oven

500 Series – Stainless Steel HMC54151UC

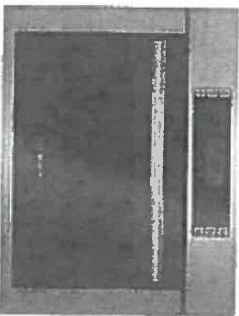

HMC54151UC  
Stainless Steel

The 24" speed oven pairs the cooking qualities of a conventional oven with the speed of a microwave, designed for smaller spaces.

### Features & Benefits

SpeedChef® cooking modes offer faster cooking times for your convenience.

Installs flush with kitchen cabinetry.

24-in-1 microwave and convection oven for a variety of cooking options.

Electrical connection - 120 Volt NEMA 5-20 three prong plug.

General Properties	
Cavity material	Stainless steel
Max. microwave power (W)	1,000 W
Capacity	
Cavity capacity (cu. ft.)	1.6
Turntable diameter (in.)	14 3/16"
Technical Details	
Watts (W)	1,920 W
Circuit breaker (A)	20 A
Volts (V)	120 V
Frequency (Hz)	60 Hz
Power cord length (in)	48"
Plug type	NEMA 5-20 – 3 prong plug

Dimensions & Weight	
Overall appliance dimensions (HxWxD) (in)	17 7/8" x 23 7/16" x 22 1/16"
Required cutout size (HxWxD) (in)	(Standard) 17 3/4" x 22 5/16" x 22" (Flush) 18 7/16" x 24" x 22 3/4"
Oven overall interior dimensions (HxWxD) (in.)	9 7/8" x 16 1/2" x 16 1/2"
Turntable – Metal Max. Cookware	12 3/4" dia.
Turntable – Ceramic Max. Cookware	12 1/2" dia.
Rack – Rectangular Cookware Max.	15" x 12"
Net weight (lbs)	83 lbs.
Accessories—Included	
Included	Metal turntable, cooking rack, ceramic cooking tray



Accessories: To purchase Bosch accessories, cleaners & parts please visit [www.bosch-home.com/us/store](http://www.bosch-home.com/us/store) or call 1-800-944-2904 (Mon to Fri 9 am to 6 pm PST, Sat 9 am to 3 pm PST).  
Notes: All height, width and depth dimensions are shown in inches. BSH reserves the absolute and unrestricted right to change product materials and specifications, at any time, without notice. Consult the product's installation instructions for final dimensional data and other data is prior to making cutout.  
Warranties: Please see Use & Care manual or Bosch website for statement of limited warranty.  
For more information on our entire line of products, go to [www.bosch-home.com/us](http://www.bosch-home.com/us) or call 1-800-944-2904  
© BSH Home Appliances Corporation. All rights reserved. Bosch is a registered trademark of Robert Bosch GmbH

2-12

# 24" Speed Oven

500 Series – Stainless Steel HMC54151UC



## Installation Details

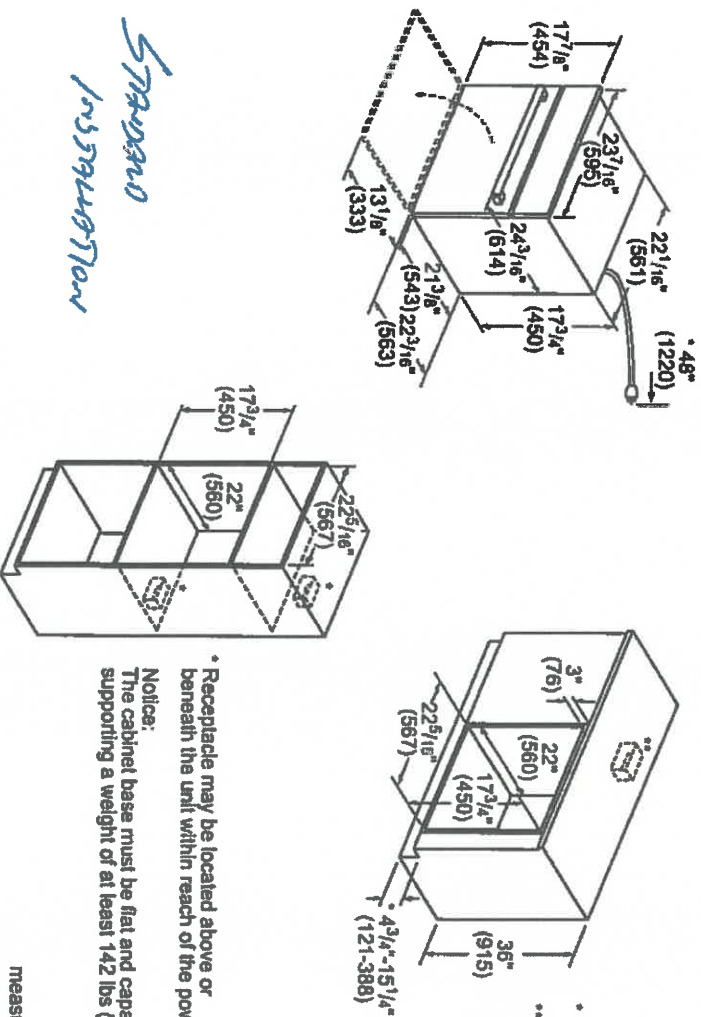

\* Receptacle may be located above or beneath the unit within reach of the power cord.  
Notice:  
The cabinet base must be flat and capable of supporting a weight of at least 142 lbs (64.1 kg).

measurements in inches (mm)

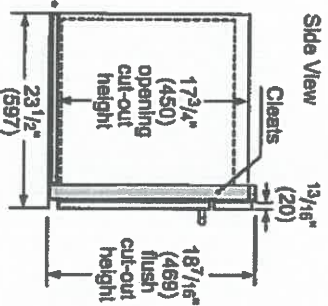
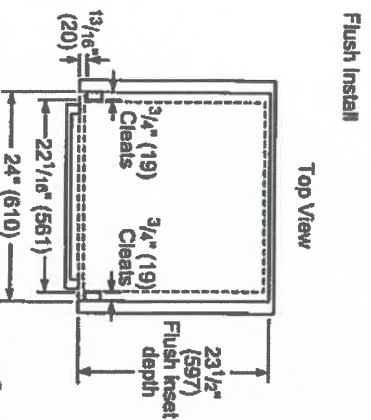

\* Baseplate 5 1/8" (6)

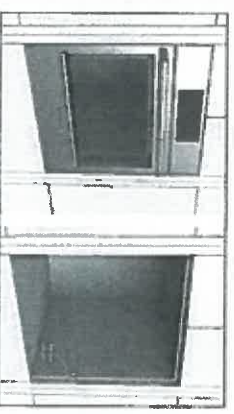

**Accessories:** To purchase Bosch accessories, cleaners & parts please visit [www.bosch-home.com/us/store](http://www.bosch-home.com/us/store) or call 1-800-944-2904 (Mon to Fri 5 am to 6 pm PST, Sat 6 am to 3 pm PST).  
**Notes:** All height, width and depth dimensions are shown in inches. BSH reserves the absolute and unrestricted right to change product materials and specifications, at any time, without notice. Consult the product's installation instructions for final dimensional data and other details prior to making cutout.  
**Warranties:** Please see Use & Care manual or Bosch website for statement of limited warranty.  
For more information on our entire line of products, go to [www.bosch-home.com/us](http://www.bosch-home.com/us) or call 1-800-944-2904  
© BSH Home Appliances Corporation. All rights reserved. Bosch is a registered trademark of Robert Bosch GmbH



# UNDER COUNTER BEVERAGE CENTER

## DETAILED PLANNING DIMENSIONS GUIDE

JUBFR242HL, JUBFL242HL, JUBFR242HM, JUBFL242HM, JUBFL242HX, JUBFR242HX  
23<sup>7</sup>/<sub>8</sub>" (W) x 34<sup>3</sup>/<sub>8</sub>" (H) x 23<sup>1</sup>/<sub>2</sub>" (Depth without door panels/handles)

PRODUCT DIMENSIONS

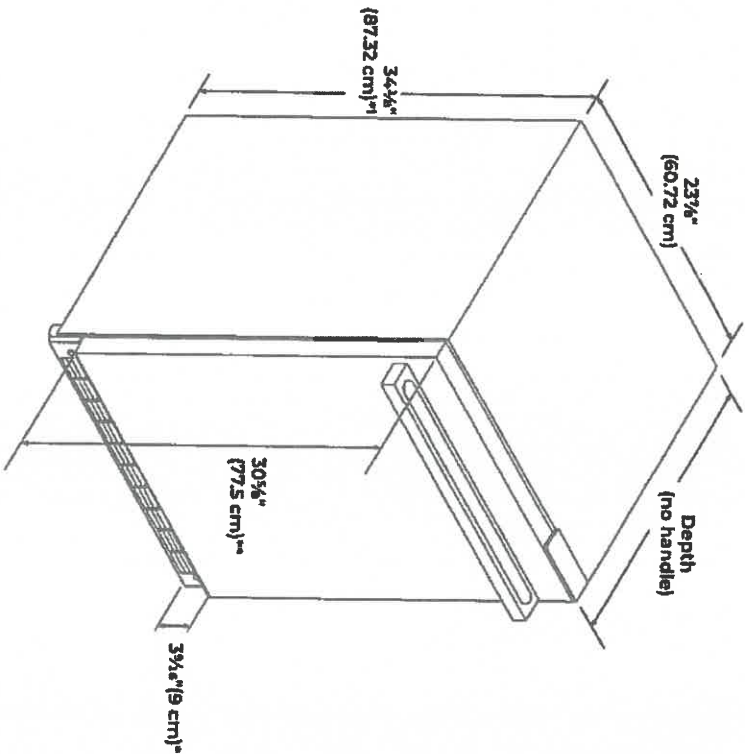

VARIANT	DEPTH (NO HANDLE)
RISE™ Model	23 <sup>11</sup> / <sub>16</sub> " (60.4 cm)
NOIR™ Model	23 <sup>15</sup> / <sub>16</sub> " (60.8 cm)
Panel ready models (with 3/4" panel)	23 <sup>11</sup> / <sub>16</sub> " (60.2 cm)

\*Add 5/8" (1.6 cm) to the height dimension when leveling legs are fully extended  
\*\*For custom panel models, this will vary.  
†Add 1/4" (6.4 mm) to the height dimension for height with hinge covers.

Because of our commitment to continuous improvement, our products are subject to change without notice.

Dimensions are for planning purposes only. For complete details, see installation instructions packed with product. Specifications subject to change without notice.

2-12

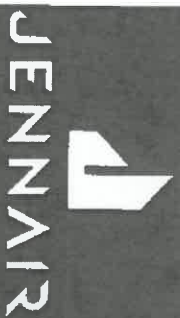

# UNDER COUNTER BEVERAGE CENTER

## DETAILED PLANNING DIMENSIONS GUIDE

JUBFR242HL, JUBFL242HL, JUBFR242HM, JUBFL242HM, JUBFL242HX, JUBFR242HX  
23<sup>7</sup>/<sub>8</sub>" (W) x 34<sup>5</sup>/<sub>8</sub>" (H) x 23<sup>7</sup>/<sub>8</sub>" (Depth without door panels/handles)

DIMENSION	DESCRIPTION	RISE™ Model	NOIR™ Model	Panel ready models (with 3/8" panel)
A	Width of door	23 <sup>3</sup> / <sub>4</sub> " (60.3 cm)		
B	Width of the grille	23 <sup>3</sup> / <sub>4</sub> " (60.5 cm)	23 <sup>3</sup> / <sub>4</sub> " (60.5 cm)	23 <sup>1</sup> / <sub>2</sub> " (60.5 cm)
C	Height to top of handle	28 <sup>1</sup> / <sub>2</sub> " (71.3 cm)	28 <sup>1</sup> / <sub>2</sub> " (71.3 cm)	**
D	Width from side of beverage center to handle – door open 90°	2 <sup>7</sup> / <sub>16</sub> " (6.2 cm)	1 <sup>5</sup> / <sub>16</sub> " (5 cm)	**
E	Depth without door	21 <sup>1</sup> / <sub>2</sub> " (55.1 cm)		
F	Depth with door	23 <sup>1</sup> / <sub>2</sub> " (60.4 cm)	23 <sup>5</sup> / <sub>8</sub> " (60.8 cm)	23 <sup>1</sup> / <sub>2</sub> " (60.2 cm)
G	Depth with handle	26 <sup>3</sup> / <sub>16</sub> " (67.5 cm)	26 <sup>1</sup> / <sub>8</sub> " (66.3 cm)	**
H	Depth with door open 90°	48" (121.9 cm)		47 <sup>15</sup> / <sub>16</sub> " (121.8 cm)

\*\*For custom panel models, this will vary.

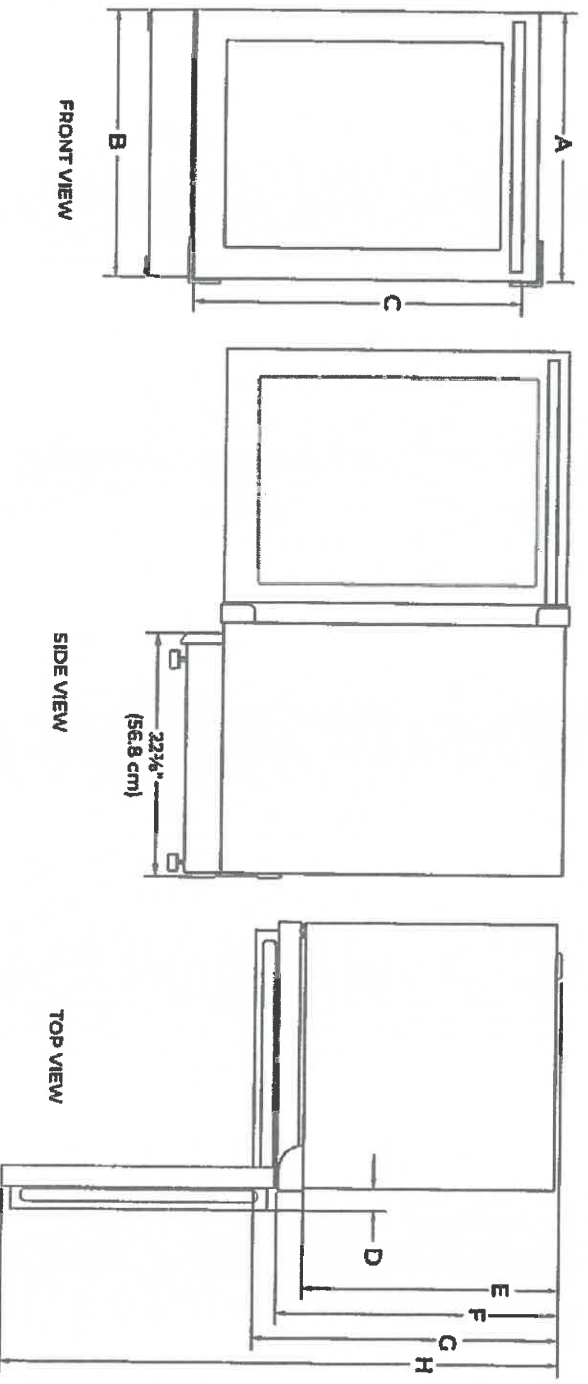

Because Whirlpool Corporation policy includes a continuous commitment to improve our products, we reserve the right to change materials and specifications without notice.

Dimensions are for planning purposes only. For complete details, see installation instructions packed with product. Specifications subject to change without notice.



# UNDER COUNTER BEVERAGE CENTER

## DETAILED PLANNING DIMENSIONS GUIDE

JUBFR242HL, JUBFL242HL, JUBFR242HM, JUBFL242HM, JUBFL242HX, JUBFR242HX  
23<sup>7</sup>/<sub>8</sub>" (W) x 34<sup>1</sup>/<sub>8</sub>" (H) x 23<sup>1</sup>/<sub>2</sub>" (Depth without door panels/handles)

OPENING DIMENSIONS

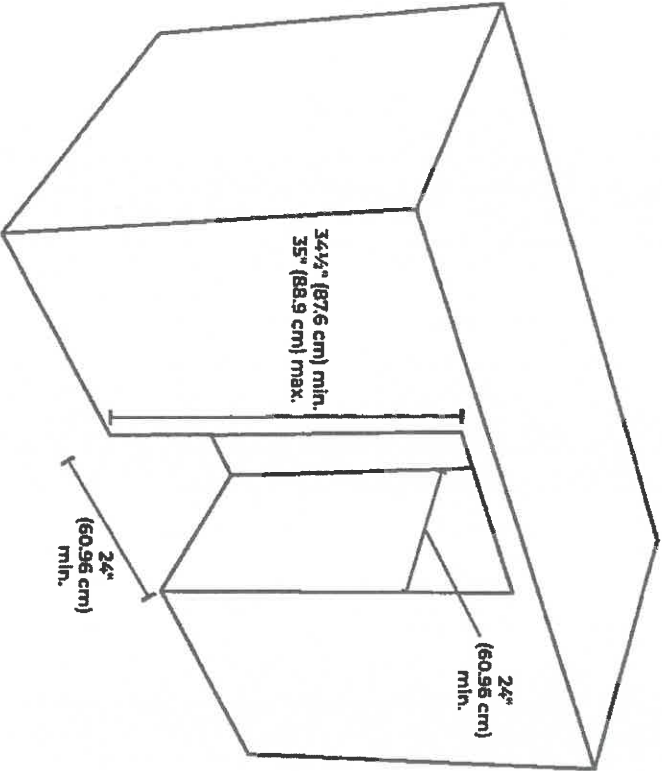

**NOTE:** Make sure there is 3" (7.6 cm) space between beverage center and adjacent appliance/wall for door swing.

ELECTRICAL SUPPLY LOCATION

- Lighter yellow area indicates recommended recessed power outlet (located behind the beverage center).
- Power cord length is 5 ft (152.4 cm).
- For flush installation, the power outlet can be installed in adjacent cabinetry with a cutout on the power cord side for routing of the power cord.

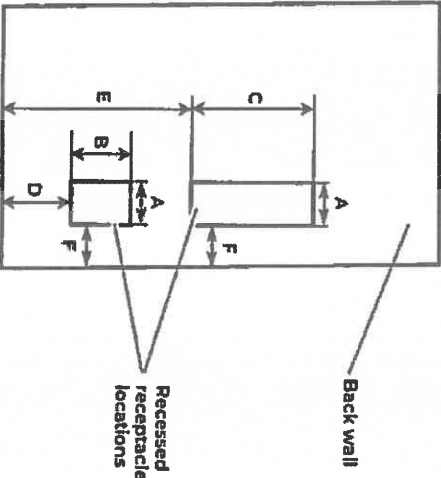

Dimension - A	3" (7.55 cm)
Dimension - B	4 1/2" (11.37 cm)
Dimension - C	9 3/4" (23.47 cm)
Dimension - D	12 1/8" (30.64 cm)
Dimension - E	21 3/4" (55.16 cm)
Dimension - F	1 3/4" (4.44 cm)

Because Whirlpool Corporation policy includes a continuous commitment to improve our products, we reserve the right to change materials and specifications without notice.

Dimensions are for planning purposes only. For complete details, see installation instructions packed with product. Specifications subject to change without notice.

0.13

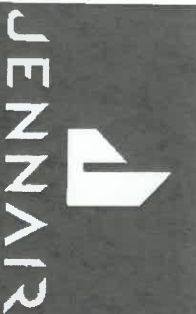

# UNDER COUNTER BEVERAGE CENTER

## DETAILED PLANNING DIMENSIONS GUIDE

JUBFR242HL, JUBFL242HL, JUBFR242HM, JUBFL242HM, JUBFL242HX, JUBFR242HX  
23<sup>3</sup>/<sub>4</sub>" (W) x 34<sup>3</sup>/<sub>4</sub>" (H) x 23<sup>3</sup>/<sub>4</sub>" (Depth without door panels/handles)

### WOOD PANEL GUIDE

#### CAUTION

##### Pinch Hazard

Installation of door panels with less than a  $\frac{1}{8}$ " (0.95 cm) gap between the door panel and the adjacent cabinet increases the risk of potential pinching.

#### IMPORTANT:

- The graphics in following sections show a custom panel for a door with the hinges installed on the right-hand side. If your beverage center has the hinges installed on the left-hand side, rotate the custom frame 180° so the hinge markings will be on the left.
- Panel dimensions shown are the minimum size to cover the appliance door. Panels can be made taller/wider to match surrounding cabinetry.
- The recommended thickness of the overlay panel is  $\frac{3}{4}$ " (19 mm).
- Custom solid door overlay panel must not weigh more than 20 lbs (9.07 kg).
- Custom glass door overlay panel must not weigh more than 10 lbs (4.54 kg).
- Overlay panels weighing more than recommended may cause damage to your appliance.

#### SOLID DOOR OVERLAY PANEL

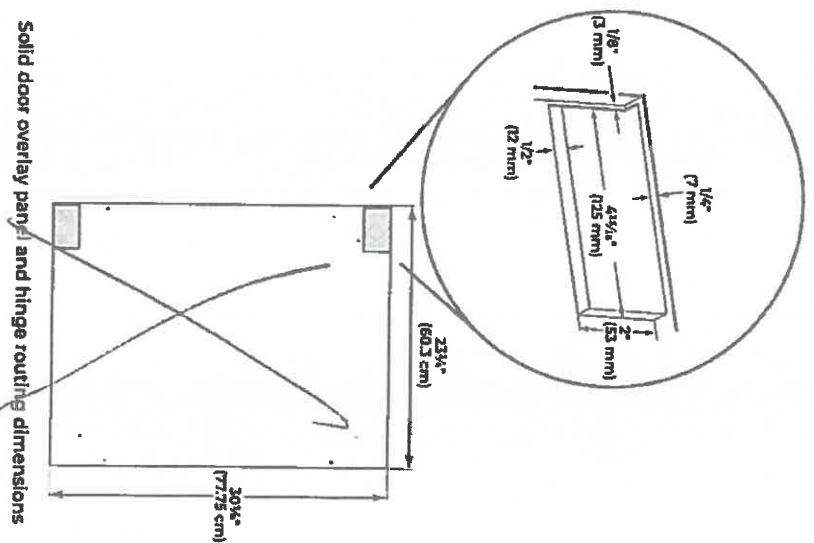

#### GLASS DOOR OVERLAY PANEL

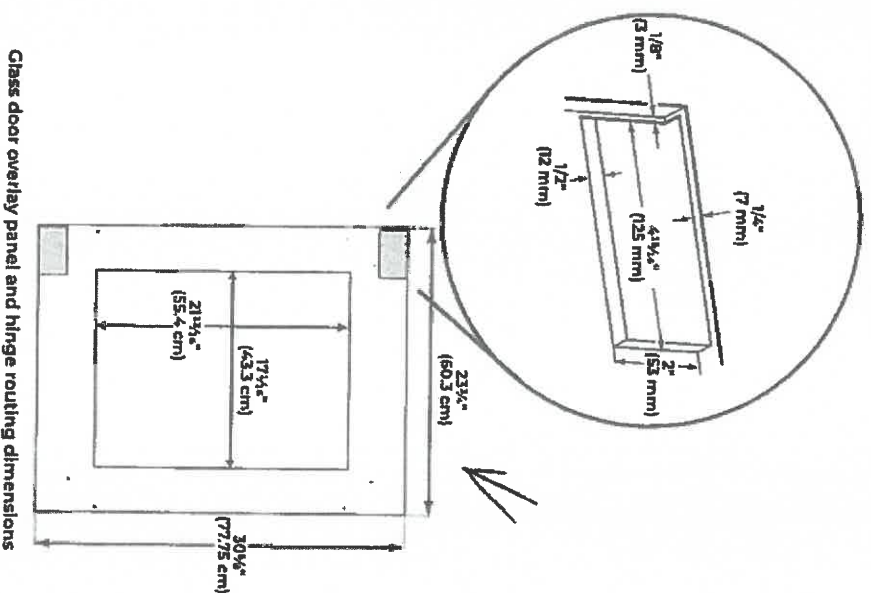

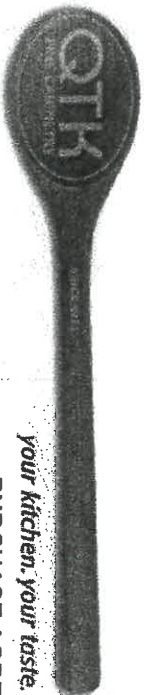

*your kitchen. your taste.*

Quality Tops & Kitchens Ltd.

80 Sante Drive, Vaughan, ON L4K 3C4

T 416.746.1811

F 905.761.5901

www.QTK.ca

info@qtk.ca

**PURCHASE AGREEMENT FORM**

PURCHASER:		CONTRACTOR:	Zancor Homes (Block 81) Ltd.	
ADDRESS:		SITE:	KING VILLAGE, KING CITY	
EMAIL:		MODEL TYPE:	TH-05	
PHONE #:		LOT #:	LOT 2-12 VLK	
PHONE #:		DATE:	Sep 1, 2020	Q6606

The purchaser agrees to buy and Quality Tops & Kitchens Ltd. (QTK) agrees to sell and provide for the purchaser the following articles listed herein and with attached drawing in accordance to the terms and conditions described on the reverse of this agreement form.

ROOM		DESCRIPTION		CATEGORY
		DOOR STYLE:	QT 5801	NONE
		FINISH:	CLASSIC GRAY	
		SPECIES:	FIBERBOARD	
		DOOR HARDWARE:		
		COUNTER TOP:	Counter Top by Others	
KITCHEN				Category 4
ITEM #	QTY	DESCRIPTION		PRICE
PF2696	1	BUILT-IN FOR PROFESSIONAL SERIES FRIDGES 26" DEEP x 95-1/2"H		
FP	1	FRIDGE PANELS (HANDLES NOT INCLUDED) (INSTALLATION NOT INCLUDED)		
ITCL2696	*	STRAIGHT PANTRY CABINET - 26"D x 95-1/2"H (IN LIEU OF BASE & UPPER)		
P-INT-DRW	4	1 INTERIOR PULL-OUT BLUM ANTARO WHITE DRW IN PANTRY - MIN. 18" DEEP CABINET		
BSPICE2	1	PULL-OUT SPICE UNIT - 2 BASKETS 6" W, 8" W, 12" W or 15-1/2" W		
BCR-MC1	1	MAGIC CORNER 1 PULL-OUT UNIT w/ 4 S.S. ANTI-SLIP BASKETS		
3PD-I/O	1	1 SET OF POT DRAWERS w/ BLUM INTIVO WHITE - P/D 3 (1 SMALL, 2 BIG DRAWER)		
DD-BG35	2	DUMMY DOOR FOR BASE (PER DOOR) 34-3/4"H (DOWN TO THE FLOOR)		
BGB2-17	1	DOUBLE BIN PULL-OUT RECYCLE 17" WIDE CAB		
UC-14	1	INCREASE DEPTH OF UPPER CABINET TO 13-3/4" DEEP (PER CABINET)		
UL-CC-14	1	UPPER L-SHAPE CORNER CABINET 26" x 26" - 13-3/4" DEEP		
DWP-1	1	DW/ PANEL SINGLE DOOR (INCLUDES SAME HANDLE AS ON DRAWERS) (INSTALLATION NOT INCLUDED)		
CUST-1	1	24" WIDE TALL CABINET w/ 1 EXTERIOR DRAWER & ACCOMODATE FOR BUILT-IN WINE FRIDGE.		
CUST-2	1	SINGLE DUMMY DOOR DETAIL ON BACK PANEL OF ISLAND		
CUST-3	1	2 1/4" WIDE RAIL IN MATTE BLACK w/ GREY SMOKED GLASS INSERT. LAMINATE INTERIOR COLOUR TBD. 5 PCS OF 10mm CLEAR GLASS SHELVES. LED PUCK LIGHTS ON TOP.		
CUST-4	1	UPGRADE DOOR STYLE & COLOUR: QTF 8007 - PAINT COLOUR TBD		
CUST-6	1	100" HIGH CABINETS OVERALL w/ 8" HIGH 2 STEP FLAT CROWN MOULDING TO CEILING - 9' HIGH OVERALL		
CUST-7	1	CONVERT B/D 4 INTO 1 SET OF POT DRAWERS w/ BLUM WHITE INTIVO MOTION DRAWER SLIDES		
CUST-8	1	PANEL BY QTK FOR WINE FRIDGE		
CUST-9	2	3" WIDE COLUMNS w/ 3/4" DETAIL ON EITHER SIDE OF FRIDGE		
CUST-10	1	AUTOSIZE HANDLES & APPLIANCES HANDLES - STYLE TBD		
		(x2) * DUMMY DOOR ON ISLAND ENDS		
		* HANDLE BOX WITH CUTOUTS IN UPPER ROOM		
ROOM		DESCRIPTION		
		DOOR STYLE:	QT 1022	NONE
		FINISH:	WILLOW GREY SUPERMATTE	
		SPECIES:	LP LAMINATE	
		DOOR HARDWARE:		
		DRW HARDWARE:		
		COUNTER TOP:	Counter Top by Others	
LAUNDRY ROOM				Category 1
ITEM #	QTY	DESCRIPTION		PRICE
CUST-1	1	39 1/2" HIGH UPPEERS ABOVE WASHER/DRYER. 1 1/2" FLOATING SHELF w/ HANGING ROD ABOVE SINK CABINET		



*Your kitchen. your taste.*

Quality Tops & Kitchens Ltd.  
80 Sante Drive, Vaughan, ON L4K 3C4  
T 416.746.1811 F 905.761.5901  
www.QTK.ca info@qtk.ca

**PURCHASE AGREEMENT FORM**

PURCHASER:		CONTRACTOR:	
ADDRESS:		Zancor Homes (Block 81) Ltd.	
EMAIL:		SITE: KING VILLAGE, KING CITY	
PHONE #:		MODEL TYPE: TH-05	
PHONE #:		LOT #: LOT 2-12 VLK	
		DATE: Sep 1, 2020 Q6606	
		ROOM SUMMARY: 970.00	
ROOM DESCRIPTION CATEGORY			
ENSUITE VANITY			
DOOR STYLE: QT 1022		NONE	
FINISH: <del>GOKALADA CROSSCUT</del>		MERCURY	
SPECIES: LP LAMINATE		OLMO AMBIENCE	
DOOR HARDWARE:		Category 2	
DRW HARDWARE:			
COUNTER TOP: Counter Top by Others			
ROOM SUMMARY:			
CUST-1 1 FLOATING BASE CABINETS w/ 2 DRAWERS UNDER EACH SINK INCL. GOLA CHANNEL HANDLESS REVEAL. PREMIUM MOTION DRAWER SLIDES.			
ROOM DESCRIPTION CATEGORY			
MAIN VANITY			
DOOR STYLE: QT 1022		NONE	
FINISH: <del>GOKALADA CROSSCUT</del>		REFLEXION	
SPECIES: LP LAMINATE		Category 2	
DOOR HARDWARE:			
DRW HARDWARE:			
COUNTER TOP: Counter Top by Others			
ROOM SUMMARY:			
CUST-1 1 FLOATING BASE CABINETS w/ 2 DRAWERS UNDER EACH SINK. HANDLE TBD			
ROOM DESCRIPTION CATEGORY			
ENSUITE CLOSET			
DOOR STYLE: QT 1022		NONE	
FINISH: <del>WILLOW GREY SUPERMATTE</del>			
SPECIES: LP LAMINATE		Category 1	
DOOR HARDWARE:			
DRW HARDWARE:			
COUNTER TOP: Counter Top by Others			
ROOM SUMMARY:			
CUST-1 1 96" HIGH CABINETRY w/ SINGLE & DOUBLE BLACK HANGING RODS. 2 SETS OF 4 MOTION DRAWERS SLIDES(808-450 DEEP). 2 CABINETS w/ ADJ. SHELVES INCL.			
ROOM DESCRIPTION CATEGORY			



Quality Tops & Kitchens Ltd.  
80 Sante Drive, Vaughan, ON L4K 3C4  
T 416.746.1811 F 905.761.5901  
www.QTK.ca info@qtk.ca

**PURCHASE AGREEMENT FORM**

PURCHASER:	CONTRACTOR:	Zancor Homes (Block 81) Ltd.	
ADDRESS:	SITE:	KING VILLAGE, KING CITY	
EMAIL:	MODEL TYPE:	TH-05	
PHONE #:	LOT #:	LOT 2-12 VLK	
PHONE #:	DATE:	Sep 1, 2020	Q6606

EXPECTED DELIVERY DATE	TBD
Customers please note all garbage bins, spice baskets, magic corner baskets and other accessories will only be delivered AFTER you move in the house. Please call us to request delivery of these items after you move in. Thank you. ALL CHANGES FINAL UPON SIGNING	
PLEASE READ ALL THE TERMS AND CONDITIONS ON THE ACCOMPANYING QTK TERMS & CONDITIONS DOCUMENT. BY SIGNING BELOW YOU AGREE TO RECEIVE THE ITEMS LISTED HEREIN AND PAY (ACCORDING TO QTK'S PAYMENT POLICY), AND HAVE READ AND UNDERSTOOD THE TERMS & CONDITIONS AS OUTLINED IN THE QTK TERMS & CONDITIONS DOCUMENT.	

DEPOSIT 1 DATE:	DE
DEPOSIT 2 DATE:	DE

BALANCE TO BE PAID IN FULL BY DUE DATE: \_\_\_\_\_ CUSTOMER INITIAL(S): \_\_\_\_\_

CUSTOMER SIGNATURE: \_\_\_\_\_ DATE: \_\_\_\_\_

CUSTOMER SIGNATURE: \_\_\_\_\_ DATE: \_\_\_\_\_

SALES REP NAME: Giovanni Toto QTK AUTHORIZED SIGNATURE: \_\_\_\_\_



80 Sante Drive, Vaughan, ON L4K 3C4  
T 416.746.1811 F 905.761.5901  
www.QTK.ca info@qtk.ca

CLIENT: ZANCOR HOMES	JOB NAME: 2-12 KING	ROOM: KITCHEN	DRAWN BY: R.J
SITE: VILLAGE AT KING'S RIDGE	DOOR STYLE: —	DOOR HANDLE: —	SCALE: 3/8" = 1'-0"
PHONE: —	FINISH: —	DRW HANDLE: —	DATE: JUL Y 22, 2020
EMAIL: —	SPECIES: —	TOP: —	PAGE: 1 OF 4
COMMENTS:			

Customer Agrees and Accepts the following conditions: 1. The Drawing is a representation only and the installed cabinetry may vary slightly in product size, measurements, handle appearance and location and other details. Although Quality Tops & Kitchens Ltd. (QTK) does it's best to manufacture exactly what is shown here outside factors may prevent that and some variance is to be expected and accepted by the customer. 2. These drawings represent the intellectual property of QTK and as such the customer understands and accepts that all deposits given by the customer to QTK are non-refundable after QTK has supplied drawings (either physically or electronically) to the customer. If the customer decides to cancel the order after QTK has submitted drawings to the customer, the deposit will then be considered a design fee and no money will be returned to the customer.

PLAN | KITCHEN

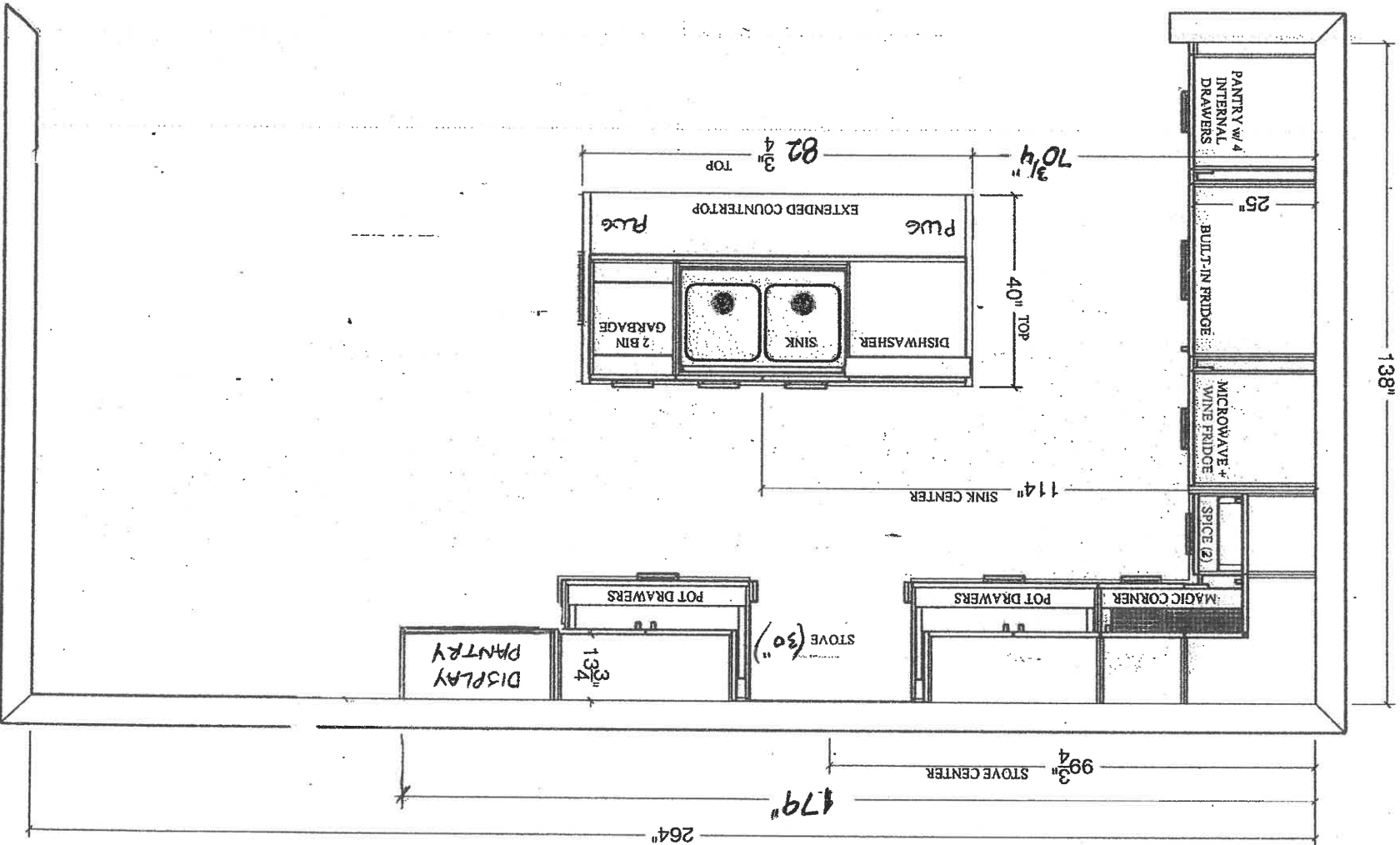

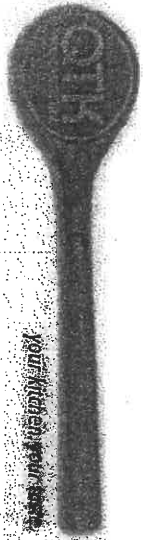

80 Sante Drive, Vaughan, ON L4K 3G4  
T 416.746.1811 F 905.761.5901  
www.qtk.ca info@qtk.ca

CLIENT: ZANCOR HOMES	JOB NAME: 2-12 KING	ROOM: KITCHEN	DRAWN BY: R.J
SITE: VILLAGE AT KING'S RIDGE	DOOR STYLE: —	DOOR HANDLE: —	SCALE: 1/2" = 1'-0"
PHONE: —	FINISH: —	DRW HANDLE: —	DATE: JULY 22, 2020
EMAIL: —	SPECIES: —	TOP: —	PAGE: 2 OF 4

COMMENTS:

Customer Agrees and Accepts the following conditions. 1. The Drawing is a representation only and the installed cabinetry may vary slightly in product size, measurements, handle, appearance and location and other details. Although Quality Tops & Kitchens Ltd. (QTK) does it's best to manufacture exactly what is shown here outside factors may prevent that and some variance is to be expected and accepted by the customer. 2. These drawings represent the intellectual property of QTK and as such the customer understands and accepts that all deposits given by the customer to QTK are non-refundable after QTK has supplied drawings (either physically or electronically) to the customer. If the customer decides to cancel the order after QTK has submitted drawings to the customer, the deposit will then be considered a design fee and no money will be returned to the customer.

ELEVATION | FRIDGE WALL

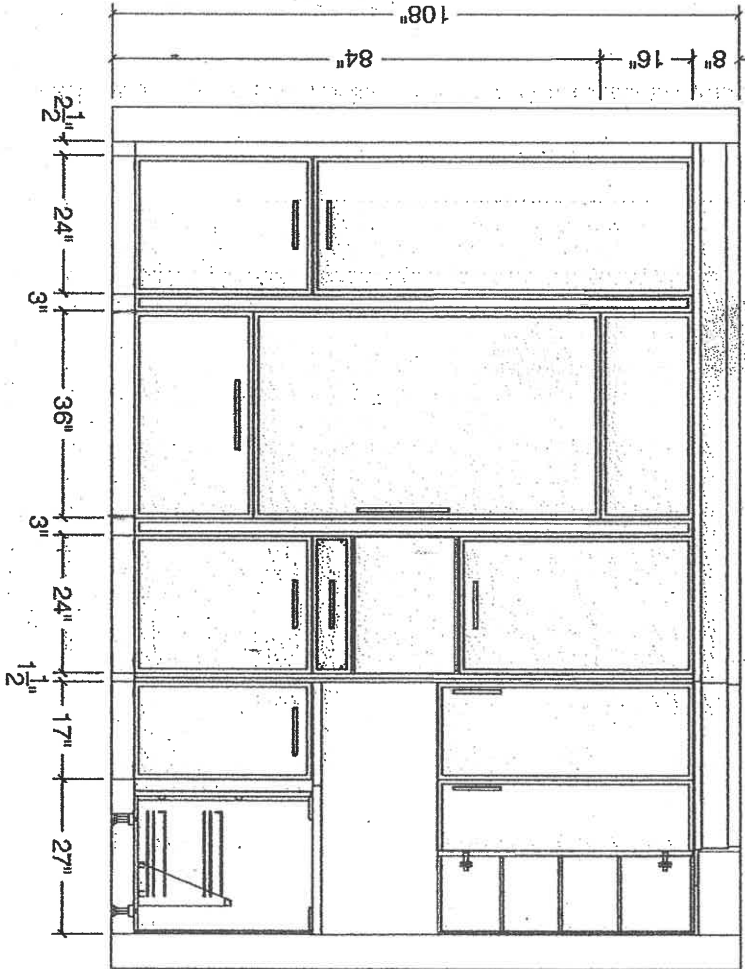

ELEVATION | STOVE WALL

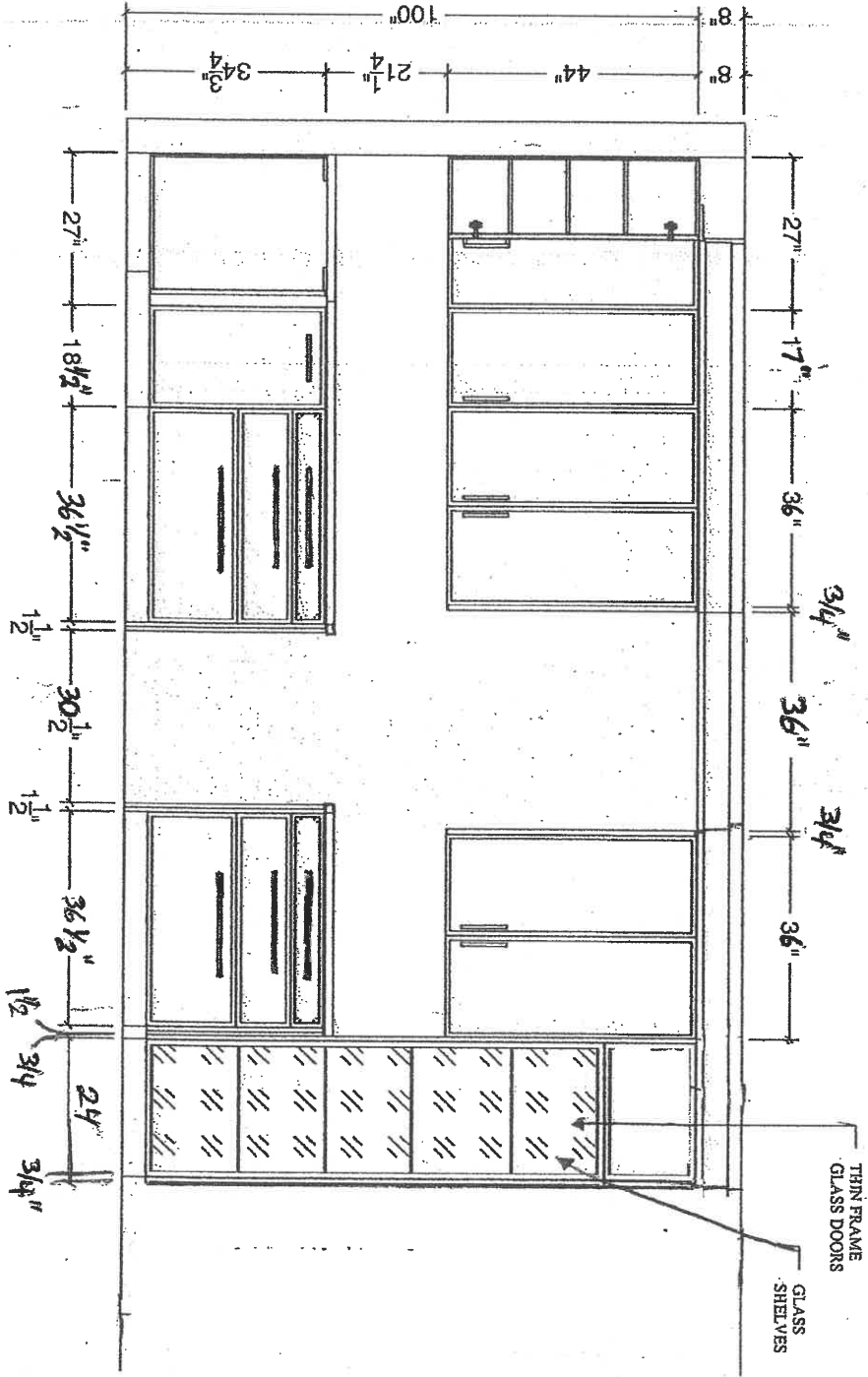

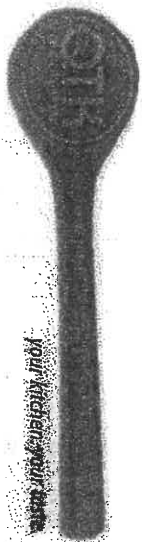

80 Sante Drive, Vaughan, ON L4K 3C4  
T 416.746.1811 F 905.761.5901  
www.QTK.ca info@qtk.ca

CLIENT: ZANCOR HOMES	JOB NAME: 2-12 KING	ROOM: KITCHEN	DRAWN BY: R.J
SITE: VILLAGE AT KING'S RIDGE	DOOR STYLE: —	DOOR HANDLE: —	SCALE: 1/2" = 1'-0"
PHONE: —	FINISH: —	DRW HANDLE: —	DATE: JULY 22, 2020
EMAIL: —	SPECIES: —	TOP: —	PAGE: 3 OF 4

COMMENTS:

Customer Agrees and Accepts the following conditions: 1. The Drawing is a representation only and the installed cabinetry may vary slightly in product size, measurements, handle appearance and location and other details. Although Quality Tops & Kitchens Ltd. (QTK) does its best to manufacture exactly what is shown here outside factors may prevent that and some variance is to be expected and accepted by the customer. 2. These drawings represent the intellectual property of QTK and as such the customer understands and accepts that all deposits given by the customer to QTK are non-refundable after QTK has supplied drawings (either physically or electronically) to the customer. If the customer decides to cancel the order after QTK has submitted drawings to the customer, the deposit will then be considered a design fee and no money will be returned to the customer.

ELEVATION | ISLAND FRONT

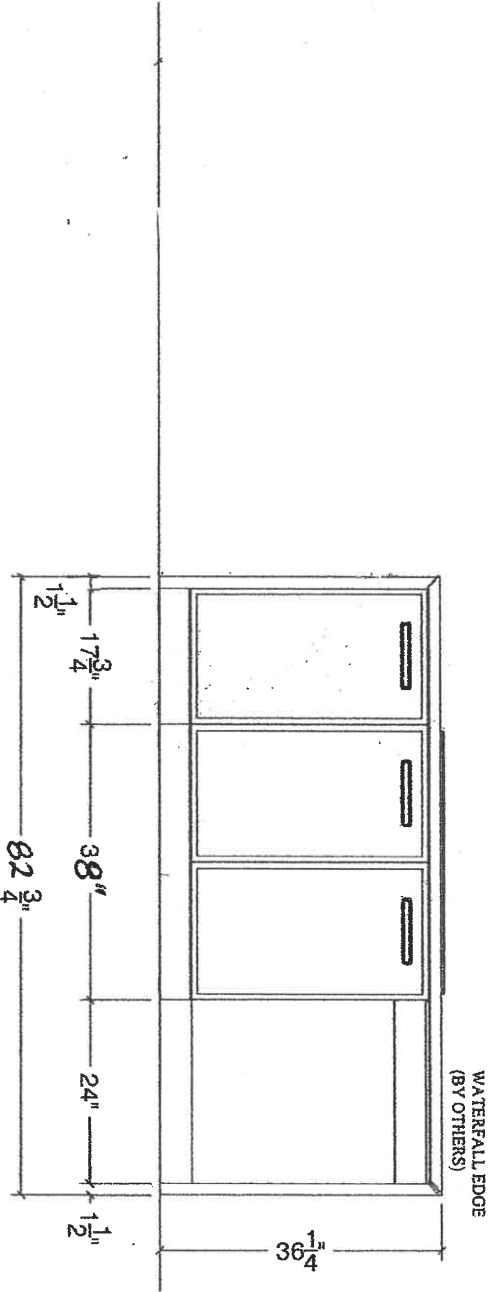

ELEVATION | ISLAND BACK

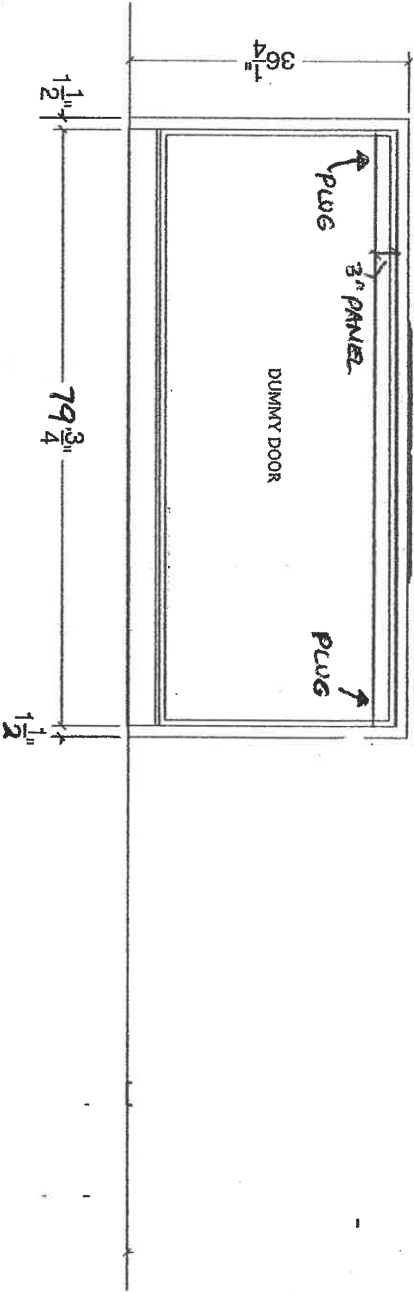

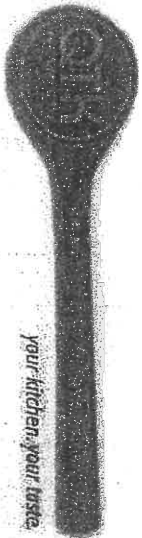

80 Santa Drive, Vaughan, ON L4K 3C4  
T 416.746.1811 F 905.761.5901  
www.QTK.ca info@qtk.ca

CLIENT: ZANCOR HOMES	JOB NAME: 2-12 KING	ROOM: KITCHEN	DRAWN BY: R.J
SITE: VILLAGE AT KING'S RIDGE	DOOR STYLE: —	DOOR HANDLE: —	SCALE: 3/8" = 1'-0"
PHONE: —	FINISH: —	DRW HANDLE: —	DATE: JUL Y 22, 2020
EMAIL: —	SPECIES: —	TOP: —	PAGE: 4 OF 4
COMMENTS:			

Customer Agrees and Accepts the following conditions: 1. The Drawing is a representation only and the installed cabinetry may vary slightly in product size, measurements, handle appearance and location and other details. Although Quality Tops & Kitchens Ltd. (QTK) does it's best to manufacture exactly what is shown here outside factors may prevent that and some variance is to be expected and accepted by the customer. 2. These drawings represent the intellectual property of QTK and as such the customer understands and accepts that all deposits given by the customer to QTK are non-refundable after QTK has supplied drawings (either physically or electronically) to the customer. If the customer decides to cancel the order after QTK has submitted drawings to the customer, the deposit will then be considered a design fee and no money will be returned to the customer.

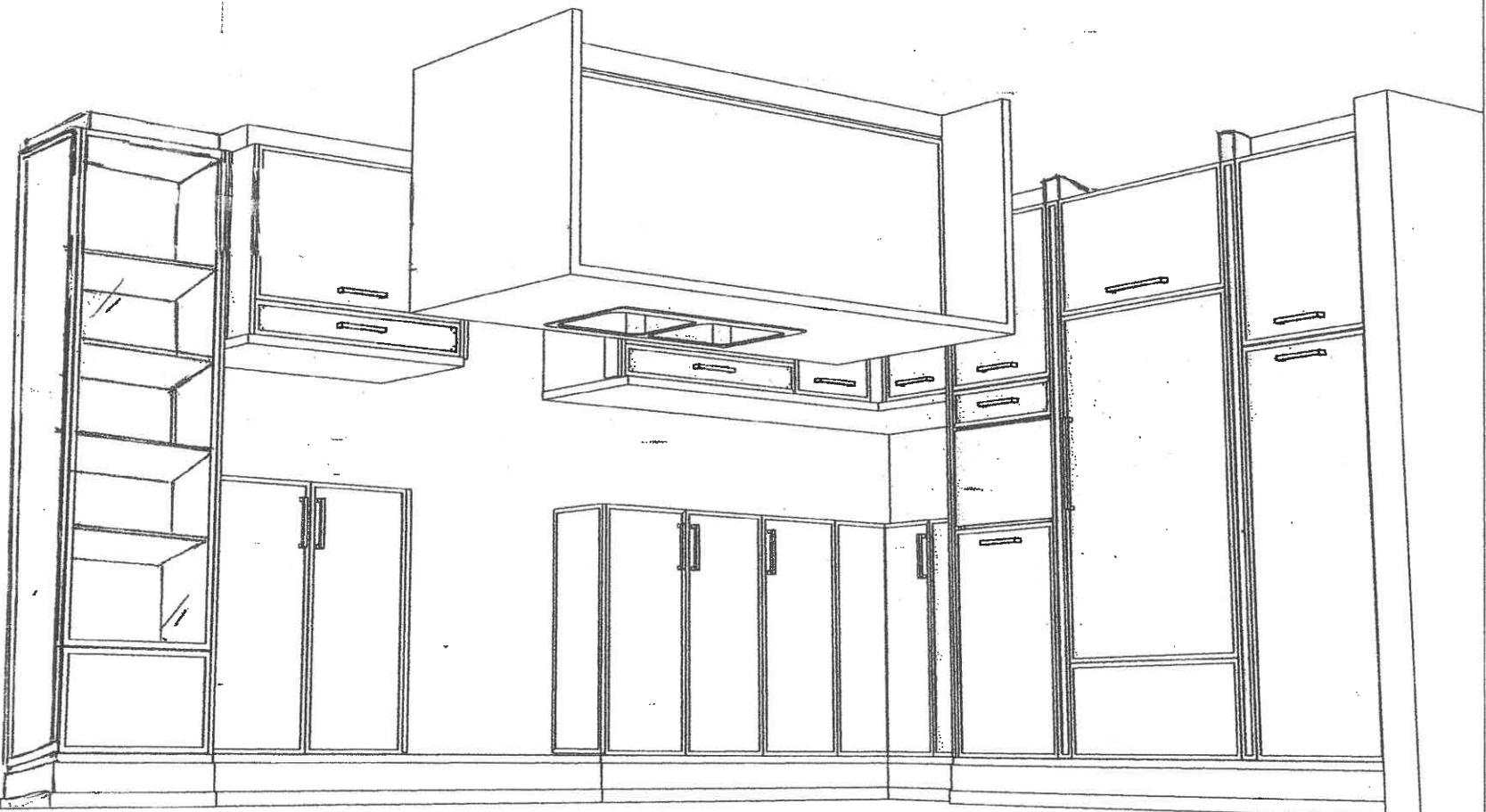

3D VIEW | KITCHEN

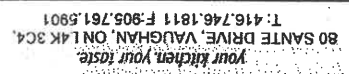

CLIENT: ZANCOR HOMES	JOB NAME: LOT 2 -12 KING	ROOM: ENSUITE VANITY	DRAWN BY: GT
SITE: KING CITY BLOCK 81	DOOR STYLE: —	DOOR HANDLE: —	SCALE: 1/2" = 1'-0"
PHONE: —	FINISH: —	DRW HANDLE: —	DATE: AUG 3, 2020
EMAIL: —	SPECIES: —	TOP: —	PAGE: —

COMMENTS:

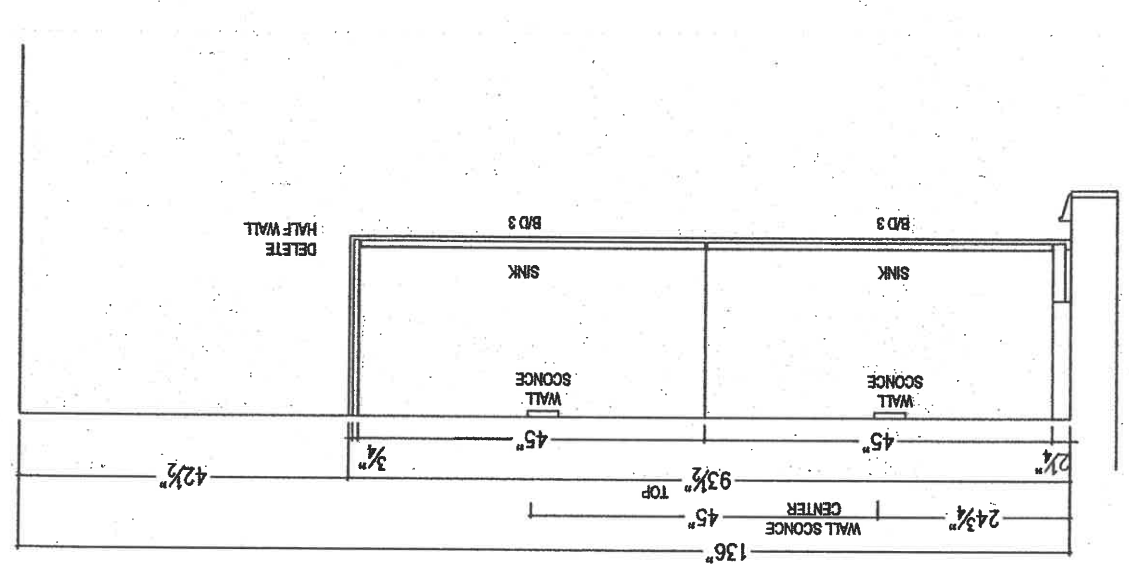

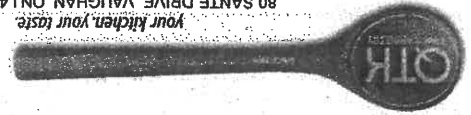

CLIENT: ZANCOR HOMES	JOB NAME: LOT 2 -12 KING	ROOM: MAIN VANITY	DRAWN BY: GT
SITE: KING CITY BLOCK 81	DOOR STYLE:	DOOR HANDLE:	SCALE: 1/2" = 1'-0"
PHONE:	FINISH:	DRW HANDLE:	DATE: AUG 3, 2020
EMAIL:	SPECIES:	TOP:	PAGE:

COMMENTS:

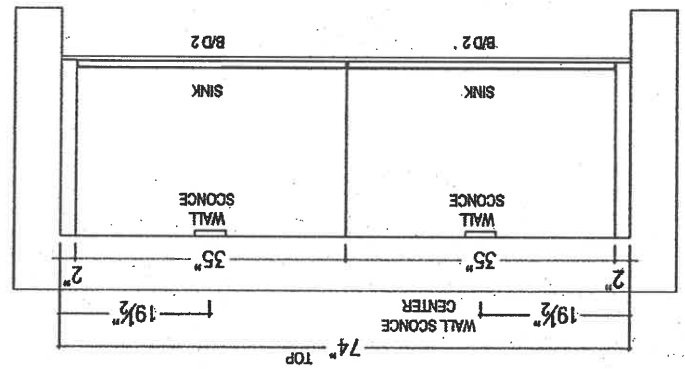
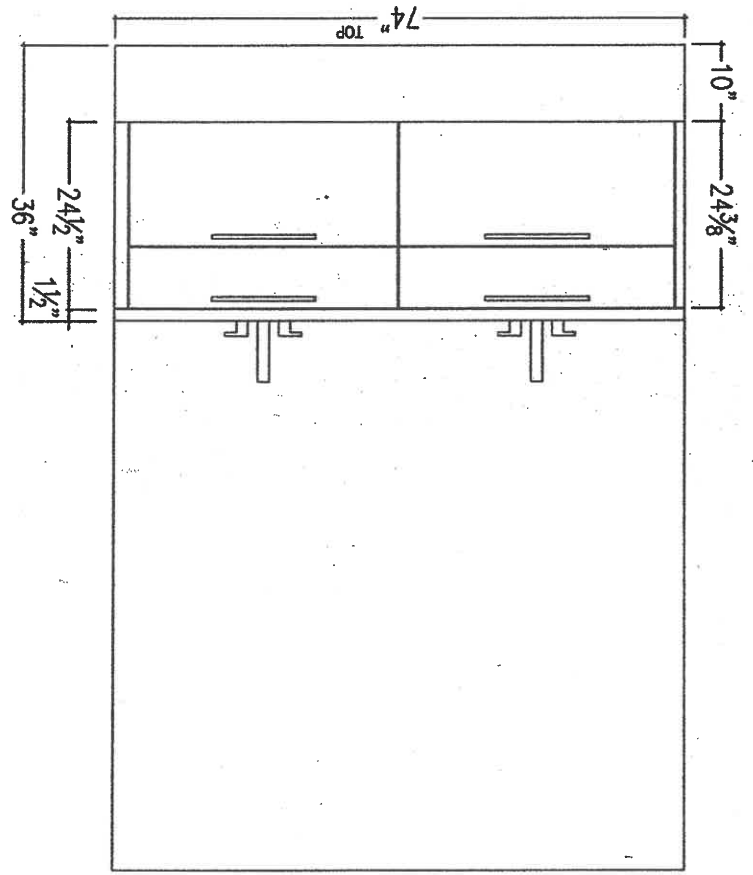

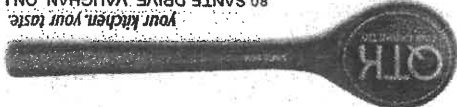

80 SANTE DRIVE, VAUGHAN, ON L4K 3C4  
T: 416.746.1811 F: 905.761.6801

CLIENT: ZANCOR HOMES	JOB NAME: LOT 2 -12 KING	ROOM: LAUNDRY - 2ND FLOOR	DRAWN BY: GT
SITE: KING CITY BLOCK 81	DOOR STYLE: —	DOOR HANDLE: —	SCALE: 1/2" = 1'-0"
PHONE: —	FINISH: —	DRW HANDLE: —	DATE: AUG 3, 2020
EMAIL: —	SPECIES: —	TOP: —	PAGE: —

COMMENTS:

