

CONSTRUCTION SUMMARY OF EXTRAS

Printed 2021-04-08 / 2:31 PM / Page 1 of 1

Site:  
Lot:  
Model:  
Purchaser:  
Purchaser:  
Phone:  
Email:

BROOKLIN NOW TOWNS  
2-11  
AMAZE RLT-1 (A)  
PATHMARAJAH RATNASINGAM  
0  
416-830-3932  
IDEALSTAIRS21@GMAIL.COM



| DESCRIPTION |  | DATE SELECTED   |
|-------------|--|-----------------|
|             | BONUS PACKAGE: 3 PIECE STAINLESS STEEL APPLIANCES WITH WHITE FRONT LOAD WASHER & DRYER                       | INCLUDED IN APS |
|             | BONUS PACKAGE: STAINLESS STEEL HOOD FAN  | INCLUDED IN APS |
|             | BONUS PACKAGE: AIR CONDITIONING UNIT   | INCLUDED IN APS |
|             |  |                 |
| #1          | NO STRUCTURAL CHANGES  | JAN 25 2021     |
|             | COLOURS  |                 |
| #1          | HARDWOOD UPGRADE 1 THROUGHOUT STANDARD (NON-TILED) AREAS   | MAR 30 2021     |
| #2          | VARNISH STAIRS ONLY **PURCHASER IS AWARE THAT THE STAIRS WILL BE A DIFFERENT COLOUR THAN THE HARDWOOD FLOORS | MAR 30 2021     |

ZANCOR HOMES COLOUR CHART

| CABINETRY / COUNTERTOPS   |   |                     |                                     |        |
|---|---|---------------------|-------------------------------------|--------|
|   | DOOR STYLE  | HARDWARE            | COUNTERTOP                          |        |
| SF - Kitchen  | EURO HIGH GLOSS WHITE                                   | H800BC              | UBA TUBA GRANITE                    |        |
| SF - Island   | EURO HIGH GLOSS WHITE                                   | H800BC              | UBA TUBA GRANITE                    |        |
| SF - Powder Room  | PEDESTAL  |                     |                                     |        |
| TF - Master Ensuite   | EURO HIGH GLOSS WHITE                                   | H800BC              | LAMINATE - 3692-58 LABRADOR GRANITE |        |
| TF - Main Bath  | EURO HIGH GLOSS WHITE                                   | H800BC              | LAMINATE - 3692-58 LABRADOR GRANITE |        |
| GF - Powder Room  | PEDESTAL  |                     |                                     |        |
| GF - Laundry  | N/A   |                     |                                     |        |
| TILES   |   |                     |                                     |        |
| GF - Foyer  | NEW BYZANTINE GREY 12 X 24 *STACKED                     |                     |                                     |        |
| GF - Mud Room/Laundry   | NEW BYZANTINE GREY 12 X 24 *STACKED                     |                     |                                     |        |
| GF - Powder Room  | NEW BYZANTINE GREY 12 X 24 *STACKED                     |                     |                                     |        |
| SF - Powder Room  | NEW BYZANTINE GREY 12 X 24 *STACKED                     |                     |                                     |        |
| SF - Kitchen  | HARDWOOD  |                     |                                     |        |
| SF - Breakfast  | HARDWOOD  |                     |                                     |        |
| TF - Master Ensuite Floor   | NEW BYZANTINE ASSURO 12 X 24 *STACKED                   |                     |                                     |        |
| TF - Master Ensuite Wall  | NEW BYZANTINE ASSURO 12 X 24 *STACKED                   |                     |                                     |        |
| TF - Master Ensuite Shower Floor  | WHITE 2 X 2   |                     |                                     |        |
| TF - Master Ensuite Shower Jamb   | BIANCO CARRARA  |                     |                                     |        |
| TF - Main Bath Floor  | NEW BYZANTINE ASSURO 12 X 24 *STACKED                   |                     |                                     |        |
| TF - Main Bath Tub Wall   | NEW BYZANTINE ASSURO 12 X 24 *STACKED                   |                     |                                     |        |
| HARDWOOD / CARPET   |   |                     |                                     |        |
| GF - Rec Room   | HARDWOOD - VINTAGE RED OAK 3-1/4" - ECLIPSE (PEARL) (1) |                     |                                     |        |
|   |   |                     |                                     |        |
| SF - Kitchen  | HARDWOOD - VINTAGE RED OAK 3-1/4" - ECLIPSE (PEARL) (1) |                     |                                     |        |
| SF - Breakfast  | HARDWOOD - VINTAGE RED OAK 3-1/4" - ECLIPSE (PEARL) (1) |                     |                                     |        |
| SF - Family   | HARDWOOD - VINTAGE RED OAK 3-1/4" - ECLIPSE (PEARL) (1) |                     |                                     |        |
| SF - Living / Dining Room   | HARDWOOD - VINTAGE RED OAK 3-1/4" - ECLIPSE (PEARL) (1) |                     |                                     |        |
|   |   |                     |                                     |        |
| TF - Upper Hall   | HARDWOOD - VINTAGE RED OAK 3-1/4" - ECLIPSE (PEARL) (1) |                     |                                     |        |
| TF - Master Bedroom   | CARPET - OPENING NIGHT - COLOUR T15 w/STANDARD UNDERPAD |                     |                                     |        |
| TF - Bedroom 2  | CARPET - OPENING NIGHT - COLOUR T15 w/STANDARD UNDERPAD |                     |                                     |        |
| TF - Bedroom 3  | CARPET - OPENING NIGHT - COLOUR T15 w/STANDARD UNDERPAD |                     |                                     |        |
| FIREPLACES  |   |                     |                                     |        |
| N/A   |   |                     |                                     |        |
| LOCATION  |   |                     |                                     |        |
| MIRRORS & ACCESSORIES   |   | PLASTER MOULDING    |                                     |        |
| Mirrors   | YES   | Opt. Crown Moulding | NO                                  |        |
| Bathroom Accessories  | YES   | Location            | NO                                  |        |
| Purchaser has reviewed the colour chart   |   |                     | SITE & LOT                          |        |
| ***FOR TRADE USE***   |   |                     | BROOKLIN NOW TOWNS                  | 2-11   |
| Any upgrades in the colour chart must be accompanied with a PES. It is the responsibility of all Trades to inform the builder of any discrepancies on sketches, PES and/or colour charts PRIOR to installation. |   |                     |                                     |        |
| ** PAGE 1 OF 2 **   |   |                     | Purchaser Initial                   | Vendor |

## STAIRS, RAILING & PICKETS & STAIR STAIN

**ZANCOR**  
HOMES

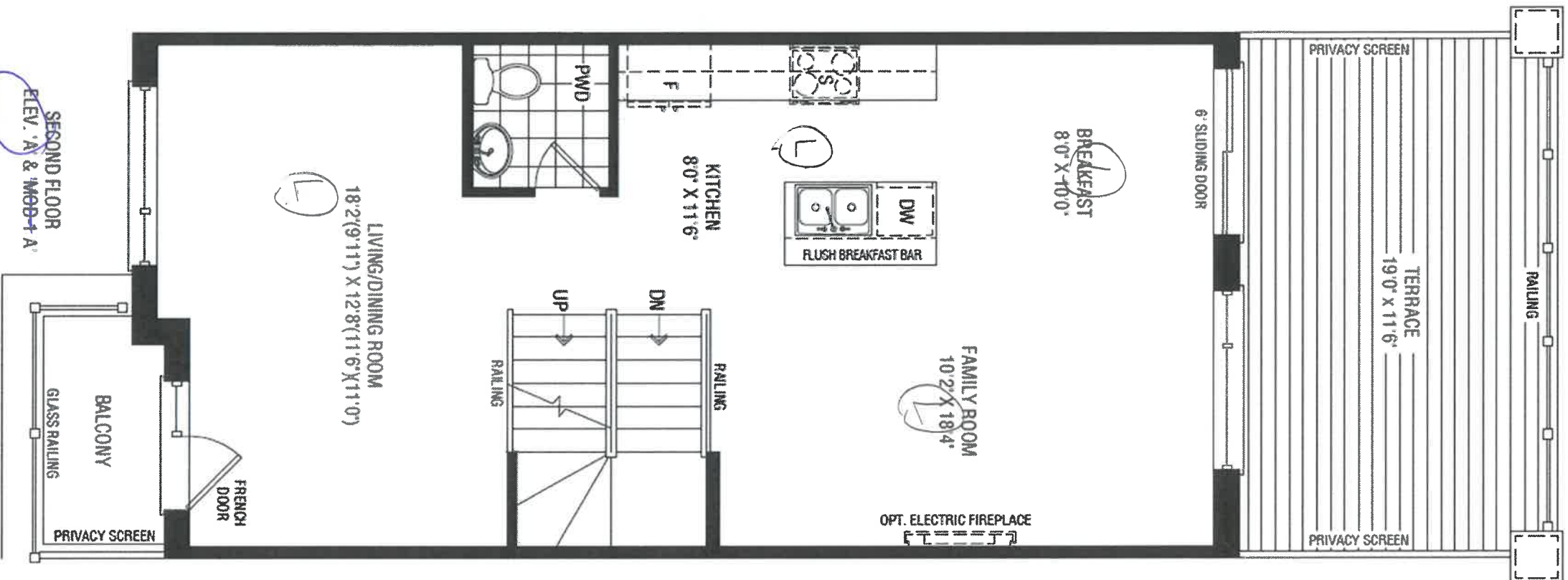

AMAZE

2-11

A

PA



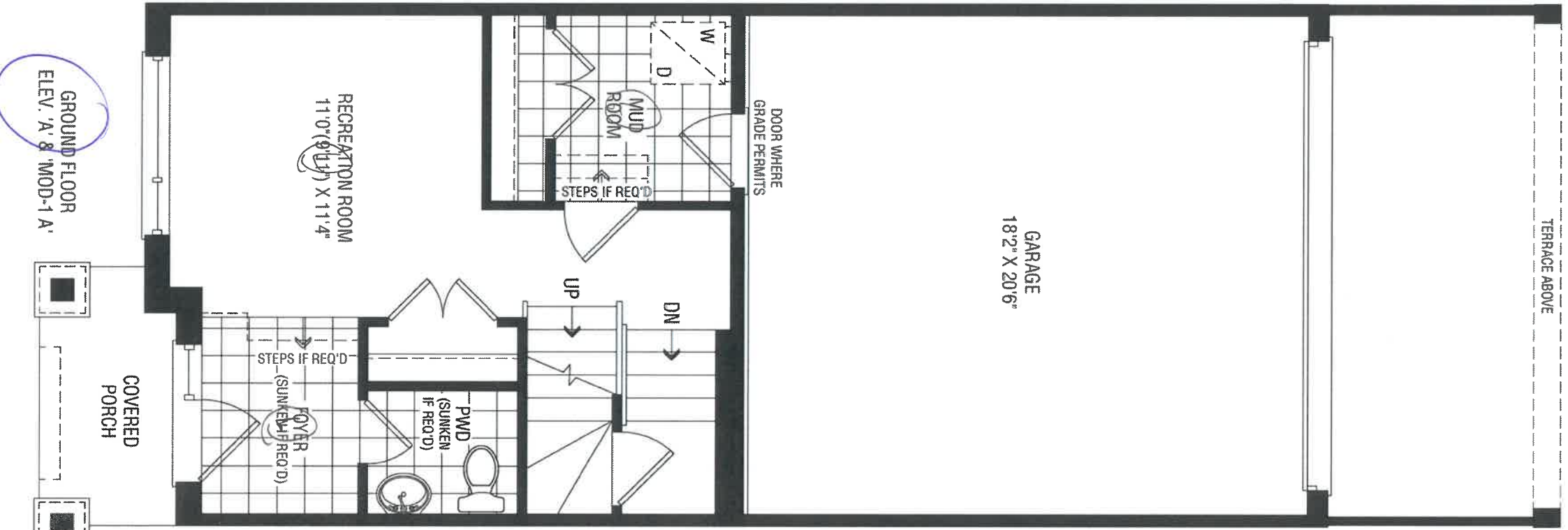

24

2-11

AMAZE

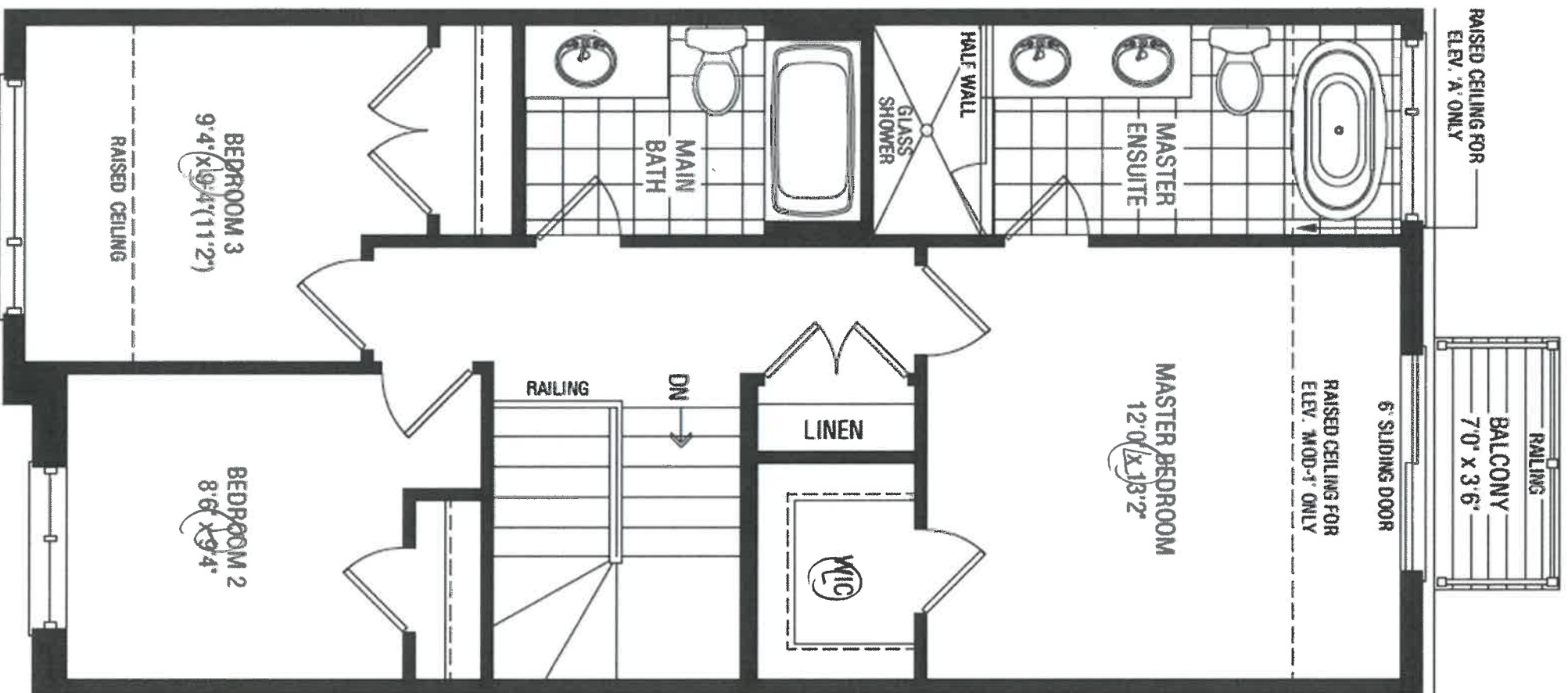

ⓧ

PR

2-11

AMAZE

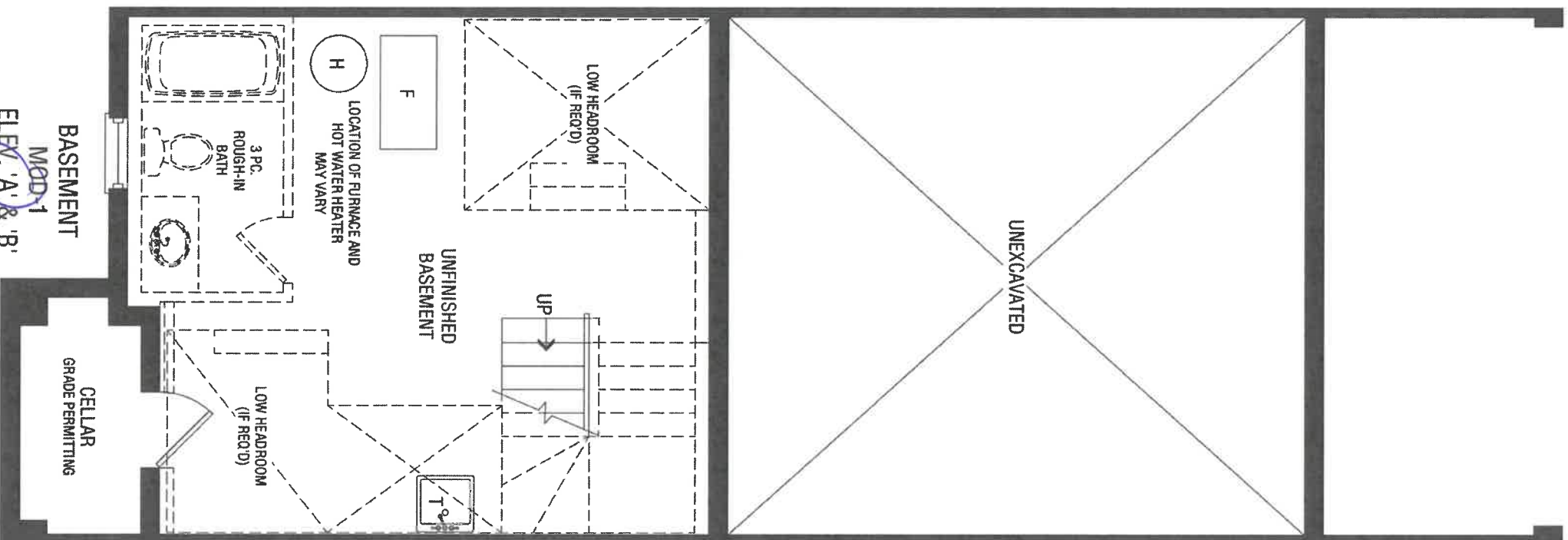

BASEMENT  
MOD-1  
ELEV. 'A' & 'B'

A

PA

2-11

AMAZE

**RLT-01**  
**KITCHEN ELEV. A & B**

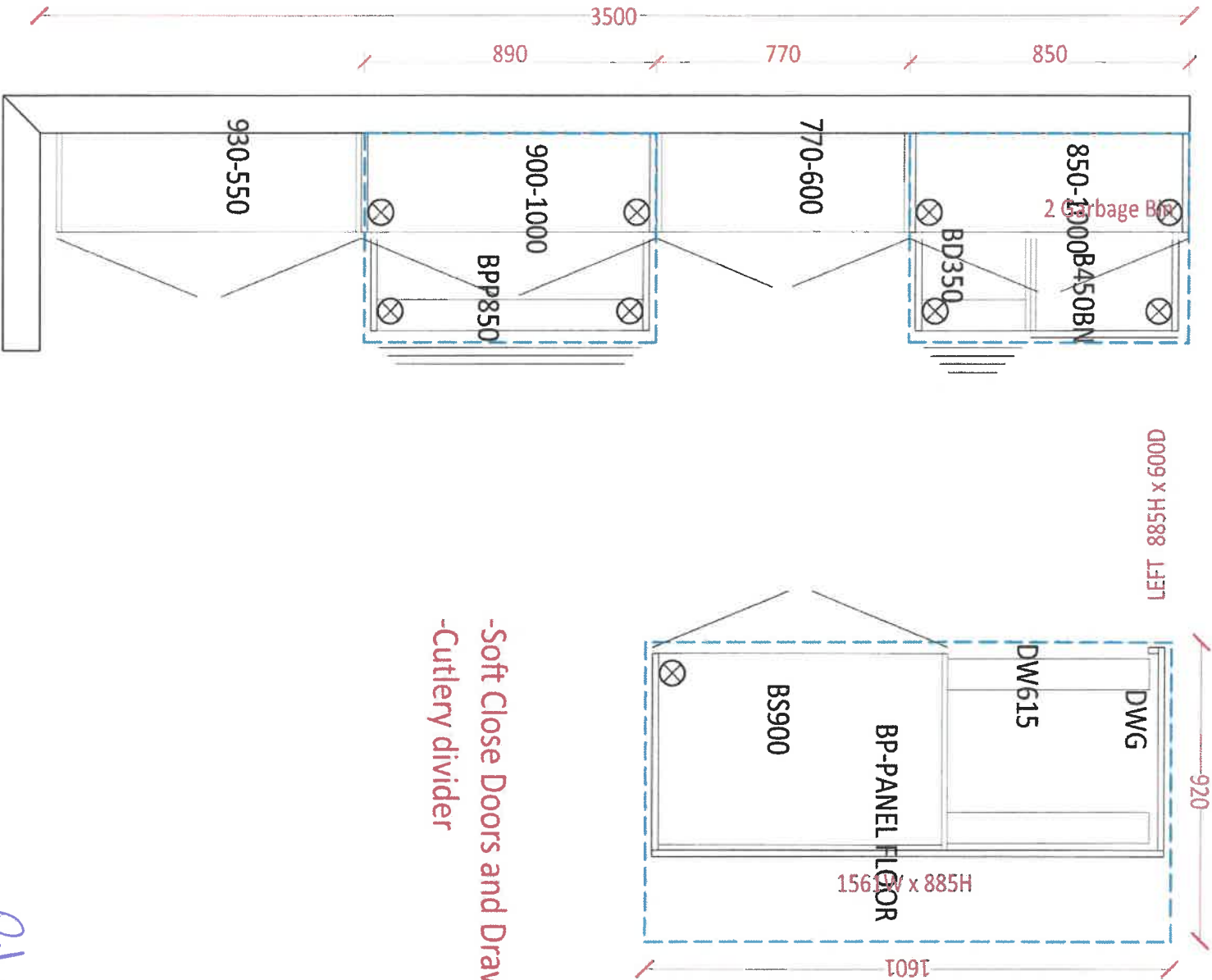



## APPLIANCE ACKNOWLEDGEMENT

CONTACT:  Steve Miller @ Appliance Canada (905) 660-2424 / 8701 Jane Street, Vaughan

▶ **Appliance Specs are DUE 2 WEEKS FROM SIGNED DATE OF COLOUR CHART (if not received during appointment)**

**\*\*Specs that require changes/modifications after this date will not be accepted\*\*\***

▶ NOTE: Any upgraded appliances are to be paid by the Purchaser, directly to the appliances company.

▶ Additional charges to the Purchaser may apply for cabinetry, electrical and plumbing in order to accommodate the specs given by the homeowner.

▶ It is the Purchaser's responsibility to coordinate delivery, installation and hook up of appliances and to ensure they are installed as per Manufacturers specifications after closing.

▶ Standard appliance openings are approximate and the minimum required. Sizes may vary due to onsite condition and/or when modifications have been made to the cabinetry.

### STANDARD OPENINGS ACKNOWLEDGED BY PURCHASER:

- Fridge Opening ▶ 36" x 74" \*\*Size is (+/-) & space above the fridge is required due to proper air flow
- Stove Opening ▶ 30"
- Hood Fan Opening ▶ 30"
- Hood Fan Vent ▶ 6"
- Dishwasher Opening ▶ 24"

  
INITIAL

### UPGRADED APPLIANCES BELOW (Check applicable)

**It is the Purchaser's responsibility to provide Zancor Homes with the correct specification for each appliance that has been upgraded. Zancor Homes will not be responsible for appliance requirements based on upgrades if specs have not been provided to the builder.**

  
INITIAL

#### FRIDGE

- ☐ Built-In ☐ Flush Inset
- (Spec's Required) ☐ Paneled / Integrated ☐ Water Line

#### RANGE

- ☐ 36" ☐ \*hood fan opening to be the same as the stove
- (Spec's Required) ☐ 48" ☐ Cooktop (Apron front)

\*\*Larger CFM may be required with these

\*\*Countertop Cut-out charge required for cooktop

appliances\*\*

☐ Induction

#### HOOD FAN &

- ☒ Under Cabinet (Standard) ☒ 6 Inch (Standard)

#### VENT

- ☐ Chimney (centre vent) ☐ 8 Inch
- (Spec's Required) ☐ Insert / Liner ☐ 10 Inch

#### WALL OVEN &

- ☐ Single Oven ☐ Warming Drawer

#### MICRO

- ☐ Double Oven ☐ Over the Range Microwave
- (Spec's Required) ☐ Steam Oven ☐ Built-in Microwave (\*trim kit required)

DATE

Mar 30/21

SITE

BROOKLIN TOWNS

LOT

2-11

\*\* Any upgrades checked in this appliance form must be accompanied with specs provided by the Purchaser.

\*\*It is the responsibility of the trade to inform the Builder of any discrepancies with specs, sketches, extras and/or colour chart PRIOR to production/installation.

221 North Rivermede Road, Concord, Ontario L4K 3N7 \* T: (905) 738.7010 F: (905) 738.5948

## INTERIOR FINISHES ACKNOWLEDGEMENT / WAIVER

Purchaser accepts and acknowledges that the Builder reserves the right to substitute materials with those of equal or better quality where the manufacture, scheduling or delivery of materials may directly impact the Builder's ability to meet its' contractual obligations under the Agreement of Purchase and Sale.

**UPGRADES/EXTRAS:** All upgrades and additional selections indicated on the colour chart must be accompanied by an upgrades/extras sheet (PES) and full payment otherwise the selection will be invalid. All colour charts and upgrades/extras will not proceed until verified and signed by an authorized signing officer at the Vendor's head office. **CHANGES WILL NOT BE PERMITTED UPON COMPLETION AND SUBMISSION OF THE COLOUR CHART.**

**PORCELAIN & NATURAL STONES:** Due to the properties of natural stones including but not limited to **marble, granite, quartz**, no two pieces are exactly the same. Variations in colour, tone, granularity (pitting, fissures) and pattern are to be expected, including various lighting may affect the overall finished look. Stone tops are sealed at time of installation and should never be cleaned with lemon oil or vinegar. Stones are porous materials, therefore any spilled substance require immediate attention. Stone countertops require regular seal re-application as part of home maintenance. Purchaser acknowledges colour and product variations as well as natural imperfections may exist with the selection of natural stone materials and shall not hold the Vendor liable for provision of same.

**STONE COUNTERTOP JOINTS:** Purchaser is aware that one joint will be at each corner and on either side of slide-in-range (if applicable). It will also be where the length of the counter top exceeds the length of a stone slab. Slabs are usually approximately 5' x 8'.

**CERAMIC TILES:** Due to manufacturing, shade (dye lots), product variations may exist that can affect the overall look of the finished product. Although every effort will be made to ensure the colours and materials selected are as close as possible to the samples, the purchaser acknowledges that the sample tiles supplied in the Design Centre may not be identical to the materials installed in the home.

**STAIR STAINS:** Due to the natural properties of wood, many variables can affect the overall look of the finished product. Factors including but not limited to wood type, knotting, graining, density, age, humidity, and air temperature can result in substantial variations in stain intensity. The purchaser accepts that although the Vendor will do their best to match stain the unfinished stairs as close as possible to the pre-finished floors, it is not possible to have an identical match and that there MAY be shade differences between the two products.

**CABINETRY:** Due to the natural properties of wood, slight variations apparent with cabinetry are to be expected. This includes but not limited to wood species, wood grain, colour, finish, product variations, and natural imperfections are all factors that may affect the overall look of the finished product. Such factors make exact colour matching impossible. The type and intensity of lighting in the areas of designated cabinetry placement may also highlight characteristics of cabinetry finish. All cabinets shall be finished with a white melamine interior box unless a finished interior is upgraded. Due to building specifications and/or on-site conditions, certain cabinetry upgrades may not be possible. The purchaser acknowledges that the Builder cannot guarantee the cabinetry finish or provision of certain upgrades and shall not hold the Builder liable for provision of same.

**UPGRADES/EXTRAS:** All upgrades and additional selections indicated on the colour chart must be accompanied by an upgrades/extras sheet (PES) and full payment otherwise the selection will be invalid. All colour charts and upgrades/extras will not proceed until verified and signed by an authorized signing officer at the Vendor's head office. **CHANGES WILL NOT BE PERMITTED UPON COMPLETION AND SUBMISSION OF THE COLOUR CHART.**

**HARDWOOD / LAMINATE FLOORING:** Due to the properties of wood and laminate, many variables can affect the overall look of the finished product. Variations include but not limited to wood type or laminate finish, colour/stain and wood grain are significant factors that make exact colour matching impossible. The purchaser acknowledges that the hardwood flooring is a pre-finished product in a controlled environment. Expansion, compression and cupping are characteristics of hardwood flooring once installed in the home. The purchaser acknowledges these may become apparent over time and despite the Builders' efforts to install the hardwood flooring materials in keeping with good workmanship, the Builder shall not be responsible nor held liable for minor variances of fluctuation in hardwood flooring materials.

### HARDWOOD / LAMINATE WAIVER:

I/We understand hardwood flooring is classified as a porous material and as such not recommended by the Builder in certain areas. I/We understand there is a concern due to possible water and other substances being frequently splashed or spilled onto the floor and in contravention of Ontario Building Code Section 9.30.1.2(1).

*"Finished flooring bathrooms, kitchens, public entrance halls, laundry & general storage areas shall consist of resilient flooring, felted-synthetic-fibre floor coverings, concrete, terrazzo, ceramic tile, mastic or other types of flooring providing similar degrees of water resistance."*

I/We are prepared to assume full responsibility for any damage caused to the hardwood floor or subfloor due to moisture absorbency in the mentioned areas, and agree to waive any claims against the Township of residence, TARIION and/or the Builder in relation to the matter. **\*\*SEE COLOUR CHART FOR LOCATIONS\*\***

DATE Mar 30/21

SITE BROOKLIN TOWNS

LOT 2-11

HOME AUTOMATION  
(Cable, CAT5, Telephone)

LOT / SITE: BROOKLIN TOWNS - 2-11

DATE: MAR 30/21

STANDARD ITEMS AS PER SCHEDULE A:

STANDARD CABLE ROUGHIN in (1) Master Bedroom, (1) Family / Great Room  
STANDARD TELEPHONE ROUGHIN in (1) Master Bedroom, (1) Family / Great Room  
STANDARD CAT5 ROUGHIN - (3) In location of Purchasers choice.

OPTION 1:

I/we the Homeowner(s) have chosen to contact the Home Automation Company to select the locations of the rough-ins for Cable, CAT5, Telephone as included in our Agreement of Purchase Sale.

I/we the Homeowner(s) will contact the trade within 4 weeks of the date of this release to select locations of the standard rough-ins review other optional products for purchase.

Trade: Artistic Smart Homes  
Phone: (905) 850-9386  
Rep: Jessica  
Location: 8601 Jane Street Unit #8 Vaughan ON L4K 5N9

Should the homeowner not make these selections within the sufficient time provided, the rough-ins as mentioned above will be installed in locations as indicated above.

Homeowner(s) Initial

OPTION 2:

I/we the Homeowner(s) have chosen to not contact the home automation company. I/we the Homeowner(s) have selected the locations for the standard rough-ins for Cable, CAT5, Telephone that are included in the Agreement of Purchase and Sale directly with a décor rep.

Homeowner(s) Initial



Stone Countertop Edge Profiles

\*\*Where applicable as per site specifications\*\*

LOT / SITE:

BROOKLIN TOWNS - 2-11

DATE:

Mar 30/21

STANDARD EDGE FOR KITCHEN & VANITIES

Standard Countertop Edge  
in Kitchen

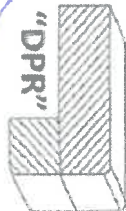

Standard Countertop Edge  
in Vanity



XRP

Homeowner(s) Initial

OPTION (1) EDGE FOR KITCHEN & VANITIES \$250

Optional Edge in Kitchen

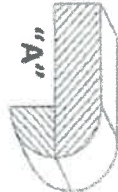
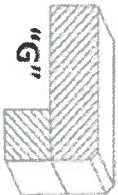
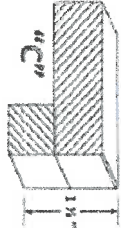

Optional Edge in Bathroom



Homeowner(s) Initial

OPTION (2) EDGE FOR KITCHEN & VANITIES CUSTOM PRICING

Optional Edge for Kitchen

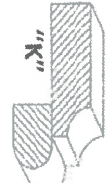
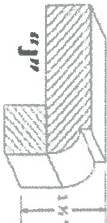

Optional Edge in Vanity



Homeowner(s) Initial