

Site: BROOKLIN NOW TOWNS

Lot: 2-12

Model: AMAZE (RLT-01) A

Purchaser: TROY ROOSEVELT ROYAN DOWNES

Purchaser: 0

Phone: 647.667.6184

Email: BIMMERSOURCE123@GMAIL.COM







DESCRIPTION		DATE SELECTED
	BONUS PACKAGE: 3 PIECE STAINLESS STEEL APPLIANCES WITH WHITE FRONT LOAD WASHER & DRYER	INCLUDED IN APS
	BONUS PACKAGE: STAINLESS STEEL HOOD FAN	INCLUDED IN APS
	BONUS PACKAGE: AIR CONDITIONING UNIT	INCLUDED IN APS
#1	TILE- SHOWER FLOOR- MASTER ENSUITE- UP 2	29-Apr-21
#2	HARDWOOD- REC ROOM, MAIN FLOOR (ALL NON TILED ARES), UPPER HALL- UP 1	29-Apr-21
#3	N/A	29-Apr-21
#4	24" MOEN METHOD TOWEL BAR- 1 MASTER ENSUITE AND 1 MAIN BATH- YB2424	29-Apr-21
#5	PIVOTING TOILET PAPER HOLDER- YB2408- 1 MASTER ENSUITE, 1 MAIN BATH, 1 SF POWDER, 1 GF POWDER	29-Apr-21
#6	9" TOWEL BAR- YB2486- 1 GF POWDER, 1 SF POWDER	29-Apr-21
#7	50" LINEAR ELECTRIC FIREPLACE BLF5051 , WALL BUILT INTO THE ROOM APPROX 8" DEEP TO ACCOMIDATE. WALL TO BE 65" WIDE FINISHED.	29-Apr-21
#8	PLUG ABOVE FIREPLACE FOR FUTURE TV. TO BE INSTALLED BESIDE CABLE- 65" AFF	29-Apr-21
#9	2 CAPPED LIGHTS TO BE EVENLY SPACED OVER THE KITCHEN ISLAND, ON SEPARATE SWITCH, STANDARD KITCHEN LIGHT TO REMAIN	29-Apr-21
#10	N/A	29-Apr-21
#11	KITCHEN CABINET- UP 1	29-Apr-21
#12	KITCHEN BACKSPLASH- UP 3- INSTALL BRICKED	29-Apr-21
#13	COMFORT HEIGHT- MASTER ENSUITE	29-Apr-21
#14	HARDWARE- BERENSON ARROWHEAD- CHROME- 128MM- QTY 4- MASTER ENSUITE, QTY 4- MAIN BATH	29-Apr-21
#15	N/A	29-Apr-21
#16	HOMEOWNER ARE AWARE AND ACCPET THAT THE STAIRS WILL BE A DIFFERENT COLOUR THAN THE FLOORS	29-Apr-21
	****VARNISH ONLY****	

ZANCOR HOMES COLOUR CHART

PRINTED 2021-04-29, 12:27 PM

ENTRANCES				
Main Foyer - FLOORING		LOFT IVORY 12 X 24		
Mudroom - FLOORING		LOFT IVORY 12 X 24		
Side Hall - FLOORING		NA		
Basement Foyer - FLOORING		NA		
KITCHEN				
Kitchen - FLOORING		NORTHERN SOLID SAWN COLLECTION RED OAK 3 1/4" ECLIPSE- UP 1		
Breakfast - FLOORING		NORTHERN SOLID SAWN COLLECTION RED OAK 3 1/4" ECLIPSE- UP 1		
Kitchen - CABINETS		CAMBRIDGE MDF GLACIER WHITE UP 1		
Island - CABINETS		CAMBRIDGE MDF GLACIER WHITE UP 1		
Servery - CABINETS		NA		
Kitchen - HANDLES/KNOBS		K400P		
Kitchen - COUNTERTOP		BIANCO SARDO		
Island - COUNTERTOP		BIANCO SARDO		
Kitchen - BACKSPLASH		TAVELLA SATIN POLVERE 3 X 6- UP 3- BRICK PATTERN		
Kitchen - SINK		STD		
Kitchen - FAUCET		STD		
GREAT ROOM / DINING / LIVING / DEN / OFFICE / BASEMENT				
Dining Room - FLOORING		NORTHERN SOLID SAWN COLLECTION RED OAK 3 1/4" ECLIPSE- UP 1		
Living Room - FLOORING		NORTHERN SOLID SAWN COLLECTION RED OAK 3 1/4" ECLIPSE- UP 1		
Great Room - FLOORING		NA		
Library / Den - FLOORING		NA		
GF- Basement Rec Room - FLOORING		NORTHERN SOLID SAWN COLLECTION RED OAK 3 1/4" ECLIPSE- UP 1		
STAIRS				
Railing Details - PICKETS		METAL BLACK SINGLE COLLAR W/ ALT PLAIN		
Railing Details - POSTS		2 3/4" TURNED OAK POST		
Railing Details - HANDRAIL		2 1/2" OVAL OAK HANDRAIL		
Stair Stain - MAIN STAIRS		VARNISH ONLY, STAIRS WILL BE DIFFERENT COLOUR THAN FLOORS		
Stair Stain - BASEMENT STAIRS (if applicable)		NA		
Stair Stain - SERVICE STAIRS (if applicable)		NA		
POWDER ROOM				
GF- Powder Room - FLOORING		LOFT IVORY 12 X 24- STACKED		
Powder Room - CABINETS		NA		
SF- Powder Room - FLOORING		LOFT IVORY 12 X 24- STACKED		
Powder Room - SINK		STD		
Powder Room - FAUCET		STD		
2ND FLOOR				
Upper Hall - FLOORING		NORTHERN SOLID SAWN COLLECTION RED OAK 3 1/4" ECLIPSE- UP 1		
Master Bedroom - FLOORING		T04 OPENING NIGHT		
Bedroom 2 - FLOORING		T04 OPENING NIGHT		
Bedroom 3 - FLOORING		T04 OPENING NIGHT		
Bedroom 4 - FLOORING		NA		
Bedroom 5 - FLOORING		NA		
Master Ensuite - FLOORING		LOFT IVORY 12 X 24- STACKED		
Master Ensuite - SHOWER WALL		LOFT IVORY 12 X 24- STACKED & VERTICLE		
Master Ensuite - SHOWER FLOOR		TUNDA GREY 2 X 2 - UP 2		
Master Ensuite - SHOWER JAMB		PERLATO ROYALE		
Master Ensuite - CABINETS		SHAKER V PVC TUXEDO- COMFORT HEIGHT		
Master Ensuite - HANDLES/KNOBS		BERENSON ARROWHEAD CHROME 128MM		
Master Ensuite - COUNTERTOP		4924-38 WHITE CARRARA		
Master Ensuite - SINK(S)	STD	Master Ensuite - FAUCET(S)	STD	
FOR TRADE USE				
Any upgrades in the colour chart must be accompanied with a PES. It is the responsibility of all Trades to inform the builder of any discrepancies on sketches, PES and/or colour charts PRIOR to installation.		BROOKLIN 2-12		
PAGE 1 OF 2		PURCHASER INITIALS	VENDOR APPROVAL	

2ND FLOOR CONTINUED ...

Main Bath - FLOORING	NEW BYZANTINE ASSURO (BLUE) 12 X 24- STACKED & VERTICLE		
Main Bath - TUB / SHOWER WALL	NEW BYZANTINE ASSURO (BLUE) 12 X 24- STACKED & VERTICLE		
Main Bath - SHOWER FLOOR	NA		
Main Bath - SHOWER JAMB	BIANCO CARRARA		
Main Bath - CABINETS	MOSAIC OAK TIMBER GREY		
Main Bath - HANDLES/KNOBS	BERENSON ARROWHEAD CHROME 128MM ✓		
Main Bath - COUNTERTOP	WHITE CASCADE 5003-38		
Main Bath - SINK(s)	STD	Main Bath - FAUCET(s)	STD
Shared Bath- FLOORING	NA		
Shared Bath- TUB / SHOWER WALL	NA		
Shared Bath- SHOWER FLOOR	NA		
Shared Bath- SHOWER JAMB	NA		
Shared Bath- CABINETS	NA		
Shared Bath- HANDLES/KNOBS	NA		
Shared Bath- COUNTERTOP	NA		
Shared Bath- SINK(s)	NA	Shared Bath - FAUCET(s)	NA
Ensuite Bath - FLOORING	NA		
Ensuite Bath - TUB / SHOWER WALL	NA		
Ensuite Bath - SHOWER FLOOR	NA		
Ensuite Bath - SHOWER JAMB	NA		
Ensuite Bath - CABINETS	NA		
Ensuite Bath - HANDLES/KNOBS	NA		
Ensuite Bath - COUNTERTOP	NA		
Ensuite Bath - SINK(s)	NA	Ensuite Bath - FAUCET(s)	NA
LAUNDRY			
Laundry - FLOORING	LOFT IVORY 12 X 24	Laundry - HANDLES/KNOBS	NA
Laundry - CABINETS	NA	Laundry - SINK	NA
Laundry - COUNTERTOP	NA	Laundry - FAUCET	NA
Laundry - BACKSPLASH	NA		
TRIM / PAINT			
Casing/Baseboards		STD	
Interior Doors		STD	
Interior Door Hardware		STD	
PAINT - Throughout		WARM GREY	
FIREPLACE			
Location / Insert / Mantle	50" LINEAR BLF5051 ✓		
ACCESSORIES			
Mirrors	YES	BATH ACCESSORIES	UPGRADE ✓
APPLIANCE REQUIREMENTS			
GAS LINE TO BBQ	STANDARD	ELECTRICAL for Built-in Oven	DECLINED
GAS LINE & ELECTRICAL TO STOVE	DECLINED	ELECTRICAL for Built-in Micro	DECLINED
GAS LINE & ELECTRICAL TO DRYER	DECLINED	ELECTRICAL for Cooktop	DECLINED
HOOD FAN VENT SIZE	STANDARD	ELECTRICAL for Bar Fridge	DECLINED
WATERLINE to Fridge	DECLINED		
DISCLAIMER			
Any changes to the colour chart after signing are subject to a \$5000 administration fee plus costs			
Purchaser has checked and acknowledged accuracy of colour and selections before signing.			
Colours of all materials are as close as possible to Builders selection but not necessarily identical due to dye lot variances in manufacturing/manufacturers. Due to construction progress some items may have been pre-selected or installed. In this event the Vendor's selection must be accepted by the purchaser			
SITE / LOT:	BROOKLIN LOT 2-12		
PURCHASER(S):	TROY ROOSEVELT ROYAN DOWNES		
PURCHASER(S):	0		
CONTACT:	647.667.6184	BIMMERSOURCE123@GMAIL.COM	
FOR TRADE USE			
Any upgrades in the colour chart must be accompanied with a PES. It is the responsibility of all Trades to inform the builder of any discrepancies on sketches, PES and/or colour charts PRIOR to installation.			
ZANCOR HOMES		PURCHASER SIGNATURE	
		PURCHASER SIGNATURE	
		DÉCOR CONSULTANT	
		Vendor APPROVAL	 May 4/21

ALL PRICES ARE PER PIECE

BERENSON - ARROWHEAD

Master Bath
Main Bath

CHROME

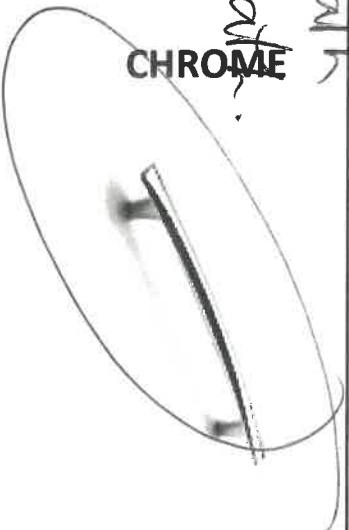

- Knob
- 96mm
 - 128mm
 - 160mm
 - 256mm
 - 320mm

BRUSHED
NICKEL



- Knob
- 96mm
 - 128mm
 - 160mm
 - 256mm
 - 320mm
 - 448mm

BRUSHED
BRASS



- Knob
- 96mm
 - 128mm
 - 160mm
 - 256mm
 - 320mm

GRAPHITE



- Knob
- 96mm
 - 128mm
 - 160mm
 - 256mm
 - 320mm

MATTE BLACK



- Knob
- 96mm
 - 128mm
 - 160mm
 - 256mm
 - 320mm

8-12

AMAZE

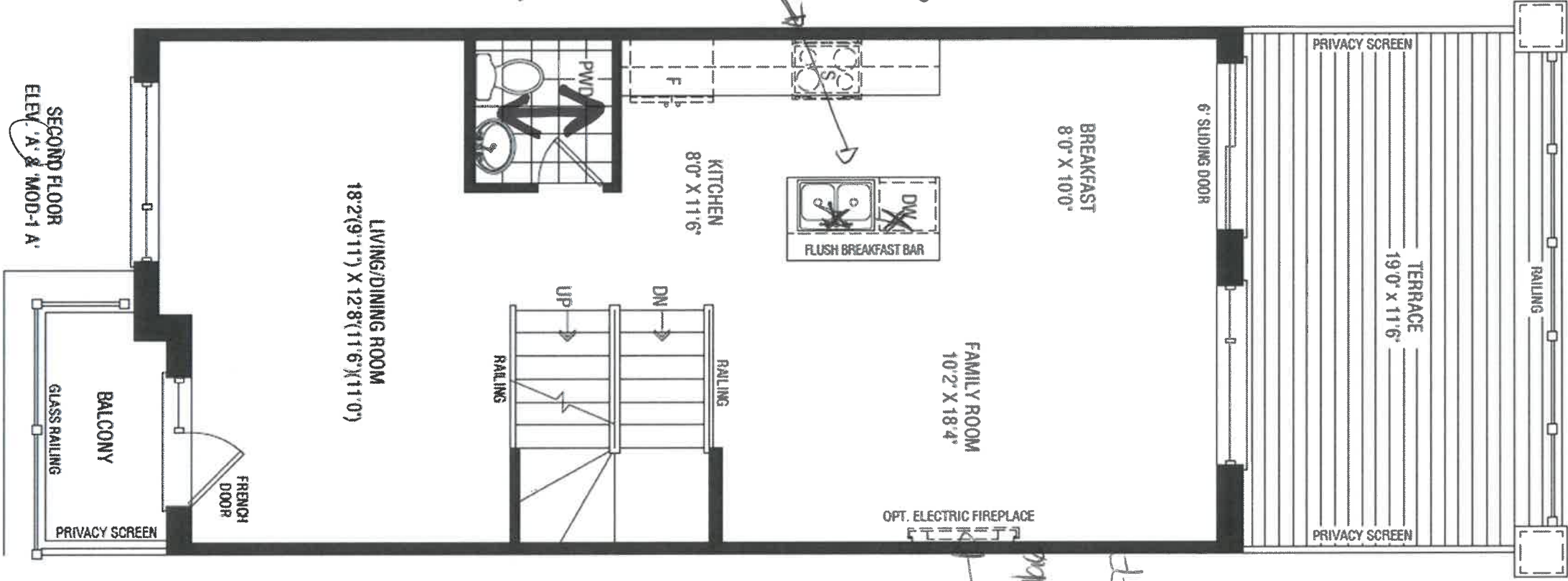

50" electric
fireplace.
WALL TO BE
65" wide.
plug above fireplace
for future TV
65" AFF
install

Lot 2-12
Apr. 29/21

Lot 2-12
Apr. 29/21

Tile
direction

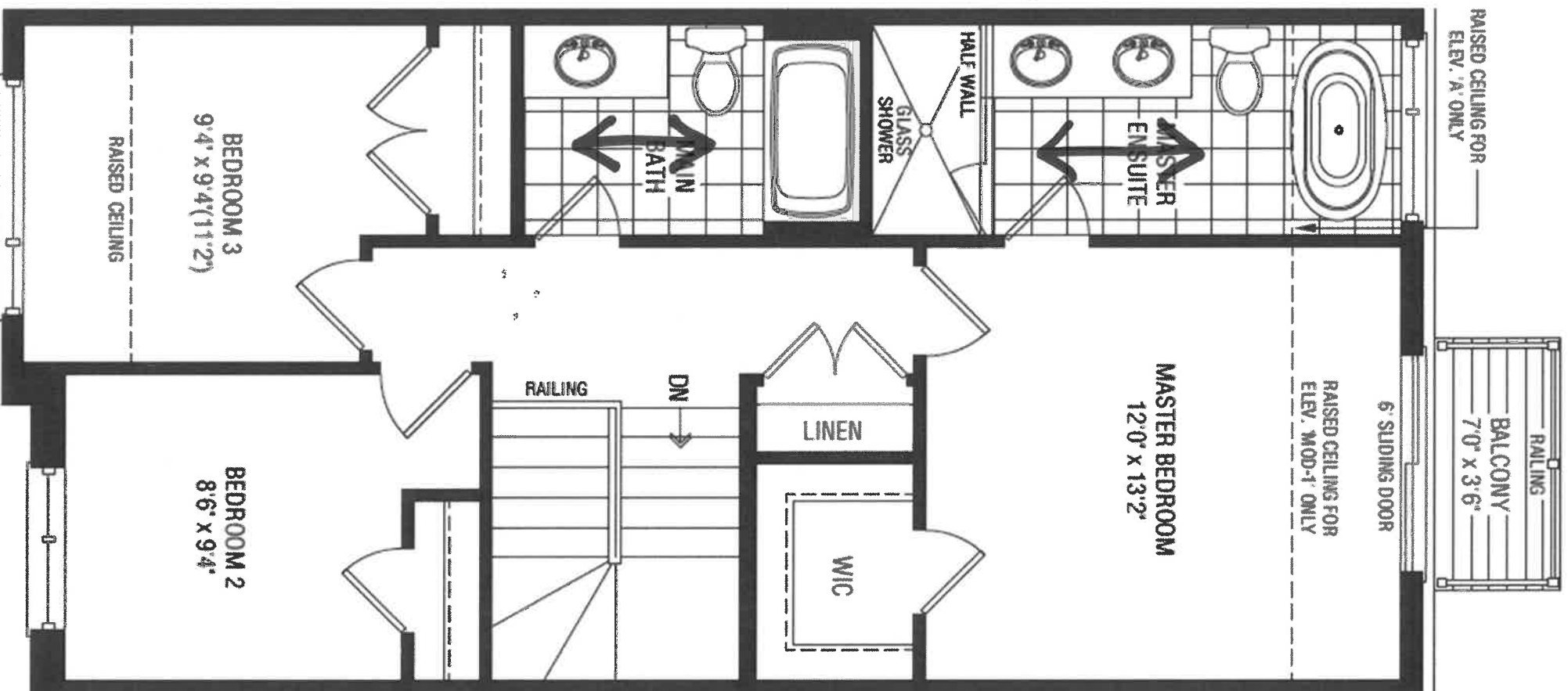

THIRD FLOOR
ELEV. 'A' & 'MOD-1 A'

AMAZE

1 of 2-12
Apr. 29/21

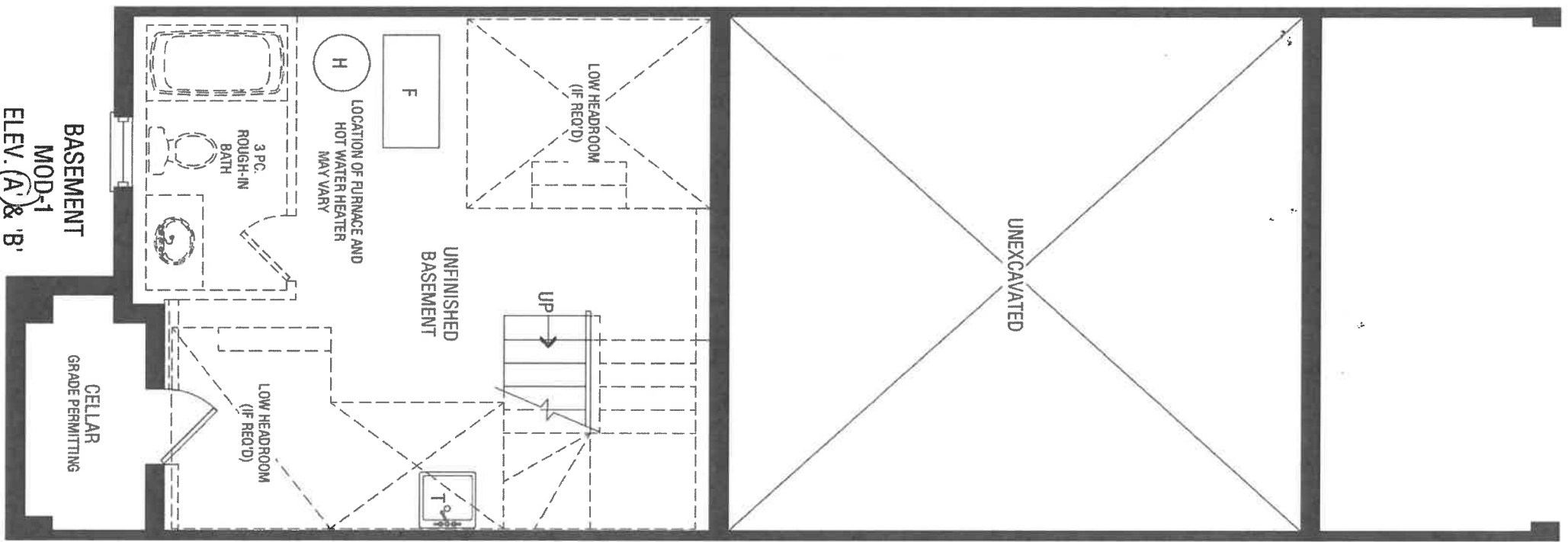

[Handwritten signature]

AMAZE

Lot 2-12
Apr. 29/21

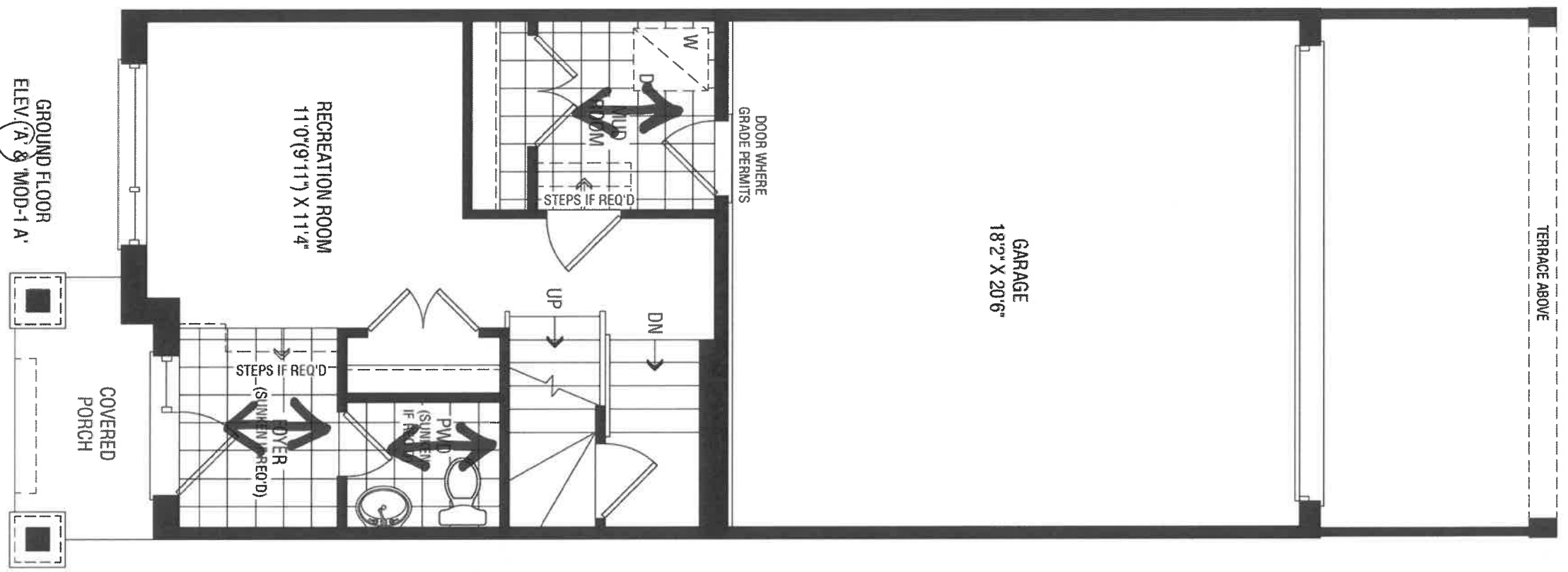

The
direction

AMAZE





DATE SUBMITTED
30 Mar 2021

CLIENT NAME: ZANCOR HOMES
SHIP TO : BROOKVALLEY TOWNS

PH:
CELL:

DRAFTED BY: FERNANDA
COMMENT

P/O #

JOB NUMBER

INSTALL DATE:

PAGE

11 of 19

RLT-01
KITCHEN 3D DRAWING

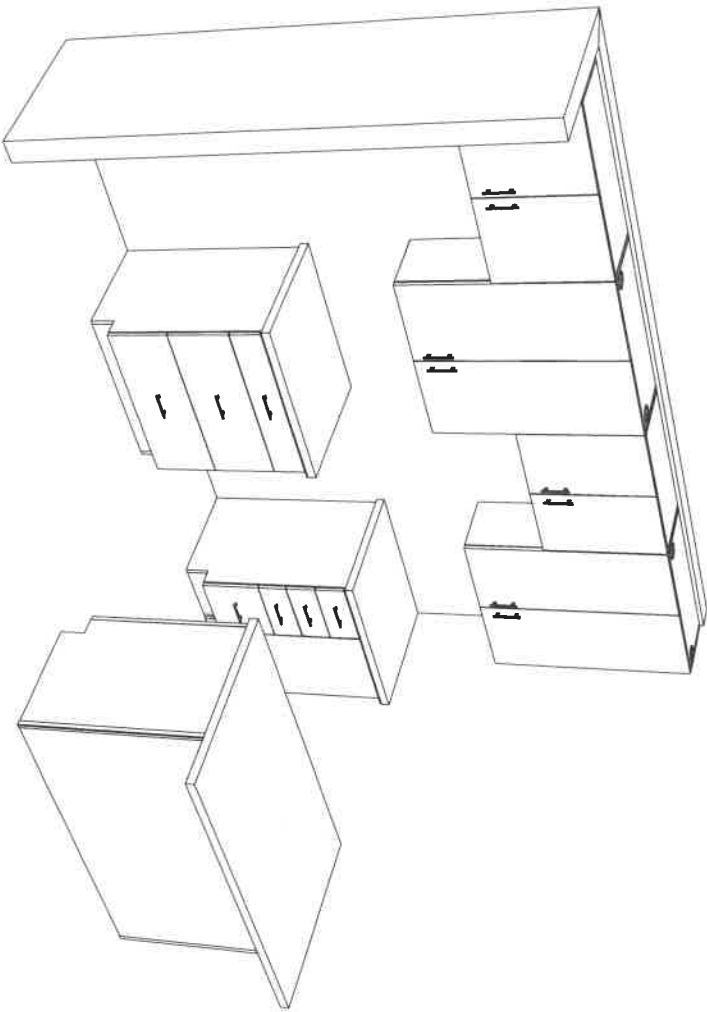

1 of 2-12
Apr. 29/21

Fernanda
Kitchen



DATE SUBMITTED
30 Mar 2021

CLIENT NAME: ZANCOR HOMES
SHIP TO : BROOKVALLEY TOWNS

DRAFTED BY: FERNANDA
COMMENT

PH:
CELL:

P/O #

JOB NUMBER

INSTALL DATE:

PAGE

10 of 19

RLT-01
KITCHEN ELEV. A & B

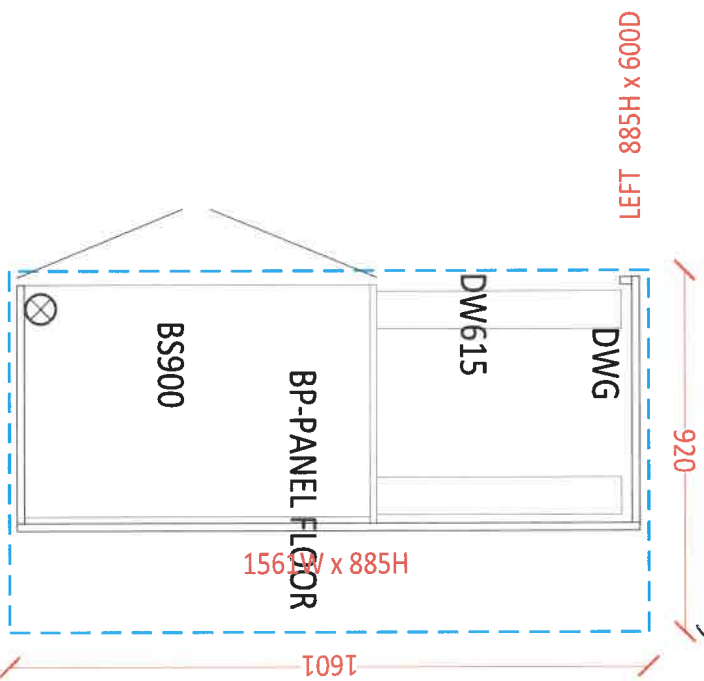
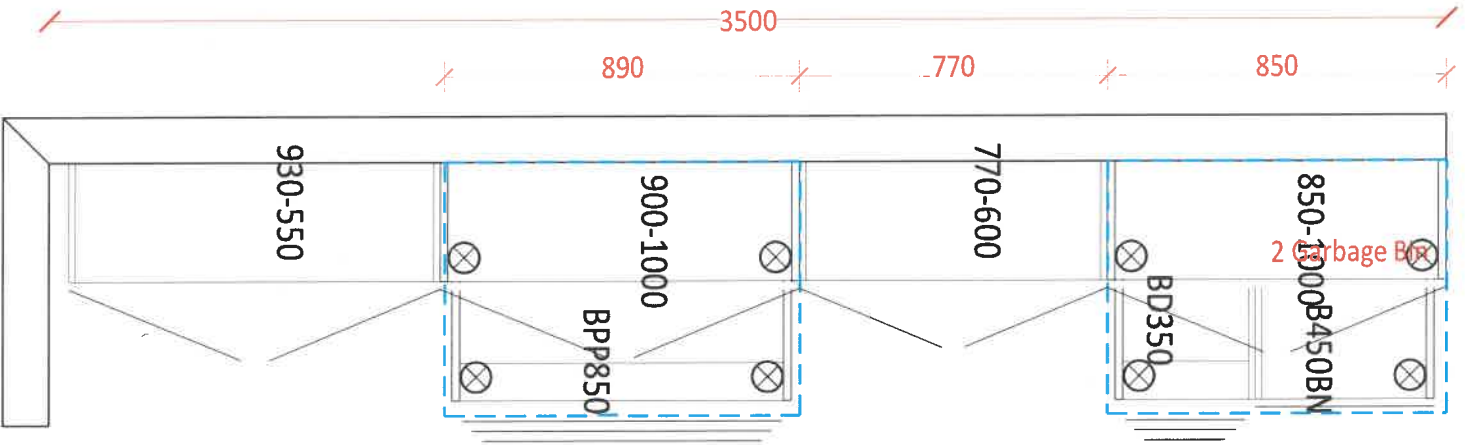

-Soft Close Doors and Drawers
-Cutlery divider

Standard
Kitchen

MPG / cabinets

Lot 2-12
Apr. 29/21

CLIENT NAME: ZANCOR HOMES
SHIP TO : BROOKVALEY TOWNS

PH:
CELL :

DRAFTED BY: FERNANDA
COMMENT

P/O #

JOB NUMBER

INSTALL DATE:

PAGE

12 of 19

RLT-01
STANDARD VANITIES ELEV A & B

MAIN
1260

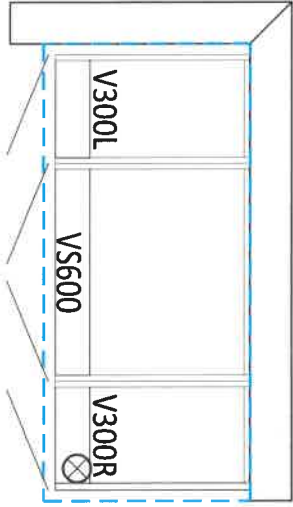

1 of 2-12
Apr. 29/21

MASTER ENSUITE

1660

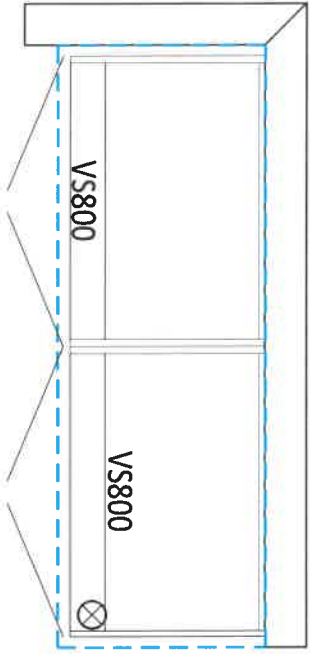

Confer
Helel

OPT. BASEMENT BATH

960

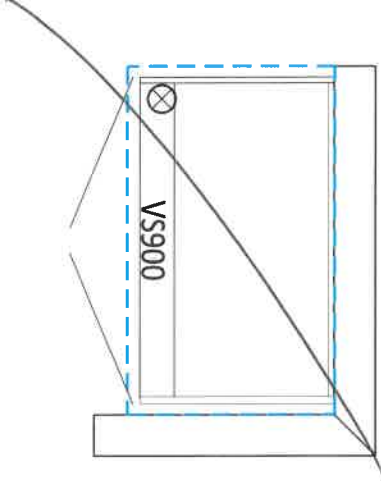

Handwritten signature

BRICK/JOINT PATTERN INSTALLATION RELEASE FORM

LOT / SITE: BROOKLIN TOWNS - 2-12

DATE: April 29/21

Brick installation requires an additional charge and must be included on the extras if selected

(Large tiles installation for floor and wall) – ¾ Brick

Please be advised it has come to our attention, that due to production, many of the over-sized and odd it is therefore recommended, that if and when a purchaser requests to install one of these tiles in a brick-

LOCATIONS: Kitchen Backsplash

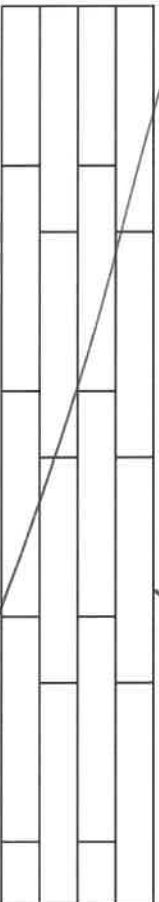

Please understand, even in using this ¾ brick installation, there may still be minimal lippage which cannot Hence, when there is a request for brick-joint installation, Zancor Homes and their contractor, cannot be held

Homeowner(s) Initial

(Small tile installation for walls) – ½ Brick

Purchaser requests to install small wall tiles on a backsplash or shower wall in a brick-joint pattern, that it be

LOCATIONS: Kitchen Backsplash



Homeowner(s) Initial

INTERIOR FINISHES ACKNOWLEDGEMENT / WAIVER

Purchaser accepts and acknowledges that the Builder reserves the right to substitute materials with those of equal or better quality where the manufacture, scheduling or delivery of materials may directly impact the Builder's ability to meet its' contractual obligations under the Agreement of Purchase and Sale.

UPGRADES/EXTRAS: All upgrades and additional selections indicated on the colour chart must be accompanied by an upgrades/extras sheet (PES) and full payment otherwise the selection will be invalid. All colour charts and upgrades/extras will not proceed until verified and signed by an authorized signing officer at the Vendor's head office. **CHANGES WILL NOT BE PERMITTED UPON COMPLETION AND SUBMISSION OF THE COLOUR CHART.**

PORCELAIN & NATURAL STONES: Due to the properties of natural stones including but not limited to **marble, granite, quartz**, no two pieces are exactly the same. Variations in colour, tone, granularity (pitting, fissures) and pattern are to be expected, including various lighting may affect the overall finished look. Stone tops are sealed at time of installation and should never be cleaned with lemon oil or vinegar. Stones are porous materials, therefore any spilled substance require immediate attention. Stone countertops require regular seal re-application as part of home maintenance. Purchaser acknowledges colour and product variations as well as natural imperfections may exist with the selection of natural stone materials and shall not hold the Vendor liable for provision of same.

STONE COUNTERTOP JOINTS: Purchaser is aware that one joint will be at each corner and on either side of slide-in-range (if applicable). It will also be where the length of the counter top exceeds the length of a stone slab. Slabs are usually approximately 5'x 8'.

CERAMIC TILES: Due to manufacturing, shade (dye lots), product variations may exist that can affect the overall look of the finished product. Although every effort will be made to ensure the colours and materials selected are as close as possible to the samples, the purchaser acknowledges that the sample tiles supplied in the Design Centre may not be identical to the materials installed in the home.

STAIR STAINS: Due to the natural properties of wood, many variables can affect the overall look of the finished product. Factors including but not limited to wood type, knotting, graining, density, age, humidity, and air temperature can result in substantial variations in stain intensity. The purchaser accepts that although the Vendor will do their best to match stain the unfinished stairs as close as possible to the pre-finished floors, it is not possible to have an identical match and that there MAY be shade differences between the two products.

CABINETRY: Due to the natural properties of wood, slight variations apparent with cabinetry are to be expected. This includes but not limited to wood species, wood grain, colour, finish, product variations, and natural imperfections are all factors that may affect the overall look of the finished product. Such factors make exact colour matching impossible. The type and intensity of lighting in the areas of designated cabinetry placement may also highlight characteristics of cabinetry finish. All cabinets shall be finished with a white melamine interior box unless a finished interior is upgraded. Due to building specifications and/or on-site conditions, certain cabinetry upgrades may not be possible. The purchaser acknowledges that the Builder cannot guarantee the cabinetry finish or provision of certain upgrades and shall not hold the Builder liable for provision of same.

UPGRADES/EXTRAS: All upgrades and additional selections indicated on the colour chart must be accompanied by an upgrades/extras sheet (PES) and full payment otherwise the selection will be invalid. All colour charts and upgrades/extras will not proceed until verified and signed by an authorized signing officer at the Vendor's head office. **CHANGES WILL NOT BE PERMITTED UPON COMPLETION AND SUBMISSION OF THE COLOUR CHART.**

HARDWOOD / LAMINATE FLOORING: Due to the properties of wood and laminate, many variables can affect the overall look of the finished product. Variations include but not limited to wood type or laminate finish, colour/stain and wood grain are significant factors that make exact colour matching impossible. The purchaser acknowledges that the hardwood flooring is a pre-finished product in a controlled environment. Expansion, compression and cupping are characteristics of hardwood flooring once installed in the home. The purchaser acknowledges these may become apparent over time and despite the Builders' efforts to install the hardwood flooring materials in keeping with good workmanship, the Builder shall not be responsible nor held liable for minor variances of fluctuation in hardwood flooring materials.

HARDWOOD / LAMINATE WAIVER:

I/We understand hardwood flooring is classified as a porous material and as such not recommended by the Builder in certain areas. I/We understand there is a concern due to possible water and other substances being frequently splashed or spilled onto the floor and in contravention of Ontario Building Code Section 9.30.1.2(1).

"Finished flooring bathrooms, kitchens, public entrance halls, laundry & general storage areas shall consist of resilient flooring, felted-synthetic-fibre floor coverings, concrete, terrazzo, ceramic tile, mastic or other types of flooring providing similar degrees of water resistance.

I/We are prepared to assume full responsibility for any damage caused to the hardwood floor or subfloor due to moisture absorbency in the mentioned areas, and agree to waive any claims against the Township of residence, TARIION and/or the Builder in relation to the matter. ****SEE COLOUR CHART FOR LOCATIONS****

DATE APR. 29/21

SITE BROOKLIN TOWNS

LOT 2-12

APPLIANCE ACKNOWLEDGEMENT

CONTACT: Steve Miller @ Appliance Canada (905) 660-2424 / 8701 Jane Street, Vaughan

▶ **Appliance Specs are DUE 2 WEEKS FROM SIGNED DATE OF COLOUR CHART (if not received during appointment)**

Specs that require changes/modifications after this date will not be accepted

▶ NOTE: Any upgraded appliances are to be paid by the Purchaser, directly to the appliances company.

▶ Additional charges to the Purchaser may apply for cabinetry, electrical and plumbing in order to accommodate the specs given by the homeowner.

▶ It is the Purchasers responsibility to coordinate delivery, installation and hook up of appliances and to ensure they are installed as per Manufacturers specifications after closing.

▶ Standard appliance openings are approximate and the minimum required. Sizes may vary due to onsite condition and/or when modifications have been made to the cabinetry.

STANDARD OPENINGS ACKNOWLEDGED BY PURCHASER:

INITIAL

- Fridge Opening ▶ 36" x 74" **Size is (+/-) & space above the fridge is required due to proper air flow
- Stove Opening ▶ 30"
- Hood Fan Opening ▶ 30"
- Hood Fan Vent ▶ 6"
- Dishwasher Opening ▶ 24"

UPGRADED APPLIANCES BELOW (Check applicable)

It is the Purchaser's responsibility to provide Zancor Homes with the correct specification for each appliance that has been upgraded. Zancor Homes will not be responsible for appliance requirements based on upgrades if specs have not been provided to the builder.

INITIAL

FRIDGE

- ☐ Built-In ☐ Flush Inset
- (Spec's Required) ☐ Paneled / Integrated ☐ Water Line

RANGE

- ☐ 36" ☐ Cooktop (Apron front)
- (Spec's Required) ☐ 48" *hood fan opening to be the same as the stove ☐ Cooktop (Drop-in)

Larger CFM may be required with these appliances

**Countertop Cut-out charge required for cooktop

☐ Induction

HOOD FAN &

- ☐ Under Cabinet (Standard) ☒ 6 Inch (Standard)

VENT

- ☐ Chimney (centre vent) ☐ 8 Inch
- (Spec's Required) ☐ Insert / Liner ☐ 10 Inch

WALL OVEN &

- ☐ Single Oven ☐ Warming Drawer

MICRO

- ☐ Double Oven ☐ Over the Range Microwave
- (Spec's Required) ☐ Steam Oven ☐ Built-in Microwave (*trim kit required)

DATE Apr 29/21

SITE BROOKLIN TOWNS

LOT 2-12

** Any upgrades checked in this appliance form must be accompanied with specs provided by the Purchaser.

**It is the responsibility of the trade to inform the Builder of any discrepancies with specs, sketches, extras and/or colour chart PRIOR to production/installation.

HOME AUTOMATION
(Cable, CAT5, Telephone)

LOT / SITE: BROOKLIN TOWNS -

9 2-12

DATE:

Apr 29/21

STANDARD ITEMS AS PER SCHEDULE A:

STANDARD CABLE ROUGHIN in (1) Master Bedroom, (1) Family / Great Room
STANDARD TELEPHONE ROUGHIN in (1) Master Bedroom, (1) Family / Great Room
STANDARD CAT5 ROUGHIN - (3) In location of Purchasers choice.

OPTION 1:

I/we the Homeowner(s) have chosen to contact the Home Automation Company to select the locations of the rough-ins for Cable, CAT5, Telephone as included in our Agreement of Purchase Sale.

I/we the Homeowner(s) will contact the trade within 4 weeks of the date of this release to select locations of the standard rough-ins review other optional products for purchase.

Trade:

Artistic Smart Homes

Phone:

(905) 850-9386

Rep:

Jessica

Location:

8601 Jane Street Unit #8 Vaughan ON L4K 5N9

Should the homeowner not make these selections within the sufficient time provided, the rough-ins as mentioned above will be installed in locations as indicated above.



Homeowner(s) Initial

OPTION 2:

I/we the Homeowner(s) have chosen to not contact the home automation company. I/we the Homeowner(s) have selected the locations for the standard rough-ins for Cable, CAT5, Telephone that are included in the Agreement of Purchase and Sale directly with a décor rep.

Homeowner(s) Initial

Stone Countertop Edge Profiles

Where applicable as per site specifications

LOT / SITE:

BROOKLIN TOWNS - 2-12

DATE:

Apr. 29/21

STANDARD EDGE FOR KITCHEN & VANITIES

Standard Countertop Edge
in Kitchen

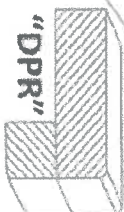

Standard Countertop Edge
in Vanity



Homeowner(s) Initial

OPTION (1) EDGE FOR KITCHEN & VANITIES \$250

Optional Edge in Kitchen

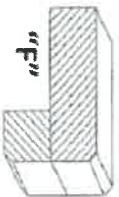
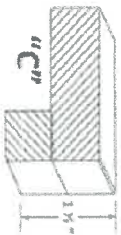

Optional Edge in Bathroom

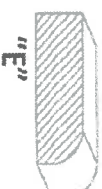
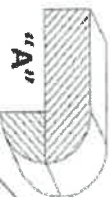
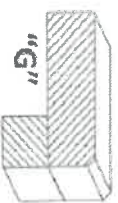

Homeowner(s) Initial

OPTION (2) EDGE FOR KITCHEN & VANITIES CUSTOM PRICING

Optional Edge for Kitchen

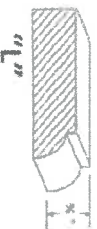

Optional Edge in Vanity

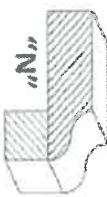
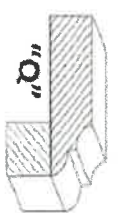
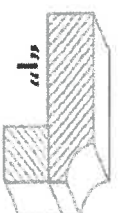
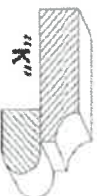
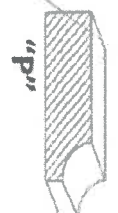

Homeowner(s) Initial