

Site: BROOKLIN

Lot: LOT 4-21

Model: INSPIRE TH-03 B

Purchaser: TAHIR LATIF GILANI

Purchaser: 0

Phone: 416.276.3912

Email: TAHIR.GILANI@GMAIL.COM



DESCRIPTION		DATE SELECTED
BONUS PACKAGE: 3 PIECE STAINLESS STEEL APPLIANCES WITH WHITE WASHER & DRYER	INCLUDED IN APS	
BONUS PACKAGE: STAINLESS STEEL HOOD FAN		
BONUS PACKAGE: AIR CONDITIONER	INCLUDED IN APS	
#1 WATERLINE TO THE FRIDGE		23-Apr-21
#2 HARDWOOD, MAIN FLOOR, REC ROOM AND UPPER HALL, ALL NON TILED AREAS ON MAIN FLOOR- UP 1		23-Apr-21
#3 STAIN FOR STAIRS		23-Apr-21
#4 PLUG FOR FUTURE TV TO BE INSTALLED 65" AFF- SEE SKETCH		23-Apr-21
#5 N/A		23-Apr-21
#6 2 CAPPED INTERIOR LIGHTS ABOVE KITCHEN ISLAND ON SAME SWITCH, SPACED EVENLY, STANDARD LIGHT TO REMAIN		23-Apr-21
#7 KITCHEN BACKSLASH- UP 2		23-Apr-21



Authorization to Allow Another Party to Select Finishes

LOT No. BLK 4 LOT 21

PLAN No. \_\_\_\_\_

HOMEOWNER(S) THAIR GILADI

CIVIC ADDRESS \_\_\_\_\_

The undersigned, being the Purchaser of the above noted property, hereby appoints and authorizes any one or combination of the undersigned Purchasers or Authorized Representatives as noted below, to be their representative and agent for the purposes of selecting the finishes, colors, and materials and ordering upgrades and extras from the selections offered by the Vendor with full authority to make all such selection or substitutions on behalf of the Absentee Purchasers. The Purchaser hereby agrees with the Vendor that any and all selections made on behalf of any Absentee Purchaser shall be binding upon the Absentee Purchaser as if such selection was personally made by the Purchaser. The Purchaser agrees that any cancellation of this authorization must be in writing to the Vendor along with the proven receipt of same by the Vendor.

Dated at BRAHPTON, this 22 day of APRIL, 2021

Purchaser [Signature] THAIR GILADI      Witness [Signature] TASHIR #14  
HESLUK AVE.

Purchaser \_\_\_\_\_      Witness \_\_\_\_\_

Authorized Representative, if applicable:

Name: KHACID GILADI

Address: 28 COASTHILLS CT. BRAHPTON ON L6Y 2Y4

License Number: \_\_\_\_\_

Phone Number: 647-294-6662

Business Number: 905-460-0223

Fax Number: \_\_\_\_\_

I agree to act as the Authorized Representative for the above mentioned Purchaser.

Signature of Authorized Representative [Signature]  
KHACID GILADI

ZANCOR HOMES COLOUR CHART

PRINTED 2021-04-23, 5:03 PM

ENTRANCES				
Main Foyer - FLOORING		ESPARTA CREMA 18 X 18	✓	
Mudroom - FLOORING		ESPARTA CREMA 18 X 18	✓	
Side Hall - FLOORING		NA		
Basement Foyer - FLOORING		NA		
KITCHEN				
Kitchen - FLOORING		NORTHERN SOLID SAWN COLLECTION BUILDER EXCLUSIVE PEARL RED OAK 3 1/4" ECLIPSE- UP 1	✓	
Breakfast - FLOORING		NORTHERN SOLID SAWN COLLECTION BUILDER EXCLUSIVE PEARL RED OAK 3 1/4" ECLIPSE- UP 1	✓	
Kitchen - CABINETS		CAMBRIDGE OAK ESPRESSO STAIN	✓	
Island - CABINETS		CAMBRIDGE OAK ESPRESSO STAIN	✓	
Servery - CABINETS		NA		
Kitchen - HANDLES/KNOBS		H800BC		
Kitchen - COUNTERTOP		GALLO ORNAMENTAL LT GRANITE	✓	
Island - COUNTERTOP		GALLO ORNAMENTAL LT GRANITE	✓	
Kitchen - BACKSPLASH		TENDER GREY BRIGHT 4 X 16 - UP 2- STACKED		
Kitchen - SINK		STD		
Kitchen - FAUCET		STD		
DINING / LIVING / DEN / OFFICE / BASEMENT				
Dining Room - FLOORING		NORTHERN SOLID SAWN COLLECTION BUILDER EXCLUSIVE PEARL RED OAK 3 1/4" ECLIPSE- UP 1		
Living Room - FLOORING	+ GARAGE ROOM	NORTHERN SOLID SAWN COLLECTION BUILDER EXCLUSIVE PEARL RED OAK 3 1/4" ECLIPSE- UP 1		
Den - FLOORING		NA		
Library - FLOORING		NA		
Office - FLOORING		NA		
Basement Rec Room - FLOORING		NA		
STAIRS				
Railing Details - PICKETS		METAL BLACK SINGLE COLLAR W ALT PLAIN	✓	
Railing Details - POSTS		2- 3/4" TURNED OAK POST	✓	
Railing Details - HANDRAIL		2 -1/2" OVAL OAK HANDRAIL	✓	
Stair Stain - MAIN STAIRS		STAIN STAIRS TO MATCH HARDWOOD AS CLOSE AS POSSIBLE	✓	
Stair Stain - BASEMENT STAIRS (if applicable)		NA		
Stair Stain - SERVICE STAIRS (if applicable)		NA		
POWDER ROOM				
GF- Powder Room - FLOORING		ESPARTA CREMA 18 X 18	✓	
Powder Room - CABINETS		NA		
SF- Powder Room - FLOORING		ESPARTA CREMA 18 X 18	✓	
Powder Room - SINK		STD		
Powder Room - FAUCET		STD		
2ND FLOOR				
Upper Hall - FLOORING		NORTHERN SOLID SAWN COLLECTION BUILDER EXCLUSIVE PEARL RED OAK 3 1/4" ECLIPSE- UP 1		
Master Bedroom - FLOORING		T15 OPENING NIGHT	✓	
Bedroom 2 - FLOORING		T15 OPENING NIGHT	✓	
Bedroom 3 - FLOORING		T15 OPENING NIGHT	✓	
Bedroom 4 - FLOORING		NA		
Bedroom 5 - FLOORING		NA		
Master Ensuite - FLOORING		ESPARTA CREMA 18 X 18	✓	
Master Ensuite - SHOWER WALL		ESPARTA CREMA 18 X 18	✓	
Master Ensuite - SHOWER FLOOR		BONE 2 X 2	✓	
Master Ensuite - SHOWER JAMB		PERLATO ROYALE	✓	
Master Ensuite - CABINETS		SHAKER V PVC TUXEDO	✓	
Master Ensuite - HANDLES/KNOBS		H800BC	✓	
Master Ensuite - COUNTERTOP		7264-58	✓	
Master Ensuite - SINK(s)	STD	Master Ensuite - FAUCET(s)		STD
***FOR TRADE USE***				
Any upgrades in the colour chart must be accompanied with a PES. It is the responsibility of all Trades to inform the builder of any discrepancies on sketches, PES and/or colour charts <u>PRIOR</u> to installation.		LOT 4-21 BROOKLIN	1<4	
***PAGE 1 OF 2***		PURCHASER INITIALS	VENDOR APPROVAL	

ZANCOR HOMES COLOUR CHART

PRINTED 2021-04-23, 5:03 PM

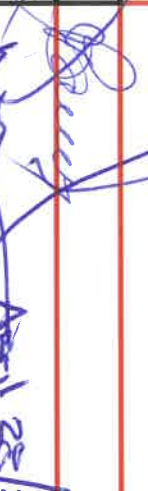
2ND FLOOR CONTINUED...									
Main Bath - FLOORING					ESPARTA CREMA 18 X 18		✓		
Main Bath - TUB / SHOWER WALL					ESPARTA CREMA 18 X 18		✓		
Main Bath - SHOWER FLOOR					NA				
Main Bath - SHOWER JAMB					NA				
Main Bath - CABINETS					SHAKER V PVC TUXEDO		✓		
Main Bath - HANDLES/KNOBS					H800BC		✓		
Main Bath - COUNTERTOP					7264-58		✓		
Main Bath - SINK(s)					STD			Main Bath - FAUCET(s)	STD
Shared Bath - FLOORING					NA				
Shared Bath- TUB / SHOWER WALL					NA				
Shared Bath- SHOWER FLOOR					NA				
Shared Bath- SHOWER JAMB					NA				
Shared Bath- CABINETS					NA				
Shared Bath- HANDLES/KNOBS					NA				
Shared Bath- COUNTERTOP					NA				
Shared Bath- SINK(s)					NA			Shared Bath - FAUCET(s)	NA
Ensuite Bath - FLOORING					NA				
Ensuite Bath - TUB / SHOWER WALL					NA				
Ensuite Bath - SHOWER FLOOR					NA				
Ensuite Bath - SHOWER JAMB					NA				
Ensuite Bath - CABINETS					NA				
Ensuite Bath - HANDLES/KNOBS					NA				
Ensuite Bath - COUNTERTOP					NA				
Ensuite Bath - SINK(s)					NA			Ensuite Bath - FAUCET(s)	NA
LAUNDRY									
Laundry - FLOORING					ESPARTA CREMA 18 X 18		✓	Laundry - HANDLES/KNOBS	NA
Laundry - CABINETS					NA			Laundry - SINK	STD
Laundry - COUNTERTOP					NA			Laundry - FAUCET	STD
Laundry - BACKSPLASH					NA				
TRIM / PAINT									
Casing/Baseboards					STD				
Interior Doors					STD				
Interior Door Hardware					STD				
PAINT - Throughout					BIRCH WHITE		✓		
FIREPLACE									
Location / Insert / Mantle					NA				
ACCESSORIES									
Mirrors					YES			BATH ACCESSORIES	YES
APPLIANCE REQUIREMENTS									
GAS LINE TO BBQ					STANDARD			ELECTRICAL for Built-in Oven	DECLINED
GAS LINE & ELECTRICAL TO STOVE					DECLINED			ELECTRICAL for Built-in Micro	DECLINED
GAS LINE & ELECTRICAL TO DRYER					DECLINED			ELECTRICAL for Cooktop	DECLINED
HOOD FAN VENT SIZE					STD			ELECTRICAL for Bar Fridge	DECLINED
WATERLINE to Fridge					YES				
DISCLAIMER									
Any changes to the colour chart after signing are subject to a \$5000 administration fee plus costs									
Purchaser has checked and acknowledged accuracy of colour and selections before signing.									
Colours of all materials are as close as possible to Builders selection but not necessarily identical due to dye lot variances in manufacturing/manufacturers. Due to construction progress some items may have been pre-selected or installed. In this event the Vendor's selection must be accepted by the purchaser									
SITE / LOT:									
LOT 4-21 BROOKLIN									
PURCHASER(S):									
TAHIR LATIF GILANI									
HOME #/CELL #									
416.276.3912									
EMAIL:									
TAHIR.GILANI@GMAIL.COM.									
***FOR TRADE USE***									
Any upgrades in the colour chart must be accompanied with a PES. It is the responsibility of all Trades to inform the builder of any discrepancies on sketches, PES and/or colour charts PRIOR to installation.									
SIGNATURES / DATE									
PURCHASER SIGNATURE									
PURCHASER SIGNATURE									
DÉCOR CONSULTANT									
Vendor APPROVAL									



4-21

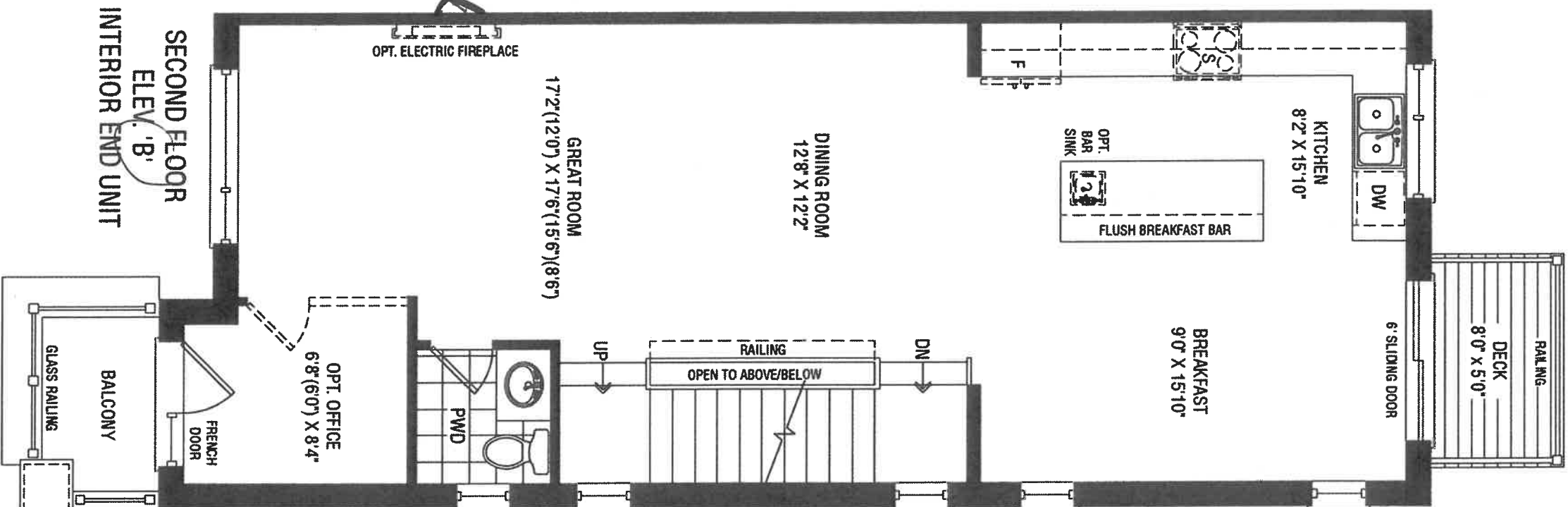

plug for  
future TV  
install 65"  
APF

K9

INSPIRE

ARR 23/21

Lot  
4-21

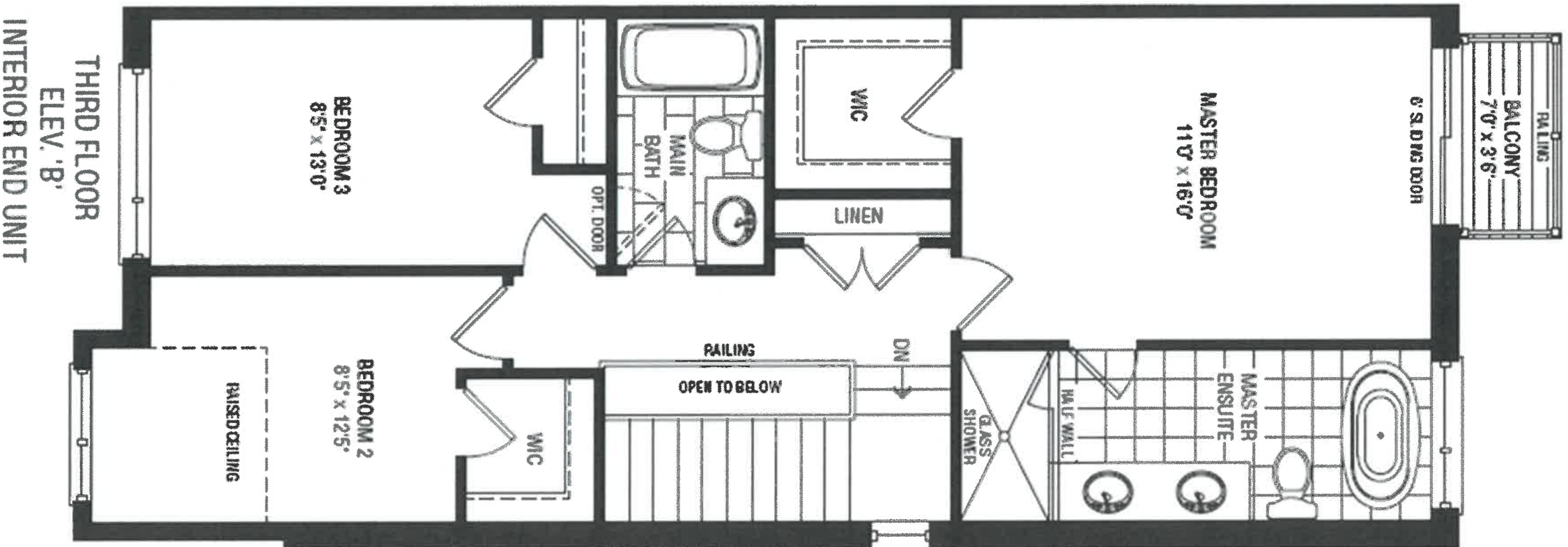

1

1/25

INSPIRE

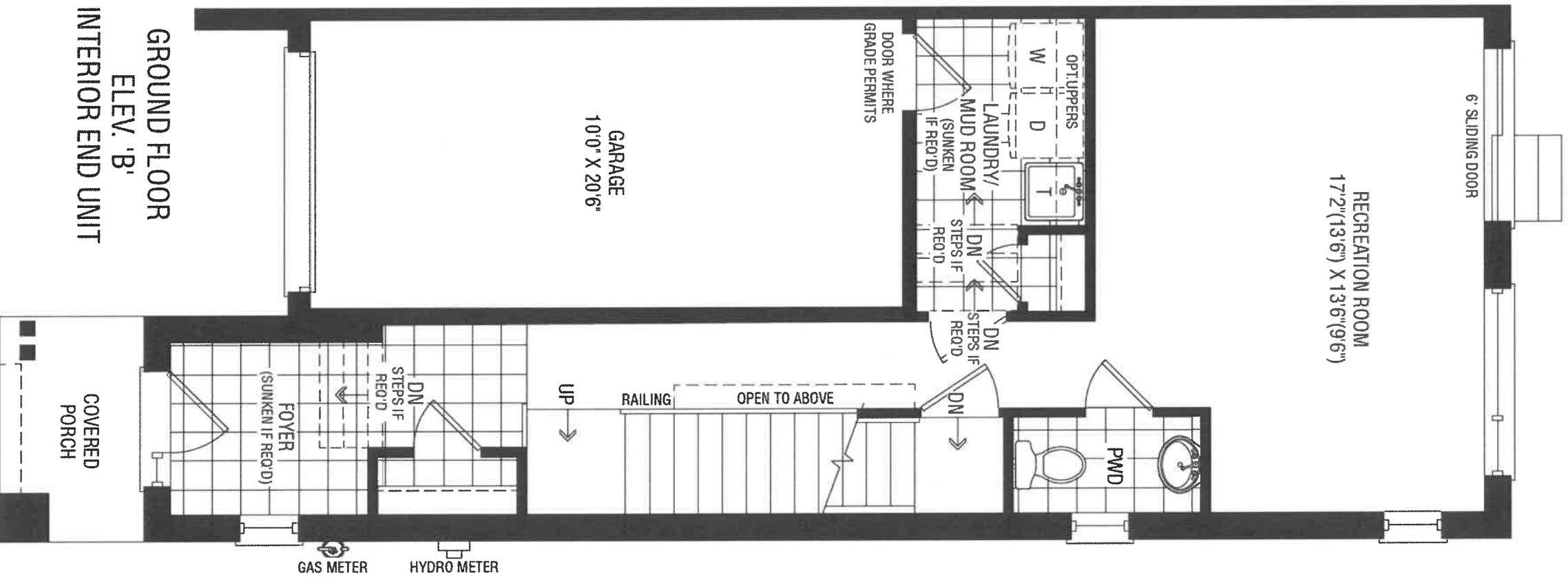

GROUND FLOOR  
ELEV. 'B'  
INTERIOR END UNIT

Lot  
4-21

K5

INSPIRE

**BASEMENT**  
**ELEV. 'B'**  
**EXTERIOR END UNIT**  
**BLOCK 4/LOT 26**

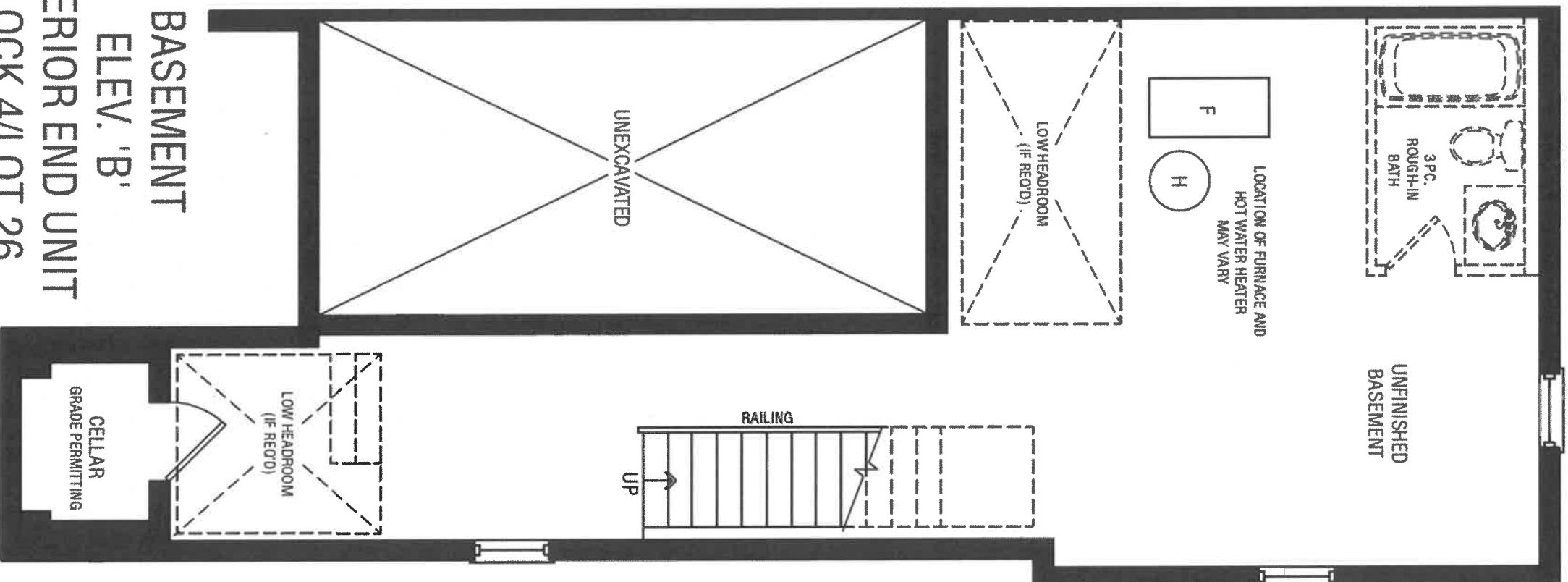

*Lot*  
*4-21*

*K9*

**INSPIRE**





DATE SUBMITTED

30 Mar 2021

CLIENT NAME: ZANCOR HOMES

SHIP TO : BROOKVALLEY TOWNS

PH:

CELL:

DRAFTED BY: FERNANDA

COMMENT

P/O #

JOB NUMBER

INSTALL DATE:

PAGE

7 of 19

TH-03  
KITCHEN ELEV. A & B  
CORNER UPGRADE

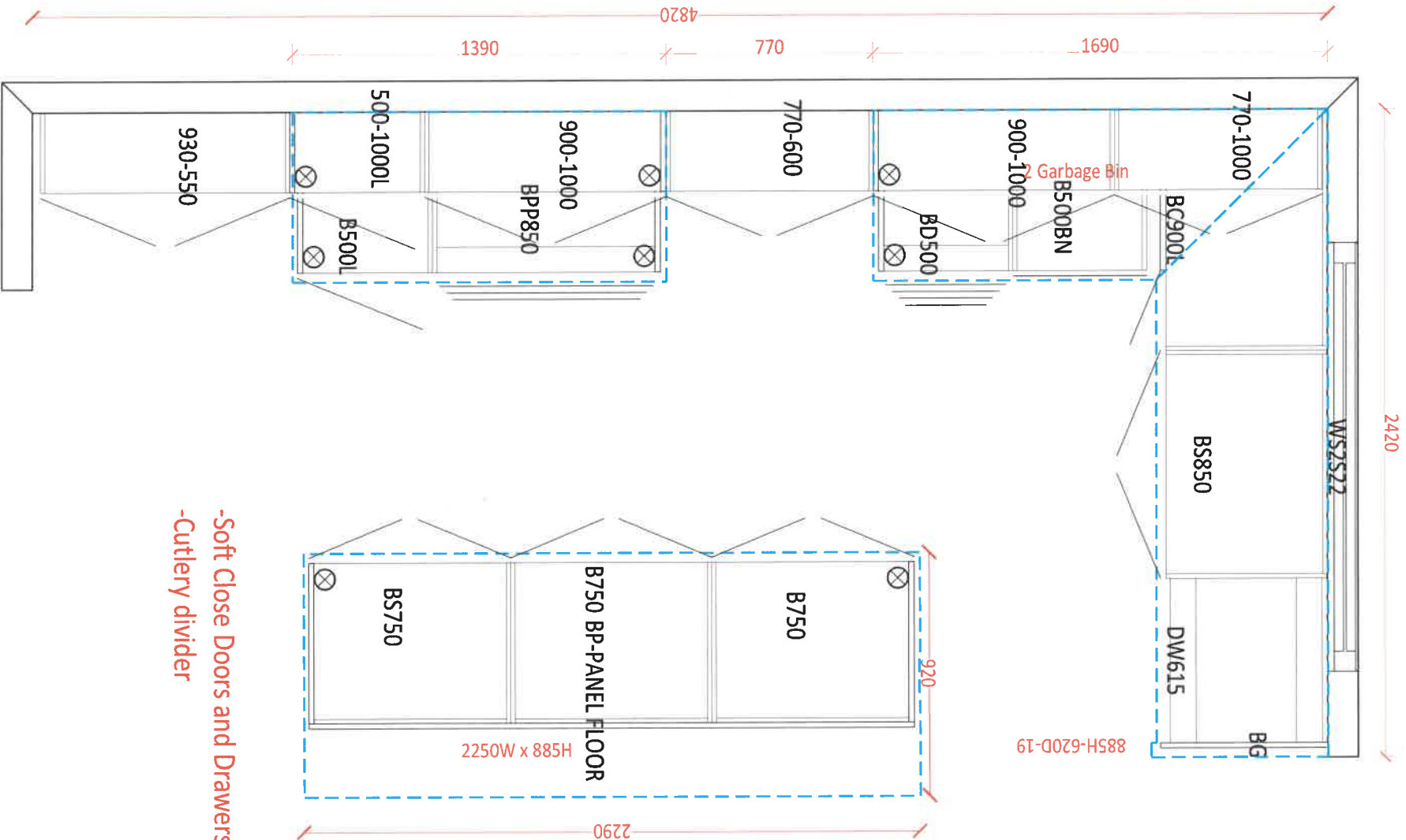

K5

CLIENT NAME: ZANCOR HOMES  
SHIP TO : BROOKVALLEY TOWNS

PH:  
CELL :

DRAFTED BY: FERNANDA  
COMMENT

P/O #

JOB NUMBER

INSTALL DATE:

PAGE

9 of 19

**TH-03**  
**STANDARD VANITIES ELEV A & B**  
**CORNER UPGRADE**

MAIN

960

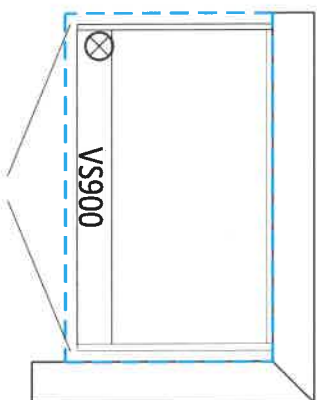

1014-21  
MR23/21

MASTER ENSUITE

1760

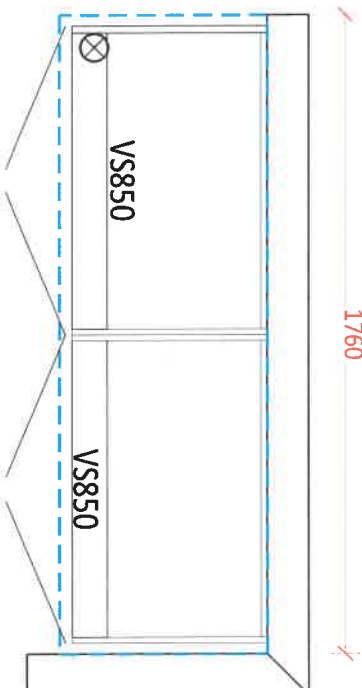

OPT. LAUNDRY UPPERS

2150

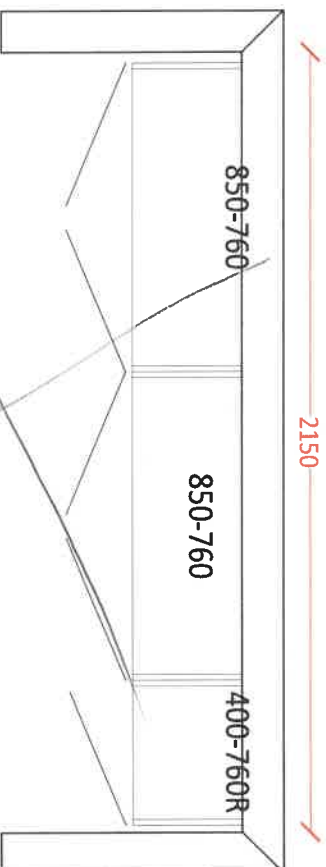

OPT. BASEMENT BATH

960

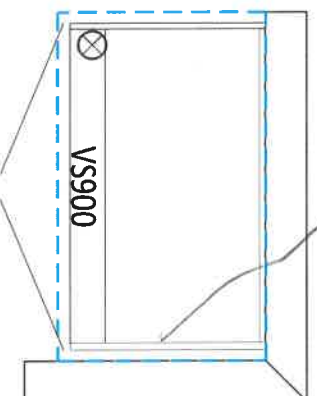

K59



DATE SUBMITTED  
30 Mar 2021

CLIENT NAME: ZANCOR HOMES  
SHIP TO : BROOKVALEY TOWNS

PH:  
CELL:

DRAFTED BY: FERNANDA

COMMENT

P/O #

JOB NUMBER

INSTALL DATE:

PAGE

8 of 19

TH-03  
KITCHEN 3D DRAWING

Lot 4-21  
MR-23/21

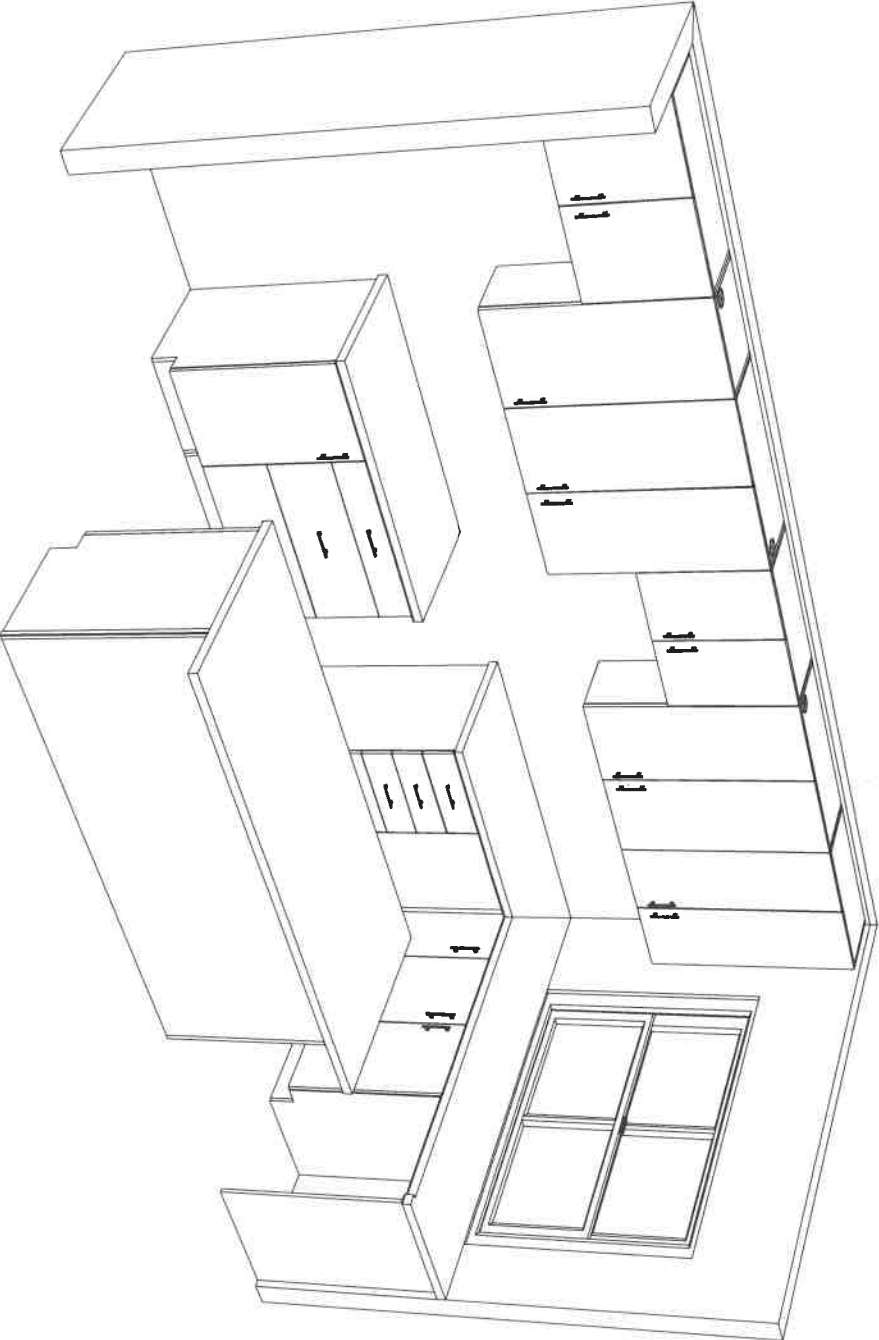

Standard  
Kitchen

109

APPLIANCE ACKNOWLEDGEMENT

CONTACT: Steve Miller @ Appliance Canada (905) 660-2424 / 8701 Jane Street, Vaughan

▶ **Appliance Specs are DUE 2 WEEKS FROM SIGNED DATE OF COLOUR CHART (if not received during appointment)**

**\*\*\*Specs that require changes/modifications after this date will not be accepted\*\*\***

▶ NOTE: Any upgraded appliances are to be paid by the Purchaser, directly to the appliances company.

▶ Additional charges to the Purchaser may apply for cabinetry, electrical and plumbing in order to accommodate the specs given by the homeowner.

▶ It is the Purchasers responsibility to coordinate delivery, installation and hook up of appliances and to ensure they are installed as per Manufacturers specifications after closing.

▶ Standard appliance openings are approximate and the minimum required. Sizes may vary due to onsite condition and/or when modifications have been made to the cabinetry.

STANDARD OPENINGS ACKNOWLEDGED BY PURCHASER:

- Fridge Opening ▶ 36" x 74" \*\*Size is (+/-) & space above the fridge is required due to proper air flow
- Stove Opening ▶ 30"
- Hood Fan Opening ▶ 30"
- Hood Fan Vent ▶ 6"
- Dishwasher Opening ▶ 24"

Initial *SM*

UPGRADED APPLIANCES BELOW (Check applicable)

**It is the Purchaser's responsibility to provide Zancor Homes with the correct specification for each appliance that has been upgraded. Zancor Homes will not be responsible for appliance requirements based on upgrades if specs have not been provided to the builder.**

Initial *SM*

FRIDGE

☐ Built-In

☐ Flush Inset

(Spec's Required) ☐ Paneled / Integrated

☒ Water Line

Initial

RANGE

☐ 36"

\*hood fan opening to be the same as the stove

☒ Cooktop (Apron front)

(Spec's Required) ☐ 48"

☐ Cooktop (Drop-in)

\*\*Larger CFM may be required with these appliances\*\*

☐ Induction

\*\*Countertop Cut-out charge required for cooktop

HOOD FAN &

☐ Under Cabinet (Standard)

☐ 6 Inch (Standard)

VENT

☐ Chimney (centre vent)

☐ 8 Inch

(Spec's Required) ☐ Insert / Liner

☐ 10 Inch

WALL OVEN &

☐ Single Oven

☐ Warming Drawer

MICRO

☐ Double Oven

☐ Over the Range Microwave

(Spec's Required) ☐ Steam Oven

☐ Built-in Microwave (\*trim kit required)

DATE *11/8/23/24*

SITE *BROOKLIN TOWNS*

LOT *4221*

\*\*Any upgrades checked in this appliance form must be accompanied with specs provided by the Purchaser.

\*\*It is the responsibility of the trade to inform the Builder of any discrepancies with specs, sketches, extras and/or colour chart PRIOR to production/installation.

221 North Rivermede Road, Concord, Ontario L4K 3N7 \* T: (905) 738.7010 F: (905) 738.5948

## HOME AUTOMATION (Cable, CAT5, Telephone)

LOT / SITE: BROOKLIN TOWNS - Lot 4-21  
DATE: APR 23/21

### STANDARD ITEMS AS PER SCHEDULE A:

STANDARD CABLE ROUGHIN in (1) Master Bedroom, (1) Family / Great Room  
STANDARD TELEPHONE ROUGHIN in (1) Master Bedroom, (1) Family / Great Room  
STANDARD CAT5 ROUGHIN - (3) In location of Purchasers choice.

### OPTION 1:

I/we the Homeowner(s) have chosen to contact the Home Automation Company to select the locations of the rough-ins for Cable, CAT5, Telephone as included in our Agreement of Purchase Sale.

I/we the Homeowner(s) will contact the trade within 4 weeks of the date of this release to select locations of the standard rough-ins review other optional products for purchase.

Trade: **Artistic Smart Homes**  
Phone: **(905) 850-9386**  
Rep: **Jessica**  
Location: **8601 Jane Street Unit #8 Vaughan ON L4K 5N9**

Should the homeowner not make these selections within the sufficient time provided, the rough-ins as mentioned above will be installed in locations as indicated above.

KS  
Homeowner(s) Initial

### OPTION 2:

I/we the Homeowner(s) have chosen to not contact the home automation company. I/we the Homeowner(s) have selected the locations for the standard rough-ins for Cable, CAT5, Telephone that are included in the Agreement of Purchase and Sale directly with a décor rep.

Homeowner(s) Initial



Stone Countertop Edge Profiles

\*\*Where applicable as per site specifications\*\*

LOT / SITE:

BROOKLIN TOWNS -

Lot 421

DATE:

APR 23/21

STANDARD EDGE FOR KITCHEN & VANITIES

Standard Countertop Edge  
in Kitchen



Standard Countertop Edge  
in Vanity

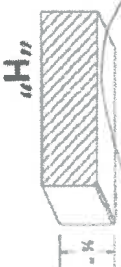

Homeowner(s) Initial

KS

OPTION (1) EDGE FOR KITCHEN & VANITIES \$250

Optional Edge in Kitchen

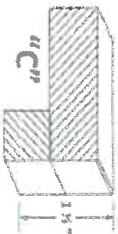

Optional Edge in Bathroom

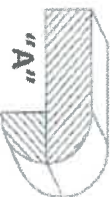

Homeowner(s) Initial

OPTION (2) EDGE FOR KITCHEN & VANITIES CUSTOM PRICING

Optional Edge for Kitchen

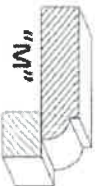
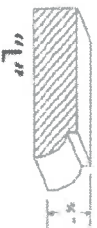

Optional Edge in Vanity

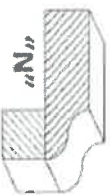
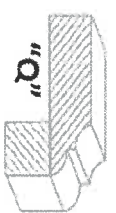
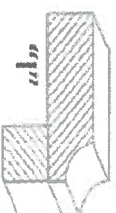
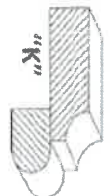
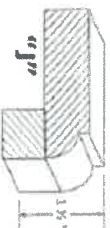
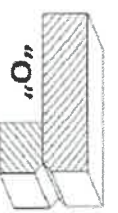
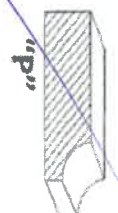

Homeowner(s) Initial



INTERIOR FINISHES ACKNOWLEDGEMENT / WAIVER

Purchaser accepts and acknowledges that the Builder reserves the right to substitute materials with those of equal or better quality where the manufacture, scheduling or delivery of materials may directly impact the Builder's ability to meet its' contractual obligations under the Agreement of Purchase and Sale.

K59

**UPGRADES/EXTRAS:** All upgrades and additional selections indicated on the colour chart must be accompanied by an upgrades/extras sheet (PES) and full payment otherwise the selection will be invalid. All colour charts and upgrades/extras will not proceed until verified and signed by an authorized signing officer at the Vendor's head office. **CHANGES WILL NOT BE PERMITTED UPON COMPLETION AND SUBMISSION OF THE COLOUR CHART.**

K59

**PORCELAIN & NATURAL STONES:** Due to the properties of natural stones including but not limited to **marble, granite, quartz**, no two pieces are exactly the same. Variations in colour, tone, granularity (pitting, fissures) and pattern are to be expected, including various lighting may affect the overall finished look. Stone tops are sealed at time of installation and should never be cleaned with lemon oil or vinegar. Stones are porous materials, therefore any spilled substance require immediate attention. Stone countertops require regular seal re-application as part of home maintenance. Purchaser acknowledges colour and product variations as well as natural imperfections may exist with the selection of natural stone materials and shall not hold the Vendor liable for provision of same.

K59

**STONE COUNTERTOP JOINTS:** Purchaser is aware that one joint will be at each corner and on either side of slide-in-range (if applicable). It will also be where the length of the counter top exceeds the length of a stone slab. Slabs are usually approximately 5'x 8'.

K59

**CERAMIC TILES:** Due to manufacturing, shade (dye lots), product variations may exist that can affect the overall look of the finished product. Although every effort will be made to ensure the colours and materials selected are as close as possible to the samples, the purchaser acknowledges that the sample tiles supplied in the Design Centre may not be identical to the materials installed in the home.

K59

**STAIR STAINS:** Due to the natural properties of wood, many variables can affect the overall look of the finished product. Factors including but not limited to wood type, knotting, graining, density, age, humidity, and air temperature can result in substantial variations in stain intensity. The purchaser accepts that although the Vendor will do their best to match stain the unfinished stairs as close as possible to the pre-finished floors, it is not possible to have an identical match and that there MAY be shade differences between the two products.

K59

**CABINETRY:** Due to the natural properties of wood, slight variations apparent with cabinetry are to be expected. This includes but not limited to wood species, wood grain, colour, finish, product variations, and natural imperfections are all factors that may affect the overall look of the finished product. Such factors make exact colour matching impossible. The type and intensity of lighting in the areas of designated cabinetry placement may also highlight characteristics of cabinetry finish. All cabinets shall be finished with a white melamine interior box unless a finished interior is upgraded. Due to building specifications and/or on-site conditions, certain cabinetry upgrades may not be possible. The purchaser acknowledges that the Builder cannot guarantee the cabinetry finish or provision of certain upgrades and shall not hold the Builder liable for provision of same.

K59

**UPGRADES/EXTRAS:** All upgrades and additional selections indicated on the colour chart must be accompanied by an upgrades/extras sheet (PES) and full payment otherwise the selection will be invalid. All colour charts and upgrades/extras will not proceed until verified and signed by an authorized signing officer at the Vendor's head office. **CHANGES WILL NOT BE PERMITTED UPON COMPLETION AND SUBMISSION OF THE COLOUR CHART.**

K59

**HARDWOOD / LAMINATE FLOORING:** Due to the properties of wood and laminate, many variables can affect the overall look of the finished product. Variations include but not limited to wood type or laminate finish, colour/stain and wood grain are significant factors that make exact colour matching impossible. The purchaser acknowledges that the hardwood flooring is a pre-finished product in a controlled environment. Expansion, compression and cupping are characteristics of hardwood flooring once installed in the home. The purchaser acknowledges these may become apparent over time and despite the Builders' efforts to install the hardwood flooring materials in keeping with good workmanship, the Builder shall not be responsible nor held liable for minor variances of fluctuation in hardwood flooring materials.

K59

HARDWOOD / LAMINATE WAIVER:

I/We understand hardwood flooring is classified as a porous material and as such not recommended by the Builder in certain areas. I/We understand there is a concern due to possible water and other substances being frequently splashed or spilled onto the floor and in contravention of Ontario Building Code Section 9.30.1.2(1).

*"Finished flooring bathrooms, kitchens, public entrance halls, laundry & general storage areas shall consist of resilient flooring, felted-synthetic-fibre floor coverings, concrete, terrazzo, ceramic tile, mastic or other types of flooring providing similar degrees of water resistance.*

I/We are prepared to assume full responsibility for any damage caused to the hardwood floor or subfloor due to moisture absorbency in the mentioned areas, and agree to waive any claims against the Township of residence, TARIION and/or the Builder in relation to the matter. **\*\*SEE COLOUR CHART FOR LOCATIONS\*\***

K59

DATE 10/8/23/21

BROOKLIN TOWNS  
SITE

LOT

421