

Site:

INNIFIL

Lot:

41W

Model:

MASTHEAD 42-06 (A)

Purchaser:

KRISTIAN ALEXANDER CARO &
ALINA FRANCES SOUSA

Phone/Email:

647-833-1122



DESCRIPTION		DATE SELECTED
BONUS PACKAGE: 3 PIECE STAINLESS STEEL APPLIANCES WITH WHITE TOP LOAD WASHER & DRYER		INCLUDED IN APS
BONUS PACKAGE: STAINLESS STEEL HOOD FAN		INCLUDED IN APS
	STRUCTURALS	
#1 SMOOTH CEILINGS ON MAIN FLOOR ONLY **INCLUDES GREAT ROOM CEILING		JAN 31 2020
#2 INTERIOR DOORS - INCREASE TO 8 FEET HIGH (X5)		JAN 31 2020
#3 KIDS PLAYROOM - INCREASE WIDTH OF END WALLS IN ORDER TO INSTALL 30 INCH DOORS (X2) AFTER CLOSING		JAN 31 2020
FINISHED OPENING TO BE LARGE ENOUGH TO ACCOMMODATE DOUBLE DOORS 30" WIDE X2		JAN 31 2020
#4 CLARIFICATION - FURNACE LOCATION AS PER BROCHURE TO BE CONFIRMED		JAN 31 2020
	COLOURS	
#1 KITCHEN - ADD (2) SETS OF 36 INCH POT DRAWERS **ON EITHER SIDE OF THE STOVE ***MOVE THE STANDARD BANK TO THE ISLAND		MAY 14 2021
#2 KITCHEN **NOTE DISTANCE BETWEEN ISLAND AND STOVE WALL ON PLAN **MIN 42 INCHES		MAY 14 2021
#3 N/A		MAY 14 2021
#4 N/A		MAY 14 2021
#5 KITCHEN - FRIDGE ENCLOSURE *WITH GABLES		MAY 14 2021
#6 KITCHEN - DELETE UPPERS ABOVE STOVE **DO NOT RUN PANEL ACROSS** *CENTRE VENT		MAY 14 2021
#7 CLARIFICATION KITCHEN - ENSURE STANDARD BULKHEAD IS IN THE KITCHEN ABOVE THE CABINETS		MAY 14 2021
#8 KITCHEN CABINETS - UPGRADE 1		MAY 14 2021
#9 KITCHEN ISLAND - DIFFERENT COLOUR **TWO TONE		MAY 14 2021
#10 KITCHEN COUNTERTOP - UPGRADE 5 **BROGHINI GOLD		MAY 14 2021
#11 TILES - FOYER UPGRADE 6		MAY 14 2021
#12 TILES - KITCHEN BREAKFAST UPGRADE 6		MAY 14 2021
#13 TILES - POWDER ROOM UPGRAE 6		MAY 14 2021
#14 HARDWOOD - UPGRADE 4 ON MAIN FLOOR STANDARD NON-TILED AREAS		MAY 14 2021
#15 STAIN STAIRS TO MATCH HARDWOOD AS CLOSE AS POSSIBLE **IF THERE IS ANY LEFT OVER, PLEASE LEAVE IN HOUSE IF POSSIBLE		MAY 14 2021
#16 TILES - LAUNDRY ROOM - UPGRADE 1		MAY 14 2021
#17 DELETE DOORS AT MASTER BEDROOM CLOSET		MAY 14 2021
#18 MASTER ENSUITE CABINETS - UPGRADE 1		MAY 14 2021
#19 MASTER ENSUITE TILES - FLOOR UPGRADE 6		MAY 14 2021
#20 MASTER ENSUITE TILES - FLOOR TILES ON SHOWER WALL UPGRADE 5		MAY 14 2021
#21 MASTER ENSUITE SHOWER FLOOR - MARBLE		MAY 14 2021
#22 FRAMELESS GLASS SHOWER IN MASTER ENSUITE		MAY 14 2021
#23 MASTER ENSUITE & TWIN BATH - BANK OF DRAWERS BETWEEN SINKS		MAY 14 2021
#24 TWIN BATH FLOOR TILES - UPGRADE 1		MAY 14 2021
#25 ENSUITE 2 BATH FLOOR TILES - UPGRADE 1		MAY 14 2021
#26 RAILINGS - UPGRADE 1		MAY 14 2021
#27 WATERLINE TO FRIDGE		MAY 14 2021
#28 CLARIFICATION ON NOSINGS - 3/4 INCH IS STANDARD		MAY 14 2021
#29 N/A		MAY 14 2021
#30 INTERIOR DOORS - LOGAN STYLE		MAY 14 2021
#31 N/A		MAY 14 2021
#32 ALL CABINET DRAWERS IN KITCHEN AND BATHROOMS - DO NOT DRILL		MAY 14 2021
#33 ELECTRICAL - ADD (2) EXTERIOR POTLIGHTS AT FRONT OF HOUSE ON SEPRATE SWITCH AND (1) EXTERIOR POTLIGHT AT BACK OF HOUSE ON SAME SWITCH AS LIGHT BY SLIDING DOOR		MAY 14 2021
#34 **CONFIRM DEPTH OF WALL BESIDE WINDOW TO ENSURE THAT THE DEPTH OF WALL OVENS WORK		MAY 14 2021
#35 ELECTRICAL - ADD (4) POTLIGHTS IN THE KITCHEN ON SEP SWITCH **SEE LOCATION OF STANDARD LIGHT ***EXTERIOR POTLIGHTS AS PER MASTHEAD MODEL HOME		MAY 14 2021
#36 ELECTRICAL - ADD CAPPED LIGHT ON EXISTING SWITCH IN DEN		MAY 14 2021

ZANCOR HOMES COLOUR CHART

PRINTED 2021-05-18, 4:39 PM

ENTRANCES				
Main Foyer - FLOORING		ROMA STATUARIO 24 X 24 (6)		
Mudroom - FLOORING		MADISON WHITE MATTE 18 X 18 (1) **MAY 18 2021		
Side Hall - FLOORING		N/A		
Basement Foyer - FLOORING		N/A		
KITCHEN				
Kitchen - FLOORING		ROMA STATUARIO 24 X 24 (6)		
Breakfast - FLOORING		ROMA STATUARIO 24 X 24 (6)		
Kitchen - CABINETS		SIERRA MDF - VANILLA MILKSHAKE (1) **MAY 18 2021		
Island - CABINETS		SIERRA MDF - FOG GREY (1)		
Servery - CABINETS		N/A		
Kitchen - HANDLES/KNOB*****		**ON DOORS ONLY K200BC** / DO NOT INSTALL ANY HARDWARE ON DRAWERS		
Kitchen - COUNTERTOP		EMERSTONE BIRGHINI GOLD (5) **MAY 18 2021		
Island - COUNTERTOP		EMERSTONE BIRGHINI GOLD (5) **MAY 18 2021		
Kitchen - BACKSPLASH		DECLINED		
Kitchen - SINK		STANDARD		
Kitchen - FAUCET		STANDARD		
GREAT ROOM / DINING / LIVING / DEN / OFFICE / BASEMENT				
Dining Room - FLOORING		VINTAGE WHITE OAK 5 INCH NAUTILUS SCUPLTED UVF (4) **MAY 18 2021		
Main Hall - FLOORING		VINTAGE WHITE OAK 5 INCH NAUTILUS SCUPLTED UVF (4) **MAY 18 2021		
Great Room - FLOORING		VINTAGE WHITE OAK 5 INCH NAUTILUS SCUPLTED UVF (4) **MAY 18 2021		
Library / KIDS PLAYROOM - FLOORING		VINTAGE WHITE OAK 5 INCH NAUTILUS SCUPLTED UVF (4) **MAY 18 2021		
Basement Rec Room - FLOORING		N/A		
STAIRS				
Railing Details - PICKETS		UPGRADE 1-5/16" SQUARE OAK		
Railing Details - POSTS		UPGRADE SQUARE OAK POST TO MATCH		
Railing Details - HANDRAIL		UPGRADE SQUARE OAK HANDRAIL TO MATCH		
Stair Stain - MAIN STAIRS		STAIN STAIRS TO MATCH HARDWOOD AS CLOSE AS POSSIBLE		
Stair Stain - BASEMENT STAIRS (if applicable)		N/A		
Stair Stain - SERVICE STAIRS (if applicable)		N/A		
POWDER ROOM				
Powder Room - FLOORING		ROMA STATUARIO 24 X 24 (6)		
Powder Room - CABINETS		N/A		
Powder Room - COUNTERTOP		N/A		
Powder Room - SINK		PEDESTAL		
Powder Room - FAUCET		STANDARD		
2ND FLOOR				
Upper Hall - FLOORING		CARPET - OPENING NIGHT COLOUR T03 w/STANDARD UNDERPAD		
Master Bedroom - FLOORING		CARPET - OPENING NIGHT COLOUR T03 w/STANDARD UNDERPAD		
Bedroom 2 - FLOORING		CARPET - OPENING NIGHT COLOUR T03 w/STANDARD UNDERPAD		
Bedroom 3 - FLOORING		CARPET - OPENING NIGHT COLOUR T03 w/STANDARD UNDERPAD		
Bedroom 4 - FLOORING		CARPET - OPENING NIGHT COLOUR T03 w/STANDARD UNDERPAD		
Bedroom 5 - FLOORING		N/A		
Master Ensuite - FLOORING		ETERNA VOLKAS CALCATTA GREY POLISHED 24 X 24 (6)		
Master Ensuite - SHOWER WALL		ETERNA VOLKAS CALCATTA GREY POLISHED 12 X 24 (5) **STACKED HORIZONTAL		
Master Ensuite - SHOWER FLOOR		MARBLE - ICEBURG 2 X 2		
Master Ensuite - SHOWER JAMB		BIANCO CARRARA		
Master Ensuite - CABINETS		SIERRA MDF - FOG GREY (1)		
Master Ensuite - HANDLES/KNOB		**ON DOORS ONLY K200BC** / DO NOT INSTALL ANY HARDWARE ON DRAWERS		
Master Ensuite - COUNTERTOP		LAMINATE - 1573-60		
Master Ensuite - SINK(S)		STANDARD	Master Ensuite - FAUCET(s)	STANDARD
FOR TRADE USE				
Any upgrades in the colour chart must be accompanied with a PES. It is the responsibility of all Trades to inform the builder of any discrepancies on sketches, PES and/or colour charts <u>PRIOR</u> to installation.		INNISFIL 41W	YLV	Vendor APPROVAL
PAGE 1 OF 2		PURCHASER INITIALS		

ZANCOR HOMES COLOUR CHART

PRINTED 2021-05-14, 6:45 PM

ENTRANCES				
Main Foyer - FLOORING		ROMA STATUARIO 24 X 24 (6)		
Mudroom - FLOORING		MADISON ANTHRACITE MATTE 18 X 18 (1)		
Side Hall - FLOORING		N/A		
Basement Foyer - FLOORING		N/A		
KITCHEN				
Kitchen - FLOORING		ROMA STATUARIO 24 X 24 (6)		
Breakfast - FLOORING		ROMA STATUARIO 24 X 24 (6)		
Kitchen - CABINETS		SIERRA MDF - GLACIER WHITE (1)		
Island - CABINETS		SIERRA MDF - FOG GREY (1)		
Servery - CABINETS		N/A		
Kitchen - HANDLES/KNOBS*****		**ON DOORS ONLY K200BC** / DO NOT INSTALL ANY HARDWARE ON DRAWERS		
Kitchen - COUNTERTOP		EMERSTONE STATUARIO POLISHED (3)		
Island - COUNTERTOP		EMERSTONE STATUARIO POLISHED (3)		
Kitchen - BACKSPLASH		DECLINED		
Kitchen - SINK		STANDARD		
Kitchen - FAUCET		STANDARD		
GREAT ROOM / DINING / LIVING / DEN / OFFICE / BASEMENT				
Dining Room - FLOORING		VINTAGE WHITE OAK 5 INCH NAUTILUS (PEARL) (2)		
Main Hall - FLOORING		VINTAGE WHITE OAK 5 INCH NAUTILUS (PEARL) (2)		
Great Room - FLOORING		VINTAGE WHITE OAK 5 INCH NAUTILUS (PEARL) (2)		
Library / KIDS PLAYROOM - FLOORING		VINTAGE WHITE OAK 5 INCH NAUTILUS (PEARL) (2)		
Basement Rec Room - FLOORING		N/A		
STAIRS				
Railing Details - PICKETS		UPGRADE 1-5/16" SQUARE OAK		
Railing Details - POSTS		UPGRADE SQUARE OAK POST TO MATCH		
Railing Details - HANDRAIL		UPGRADE SQUARE OAK HANDRAIL TO MATCH		
Stair Stain - MAIN STAIRS		STAIN STAIRS TO MATCH HARDWOOD AS CLOSE AS POSSIBLE		
Stair Stain - BASEMENT STAIRS (if applicable)		N/A		
Stair Stain - SERVICE STAIRS (if applicable)		N/A		
POWDER ROOM				
Powder Room - FLOORING		ROMA STATUARIO 24 X 24 (6)		
Powder Room - CABINETS		N/A		
Powder Room - COUNTERTOP		N/A		
Powder Room - SINK		PEDESTAL		
Powder Room - FAUCET		STANDARD		
2ND FLOOR				
Upper Hall - FLOORING		CARPET - OPENING NIGHT COLOUR T03 w/STANDARD UNDERPAD		
Master Bedroom - FLOORING		CARPET - OPENING NIGHT COLOUR T03 w/STANDARD UNDERPAD		
Bedroom 2 - FLOORING		CARPET - OPENING NIGHT COLOUR T03 w/STANDARD UNDERPAD		
Bedroom 3 - FLOORING		CARPET - OPENING NIGHT COLOUR T03 w/STANDARD UNDERPAD		
Bedroom 4 - FLOORING		CARPET - OPENING NIGHT COLOUR T03 w/STANDARD UNDERPAD		
Bedroom 5 - FLOORING		N/A		
Master Ensuite - FLOORING		ETERNA VOLKAS CALCATTA GREY 24 X 24 (6)		
Master Ensuite - SHOWER WALL		ETERNA VOLKAS CALCATTA GREY 12 X 24 (5) **STACKED HORIZONTAL		
Master Ensuite - SHOWER FLOOR		MARBLE - ICEBURG 2 X 2		
Master Ensuite - SHOWER JAMB		BIANCO CARRARA		
Master Ensuite - CABINETS		SIERRA MDF - FOG GREY (1)		
Master Ensuite - HANDLES/KNOBS		**ON DOORS ONLY K200BC** / DO NOT INSTALL ANY HARDWARE ON DRAWERS		
Master Ensuite - COUNTERTOP		LAMINATE - 1573-60		
Master Ensuite - SINK(s)	STANDARD	Master Ensuite - FAUCET(s)	STANDARD	
FOR TRADE USE				
Any upgrades in the colour chart must be accompanied with a PES. It is the responsibility of all Trades to inform the builder of any discrepancies on sketches, PES and/or colour charts <u>PRIOR</u> to installation.		INNISFIL 41W	P.C. AS	
		PAGE 1 OF 2	PURCHASER INITIALS	VENDOR APPROVAL

2ND FLOOR CONTINUED...									
Ensuite 2 Bath - FLOORING		MADISON WHITE MATTE 18 X 18 (1)							
Ensuite 2 Bath - TUB / SHOWER WALL		SPLENDOUR WHITE 8 X 10							
Ensuite 2 Bath - SHOWER FLOOR		N/A							
Ensuite 2 Bath - SHOWER JAMB		N/A							
Ensuite 2 Bath - CABINETS		FLAT SLAB MDF - CONCRETE GREY							
Ensuite 2 Bath - HANDLES/KNOBS		**ON DOORS ONLY K200BC** / DO NOT INSTALL ANY HARDWARE ON DRAWERS							
Ensuite 2 Bath - COUNTERTOP		LAMINATE - 1886K-07							
Ensuite 2 Bath - SINK(s)		STANDARD		ENSUITE 2 Bath - FAUCET(s)		STANDARD			
Shared Bath- FLOORING		MADISON WHITE MATTE 18 X 18 (1)							
Shared Bath- TUB / SHOWER WALL		SPLENDOUR WHITE 8 X 10							
Shared Bath- SHOWER FLOOR		N/A							
Shared Bath- SHOWER JAMB		N/A							
Shared Bath- CABINETS		SIERRA PVC -WHITE							
Shared Bath- HANDLES/KNOBS		**ON DOORS ONLY K200BC** / DO NOT INSTALL ANY HARDWARE ON DRAWERS							
Shared Bath- COUNTERTOP		LAMINATE - 1886K-07							
Shared Bath- SINK(s)		STANDARD		Shared Bath - FAUCET(s)		STANDARD			
Ensuite Bath - FLOORING		N/A							
Ensuite Bath - TUB / SHOWER WALL		N/A							
Ensuite Bath - SHOWER FLOOR		N/A							
Ensuite Bath - SHOWER JAMB		N/A							
Ensuite Bath - CABINETS		N/A							
Ensuite Bath - HANDLES/KNOBS		N/A							
Ensuite Bath - COUNTERTOP		N/A							
Ensuite Bath - SINK(s)				Ensuite Bath - FAUCET(s)					
LAUNDRY									
Laundry - FLOORING		MADISON ANTHRACITE MATTE 18 X 18 (1)		Laundry - HANDLES/KNOBS		N/A			
Laundry - CABINETS		N/A		Laundry - SINK		N/A			
Laundry - COUNTERTOP		N/A		Laundry - FAUCET		N/A			
Laundry - BACKSPLASH		N/A							
TRIM / PAINT									
Casing/Baseboards		STANDARD							
Interior Doors		LOGAN ON MAIN FLOOR (5 DOORS) / STANDARD ON 2ND FLOOR							
Interior Door Hardware		STANDARD							
PAINT - Throughout		WARM GREY							
FIREPLACE									
Location / Insert / Mantle		N/A							
ACCESSORIES									
Mirrors		YES		BATH ACCESSORIES		DELETE			
APPLIANCE REQUIREMENTS									
GAS LINE TO BBQ		DECLINED		ELECTRICAL for Built-in Oven		DECLINED			
GAS LINE & ELECTRICAL TO STOVE		DECLINED		ELECTRICAL for Built-in Micro		DECLINED			
GAS LINE & ELECTRICAL TO DRYER		N/A		ELECTRICAL for Cooktop		DECLINED			
HOOD FAN VENT SIZE		6 INCH		ELECTRICAL for Bar Fridge		N/A			
WATERLINE to Fridge		YES							
DISCLAIMER									
Any changes to the colour chart after signing are subject to a \$5000 administration fee plus costs									
Purchaser has checked and acknowledged accuracy of colour and selections before signing.									
Colours of all materials are as close as possible to Builders selection but not necessarily identical due to dye lot variances in manufacturing/manufacturers. Due to construction progress some items may have been pre-selected or installed. In this event the Vendor's selection must be accepted by the purchaser									
SITE / LOT:		INNISFIL		LOT		41W			
PURCHASER(S):		KRISTIAN ALEXANDER CARO							
PURCHASER(S):		ALINA FRANCES SOUSA							
CONTACT:		647-833-1122		KRISTIAN.CARO01@GMAIL.COM					
FOR TRADE USE									
Any upgrades in the colour chart must be accompanied with a PES. It is the responsibility of all Trades to inform the builder of any discrepancies on sketches, PES and/or colour charts PRIOR to installation.				PURCHASER SIGNATURE		KRISTIAN CARO		DATE	
				PURCHASER SIGNATURE		ALINA SOUSA		DATE	
				DÉCOR CONSULTANT					
				Vendor APPROVAL		KRISTIAN CARO		DATE	

e Masthead

4W.

A 3049 sq.ft. – Optional 5 Bedroom Floor Plan 3300 sq.ft.

B 3097 sq.ft. – Optional 5 Bedroom Floor Plan 3348 sq.ft.

KE AS



n A - 3049 sq.ft.

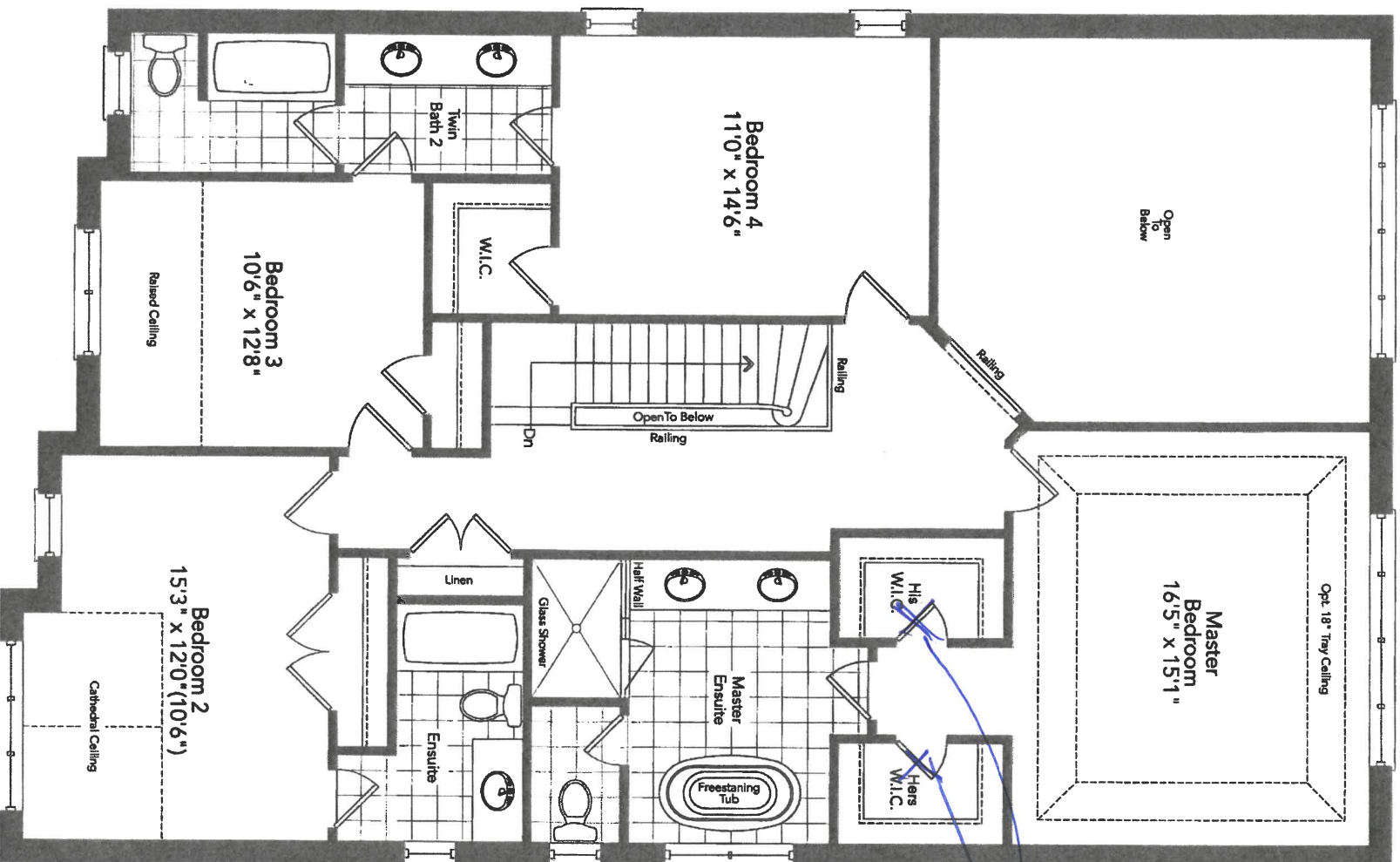

Second Floor
Elevation A

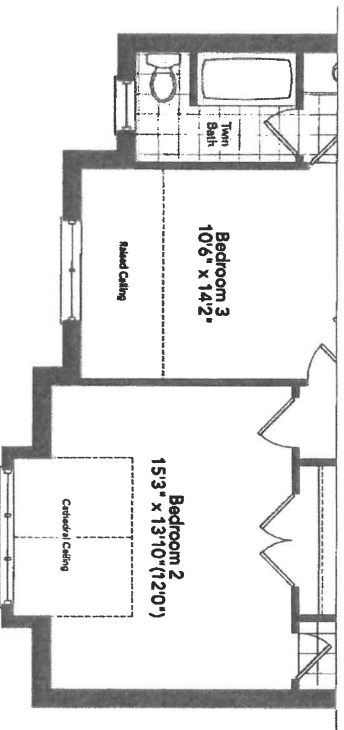

Partial Second Floor
Elevation B

*where
closet
doors
STD trim
to remain*

*V.C.
A.S.*

41W

*K.C.
A.S.*

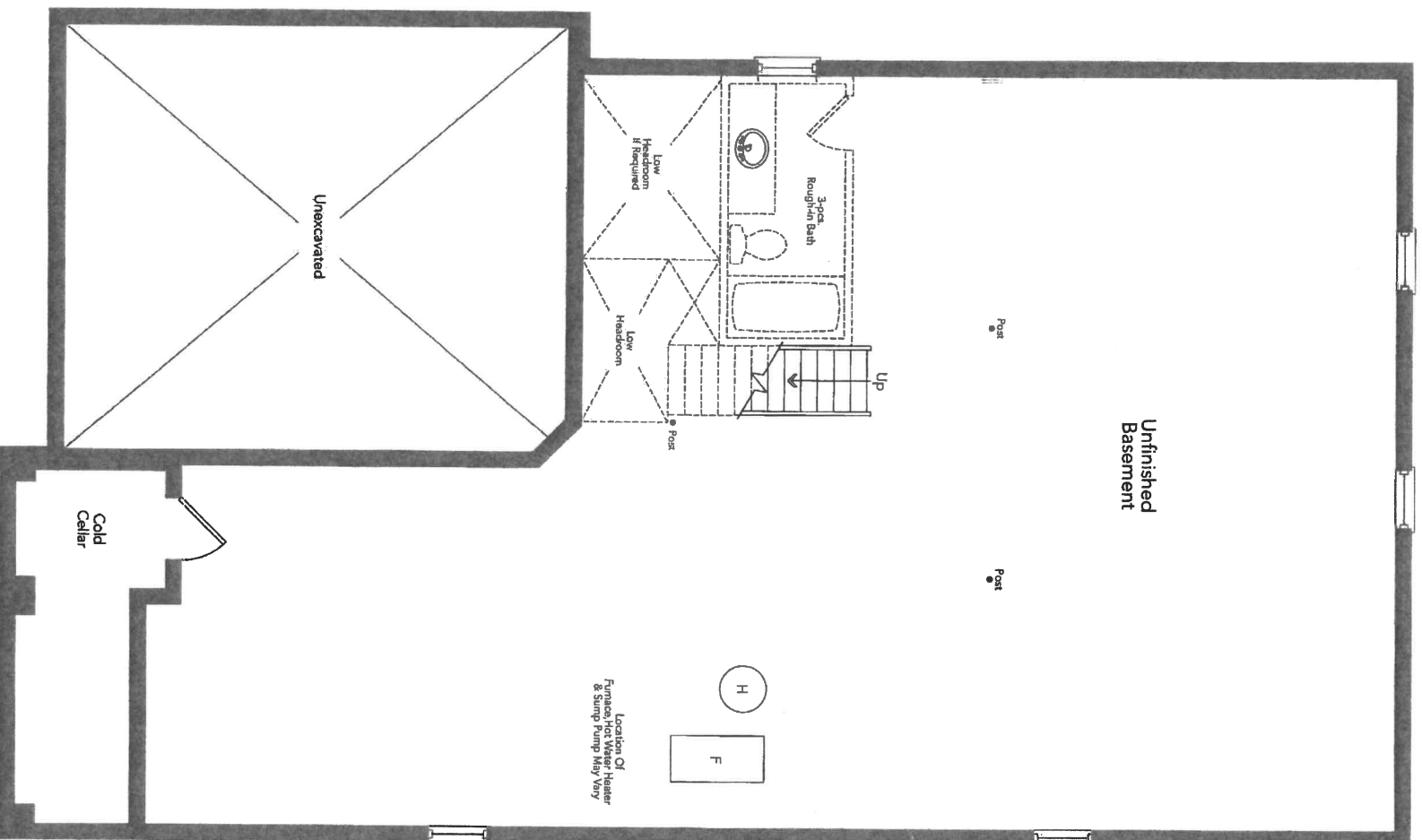

Basement
Elevation A

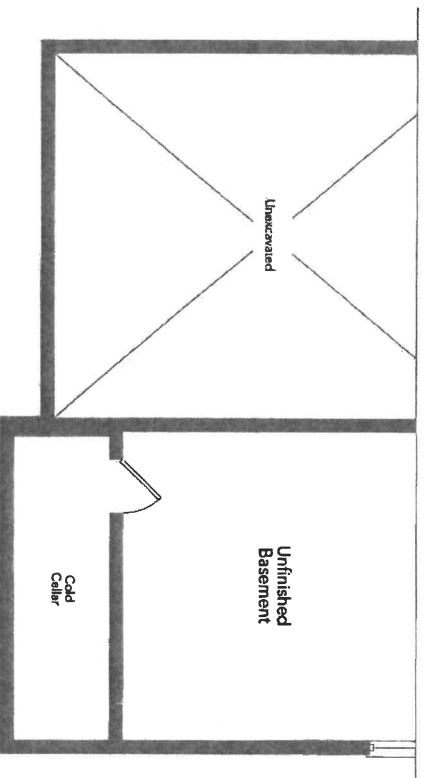

Partial Basement
Elevation B

MASTHEAD 42-06

4(W)
K.C.
A.S.

- ① for PLACES 36"
- ② STD BUNK LOCATION
- ③ FALSE ENCLOSURE
- ④ Delete upper for Chimney (no panel)
- ⑤ TWO TONE

New Image Kitchens Inc.
 Scale: _____ Approved by: _____
 Date: 10/10/15 Reviset: _____

BELLE AIR SHORES, INNISFIL Drawing number: _____

MODEL: 42-06

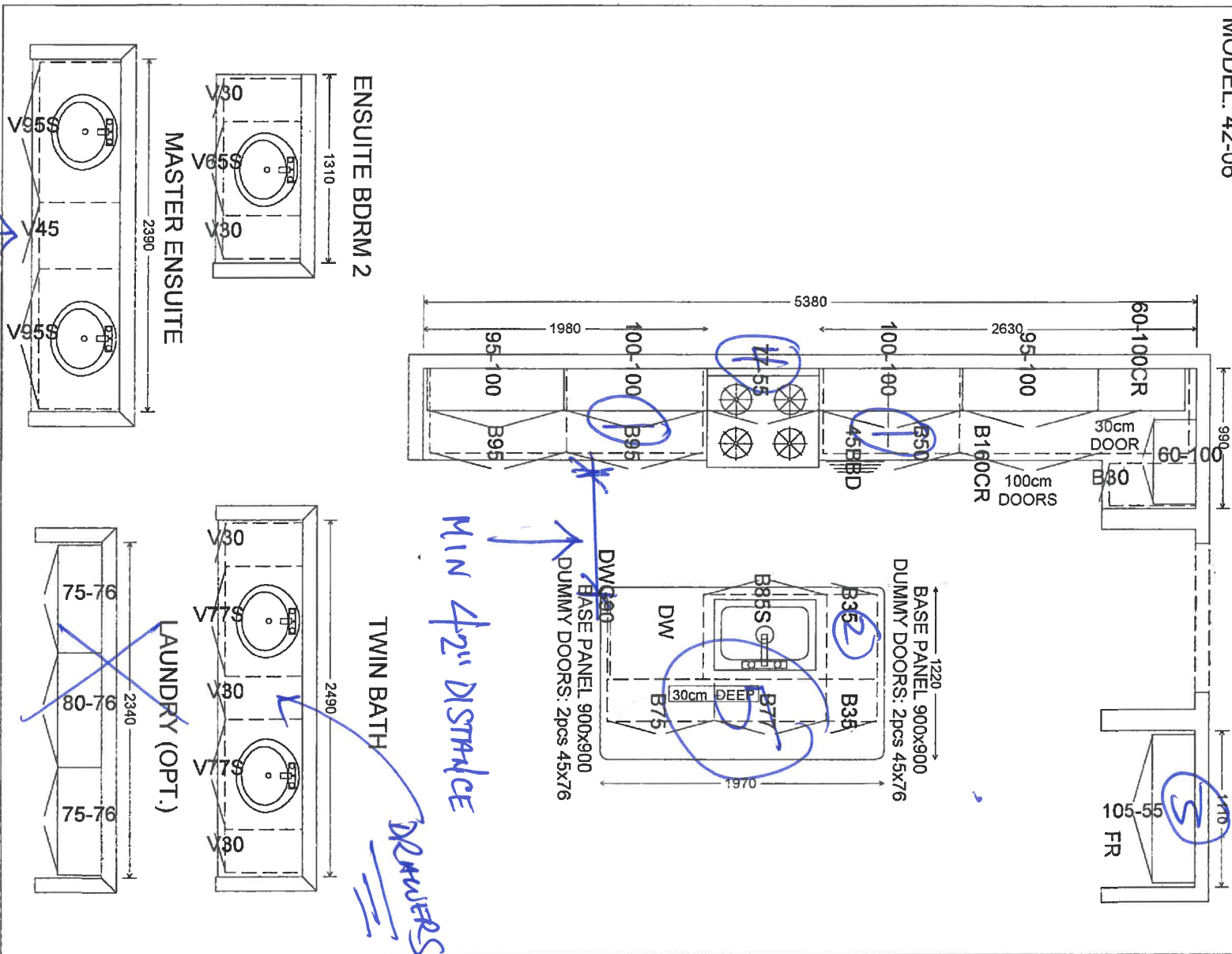

K.C.
A.S

DOORS

DOORS

4110 Innisfil

CONTACT: WAYNE AT CONST APPLIANCES 905-303-6909

It is the Purchaser's responsibility to coordinate delivery, installation and hook up of appliances and to ensure they are installed as per Manufacturers specifications after closing.

STANDARD APPLIANCE OPENINGS provided by Zancor:

- Standard appliance openings are approximate and the minimum required. Sizes may vary due to onsite condition and/or when modifications have been made to the cabinetry.
- ▶ Fridge Opening 36" x 74"
- ▶ Stove Opening 30"
- ▶ Hood Fan Opening 30"
- ▶ Hood Fan & Vent 6" with Under Cabinet Hood
- ▶ Dishwasher Opening 24"

Accepts Standard
Openings **Initial

WCS
K.S.

OPTIONAL UPGRADED APPLIANCES to be provided by Homeowner:

- **Specs/Information sheets are required and it is the responsibility of the homeowner to provide this to Zancor Homes by the due date that has been provided. If appliance specs are not submitted, Zancor Homes will not be responsible for any necessary requirements and the standard opening will be built.

INITIAL
WCS
K.S.

- Upgraded Appliance Specs are DUE 2 WEEKS FROM SIGNED DATE OF COLOUR CHART (if not received during appointment)

- **Specs that require changes/modifications after this date will not be accepted***

- NOTE: Any upgraded appliances are to be paid by the Purchaser, directly to the appliances company.

- Additional charges to the Purchaser may apply for cabinetry, electrical and plumbing in order to accommodate the specs given by the homeowner.

FRIDGE UPGRADE

- ☐ Built-in
- ☐ Paneled **Panel to match required
- ☐ Integrated / Flush Inset
- ☒ Waterline

RANGE UPGRADE

*Larger hood fan CFM might be required, which need a larger vent

- ☐ 36" **Hood fan opening must be the same size or larger (8" vent might be required)
- ☐ 48" **Hood Fan opening must be the same size or larger (8" or 10" vent required)
- ☐ Gas Range **gas line and electrical required & sold separately
- ☐ Induction **electrical required & sold separately
- ☐ Cooktop (Apron Front) **Countertop Cut-out required & sold separately
- ☐ Cooktop (Drop-in) **countertop Cut-out required & sold separately

HOOD FAN & VENT
UPGRADE

- ☐ 8 Inch **Required for 600 CFM
- ☐ 10 Inch
- ☐ Chimney Hood Fan **Vent must be centred
- ☐ Insert / Liner

WALL OVEN/MICRO
UPGRADE

- ☐ Single Wall Oven **electrical required & sold separately
- ☐ Double Wall Oven **electrical required & sold separately
- ☐ Steam Oven **electrical required & sold separately
- ☐ Warming Drawer **electrical required & sold separately
- ☐ Over Then Range Microwave (OTR)
- ☒ Built-In Microwave **Trim Kit required **electrical required & sold separately

DATE May 14/24

SITE Imishi

LOT 4114

** Any upgrades checked in this appliance form must be accompanied with specs provided by the Purchaser.

**It is the responsibility of the trade to inform the Builder of any discrepancies with specs, sketches, extras and/or colour chart PRIOR to production/installation.

ZANCOR

INTERIOR FINISHES ACKNOWLEDGEMENT / WAIVER

Purchaser accepts and acknowledges that the Builder reserves the right to substitute materials with those of equal or better quality where the manufacture, scheduling or delivery of materials may directly impact the Builder's ability to meet its' contractual obligations under the Agreement of Purchase and Sale.

KC
A.S

UPGRADES/EXTRAS: All upgrades and additional selections indicated on the colour chart must be accompanied by an upgrades/extras sheet (PES) and full payment otherwise the selection will be invalid. All colour charts and upgrades/extras will not proceed until verified and signed by an authorized signing officer at the Vendor's head office. **CHANGES WILL NOT BE PERMITTED UPON COMPLETION AND SUBMISSION OF THE COLOUR CHART.**

KC
A.S

PORCELAIN & NATURAL STONES: Due to the properties of natural stones including but not limited to **marble, granite, quartz**, no two pieces are exactly the same. Variations in colour, tone, granularity (pitting, fissures) and pattern are to be expected, including various lighting may affect the overall finished look. Stone tops are sealed at time of installation and should never be cleaned with lemon oil or vinegar. Stones are porous materials, therefore any spilled substance require immediate attention. Stone countertops require regular seal re-application as part of home maintenance. Purchaser acknowledges colour and product variations as well as natural imperfections may exist with the selection of natural stone materials and shall not hold the Vendor liable for provision of same.

KC
A.S

STONE COUNTERTOP JOINTS: Purchaser is aware that one joint will be at each corner and on either side of slide-in-range (if applicable). It will also be where the length of the counter top exceeds the length of a stone slab. Slabs are usually approximately 5'x 8'.

KC
A.S

CERAMIC TILES: Due to manufacturing, shade (dye lots), product variations may exist that can affect the overall look of the finished product. Although every effort will be made to ensure the colours and materials selected are as close as possible to the samples, the purchaser acknowledges that the sample tiles supplied in the Design Centre may not be identical to the materials installed in the home.

KC
A.S

STAIR STAINS: Due to the natural properties of wood, many variables can affect the overall look of the finished product. Factors including but not limited to wood type, knotting, graining, density, age, humidity, and air temperature can result in substantial variations in stain intensity. The purchaser accepts that although the Vendor will do their best to match stain the unfinished stairs as close as possible to the pre-finished floors, it is not possible to have an identical match and that there **MAY** be shade differences between the two products.

KC
A.S

CABINETRY: Due to the natural properties of wood, slight variations apparent with cabinetry are to be expected. This includes but not limited to wood species, wood grain, colour, finish, product variations, and natural imperfections are all factors that may affect the overall look of the finished product. Such factors make exact colour matching impossible. The type and intensity of lighting in the areas of designated cabinetry placement may also highlight characteristics of cabinetry finish. All cabinets shall be finished with a white melamine interior box unless a finished interior is upgraded. Due to building specifications and/or on-site conditions, certain cabinetry upgrades may not be possible. The purchaser acknowledges that the Builder cannot guarantee the cabinetry finish or provision of certain upgrades and shall not hold the Builder liable for provision of same.

KC
A.S

UPGRADES/EXTRAS: All upgrades and additional selections indicated on the colour chart must be accompanied by an upgrades/extras sheet (PES) and full payment otherwise the selection will be invalid. All colour charts and upgrades/extras will not proceed until verified and signed by an authorized signing officer at the Vendor's head office. **CHANGES WILL NOT BE PERMITTED UPON COMPLETION AND SUBMISSION OF THE COLOUR CHART.**

KC
A.S

HARDWOOD / LAMINATE FLOORING: Due to the properties of wood and laminate, many variables can affect the overall look of the finished product. Variations include but not limited to wood type or laminate finish, colour/stain and wood grain are significant factors that make exact colour matching impossible. The purchaser acknowledges that the hardwood flooring is a pre-finished product in a controlled environment. Expansion, compression and cupping are characteristics of hardwood flooring once installed in the home. The purchaser acknowledges these may become apparent over time and despite the Builders' efforts to install the hardwood flooring materials in keeping with good workmanship, the Builder shall not be responsible nor held liable for minor variances of fluctuation in hardwood flooring materials.

KC
A.S

HARDWOOD / LAMINATE WAIVER:

I/We understand hardwood flooring is classified as a porous material and as such not recommended by the Builder in certain areas. I/We understand there is a concern due to possible water and other substances being frequently splashed or spilled onto the floor and in contravention of Ontario Building Code Section 9.30.1.2(1).

"Finished flooring bathrooms, kitchens, public entrance halls, laundry & general storage areas shall consist of resilient flooring, felted-synthetic-fibre floor coverings, concrete, terrazzo, ceramic tile, mastic or other types of flooring providing similar degrees of water resistance.

I/We are prepared to assume full responsibility for any damage caused to the hardwood floor or subfloor due to moisture absorbency in the mentioned areas, and agree to waive any claims against the Township of residence, TARIION and/or the Builder in relation to the matter. ****SEE COLOUR CHART FOR LOCATIONS****

KC
A.S

DATE May 14/21

SITE Imish 1

LOT 410

HOME AUTOMATION
(Cable, CAT5/6, Telephone)

OPTION 1:

I/we the Homeowner(s) have chosen to contact the Home Automation Company to select the locations of the rough-ins for Cable, CAT5, Telephone as included in our Agreement of Purchase Sale.

I/we the Homeowner(s) will contact the trade within 4 weeks of the date of this release to select locations of the standard rough-ins review other optional products for purchase.

Trade: Smart-Tech Home Automation

Phone: (905) 761-6469

Rep: Kris

Location: 200 Millway Avenue, Unit 8

Concord, Ont L4K 5K8

Should the homeowner not make these selections within the sufficient time provided, the rough-ins as mentioned above will be installed in locations at the Vendor's discretion.

AS
Homeowner(s) Initial

OPTION 2:

I/we the Homeowner(s) have chosen to not contact the home automation company. I/we the Homeowner(s) have selected the locations for the standard rough-ins for Cable, CAT5, Telephone that are included in the Agreement of Purchase and Sale directly with a décor rep .

AS
Homeowner(s) Initial

DATE May 14/21

SITE Innisfil

LOT 41W

Stone Countertop Edge Profiles

Where applicable as per site specifications

STANDARD EDGE FOR KITCHEN & VANITIES

Standard Countertop Edge in
Kitchen

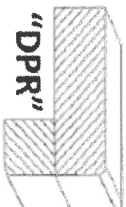

Standard Countertop Edge in
Vanity

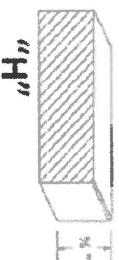

Homeowner(s) Initial lc A.S

OPTION (1) EDGE FOR KITCHEN & VANITIES \$250

Optional Edge in Kitchen

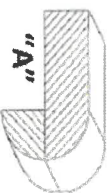
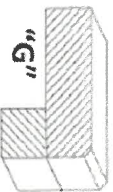
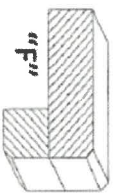
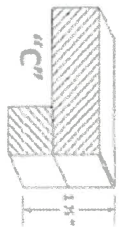

Optional Edge in Bathroom

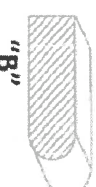

Homeowner(s) Initial _____

OPTION (2) EDGE FOR KITCHEN & VANITIES CUSTOM PRICING

Optional Edge for Kitchen

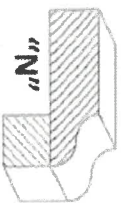
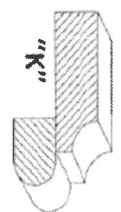
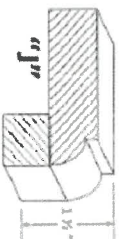
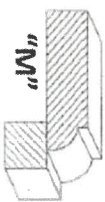
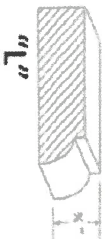

Optional Edge in Vanity

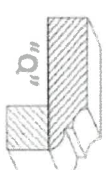
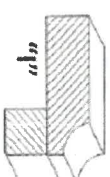
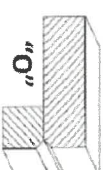
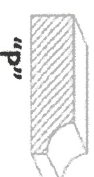

Homeowner(s) Initial _____

DATE May 14/21

SITE Imish /

LOT 4W