

CONSTRUCTION SUMMARY OF EXTRAS
Printed 2021-09-10 / 12:34 PM / Page 1 of 1

Site: WASAGA
Lot: 32
Model: MEADOW(40-06) ELEV A MOD
Purchaser: JENASIA JEYASEELAN
Purchaser: 0
Phone: 807.356.4258
Email: JENASIAJEYASEELAN@GMAIL.COM



DESCRIPTION		DATE SELECTED
BONUS PACKAGE: 3 PIECE STAINLESS STEEL APPLIANCES WITH WHITE TOP LOAD WASHER & DRYER	INCLUDED IN APS	
BONUS PACKAGE: STAINLESS STEEL HOOD FAN	INCLUDED IN APS	
STRUCTURALS		
1 8 FOOT HIGH SLIDING DOOR (REAR)- SEE SKETCH		25-Aug-21
2 QTY 5- 8 INTERIOR FOOT DOORS ON MAIN FLOOR, IN LIEU OF STANDARD (6'8")- SEE SEKTC		25-Aug-21
COLOURS		
1 50" ELECTRIC DIMPLEX FIREPLACE IN LIEU OF STANDARD. WALL TO BE BUILT INTO ROOM APPROX 8 INCHES TO ACCOMMODATE- SEE SKETCH		25-Aug-21
2 SMOOTH CEILINGS ON MAIN FLOOR-SEE SKETCH		25-Aug-21
3 TRIM- UP 1 COLONNIAL		25-Aug-21
4 PLUG OVER FIREPLACE FOR FUTURE TV, INSTALL 65 AFF, BESIDE CABLE- SEE SKETCH		25-Aug-21
5 2 CAPPED LIGHTS OVER KITCHEN ISLAND, SPACE EVENLY ON SEPARATE SWITCH, STD LIGHT TO REMAIN- SEE SKETCH		25-Aug-21
6 BANK OF DRAWERS IN MASTER BATH		25-Aug-21
7 OVER THE RANGE MICROWAVE INCLUDES ELECTRICAL 15 AMP		25-Aug-21
8 TILE- MASTER FLOOR- UP 5- BRICKED		25-Aug-21
9 TILE- MASTER SHOWER WALL- UP 5- STACKED VERTICLE		25-Aug-21
10 TILE- MASTER SHOWER FLOOR- UP 1		25-Aug-21
11 CABINET- MASTER ENSUITE- UP 1		25-Aug-21
12 COUNTERTOP- MASTER ENSUITE- UP 2, INCLUDES QTY 2 OVAL UNDERMOUNT SINK- 4220-CFY		25-Aug-21
13 CABINET- KITCHEN- UP 1		25-Aug-21
14 COUNTERTOP- KITCHEN- UP 2- INCLUDES UNDERMOUNT SINK		25-Aug-21
15 BACKSPLASH- KITCHEN- QUARTZ SLAB- UP 2		25-Aug-21
16 TILE- KITCHEN / BREAKFAST/PANTRY - BRICKED-UP 4		25-Aug-21
17 CABINET- MAIN BATH- UP 1		25-Aug-21
18 TILE- MAIN BATH FLOOR- UP 4- BRICKED		25-Aug-21
19 COUNTERTOP- MAIN BATH- UP 2 (INCLUDES QTY 1 OVAL UNDERMOUNT SINK- 4220-CFY)		25-Aug-21
20 TILE- MAIN BATH TUB WALL- UP 4- STACKED HORIZONTAL		25-Aug-21
21 TILE- LAUNDRY FLOOR TILE- UP 4- BRICKED		25-Aug-21
22 CABINET- LAUNDRY- UP 1		25-Aug-21
23 COUNTERTOP- LAUNDRY- UP 2		25-Aug-21
24 NA		25-Aug-21
25 TILE- FOYER- UP 4- BRICKED		25-Aug-21
26 TILE- POWDER- UP 4- BRICKED		25-Aug-21
27 MASTER BATH JAMB- UP 1		25-Aug-21
28 HARDWOOD- FAMILY ROOM, LANDINGS, DINING, LIVING ROOM, UPPER HALL		25-Aug-21
29 STAIN FOR STAIRS TO MATCH HARDWOOD AS MUCH AS POSSIBLE		25-Aug-21
30 COMFORT HEIGHT- QTY 2- MASTER, MAIN BATH		25-Aug-21
31 GAS LINE FOR STOVE, INCLUDES 15AMP, 40 AMP TO REMAIN		25-Aug-21
32 WATERLINE FOR FRIDGE		25-Aug-21
33 COUNTERTOP - LAUNDRY ROOM- UP 2		25-Aug-21
34 PLUMBING- LAUNDRY SINK- BLANCO- 402242-FORMERA U1- SEE SPEC		25-Aug-21

ZANCOR HOMES COLOUR CHART

PRINTED 2021-08-25, 5:27 PM

ENTRANCES				
Main Foyer - FLOORING		SIMPLICITY BLACK 12 X 24- UP 4- BRICKED		
Mudroom - FLOORING		NA		
Side Hall - FLOORING		NA		
Basement Foyer - FLOORING		NA		
KITCHEN				
Kitchen - FLOORING		SIMPLICITY BLACK 12 X 24- UP 4- BRICKED		
Breakfast - FLOORING		SIMPLICITY BLACK 12 X 24- UP 4- BRICKED		
Kitchen - CABINETS		MDF MOSAIC GLACIER WHITE- UP 1		
Island - CABINETS		MDF MOSAIC GLACIER WHITE- UP 1		
PANTRY- CABINETS		MDF MOSAIC GLACIER WHITE- UP 1		
Kitchen - HANDLES/KNOBS		H800BC		
Kitchen - COUNTERTOP		SILVER WAVE GRANITE- UP 2		
Island - COUNTERTOP		SILVER WAVE GRANITE- UP 2		
Kitchen - BACKSPLASH		SLAB- SILVER WAVE GRANITE- UP 2		
Kitchen - SINK		STD		
Kitchen - FAUCET		STD		
GREAT ROOM / DINING / LIVING / DEN / OFFICE / BASEMENT				
Family / Great Room - FLOORING		NORTHERN SOLID SAWN PEARL WHITE OAK- 5" - UP 2- BAROQUE		
Main Hall - FLOORING		NORTHERN SOLID SAWN PEARL WHITE OAK- 5" - UP 2- BAROQUE		
Dining / Living Room - FLOORING		NORTHERN SOLID SAWN PEARL WHITE OAK- 5" - UP 2- BAROQUE		
Library / Den - FLOORING		NA		
Basement Rec Room - FLOORING		NA		
STAIRS				
Railing Details - PICKETS		1 3/4" TURNED OAK		
Railing Details - POSTS		2 3/4" TURNED OAK POST		
Railing Details - HANDRAIL		2 1/2" OVAL OAK HANDRAIL		
Stair Stain - MAIN STAIRS		STAIN TO MATCH HARDWOOD AS CLOSE AS POSSIBLE		
Stair Stain - BASEMENT STAIRS (if applicable)		NA		
Stair Stain - SERVICE STAIRS (if applicable)		NA		
POWDER ROOM				
Powder Room - FLOORING		SIMPLICITY BLACK 12 X 24- UP 4- BRICKED		
Powder Room - CABINETS		NA		
Powder Room - COUNTERTOP		NA		
Powder Room - SINK		STD		
Powder Room - FAUCET		STD		
2ND FLOOR				
Upper Hall - FLOORING		NORTHERN SOLID SAWN PEARL WHITE OAK- 5" - UP 2- BAROQUE		
Master Bedroom - FLOORING		T03 OPENING NIGHT		
Bedroom 2 - FLOORING		T03 OPENING NIGHT		
Bedroom 3 - FLOORING		T03 OPENING NIGHT		
Bedroom 4 - FLOORING		T03 OPENING NIGHT		
Bedroom 5 - FLOORING		NA		
Master Ensuite - FLOORING		B&W BREACH POLISHED 12 X 24- UP 5- BRICKED		
Master Ensuite - SHOWER WALL		B&W BREACH POLISHED 12 X 24- UP 5- STACKED VERTICLE		
Master Ensuite - SHOWER FLOOR		ONTARIO SERIES HEXAGON MATTE BLACK- UP 1		
Master Ensuite - SHOWER JAMB		SNOW QUARTZ		
Master Ensuite - CABINETS		EURO HIGH GLOSS BLACK- UP 1- COMFORT HEIGHT		
Master Ensuite - HANDLES/KNOBS		H800BC		
Master Ensuite - COUNTERTOP		BLANCO PURE - UP 2		
Master Ensuite - SINK(s)	OVAL- 4220-CFY- QTY 2	Master Ensuite - FAUCET(s)	STD	
FOR TRADE USE				
Any upgrades in the colour chart must be accompanied with a PES. It is the responsibility of all Trades to inform the builder of any discrepancies on sketches, PES and/or colour charts PRIOR to installation.		WASAGA SHORELINE 32		
		PURCHASER INITIALS		
		VENDOR APPROVAL		

ZANCOR HOMES COLOUR CHART

2ND FLOOR CONTINUED ...									
Main Bath - FLOORING		SIMPLICITY BLACK 12 X 24- UP 4- BRICKED							
Main Bath - TUB / SHOWER WALL		SIMPLICITY BLACK 12 X 24- UP 4-STACKED HORIZONTAL							
Main Bath - SHOWER FLOOR		NA							
Main Bath - SHOWER JAMB		NA							
Main Bath - CABINETS		MOSAIC MDF GLACIER WHITE- UP 1- COMFORT HEIGHT							
Main Bath - HANDLES/KNOBS		H800BC							
Main Bath - COUNTERTOP		SILVER WAVE GRANITE- UP 2							
Main Bath - SINK(S)		OVA;- 4220-CFY	SILVER WAVE GRANITE- UP 2		Main Bath - FAUCET(S)		STD		
Shared Bath- FLOORING		NA							
Shared Bath- TUB / SHOWER WALL		NA							
Shared Bath- SHOWER FLOOR		NA							
Shared Bath- SHOWER JAMB		NA							
Shared Bath- CABINETS		NA							
Shared Bath- HANDLES/KNOBS		NA							
Shared Bath- COUNTERTOP		NA							
Shared Bath- SINK(S)		NA		Shared Bath - FAUCET(S)		NA			
Ensuite Bath - FLOORING		NA							
Ensuite Bath - TUB / SHOWER WALL		NA							
Ensuite Bath - SHOWER FLOOR		NA							
Ensuite Bath - SHOWER JAMB		NA							
Ensuite Bath - CABINETS		NA							
Ensuite Bath - HANDLES/KNOBS		NA							
Ensuite Bath - COUNTERTOP		NA							
Ensuite Bath - SINK(S)		NA		Ensuite Bath - FAUCET(S)		NA			
LAUNDRY									
Laundry - FLOORING		SIMPLICITY BLACK- 12 X 24- UP 4- BRICK		Laundry - HANDLES/KNOBS		H800BC			
Laundry - CABINETS		MOSAIC MDF GLACIER WHITE		Laundry - SINK		BLANCO - 402242-			
Laundry - COUNTERTOP		SILVER WAVE GRANITE- UP 2		Laundry - FAUCET		STD			
Laundry - BACKSPLASH		NA							
TRIM / PAINT									
Casing/Baseboards		COLONIAL- UP 1							
Interior Doors		STD							
Interior Door Hardware		STD							
PAINT - Throughout		WARM GREY							
FIREPLACE									
Location / Insert / Mantle		50" FIREPLACE							
ACCESSORIES									
Mirrors		YES		BATH ACCESSORIES		DO NOT INSTALL			
APPLIANCE REQUIREMENTS									
GAS LINE TO BBQ		STD		ELECTRICAL for Built-in Oven		DECLINED			
GAS LINE & ELECTRICAL TO STOVE		YES		ELECTRICAL for Built-in Micro		YES			
GAS LINE & ELECTRICAL TO DRYER		DECLINED		ELECTRICAL for Cooktop		DECLINED			
HOOD FAN VENT SIZE		6" STD		ELECTRICAL for Bar Fridge		DECLINED			
WATERLINE to Fridge		YES							
DISCLAIMER									
Any changes to the colour chart after signing are subject to a \$5000 administration fee plus costs									
Purchaser has checked and acknowledged accuracy of colour and selections before signing.									
Colours of all materials are as close as possible to Builders selection but not necessarily identical due to dye lot variances in manufacturing/manufacturers. Due to construction progress some items may have been pre-selected or installed. In this event the Vendor's selection must be accepted by the purchaser									
SITE / LOT:		WASAGA		32					
PURCHASER(S):		JENASIA JEYASEELAN							
PURCHASER(S):		0							
CONTACT:		807.356.4258		JENASIAJEYASEELAN@GMAIL.COM					
FOR TRADE USE									
Any upgrades in the colour chart must be accompanied with a PES. It is the responsibility of all Trades to inform the builder of any discrepancies on sketches, PES and/or colour charts PRIOR to installation.									
ZANCOR HOMES		PURCHASER SIGNATURE		PURCHASER SIGNATURE					
DEOR CONSULTANT		DEOR CONSULTANT		DEOR CONSULTANT					
Vendor APPROVAL		Vendor APPROVAL		Vendor APPROVAL					
PAGE 2 OF 2									

WASAGA BEACH

132

Aug 25/21



50'' Fireplace

plug for TV
above
Fireplace
OS AFF

Qty 5
8 Foot
interior
Doors

Smooth Cellings

15

SHORELINE POINT
WASAGA BEACH

MEADOW 40-06

lot 32
Aug 25/21

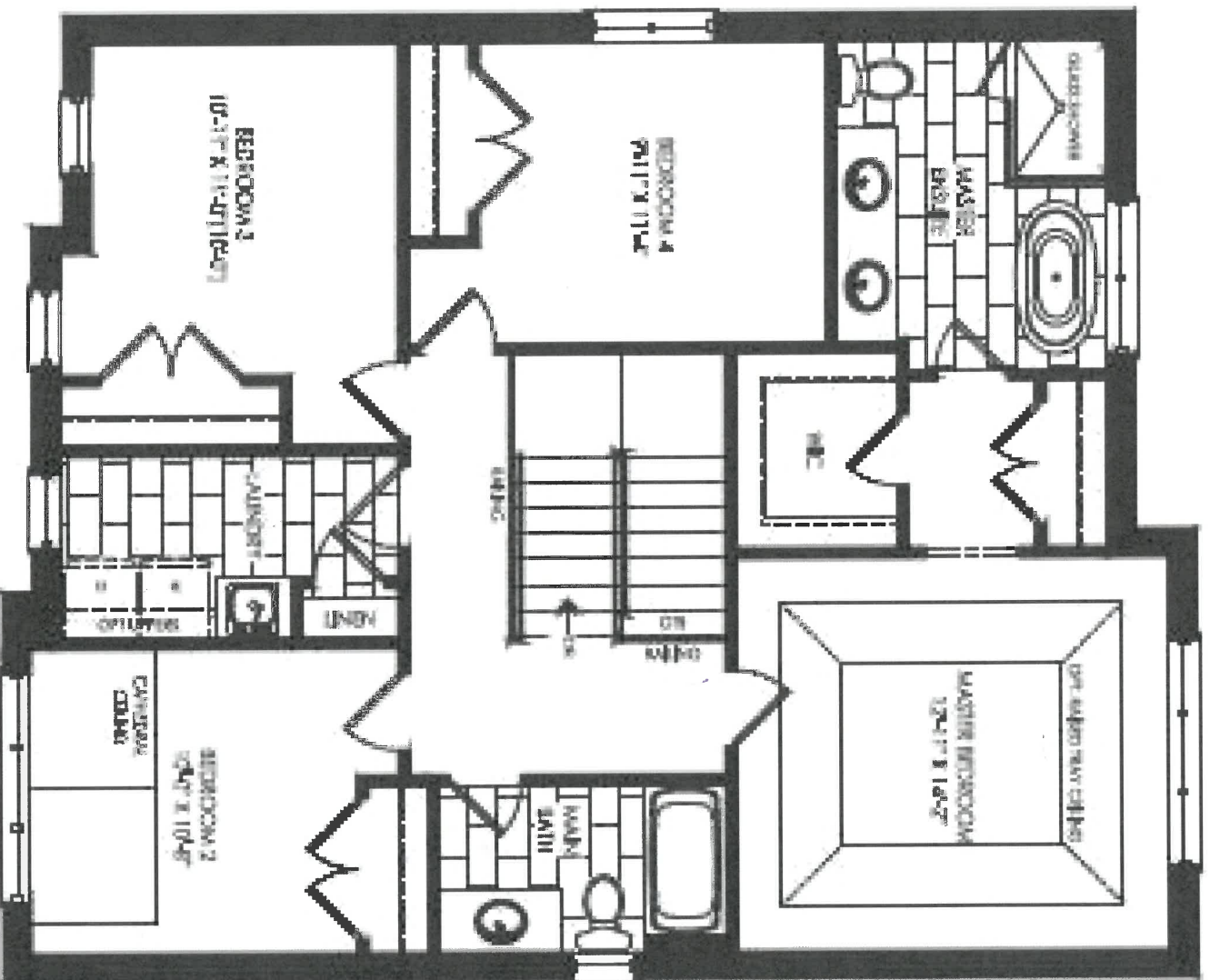

Elevation A
Second Floor

21

SHORELINE POINT
WASAGA BEACH

MEADOW 40-06

1st 32
18925/21

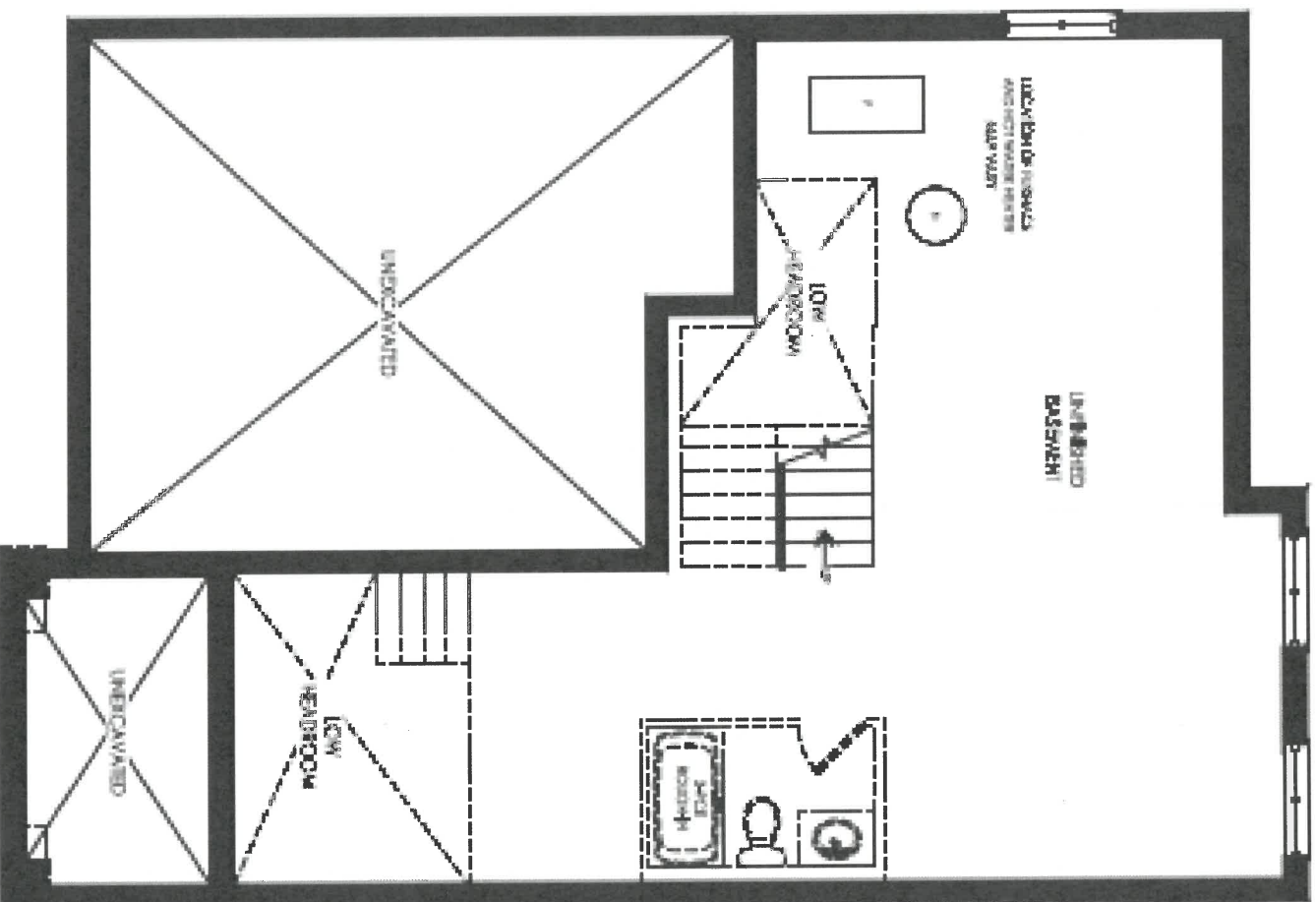

Elevation A, B & C
Basement

Handwritten signature or initials in blue ink.

1st 32
Aug 25/21

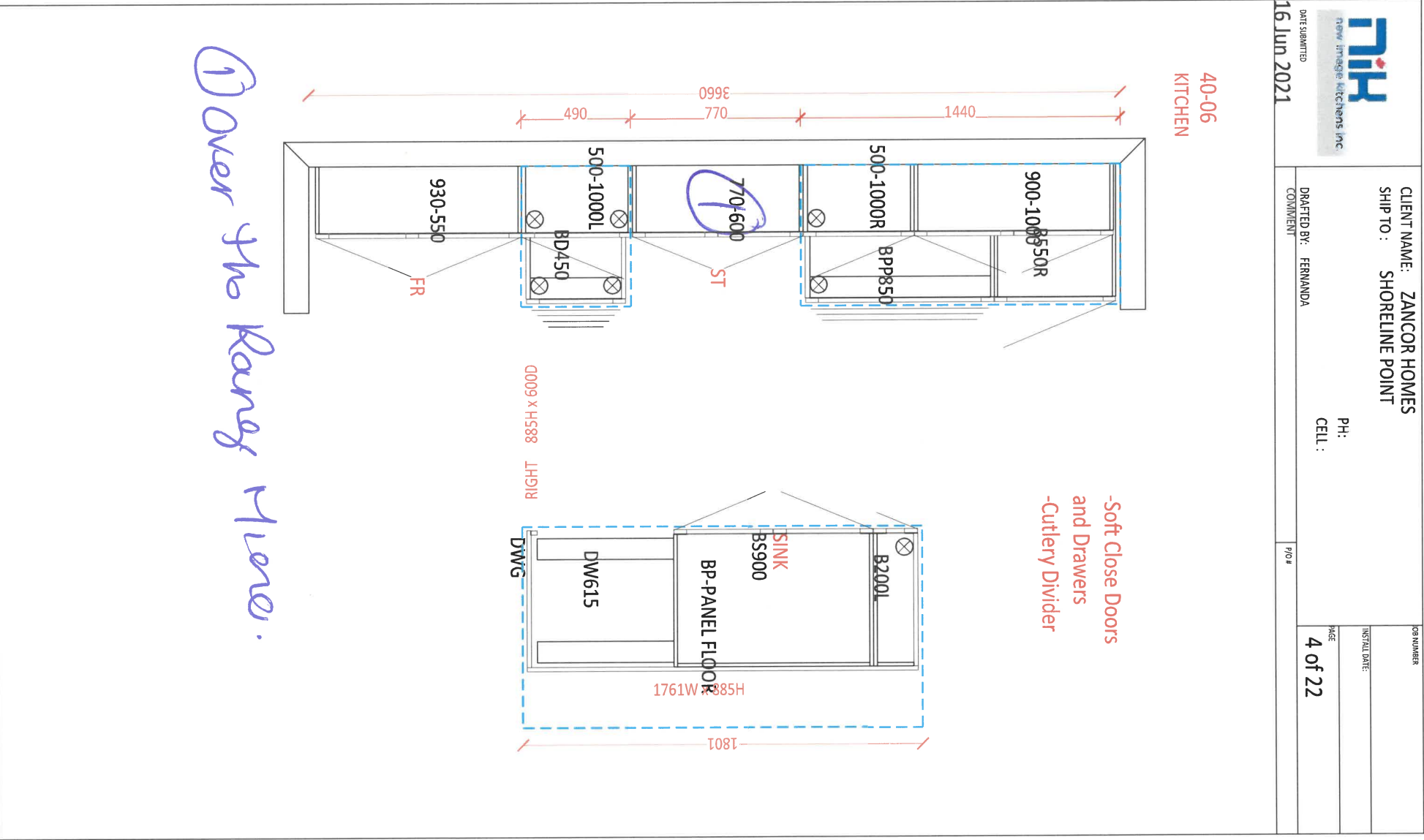

55

1st 32
Aug 25/21



DATE SUBMITTED

16 Jun 2021

CLIENT NAME: ZANCOR HOMES
SHIP TO : SHORELINE POINT

JOB NUMBER

PH:

CELL:

INSTALL DATE:

PAGE

5 of 22

DRAFTED BY: FERNANDA
COMMENT

FIG #

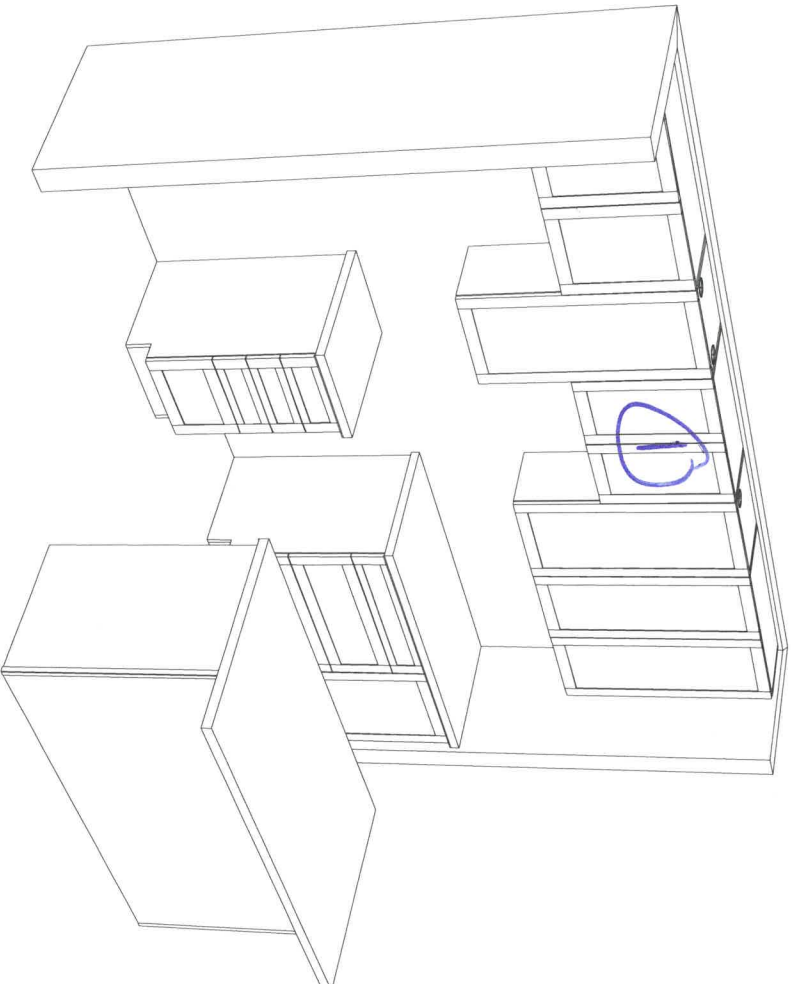

① over the Range Hood

22

1st 32
Aug 25/21

		JOB NUMBER	
CLIENT NAME: ZANCOR HOMES		INSTALL DATE:	
SHIP TO : SHORELINE POINT		PAGE	
DRAFTED BY: FERNANDA		6 of 22	
DATE SUBMITTED 16 Jun 2021		P/O #	
COMMENT			

40-06

MAIN 1150

Can't Height

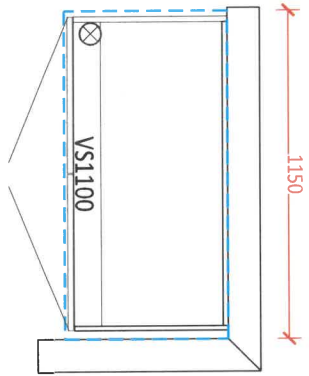

MASTER ENSUITE 1960

Can't Height

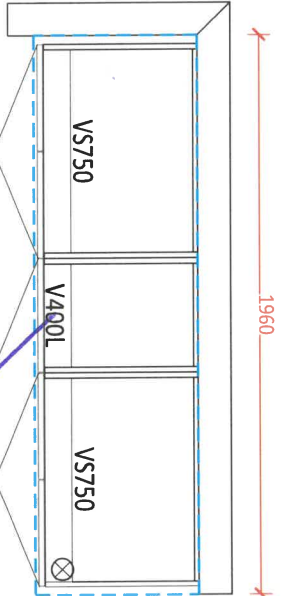

LAUNDRY 2300

Back of drawers

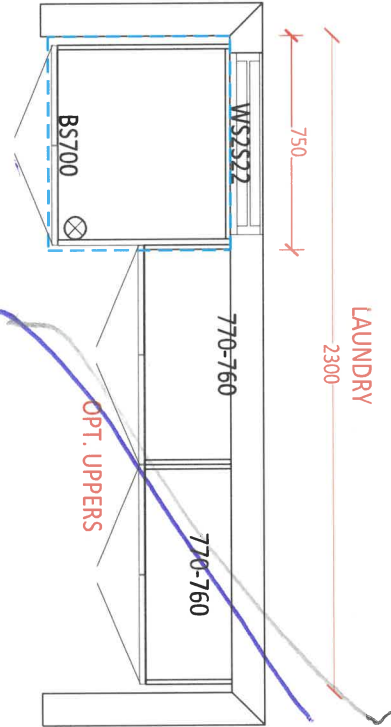

55



Lot 32
Aug 30/21

Sink Specifications

QUATRUS R15 LAUNDRY

Colour **SKU**
brushed finish 401802

Design and planning tips

- Min cabinet size: 27 in (685 mm)
- Bowl Depth: 12 in (305.0 mm)

Specifications:

Sink template, Mounting clips, Installation instructions, 3 1/2" (90 mm) stainless steel strainers

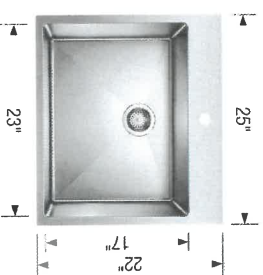

Sink can be installed as a topmount or undermount. Depending on cabinet construction, a different cabinet size may be required. Consult the cabinet manufacturer. Codes/Standards: ASME A112.19.3-2017/ CSA B45.4-17

Optional Accessories

Laundry Rack 401952
CapFlow Strainer Cover 517666

Laundry Sink

Warranty

Limited lifetime warranty on all sinks and faucets. One-year warranty on all accessories and soap dispensers.

Code/Standards Compliance

BLANCO sinks and faucets are third-party tested and certified to CSA, cUPC, ANSI/ASME, IAPMO and NSF standards and listed by applicable certification bodies. For more information on individual product listings, contact our office or listing organization.



Need support? Learn more by watching our sink & faucet How-to videos:
<https://www.blanco.com/ca-en/support/how-to-videos/how-to-videos-for-sinks/>



BLANCO Canada Inc
100 Corporation Drive
Brampton ON L6S 6B5

Tel & Fax
Tel: 905-494-2400 Toll free: 1-877-425-2626
Fax: 905-494-2425 Toll free: 1-877-825-2626

While BLANCO strives to provide accurate information, all images and dimensions in this document are intended for reference only and are subject to change at any time without notice. This document is not intended for use as an installation guide. For technical installation details, refer to installation instructions provided with the product. BLANCO assumes no responsibility for the use of superseded or voided specifications.

X

CLEAR COPY

BLANCO

Sink Specifications

Colour **SKU**
brushed finish 401802

Design and planning tips

- Min cabinet size: 27 in (695 mm)
- Bowl Depth: 12 in (305.0 mm)

Specifications:

Sink template, Mounting clips, Installation instructions, 3 1/2" (90 mm) stainless steel strainers

Sink can be installed as a topmount or undermount. Depending on cabinet construction, a different cabinet size may be required. Consult the cabinet manufacturer. Code:Standard: ASME A112.19.3-2017/ CSA B45.4-17

Optional Accessories

Laundry Rack 401852
CapTow Steiner Cover 517866

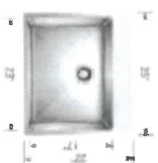

QUATRUS R15 LAUNDRY

Laundry Sink

Warranty
Limited lifetime warranty on all sinks and faucets. One-year warranty on all accessories and soap dispensers.

Code/Standards Compliance
BLANCO sinks and faucets are third-party tested and certified to CSA, DHP, ANSI/APSE, IAPMO and NSF standards and listed by applicable certification bodies. For more information on individual product listings, contact our office or listing organization.

 Need support? Learn more by watching our sink & faucet How-to videos:
<https://www.blanco.com/usa-english/video-to-information-to-choose-the-right>

 **BLANCO Canada Inc.**
100 Corporation Drive
Brampton ON L6S 9B5

Tel & Fax
Tel: 905-494-2400 Toll free: 1-877-425-2626
Fax: 905-494-2425 Toll free: 1-877-425-2626

While BLANCO strives to provide accurate information, all images and dimensions in this document are intended for reference only and are subject to change at any time without notice. This document is not intended for use as an installation guide. For technical installation details, refer to installation instructions provided with the product. BLANCO assumes no responsibility for the use of reproduced or modified specifications.

X
✓



Prism Series
50" Linear Electric Fireplace

BLF5051

The best-selling linear fireplace is now even better.



The best-selling electric linear fireplace just got better with the all new Prism Series. Sparkling with intensity in a full spectrum of colors, the Prism effect illuminates the diamond-like acrylic ice ember bed in a show-stopping effect. Plug-in or hard-wire, hung on the wall or built-in; the Prism Series is beautifully versatile.

PRISM
series

32 weeks



Prism Series

50" Linear Electric Fireplace

BLF5051

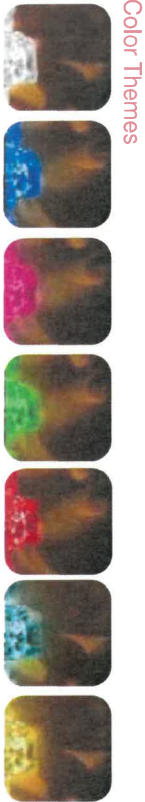
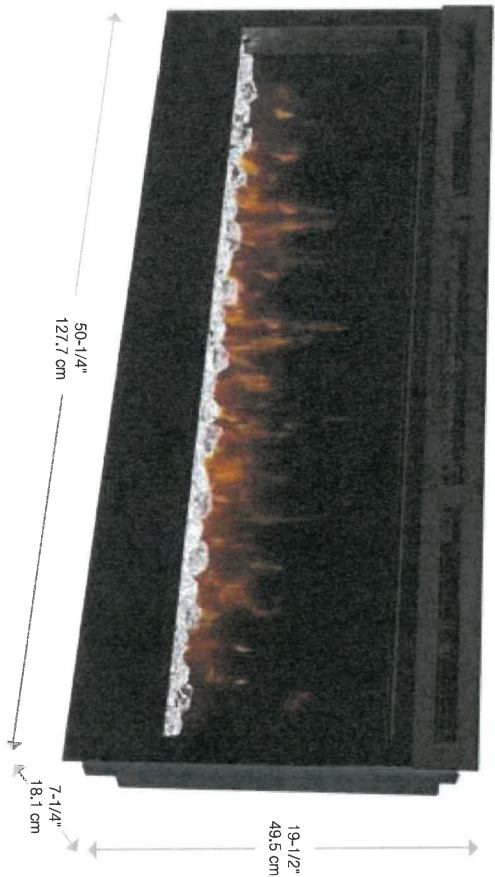

Accessories



120 Volts | 1,230 Watts | 4,197 BTU

Model #	Description	Lbs / Kg	UPC	Wty ¹	Carton Dimensions (WxHxD)		Cube
					Inches	cm	ft ³ / m ³
BLF5051	50" Linear Electric Fireplace	75 / 34.1	781052 098787	2 yr.	55 x 23-1/4 x 12-7/8	139.7 x 58.9 x 32.7	9.5 / 0.26
DTT1267BLK	Cohesion Trim - Black	51 / 23.1	781052 080355	1 yr.	64-7/8 x 26-1/4 x 8-3/4	164.8 x 66.8 x 22.1	8.6 / 0.24
LF50DWS-KIT	50" Driftwood and River Rock Accessory Kit	7 / 3.17	781052 102842		34-1/4 x 5-7/8 x 8-1/8	87.2 x 14.98 x 20.6	

Specifications, finishes and dimensions are subject to change. ¹ Limited warranty. ©2020 Glen Dimplex Americas

Glen Dimplex Americas | 1-800-668-6663 | www.dimplex.com

Features

- The Original Dimplex Flame Effect™**
A blend of technology, artistry and craftsmanship that sets the standard for realism.
- Acrylic Ice Media Bed**
Light plays through different size pieces and sparkle in a spectrum of colors.
- Media Accent Colors**
Choose from a variety of brilliant color themes or cycle through a range of colors using the custom mode, freezing on the hue of your choice.
- Flexible Installation**
Simply surface mount and plug-in or fully-recess and direct wire for a seamless installation
- Hanging Glass Design**
Detachable glass trim easily finishes rough openings and provides access to media.
- Remote Thermostat Control**
Temperature control at your fingertips for convenient comfort.
- Multi-function Remote**
Control the flame, heat and thermostat from the comfort of your chair.
- LED Lighting**
Flame and lights use brilliant, low-energy LEDs that require zero maintenance.
- All-season Flames**
Enjoy the unique charm of a fireplace 365 days a year using the flames without the heat.
- Cool-touch Glass**
Glass remains cool making it safe for any location and any user.
- Low Carbon Footprint**
The most sustainable fireplace option: no emissions and 100% efficient.

SE-022-FRM-C4 1520

32 Wasega



Prism Series

50" Linear Electric Fireplace

BLF5051

Product Dimensions:

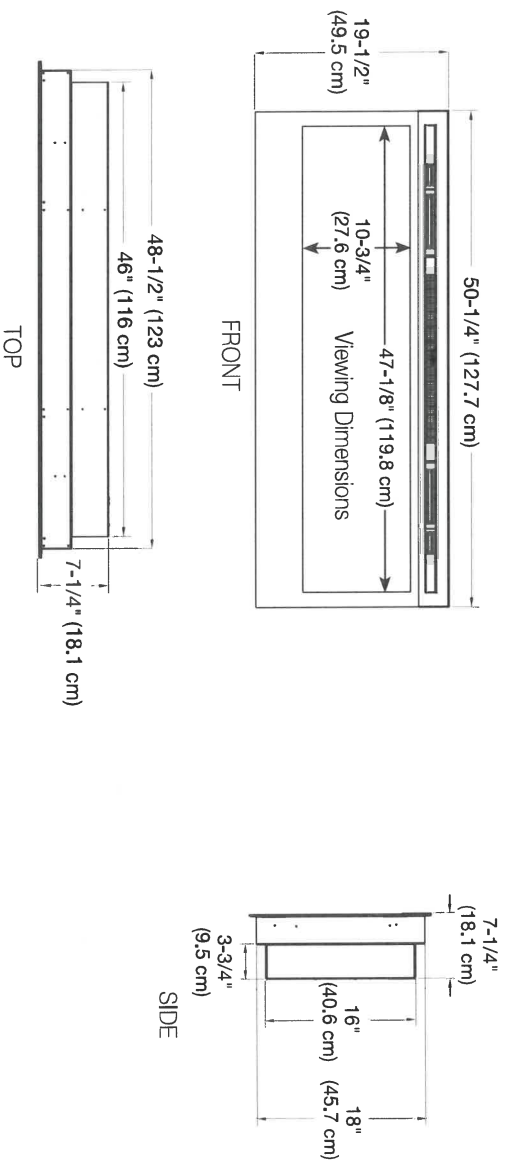

Installation Options and Framing Dimensions

3 Mounting Options

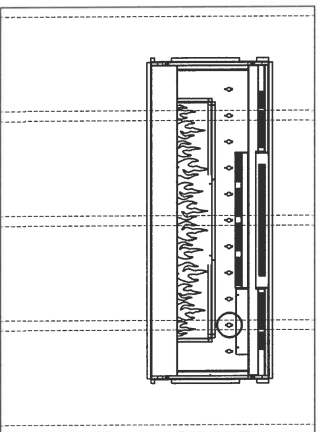

ON WALL

Must mount to a minimum of three (3) wall studs

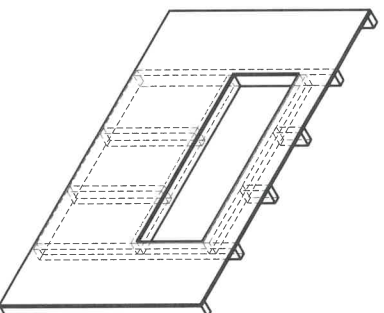

PARTIAL RECESSED

2 X 4 Wall Construction
Framing dimensions:
46-1/2" W x 16-1/2" H
(118.1 cm) W x (42 cm) H

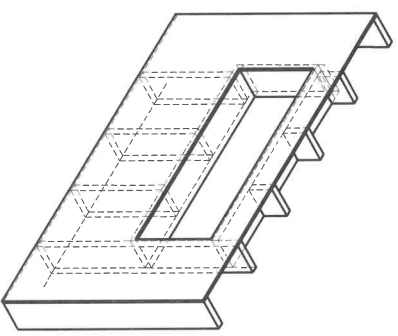

FULLY RECESSED

2 X 8 Wall Construction
Framing dimensions:
49" W x 18-1/2" H
(124.5 cm) W x (47 cm) H

32 Wesaqa

THE
GALLERY

BY ZANCOR

SHORELINE POINT

WASAGA BEACH

ZANCOR

APPLIANCE ACKNOWLEDGEMENT

CONTACT: Steve Miller - Appliance Canada (905) 660-2424 / smiller@appliancecanada.com

- It is the Purchaser's responsibility to coordinate delivery, installation and hook up of appliances and to ensure they are installed as per Manufacturers specifications after closing.

STANDARD APPLIANCE OPENINGS provided by Zancor:

*Standard appliance openings are approximate and the minimum required. Sizes may vary due to onsite condition and/or when modifications have been made to the cabinetry.

- Fridge Opening 36" x 74"
- Stove Opening 30"
- Hood Fan Opening 30"
- Hood Fan & Vent 6" with Under Cabinet Hood
- Dishwasher Opening 24"

Accepts Standard
Openings **Initial

SM

OPTIONAL UPGRADED APPLIANCES to be provided by Homeowner:

- ****Specs/information sheets are required and it is the responsibility of the homeowner to provide this to Zancor Homes by the due date that has been provided. If appliance specs are not submitted, Zancor Homes will not be responsible for any necessary requirements and the standard opening will be built.**

SM

INITIAL

- Upgraded Appliance Specs are DUE 2 WEEKS FROM SIGNED DATE OF COLOUR CHART (if not received during appointment)
- ***Specs that require changes/modifications after this date will not be accepted***
- NOTE: Any upgraded appliances are to be paid by the Purchaser, directly to the appliances company.
- Additional charges to the Purchaser may apply for cabinetry, electrical and plumbing in order to accommodate the specs given by the homeowner.

FRIDGE UPGRADE

- ☐ Built-in
- ☐ Paneled **Panel to match required
- ☐ Integrated / Flush Inset
- ☒ Waterline

RANGE UPGRADE

*Larger hood fan CFM might be required, which need a larger vent

- ☐ 36" **Hood fan opening must be the same size or larger (8" vent might be required)
- ☐ 48" **Hood Fan opening must be the same size or larger (8" or 10" vent required)
- ☒ Gas Range **gas line and electrical required & sold separately
- ☐ Induction **electrical required & sold separately
- ☐ Cooktop (Apron Front) **Countertop Cut-out required & sold separately
- ☐ Cooktop (Drop-in) **countertop Cut-out required & sold separately

HOOD FAN & VENT UPGRADE

- ☐ 8 Inch **Required for 600 CFM
- ☐ 10 Inch
- ☐ Chimney Hood Fan **Vent must be centred
- ☒ Insert / Liner

WALL OVEN/MICRO UPGRADE

**Electrical required

- ☐ Single Wall Oven **electrical required & sold separately
- ☐ Double Wall Oven **electrical required & sold separately
- ☐ Steam Oven **electrical required & sold separately
- ☐ Warning Drawer **electrical required & sold separately
- ☒ Over Then Range Microwave (OTR)
- ☐ Built-In Microwave **Trim Kit required **electrical required & sold separately

DATE May 25/21

WASAGA SHORLINE

SITE

LOT

32

** Any upgrades checked in this appliance form must be accompanied with specs provided by the Purchaser.

**It is the responsibility of the trade to inform the Builder of any discrepancies with specs, sketches, extras and/or colour chart PRIOR to production/installation.

ZANCOR

221 North Rivermede Road, Concord, Ontario L4K 3N7 * T: (905) 738.7010 F: (905) 738.5948

INTERIOR FINISHES ACKNOWLEDGEMENT / WAIVER

Purchaser accepts and acknowledges that the Builder reserves the right to substitute materials with those of equal or better quality where the manufacture, scheduling or delivery of materials may directly impact the Builder's ability to meet its' contractual obligations under the Agreement of Purchase and Sale.

UPGRADES/EXTRAS: All upgrades and additional selections indicated on the colour chart must be accompanied by an upgrades/extras sheet (PES) and full payment otherwise the selection will be invalid. All colour charts and upgrades/extras will not proceed until verified and signed by an authorized signing officer at the Vendor's head office. **CHANGES WILL NOT BE PERMITTED UPON COMPLETION AND SUBMISSION OF THE COLOUR CHART.**

PORCELAIN & NATURAL STONES: Due to the properties of natural stones including but not limited to **marble, granite, quartz**, no two pieces are exactly the same. Variations in colour, tone, granularity (pitting, fissures) and pattern are to be expected, including various lighting may affect the overall finished look. Stone tops are sealed at time of installation and should never be cleaned with lemon oil or vinegar. Stones are porous materials, therefore any spilled substance require immediate attention. Stone countertops require regular seal re-application as part of home maintenance. Purchaser acknowledges colour and product variations as well as natural imperfections may exist with the selection of natural stone materials and shall not hold the Vendor liable for provision of same.

STONE COUNTERTOP JOINTS: Purchaser is aware that one joint will be at each corner and on either side of slide-in-range (if applicable). It will also be where the length of the counter top exceeds the length of a stone slab. Slabs are usually approximately 5'x 8'.

CERAMIC TILES: Due to manufacturing, shade (dye lots), product variations may exist that can affect the overall look of the finished product. Although every effort will be made to ensure the colours and materials selected are as close as possible to the samples, the purchaser acknowledges that the sample tiles supplied in the Design Centre may not be identical to the materials installed in the home.

STAIR STAINS: Due to the natural properties of wood, many variables can affect the overall look of the finished product. Factors including but not limited to wood type, knotting, graining, density, age, humidity, and air temperature can result in substantial variations in stain intensity. The purchaser accepts that although the Vendor will do their best to match stain the unfinished stairs as close as possible to the pre-finished floors, it is not possible to have an identical match and that there MAY be shade differences between the two products.

CABINETRY: Due to the natural properties of wood, slight variations apparent with cabinetry are to be expected. This includes but not limited to wood species, wood grain, colour, finish, product variations, and natural imperfections are all factors that may affect the overall look of the finished product. Such factors make exact colour matching impossible. The type and intensity of lighting in the areas of designated cabinetry placement may also highlight characteristics of cabinetry finish. All cabinets shall be finished with a white melamine interior box unless a finished interior is upgraded. Due to building specifications and/or on-site conditions, certain cabinetry upgrades may not be possible. The purchaser acknowledges that the Builder cannot guarantee the cabinetry finish or provision of certain upgrades and shall not hold the Builder liable for provision of same.

UPGRADES/EXTRAS: All upgrades and additional selections indicated on the colour chart must be accompanied by an upgrades/extras sheet (PES) and full payment otherwise the selection will be invalid. All colour charts and upgrades/extras will not proceed until verified and signed by an authorized signing officer at the Vendor's head office. **CHANGES WILL NOT BE PERMITTED UPON COMPLETION AND SUBMISSION OF THE COLOUR CHART.**

HARDWOOD / LAMINATE FLOORING: Due to the properties of wood and laminate, many variables can affect the overall look of the finished product. Variations include but not limited to wood type or laminate finish, colour/stain and wood grain are significant factors that make exact colour matching impossible. The purchaser acknowledges that the hardwood flooring is a pre-finished product in a controlled environment. Expansion, compression and cupping are characteristics of hardwood flooring once installed in the home. The purchaser acknowledges these may become apparent over time and despite the Builders' efforts to install the hardwood flooring materials in keeping with good workmanship, the Builder shall not be responsible nor held liable for minor variances of fluctuation in hardwood flooring materials.

HARDWOOD / LAMINATE WAIVER:

I/We understand hardwood flooring is classified as a porous material and as such not recommended by the Builder in certain areas. I/We understand there is a concern due to possible water and other substances being frequently splashed or spilled onto the floor and in contravention of Ontario Building Code Section 9.30.1.2(1).

"Finished flooring bathrooms, kitchens, public entrance halls, laundry & general storage areas shall consist of resilient flooring, felted-synthetic-fibre floor coverings, concrete, terrazzo, ceramic tile, mastic or other types of flooring providing similar degrees of water resistance."

I/We are prepared to assume full responsibility for any damage caused to the hardwood floor or subfloor due to moisture absorbency in the mentioned areas, and agree to waive any claims against the Township of residence, TARIION and/or the Builder in relation to the matter. ****SEE COLOUR CHART FOR LOCATIONS****

DATE	<i>Aug 25/21</i>	SITE	<i>32</i>	LOT	<i>32</i>
WASAGA SHORELINE					

221 North Rivermede Road, Concord, Ontario L4K 3N7 * T.: (905) 738.7010 F: (905) 738.5948

HOME AUTOMATION (Cable, CAT5/6, Telephone)

INCLUDED IN SCHEDULE "A" IN AGREEMENT OF PURCHASE AND SALE:

- Rough-in for Central Vacuum system piped to garage
- Rough-in for Telephone (2) locations
- Rough-in for Cable TV (2) locations
- Rough-in for Cat-6 Network (3) locations

CONTACT:

I/we the Homeowner(s) have chosen to contact the Home Automation Company to select the locations of the rough-ins for Cable, CAT5, Telephone as included in our Agreement of Purchase Sale.

I/we the Homeowner(s) will contact the trade within 4 weeks of the date of this release to select locations of the standard rough-ins review other optional products for purchase.

Trade: Smart-Tech Home Automation
Phone: (905) 761-6469
Email: kris@smart-tech.ca
Rep: Kris
Location: 200 Millway Avenue, Unit 8
Concord, Ont L4K 5K8

ACKNOWLEDGEMENT:

I/We the homeowner(s) acknowledge that if I/We the homeowners decide to not contact Smart-Tech, locations of the standard rough-ins will be installed as per Vendors discretion.

JS
Homeowner(s) Initial

DATE Aug 25/21

WASAGA SHORELINE

SITE

LOT

32

BRICK/JOINT PATTERN INSTALLATION RELEASE FORM

BRICK installation is included as a standard on the floor for 12 x 24 tiles and must be noted on the colour chart and acknowledged on this form

(Large tiles installation for floor and wall) – ¼ Brick

Please be advised it has come to our attention, that due to production, many of the over-sized and odd shaped, man-made tiles (i.e. porcelain & ceramic), have been found to have a slight bow in the tile. It is a standard occurrence with all suppliers and manufacturers.

It is therefore recommended, that if and when a purchaser requests to install one of these tiles in a brick-joint pattern, that it be installed o=[n a ¼ brick pattern, to try to avoid lippage. Attached with this letter, you will find a layout of the ¼ brick installation that has been recommended.

LOCATIONS: Lower Powder, Kitchen,
LOCATIONS: 8 of powder, main, laundry.
LOCATIONS: _____
LOCATIONS: _____

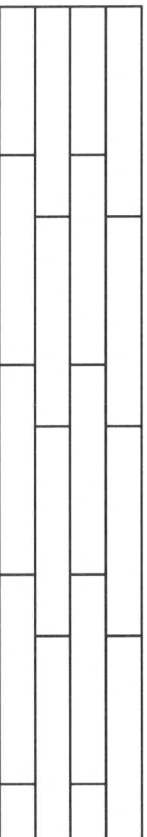

Please understand, even in using this ¼ brick installation, there may still be minimal lippage which cannot fully be eliminated.

Hence, when there is a request for brick-joint installation, Zancor Homes and their contractor, cannot be held responsible for this matter.

XJ
Homeowner(s) Initial

(Small tile installation for walls) – ½ Brick

Purchaser requests to install small wall tiles on a backsplash or shower wall in a brick-joint pattern, that it be installed on a ½ brick pattern.

LOCATIONS: _____
LOCATIONS: _____
LOCATIONS: _____
LOCATIONS: _____



Homeowner(s) Initial

DATE: Aug 25/2 WASAGA SHORELINE SITE: _____ LOT: 30

Stone Countertop Edge Profiles

Where applicable as per site specifications

STANDARD EDGE FOR KITCHEN & VANITIES

Standard Countertop Edge in Kitchen

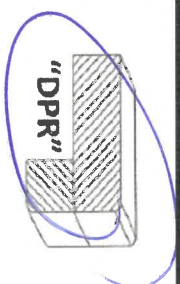

Standard Countertop Edge in Vanity

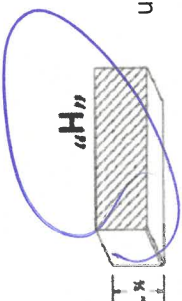

Homeowner(s) Initial J

OPTION (1) EDGE FOR KITCHEN & VANITIES \$250

Optional Edge in Kitchen

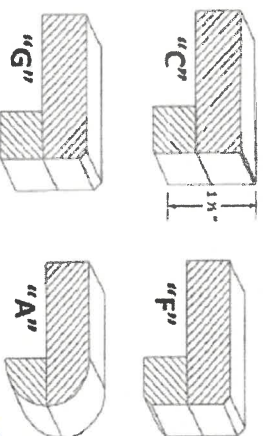

Optional Edge in Bathroom

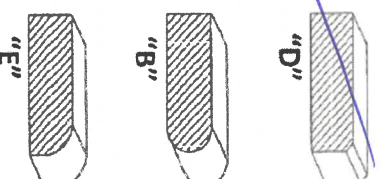

Homeowner(s) Initial

OPTION (2) EDGE FOR KITCHEN & VANITIES CUSTOM PRICING

Optional Edge for Kitchen

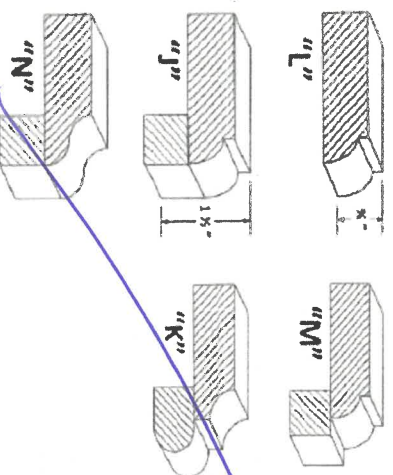

Optional Edge in Vanity

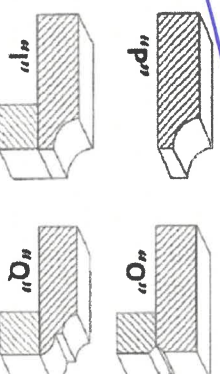

Homeowner(s) Initial

WASAGA SHORELINE

32

DATE

Aug 25/21

SITE

LOT