

CONSTRUCTION SUMMARY OF EXTRAS  
Printed 2022-02-09 / 4:34 PM / Page 1 of 2



Site: WASAGA  
Lot: 163  
Model: CORAL (60-04) ELEV. C  
Purchaser: DMITRI PROTAS  
Purchaser: KATRINA PROTAS  
Phone: 416-728-4818  
Email: KATRINA.MAC@ME.COM

DESCRIPTION		DATE SELECTED
BONUS PACKAGE: 3 PIECE STAINLESS STEEL APPLIANCES WITH WHITE TOP LOAD WASHER & DRYER	INCLUDED IN APS	
BONUS PACKAGE: STAINLESS STEEL HOOD FAN	INCLUDED IN APS	
STRUCTURALS		
1 SMOOTH CELINGS		OCT 15 2021
2 9 FEET CEILINGS IN BASEMENT		OCT 15 2021
3 TRAY CEILING IN MASTER BEDROOM		OCT 15 2021
4 COFFERED CEILING IN LIBRARY		OCT 15 2021
5 FROSTED GLASS ON FRONT DOORS		OCT 15 2021
6 10 FOOT MAIN FLOOR CEILING HEIGHT *INCLUDES 8 FOOT INTERIOR DOORS, 8 FOOT FRONT, REAR AND GARAGE MAN DOOR, TRANSOMS ABOVE WINDOWS		OCT 15 2021
7 FINISHED BASEMENT BATHROOM - WITH TUB, TOILET AND VANITY		OCT 15 2021
COLOURS		
1 FIREPLACE - 50 INCH ELECTRICAL BLF5051 (IN LIEU OF STANDARD) WITH WOOD LOG INSERT		09-Feb-22
2 FIREPLACE - WOOD LOG KIT		09-Feb-22
3 FIREPLACE - COHESION TRIM KIT FOR 50 INCH FIREPLACE		09-Feb-22
4 KITCHEN - 36 INCH TRIMMED OPENING FROM KITCHEN		09-Feb-22
5 KITCHEN - BUILT IN OVEN, MICROWAVE AND WARMING DRAWER		09-Feb-22
6 ELECTRICAL FOR BUILTIN OVEN, MICROWAVE AND WARMING DRAWER		09-Feb-22
7 KITCHEN - 30 INCH BUILT IN FRIDGE WITH MATCHING PANELS		09-Feb-22
8 KITCHEN - COOKTOP WITH POT DRAWERS BELOW		09-Feb-22
9 CUT-OUT IN COUNTERTOP FOR COOKTOP		09-Feb-22
10 KITCHEN - ADD SOFT CLOSE BASED ON STANDARD KITCHEN & BANK OF DRAWERS		09-Feb-22
11 KITCHEN - DO NOT DRILL OR INSTALL ANY HANDLES		09-Feb-22
12 KITCHEN - ADD POT DRAWERS BESIDE STOVE *RELOCATE BANK INTO THE ISLAND		09-Feb-22
13 KITCHEN - EURO CARGO (1) BIN GARBAGE PULLOUT (30 CM CABINET REQUIRED) **IN ISLAND		09-Feb-22
14 KITCHEN - CUSTOM HOOD FAN WITH BRONZE TINTED MIRROR **SIZE TO BE CONFIRMED ***HOOD FAN INSERT/LINER TO BE SUPPLIED BY PURCHASER***		09-Feb-22
15 KITCHEN - UPGRADE 1 CABINETS *INCLUDES TWO TONE & SOFT CLOSE		09-Feb-22
16 KITCHEN - STACKED UPERS **SOFT CLOSE INCLUDED		09-Feb-22
17 KITCHEN - RISER PANEL FROM UPPER CABINET TO CEILING		09-Feb-22
18 KITCHEN - HIDDEN LIGHT VALANCE (EXTENDED DOORS)		09-Feb-22
19 ELECTRICAL - LED TAPE LIGHTING - TO BE INSTALLED TIGHT TO THE VALANCE		09-Feb-22
20 KITCHEN - STONE COUNTERTOP MONT BLANC (6) **INCLUDES ADDITIONAL TOP		09-Feb-22
21 KITCHEN - EXTEND ISLAND CABINETS BY APPROX 6 FEET		09-Feb-22
22 KITCHEN - EXTEND UPPER AND LOWER CABINETS ON STOVE WALL APPROX 6 FEET		09-Feb-22
23 KITCHEN SINK - BLANCO SUPER SINGLE SILGRANITE 401482 (white) see spec		09-Feb-22
24 KITCHEN - SEE LAYOUT WITH NEW LOCATIONS OF APPLIANCES		09-Feb-22
25 TILES - UPGRADE 6 - MAIN FOYER & BASEMENT FOYER		09-Feb-22
26 TILES - MAIN BATH & MASTER FLOOR - UPGRADE 2		09-Feb-22
27 TILES - MAIN BATH & BASEMENT TUB WALL - UPGRADE 3 *BRICK PATTERN		09-Feb-22
28 TILES - MASTER BATH FLOOR - UPGRADE 2		09-Feb-22
29 TILES - MASTER ENSUITE SHOWER WALL - UPGRADE 2 **HERRINGBONE PATTERN		09-Feb-22
30 TILES - POWDER ROOM - CUSTOM MOSAIC		09-Feb-22

CONSTRUCTION SUMMARY OF EXTRAS  
Printed 2022-02-09 / 4:34 PM / Page 2 of 2

Site: WASAGA  
Lot: 163  
Model: CORAL (60-04) ELEV. C  
Purchaser: DMITRI PROTAS  
Purchaser: KATRINA PROTAS  
Phone: 416-728-4818  
Email: KATRINA.MAC@ME.COM



	DESCRIPTION	DATE SELECTED
31	COUNTERTOP - MAIN BATH & BASEMENT - UPGRADE 3	09-Feb-22
32	COUNTERTOP - MASTER BATH - UPGRADE 3	09-Feb-22
33	COUNTERTOP - BASEMENT BATH - UPGRADE 3	09-Feb-22
34	VANITY SINKS - MASTER, MAIN BATH, BASEMENT - RECTANGLE UNDERMOUNTS (4)	09-Feb-22
35	TOILETS - ONE PIECE CONTRAC CALL - ALL BATHROOMS (4)	09-Feb-22
36	COMFORT HEIGHT VANITIES IN ALL BATHROOMS (MASTER, MAIN, BASEMENT)	09-Feb-22
37	HARDWOOD - IN STANDARD AREAS LIBRARY, FAMILY ROOM, HALL - UPGRADE 4	09-Feb-22
38	HARDWOOD - IN KITCHEN / BREAKFAST IN LIEU OF TILES - UPGRADE 4	09-Feb-22
39	HARDWOOD - IN ALL BEDROOMS IN LIEU OF CARPET - UPGRADE 4	09-Feb-22
40	RAILINGS - UPGRADE 2	09-Feb-22
41	INTERIOR TRIM - UPGRADE 2	09-Feb-22
42	STAIN THE STAIRS TO MATCH THE HARDWOOD AS CLOSE AS POSSIBLE	09-Feb-22
43	KITCHEN - ADD OPENING FOR UNDER COUNTER FRIDGE	09-Feb-22
44	ELECTRICAL - FOR UNDER COUNTER FRIDGE	09-Feb-22
45	GAS LINE TO STOVE **INCLUDES 15 AMP PLUG	09-Feb-22
46	WATERLINE TO FRIDGE	09-Feb-22
47	MASTER ENSUITE SHOWER JAMB	09-Feb-22
48	MASTER ENSUITE SHOWER FLOOR	09-Feb-22
49	KITCHEN - ADD 16 INCH PANTRY WITH 5 INTERIOR PULL OUTS *LOCATION BESIDE WALL OVENS	09-Feb-22
50	KITCHEN - ADD 30 INCH PANTRY WITH 5 INTERIOR PULL OUTS BESIDE FRIDGE	09-Feb-22
51	KITCHEN - ADD POT DRAWERS IN ISLAND SOFT CLOSE	09-Feb-22
52	KITCHEN - ADD BANK OF DRAWERS BESIDE UNDERCOUNTER FRIDGE	09-Feb-22



Final Kitchen Drawing to follow



ZANCOR HOMES COLOUR CHART

ENTRANCES				
Main Foyer - FLOORING	ROMA CALCATTA 24 X 24 (6)			
Mudroom - FLOORING	LOFT WHITE 12 X 24 *STACKED			
Side Hall - FLOORING	N/A			
Basement Foyer - FLOORING	N/A			
KITCHEN				
Kitchen - FLOORING	HARDWOOD - MIRAGE WHITE OAK 5 INCH - WHITE MIST DURAMATT (4) in lieu of tile			
Breakfast - FLOORING	HARDWOOD - MIRAGE WHITE OAK 5 INCH - WHITE MIST DURAMATT (4) in lieu of tile			
Kitchen - CABINETS UPPEERS	SIERRA NARROW FRAME MDF - VANILLA MILKSHAKE (1)			
Kitchen - CABINETS LOWERS	SIERRA NARROW FRAME MDF - SAGE GREEN (1)			
Kitchen - HANDLES/KNOBS	DO NOT DRILL / DO NOT INSTALL			
Kitchen - COUNTERTOP	QUARTZITE MONT BLANC (CUSTOM) **BOOKED MATCHED			
Island - COUNTERTOP	QUARTZITE MONT BLANC (CUSTOM) **BOOKED MATCHED			
Kitchen - BACKSPLASH	DECLINED			
Kitchen - SINK	UPGRADE - BLANCO PRECIS SILGRANIT SUPER SINGLE			
Kitchen - FAUCET	STANDARD			
GREAT ROOM / DINING / LIVING / DEN / OFFICE / BASEMENT				
Family / Great Room - FLOORING	HARDWOOD - MIRAGE WHITE OAK 5 INCH - WHITE MIST DURAMATT (4)			
Main Hall - FLOORING	HARDWOOD - MIRAGE WHITE OAK 5 INCH - WHITE MIST DURAMATT (4)			
Dining / Living Room - FLOORING	HARDWOOD - MIRAGE WHITE OAK 5 INCH - WHITE MIST DURAMATT (4)			
Library / Den - FLOORING	HARDWOOD - MIRAGE WHITE OAK 5 INCH - WHITE MIST DURAMATT (4)			
Basement Rec Room - FLOORING	N/A			
STAIRS				
Railing Details - PICKETS	UPGRADE - ALL PLAIN METAL PICKETS (BLACK)			
Railing Details - POSTS	UPGRADE - SQUARE OAK WITH REVEAL			
Railing Details - HANDRAIL	UPGRADE - SQUARE OAK			
Stair Stain - MAIN STAIRS	STAIN TO MATCH HARDWOOD AS CLOSE AS POSSIBLE			
Stair Stain - BASEMENT STAIRS (if applicable)	N/A			
Stair Stain - SERVICE STAIRS (if applicable)	N/A			
POWDER ROOM				
Powder Room - FLOORING	ETERNA VOLKAS WHITE POLISHED HERRINGBONE (CUSTOM) ✓			
Powder Room - CABINETS	N/A			
Powder Room - COUNTERTOP	N/A			
Powder Room - SINK	PEDESTAL SINK			
Powder Room - FAUCET	STANDARD			
2ND FLOOR				
Hall at Bedroom area - FLOORING	HARDWOOD - MIRAGE WHITE OAK 5 INCH - WHITE MIST DURAMATT (4)			
Master Bedroom - FLOORING	HARDWOOD - MIRAGE WHITE OAK 5 INCH - WHITE MIST DURAMATT (4)			
Bedroom 2 - FLOORING	HARDWOOD - MIRAGE WHITE OAK 5 INCH - WHITE MIST DURAMATT (4)			
Bedroom 3 - FLOORING	HARDWOOD - MIRAGE WHITE OAK 5 INCH - WHITE MIST DURAMATT (4)			
Bedroom 4 - FLOORING	N/A			
Bedroom 5 - FLOORING	N/A			
Master Ensuite - FLOORING	VERNAZZO NERO 18 X 18 (2)			
Master Ensuite - SHOWER WALL	COLOURS & DIMENSIONS 4 X 16 BONE MATTE (2) **INSTALL HERRINGBONE			
Master Ensuite - SHOWER FLOOR	ONTARIO SERIES 2 X 2 SNOW MATTE (1)			
Master Ensuite - SHOWER JAMB	MARMOLINE IVORY			
Master Ensuite - CABINETS	EURO LARICE BIANCO			
Master Ensuite - HANDLES/KNOBS	DO NOT DRILL / DO NOT INSTALL			
Master Ensuite - COUNTERTOP	EMERSTONE CALCATTA GOLD (3)			
Master Ensuite - SINK(S)	RECTANGLE UNDERMOUNT	Master Ensuite - FAUCET(S)	STANDARD	
***FOR TRADE USE***				
Any upgrades in the colour chart must be accompanied with a PES. It is the responsibility of all Trades to inform the builder of any discrepancies on sketches, PES and/or colour charts <u>PRIOR</u> to installation.		WASAGA SHORELINE 163	K.P.	DP
		**PAGE 1 OF 2**	PURCHASER INITIALS	VENDOR APPROVAL



2ND FLOOR CONTINUED ...									
Main Bath - FLOORING	FLOW WHITE MATTE 12 X 24 (2) **STACKED								
Main Bath - TUB / SHOWER WALL	TAVELLA SATIN GESSO 3 X 6 *BRICKED								
Main Bath - SHOWER FLOOR	N/A								
Main Bath - SHOWER JAMB	N/A								
Main Bath - CABINETS	CONTEMPORARY OAK - BLACK STAIN								
Main Bath - HANDLES/KNOBS	DO NOT DRILL / DO NOT INSTALL								
Main Bath - COUNTERTOP	EMERSTONE PURE EXTRA (3)								
Main Bath - SINK(S)	RECTANGLE UNDERMOUNT	Main Bath - FAUCET(S)			STANDARD				
BASEMENT Bath- FLOORING	FLOW WHITE MATTE 12 X 24 (2) **STACKED								
BASEMENT Bath- TUB / SHOWER WALL	TAVELLA SATIN GESSO 3 X 6 *BRICKED								
BASEMENT Bath- SHOWER FLOOR	N/A								
BASEMENT Bath- SHOWER JAMB	N/A								
BASEMENT Bath- CABINETS	CONTEMPORARY OAK - BLACK STAIN								
BASEMENT Bath- HANDLES/KNOBS	DO NOT DRILL / DO NOT INSTALL								
BASEMENT Bath- COUNTERTOP	EMERSTONE PURE EXTRA (3)								
BASEMENT Bath- SINK(S)	RECTANGLE UNDERMOUNT	Main Bath - FAUCET(S)			STANDARD				
Ensuite Bath - FLOORING	N/A								
Ensuite Bath - TUB / SHOWER WALL	N/A								
Ensuite Bath - SHOWER FLOOR	N/A								
Ensuite Bath - SHOWER JAMB	N/A								
Ensuite Bath - CABINETS	N/A								
Ensuite Bath - HANDLES/KNOBS	N/A								
Ensuite Bath - COUNTERTOP	N/A								
Ensuite Bath - SINK(S)		Ensuite Bath - FAUCET(S)							
LAUNDRY									
Laundry - FLOORING	N/A	Laundry - HANDLES/KNOBS			N/A				
Laundry - CABINETS	N/A	Laundry - SINK			N/A				
Laundry - COUNTERTOP	N/A	Laundry - FAUCET			N/A				
Laundry - BACKSPLASH	N/A								
TRIM / PAINT									
Casing/Baseboards	CONTEMPORARY (2)								
Interior Doors	STANDARD STYLE								
Interior Door Hardware	STANDARD								
PAINT - Throughout	COOL WHITE								
FIREPLACE									
Location / Insert / Mantle	50 INCH WITH WOOD TRIM KIT & COHESION FRAME								
ACCESSORIES									
Mirrors	YES	BATH ACCESSORIES			DELETE				
APPLIANCE REQUIREMENTS									
GAS LINE TO BBQ	YES	ELECTRICAL for Built-in Oven			YES				
GAS LINE & ELECTRICAL TO STOVE	YES	ELECTRICAL for Built-in Micro			YES				
GAS LINE & ELECTRICAL TO DRYER	N/A	ELECTRICAL for Cooktop			YES				
HOOD FAN VENT SIZE	6 INCH	ELECTRICAL for Bar Fridge			YES				
WATERLINE to Fridge	YES								
DISCLAIMER									
Any changes to the colour chart after signing are subject to a \$5000 administration fee plus costs									
Purchaser has checked and acknowledged accuracy of colour and selections before signing.									
Colours of all materials are as close as possible to Builders selection but not necessarily identical due to dye lot variances in manufacturing/manufacturers. Due to construction progress some items may have been pre-selected or installed. In this event the Vendor's selection must be accepted by the purchaser									
SITE / LOT:	WASAGA				163				
PURCHASER(S):	DMITRI PROTAS								
PURCHASER(S):	KATRINA PROTAS								
CONTACT:	416-728-4818				KATRINA.MAC@ME.COM				
***FOR TRADE USE***									
Any upgrades in the colour chart must be accompanied with a PES. It is the responsibility of all Trades to inform the builder of any discrepancies on sketches, PES and/or colour charts PRIOR to installation.									
		PURCHASER SIGNATURE			 SIMONE				
		PURCHASER SIGNATURE							
		DÉCOR CONSULTANT							
**PAGE 2 OF 2**		Vendor APPROVAL							



SHORELINE POINT  
WASAGA BEACH

CORAL 60-04

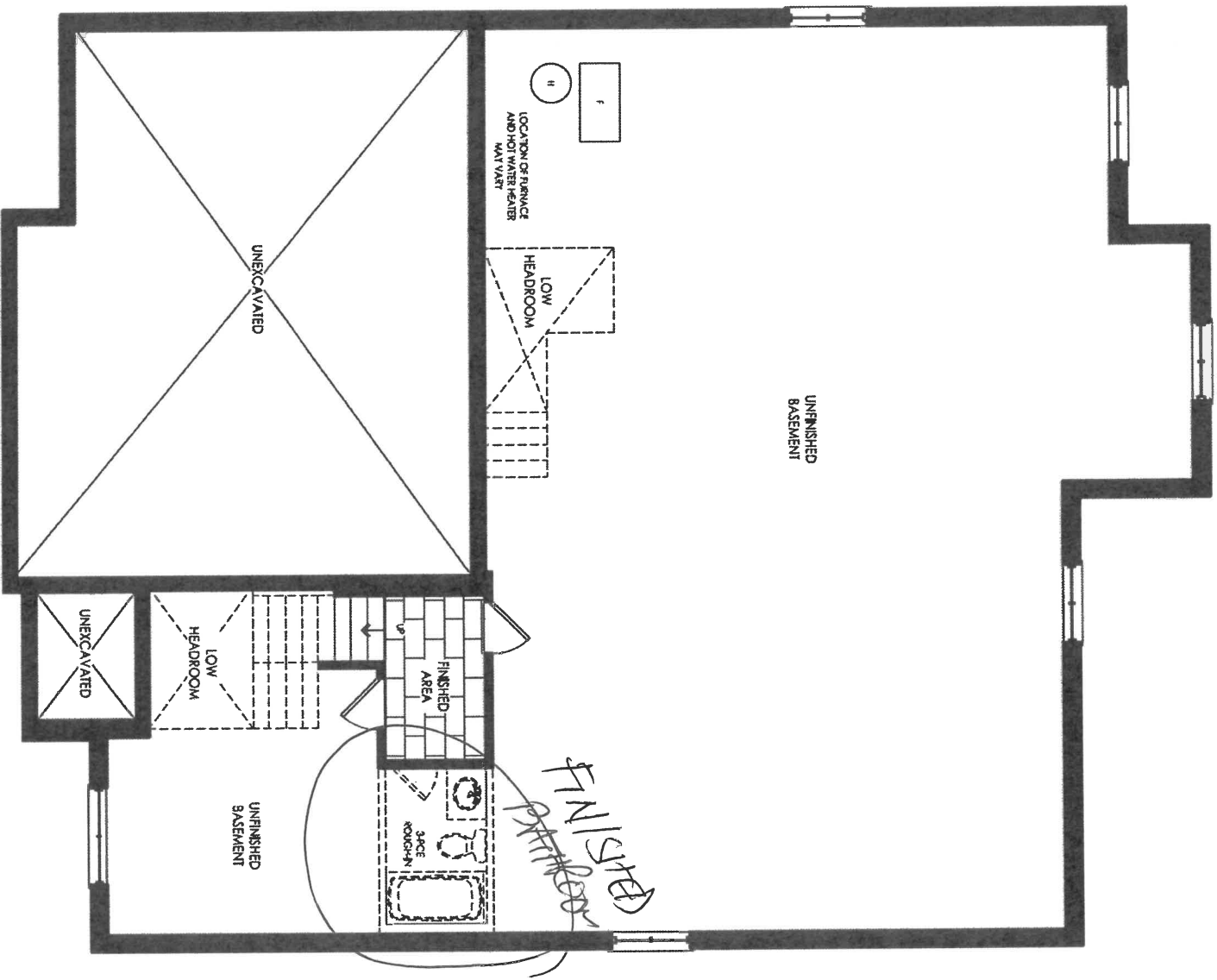

Elevation A  
Basement

163

K.P.



# SHORELINE POINT

WASAGA BEACH

## CORAL 60-04

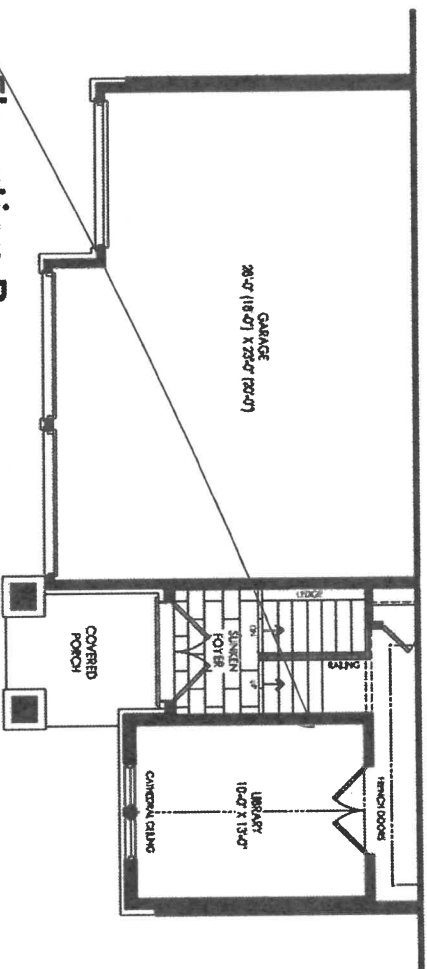

**Elevation B**  
Ground Floor

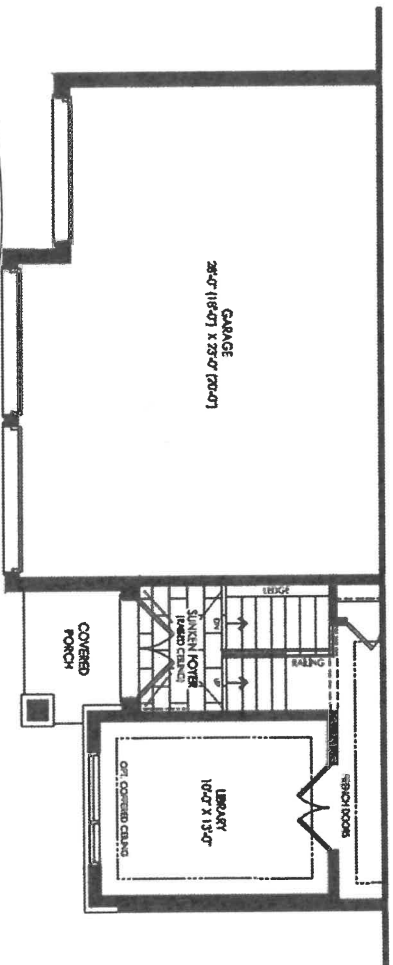

**Elevation C**  
Ground Floor

K.B.

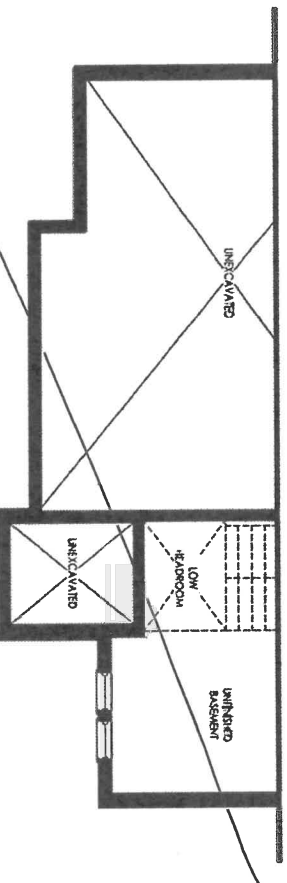

**Elevation B**  
Basement

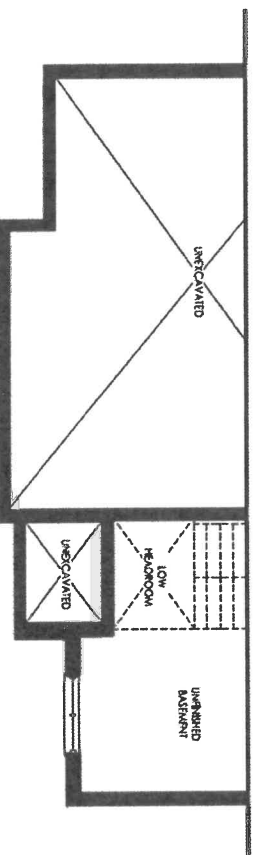

**Elevation C**  
Basement

163

SHORELINE POINT  
WASAGA BEACH

CORAL 60-04

The Coral

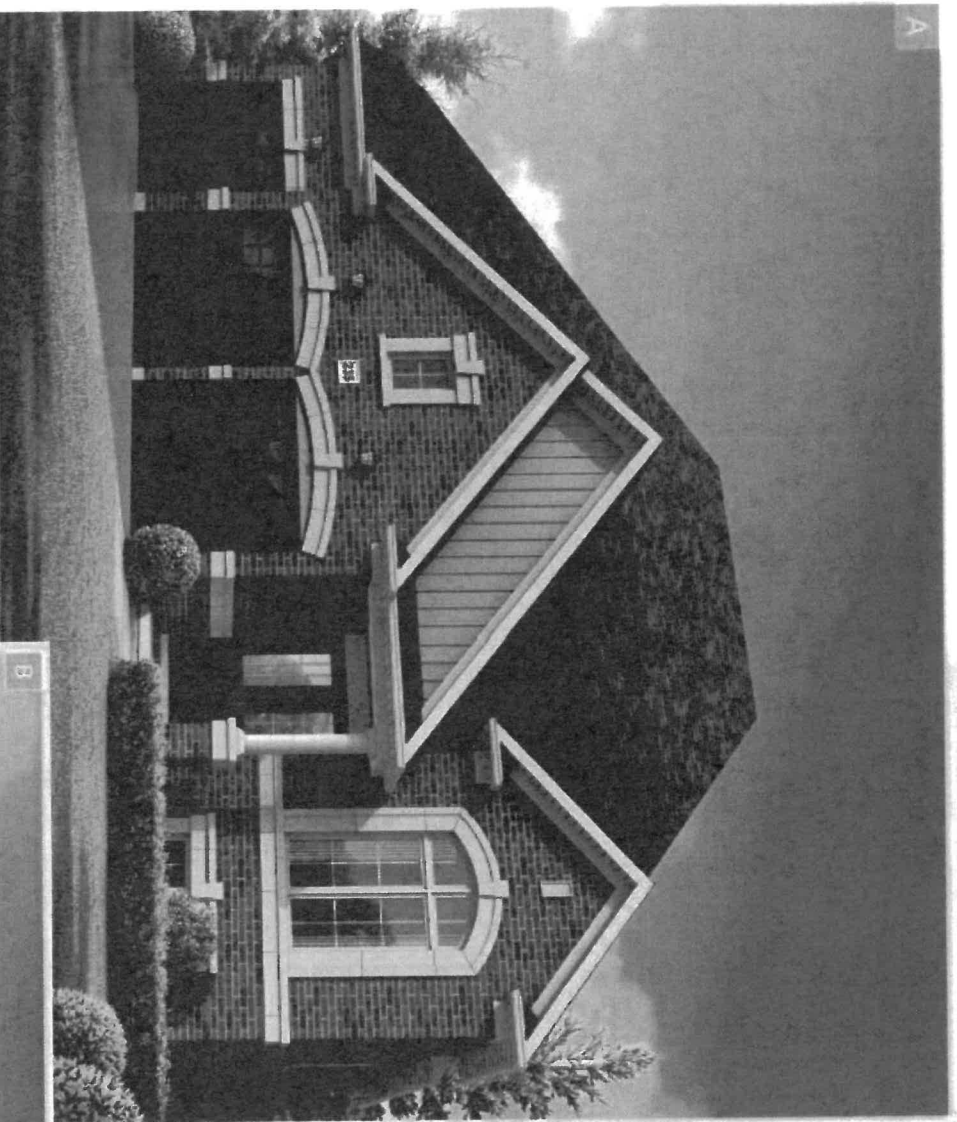

ALL ELEVATIONS INCLUDE 55 SQ. FT. OF FINISHED BASEMENT

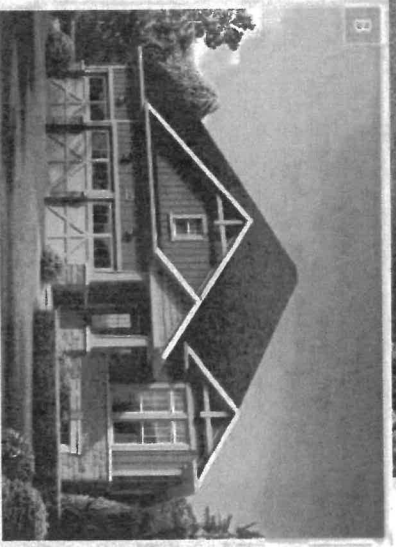

163 K.P.



ETERNA SERIES - Coloured Base Porcelain (Rectified)

VOLKAS WHITE



30 x 60 cm (12 x 24)	
Matte	OV.ET.VLK.1224.MT
Polished	OV.ET.VLK.1224.PL
60 x 60 cm (24 x 24)	
Matte	OV.ET.VLK2424.MT
Polished	OV.ET.VLK.2424.PL

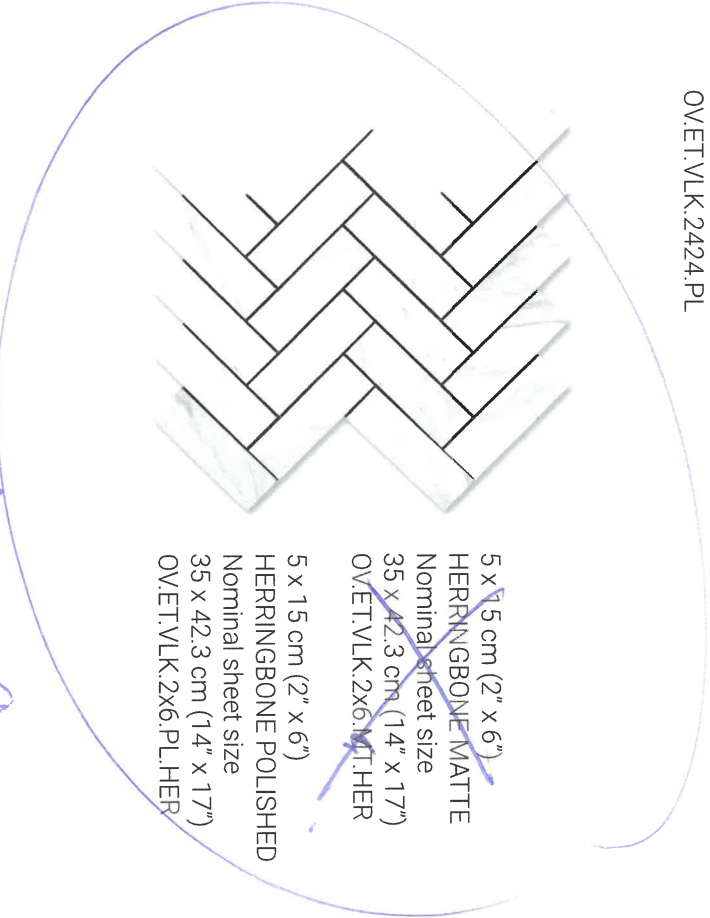

5 x 15 cm (2" x 6")  
HERRINGBONE MATTE  
Nominal sheet size  
35 x 42.3 cm (14" x 17")  
~~OV.ET.VLK.2x6.MT.HER~~  
5 x 15 cm (2" x 6")  
HERRINGBONE POLISHED  
Nominal sheet size  
35 x 42.3 cm (14" x 17")  
OV.ET.VLK.2x6.PL.HER

*Powder Room floor*

**All items shown in this document are part of Olympia's stocking program.** For special orders, please contact your Olympia Tile Sales Representative.

*163  
Wassaga  
K.*



DATE SUBMITTED

23 Mar 2021

CLIENT NAME: CANOPIES  
SHIP TO :

PH:  
CELL :

DRAFTED BY: FERNANDA  
COMMENT

P/O #

JOB NUMBER

INSTALL DATE:

PAGE

2 of 3

TRANSITIONAL

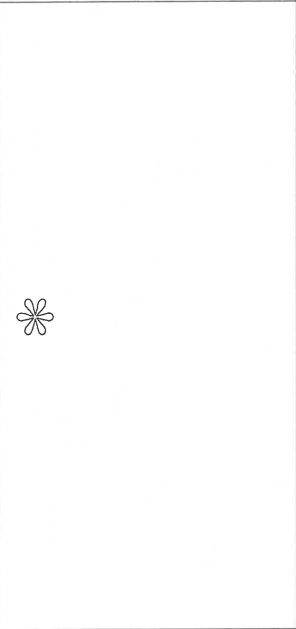

TransitionalHOOD3-900w-750h-550d

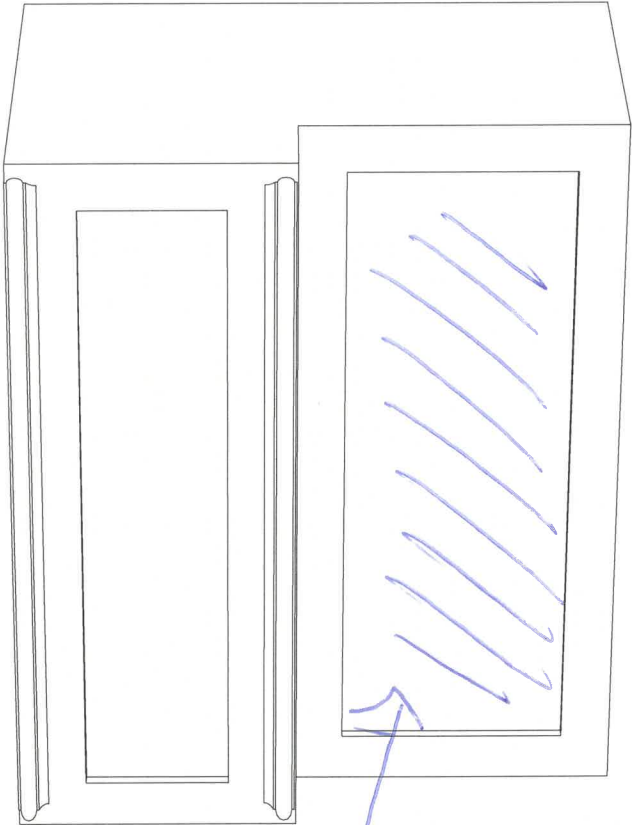
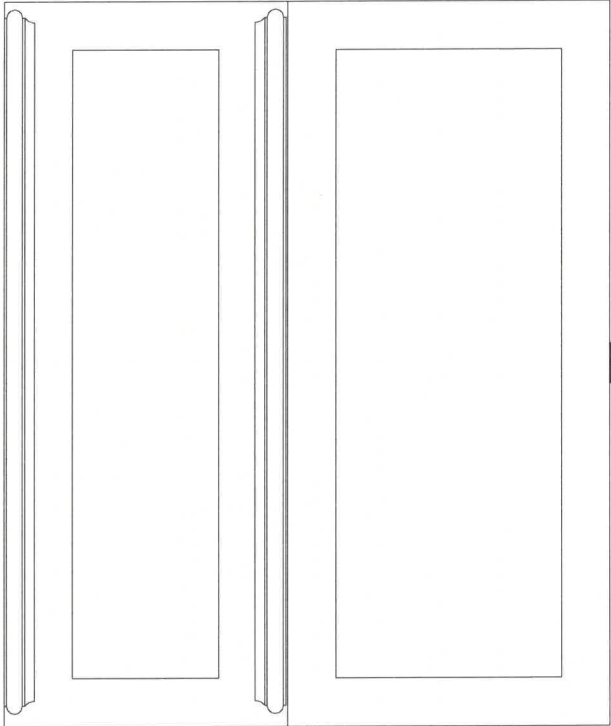

163  
38-40"

PLEASE  
TUNE  
MICHEL



## Sink Specifications

## PRECIS U SUPER SINGLE SILGRANIT

Colour	SKU
Café	400889
Anthracite	400890
Truffe	401143
Cinder	401397
Metallic Grey	401683
White	401820
Concrete Grey	402266
Coal Black	402660

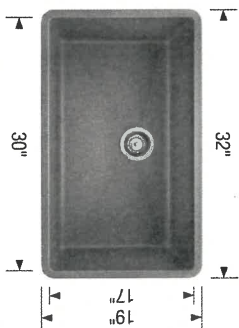

### Design and planning tips

- Min cabinet size: 36 in ( 915 mm )
- Bowl Depth: 9 1/2 in ( 240.0 mm )

#### Specifications:

Mounting clips, Sink template, Installation instructions, 3½" (90 mm) stainless steel strainer(s), Limited Lifetime Warranty

To protect from damage, this model should be shipped on a pallet.

Depending on cabinet construction, a different cabinet size may be required. Consult the cabinet manufacturer. Codes/Standards: CSA B45.8-18/ IAPMO Z403-2018

### Optional Accessories

CapFlow Strainer Cover	517666
Blancoclean Silgranit Cleaner	406200
Floating Grid	406535
Sink Grid	406446
Mechanical Pop-up Strainer	406244

### Warranty

Limited lifetime warranty on all sinks and faucets. One-year warranty on all accessories and soap dispensers.

### Code/Standards Compliance

BLANCO sinks and faucets are third-party tested and certified to CSA, cUPC, ANSI/ASME, IAPMO and NSF standards and listed by applicable certification bodies. For more information on individual product listings, contact our office or listing organization.



Need support? Learn more by watching our sink & faucet How-to videos:  
<https://www.blanco.ca/en/support/how-to-videos/how-to-videos-for-sinks/>



BLANCO Canada Inc  
100 Corporation Drive  
Brampton ON L6S 6B5

Tel & Fax  
Tel: 905-494-2400 Toll free: 1-877-425-2626  
Fax: 905-494-2425 Toll free: 1-877-825-2626

*While BLANCO strives to provide accurate information, all images and dimensions in this document are intended for reference only and are subject to change at any time without notice. This document is not intended for use as an installation guide. For technical installation details, refer to installation instructions provided with the product. BLANCO assumes no responsibility for the use of superseded or voided specifications.*



COLLETTE

21½" RECTANGULAR UNDERMOUNT SINK

☐ 4220C1Y Undermount Sink

**Product Specs:**

- Vitreous china
- Front overflow hole
- Template and mounting hardware supplied

**Overall Dimensions (W x D x H):**

(OD): 545mm(21½") x 355mm(14") x 190mm(7½")  
(ID): 485mm(19") x 295mm(11⅝") x 140mm(5½")

**Compliance Certifications:**

- Meets or exceeds the following:
- IAPMO cUPC
  - ASME A112.19.2 / CSA B45.1-2013

**Shipping:**

Cube 1.64  
GW 25 lbs



Colours To Be Specified:

Colour:

☐ Soft White

☐ Bone (055)\*

☐ Biscuit (066)\*

**Notes:**  
Dimensions of fixtures are nominal and may vary within the range of tolerances established by ASME standard A112.19.2. These measurements are subject to change or cancellation. No responsibility is assumed for use of superseded or voided pages.  
\*Bone and Biscuit available through Direct Import (CIFI) only.

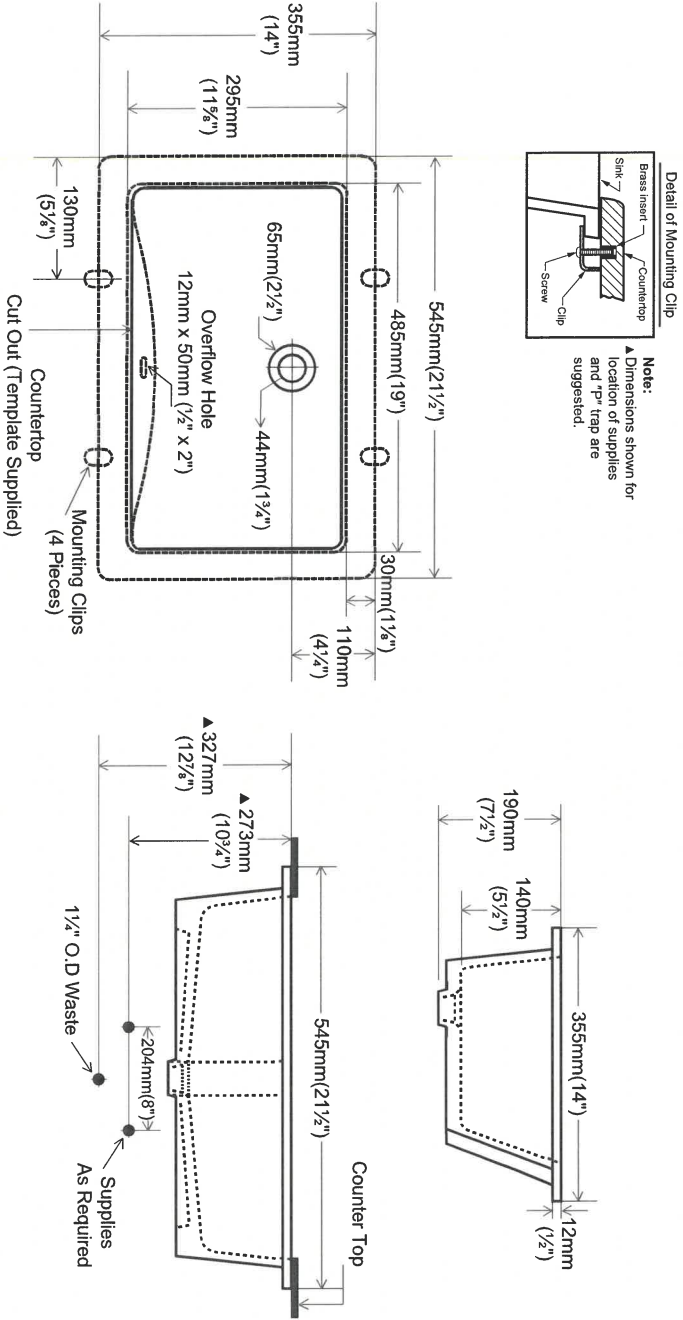

Contrac®

5970 Chedworth Way, Unit A, Mississauga, ON, Canada L5R 3V5

www.contrac.ca

Revised: January 2016

163- All bathrooms



**Prism Series**  
50" Linear Electric Fireplace

BLF5051

The best-selling linear fireplace is now even better.



The best-selling electric linear fireplace just got better with the all new Prism Series. Sparkling with intensity in a full spectrum of colors, the Prism effect illuminates the diamond-like acrylic ice ember bed in a show-stopping effect. Plug-in or hard-wire, hung on the wall or built-in; the Prism Series is beautifully versatile.

**PRISM**  
series

\* 163  
w/wood leg + cohesion trim  
kit





# Prism Series

## 50" Linear Electric Fireplace

BLF5051

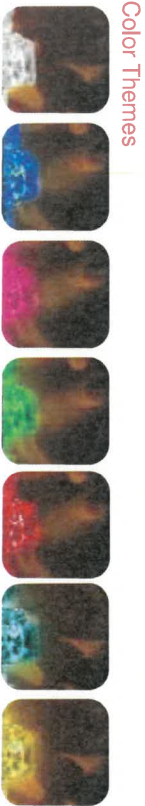
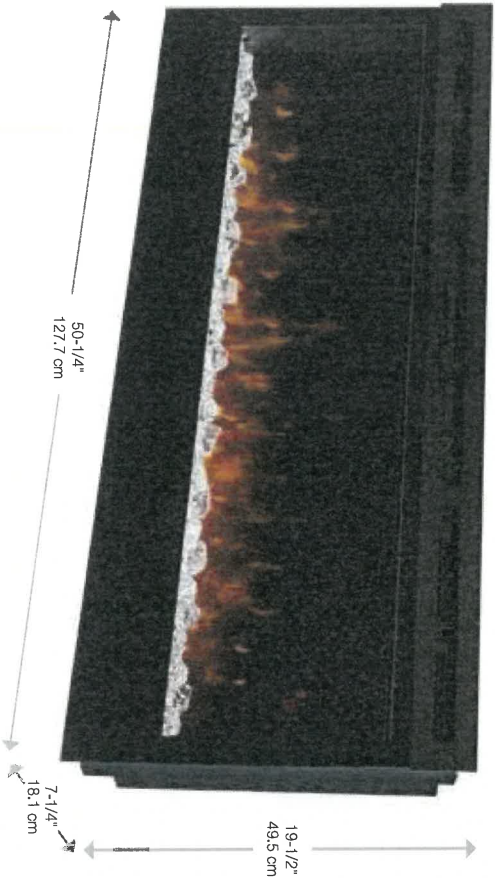

### Accessories



120 Volts   1,230 Watts   4,197 BTU									
Model #	Description	Lbs / Kg	UPC	Warranty	Carton Dimensions (WxHxD)		Cube		
				Why?	inches	cm	ft³	m³	
BLF5051	50" Linear Electric Fireplace	75 / 34.1	781052 098787	2 yr.	55 x 23-1/4 x 12-7/8	139.7 x 58.9 x 32.7	9.5	0.26	
DT1267BLK	Cohesion Trim - Black	51 / 23.1	781052 080355	1 yr.	64-7/8 x 26-1/4 x 8-3/4	164.8 x 66.8 x 22.1	8.6	0.24	
LF50DWS-KIT	50" Driftwood and River Rock Accessory Kit	7 / 3.17	781052 102842		34-1/4 x 5-7/8 x 8-1/8	87.2 x 14.98 x 20.6			

Specifications, finishes and dimensions are subject to change. \*Limited warranty. ©2020 Glen Dimplex Americas

Glen Dimplex Americas | 1-800-668-6663 | www.dimplex.com

### Features

- The Original Dimplex Flame Effect™**  
A blend of technology, artistry and craftsmanship that sets the standard for realism.
- Acrylic Ice Media Bed**  
Light plays through different size pieces and sparkle in a spectrum of colors.
- Media Accent Colors**  
Choose from a variety of brilliant color themes or cycle through a range of colors using the custom mode, freezing on the hue of your choice.
- Flexible Installation**  
Simply surface mount and plug-in or fully-recess and direct wire for a seamless installation
- Hanging Glass Design**  
Detachable glass trim easily finishes rough openings and provides access to media.
- Remote Thermostat Control**  
Temperature control at your fingertips for convenient comfort.
- Multi-function Remote**  
Control the flame, heat and thermostat from the comfort of your chair.
- LED Lighting**  
Flame and lights use brilliant, low-energy LED's that require zero maintenance.
- All-season Flames**  
Enjoy the unique charm of a fireplace 365 days a year using the flames without the heat.
- Cool-touch Glass**  
Glass remains cool making it safe for any location and any user.
- Low Carbon Footprint**  
The most sustainable fireplace option, no emissions and 100% efficient.

SE-022-R06-041520

163





# Prism Series

## 50" Linear Electric Fireplace

BLF5051

### Product Dimensions:

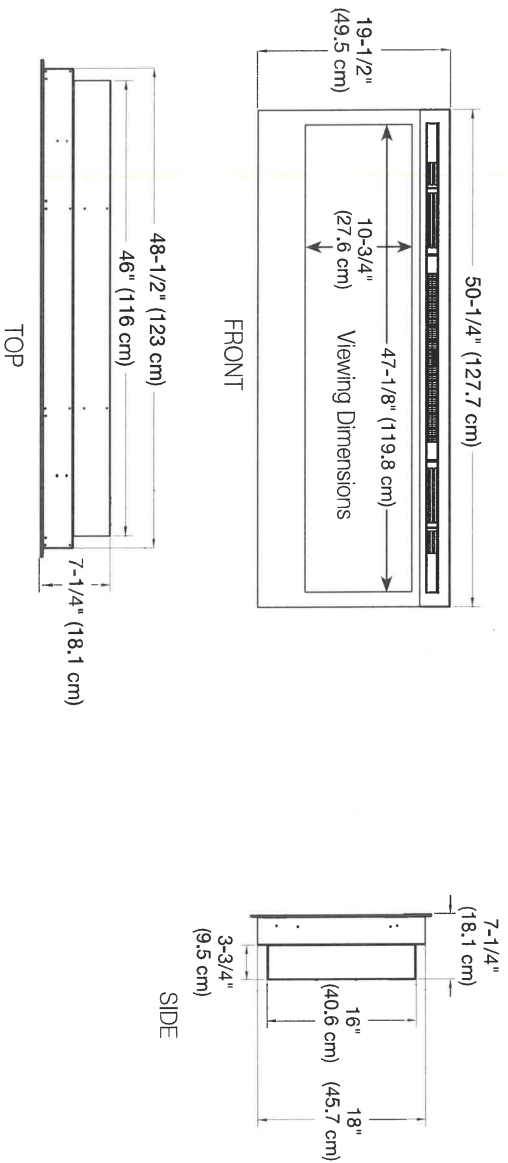

### Installation Options and Framing Dimensions

#### 3 Mounting Options

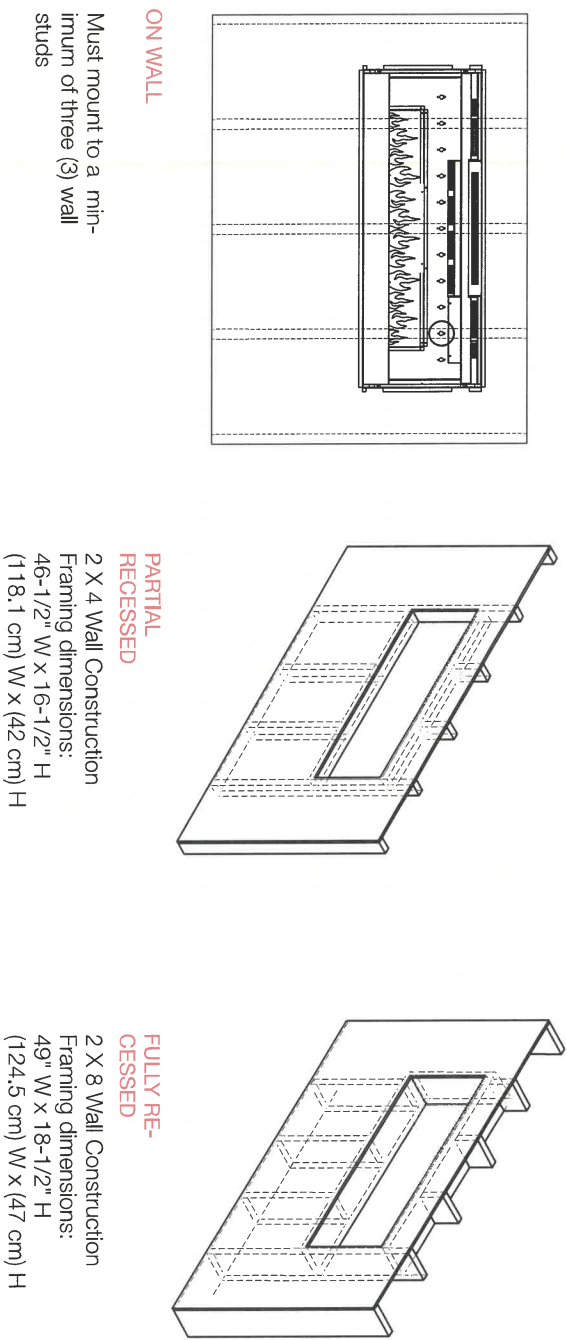

163

CAL ONE PIECE TOILET  
4.8LPF / 1.28GPF

- ☐ 4710BOV Lined Tank
- ☐ 4710BOVU Unlined Tank

- PRODUCT SPECS:**

  - High efficiency toilet
  - 4.8Lpf / 1.28Gpf
  - Elongated bowl with concealed skirted trapway
  - Vitreous china
  - 17" Plus Height for greater comfort
  - Soft white tank lever
  - 12" (305mm) Rough-in
  - 2" Fully glazed ball pass trapway
  - 3" Flapper
  - Siphon jet flush action
  - Water surface: 7<sup>3</sup>/<sub>8</sub>" x 5<sup>5</sup>/<sub>8</sub>" (198mm x 143mm)
  - Decorative soft white side caps included
  - Smooth close toilet seat included
- DIMENSIONS:**

390mm W x 725mm D x 765mm H  
15<sup>3</sup>/<sub>8</sub>" W x 28<sup>1</sup>/<sub>2</sub>" D x 30<sup>3</sup>/<sub>8</sub>" H
- COMPLIANCE CERTIFICATIONS**

Meets or exceeds the following:

  - IAPMO cUPC
  - ASME A 112.19.2 / CSA B45.1
  - ADA Guidelines & ANSI A117.1
  - LEED Compliant
  - CSA B651 barrier-free standard
  - US EPA WaterSense
  - Map Tested 1000g

- SHIPPING**
- Cube

9.39
- GW

92.5 lbs



**NOTES:** This toilet is designed to rough-in at a minimum dimension of 305mm (12") from finished wall to C/L of outlet. Supply line not included with fixture and must be ordered separately.

Important: Dimensions of fixtures are nominal and may vary within the range of tolerances established by ASME standard A112.19.2. These measurements are subject to change or cancellation. No responsibility is assumed for use of superseded or voided pages.

Product is designed to comply with ADA / ANSI A117.1 and CSA B651 Barrier-free Standard requirements, if installed according to the standard and local building codes. It is the responsibility of the installer to comply with this standard and local building codes prior to installation.

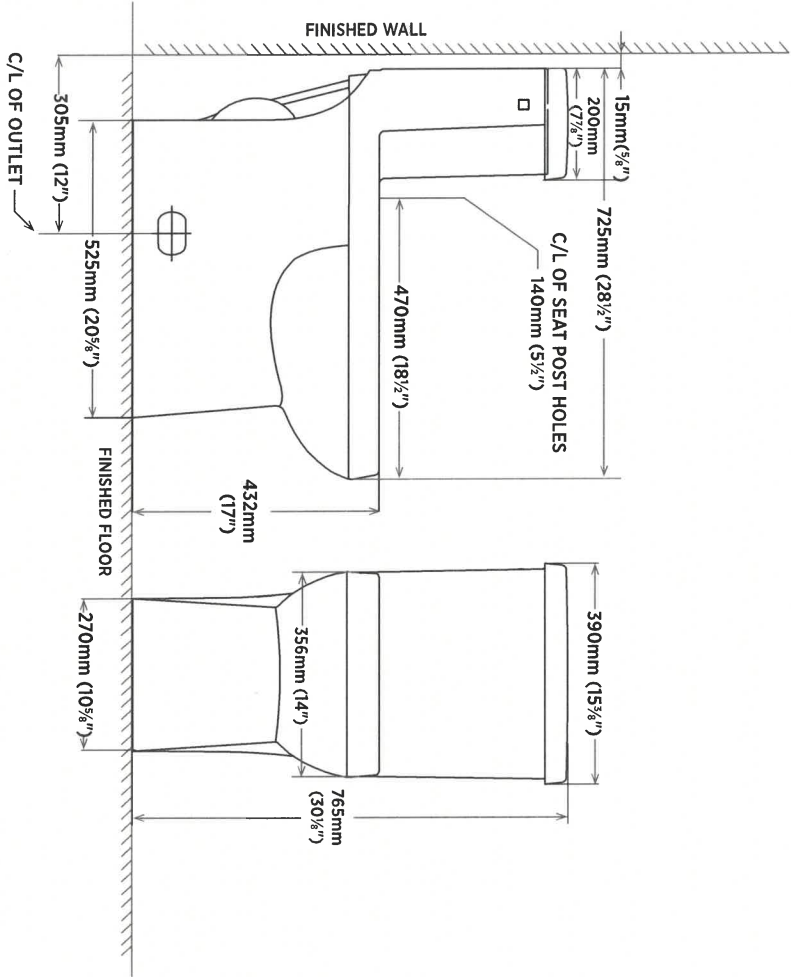

contrac

5970 CHEDWORTH WAY, UNIT B, MISSISSAUGA, ONTARIO, CANADA L5R 4G5 | CONTRAC.CA

REVISED MAY 2021

163 - All bathrooms

APPLIANCE ACKNOWLEDGEMENT

**CONTACT: Steve Miller - Appliance Canada (905) 660-2424 / smiller@appliancecanada.com**

- It is the Purchasers responsibility to coordinate delivery, installation and hook up of appliances and to ensure they are installed as per Manufacturers specifications after closing.

STANDARD APPLIANCE OPENINGS provided by Zancor:

- \*Standard appliance openings are approximate and the minimum required. Sizes may vary due to onsite condition and/or when modifications have been made to the cabinetry.
- |                      |                            |  |
|----------------------|----------------------------|--|
| ▶ Fridge Opening     | 36" x 74"                  |  |
| ▶ Stove Opening      | 30"                        | Accepts Standard<br>Openings **Initial |
| ▶ Hood Fan Opening   | 30"                        |  |
| ▶ Hood Fan & Vent    | 6" with Under Cabinet Hood |  |
| ▶ Dishwasher Opening | 24"                        |  |

OPTIONAL UPGRADED APPLIANCES to be provided by Homeowner:

- \*\*Specs/Information sheets are required and it is the responsibility of the homeowner to provide this to Zancor Homes by the due date that has been provided. If appliance specs are not submitted, Zancor Homes will not be responsible for any necessary requirements and the standard opening will be built.**

KP

- ▶ Upgraded Appliance Specs are DUE 2 WEEKS FROM SIGNED DATE OF COLOUR CHART (if not received during appointment)

INITIAL

- ▶ \*\*\*Specs that require changes/modifications after this date will not be accepted\*\*\*

- ▶ NOTE: Any upgraded appliances are to be paid by the Purchaser, directly to the appliances company.

- ▶ Additional charges to the Purchaser may apply for cabinetry, electrical and plumbing in order to accommodate the specs given by the homeowner.

FRIDGE UPGRADE

- ☐ Built-in
- ☐ Paneled \*\*Panel to match required
- ☐ Integrated / Flush Inset
- ☒ Waterline

RANGE UPGRADE

- \*Larger hood fan CFM might be required, which need a larger vent
- ☐ 36" \*\*Hood fan opening must be the same size or larger (8" vent might be required)
- ☐ 48" \*\*Hood Fan opening must be the same size or larger (8" or 10" vent required)

- ☒ Gas Range \*\*gas line and electrical required & sold separately
- ☐ Induction \*\*electrical required & sold separately
- ☐ Cooktop (Apron Front) \*\*Countertop Cut-out required & sold separately
- ☒ Cooktop (Drop-in) \*\*countertop Cut-out required & sold separately

HOOD FAN & VENT

UPGRADE

- ☐ 8 Inch \*\*Required for 600 CFM
- ☐ 10 Inch
- ☐ Chimney Hood Fan \*\*Vent must be centred
- ☐ Insert / Liner

WALL OVEN/MICRO

UPGRADE

- \*\*Electrical required

- ☒ Single Wall Oven \*\*electrical required & sold separately
- ☐ Double Wall Oven \*\*electrical required & sold separately
- ☐ Steam Oven \*\*electrical required & sold separately
- ☐ Warming Drawer \*\*electrical required & sold separately
- ☐ Over Then Range Microwave (OTR)
- ☒ Built-In Microwave \*\*Trim Kit required \*\*electrical required & sold separately

DATE

SITE

LOT

WASAGA SHORLINE

\*\* Any upgrades checked in this appliance form must be accompanied with specs provided by the Purchaser.

\*\*It is the responsibility of the trade to inform the Builder of any discrepancies with specs, sketches, extras and/or colour chart PRIOR to production/installation.

ZANCOR

221 North Rivermede Road, Concord, Ontario L4K 3N7 \* T: (905) 738.7010 F: (905) 738.5948



THE  
GALLERY

SHORELINE POINT  
WASAGA BEACH

ZANCOR

INTERIOR FINISHES ACKNOWLEDGEMENT / WAIVER

Purchaser accepts and acknowledges that the Builder reserves the right to substitute materials with those of equal or better quality where the manufacture, scheduling or delivery of materials may directly impact the Builder's ability to meet its contractual obligations under the Agreement of Purchase and Sale.

KP

**UPGRADES/EXTRAS:** All upgrades and additional selections indicated on the colour chart must be accompanied by an upgrades/extras sheet (PES) and full payment otherwise the selection will be invalid. All colour charts and upgrades/extras will not proceed until verified and signed by an authorized signing officer at the Vendor's head office. **CHANGES WILL NOT BE PERMITTED UPON COMPLETION AND SUBMISSION OF THE COLOUR CHART.**

KP

**PORCELAIN & NATURAL STONES:** Due to the properties of natural stones including but not limited to **marble, granite, quartz**, no two pieces are exactly the same. Variations in colour, tone, granularity (pitting, fissures) and pattern are to be expected, including various lighting may affect the overall finished look. Stone tops are sealed at time of installation and should never be cleaned with lemon oil or vinegar. Stones are porous materials, therefore any spilled substance require immediate attention. Stone countertops require regular seal re-application as part of home maintenance. Purchaser acknowledges colour and product variations as well as natural imperfections may exist with the selection of natural stone materials and shall not hold the Vendor liable for provision of same.

KP

**STONE COUNTERTOP JOINTS:** Purchaser is aware that one joint will be at each corner and on either side of slide-in-range (if applicable). It will also be where the length of the counter top exceeds the length of a stone slab. Slabs are usually approximately 5'x 8'.

KP

**CERAMIC TILES:** Due to manufacturing, shade (dye lots), product variations may exist that can affect the overall look of the finished product. Although every effort will be made to ensure the colours and materials selected are as close as possible to the samples, the purchaser acknowledges that the sample tiles supplied in the Design Centre may not be identical to the materials installed in the home.

KP

**STAIR STAINS:** Due to the natural properties of wood, many variables can affect the overall look of the finished product. Factors including but not limited to wood type, knotting, graining, density, age, humidity, and air temperature can result in substantial variations in stain intensity. The purchaser accepts that although the Vendor will do their best to match stain the unfinished stairs as close as possible to the pre-finished floors, it is not possible to have an identical match and that there MAY be shade differences between the two products.

KP

**CABINETRY:** Due to the natural properties of wood, slight variations apparent with cabinetry are to be expected. This includes but not limited to wood species, wood grain, colour, finish, product variations, and natural imperfections are all factors that may affect the overall look of the finished product. Such factors make exact colour matching impossible. The type and intensity of lighting in the areas of designated cabinetry placement may also highlight characteristics of cabinetry finish. All cabinets shall be finished with a white melamine interior box unless a finished interior is upgraded. Due to building specifications and/or on-site conditions, certain cabinetry upgrades may not be possible. The purchaser acknowledges that the Builder cannot guarantee the cabinetry finish or provision of certain upgrades and shall not hold the Builder liable for provision of same.

KP

**UPGRADES/EXTRAS:** All upgrades and additional selections indicated on the colour chart must be accompanied by an upgrades/extras sheet (PES) and full payment otherwise the selection will be invalid. All colour charts and upgrades/extras will not proceed until verified and signed by an authorized signing officer at the Vendor's head office. **CHANGES WILL NOT BE PERMITTED UPON COMPLETION AND SUBMISSION OF THE COLOUR CHART.**

KP

**HARDWOOD / LAMINATE FLOORING:** Due to the properties of wood and laminate, many variables can affect the overall look of the finished product. Variations include but not limited to wood type or laminate finish, colour/stain and wood grain are significant factors that make exact colour matching impossible. The purchaser acknowledges that the hardwood flooring is a pre-finished product in a controlled environment. Expansion, compression and cupping are characteristics of hardwood flooring once installed in the home. The purchaser acknowledges these may become apparent over time and despite the Builders' efforts to install the hardwood flooring materials in keeping with good workmanship, the Builder shall not be responsible nor held liable for minor variances of fluctuation in hardwood flooring materials.

KP

HARDWOOD / LAMINATE WAIVER:

I/We understand hardwood flooring is classified as a porous material and as such not recommended by the Builder in certain areas. I/We understand there is a concern due to possible water and other substances being frequently splashed or spilled onto the floor and in contravention of Ontario Building Code Section 9.30.1.2(1).

*"Finished flooring bathrooms, kitchens, public entrance halls, laundry & general storage areas shall consist of resilient flooring, felted-synthetic-fibre floor coverings, concrete, terrazzo, ceramic tile, mastic or other types of flooring providing similar degrees of water resistance.*

KP

I/We are prepared to assume full responsibility for any damage caused to the hardwood floor or subfloor due to moisture absorbency in the mentioned areas, and agree to waive any claims against the Township of residence, TARIO and/or the Builder in relation to the matter. **\*\*SEE COLOUR CHART FOR LOCATIONS\*\***

KP

DATE Feb 9/22

WASAGA SHORELINE

SITE

LOT

163

221 North Rivermede Road, Concord, Ontario L4K 3N7 \* T: (905) 738-7010 F: (905) 738-5948

## HOME AUTOMATION (Cable, CAT5/6, Telephone)

### INCLUDED IN SCHEDULE "A" IN AGREEMENT OF PURCHASE AND SALE:

- Rough-in for Central Vacuum system piped to garage
- Rough-in for Telephone (2) locations
- Rough-in for Cable TV (2) locations
- Rough-in for Cat-6 Network (3) locations

### CONTACT:

I/we the Homeowner(s) have chosen to contact the Home Automation Company to select the locations of the rough-ins for Cable, CAT5, Telephone as included in our Agreement of Purchase Sale.

I/we the Homeowner(s) will contact the trade within 4 weeks of the date of this release to select locations of the standard rough-ins review other optional products for purchase.

Trade: Smart-Tech Home Automation  
Phone: (905) 761-6469  
Email: [kris@smart-tech.ca](mailto:kris@smart-tech.ca)  
Rep: Kris  
Location: 200 Millway Avenue, Unit 8  
Concord, Ont L4K 5K8

### ACKNOWLEDGEMENT:

I/We the homeowner(s) acknowledge that if I/We the homeowners decide to not contact Smart-Tech, locations of the standard rough-ins will be installed as per Vendors discretion.

KP.  
Homeowner(s) Initial

Feb 9/22

**WASAGA SHORELINE**

163

DATE

SITE

LOT



Stone Countertop Edge Profiles

\*\*Where applicable as per site specifications\*\*

STANDARD EDGE FOR KITCHEN & VANITIES

Standard Countertop Edge in Kitchen

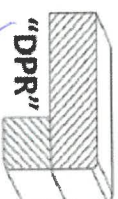

Standard Countertop Edge in Vanity

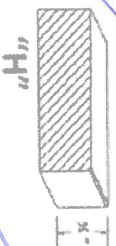

K.P.

Homeowner(s) Initial

OPTION (1) EDGE FOR KITCHEN & VANITIES \$250

Optional Edge in Kitchen

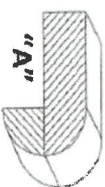
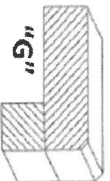
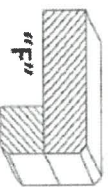
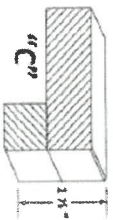

Optional Edge in Bathroom

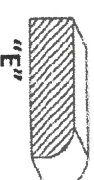
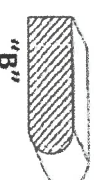

Homeowner(s) Initial

OPTION (2) EDGE FOR KITCHEN & VANITIES CUSTOM PRICING

Optional Edge for Kitchen

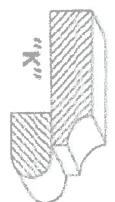
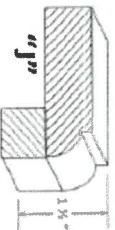
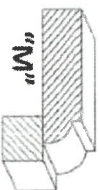
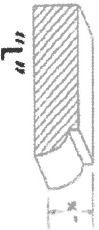

Optional Edge in Vanity

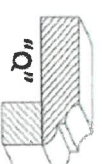
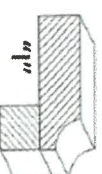
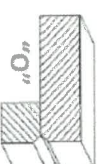
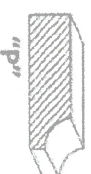

Homeowner(s) Initial

DATE

Feb 9/22

SITE

WASAGA SHORELINE

LOT

163