

CONSTRUCTION SUMMARY OF EXTRAS  
Printed 2022-01-25 / 2:32 PM / Page 1 of 1

Site: CALEDON (B)  
Lot: 178-2  
Model: ROSEDALE (RLTH-01) ELEV B  
Purchaser: Navjot Singh  
Purchaser: 0  
Phone: 647-449-0505  
Email: navjotkooner@live.com





| DESCRIPTION  |  | DATE SELECTED   |
|--|--|-----------------|
| BONUS PACKAGE: 3 PIECE STAINLESS STEEL APPLIANCES WITH WHITE WASHER & DRYER                            |  | INCLUDED IN APS |
| BONUS PACKAGE: STAINLESS STEEL HOOD FAN  |  | INCLUDED IN APS |
| BONUS PACKAGE: AIR CONDITIONER   |  | AS PER SCH E    |
|  |  |                 |
| COLOURS  |  |                 |
| 1 ADD PLUG ABOVE FIREPLACE INSTALL APPROX 65" FROM FLOOR   |  | 20-Jan-22       |
| 2 BATHROOM ACCESSORIES POWDER ROOM (2) PAPER HOLDERS YB2408 AND (2) TOWEL BAR YB 2418                  |  | 20-Jan-22       |
| 3 BATHROOM ACCESSORIES MASTER ENSUITE AND MAIN BATH (2) PAPER HOLDERS YB2408 AND (2) TOWEL BAR YB 2424 |  | 20-Jan-22       |
| 4 WATERLINE TO FRIDGE  |  | 20-Jan-22       |
| 5 HARD WOOD UP # 1 GREAT ROOM, LANDINGS, REC ROOM, HALL AND UPPER HALL                                 |  | 20-Jan-22       |

ZANCOR HOMES COLOUR CHART

| ENTRANCES   |  |                            |                 |   |
|---|--|----------------------------|-----------------|---|
| Main Foyer - FLOORING   | NEW BYZANTINE ASSURO BLUE 12 X 24 INSTALL BRICK PATTERN                |                            |                 |   |
| Mudroom - FLOORING  | NA   |                            |                 |   |
| Side Hall - FLOORING  | NA   |                            |                 |   |
| Basement Foyer - FLOORING   | NA   |                            |                 |   |
| KITCHEN   |  |                            |                 |   |
| Kitchen - FLOORING  | NEW BYZANTINE ASSURO BLUE 12 X 24 INSTALL BRICK PATTERN                |                            |                 |   |
| Breakfast - FLOORING  | NEW BYZANTINE ASSURO BLUE 12 X 24 INSTALL BRICK PATTERN                |                            |                 |   |
| Kitchen - CABINETS  | EURO STORM   |                            |                 |   |
| Island - CABINETS   | EURO STORM   |                            |                 |   |
| Servery - CABINETS  | NA   |                            |                 |   |
| Kitchen - HANDLES/KNOBS   | H-800-BC   |                            |                 |   |
| Kitchen - COUNTERTOP  | BIANCO SARDO GRANITE   |                            |                 |   |
| Island - COUNTERTOP   | BIANCO SARDO GRANITE   |                            |                 |   |
| Kitchen - BACKSPLASH  | DECLINED   |                            |                 |   |
| Kitchen - SINK  | STANDARD   |                            |                 |   |
| Kitchen - FAUCET  | STANDARD   |                            |                 |   |
| GREAT ROOM / DINING / LIVING / DEN / OFFICE / BASEMENT  |  |                            |                 |   |
| Family / Great Room - FLOORING  | KENTWOOD OAK STURGEON 3 1/2" X 3/4" UP # 1                             |                            |                 |   |
| Main Hall - FLOORING  | NA   |                            |                 |   |
| Dining / Living Room - FLOORING   | NA   |                            |                 |   |
| Library / Den - FLOORING  | NA   |                            |                 |   |
| Basement Rec Room -/Hall FLOORING   | KENTWOOD OAK STURGEON 3 1/2" X 3/4" UP # 1                             |                            |                 |   |
| STAIRS  |  |                            |                 |   |
| Railing Details - PICKETS   | METAL BLACK SINGLE COLLAR WITH ALT PLAIN                               |                            |                 |   |
| Railing Details - POSTS   | 2 3/4 " TURNED OAK POST  |                            |                 |   |
| Railing Details - HANDRAIL  | 2 1/2" OVAL OAK HANDRAIL   |                            |                 |   |
| Stair Stain - MAIN STAIRS   | STAIN TO MATCH HARDWOOD AS CLOSE AS POSSIBLE                           |                            |                 |   |
| Stair Stain - BASEMENT STAIRS (if applicable)   | NA   |                            |                 |   |
| Stair Stain - SERVICE STAIRS (if applicable)  | NA   |                            |                 |   |
| POWDER ROOM   |  |                            |                 |   |
| Powder Room - FLOORINGGR & 2ND FLOOR  | NEW BYZANTINE ASSURO BLUE 12 X 24 INSTALL BRICK PATTERN                |                            |                 |   |
| Powder Room - CABINETS GR & 2ND FLOOR   | EURO STORM   |                            |                 |   |
| Powder Room - COUNTERTOP GR & 2ND FLOOR   | BIANCO SARDO GRANITE   |                            |                 |   |
| Powder Room - SINK GR & 2ND FLOOR   | OVAL UNDERMOUNT 4220 CFY   |                            |                 |   |
| Powder Room - FAUCET GR &2ND FLOOR  | STANDARD   |                            |                 |   |
| 2ND FLOOR   |  |                            |                 |   |
| Upper Hall - FLOORING   | KENTWOOD OAK STURGEON 3 1/2" X 3/4" UP # 1                             |                            |                 |   |
| Master Bedroom - FLOORING   | OPENING NIGHT T-03   |                            |                 |   |
| Bedroom 2 - FLOORING  | OPENING NIGHT T-03   |                            |                 |   |
| Bedroom 3 - FLOORING  | OPENING NIGHT T-03   |                            |                 |   |
| Bedroom 4 - FLOORING  | NA   |                            |                 |   |
| Bedroom 5 - FLOORING  | NA   |                            |                 |   |
| Master Ensuite - FLOORING   | NEW BYZANTINE PENTELLIC ASSURO BLUE 12 X 24 INSTALL STACKED            |                            |                 |   |
| Master Ensuite - SHOWER WALL  | NEW BYZANTINE PENTELLIC ASSURO BLUE 12 X 24 INSTALL HORIZONTAL STACKED |                            |                 |   |
| Master Ensuite - SHOWER FLOOR   | 2 X 2 WHITE  |                            |                 |   |
| Master Ensuite - SHOWER JAMB  | BIANCA CARRERRA  |                            |                 |   |
| Master Ensuite - CABINETS   | EURO STORM   |                            |                 |   |
| Master Ensuite - HANDLES/KNOBS  | H-800-BC   |                            |                 |   |
| Master Ensuite - COUNTERTOP   | BIANCO SARDO GRANITE   |                            |                 |   |
| Master Ensuite - SINK(s)  | OVAL 4220 CFY  | Master Ensuite - FAUCET(s) | STANDARD        |   |
| ***FOR TRADE USE***   |  |                            |                 |   |
| Any upgrades in the colour chart must be accompanied with a PES. It is the responsibility of all Trades to inform the builder of any discrepancies on sketches, PES and/or colour charts PRIOR to installation. |  | CALEDON 178-2              | NS              |  |
|   |  | PURCHASER INITIALS         | VENDOR APPROVAL |   |

JAN 21 2012

| 2ND FLOOR CONTINUED...   |  |                     |                  |   |                               |                   |          |             |  |
|--|--|---------------------|------------------|---|-------------------------------|-------------------|----------|-------------|--|
| Main Bath - FLOORING   | NEW BYZANTINE PENTELLIC ASSURO BLUE 12 X 24 INSTALL STACKED            |                     |                  |   | ✓                             |                   |          |             |  |
| Main Bath - TUB / SHOWER WALL  | NEW BYZANTINE PENTELLIC ASSURO BLUE 12 X 24 INSTALL HORIZONTAL STACKED |                     |                  |   | ✓                             |                   |          |             |  |
| Main Bath - SHOWER FLOOR   |  |                     |                  |   | NA                            |                   |          |             |  |
| Main Bath - SHOWER JAMB  |  |                     |                  |   | NA                            |                   |          |             |  |
| Main Bath - CABINETS   |  |                     |                  |   | EURO STORM                    |                   |          |             |  |
| Main Bath - HANDLES/KNOB   |  |                     |                  |   | H-800-BC                      |                   |          |             |  |
| Main Bath - COUNTERTOP   |  |                     |                  |   | GASPE GREY P282CA ✓           |                   |          |             |  |
| Main Bath - SINK(s)  | STANDARD   |                     |                  |   | Main Bath - FAUCET(s)         |                   | STANDARD |             |  |
|  |  |                     |                  |   |                               |                   |          |             |  |
| Shared Bath - FLOORING   |  |                     |                  |   | NA                            |                   |          |             |  |
| Shared Bath - TUB / SHOWER WALL  |  |                     |                  |   | NA                            |                   |          |             |  |
| Shared Bath - SHOWER FLOOR   |  |                     |                  |   | NA                            |                   |          |             |  |
| Shared Bath - SHOWER JAMB  |  |                     |                  |   | NA                            |                   |          |             |  |
| Shared Bath - CABINETS   |  |                     |                  |   | NA                            |                   |          |             |  |
| Shared Bath - HANDLES/KNOB   |  |                     |                  |   | NA                            |                   |          |             |  |
| Shared Bath - COUNTERTOP   |  |                     |                  |   | NA                            |                   |          |             |  |
| Shared Bath - SINK(s)  |  |                     |                  |   | Shared Bath - FAUCET(s)       |                   |          |             |  |
|  |  |                     |                  |   |                               |                   |          |             |  |
| Ensuite Bath - FLOORING  |  |                     |                  |   | NA                            |                   |          |             |  |
| Ensuite Bath - TUB / SHOWER WALL   |  |                     |                  |   | NA                            |                   |          |             |  |
| Ensuite Bath - SHOWER FLOOR  |  |                     |                  |   | N                             |                   |          |             |  |
| Ensuite Bath - SHOWER JAMB   |  |                     |                  |   | N                             |                   |          |             |  |
| Ensuite Bath - CABINETS  |  |                     |                  |   | N                             |                   |          |             |  |
| Ensuite Bath - HANDLES/KNOB  |  |                     |                  |   | N                             |                   |          |             |  |
| Ensuite Bath - COUNTERTOP  |  |                     |                  |   |                               |                   |          |             |  |
| Ensuite Bath - SINK(s)   |  |                     |                  |   | Ensuite Bath - FAUCET(s)      |                   |          |             |  |
|  |  |                     |                  |   |                               |                   |          |             |  |
| LAUNDRY  |  |                     |                  |   |                               |                   |          |             |  |
| Laundry - FLOORING   | NEW BYZANTINE ASSURO BLUE 12 X 24 INSTALL BRICK PATTERN                |                     |                  |   | ✓                             |                   |          |             |  |
| Laundry - CABINETS   | EURO STORM   |                     |                  |   | Laundry - HANDLES/KNOB        |                   | H-800-BC |             |  |
| Laundry - COUNTERTOP   | GASPE GREY P 282CA   |                     |                  |   | Laundry - SINK                |                   | STANDARD |             |  |
| Laundry - BACKSPLASH   | NA   |                     |                  |   | Laundry - FAUCET              |                   | STANDARD |             |  |
| TRIM / PAINT   |  |                     |                  |   |                               |                   |          |             |  |
| Casing/Baseboards  |  |                     |                  |   | STANDARD                      |                   |          |             |  |
| Interior Doors   |  |                     |                  |   | STANDARD                      |                   |          |             |  |
| Interior Door Hardware   |  |                     |                  |   | STANDARD                      |                   |          |             |  |
| PAINT - Throughout   |  |                     |                  |   | WARM GREY                     |                   |          |             |  |
| FIREPLACE  |  |                     |                  |   |                               |                   |          |             |  |
| Location / Insert / Mantle   |  |                     |                  |   | STANDARD 34" ELELCTRIC        |                   |          |             |  |
| ACCESSORIES  |  |                     |                  |   |                               |                   |          |             |  |
| Mirrors  | STANDARD   |                     | BATH ACCESSORIES |   | UPGRADE                       |                   |          |             |  |
| APPLIANCE REQUIREMENTS   |  |                     |                  |   |                               |                   |          |             |  |
| GAS LINE TO BBQ  | STANDARD   |                     |                  |   | ELECTRICAL for Built-in Oven  |                   | DECLINED |             |  |
| GAS LINE & ELECTRICAL TO STOVE   | DECLINED   |                     |                  |   | ELECTRICAL for Built-in Micro |                   | DECLINED |             |  |
| GAS LINE & ELECTRICAL TO DRYER   | DECLINED   |                     |                  |   | ELECTRICAL for Cooktop        |                   | DECLINED |             |  |
| HOOD FAN VENT SIZE   | 6" STANDARD  |                     | ✓                |   | ELECTRICAL for Bar Fridge     |                   | DECLINED |             |  |
| WATERLINE to Fridge  | UPGRADE  |                     | ✓                |   |                               |                   |          |             |  |
| DISCLAIMER   |  |                     |                  |   |                               |                   |          |             |  |
| Any charges to the colour chart after signing are subject to a <b>\$5000</b> administration fee plus costs   |  |                     |                  |   |                               |                   |          |             |  |
| Purchaser has checked and acknowledged accuracy of colour and selections before signing.   |  |                     |                  |   |                               |                   |          |             |  |
| Colours of all materials are as close as possible to Builders selection but not necessarily identical due to dye lot variances in manufacturing/manufacturers. Due to construction progress some items may have been pre-selected or installed. In this event the Vendor's selection must be accepted by the purchaser |  |                     |                  |   |                               |                   |          |             |  |
| SITE / LOT:  | CALEDON (B)  |                     |                  |   | 178-2                         |                   | ✓        |             |  |
| PURCHASER(S):  | Navjot Singh   |                     |                  |   |                               |                   |          |             |  |
| PURCHASER(S):  | 0  |                     |                  |   |                               |                   |          |             |  |
| CONTACT:   | 647-449-0505   |                     |                  |   | navjotkooner@live.com         |                   |          |             |  |
| ***FOR TRADE USE***  |  |                     |                  |   |                               |                   |          |             |  |
| Any upgrades in the colour chart must be accompanied with a PES. It is the responsibility of all Trades to inform the builder of any discrepancies on sketches, PES and/or colour charts PRIOR to installation.  |  |                     |                  |   |                               |                   |          |             |  |
|   |  | PURCHASER SIGNATURE |                  |  |                               | SIGNATURES / DATE |          |             |  |
|  |  | PURCHASER SIGNATURE |                  |   |                               |                   |          |             |  |
|  |  | DÉCOR CONSULTANT    |                  |   |                               |                   |          |             |  |
|  |  | Vendor APPROVAL     |                  |   |                               |                   |          | KATHERINE   |  |
|  |  |                     |                  |   |                               |                   |          | JAN 24 2022 |  |
|  |  | **PAGE 2 OF 2**     |                  |   |                               |                   |          |             |  |

Lot 118-2

Jan 20/22

# ROSEDALE RLTH-01

ADD 249  
ABOVE  
FP  
APRX  
65"  
FRAM  
FLOOR

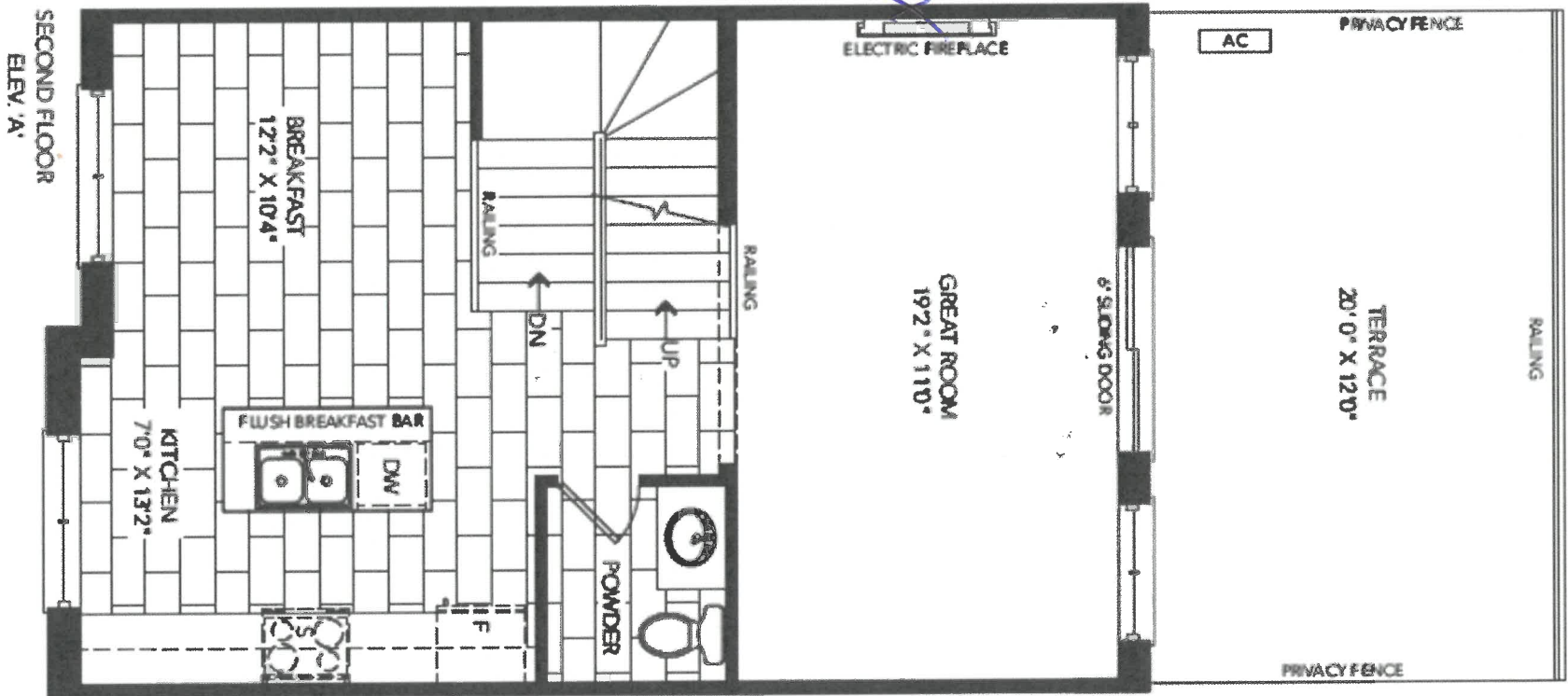

25

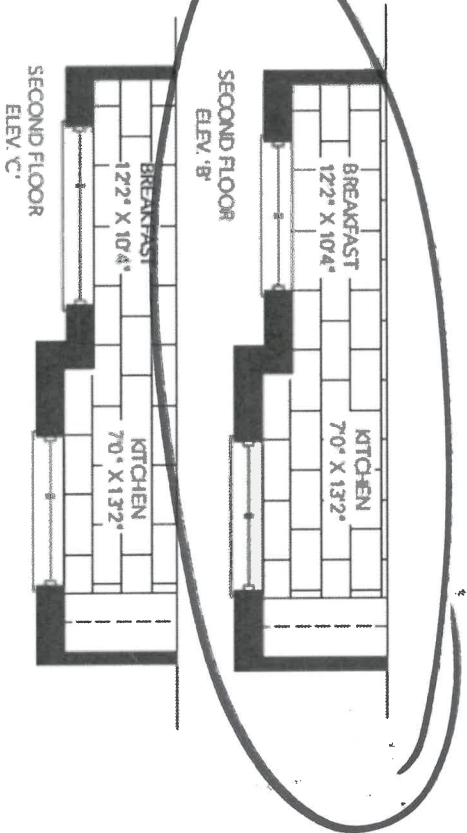

118-2



L01122-2  
Jan 20/22

# ROSEDALE RLTH-01

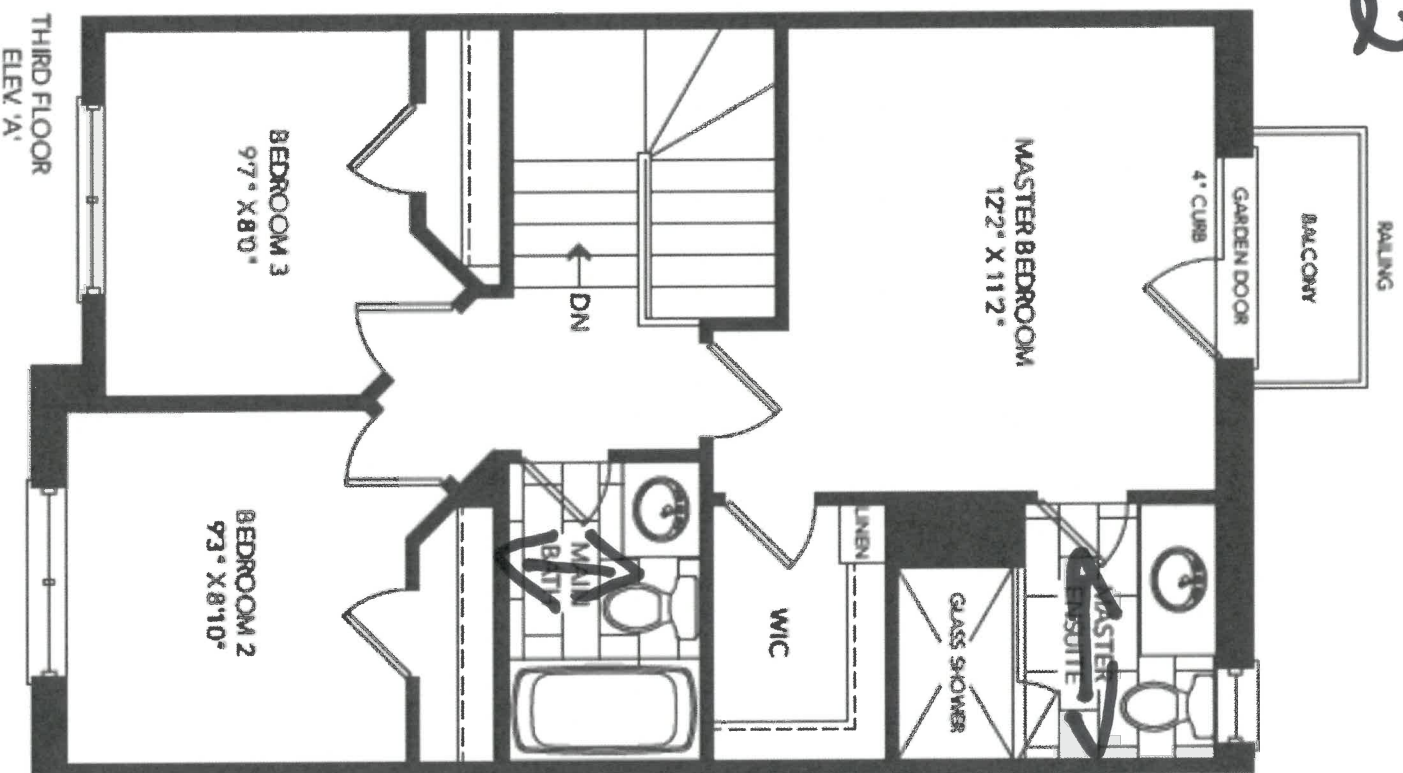

N

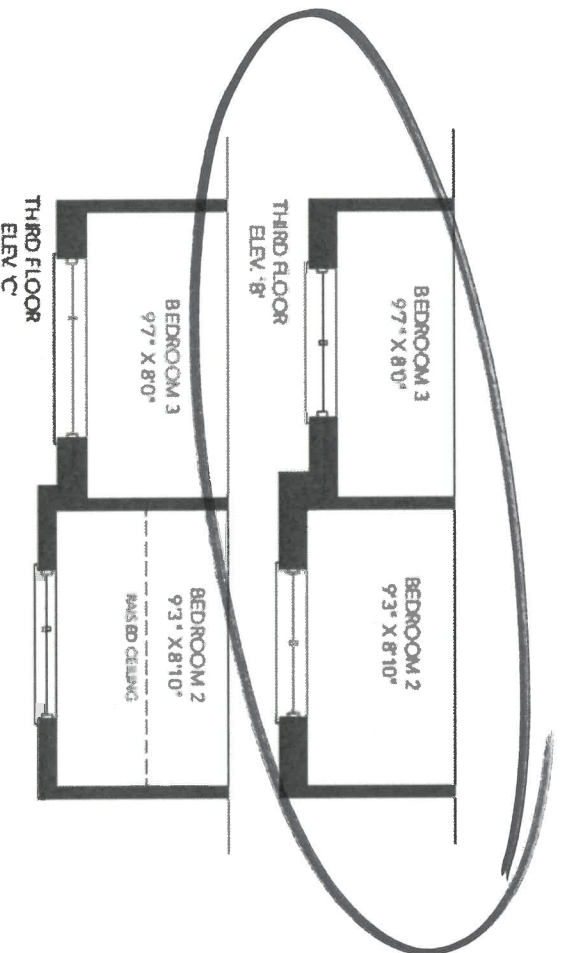

Tile  
Direction

178-2

CLIENT NAME: ZANCOR HOMES  
SHIP TO : CALEDON CLUB

PH:  
CELL:

DRAFTED BY: FERNANDA  
COMMENT

P/O #

JOB NUMBER

INSTALL DATE:

PAGE

1 of 12

RLTH-01-ELEV. A, B, C  
KITCHEN

*Lot 178-2  
per notes*

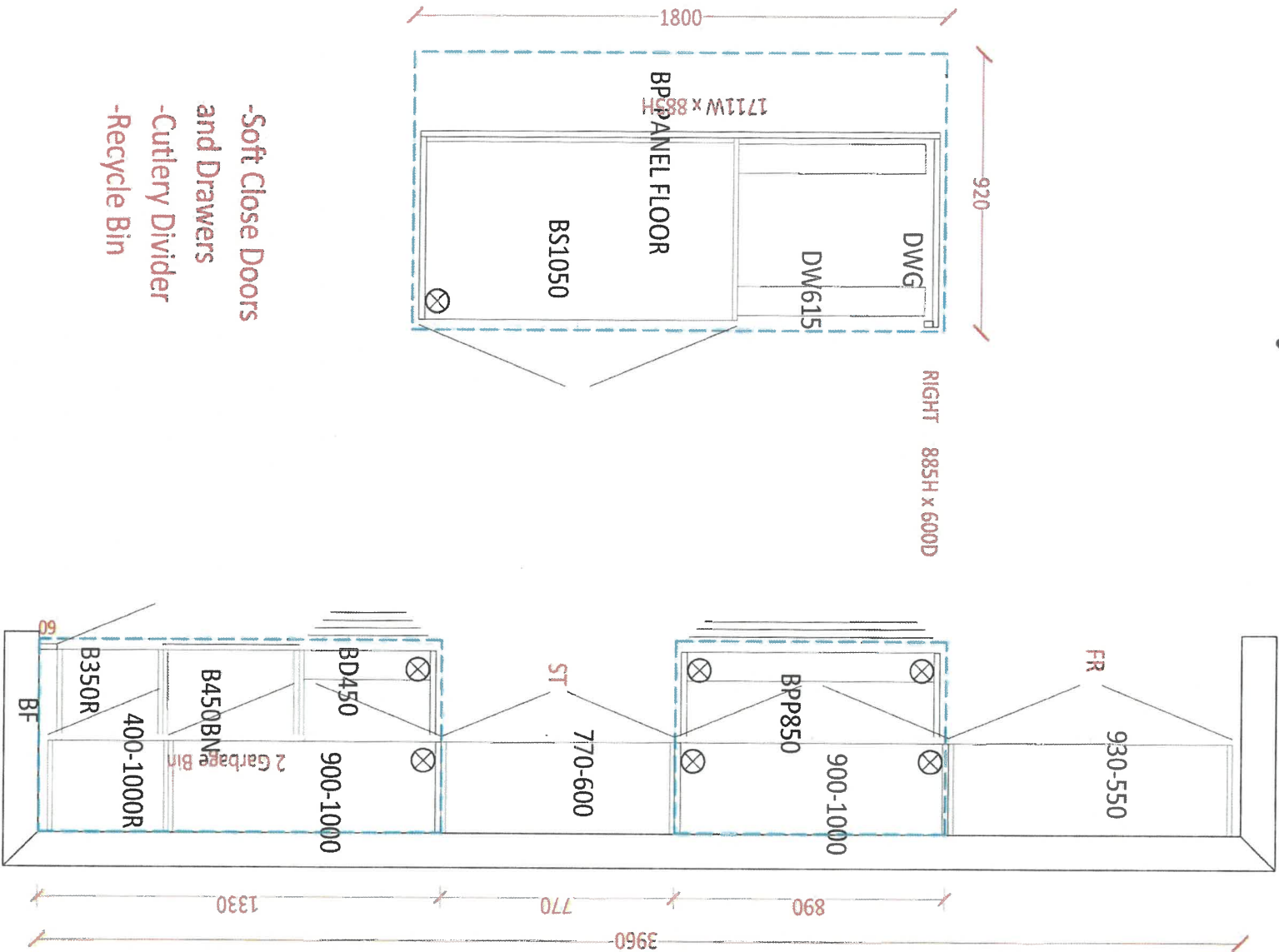

- Soft Close Doors and Drawers
- Cutlery Divider
- Recycle Bin

*ms  
178-2*

CLIENT NAME: ZANCOR HOMES  
SHIP TO : CALEDON CLUB

PH:  
CELL :

DATE SUBMITTED  
10 Mar 2021

DRAFTED BY: FERNANDA  
COMMENT

P/O #

JOB NUMBER

INSTALL DATE:

PAGE  
2 of 12

RLTH-01-ELEV. A, B, C  
STD. VANITIES

*Lo117822  
Jan20/22*

POWDER

MAIN

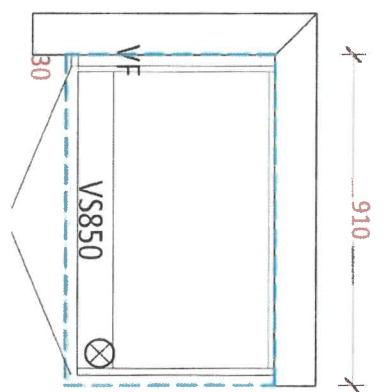
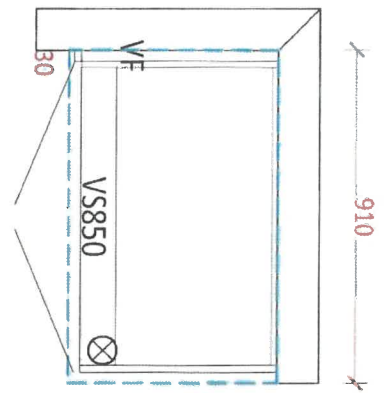

MASTER ENSUITE

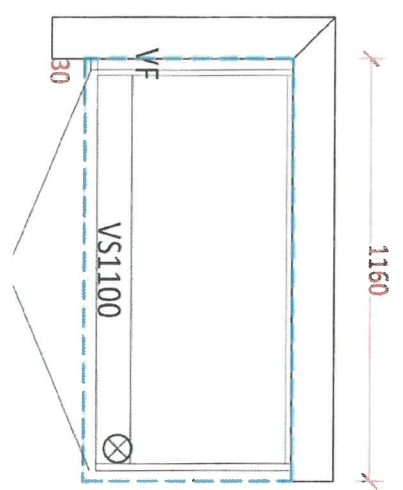

*ALL  
STANDARD*

LAUNDRY

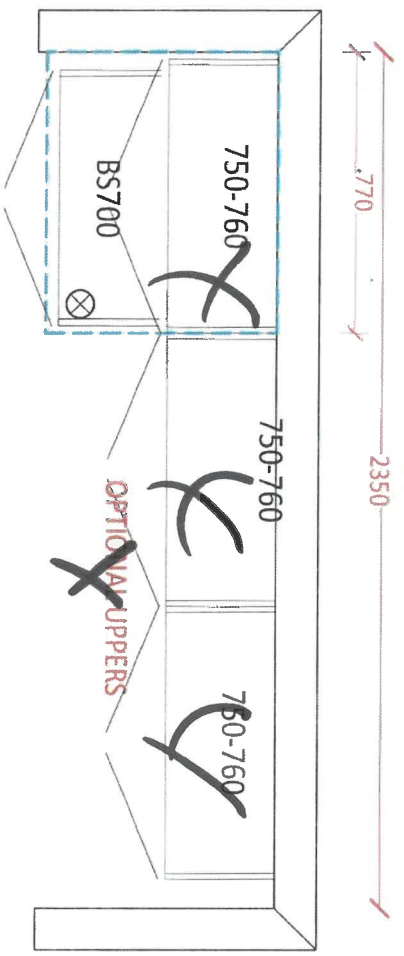

OPTIONAL UPPEERS

OPT. BASEMENT BATH

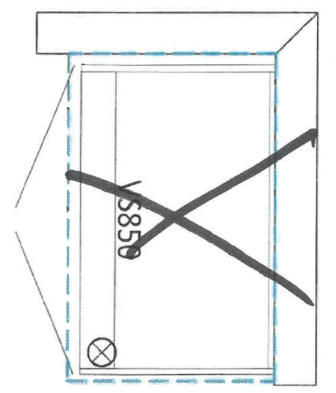

*NS*

*178-2*

APPLIANCE ACKNOWLEDGEMENT

CONTACT: Steve Miller - Appliance Canada (905) 660-2424 / smiller@appliancecanada.com

- It is the Purchasers responsibility to coordinate delivery, installation and hook up of appliances and to ensure they are installed as per Manufacturers specifications after closing.

STANDARD APPLIANCE OPENINGS provided by Zancor:

\*Standard appliance openings are approximate and the minimum required. Sizes may vary due to onsite condition and/or when modifications have been made to the cabinetry.

- Fridge Opening 36" x 74"
- Stove Opening 30"
- Hood Fan Opening 30"
- Hood Fan & Vent 6" with Under Cabinet Hood
- Dishwasher Opening 24"

Accepts Standard  
Openings \*\*Initial

MS

OPTIONAL UPGRADED APPLIANCES to be provided by Homeowner:

- **\*\*Specs/information sheets are required and it is the responsibility of the homeowner to provide this to Zancor Homes by the due date that has been provided. If appliance specs are not submitted, Zancor Homes will not be responsible for any necessary requirements and the standard opening will be built.**

MS

- Upgraded Appliance Specs are DUE 2 WEEKS FROM SIGNED DATE OF COLOUR CHART (if not received during appointment)

INITIAL

- \*\*\*Specs that require changes/modifications after this date will not be accepted\*\*\*
- NOTE: Any upgraded appliances are to be paid by the Purchaser, directly to the appliances company.

- Additional charges to the Purchaser may apply for cabinetry, electrical and plumbing in order to accommodate the specs given by the homeowner.

FRIDGE UPGRADE

- ☐ Built-in
- ☐ Paneled \*\*Panel to match required
- ☐ Integrated / Flush Inset
- ☒ Waterline

RANGE UPGRADE

\*Larger hood fan CFM might be required, which need a larger vent

- ☐ 36" \*\*Hood fan opening must be the same size or larger (8" vent might be required)
- ☐ 48" \*\*Hood Fan opening must be the same size or larger (8" or 10" vent required)
- ☐ Gas Range \*\*gas line and electrical required & sold separately
- ☐ Induction \*\*electrical required & sold separately
- ☐ Cooktop (Apron Front) \*\*Countertop Cut-out required & sold separately
- ☐ Cooktop (Drop-in) \*\*Countertop Cut-out required & sold separately

HOOD FAN & VENT  
UPGRADE

- ☐ 8 Inch \*\*Required for 600 CFM
- ☐ 10 Inch
- ☐ Chimney Hood Fan \*\*Vent must be centred
- ☐ Insert / Liner

WALL OVEN/MICRO  
UPGRADE

- ☐ Single Wall Oven \*\*electrical required & sold separately
- ☐ Double Wall Oven \*\*electrical required & sold separately
- ☐ Steam Oven \*\*electrical required & sold separately
- ☐ Warming Drawer \*\*electrical required & sold separately
- ☐ Over Then Range Microwave (OTR)
- ☐ Built-In Microwave \*\*Trim Kit required \*\*electrical required & sold separately

\*\*Electrical required

DATE Jan 20/22

CALEDON

SITE

LOT

138-2

\*\* Any upgrades checked in this appliance form must be accompanied with specs provided by the Purchaser.  
\*\* It is the responsibility of the trade to inform the Builder of any discrepancies with specs, sketches, extras and/or colour chart PRIOR to production/installation.

ZANCOR

221 North Rivermede Road, Concord, Ontario L4K 3N7 \* T: (905) 738.7010 F: (905) 738.5948

Stone Countertop Edge Profiles

\*\*Where applicable as per site specifications\*\*

STANDARD EDGE FOR KITCHEN & VANITIES

Standard Countertop Edge in  
Kitchen



Standard Countertop Edge in  
Vanity



NS

Homeowner(s) Initial

OPTION (1) EDGE FOR KITCHEN & VANITIES \$250

Optional Edge in Kitchen

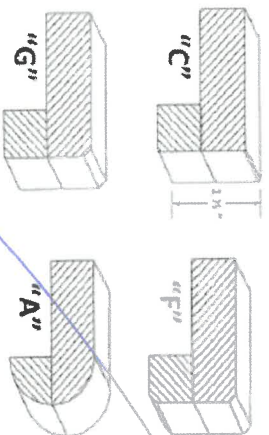

Optional Edge in Bathroom

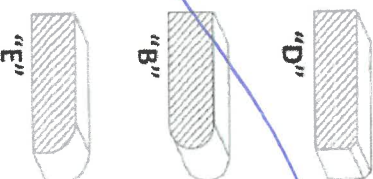

Homeowner(s) Initial

OPTION (2) EDGE FOR KITCHEN & VANITIES CUSTOM PRICING

Optional Edge for Kitchen

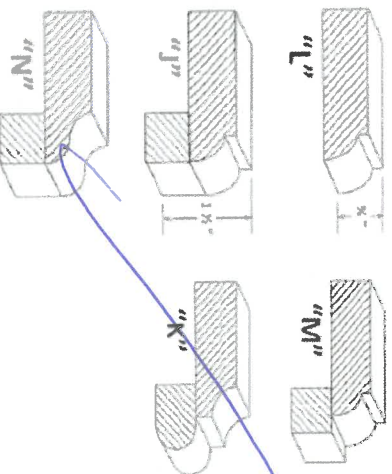

Optional Edge in Vanity

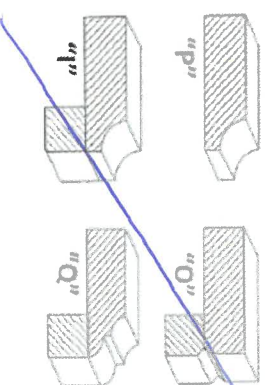

Homeowner(s) Initial

DATE

Jan 20/22

SITE

CALEDON

LOT

138-2

BRICK/JOINT PATTERN INSTALLATION  
RELEASE FORM

**FLOOR TILES** \*Brick installation is standard\*

**WALL TILES** \*Brick installation requires an additional charge and must be included on the extras if selected\*

(Large tiles installation for floor and wall) – ¼ Brick

Please be advised it has come to our attention, that due to production, many of the over-sized and odd shaped, man-made tiles (i.e. porcelain & ceramic), have been found to have a slight bow in the tile. It is a standard occurrence with all suppliers and manufacturers.

It is therefore recommended, that if and when a purchaser requests to install one of these tiles in a brick-joint pattern, that it be installed  $\leq 1$  in a ¼ brick pattern, to try to avoidlippage. Attached with this letter, you will find a layout of the ¼ brick installation that has been recommended.

LOCATIONS:

Foyer, Kit/BF/Pantry & Laundry.

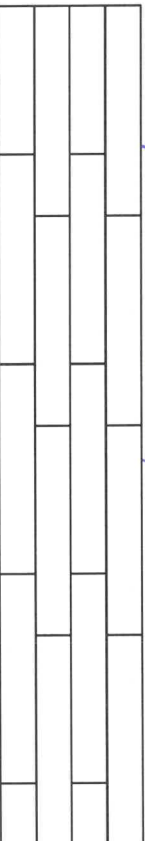

Please understand, even in using this ¼ brick installation, there may still be minimal lippage which cannot fully be eliminated.

Hence, when there is a request for brick-joint installation, Zancor Homes and their contractor, cannot be held responsible for this matter.

NS

Homeowner(s) Initial

(Small tile installation for walls) – ½ Brick

Purchaser requests to install small wall tiles on a backsplash or shower wall in a brick-joint pattern, that it be installed on a ½ brick pattern.

LOCATIONS:



Homeowner(s) Initial

**CALEDON**

DATE

Jan 20/22

SITE

LOT

128-2

## HOME AUTOMATION (Cable, CAT5/6, Telephone)

**INCLUDED IN SCHEDULE "A" IN AGREEMENT OF PURCHASE AND SALE:**

- Rough-in for Central Vacuum system piped to garage
- Rough-in for Telephone (2) locations
- Rough-in for Cable TV (2) locations
- Rough-in for Cat-6 Network (3) locations

**OPTION 1:**

I/we the Homeowner(s) have chosen to contact the Home Automation Company to select the locations of the rough-ins for Cable, CAT5, Telephone as included in our Agreement of Purchase Sale.

I/we the Homeowner(s) will contact the trade within 4 weeks of the date of this release to select locations of the standard rough-ins review other optional products for purchase.

**Trade:**                      **Artistic Smart Homes**

**Phone:**                    **(905) 850-9386**

**Location:**                **8601 Jane Street  
Concord, Ont L4K 5N9**

Should the homeowner not make these selections within the sufficient time provided, the rough-ins as mentioned above will be installed in locations at the Vendor's discretion.

Homeowner(s) Initial

NS

**OPTION 2:**

I/we the Homeowner(s) acknowledge that if we do not contact the home automation company, I/we the Homeowner(s) have agreed to the Vendor locations for the standard rough-ins for Cable, CAT6, Telephone that are included in the Agreement of Purchase and Sale.

Homeowner(s) Initial

CALEDON

DATE

Jan 20/22

SITE

LOT

128-2.

Purchaser accepts and acknowledges that the Builder reserves the right to substitute materials with those of equal or better quality where the manufacture, scheduling or delivery of materials may directly impact the Builder's ability to meet its' contractual obligations under the Agreement of Purchase and Sale.

**UPGRADES/EXTRAS:** All upgrades and additional selections indicated on the colour chart must be accompanied by an upgrades/extras sheet (PES) and full payment otherwise the selection will be invalid. All colour charts and upgrades/extras will not proceed until verified and signed by an authorized signing officer at the Vendor's head office. **CHANGES WILL NOT BE PERMITTED UPON COMPLETION AND SUBMISSION OF THE COLOUR CHART.**

**PORCELAIN & NATURAL STONES:** Due to the properties of natural stones including but not limited to **marble, granite, quartz**, no two pieces are exactly the same. Variations in colour, tone, granularity (pitting, fissures) and pattern are to be expected, including various lighting may affect the overall finished look. Stone tops are sealed at time of installation and should never be cleaned with lemon oil or vinegar. Stones are porous materials, therefore any spilled substance require immediate attention. Stone countertops require regular seal re-application as part of home maintenance. Purchaser acknowledges colour and product variations as well as natural imperfections may exist with the selection of natural stone materials and shall not hold the Vendor liable for provision of same.

**STONE COUNTERTOP JOINTS:** Purchaser is aware that one joint will be at each corner and on either side of slide-in-range (if applicable). It will also be where the length of the counter top exceeds the length of a stone slab. Slabs are usually approximately 5' x 8'.

**CERAMIC TILES:** Due to manufacturing, shade (dye lots), product variations may exist that can affect the overall look of the finished product. Although every effort will be made to ensure the colours and materials selected are as close as possible to the samples, the purchaser acknowledges that the sample tiles supplied in the Design Centre may not be identical to the materials installed in the home.

**STAIR STAINS:** Due to the natural properties of wood, many variables can affect the overall look of the finished product. Factors including but not limited to wood type, knotting, graining, density, age, humidity, and air temperature can result in substantial variations in stain intensity. The purchaser accepts that although the Vendor will do their best to match stain the unfinished stairs as close as possible to the pre-finished floors, it is not possible to have an identical match and that there MAY be shade differences between the two products.

**CABINETRY:** Due to the natural properties of wood, slight variations apparent with cabinetry are to be expected. This includes but not limited to wood species, wood grain, colour, finish, product variations, and natural imperfections are all factors that may affect the overall look of the finished product. Such factors make exact colour matching impossible. The type and intensity of lighting in the areas of designated cabinetry placement may also highlight characteristics of cabinetry finish. All cabinets shall be finished with a white melamine interior box unless a finished interior is upgraded. Due to building specifications and/or on-site conditions, certain cabinetry upgrades may not be possible. The purchaser acknowledges that the Builder cannot guarantee the cabinetry finish or provision of certain upgrades and shall not hold the Builder liable for provision of same.

**UPGRADES/EXTRAS:** All upgrades and additional selections indicated on the colour chart must be accompanied by an upgrades/extras sheet (PES) and full payment otherwise the selection will be invalid. All colour charts and upgrades/extras will not proceed until verified and signed by an authorized signing officer at the Vendor's head office. **CHANGES WILL NOT BE PERMITTED UPON COMPLETION AND SUBMISSION OF THE COLOUR CHART.**

**HARDWOOD / LAMINATE FLOORING:** Due to the properties of wood and laminate, many variables can affect the overall look of the finished product. Variations include but not limited to wood type or laminate finish, colour/stain and wood grain are significant factors that make exact colour matching impossible. The purchaser acknowledges that the hardwood flooring is a pre-finished product in a controlled environment. Expansion, compression and cupping are characteristics of hardwood flooring once installed in the home. The purchaser acknowledges these may become apparent over time and despite the Builders' efforts to install the hardwood flooring materials in keeping with good workmanship, the Builder shall not be responsible nor held liable for minor variances of fluctuation in hardwood flooring materials.

#### HARDWOOD / LAMINATE WAIVER:

I/We understand hardwood flooring is classified as a porous material and as such not recommended by the Builder in certain areas. I/We understand there is a concern due to possible water and other substances being frequently splashed or spilled onto the floor and in contravention of Ontario Building Code Section 9.30.1.2(1).

*"Finished flooring bathrooms, kitchens, public entrance halls, laundry & general storage areas shall consist of resilient flooring, felted-synthetic-fibre floor coverings, concrete, terrazzo, ceramic tile, mastic or other types of flooring providing similar degrees of water resistance.*

I/We are prepared to assume full responsibility for any damage caused to the hardwood floor or subfloor due to moisture absorbcency in the mentioned areas, and agree to waive any claims against the Township of residence, TARIION and/or the Builder in relation to the matter. **\*\*SEE COLOUR CHART FOR LOCATIONS\*\***

|      |         |  |       |
|------|---------|--|-------|
| DATE | SITE    |  | LOT   |
|      | CALEDON |  | 108-2 |

221 North Rivermede Road, Concord, Ontario L4K 3N7 \* T: (905) 738.7010 F: (905) 738.5948