

CONSTRUCTION SUMMARY OF EXTRAS  
Printed 2022-02-28 / 6:04 PM / Page 1 of 1

Site:  
Lot:  
Model:  
Purchaser:  
Purchaser:  
Phone:  
Email:

CALEDON (B)  
177-1  
HIGHLAND (RLTH-02) ELEVC C END  
Parveen Kumar Basra  
Shallu Basra  
647-226-6281  
realtorpraveenbasra@gmail.com







DESCRIPTION		DATE SELECTED
	BONUS PACKAGE: 3 PIECE STAINLESS STEEL APPLIANCES WITH WHITE WASHER & DRYER	INCLUDED IN APS
	BONUS PACKAGE: STAINLESS STEEL HOOD FAN	INCLUDED IN APS
	BONUS PACKAGE: AIR CONDITIONER	AS PER SCH E
	STRUCTURALS	
1	N/A	10-Feb-22
2	PLUG ABOVE FIREPLACE INSTALL APPROX 65" FROM FLOOR	10-Feb-22
3	ELECTRICAL FIREPLACE DIMPLEX PRISM BLF5051 (50") LINEAR WALL BUILT INTO ROOM APPROX 8" DEEP TO ACCOMMODATE ACRYLIC ICE AND MULTI COLORED LIGHTS FAN FORCED HEATER AND ELECTRICAL IN LIEU OF STANDARD	10-Feb-22
4	PLUG INSTALL AT THE SIDE OF THE KITCHEN ISLAND	10-Feb-22
5	PLUG FOR ISLAND BASE MICROWAVE ON SEPARATE CIRCUIT	10-Feb-22
6	COMFORT HEIGHT VANITY GR FLR AND 2ND FLOOR POWDER ROOM	10-Feb-22
7	COMFORT HEIGHT VANITY MASTER ENSUITE ND MAIN BATH	10-Feb-22
8	VANITY UPGRADE # 1 MASTER ENSUITE	10-Feb-22
9	VANITY UPGRADE # 1 MAIN BATH	10-Feb-22
10		10-Feb-22
11	KITCHEN BASE MICROWAVE WITH DRAWER BELOW ON ISLAND	10-Feb-22
12	HARDWOOD UP # 2 GREAT ROOM, HALL, LANDINGS, REC ROOM, HALL UPPER HALL	10-Feb-22
13	TILES UP # 2 FOYER,POWDER ROOM GR FLR & 2ND FLR, LAUNDRY MUDROOM	10-Feb-22
14	TILE UP # 2 KITCHEN AND BREAKFAST	10-Feb-22
15	KITCHEN UPGRADE HARDWARE	10-Feb-22
16	KITCHEN COUNTER TOP UP # 3	10-Feb-22
17	POWDER ROOM 2ND FLOOR COUNTER TOP UP # 3	10-Feb-22
18	TILES SHOWER FLOOR MASTER ENSUITE UP # 1	10-Feb-22
19	MAIN BATH UP # 1 COUNTER TOP	10-Feb-22
20	WATERLINE TO FRIDGE	10-Feb-22
21	BATHROOM ACCESSORIES (2) PAPER HOLDERS POWDER ROOM GROUND AND 2ND FLOOR YB2408 (2) TOWEL BAR YB2418	10-Feb-22
22	BATHROOM ACCESSORIES (2) PAPER HOLDERS YB2408 (2) TOWEL BAR YB2424 MAIN AND MASTER	10-Feb-22

ZANCOR HOMES COLOUR CHART

PRINTED 2022-02-10, 11:24 AM

ENTRANCES				
Main Foyer - FLOORING	FLOW GREIGE POLISHED 12 X 24 UP # 2 INSTALL STACKED			
Mudroom - FLOORING	NA			
Side Hall - FLOORING	NA			
Basement Foyer - FLOORING	NA			
KITCHEN				
Kitchen - FLOORING	FLOW GREIGE POLISHED 12 X 24 UP # 2 INSTALL STACKED			
Breakfast - FLOORING	FLOW GREIGE POLISHED 12 X 24 UP # 2 INSTALL STACKED			
Kitchen - CABINETS	SHAKER V PVC TUXEDO			
Island - CABINETS	SHAKER V PVC TUXEDO			
Servery - CABINETS	NA			
Kitchen - HANDLES/KNOBS	H1400-BC			
Kitchen - COUNTERTOP	CALACATTA GOLD QUARTZ UP # 3			
Island - COUNTERTOP	CALACATTA GOLD QUARTZ UP # 3			
Kitchen - BACKSPLASH	DECLINED			
Kitchen - SINK	STANDARD			
Kitchen - FAUCET	STANDARD			
GREAT ROOM / DINING / LIVING / DEN / OFFICE / BASEMENT				
Family / Great Room - FLOORING	SOLID SAWN PEARL BARISTA 5" UP # 2			
Main Hall - FLOORING	SOLID SAWN PEARL BARISTA 5" UP # 2			
Dining / Living Room - FLOORING	NA			
Library / Den - FLOORING	NA			
Basement Rec Room -/Hall FLOORING	SOLID SAWN PEARL BARISTA 5" UP # 2			
STAIRS				
Railing Details - PICKETS	METAL BLACK SINGLE COLLAR WITH ALT PLAIN			
Railing Details - POSTS	2 3/4" TURNED OAK POSTS			
Railing Details - HANDRAIL	2 1/2" OVAL OAK HANDRAIL			
Stair Stain - MAIN STAIRS	STAIN TO MATCH HARDWOOD AS CLOSE AS POSSIBLE			
Stair Stain - BASEMENT STAIRS (if applicable)	NA			
Stair Stain - SERVICE STAIRS (if applicable)	NA			
POWDER ROOM				
Powder Room - FLOORING GR FL & 2ND FLR	FLOW GREIGE POLISHED 12 X 24 UP # 2 INSTALL STACKED			
Powder Room - CABINETS	SHAKER V PVC TUXEDO COMFORT HEIGHT H-800-BC			
Powder Room - COUNTERTOP	GROUND FLOOR PERLATO ROYAL///2ND FLOOR CALACATTA GOLD UP # 3			
Powder Room - SINK	OVAL UNDERMOUNT 4220 CFY			
Powder Room - FAUCET	STANDARD			
2ND FLOOR				
Upper Hall - FLOORING	SOLID SAWN PEARL BARISTA 5" UP # 2			
Master Bedroom - FLOORING	OPENING NIGHT T-15			
Bedroom 2 - FLOORING	OPENING NIGHT T-15			
Bedroom 3 - FLOORING	OPENING NIGHT T-15			
Bedroom 4 - FLOORING	NA			
Bedroom 5 - FLOORING	NA			
Master Ensuite - FLOORING	NEW BYZANTINE PENTELLIC GREY 12 X 24 INSTALL STACKED			
Master Ensuite - SHOWER WALL	NEW BYZANTINE PENTELLIC GREY 12 X 24 HORIZONTAL STACKED			
Master Ensuite - SHOWER FLOOR	ONT SERIES TENDER GREY MATT HEXAGON UP # 1			
Master Ensuite - SHOWER JAMB	PERLATO ROYAL			
Master Ensuite - CABINETS	MOSAIC MAPLE TIMBERGREY COMFORT HEIGHT UP # 1			
Master Ensuite - HANDLES/KNOBS	H-800-BC			
Master Ensuite - COUNTERTOP	PERLATO ROYAL			
Master Ensuite - SINK(S)	OVAL 4220 CFY	Master Ensuite - FAUCET(s)	STANDARD	
***FOR TRADE USE***				
Any upgrades in the colour chart must be accompanied with a PES. It is the responsibility of all Trades to inform the builder of any discrepancies on sketches, PES and/or colour charts PRIOR to installation.		CALEDON	177-1	
**PAGE 1 OF 2**		PURCHASER INITIALS	VENDOR APPROVAL	



2ND FLOOR CONTINUED ...									
Main Bath - FLOORING		GENESSIS DARK GREY 12 X 24 INSTALL STACKED							
Main Bath - TUB / SHOWER WALL		GENESSIS DARK GREY 12 X 24 INSTALL HORIZONTAL STACKED							
Main Bath - SHOWER FLOOR		NA							
Main Bath - SHOWER JAMB		NA							
Main Bath - CABINETS		MATRIX OLMO CARISMA UP # 1 COMFORT HEIGHT							
Main Bath - HANDLES/KNOBS		H-800-BC							
Main Bath - COUNTERTOP		WHITE GALAXY QUARTZ UP # 1							
Main Bath - SINK(s)		OVAL 4220CFY		Main Bath - FAUCET(s)		STANDARD			
Shared Bath- FLOORING		NA							
Shared Bath- TUB / SHOWER WALL		NA							
Shared Bath- SHOWER FLOOR		NA							
Shared Bath- SHOWER JAMB		NA							
Shared Bath- CABINETS		NA							
Shared Bath- HANDLES/KNOBS		NA							
Shared Bath- COUNTERTOP		NA							
Shared Bath- SINK(s)				Shared Bath - FAUCET(s)					
Ensuite Bath - FLOORING		NA							
Ensuite Bath - TUB / SHOWER WALL		NA							
Ensuite Bath - SHOWER FLOOR		NA							
Ensuite Bath - SHOWER JAMB		NA							
Ensuite Bath - CABINETS		NA							
Ensuite Bath - HANDLES/KNOBS		NA							
Ensuite Bath - COUNTERTOP		NA							
Ensuite Bath - SINK(s)				Ensuite Bath - FAUCET(s)					
LAUNDRY									
Laundry -/Mud Room FLOORING		FLOW GREIGE POLISHED 12 X 24 UP # 2 INSTALL STACKED							
Laundry - CABINETS		SHAKER V PVC TUXEDO		Laundry - HANDLES/KNOBS		H-800-BC			
Laundry - COUNTERTOP		SIERRA CASCADE 5005-38		Laundry - SINK		STANDARD			
Laundry - BACKSPLASH		NA		Laundry - FAUCET		STANDARD			
TRIM / PAINT									
Casing/Baseboards		STANDARD							
Interior Doors		STANDARD							
Interior Door Hardware		STANDARD							
PAINT - Throughout		BIRCH WHITE							
FIREPLACE									
Location / Insert / Mantle		50" ELECTRIC LINEAR BLF5051							
ACCESSORIES									
Mirrors		STANDARD		BATH ACCESSORIES		UPGRADE			
APPLIANCE REQUIREMENTS									
GAS LINE TO BBQ		STANDARD		ELECTRICAL for Built-in Oven		DECLINED			
GAS LINE & ELECTRICAL TO STOVE		DECLINED		ELECTRICAL for Built-in Micro		DECLINED			
GAS LINE & ELECTRICAL TO DRYER		DECLINED		ELECTRICAL for Cooktop		DECLINED			
HOOD FAN VENT SIZE		6" STANDARD		ELECTRICAL for Bar Fridge		DECLINED			
WATERLINE to Fridge		UPGRADE							
		DISCLAIMER				INITIALS			
Any changes to the colour chart after signing are subject to a <b>\$5000</b> administration fee plus costs									
Purchaser has checked and acknowledged accuracy of colour and selections before signing.									
Colours of all materials are as close as possible to Builders selection but not necessarily identical due to dye lot variances in manufacturing/manufacturers. Due to construction progress some items may have been pre-selected or installed. In this event the Vendor's selection must be accepted by the purchaser									
SITE / LOT:		CALEDON (B)				177-1			
PURCHASER(S):		Parveen Kumar Basra							
PURCHASER(S):		Shallu Basra							
CONTACT:		647-226-6281		realtorpraveenbasra@gmail.com					
***FOR TRADE USE***									
Any upgrades in the colour chart must be accompanied with a PES. It is the responsibility of all Trades to inform the builder of any discrepancies on sketches, PES and/or colour charts PRIOR to installation.									
		PURCHASER SIGNATURE							
		PURCHASER SIGNATURE							
		DÉCOR CONSULTANT		KATHERINE					
**PAGE 2 OF 2**		Vendor APPROVAL		 Feb 17/22					

HIGHLAND RLTH-02 (end unit)

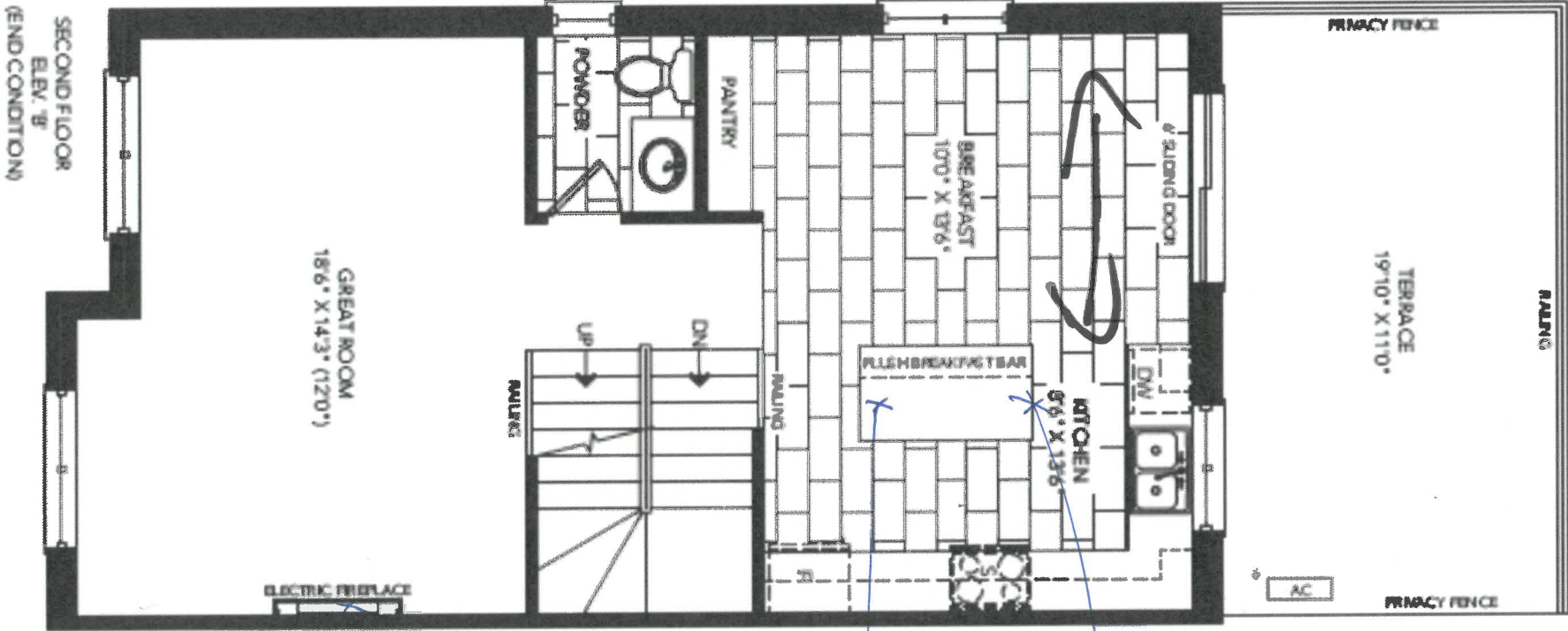

Lot 177-1

FEB 10/22

Plug at  
side of  
stove

Base mu Plug

APPROX  
11'1" front  
to 10'0" front

ADD Plug ABOVE FP

UPGRADE

50" LINEAR

Fireplace

*[Handwritten signature]*

106177-1





Lot 177-1

FEB 10/22

# HIGHLAND RLTH-02 (end unit)

↑ Floor  
like  
Direction

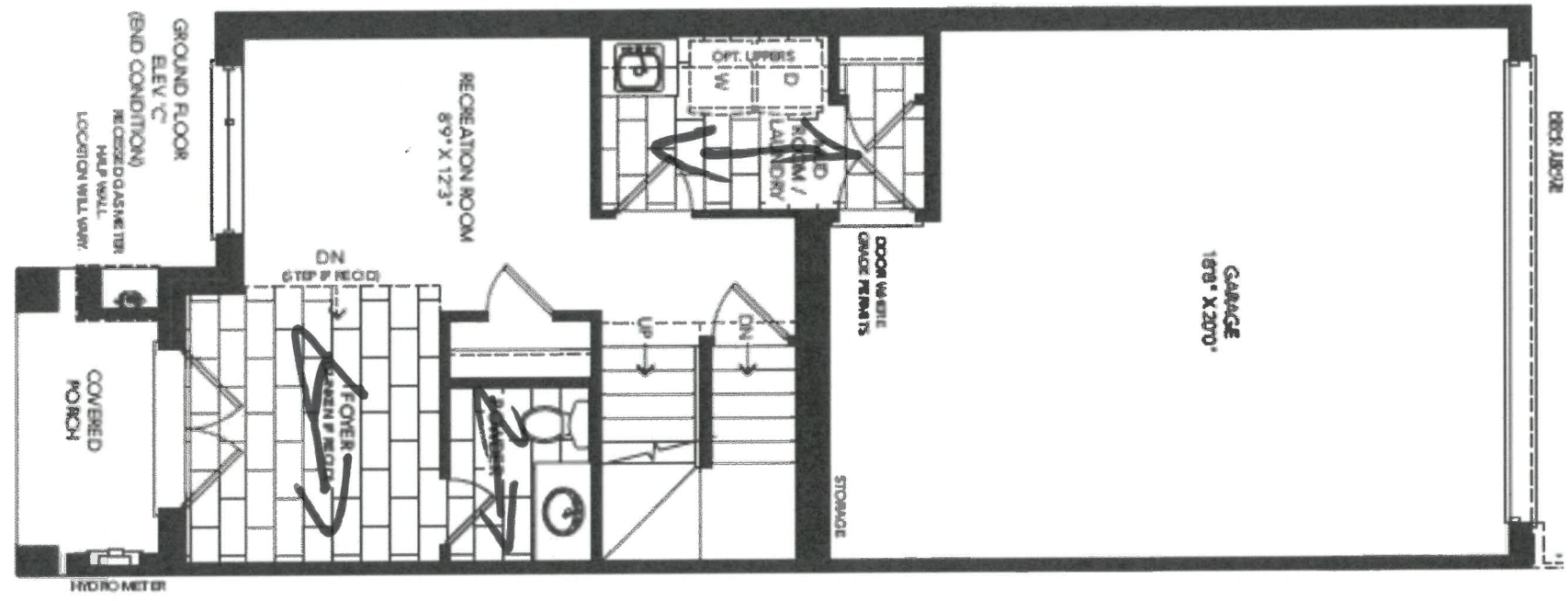

*[Handwritten signature]*

HIGHLAND RLTH-02 (end unit)

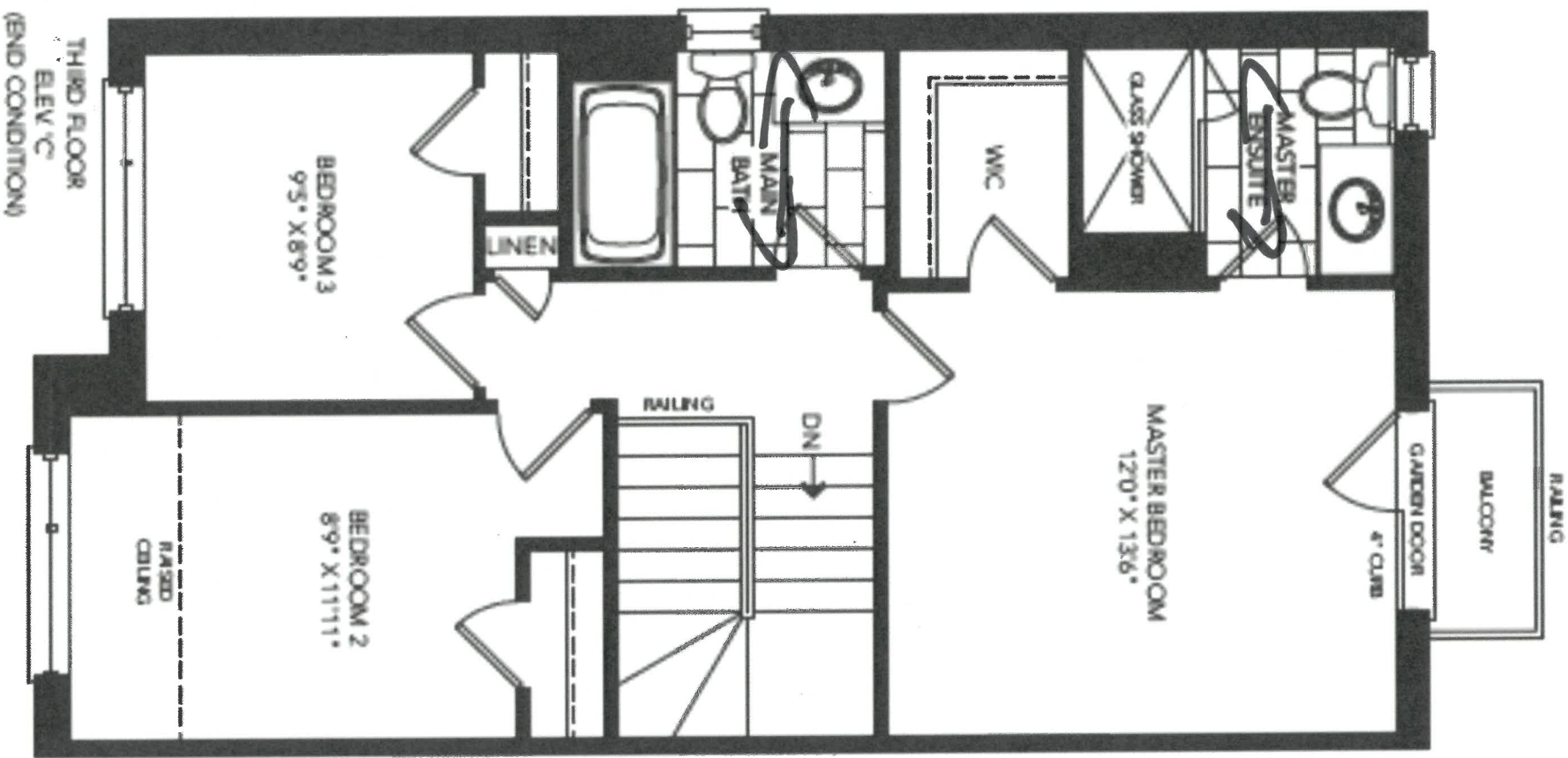

↔  
Floor 17/e  
Dike's

*[Handwritten signature]*

106177-1  
Feb 10/22

RLTH-02-ELEV. A, B, C  
KITCHEN

Lot 1177-1  
Jeh 10/22

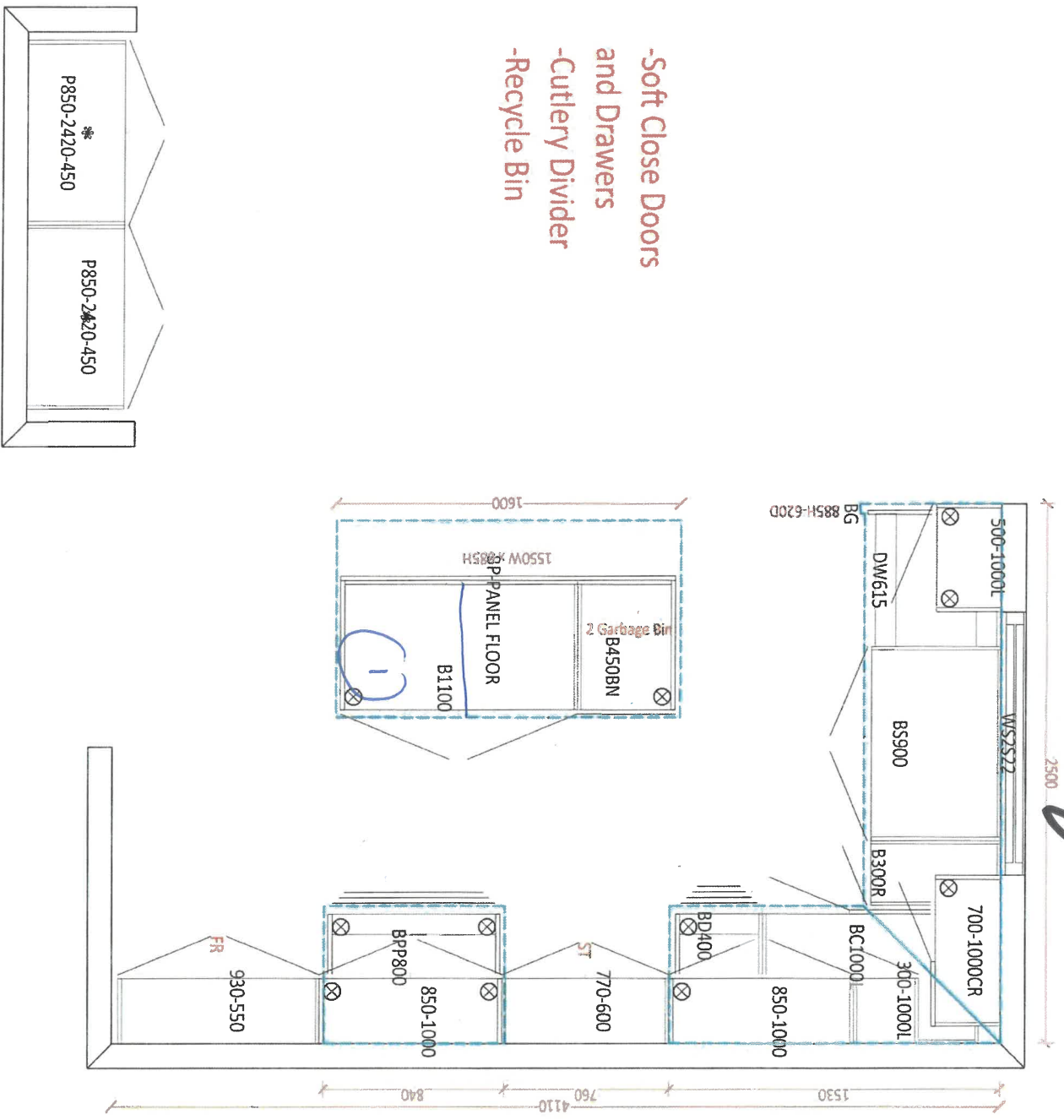

① Base in w. drawer Below  
with Drawer Below

*[Handwritten signature]*



RLTH-02-ELEV. A, B, C  
STD. VANITIES

POWDER GROUND FLOOR  
900

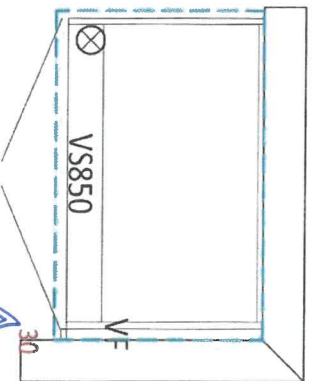

MAIN  
910

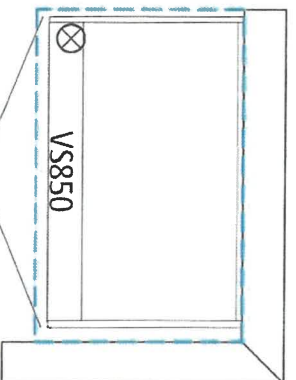

POWDER SECOND FLOOR  
910

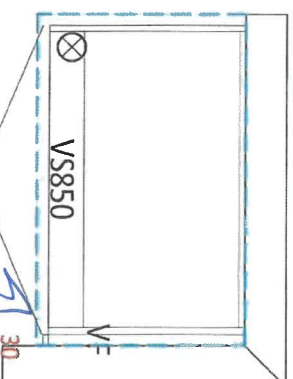

MASTER ENSUITE  
1160

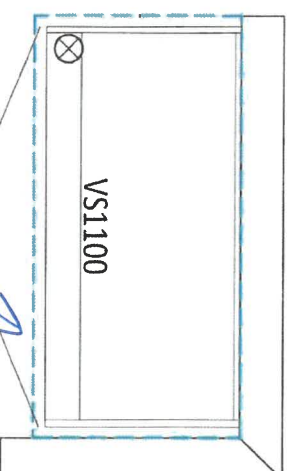

LAUNDRY ROOM  
2420

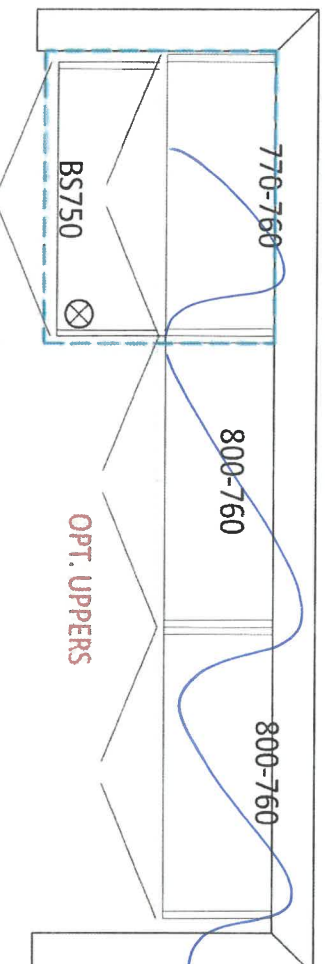

OPT. BASEMENT BATH  
900

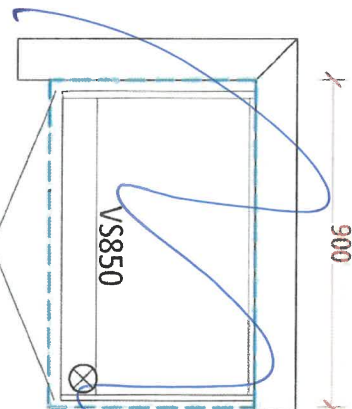

Lot 177-1  
Add 0/22

comfort height

Handwritten signature

## APPLIANCE ACKNOWLEDGEMENT

**CONTACT: Steve Miller - Appliance Canada (905) 660-2424 / smiller@appliancecanada.com**

- It is the Purchaser's responsibility to coordinate delivery, installation and hook up of appliances and to ensure they are installed as per Manufacturers specifications after closing.

**STANDARD APPLIANCE OPENINGS provided by Zancor:**

\*Standard appliance openings are approximate and the minimum required. Sizes may vary due to onsite condition and/or when modifications have been made to the cabinetry.

- Fridge Opening 36" x 74"
- Stove Opening 30"
- Hood Fan Opening 30"
- Hood Fan & Vent 6" with Under Cabinet Hood
- Dishwasher Opening 24"

Accepts Standard  
Openings \*\*Initial**OPTIONAL UPGRADED APPLIANCES to be provided by Homeowner:**

- **\*\*Specs/information sheets are required and it is the responsibility of the homeowner to provide this to Zancor**
- **Homes by the due date that has been provided. If appliance specs are not submitted, Zancor Homes will not be responsible for any necessary requirements and the standard opening will be built.**



INITIAL

- **Upgraded Appliance Specs are DUE 2 WEEKS FROM SIGNED DATE OF COLOUR CHART (if not received during appointment)**

- **\*\*Specs that require changes/modifications after this date will not be accepted\*\*\***

- **NOTE: Any upgraded appliances are to be paid by the Purchaser, directly to the appliances company.**

- Additional charges to the Purchaser may apply for cabinetry, electrical and plumbing in order to accommodate the specs given by the homeowner.

**FRIDGE UPGRADE**

- ☐ Built-in
- ☐ Paneled \*\*Panel to match required
- ☐ Integrated / Flush Inset
- ☒ Waterline

**RANGE UPGRADE**

\*Larger hood fan CFM might be required, which need a larger vent

- ☐ 36" \*\*Hood fan opening must be the same size or larger (8" vent might be required)
- ☐ 48" \*\*Hood Fan opening must be the same size or larger (8" or 10" vent required)
- ☐ Gas Range \*\*gas line and electrical required & sold separately
- ☐ Induction \*\*electrical required & sold separately
- ☐ Cooktop (Apron Front) \*\*Countertop Cut-out required & sold separately
- ☐ Cooktop (Drop-in) \*\*countertop Cut-out required & sold separately

**HOOD FAN & VENT UPGRADE**

- ☐ 8 Inch \*\*Required for 600 CFM
- ☐ 10 Inch
- ☐ Chimney Hood Fan \*\*Vent must be centred
- ☐ Insert / Liner

**WALL OVEN/MICRO UPGRADE**

\*\*Electrical required

- ☐ Single Wall Oven \*\*electrical required & sold separately
- ☐ Double Wall Oven \*\*electrical required & sold separately
- ☐ Steam Oven \*\*electrical required & sold separately
- ☐ Warming Drawer \*\*electrical required & sold separately
- ☐ Over Then Range Microwave (OTR)
- ☒ Built-In Microwave \*\*Trim Kit required \*\*electrical required & sold separately

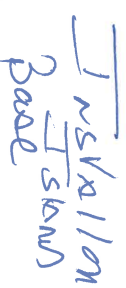
DATE Feb 10/22SITE CALEDONLOT 177-1

\*\* Any upgrades checked in this appliance form must be accompanied with specs provided by the Purchaser.

\*\*It is the responsibility of the trade to inform the Builder of any discrepancies with specs, sketches, extras and/or colour chart PRIOR to production/installation.

ZANCOR

221 North Rivermede Road, Concord, Ontario L4K 3N7 \* T: (905) 738.7010 F: (905) 738.5948



Purchaser accepts and acknowledges that the Builder reserves the right to substitute materials with those of equal or better quality where the manufacture, scheduling or delivery of materials may directly impact the Builder's ability to meet its' contractual obligations under the Agreement of Purchase and Sale.

**UPGRADES/EXTRAS:** All upgrades and additional selections indicated on the colour chart must be accompanied by an upgrades/extras sheet (PES) and full payment otherwise the selection will be invalid. All colour charts and upgrades/extras will not proceed until verified and signed by an authorized signing officer at the Vendor's head office. **CHANGES WILL NOT BE PERMITTED UPON COMPLETION AND SUBMISSION OF THE COLOUR CHART.**

**PORCELAIN & NATURAL STONES:** Due to the properties of natural stones including but not limited to **marble, granite, quartz**, no two pieces are exactly the same. Variations in colour, tone, granularity (pitting, fissures) and pattern are to be expected, including various lighting may affect the overall finished look. Stone tops are sealed at time of installation and should never be cleaned with lemon oil or vinegar. Stones are porous materials, therefore any spilled substance require immediate attention. Stone countertops require regular seal re-application as part of home maintenance. Purchaser acknowledges colour and product variations as well as natural imperfections may exist with the selection of natural stone materials and shall not hold the Vendor liable for provision of same.

**STONE COUNTERTOP JOINTS:** Purchaser is aware there may be joints in stone counter tops, in kitchens and vanities if applicable as per plan. Joints will also be applicable where the length of the counter top exceeds the length of a stone slab.

**CERAMIC TILES:** Due to manufacturing, shade (dye lots), product variations may exist that can affect the overall look of the finished product. Although every effort will be made to ensure the colours and materials selected are as close as possible to the samples, the purchaser acknowledges that the sample tiles supplied in the Design Centre may not be identical to the materials installed in the home.

**STAIR STAINS:** Due to the natural properties of wood, many variables can affect the overall look of the finished product. Factors including but not limited to wood type, knotting, graining, density, age, humidity, and air temperature can result in substantial variations in stain intensity. The purchaser accepts that although the Vendor will do their best to match stain the unfinished stairs as close as possible to the pre-finished floors, it is not possible to have an identical match and that there MAY be shade differences between the two products.

**CABINETRY:** Due to the natural properties of wood, slight variations apparent with cabinetry are to be expected. This includes but not limited to wood species, wood grain, colour, finish, product variations, and natural imperfections are all factors that may affect the overall look of the finished product. Such factors make exact colour matching impossible. The type and intensity of lighting in the areas of designated cabinetry placement may also highlight characteristics of cabinetry finish. All cabinets shall be finished with a white melamine interior box unless a finished interior is upgraded. Due to building specifications and/or on-site conditions, certain cabinetry upgrades may not be possible. The purchaser acknowledges that the Builder cannot guarantee the cabinetry finish or provision of certain upgrades and shall not hold the Builder liable for provision of same.

**UPGRADES/EXTRAS:** All upgrades and additional selections indicated on the colour chart must be accompanied by an upgrades/extras sheet (PES) and full payment otherwise the selection will be invalid. All colour charts and upgrades/extras will not proceed until verified and signed by an authorized signing officer at the Vendor's head office. **CHANGES WILL NOT BE PERMITTED UPON COMPLETION AND SUBMISSION OF THE COLOUR CHART.**

**HARDWOOD / LAMINATE FLOORING:** Due to the properties of wood and laminate, many variables can affect the overall look of the finished product. Variations include but not limited to wood type or laminate finish, colour/stain and wood grain are significant factors that make exact colour matching impossible. The purchaser acknowledges that the hardwood flooring is a pre-finished product in a controlled environment. Expansion, compression and cupping are characteristics of hardwood flooring once installed in the home. The purchaser acknowledges these may become apparent over time and despite the Builders' efforts to install the hardwood flooring materials in keeping with good workmanship, the Builder shall not be responsible nor held liable for minor variances of fluctuation in hardwood flooring materials.

#### HARDWOOD / LAMINATE WAIVER:

I/We understand hardwood flooring is classified as a porous material and as such not recommended by the Builder in certain areas. I/We understand there is a concern due to possible water and other substances being frequently splashed or spilled onto the floor and in contravention of Ontario Building Code Section 9.30.1.2(1).

*"Finished flooring bathrooms, kitchens, public entrance halls, laundry & general storage areas shall consist of resilient flooring, felted-synthetic-fibre floor coverings, concrete, terrazzo, ceramic tile, mastic or other types of flooring providing similar degrees of water resistance.*

I/We are prepared to assume full responsibility for any damage caused to the hardwood floor or subfloor due to moisture absorbency in the mentioned areas, and agree to waive any claims against the Township of residence, TARIION and/or the Builder in relation to the matter. **\*\*SEE COLOUR CHART FOR LOCATIONS\*\***

DATE Jul 10/22 SITE CALEDON LOT 177-1



## HOME AUTOMATION (Cable, CAT5/6, Telephone)

**INCLUDED IN SCHEDULE "A" IN AGREEMENT OF PURCHASE AND SALE:**

- Rough-in for Central Vacuum system piped to garage
- Rough-in for Telephone (2) locations
- Rough-in for Cable TV (2) locations
- Rough-in for Cat-6 Network (3) locations

**OPTION 1:**

I/we the Homeowner(s) have chosen to contact the Home Automation Company to select the locations of the rough-ins for Cable, CAT5, Telephone as included in our Agreement of Purchase Sale.

I/we the Homeowner(s) will contact the trade within 4 weeks of the date of this release to select locations of the standard rough-ins review other optional products for purchase.

**Trade:** Artistic Smart Homes  
**Phone:** (905) 850-9386  
**Location:** 8601 Jane Street  
Concord, Ont L4K 5N9

Should the homeowner not make these selections within the sufficient time provided, the rough-ins as mentioned above will be installed in locations at the Vendor's discretion.

I/we the Homeowner(s) acknowledge that if we do not contact the home automation company, I/we the Homeowner(s) have agreed to the Vendor locations for the standard rough-ins for Cable, CAT6, Telephone that are included in the Agreement of Purchase and Sale.

Homeowner(s) Initial

Homeowner(s) Initial

CALEDON

DATE

SITE

LOT

177-1

Stone Countertop Edge Profiles

\*\*Where applicable as per site specifications\*\*

STANDARD EDGE FOR KITCHEN & VANITIES

Standard Countertop Edge in  
Kitchen

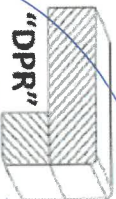

Standard Countertop Edge in  
Vanity



Homeowner(s) Initial

OPTION (1) EDGE FOR KITCHEN & VANITIES \$250

Optional Edge in Kitchen

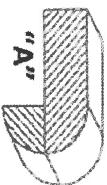
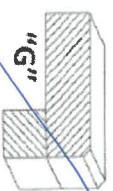
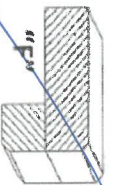
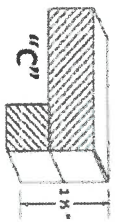

Optional Edge in Bathroom

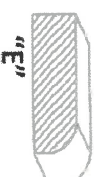
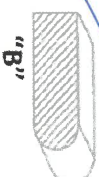
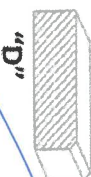

Homeowner(s) Initial

OPTION (2) EDGE FOR KITCHEN & VANITIES CUSTOM PRICING

Optional Edge for Kitchen

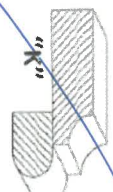
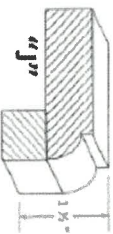
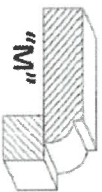

Optional Edge in Vanity

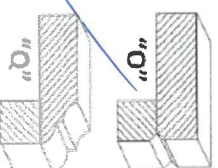
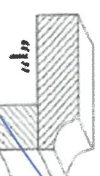

Homeowner(s) Initial

DATE

SITE

CALEDON

LOT



**Prism Series**  
50" Linear Electric Fireplace

BLF5051

The best-selling linear fireplace is now even better.



The best-selling electric linear fireplace just got better with the all new Prism Series. Sparkling with intensity in a full spectrum of colors, the Prism effect illuminates the diamond-like acrylic ice ember bed in a show-stopping effect. Plug-in or hard-wire, hung on the wall or built-in; the Prism Series is beautifully versatile.

**PRISM**  
series

177-1





# Prism Series

## 50" Linear Electric Fireplace

BLF5051

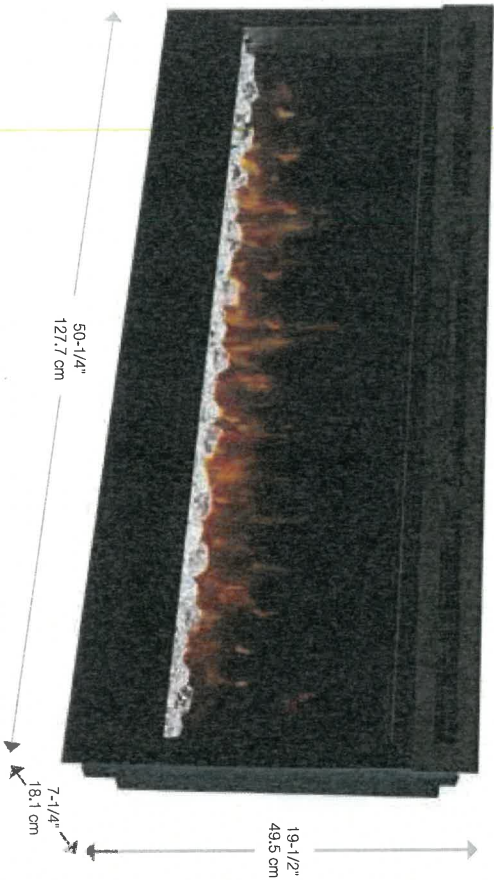

Driftwood and River Rock Accessory Package - 50" LF50DWS-KIT

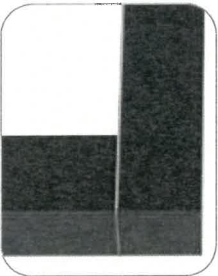

Cohesion Trim - Black DT1267BLK



Multi-function Remote

120 Volts | 1,230 Watts | 4,197 BTU

Model #	Description	Lbs / Kg	UPC	Warranty	Carton Dimensions (WxHxD)		Cube	
					inches	cm	ft <sup>3</sup>	m <sup>3</sup>
BLF5051	50" Linear Electric Fireplace	75 / 34.1	781052 098787	2 yr.	55 x 23-1/4 x 12-7/8	139.7 x 58.9 x 32.7	9.5	0.26
DT1267BLK	Cohesion Trim - Black	51 / 23.1	781052 080355	1 an	64-7/8 x 26-1/4 x 8-3/4	164.8 x 66.8 x 22.1	8.6	0.24
LF50DWS-KIT	50" Driftwood and River Rock Accessory Kit	7 / 3.17	781052 102842		34-1/4 x 5-7/8 x 8-1/8	87.2 x 14.98 x 20.6		

Specifications, finishes and dimensions are subject to change. \*Limited warranty. ©2020 Glen Dimplex Americas

Glen Dimplex Americas | 1-800-668-6663 | www.dimplex.com

### Features

- The Original Dimplex Flame Effect™**  
A blend of technology, artistry and craftsmanship that sets the standard for realism.
- Acrylic Ice Media Bed**  
Light plays through different size pieces and sparkle in a spectrum of colors.
- Media Accent Colors**  
Choose from a variety of brilliant color themes or cycle through a range of colors using the custom mode, freezing on the hue of your choice.
- Flexible Installation**  
Simply surface mount and plug-in or fully-recess and direct wire for a seamless installation
- Hanging Glass Design**  
Detachable glass trim easily finishes rough openings and provides access to media.
- Remote Thermostat Control**  
Temperature control at your fingertips for convenient comfort.
- Multi-function Remote**  
Control the flame, heat and thermostat from the comfort of your chair.
- LED Lighting**  
Flame and lights use brilliant, low-energy LED's that require zero maintenance.
- All-season Flames**  
Enjoy the unique charm of a fireplace 365 days a year using the flames without the heat.
- Cool-touch Glass**  
Glass remains cool making it safe for any location and any user.
- Low Carbon Footprint**  
The most sustainable fireplace option, no emissions and 100% efficient.

SE-022-R06-041520

177-1



# Prism Series

## 50" Linear Electric Fireplace

BLF5051

### Product Dimensions:

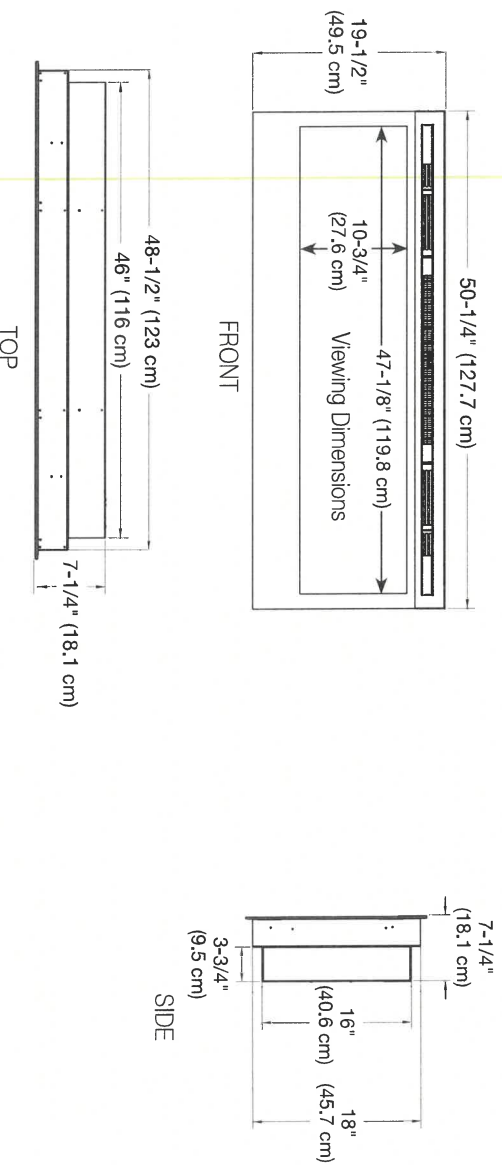

### Installation Options and Framing Dimensions

#### 3 Mounting Options

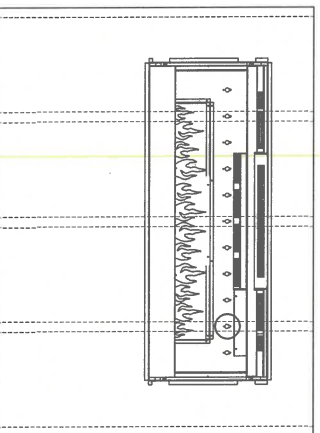

##### ON WALL

Must mount to a minimum of three (3) wall studs

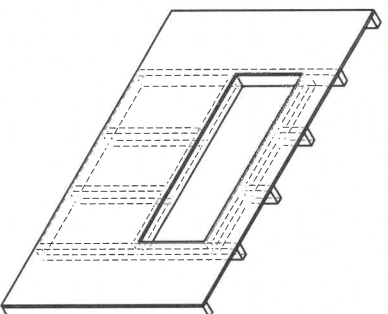

##### PARTIAL RECESSED

2 X 4 Wall Construction  
Framing dimensions:  
46-1/2" W x 16-1/2" H  
(118.1 cm) W x (42 cm) H

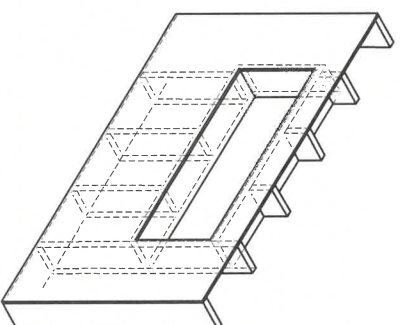

##### FULLY RECESSED

2 X 8 Wall Construction  
Framing dimensions:  
49" W x 18-1/2" H  
(124.5 cm) W x (47 cm) H

177-1