

CONSTRUCTION SUMMARY OF EXTRAS

Printed 2022-06-08 / 1:29 PM / Page 1 of 2

Site:  
Lot:  
Model:  
Purchaser:  
Purchaser:  
Phone:  
Email:

WASAGA  
174  
CORAL 60-04 ELEV. C  
F. CORTELLUCCI  
0  
SIMONE 416-843-7270  
SIMONE@ZANCORHOMES.COM



DESCRIPTION		DATE SELECTED
BONUS PACKAGE: 3 PIECE STAINLESS STEEL APPLIANCES WITH WHITE TOP LOAD WASHER & DRYER	INCLUDED IN APS	
BONUS PACKAGE: STAINLESS STEEL HOOD FAN	INCLUDED IN APS	
1 8 FOOT INTERIOR DOORS THROUGHOUT (x15) ***DOES NOT INCLUDE THE MUD ROOM CLOSET OR BASEMENT DOORS, WHERE POSSIBLE		5-May-22
2 SMOOTH CEILINGS THROUGHOUT		5-May-22
3 FIREPLACE - 50 INCH ELECTRIC BLF5051 (in lieu of 34") **BUMP OUT TO BE APPROX 72 INCHES WIDE		5-May-22
4 HARDWOOD IN STANDARD NON-TILES AREAS - UPGRADE 2		5-May-22
5 HARDWOOD IN KITCHEN AND BREAKFAST (in lieu of tile) - UPGRADE 2		5-May-22
6 HARDWOOD IN ALL BEDROOMS (in lieu of carpet)		5-May-22
7 KITCHEN - UPGRADE 1 CABINETS **TWO TONE		5-May-22
8 KITCHEN - ADD 3 FEET OF CABINETS ON STOVE WALL FOR BUILTIN OVEN MICROWAVE		5-May-22
9 KITCHEN - COOKTOP WITH POT DRAWERS BELOW		5-May-22
10 KITCHEN - FRIDGE ENCLOSURE		5-May-22
11 KITCHEN - DELETE UPPEBS ABOVE STOVE FOR FUTURE CHIMNEY HOOD FAN **CENTRE VENT		5-May-22
12 KITCHEN COUNTERTOP - UPGRADE 3		5-May-22
13 APPLIANCE UPGRADES		5-May-22
14 ELECTRICAL FOR COOKTOP - USE THE STANDARD 40 AMP **SEE SPEC		5-May-22
15 ELECTRICAL FOR BUILT-IN WALL OVENS **SEE SPEC		5-May-22
16 KITCHEN - INSTALL BANK OF DRAWERS IN LIEU OF POT DRAWERS BESIDE COOKTOP		5-May-22
17 KITCHEN - ADD 2 BIN GARBAGE PULL OUT IN ISLAND **INCREASE ISLAND AS REQUIRED		5-May-22
18 KITCHEN - DOUBLE RISER TO CEILING		5-May-22
19 KITCHEN - BASE PIE CORNER CABINET		5-May-22
20 MASTER ENSUITE - STONE COUNTERTOP - UPGRADE 3 **INCLUDES OVAL UNDERMOUNT SINK		5-May-22
21 MAIN BATH - STONE COUNTERTOP - UPGRADE 3 **INCLUDES OVAL UNDERMOUNT SINK		5-May-22
22 INTERIOR TRIM - UPGRADE 1 - COLONIAL		5-May-22
23 ELECTRICAL - ADD PLUG ABOVE FIREPLACE **CABLE ROUGH IN LOCATED BESDIE IT APPROX 65 INCHES OFF FLOOR		5-May-22
24 HVAC - HUMIDIFIER		5-May-22
25 HVAC - COMPLETE AIR CONDITIONING UNIT		5-May-22
26 ELECTRICAL - ADD POTLIGHTS IN KITCHEN (4) **STANDARD KITCHEN LIGHT TO BE CENTRED OVER ISLAND		5-May-22
27 ELECTRICAL - ADD CAPPED LIGHT IN LIBRARY ON SEP SWITCH		5-May-22
28 ELECTRICAL - ADD POTLIGHTS IN GREAT ROOM (4) **STANDARD LIGHT TO BE CAPPED		5-May-22
29 ELECTRICAL - ADD POTLIGHTS IN SIDE HALL (5) **STANDARD DELETED		5-May-22
30 UPGRADE PAINT THROUGHOUT		5-May-22
31 ELECTRICAL - ADD POTLIGHTS IN LAUNDRY / MUD (4) *DELETE STANDARD		5-May-22
32 ELECTRICAL - ADD POTLIGHTS IN DINING ROOM (2) *STANDARD REMAIN		5-May-22
33 ELECTRICAL - ADD CAPPED ROUGHIN OVER TUB IN MASTER ENSUITE ON SEP SWITCH		5-May-22
34 ELECTRICAL - ADD POTLIGHTS IN MASTER WALK IN CLOSET (2) *DELETE STANDARD		5-May-22
35 ELECTRICAL - ADD POTLIGHTS IN BASEMENT FOYER (2) *DELETE STANDARD		5-May-22
36 LIGHTS - UPGRADED FIXTURES ***TO BE INSTALLED BY ELECTRICIANS		5-May-22
37 ELECTRICAL - LIGHT & DOOR JAMB SWITCH INSIDE MAIN HALL CLOSET		5-May-22
38 ELECTRICAL - ADD POTLIGHTS IN MAIN HALL/STAIRS (3) *DELETE STANDARD		5-May-22
39 BLINDS - SUNCOVER		5-May-22
40 MASTER ENSUITE & MAIN BATH - CABINETS - UPGRADE 1		5-May-22
41 MASTER ENSUITE - ADD BANK OF DRAWERS		5-May-22
42 RAILINGS - UPGRADE 2		5-May-22
43 LAUNDRY - ADD OPTIONAL UPPER CABINETS		5-May-22
44 KITCHEN SINK - UPGRADE TO BLANCO 400890 ANTHRACITE		5-May-22

CONSTRUCTION SUMMARY OF EXTRAS

Printed 2022-06-08 / 1:29 PM / Page 2 of 2

Site: WASAGA  
Lot: 174  
Model: CORAL 60-04 ELEV. C  
Purchaser: F. CORTELLUCCI  
Purchaser: 0  
Phone: SIMONE 416-843-7270  
Email: SIMONE@ZANCORHOMES.COM



DESCRIPTION		DATE SELECTED
45	KITCHEN FAUCET - MOEN GENTA MATTE BLACK	5-May-22
46	KITCHEN BACKSPASH - UPGRADE 4 **INCLUDES CHIMNEY	5-May-22
47	FAUCETS - MOEN EVA SINGLE HOLE 6400 (MASTER X2, MAIN X1, POWDER X1)	5-May-22
48	MASTER ENSUITE SHOWER JAMB	5-May-22
49	BATHROOM ACCESSORIES- MOEN METHOD TOWEL BAR & TOILET PAPER HOLDER IN ALL BATHS	5-May-22
50	WATERLINE TO FRIDGE	5-May-22
		5-May-22

- Lighting Specs to follow -  
- Paint details to follow -

ENTRANCES				
Main Foyer - FLOORING		LOFT WHITE 12 X 24 *BRICK		
Mudroom - FLOORING		LOFT WHITE 12 X 24 *BRICK		
Side Hall - FLOORING		N/A		
Basement Foyer - FLOORING		LOFT WHITE 12 X 24 *BRICK		
KITCHEN				
Kitchen - FLOORING		HARDWOOD - VINTAGE WHITE OAK 5 INCH - ATLANTIS WIREBRUSH UVF (3)		
Breakfast - FLOORING		HARDWOOD - VINTAGE WHITE OAK 5 INCH - ATLANTIS WIREBRUSH UVF (3)		
Kitchen - CABINETS		SHAKER MDF - VANILLA MILKSHAKE (1)		
Island - CABINETS		SHAKER MDF - SAGE (1)		
Servey - CABINETS		N/A		
Kitchen - HANDLES/KNOBS		H800MB (BLACK)		
Kitchen - COUNTERTOP		EMERSTONE CALCATTA GOLD (3)		
Island - COUNTERTOP		EMERSTONE CALCATTA GOLD (3)		
Kitchen - BACKSPLASH		DART - SNOW WHITE MATTE (4) **INCLUDES BEHIND CHIMNEY		
Kitchen - SINK		UPGRADE - BLANCO SUPER SINGLE (SEE SPEC)		
Kitchen - FAUCET		UPGRADE - MOEN GENTA MATTE BLACK		
GREAT ROOM / DINING / LIVING / DEN / OFFICE / BASEMENT				
Family / Great Room - FLOORING		HARDWOOD - VINTAGE WHITE OAK 5 INCH - ATLANTIS WIREBRUSH UVF (3)		
Main Hall - FLOORING		HARDWOOD - VINTAGE WHITE OAK 5 INCH - ATLANTIS WIREBRUSH UVF (3)		
Dining / Living Room - FLOORING		HARDWOOD - VINTAGE WHITE OAK 5 INCH - ATLANTIS WIREBRUSH UVF (3)		
Library / Den - FLOORING		HARDWOOD - VINTAGE WHITE OAK 5 INCH - ATLANTIS WIREBRUSH UVF (3)		
Basement Rec Room - FLOORING		LOFT WHITE 12 X 24 *BRICK		
STAIRS				
Railing Details - PICKETS		UPGRADE 2 - ALL PLAIN BLACK METAL		
Railing Details - POSTS		UPGRADE - SQUARE OAK WITH REVEAL		
Railing Details - HANDRAIL		UPGRADE - SQUARE OAK		
Stair Stain - MAIN TO BASEMENT STAIRS		STAIN STAIRS TO MATCH HARDWOOD AS CLOSE AS POSSIBLE		
POWDER ROOM				
Powder Room - FLOORING		LOFT WHITE 12 X 24 *BRICK		
Powder Room - CABINETS		N/A		
Powder Room - COUNTERTOP		N/A		
Powder Room - SINK		PEDESTAL		
Powder Room - FAUCET		UPGRADE - MOEV EVA CHROME 6400		
2ND FLOOR				
Upper Hall - FLOORING		N/A		
Master Bedroom - FLOORING		HARDWOOD - VINTAGE WHITE OAK 5 INCH - ATLANTIS WIREBRUSH UVF (3)		
Bedroom 2 - FLOORING		HARDWOOD - VINTAGE WHITE OAK 5 INCH - ATLANTIS WIREBRUSH UVF (3)		
Bedroom 3 - FLOORING		HARDWOOD - VINTAGE WHITE OAK 5 INCH - ATLANTIS WIREBRUSH UVF (3)		
Bedroom 4 - FLOORING		N/A		
Bedroom 5 - FLOORING		N/A		
Master Ensuite - FLOORING		LOFT WHITE 12 X 24 *BRICK		
Master Ensuite - SHOWER WALL		COLOURS & DIMENSIONS 3 X 6 ARCTIC WHITE MATTE in lieu of floor tile **BRICK ***DARK GREY GROUT		
Master Ensuite - SHOWER FLOOR		WHITE 2 X 2		
Master Ensuite - SHOWER JAMB		MARMOLINE SNOW		
Master Ensuite - CABINETS		ADAMELLO 2 (UPG 1)		
Master Ensuite - HANDLES/KNOBS		H800MB (BLACK)		
Master Ensuite - COUNTERTOP		EMERSTONE BORGHINI CLASSIC (3)		
Master Ensuite - SINK(s)		Master Ensuite - FAUCET(s)		
		UPGRADE SINGLE HOLE		
***FOR TRADE USE***				
Any upgrades in the colour chart must be accompanied with a PES. It is the responsibility of all Trades to inform the builder of any discrepancies on sketches, PES and/or colour charts <u>PRIOR</u> to installation.		WASAGA SHORELINE 174		SIGNATURES
		**PAGE 1 OF 2**	PURCHASER INITIALS	VENDOR APPROVAL

*June 8/22*

2ND FLOOR CONTINUED...						
Main Bath - FLOORING				LOFT WHITE 12 X 24 *BRICK		
Main Bath - TUB / SHOWER WALL				LOFT WHITE 12 X 24 *STACKED		
Main Bath - SHOWER FLOOR				N/A		
Main Bath - SHOWER JAMB				N/A		
Main Bath - CABINETS				ADAMELLO 2 (UPG 1)		
Main Bath - HANDLES/KNOBS				H800MB (BLACK)		
Main Bath - COUNTERTOP				EMERSTONE BORGHINI CLASSIC (3)		
Main Bath - SINK(s)	OVAL UNDERMOUNT		Main Bath - FAUCET(s)	UPGRADE SINGLE HOLE		
Shared Bath- FLOORING				N/A		
Shared Bath- TUB / SHOWER WALL				N/A		
Shared Bath- SHOWER FLOOR				N/A		
Shared Bath- SHOWER JAMB				N/A		
Shared Bath- CABINETS				N/A		
Shared Bath- HANDLES/KNOBS				N/A		
Shared Bath- COUNTERTOP				N/A		
Shared Bath- SINK(s)			Shared Bath - FAUCET(s)			
Ensuite Bath - FLOORING				N/A		
Ensuite Bath - TUB / SHOWER WALL				N/A		
Ensuite Bath - SHOWER FLOOR				N/A		
Ensuite Bath - SHOWER JAMB				N/A		
Ensuite Bath - CABINETS				N/A		
Ensuite Bath - HANDLES/KNOBS				N/A		
Ensuite Bath - COUNTERTOP				N/A		
Ensuite Bath - SINK(s)			Ensuite Bath - FAUCET(s)			
LAUNDRY						
Laundry - FLOORING	LOFT WHITE 12 X 24 *BRICK		Laundry - HANDLES/KNOBS	H800MB		
Laundry - CABINETS & UPPERS	CONT. VANILLA MILKSHAKE		Laundry - SINK	STANDARD		
Laundry - COUNTERTOP	LAMINATE - 9527 SHALESTONE		Laundry - FAUCET	STANDARD		
Laundry - BACKSPLASH	N/A					
TRIM / PAINT						
Casing/Baseboards				UPGRADE 1 - COLONIAL		
Interior Doors				STANDARD STYLE - 8 FEET HIGH		
Interior Door Hardware				STANDARD		
PAINT - Throughout				UPGRADE - SEE FLOOR PLAN		
FIREPLACE						
Location / Insert / Mantle				50 INCH ELELCTRIC		
ACCESSORIES						
Mirrors	YES		BATH ACCESSORIES	UPGRADE		
APPLIANCE REQUIREMENTS						
GAS LINE TO BBQ	STANDARD		ELECTRICAL for Built-in Oven	YES		
GAS LINE & ELECTRICAL TO STOVE	N/A		ELECTRICAL for Built-in Micro	YES		
GAS LINE & ELECTRICAL TO DRYER	N/A		ELECTRICAL for Cooktop	YES		
HOOD FAN VENT SIZE	6 INCH		ELECTRICAL for Bar Fridge	N/A		
WATERLINE to Fridge	YES					
DISCLAIMER						
Any changes to the colour chart after signing are subject to a \$5000 administration fee plus costs						
Purchaser has checked and acknowledged accuracy of colour and selections before signing.						
Colours of all materials are as close as possible to Builders selection but not necessarily identical due to dye lot variances in manufacturing/manufacturers. Due to construction progress some items may have been pre-selected or installed. In this event the Vendor's selection must be accepted by the purchaser						
SITE / LOT:	WASAGA			174		
PURCHASER(S):	F. CORTELUCCI					
PURCHASER(S):	0					
CONTACT:	SIMONE 416-843-7270			SIMONE@ZANCORHOMES.COM		
***FOR TRADE USE***						
Any upgrades in the colour chart must be accompanied with a PES.						
It is the responsibility of all Trades to inform the builder of any discrepancies on sketches, PES and/or colour charts PRIOR to installation.						
			PURCHASER SIGNATURE			
			PURCHASER SIGNATURE			
			DÉCOR CONSULTANT			
			SIMONE			
			Vendor APPROVAL			

# SHORELINE POINT WASAGA BEACH

## CORAL 60-04

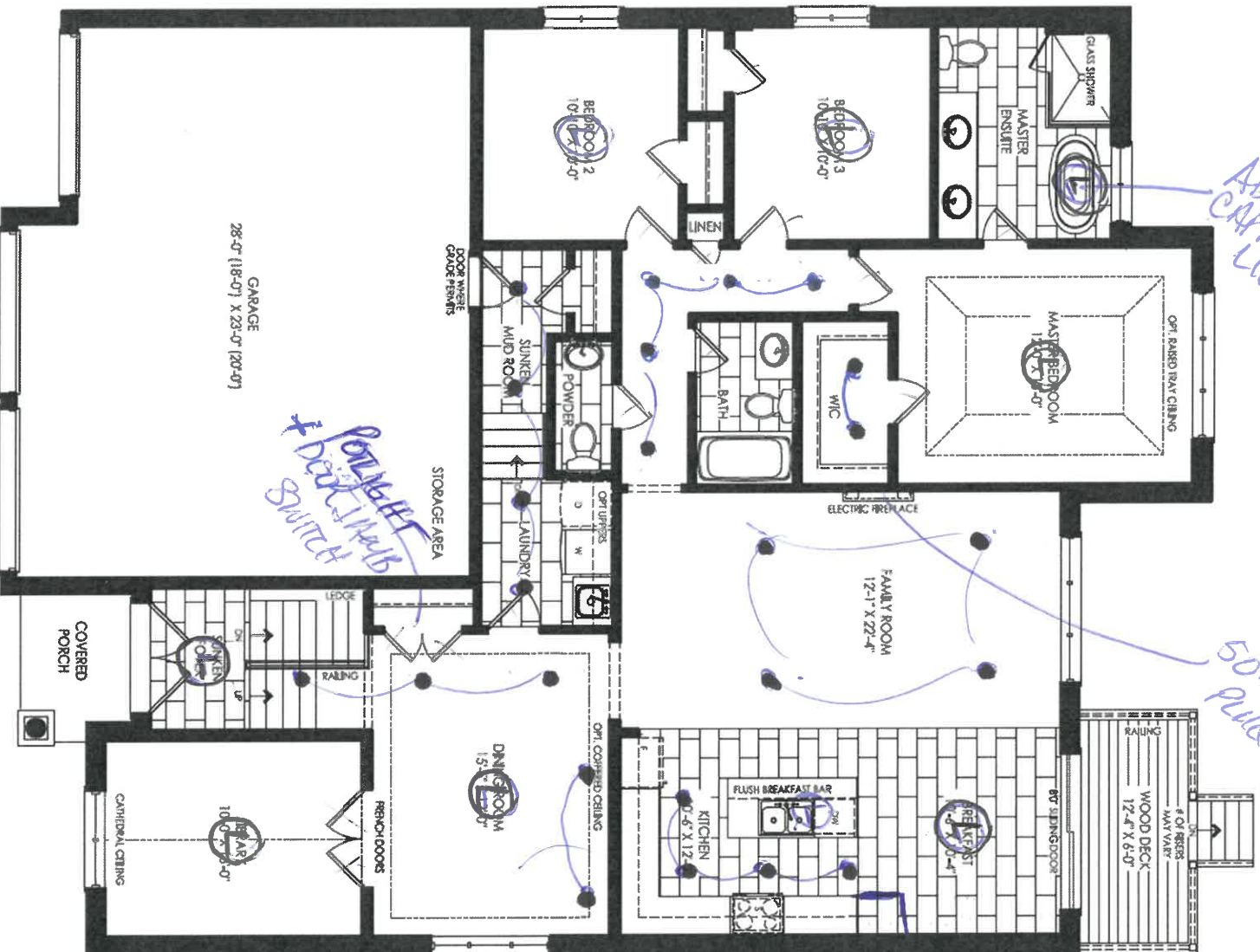

### Elevation A Ground Floor

- Ⓛ = POTLIGHT
- Ⓛ = CEILING LIGHT LOCATIONS
- \* WALL LIGHTS IN BATHROOMS TO REMAIN IN STD LOCATIONS

174 Ⓢ

CORAL 60-04

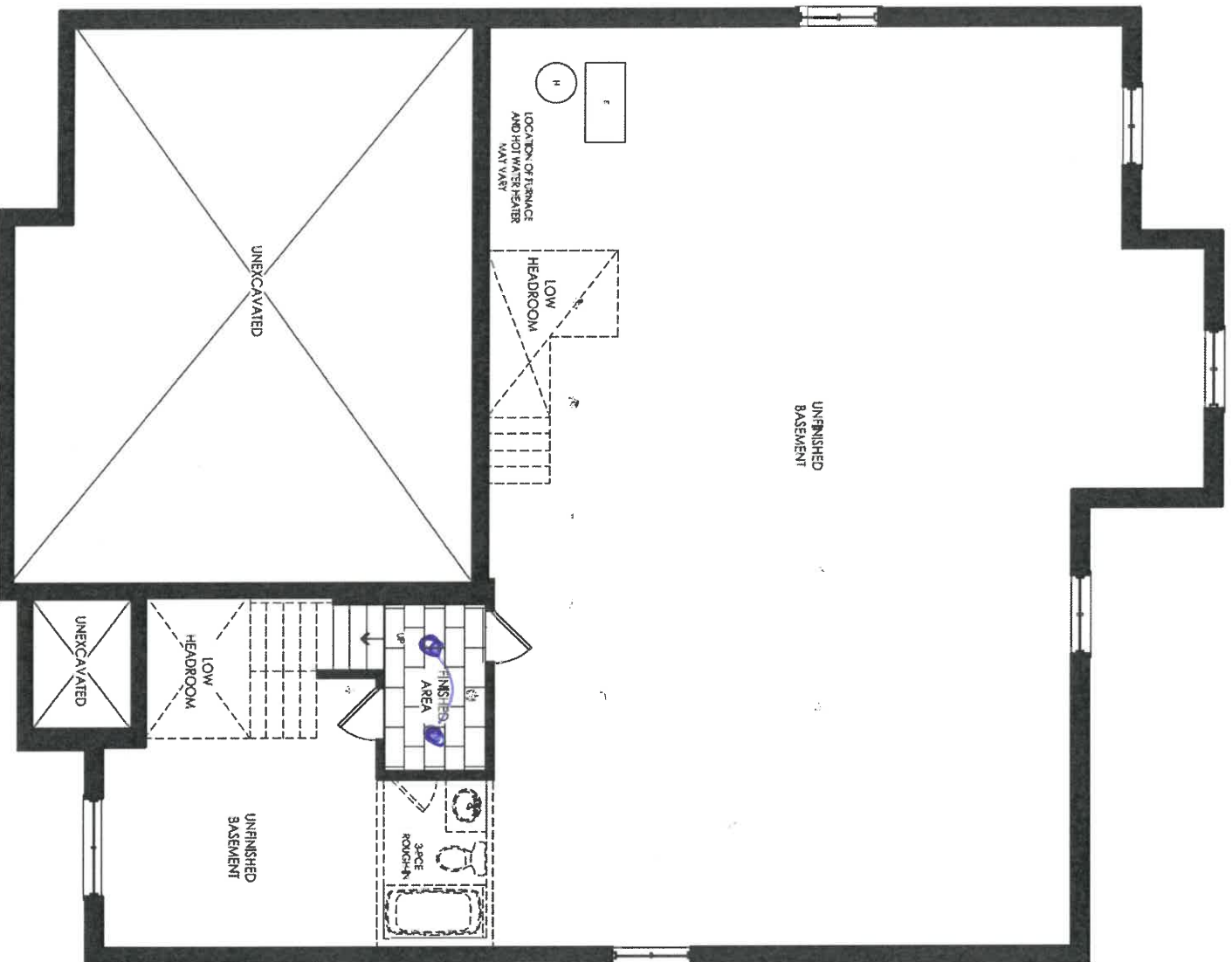

Elevation A  
Basement

Humidifier  
Air conditioner

1740

CORAL 60-04

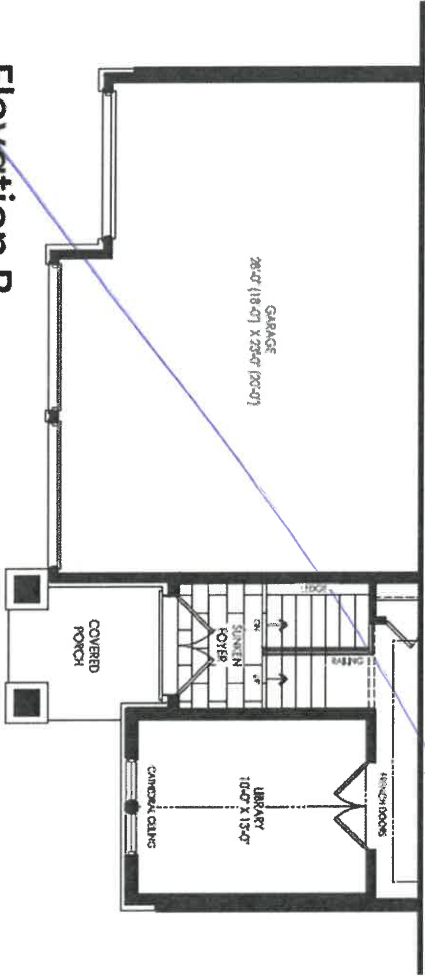

Elevation B  
Ground Floor

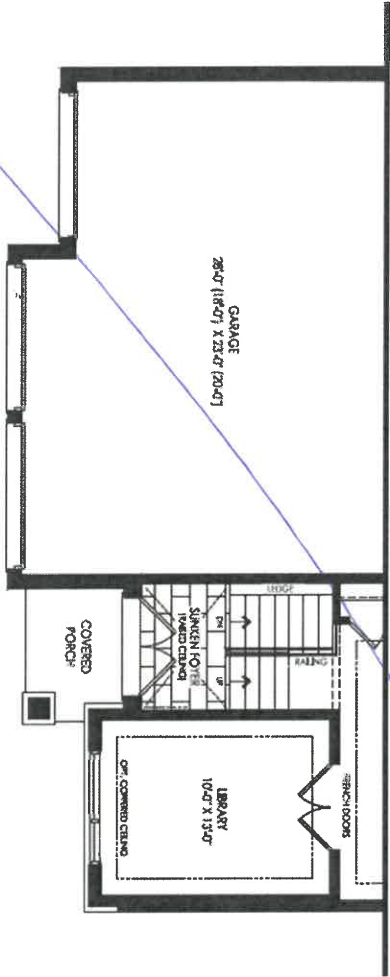

Elevation C  
Ground Floor

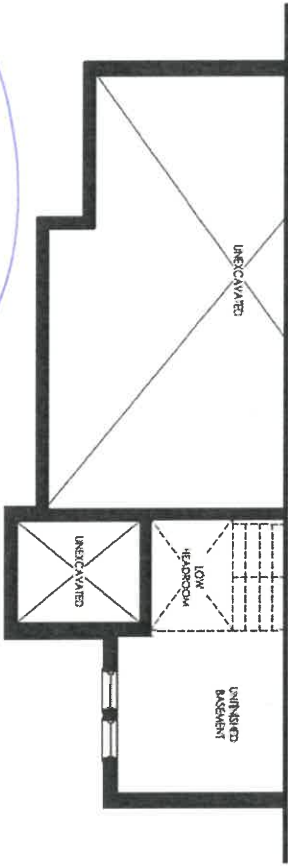

Elevation B  
Basement

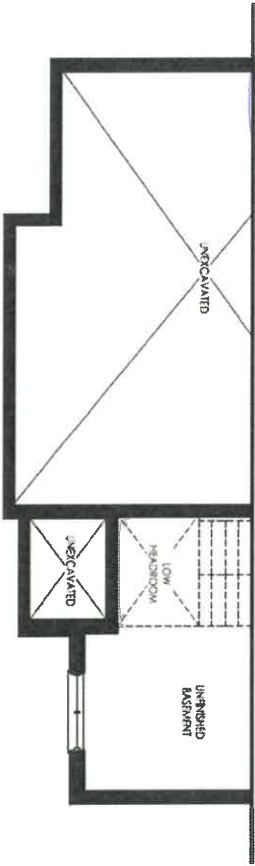

Elevation C  
Basement

# SHORELINE POINT

WASAGA BEACH

## CORAL 60-04

### The Coral



ALL ELEVATIONS INCLUDE 55 SQ. FT. OF FINISHED BASEMENT



174



DATE SUBMITTED  
16 Jun 2021

CLIENT NAME: ZANCOR HOMES  
SHIP TO : SHORELINE POINT

DRAFTED BY: FERNANDA  
PH:   
CELL:   
COMMENT

JOB NUMBER  
INSTALL DATE:  
PAGE  
20 of 22  
P/O #

60-04  
KITCHEN

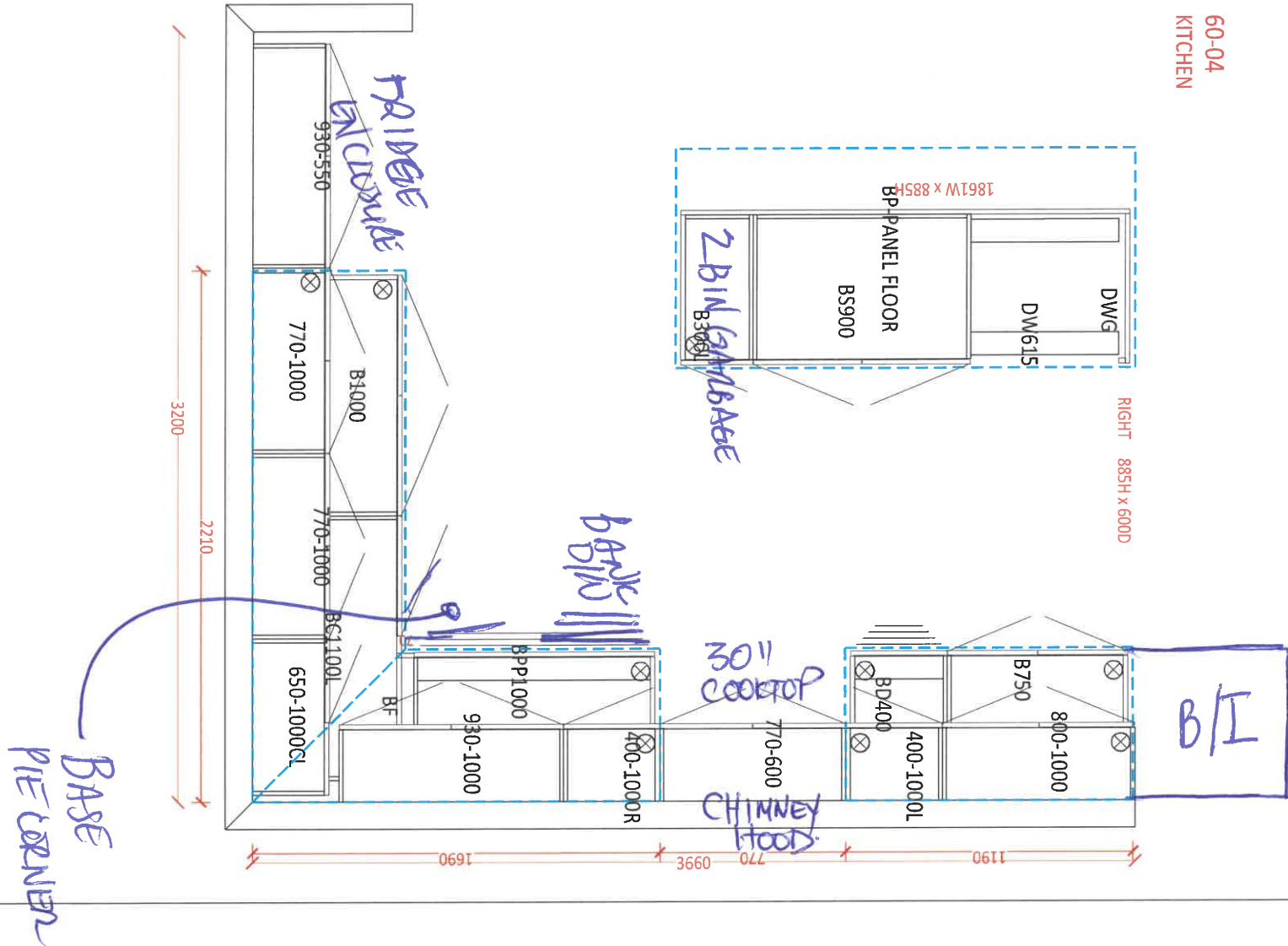

174



CLIENT NAME: ZANCOR HOMES  
SHIP TO : SHORELINE POINT

DRAFTED BY: FERNANDA  
COMMENT

PH:  
CELL :

DATE SUBMITTED  
16 Jun 2021

CS NUMBER

INSTALL DATE:

PAGE

21 of 22

P/O #

60-04

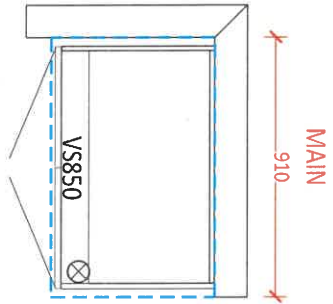

MASTER ENSUITE

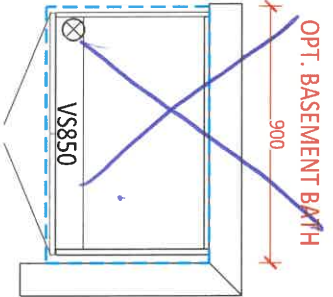
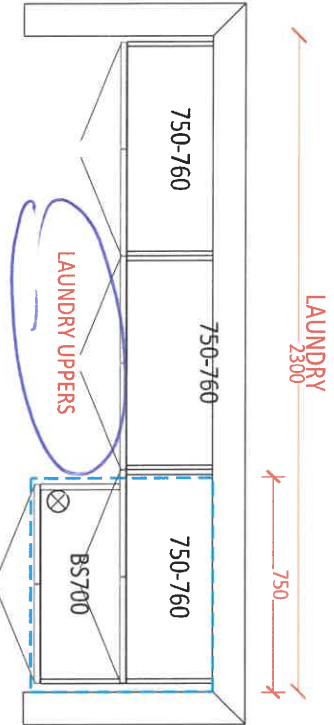
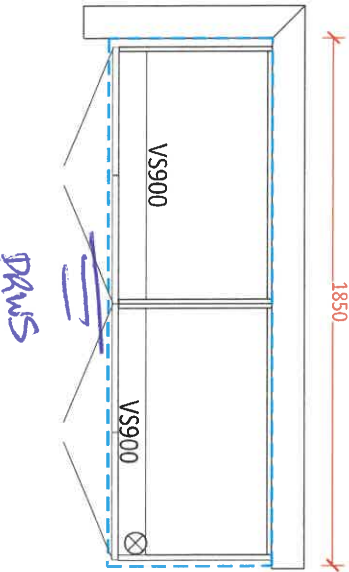

174



CLIENT NAME: ZANCOR HOMES  
SHIP TO : SHORELINE POINT

PH:  
CELL :

DRAFTED BY: FERNANDA  
COMMENT

DATE SUBMITTED  
16 Jun 2021

JOB NUMBERS

INSTALL DATE:

PAGE

22 of 22

P/O #

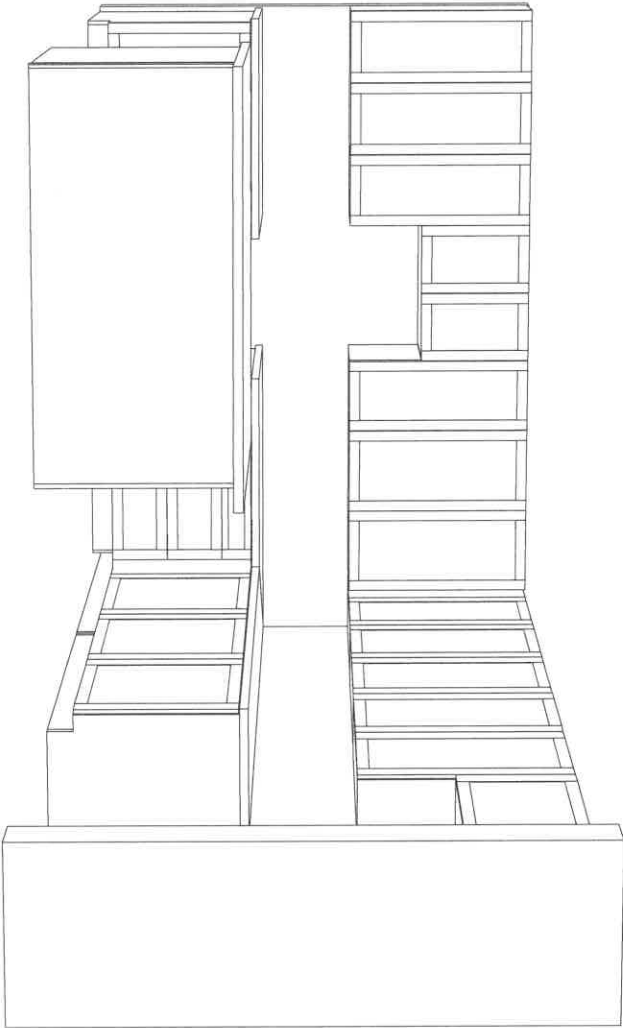

CALVIN  
19 1/4" OVAL UNDERMOUNT SINK

❑ 4220CFY Undermount Sink

Product Specs:

- Vitreous china
- Front overflow hole
- Template and mounting hardware supplied

Overall Dimensions (W x D x H):

(OD) : 490mm(19 1/4") x 410mm(16 1/8") x 195mm(7 7/8")  
(ID) : 430mm(17") x 350mm(13 3/4") x 145mm(5 3/4")

Compliance Certifications:

Meets or exceeds the following:

- IAPMO cUPC
- ASME A112.19.2 / CSA B45.1-2013

Shipping:

Cube 1.53  
GW 19 lbs



**Notes:**  
Dimensions of fixtures are nominal and may vary within the range of tolerances established by ASME standard A112.19.2. These measurements are subject to change or cancellation. No responsibility is assumed for use of superseded or voided pages.

\*Bone and Biscuit available through Direct Import (CIF) only.

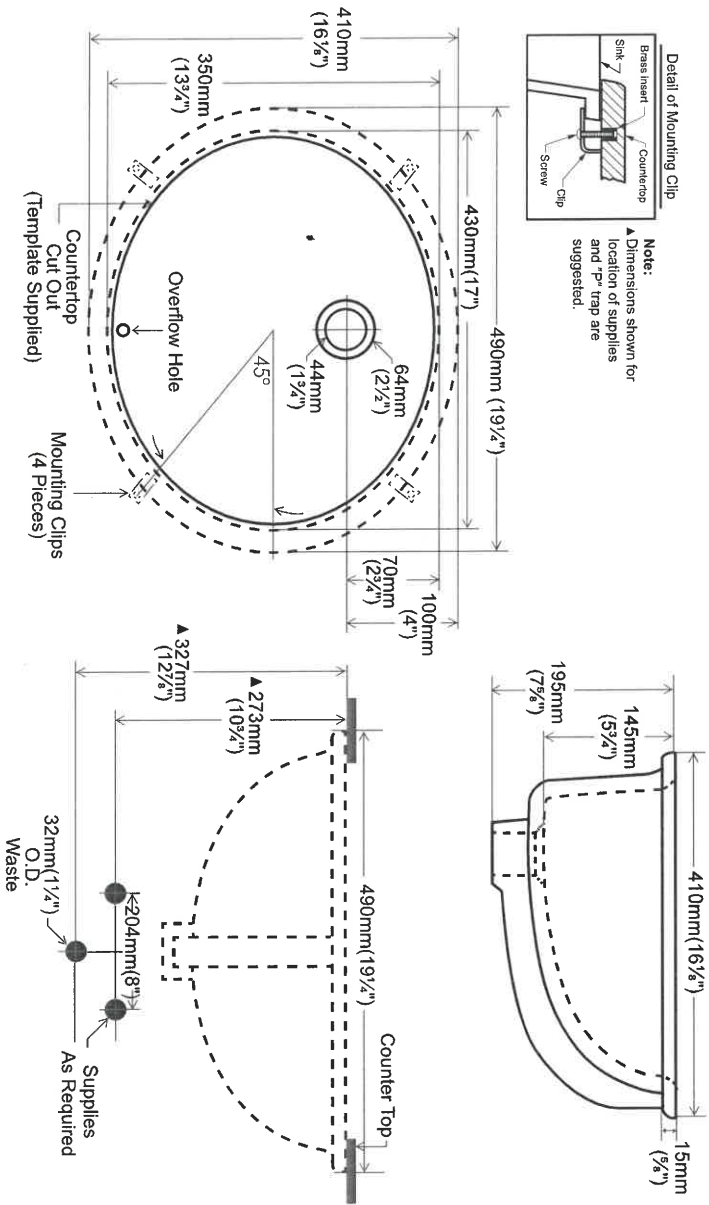

contrac®

5970 Chedworth Way, Unit A, Mississauga, ON, Canada L5R 3V5  
www.contrac.ca

Revised: January 2016

174 all baths  
(x3)

# BLANCO

## PRECIS U SUPER SINGLE SILGRANIT

Colour	SKU
Café	400889
Anthracite	400890
Truffe	401143
Cinder	401397
Metallic Grey	401683
White	401820
Concrete Grey	402266
Coal Black	402660

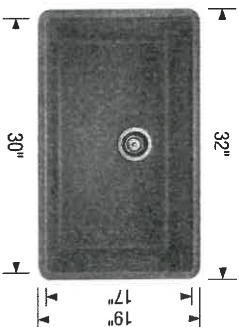

### Design and planning tips

- Min cabinet size: 36 in ( 915 mm )
- Bowl Depth: 9,5 in ( 240.0 mm )

#### Specifications:

Mounting clips, Sink template, Installation instructions, 3½" (90 mm) stainless steel strainer(s), Limited Lifetime Warranty

To protect from damage, this model should be shipped on a pallet.

Depending on cabinet construction, a different cabinet size may be required. Consult the cabinet manufacturer.

Codes/Standards: CSA B45.8-18/ IAPMO Z403-2018

ANTHRACITE

### Optional Accessories

CapFlow Strainer Cover	517666
Floating Grid	406535
Sink Grid	406446
Mesh Basket	406399

### Warranty

Limited lifetime warranty on all sinks and faucets. One-year warranty on all accessories and soap dispensers.

#### Code/Standards Compliance

BLANCO sinks and faucets are third-party tested and certified to CSA, cUPC, ANSI/ASME, IAPMO and NSF standards and listed by applicable certification bodies. For more information on individual product listings, contact our office or listing organization.



Need support? Learn more by watching our sink & faucet How-to videos:  
<https://www.blanco.com/ca-en/support/how-to-videos/how-to-videos-for-sinks/>



BLANCO Canada Inc  
100 Corporation Drive  
Brampton ON L6S 6B5

Tel & Fax  
Tel: 905-494-2400 Toll free: 1-877-425-2626  
Fax: 905-494-2425 Toll free: 1-877-825-2626

While BLANCO strives to provide accurate information, all images and dimensions in this document are intended for reference only and are subject to change at any time without notice. This document is not intended for use as an installation guide. For technical installation details, refer to installation instructions provided with the product. BLANCO assumes no responsibility for the use of superseded or voided specifications.

174

# Genta™ LX

KITCHEN



## FAUCETS



Single Handle Pulldown  
Kitchen Faucet

7882

Chrome

Other

Deckplate included

~~7882~~  
~~7882~~

Matte Black

Kitchen

## FINISH OPTIONS



Chrome (I), Matte Black (BL),  
Spot Resist™ Stainless (SRS)

To order, combine the model number with  
one of these finish letters: Matte Black  
(BL) & Spot Resist™ Stainless (SRS).  
To order Chrome (I) models, use model  
number only.

174

# Method™

Traditional | Transitional | Modern

~~\$1400~~ per bathroom for (2) items

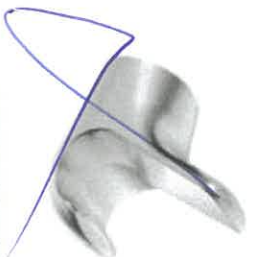

**Double Robe Hook**  
Model YB2403

Chrome  
Other



**Pivoting Paper Holder**  
Model YB2408

Chrome  
Other



**18" Towel Bar**  
Model YB2418

Chrome  
Other



**24" Towel Bar**  
Model YB2424

Chrome  
Other



**9" Towel Bar**  
Model YB2486

Chrome  
Other



CH BN

## FINISH OPTIONS:

To order, combine the model number with one of these finish letter(s):  
Chrome (CH), Lifeshine® Brushed Nickel (BN).

**PROOFIT™**  
INSTALLATION SYSTEM

174 All baths



LAVATORY FAUCETS

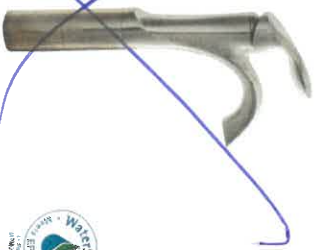

Single Handle Vessel Lav  
Faucet with Lift Rod Drain  
and Grid Drain Kit

6400 / A1717

Chrome

Other

Deckplate included



Single Handle Lav Faucet  
with Lift Rod Drain

6400

Chrome

Other

Deckplate included

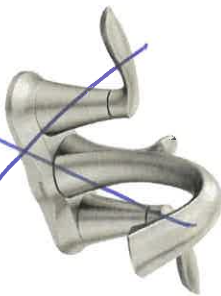

Two Handle Lav Faucet  
with Lift Rod Drain

6410

Chrome

Other

Deckplate included

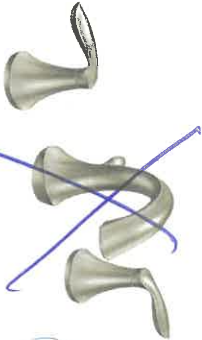

Two Handle Adjustable  
Widespread (8" - 16") Lav  
Faucet with Lift Rod Drain

T6420 / 49000

Chrome

Other

\$



Chrome

Master x1  
Powder x1  
main x1

EVA FINISH OPTIONS



Chrome, LifeShine® Brushed Nickel  
(BN), Oil Rubbed Bronze (ORB)

To order, combine the  
model number with  
one of these finish  
letter(s): LifeShine®  
Brushed Nickel (BN)  
& Oil Rubbed Bronze  
(ORB). To order  
Chrome (C) model, use  
model number only.

174



**Prism Series**  
50" Linear Electric Fireplace

BLF5051

The best-selling linear fireplace is now even better.



The best-selling electric linear fireplace just got better with the all new Prism Series. Sparkling with intensity in a full spectrum of colors, the Prism effect illuminates the diamond-like acrylic ice ember bed in a show-stopping effect. Plug-in or hard-wire, hung on the wall or built-in; the Prism Series is beautifully versatile.

**PRISM**  
series

174

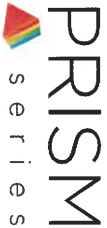

Prism Series  
50" Linear Electric Fireplace

BLF5051

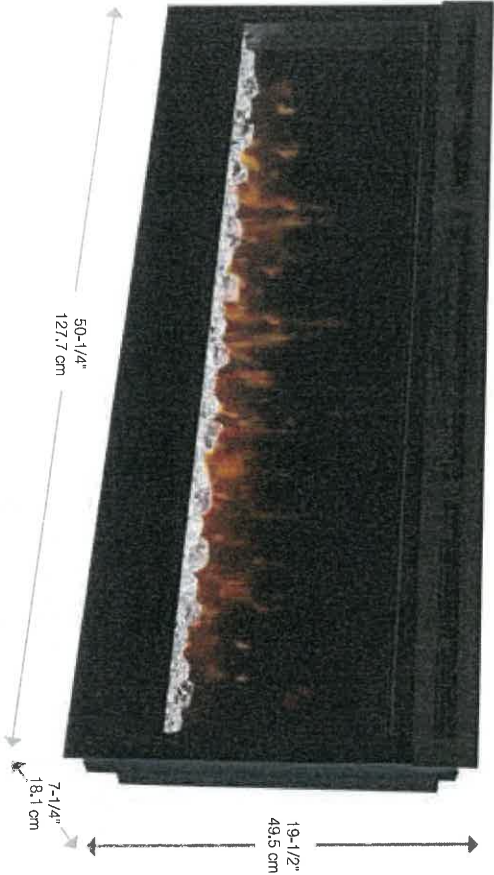

Accessories



Model #	Description	Lbs / Kg	UPC	Warranty	Carton Dimensions (WxHxD)		Cube	
					inches	cm	ft <sup>3</sup>	m <sup>3</sup>
BLF5051	50" Linear Electric Fireplace	75 / 34.1	781052 098787	2 yr.	55 x 23-1/4 x 12-7/8	139.7 x 58.9 x 32.7	9.5	0.26
DT1267BLK	Cohesion Trim - Black	51 / 23.1	781052 080355	1 yr	64-7/8 x 26-1/4 x 8-3/4	164.8 x 66.8 x 22.1	8.6	0.24
LF50DWS-KIT	50" Driftwood and River Rock Accessory Kit	7 / 3.17	781052 102842		34-1/4 x 5-7/8 x 8-1/8	87.2 x 14.98 x 20.6		

Specifications, finishes and dimensions are subject to change. \*Limited warranty. ©2020 Glen Dimplex Americas  
Glen Dimplex Americas | 1-800-668-6663 | [www.dimplex.com](http://www.dimplex.com)

Features

- The Original Dimplex Flame Effect™**  
A blend of technology, artistry and craftsmanship that sets the standard for realism.
- Acrylic Ice Media Bed**  
Light plays through different size pieces and sparkle in a spectrum of colors.
- Media Accent Colors**  
Choose from a variety of brilliant color themes or cycle through a range of colors using the custom mode, freezing on the hue of your choice.
- Flexible Installation**  
Simply surface mount and plug-in or fully-recess and direct wire for a seamless installation
- Hanging Glass Design**  
Detachable glass trim easily finishes rough openings and provides access to media.
- Remote Thermostat Control**  
Temperature control at your fingertips for convenient comfort.
- Multi-function Remote**  
Control the flame, heat and thermostat from the comfort of your chair.
- LED Lighting**  
Flame and lights use brilliant, low-energy LED's that require zero maintenance.
- All-season Flames**  
Enjoy the unique charm of a fireplace 365 days a year using the flames without the heat.
- Cool-touch Glass**  
Glass remains cool making it safe for any location and any user.
- Low Carbon Footprint**  
The most sustainable fireplace option, no emissions and 100% efficient.

174

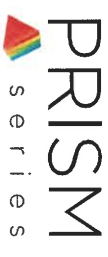

# Prism Series 50" Linear Electric Fireplace

BLF5051

## Product Dimensions:

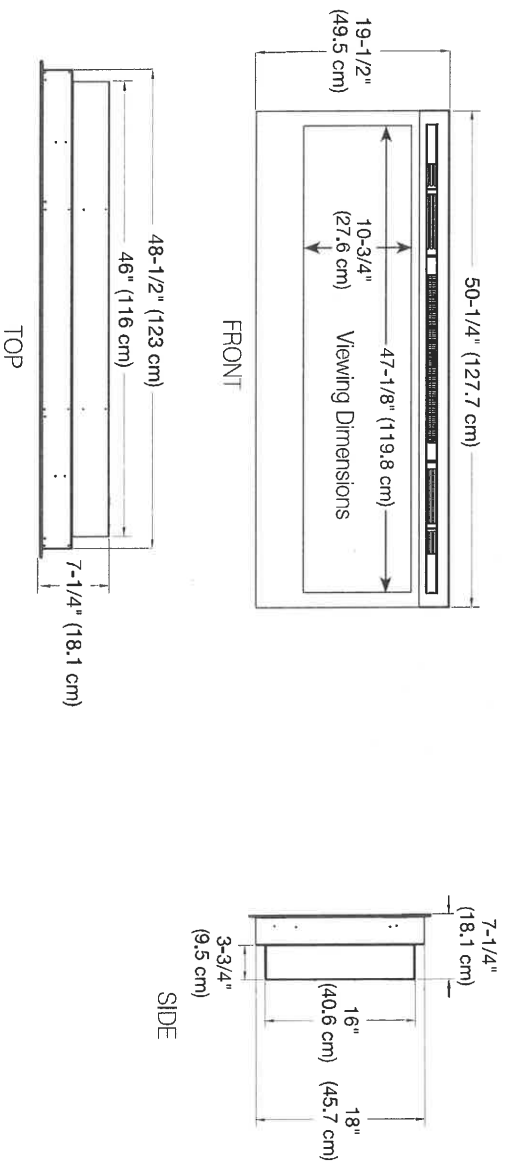

## Installation Options and Framing Dimensions

### 3 Mounting Options

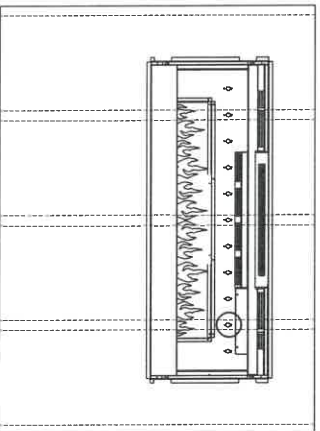

#### ON WALL

Must mount to a minimum of three (3) wall studs

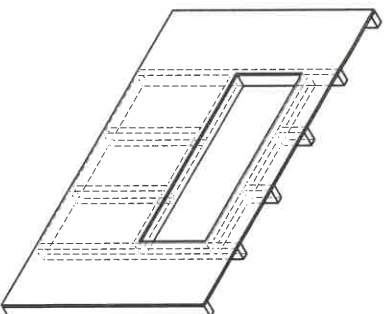

#### PARTIAL RECESSED

2 X 4 Wall Construction  
Framing dimensions:  
46-1/2" W x 16-1/2" H  
(118.1 cm) W x (42 cm) H

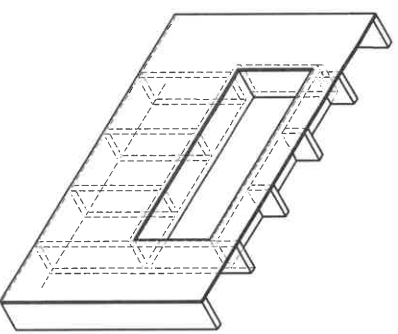

#### FULLY RECESSED

2 X 8 Wall Construction  
Framing dimensions:  
49" W x 18-1/2" H  
(124.5 cm) W x (47 cm) H

174

HOMIE APPLIANCES

LG COOKING

LWMC3063ST  
Combi Wall Oven

1.7 cu.ft. Microwave (Speed Oven)  
Infrared Heating™  
4.7 cu.ft. Oven  
Crisp Convection  
Self+EasyClean  
SmartThinQ® WiFi Technology



Enjoy new ways to control your home with LG smart appliances

- Start or stop your Oven remotely
- Set your Monitor Status from your smartphone
- Works with the LG SmartThinQ® app

SmartThinQ®

works with the Google Assistant

works with alexa

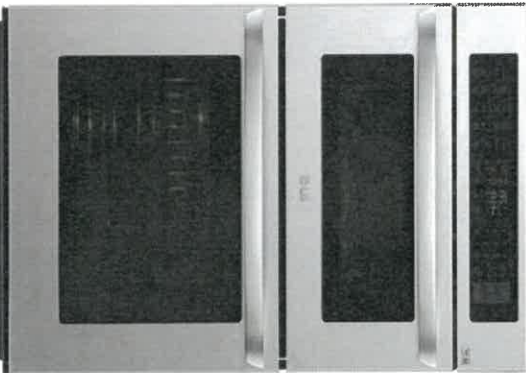

SUMMARY	
Total Oven Capacity (cu. ft.)	6.4 (Upper & Lower)
Colors	Stainless Steel
UPPER OVEN FEATURES	
Capacity (cu.ft)	1.7
Interior(Cavity) - Upper MW/O / Lower Oven	Stainless / Enamel Coating
Microwave Power output	950W
Microwave mode power consumption	1650W
Convection Bake mode power consumption	1550W
Broil mode power consumption	1650W
Convection Element (W)	1500W (Sheath heater)
Broil Upper Element (W)	1200W = 700W (Miracdon heater) + 500W (Infrared Heating™)
Broil Lower Element (W)	375W (Miracdon heater)
Microwave	Yes
Convection Bake	Yes
Broil	Yes
Speed cook	Yes (TurboCook™)
- # of Defrost (4 Menu)	Meat / Poultry / Fish / Bread Beverage / Casserole / Chicken / Pasta / Pizza / Plate of food / Rice / Soup / Vegetable
- # of Sensor cook (9 Menu)	Bacon (regular sliced) / Bagels (frozen) / Baked Corn dog (frozen) / Fresh vegetable / Frozen chicken wings / Frozen fries / Frozen chicken nuggets / Frozen pizza (regular crust) / Frozen soft pretzels / Frozen vegetable / Garlic bread (sliced, frozen) / Hamburger (1/2" thick) / Lamb chops (1/2" thick, 6-7oz) / Meat loaf (9" X 5") / Nachos / Oatmeal / Pork chops (1/2" thick, 6-7oz) / Quinoa / Rib eye steak (1" thick, 4-5oz) / Rice / Salmon steak (1" thick) / Sausage / Sirloin steak (1" thick, 16-21 oz) / Tenderloin / Vegetable-canned
- # of Soften (4 Menu)	Butter & Margarine / Cream Cheese / Ice Cream / Frozen Juice
- # of Melt (5 Menu)	Butter / Caramel / Cheese / Chocolate / Marshmallow
LOWER OVEN FEATURES	
Capacity (cu.ft)	4.7
EasyClean®	Yes
Self Clean	Yes (3-4.5 hours)
Variable cleaning time	Yes (3-4.5 hours)
Variable broil	Yes (Full/Center / High/Med/Low)
Broil element	2,500 watts inner / 1,500 watts outer
Bake element	2,500 watts
Bake element type	Hidden (8 pass)
# of rack position	5
12 hrs. shut-off	Yes
- # of light	3 (Halogen Lamp - 3 dimension lighting)
-Convection conversion	Yes
Convection element	Yes (2,000 watts Sheath heater)
Convection System/Mode/Cooking System	Conventional
Convection Fan	Dual Speed (High/Low)
Oven Cooking mode	Conv/Bake / Conv/Roast / Bake / Broil / Steam Bake / Steam Roast / Probe / more mode (Favorite/Warm/Proof)
Oven Control Features	Glass Touch (SmoothTouch™)
Door Lock	Yes

CONTROL	
Oven Control Type	Glass Touch (SmoothTouch™)
Display	White VFD
Language	English / French
Smart Function	Wi-Fi / Smart Buzzer
Clock	12 hr or 24 hr (option)
Kitchen Timer	Yes
Timed Cook	Yes
Temperature Unit of Measure	Fahrenheit / Celsius
Cooking Complete Reminder Volume	Beeper (1, Loud, 2, Low, 3, Mute)
APPEARANCE	
Available Colors	Stainless Steel
Handle/Knobs	Stainless Steel Finish (Aluminum)
Oven Door Feature	WideView™ Window
Scratch-Resistant	Yes
Smudge Resistant Finish	No
SmartThinQ® SMART FEATURES	
SmartDiagnosis™	Yes
Wi-Fi Connectivity	Yes
Works with	Google Assistant and Amazon Alexa
SmartThinQ® DIMENSIONS/CLEARANCES/WEIGHT	
Shipping Weight (lbs)	244 lbs
Product Weight (lbs)	194 lbs
Product (W x H x D)	29 3/4" x 43 13/16" x 24 1/2"
Cut-out (W x H x D)	28 1/2" x 43 8/19" x 23 1/2"
Overall Depth (in) - Including handle	26 7/8"
Actual Depth with Door Open (Lower) (in):	37 1"
Actual Depth with Door Open (Upper) (in):	45 7"
Oven Interior Dimensions (Upper) (in) (W x H x D)	20 8/11" x 8 9/25" x 17 5/13"
Oven Interior Dimensions (Lower) (in) (W x H x D)	24 1/2" x 17 5/8" x 18 7/8"
Carton Dimensions (in) (W x H x D)	33" x 30" x 50"
POWER/RATINGS	
Amp at 240V	32.5A
kW at 240V	7.8kW
Requirements	120 / 240 VAC, 120 / 208 VAC
ACCESSORIES	
Glass Tray(Upper)	Yes
Metal Tray(Upper)	Yes
Rack(Upper)	Yes
Broiler pan & Grid	Yes
Gliding Rack	1
Heavy Duty Rack	2
Meat probe	Yes
Scouring Pad	Yes
WARRANTY	
Parts & Labor	1 Year
UPC CODES	
LWMC3063ST (Stainless Steel)	048231339810

© 2018 LG Electronics Canada, Inc. All rights reserved. "LG Life's Good" is a registered trademark of LG Corp. All other product and brand names are trademarks or registered trademarks of their respective owners. Design, features and specifications are subject to change without notice. Non-metric weights and measurements are approximate. Some features may require Internet access. Content and services may vary by product and are subject to change without notice. 04/11/2019

174

## LG COOKING

# LWC3063ST

## Combi Wall Oven

## QUICK INSTALL & CLEARANCES

**For full installation directions/clearances please refer to the corresponding User Manual and Installation Guide.**

DIMENSIONS / CLEARANCES / WEIGHT	
Product Dimensions (in) (W x H x D)	29 3/4" x 43 13/16" x 24 1/2"
Cut-out (W x H x D)	28 1/2" x 43 8/9" x 23 1/2"
Overall Depth (in) - including handle	26 7/8"
Actual Depth with Door Open (Upper) (in):	37 1"
Actual Depth with Door Open (Lower) (in):	45 7"
Oven Interior Dimensions (Upper) (in) (W x H x D)	20 8/11" x 8 9/25" x 17 5/13"
Oven Interior Dimensions (Lower) (in) (W x H x D)	24 1/2" x 17 5/8" x 18 7/8"
Carton Dimensions (in) (W x H x D)	33" x 30" x 50"
POWER RATINGS	
Amp at 240V	32.5A
kW at 240V	7.8kW
Requirements	120 / 240 VAC, 120 / 208 VAC

## INSTALLATION REQUIREMENTS

- The cabinet base platform must be able to support 202 lbs. (91.65 kg) for a Microwave Combination Wall Oven. If the cabinet does not have a solid bottom, two braces or runners must be installed level with the bottom of the cutout to support the weight of the oven. Make sure the base is level and the front of the cabinet is square. If the cabinet base is not level, the oven racks will tend to slide out when opening the door.
- If marks, blemishes, or the cutout opening are visible above the installed oven, it may be necessary to add wood shims under the runners and front trim until the marks or opening are covered.
- If the cabinet does not have a front frame and the sides are less than 3/4" (1.9 cm) thick, shim both sides equally to establish the cutout width.
- The junction box must be flush with the rear wall of the cabinet as shown below.
- Allow at least a 2" clearance for the door depth when it is open.
- Kitchen cabinets in contact with the oven must be heat resistant up to 194°F (90°C), and fronts of nearby units up to at least 158°F (70°C).

## CUTOUT DIMENSIONS

- Cabinet Width: 30" (762 mm)
- Recommended Minimum  
Circuit Location  
from Floor: 12" (304.8 mm)
- Cutout Depth: 23 1/2" Min. (596.9 mm)
- Cutout Width: 28 1/2" Min. (723 mm)  
28 5/8" Max. (727 mm)
- Cutout Height: 43 7/16" Min. (1103 mm)  
43 1/2" Max. (1106 mm)

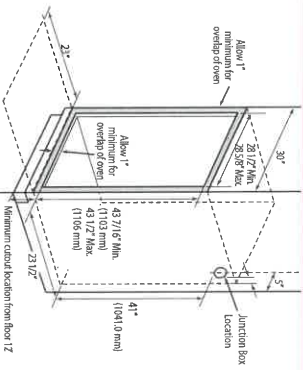

## PRODUCT DIMENSIONS

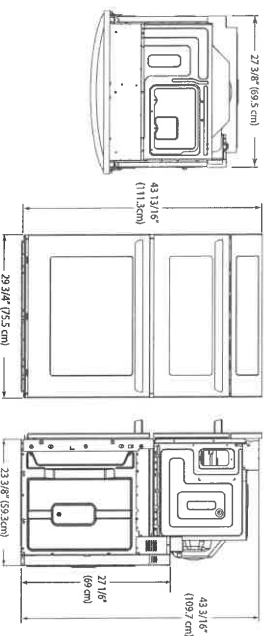

## ELECTRICAL CONNECTIONS

- **Be sure the wall oven is installed and grounded properly by a qualified installer or service technician.**
  - This wall oven must be electrically grounded in accordance with local codes or, in their absence, with the National Electrical Code (ANSI/NFPA No. 70 - latest edition in United States; or with CSA Standard C22.1 - 1992 and C22.2 No.01982 (or latest edition), Canadian Electrical Code, Part I, and all local codes and ordinances.
  - This wall oven must be supplied with the proper voltage and frequency, and connected to an individual, properly grounded branch circuit, protected by a circuit breaker or fuse. For the circuit breaker or fuse required by this model, see the rating plate to find the wattage consumption and refer to the table below to get the circuit breaker or fuse amperage.
  - A Microwave Combination Wall Oven can consume up to 7,800 W at 240 VAC. A 50 Amp circuit breaker with wire gauge #8 AWG must be used.
  - Do Not ground to a gas pipe.
  - A UL-listed conduit connector must be provided at the junction box.
  - **Prepare the electrical connection as follows:**
    - Turn off the circuit breaker or remove fuses to the oven branch circuit.
    - With the oven positioned directly in front of the cabinet opening, connect the flexible conduit to the electrical junction box as shown below. Position the conduit in such a manner that it will lie on top of the oven in a natural loop when the oven is installed.
    - If local codes permit connection of the frame grounding conductor to the neutral(white) wire, follow the instructions for a 3-wire circuit connection.
    - If used in mobile homes or new construction, or a recreational vehicle, or local codes do not permit connection of the frame grounding conductor to the neutral(white) wire, follow the instructions for a 4-wire circuit connection.
- 
- 5' Min
- 4' Min
- Junction Box Location
- For Microwave Combination Wall Ovens, the junction box must be requested and conduit connector must be used at junction box.

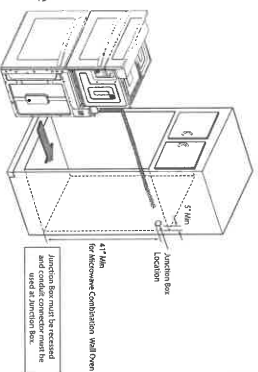

## INSTALL THE OVEN

- Install the oven into the cabinet as follows:**

- Slide the oven into the opening.
  - a. Loop (do not tie) a 36" (91 cm) string around the conduit before the oven is slid into place. Lay the string over the top of the oven and use it to keep the conduit from falling behind the oven.
  - b. Lift oven into cabinet cutout using the oven opening as a grip. Carefully push against the oven front frame. Do not push against outside edges.
  - c. While sliding the oven back, pull the string so that the conduit lies on the top of the oven in a natural loop.
  - d. When you are sure the conduit is out of the way, slide the oven 3/4 way back into the opening. Remove the string by pulling on one end of the loop.
- Secure the oven.

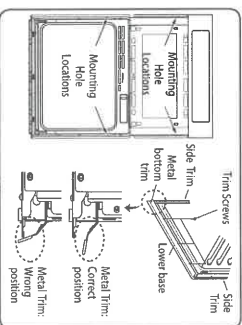

- purchased at any hardware store.
- Install the metal bottom trim.
  - a. Place the metal bottom trim centered over the pre-drilled mounting holes on the lower base.
  - b. Using 3 screws provided, secure the bottom trim to the bottom edge of the cabinet.
- Reinstall the oven door.



# INSTALLATION REQUIREMENTS

## Tools and Parts

Gather the required tools and parts before starting installation. Read and follow the instructions provided with any tools listed here.

### Tools needed

- Tape measure
- Marker or pencil
- 1/4" (6.35 mm) nut driver
- Pliers
- Flat-blade screwdriver

### Parts supplied

- Foam strip roll
- 2 1/2" (6.4 cm) clamping
- Clamping brackets (2)
- screws (2)

### Parts needed

- A UL listed or CSA approved connector for 1/2" (1.3 cm) diameter conduit
  - UL listed wire connectors
- Check local codes. Check existing electrical supply. See the "Electrical Requirements" section.
- It is recommended that all electrical connections be made by a licensed, qualified electrical installer.

## Location Requirements

**IMPORTANT:** Observe all governing codes and ordinances. When installing cooktop, use minimum dimensions given.

- To eliminate the risk of burns or fire by reaching over the heated surface units, cabinet storage space located above the surface units should be avoided. If cabinet storage is to be provided, the risk can be reduced by installing a range hood that projects horizontally a minimum of 5" (12.7 cm) beyond the bottom of the cabinets.
- The cooktop must be a specified cooktop that is approved to be installed either alone or over an undercounter built-in oven. Check the cooktop base for an approved installation label. If you do not find this label, contact your dealer to confirm that your cooktop is approved.
- The cooktop must be installed in a level countertop.
- Ovens approved for this type of installation will have an approval label located on the top of the oven. If you do not find this label, contact your dealer to confirm that your oven is approved. Refer to oven manufacturer's installation instructions for approval for built-in undercounter use and proper cutout dimensions.

- The cooktop should be installed away from strong draft areas, such as windows, doors, fans or strong heating vents. The cooktop should be located for convenient use in the kitchen.
- Use the countertop opening dimensions that are given with these installation instructions. Given dimensions are minimum clearances and provide 0" (0 cm) clearance.
- Grounded electrical supply is required. See "Electrical Requirements" section.

**IMPORTANT:** To avoid damage to your cabinets, check with your builder or cabinet supplier to make sure that the materials used will not discolor, delaminate, or sustain other damage.

## Product Dimensions

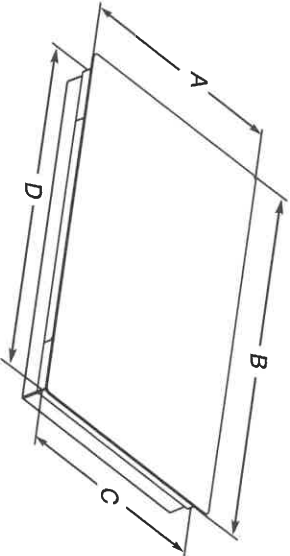

- A. Glass depth - black and white models - 21 3/4" (55.2 cm)  
Glass depth - stainless steel models - 22 1/8" (56.4 cm)
- B. Glass width - 24" (60.9 cm) models - 23 13/16" (60.5 cm)  
Glass width - 30" (76.2 cm) models - 30 13/16" (78.4 cm)  
Glass width - 36" (91.4 cm) models - 36 7/16" (92.3 cm)
- C. Frame depth - 20 1/4" (51.5 cm)
- D. Frame width - 24" (60.9 cm) models - 21 9/16" (55.7 cm)  
Frame width - 30" (76.2 cm) models - 28 15/16" (73.5 cm)  
Frame width - 36" (91.4 cm) models - 34 7/16" (87.5 cm)
- E. Cooktop height - 3 3/4" (9.6 cm)  
Cooktop height lighted knobs - 30" (76.2 cm) models - 4 15/16" (12.55 cm)  
Cooktop height lighted knobs - 36" (91.4 cm) models - 4 15/16" (12.55 cm)
- F. Cooktop height including conduit (located at rear of cooktop, right side) - 5 1/4" (13.5 cm)  
Cooktop height lighted knobs, including conduit (located at rear of cooktop, right side) - 30" (76.2 cm) models - 5 7/16" (13.5 cm)  
Cooktop height lighted knobs, including conduit (located at rear of cooktop, right side) - 30" (76.2 cm) models - 5 7/16" (13.5 cm)

30" Cooktop  
W CE55U30HS  
174

## Cabinet Dimensions

**IMPORTANT:** If installing a range hood or microwave hood combination above cooking surface, follow the range hood or microwave hood combination installation instructions for dimensional clearances above the cooktop surface.

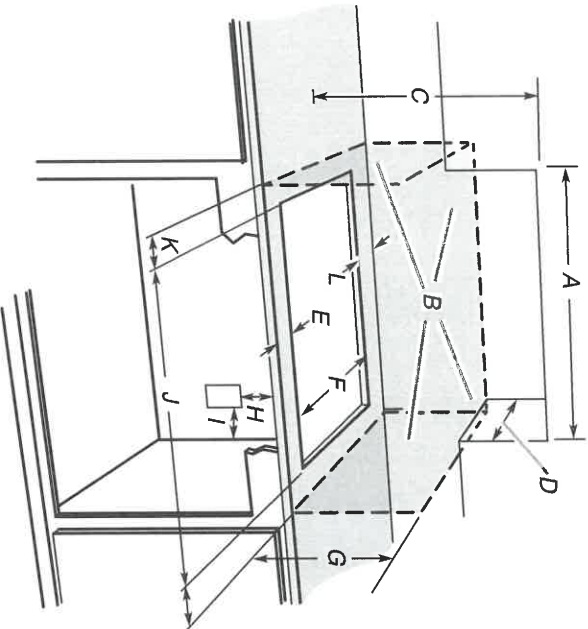

- A. 24" (60.9 cm) on 24" models; 30" (76.2 cm) on 30" models; 36" (91.4 cm) on 36" models
- B. Combustible area above countertop (shown by dashed box above)
- C. 30" (76.2 cm) minimum clearance between top of cooktop platform and bottom of uncovered wood or metal cabinet (24" [61 cm] minimum clearance if bottom of wood or metal cabinet is covered by not less than 1/4" [0.6 cm] flame retardant millboard covered with not less than No. 28 MSG sheet steel, 0.015" [0.04 cm] stainless steel, or 0.024" [0.06 cm] aluminum or 0.020" [0.05 cm] copper)
- D. 13" (33 cm) recommended upper cabinet depth
- E. 2" (5.1 cm)
- F. 20 1/2" (52.0 cm) recommended cutout. Will fit in cutout from 20 5/8"-20 7/8" (51.8-52.2 cm).
- G. 18" (45.7 cm) minimum clearance from upper cabinet to countertop within minimum horizontal clearances to cooktop
- H. Junction box or outlet: 7" (17.8 cm) minimum from top of countertop
- I. Junction box or outlet: 9" (23.0 cm) maximum from right side of cabinet
- J. 29 1/2" (74.9 cm) recommended cutout on 30" (76.2 cm) models. Will fit in cutout from 29 1/8"-29 7/8" (73.8-75.1 cm) on 30" (76.2 cm) models.
- K. 35 1/2" (90.2 cm) recommended cutout on 36" (91.4 cm) models. Will fit in cutout from 34 5/8"-35 3/8" (87.8-90.3 cm) on 36" (91.4 cm) models.
- L. 22 3/4" (56.67 cm) recommended cutout on 24" (60.96 cm) models.
- M. 2 1/2" (6.35 cm) minimum distance to nearest left and right side combustible surface above cooktop
- N. 1 1/2" (3.81 cm) minimum clearance between back wall and countertop

**NOTES:** After making the countertop cutout, some installations may require notching down the base cabinet side walls to clear the cooktop base. To avoid this modification, use a base cabinet with sidewalls wider than the cutout.

If cabinet has a drawer, a 5 1/2" (14.0 cm) depth clearance from the top of the countertop to the top of the drawer (or other obstruction) in base cabinet is required.

## Electrical Requirements

### ⚠ WARNING



#### Electrical Shock Hazard

Disconnect power before servicing.

Use 8 gauge copper wire.

Electrically ground cooktop.

Failure to follow these instructions can result in death, fire, or electrical shock.

If codes permit and a separate ground wire is used, it is recommended that a qualified electrical installer determine that the ground path and wire gauge are in accordance with local codes.

Check with a qualified electrical installer if you are not sure the cooktop is properly grounded.

Make sure that the electrical connection and wire size are adequate and in conformance with the National Electrical Code, ANSI/NFPA 70-latest edition or CSA Standards C22.1-94, Canadian Electrical Code, Part 1 and C22.2 No. 0-M91-latest edition, and all local codes and ordinances.

A copy of the above code standards can be obtained from:

National Fire Protection Association  
1 Batterymarch Park  
Quincy, MA 02169-7471  
CSA International  
8501 East Pleasant Valley Road  
Cleveland, OH 44131-5575

#### Before You Make the Electrical Connection:

To properly install your cooktop, you must determine the type of electrical connection you will be using and follow the instructions provided for it here.

A 3-wire or 4-wire, single phase, 120/240 volt, 60-Hz., AC only electrical supply is required on a separate, 40-amp circuit fused on both sides of the line. The model/serial number plate is located on the metal cabinet underneath the cooktop. See the following illustration.

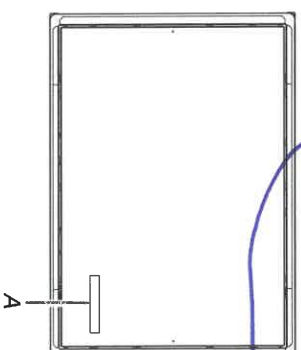

A. Model/serial number plate

- The cooktop is rated 120/240 volt. Some models have a neutral (white) wire.

HOME APPLIANCES  
LG REFRIGERATION

LFXC22526  
22 cu.ft. Counter Depth 3-Door French Door Refrigerator

- Smudge Resistant Finish
- 10 Year Warranty on Inverter Linear Compressor
- Slim SpacePlus® Ice System
- Dual Ice Maker in freezer
- Door Cooling+
- Glide N' Serve Pantry Drawer
- SmartThinQ® - WiFi Connectivity
- Fresh Air Filter
- Flat Duct design
- SmartPull™ Handle
- ENERGY STAR®



SmartThinQ®

works with the  
Google Assistant

WORKS WITH  
alexa

Enjoy new ways to control your  
home with LG smart appliances

- Get an alert when kids forget to close the door
- Make more ice while you're at work
- Works with the LG SmartThinQ® app

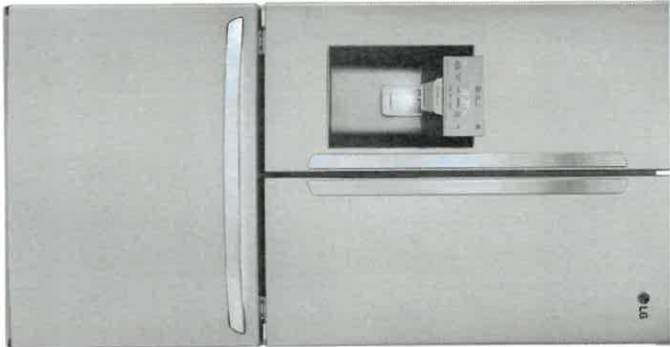

CAPACITY	
Refrigerator (cu.ft.)	14.8
Freezer (cu.ft.)	7.3
Total Capacity (cu.ft.)	22.1
ENERGY	
Energy Consumption (kWh/Year)	665
ENERGY STAR® Qualified	Yes
WATER & ICE SYSTEM	
Ice & Water Dispenser	Yes
Dispenser Type	Integrated Tall
Ice System	Slim SpacePlus®
Dual Ice Maker	Installed
Dispenser Light	Yes
Water Filter	LT1000P
COOLING	
Inverter Linear Compressor	Yes
Multi-Air Flow	Yes
Temperature Sensors	6
Fresh Air Filter	Yes
CONVENIENCE	
Display Type	Membrane / White LED
Temperature Controls	Electronic/Digital
Door Alarm	Yes
Lockbell™ Quiet Operation	Yes
REFRIGERATOR	
No. of Shelves	4 Split
Cantilevered Shelves	Hybrid Cantilevered
Shelf Construction	Spill Protector™ tempered Glass
Crisper Bins	2 Humidity Crispers
Glide N' Serve Pantry Drawer	Yes
Refrigerator Light	Ceiling LED
REFRIGERATOR DOOR	
No. of Bins	6 Total
Door Bin Construction	1 Piece (Clear)
Door Cooling+	Yes

FREEZER	
Door Type	Pull Drawer
Drawers	2-Tier Organization
DuraBase™ Solid Drawer Base	Yes
Drawer Divider	Yes
Freezer Light	LED Lighting
Freezer Handle	SmartPull™ Handle
SmartThinQ® SMART FEATURES	
Wi-Fi Enabled	Yes
SmartDiagnosis	Yes
MATERIALS AND FINISHES	
Contour Door	Yes
Hidden Hinges	Yes
Smudge Resistant Finish	Yes
Handles	Matching Commercial
Available Colours	Smudge Resistant Stainless Steel

DIMENSIONS/CLEARANCES/WEIGHTS	
Depth with Handles	31 1/4"
Depth without Handles	28 3/4"
Depth without Door	24 3/4"
Depth (Total with Door Open)	43 1/2"
Height to Top of Case	68 3/8"
Height to Top of Door Hinge	69 3/4"
Width	35 3/4"
Width (Door Open 90° with Handle)	44 1/4"
Width (Door Open 90° without Handle)	39 1/4"
Door Edge Clearance with Handle	4 1/2"
Door Edge Clearance without Handle	1 3/4"
Installation Clearance	Sides 1/8", Top 1", Back 2"
Weight (Unit/Carton)	271 lbs. / 301 lbs.
Carton Dimensions (WxHxD)	38" x 73" x 36"
WARRANTY	
Part & Labour	1 Year
Sealed System	5 Years
Inverter Linear Compressor	10 Years
UPC CODES	
LFXC22526S (Smudge Resistant Stainless Steel)	048231797238
LFPC22526D (Smudge Resistant Black Stainless Steel)	048231797245

© 2018 LG Electronics Canada Inc. All rights reserved. "LG Life's Good" is a registered trademark of LG Corp. All other product and brand names are trademarks or registered trademarks of their respective owners. Design, features and specifications are subject to change without notice. Non-metric weights and measurements are approximate. Some features may require Internet access. Content and services may vary by product and are subject to change without notice. 08/20/2018

20 Nordolo Drive, North York, Ontario M9L 2K6 Tel: 647-253-6300 | Customer Service & Parts 1-888-542-2623

LG.com

174

LDFN4542S  
Front Control Dishwasher with  
QuadWash® and EasyRack® Plus

★★★★★ 4.5 (494) Write a review

- QuadWash®
- Inverter DirectDrive® Motor with 10 Year Warranty
- EasyRack® Plus System with 3rd Rack
- Dual Zone Wash
- ThinQ® - NFC Technology

○○  
SMUDGE RESISTANT STAINLESS STEEL

WHERE TO BUY

ADD TO COMPARE

Dishwasher

OVERVIEW

SPECS

REVIEWS

SUPPORT

WHERE TO BUY

QuadWash®



ThinQ®

QuadWash®  
DirectDrive® Motor + 10  
Year Warranty

EasyRack® Plus

ThinQ®

174

SUMMARY

01/13

CAPACITY	DIMENSIONS (WXHXD)
15 Total Place Settings	23 3/4" x 33 5/8" x 24 5/8"

STEAM TECHNOLOGY	THING®
No	Yes - NFC Technology

BRAND

LG Brand	Yes
----------	-----

CONTROL

Front Control	Yes
---------------	-----

HANDLE

Pocket Handle	Yes
---------------	-----

DISHWASHERS FEATURE

TrueStream®	No
-------------	----

3rd Rack	Yes
----------	-----

Tub Light	No
-----------	----

Thing®	NFC Technology
--------	----------------

Smudge Resistant Finish	Yes
-------------------------	-----

ENERGY STAR®	Yes
--------------	-----

SOUND LEVEL

Sound Level (dB)	48
------------------	----

174

CAPACITY

Total Place Settings	15
Upper Rack Dish Height Limit	9.0"
Lower Rack Dish Height Limit	12.5"

DLB

RACKS AND BASKETS

Cutlery Baskets	Yes
Fold Down Tines	Yes
BPA-Free Nylon Coated Racks and Tines	Yes
Height Adjustability	Yes - Easy One Touch (3 Level)
EasyRack® Plus System	Yes
EasyRack® Plus System: Height Adjustable Upper Rack	Yes

STYLE AND DESIGN

Electronic Controls	Touch
Tub Material	NeverRust™ Stainless Steel
Tub Insulation	Damping Sheet, Sound Absorbing Material (felt), Base
Handle	Flush Handle
Available Colors	Smudge Resistant Stainless Steel, White

FEATURES

LoDecibel™ Quiet Operation	48 dBA
Slim Direct Drive Motor	Yes
Overflow Detector	Yes
120°F Inlet Water Capability	Yes
3-Stage Filtration System	Yes
SenseClean™ Wash System	Yes
Vario Wash	Yes

174

Variable Spray Intensities	Yes
No. of Spray Arms	3 (Top, Upper, Lower)
Hybrid Condensing Drying System	Yes
Detergent and Rinse-Aid Dispenser	Yes
Rinse-Aid Indicator	Yes
Hidden Water Heater	Yes
Leak Protection	Yes
Soil (Turbidity) Sensor	Yes
End of Cycle Indicator	Beeper + END Indication on Display

## PERFORMANCE

Number of Wash Cycles	9 (Auto, Heavy, Delicate, Normal, Turbo, Download Cycle, Machine Clean, Rinse, Express)
Number of Wash Options	8 (Dual Zone, Half Load, Energy Saver, High Temp, Extra Dry, Delay Start (up to 12 hrs), Control Lock, Night Dry)
QuadWash®	Yes

## ENERGY/WATER

Water Factor (WF)	2.9
Energy Use (kWh/Year)	258 kWh/Year
ENERGY STAR® Qualified	Yes
CEE Tier	1

## DIMENSIONS

Unit Dimensions (WxHxD)	23 3/4" x 33 5/8" x 24 5/8"
Depth with Door Closed (Handle)	24 5/8"
Depth with Door Open	49 1/4"
Carton Dimensions (WxHxD)	28" x 34 7/8" x 29 5/8"
Weight (Unit/Carton)	75 lbs / 88.2 lbs

LIMITED WARRANTY

Limited Warranty	1 Year on Parts / Labour 5 Years on PCB, Rack, Stainless Steel Door Liner, Tub 10 Years on Inverter Direct Drive® Motor
------------------	---

UPC CODES

LDFN4542S (Smudge Resistant Stainless Steel) 048231341943

174



AVH-308CS  
30" Wall mounted hood

Selected Model	
Model number	AVH-308CS
Dimensions	
Dimensions	29 1/2" (W) x 19 3/4" (D) x 3 1/4" (H)
Exterior Appearance	
Stainless steel grade	201
Features	
Control	Soft touch with LED display
Lighting	2 bulbs, 3W LED (bulbs included)
Blower type	860 CFM, 6-Speed
Blower performance	Speed 1, 2.4 sones Speed 6, 6.2 sones
Filter type	2 aluminum micro hole filters (included) 2 Stainless steel baffle filters (included)
Duct transition	6" Round (Top)
Ducting	Ducted
Chimney (ducted out)	For ceiling heights up to 9'0"
UPC code	0712038976799
Electrical Requirements	
Electrical requirements	120V / 60Hz / 2.7 Amps
Accessories (Optional)	AD-884S (884mm, AVN-AVH compatible)
Optional duct covers	
Warranty	
1-year Warranty	Parts and labour, in-home service

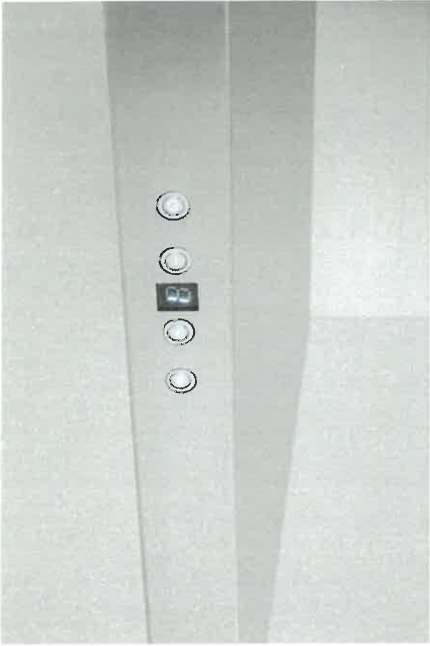

The information contained herein is based on sources that we believe to be reliable, but is not guaranteed by us, may be incomplete or may change without notice

174

AVH-308CS/368CS

Dimensions

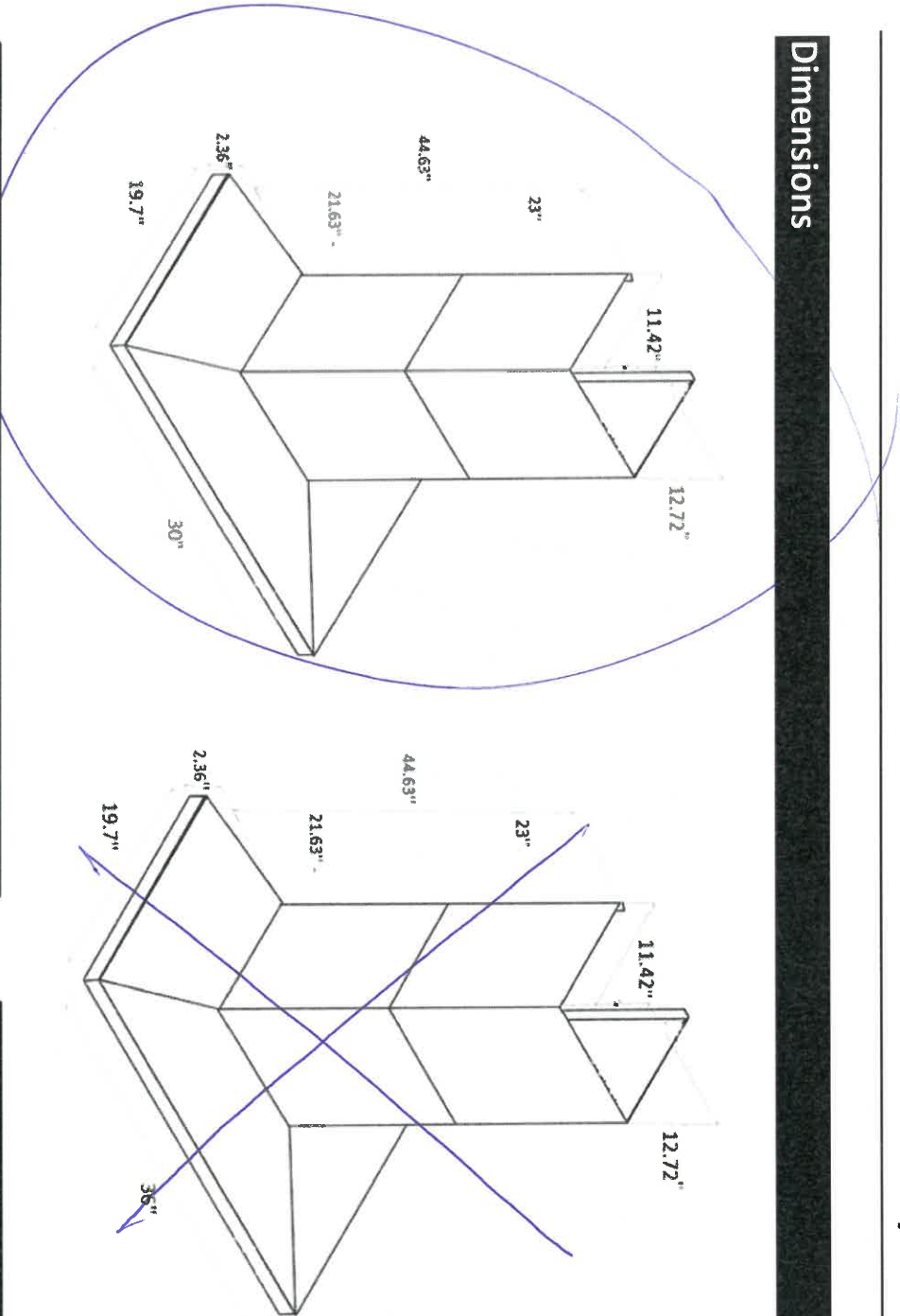

Installation

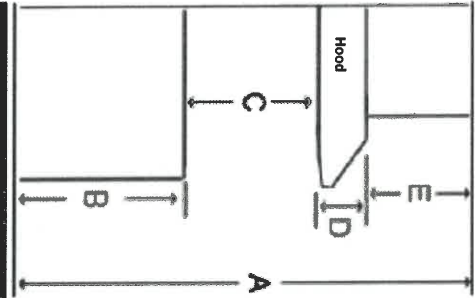

A	Floor to ceiling height	variable
B	Floor to counter top height (standard)	36"
C	Recommended height between cooking surface and bottom of the hood	28" to 30"
D	Hood height	2.36"
E	Chimney height	Max 44.63"

Duct transition

6" round top



The information contained herein is based on sources that we believe to be reliable, but is not guaranteed by us, may be incomplete and/or may change without notice.

Need technical support? 1(888) 651-2534

174