

CONSTRUCTION SUMMARY OF EXTRAS

Printed 2022-07-06 / 5:37 PM / Page 1 of 4

Site: RIVERS EDGE WASAGA
Lot: 116
Model: SPRINGWATER (50-03) ELEV C
Purchaser: ANTHONY VENUTO
Purchaser: ENZA VENUTO
Phone: 416.895.8212 / 416.995.2388
Email: AVENUTO@INTOUCHMORTGAGESOLUTIONS.COM



DESCRIPTION		DATE SELECTED
BONUS PACKAGE: STAINLESS STEEL HOOD FAN		INCLUDED IN APS
STRUCTURALS		
9 FOOT BASEMENT CEILING (FROM THE STANDARD 8') ** THERE MIGHT BE BULKHEAD/DROPS IN THE CEILING DUE TO REQUIRED MECHANICALS OR LOW HEADROOM IN SPECIFIC AREA WITH SUNKEN FLOOR, RAISED FLOOR, OPEN SPACES AND COFFERED CEILINGS, BULKHEAD IF REQUIRED. IF POSSIBLE		04-Feb-22
FRAMELESS GLASS SHOWER (FROSTED) IN LIEU OF CLEAR		04-Feb-22
SMOOTH CEILINGS- MAIN FLOOR INLIEU OF STRIPPLE		04-Feb-22
GAS LINE TO STOVE, INCLUDES 15 AMP. 40 AMP TO REMAIN		04-Feb-22
GAS FIREPLACE SL-5F FUSION 36" DIRECT VENT (INCLUDES STANDARD MANTLE, CERAMIC LOG SET) (IN LIEU OF ELECTRIC) ** TOWNSHIP PERMITTING		04-Feb-22
ACCESSORY PACKAGE FOR GAS FIREPLACE, INCLUDES FAN KIT AND TOUCHSCREEN REMOTE		04-Feb-22
8 FOOT INTERIOR DOORS ON MAIN FLOOR, IN LIEU OF (6'8")- CLEARANCES PERMITTED- QTY 12- SEE SKETCH--- CONFIRM QTY WHEN FLOOR PLAN CHANGES CONFIRMED		04-Feb-22
FRONT DOOR - MENNIE MAH8-RP, INCLUDES MULTI-POINT LOCK ***PEEPHOLE WILL BE INSTALLED IF REQUIRED*** 42 INCHES-- SEE SPEC--- QTY 1		04-Feb-22
SIDEITE FOR FRONT DOOR, APPROX 12 INCHES WIDE - QTY 1-INSTALL ON LEFT SIDE- SEE SKETCH		04-Feb-22
GARAGE INSULATION TO FRAMED EXTERIOR WALLS ONLY FOR NON-HABITABLE AREAS **FOUNDATION AND ROOF WILL NOT BE INSULATED		04-Feb-22
SOUND INSULATION BETWEEN MASTER BEDROOM AND GREAT ROOM- SEE SKETCH		04-Feb-22
8" HOOD FAN VENT ABOVE STOVE (IN LIEU OF STANDARD 6")		04-Feb-22
SMOOTH CEILINGS IN STANDARD FINISHED AREAS IN BASEMENT, AS PER PLAN		04-Feb-22
ADDITIONAL 3 PIECE ROUGH IN FOR BATHROOM IN BASEMENT, UNFINISHED AREA-SEE SKETCH		04-Feb-22
SOUND INSULATION FOR POWDER ROOM- SEE SKETCH		04-Feb-22
WET BAR ROUGH IN UNFINISHED SPACE: SINK ROUGH IN, DISHWASHER ROUGH IN, ELECTRICAL IS INCLUDED. ELECTRICAL FOR FRIDGE- 15AMP ON A SEPARATE CIRCUIT		04-Feb-22
ELECTRIC- 50 AMP PLUG TO ACCOMMODATE FUTURE ELECTRIC CAR LOCATED IN GARAGE- SEE SEKTC		04-Feb-22
AIR CONDITIONING UNIT		04-Feb-22
NA		04-Feb-22
NA		04-Feb-22
NA		04-Feb-22
NA		04-Feb-22
REVISED LAYOUT INCLUDES ADJUSTMENTS BELOW		04-Feb-22
SHIFT AND RELOCATE MAIN BATH. INCREASE SIZE OF BEDROOM 3- SEE SKETCH		04-Feb-22
INCREASE SIZE OF BREAKFAST AREA, INCLUDES ADDITIONAL STANDARD TILES IN BREAKFAST--SEE SKETCH		04-Feb-22
MASTER ENSUITE BATHROOM- REDESIGN-INCREASE SHOWER, RELOCATE TOILET, RELOCATE AND REDUCE WINDOW, INCREASE VANITY- SEE SKETCH		04-Feb-22
ADDITIONAL CABINETS IN MASTER ENSUITE BATHROOM- STANDARD		04-Feb-22

CONSTRUCTION SUMMARY OF EXTRAS
Printed 2022-07-06 / 5:37 PM / Page 2 of 4

Site: RIVERS EDGE WASAGA
Lot: 116
Model: SPRINGWATER (50-03) ELEV C
Purchaser: ANTHONY VENUTO
Purchaser: ENZA VENUTO
Phone: 416.895.8212 / 416.995.2388
Email: AVENUTO@INTOUCHMORTGAGESOLUTIONS.COM



DESCRIPTION		DATE SELECTED
COLOURS		
1	ELECTRICAL- 2 CAPPED LIGHTS OVER KITCHEN ISLAND, SPACED EVENLY ON SEPARATE SWITCH	02-Jun-22
2	ELECTRICAL- PLUG FOR TV INSTALLED OVER FIREPLACE, BESIDE CABLE. INSTALL 65 AFF- GREAT ROOM	02-Jun-22
3	ELECTRICAL- PLUG FOR TV INSTALLED 65 AFF BESIDE CABLE. MASTER BED- SEE SKETCH	02-Jun-22
4	ELECTRICAL- PLUG FOR TV INSTALLED 65 AFF BESIDE CABLE. REC ROOM SEE SKETCH	02-Jun-22
5	ELECTRICAL- KITCHEN POTLIGHT- QTY6- ON SAME SWITCH, SPACE EVENLY. DELETE STD LIGHT	02-Jun-22
6	ELECTRICAL- POTLIGHT GREAT ROOM- QTY 7, ON SEPARATE SWITCH. SPACE EVENLY. STD LIGHT TO REMAIN- SEE SKETCH	02-Jun-22
7	ELECTRICAL- 4 X POTLIGHT IN BREAKFAST, SPACE EVENLY ON SEPARATE SWITCH. STD LIGHT TO REMAIN- SEE SKETCH	02-Jun-22
8	ELECTRICAL- POTLIGHT IN MASTER BEDROOM- QTY 4 SPACE EVENLY, STD LIGHT TO REMAIN- SEE SKETCH	02-Jun-22
9	ELECTRICAL- POTLIGHT IN MASTER BATHROOM- QTY 3- SPACE EVENLY, WITH SEPARATE SWITCH- SEE SKETCH	02-Jun-22
10	EXTERIOR POT LIGHT ON PORCH, CENTER IN CEILING- SEPARATE SWITCH. SEE SKETCH	02-Jun-22
11	ELECTRICAL- EXTERIOR POTLIGHT ON FRONT OF HOUSE, SEPARATE SWITCH- QTY 6- SEE SKETCH	02-Jun-22
12	ELECTRICAL- POTLIGHT IN MAIN BATH TUB, SAME SWITCH AS STANDARD LIGHT- SEE SKETCH	02-Jun-22
13	ELECTRICAL- QTY 2 IN MAIN BATH, SPACE EVENLY ON SEPARATE SWITCH- SEE SKETCH	02-Jun-22
14	ELECTRICAL- QTY 2 POTLIGHT IN BASEMENT BATH, SEPARATE SWITCH- SEE SKETCH	02-Jun-22
15	ELECTRICAL- QTY 5 POTLIGHT IN HALLWAY, SAME SWITCH, DELETE STD LIGHT- JUNE 3, 2022	02-Jun-22
16	ELECTRICAL- QTY 4 POTLIGHT IN BEDROOM 3, SPACE EVENLY, ON SEPARATE SWITCH. STD LIGHT TO REMAIN	02-Jun-22
17	ELECTRICAL- QTY 4 POTLIGHT IN BASEMENT REC ROOM. SPACE EVENLY ON SEPARATE SWITCH. SEE SKETCH	02-Jun-22
18	PLUG IN GARAGE QTY 2- SEE SKETCH	02-Jun-22
19	JUNCTION BOX IN MASTER- QTY 2, MAIN AND BASEMENT BATH. I INSTALL BOX AT SAME HEIGHT/LOCATION OVER SINK AS STANDARD LIGHT. DELETE STD LIGHT--- ALL BATHROOMS	02-Jun-22
20	ELECTRICAL- 1 CAPPED ROUGH IN LIGHT IN GARAGE, ON SEPARATE SWITCH- SEE SKETCH	02-Jun-22
21	NA	02-Jun-22
22	ELECTRICAL- UNDER VALANCE TO MATCH CABINET, INCLUDES ELECTRICAL- LED TAPE LIGHTING, WITH SWITCH. INCLUDES EXTRA FOR ADDITIONAL CABINETS	02-Jun-22
23	RISER AND CROWN INSTALLED OVER CABINETS, CROWN INSTALLED AT CEILING, INCLUDES EXTRA FOR ADDITIONAL CABINETS	02-Jun-22
24	NA	02-Jun-22
25	BUILT IN WALL OVEN/MICRO WITH POT AND PAN DRAWERS BELOW AND CABINET ABOVE- SEE SPEC/ SKETCH	02-Jun-22
26	ELECTRICAL FOR WALL OVEN- 30 AMP	02-Jun-22
27	3 FEET APPROX OF ADDITIONAL CABINETS, UPPER AND BASE TO ACCOMMODATE WALL OVEN- SEE SKETCH	02-Jun-22
28	36" COOKTOP- WITH POT AND PAN DRAWERS BELOW IN LIEU OF CABINETS. INCLUDES SOFT CLOSE. SEE SKETCH/ SPEC	02-Jun-22
29	COOKTOP CUT OUT	02-Jun-22
30	ADDITIONAL 3 FEET APPROX OF BASE CABINET AND COUNTERTOP FOR KITCHEN ISLAND- SEE SKETCH	02-Jun-22
31	APPROX 18 INCHES OF PANTRY, SINGLE DOOR. INCLUDES SOFT CLOSE	02-Jun-22
32	PANTRY PULL OUT DRAWERS- QTY 3 LOCATED AT BOTTOM HALF, STANDARD SHELVES ABOVE	02-Jun-22
33	FRIDGE ENCLOSURE- DEEP UPPER AND GABLE	02-Jun-22
34	TWO BIN GARBAGE AND RECYCLING BIN- RICHELIEU 4614100- SEE SKETCH	02-Jun-22
35	PLUMBING--ROUGH IN AND FAUCET FOR POT FILLER-MODERN TWO HANDLE POT FILLER FAUCET WITH DUAL SHUT OFFS- S665-MATTE BLACK- SEE SPEC AND SKETCH	02-Jun-22
36	POT AND PAN DRAWERS, INCLUDES SOFT CLOSE- SEE SKETCH	02-Jun-22
37	TRANSITIONAL HOOD RANGE INCLUDING FAN (MDF FINISH TO MATCH CABINETS, IF POSSIBLE)- 40" WIDE IF POSSIBLE. INCLUDES GREY SMOKED MIRROR- SEE SPEC	02-Jun-22
38	PLUMBING- WATERLINE FOR FRIDGE	02-Jun-22
39	KITCHEN COUNTERTOP- UP 3	02-Jun-22
40	KITCHEN CABINET- UP 2	02-Jun-22
41	KITCHEN BACKSPLASH SLAB- UP 3,	02-Jun-22

CONSTRUCTION SUMMARY OF EXTRAS

Printed 2022-07-06 / 5:37 PM / Page 3 of 4

Site: RIVERS EDGE WASAGA

Lot: 116

Model: SPRINGWATER (50-03) ELEV C

Purchaser: ANTHONY VENUTO

Purchaser: ENZA VENUTO

Phone: 416.895.8212 / 416.995.2388

Email: AVENUTO@INTOUCHMORTGAGESOLUTIONS.COM



	DESCRIPTION	DATE SELECTED
42	HARDWOOD IN MASTER BEDROOM, BEDROOM 3- UP 3	02-Jun-22
43	HARDWOOD IN KITCHEN/ BREAKFAST- UP 3	02-Jun-22
44	KITCHEN CABINET HARDWARE- ARROWHEAD MATTE BLACK- 320MM TO GO ON POT DRAWERS ONLY- QTY 10 AND 128MM ON CABINETS- QTY 27- JUNE 1, 2022	02-Jun-22
45	NA	02-Jun-22
46	HARDWARE FOR CABINETS- MASTER BATH	02-Jun-22
47	FOYER TILE- UP 4	02-Jun-22
48	POWDER ROOM TILE- UP 4	02-Jun-22
49	HARDWOOD- FAMILY ROOM, LANDINGS, MAIN HALL- UP 3	02-Jun-22
50	STAIN FOR STAIRS TO MATCH HARDWOOD AS CLOSE AS POSSIBLE - 1 FLIGHT	02-Jun-22
51	RAILING- UP 2	02-Jun-22
52	MASTER BATH FLOOR- 12 X 24- UP 4- BRICKED	02-Jun-22
53	MASTER BATH SHOWER WALL 12 X 24- UP 4- BRICKED	02-Jun-22
54	MASTER BATH CABINET- UP 1	02-Jun-22
55	MASTER BATH JAMB	02-Jun-22
56	MASTER BATH COUNTERTOP- UP 5, INCLUDES UNDERMOUNT SINKS	02-Jun-22
57	MASTER BATH SHOWER FLOOR- UP 2	02-Jun-22
58	NA	02-Jun-22
59	BANK OF DRAWERS IN MASTER, MAIN AND BASEMENT BATH	02-Jun-22
60	LAUNDRY ROOM UPPER CABINETS	02-Jun-22
61	MAIN BATH COUNTERTOP- UP 3, INCLUDES UNDERMOUNT SINK	02-Jun-22
62	MAIN BATH CABINET- UP 1	02-Jun-22
63	BASEMENT BATH CABINET- UP 1	02-Jun-22
64	BASEMENT BATH COUNTERTOP, INCLUDES UNDERMOUNT SINK- UP 3	02-Jun-22
65	PLUMBING- SOAP DISPENSER - 3944- IN BLACK, INSTALL LEFT OF KITCHEN SINK FAUCET	02-Jun-22
66	PLUMBING- MASTER BATH- BATHROOM SINK FAUCET- QTY 2- ALIGN 6190 SINGLE HANDLE LAV WITH LIFT ROD DRAIN- IN CHROME	02-Jun-22
67	PLUMBING- MAIN BATH- BATHROOM SINK FAUCET- QTY 1- ALIGN 6190 SINGLE HANDLE LAV WITH LIFT ROD DRAIN- IN CHROME	02-Jun-22
68	PLUMBING- BASEMENT BATH SINK FAUCET- QTY 1- ALIGN 6190 SINGLE HANDLE LAV WITH LIFT ROD DRAIN- IN CHROME	02-Jun-22
69	PLUMBING- MASTER BATH SHOWER, AND QTY 1 IN BASEMENT BATH- ARRIS POSI TEMP SHOWER ONLY WITH 3 FUNCTION TRANSFER VALVE/TRIM AND SLIDE BAR WITH HAND SHOWER- TS22002EP / U361CI/ UTS23005 / 62320/ 3887EP/ A725- CHROME- JUNE 1, 2022	02-Jun-22
70	PLUMBING- MAIN BATH QTY 1- TUB FAUCET- ARRIS POSI TEMP/ SHOWER FAUCET WITH 3 FUNCTION TRANSFER VALVE/TRIM AND SLIDE BAR WITH HAND SHOWER- TS22003EP/ U361CI/ UTS23005/ 62320 / 3887EP/ A725- CHROME- JUNE 1, 2022	02-Jun-22
71	PLUMBING- ALIGN PIVOTING PAPER HOLDER- YB0408- CHROME- QTY 1 MASTER, QTY 1 MAIN, QTY 1 BASEMENT BATH, QTY 1 POWDER- CHROME	02-Jun-22
72	PLUMBING- ALIGN 24" TOWEL BAR- YB0424-QTY 1 MASTER, QTY 1 MAIN, QTY 1 BASEMENT BATH- CHROME	02-Jun-22
73	PLUMBING- TOWEL RING- YB0486- QTY 1 MASTER, QTY 1 MAIN, QTY 1 BASEMENT BATH, QTY 1 POWDER- CHROME	02-Jun-22
74	KITCHEN SINK- BLANCO PRECIS U1 3/4" LOW DIVIDE- COLOUR: TRUFFLE- 402069- JUNE 1, 2022	02-Jun-22
75	PLUMBING- TOILET- 471BOV- CONTRAC CALI ONE PIECE- QTY 4- MASTER, MAIN, POWDER, BASEMENT BATH	02-Jun-22
76	PLUMBING- RECTANGLE SINKS IN ALL BATHROOM- QTY 5- MASTER X 2, POWDER, MAIN, BASEMENT	02-Jun-22
77	CARPET BASEMENT REC ROOM AND BEDROOM 4- UP 2, INCLUDES GREY GOOSE MEMORY FOAM UNDERPAD	02-Jun-22
78	PLUMBING- KITCHEN FAUCET - SINGLE HANDLE PULLDOWN- ARBOR- 7594- IN BLACK	02-Jun-22
79	COMFORT HEIGHT- X 3- MASTER, MAIN, BASEMENT	02-Jun-22

CONSTRUCTION SUMMARY OF EXTRAS
Printed 2022-07-06 / 5:37 PM / Page 4 of 4

Site: RIVERS EDGE WASAGA
Lot: 116
Model: SPRINGWATER (50-03) ELEV C
Purchaser: ANTHONY VENUTO
Purchaser: ENZA VENUTO
Phone: 416.895.8212 / 416.995.2388
Email: AVENUTO@INTOUCHMORTGAGESOLUTIONS.COM



	DESCRIPTION	DATE SELECTED
80	TRIM- CONTEMPOARY W/ BEVEL- UP 2	02-Jun-22
81	INTERIOR DOORS- QTY 12- MASONITE LOGAN SMOOTH, 8 FOOT HIGH	02-Jun-22
82	INTERIOR DOOR HARDWARE- WEISER HALIFAX SQUARE ROSE	02-Jun-22
83	BASE PIE CUT CORNER CABINET- SEE SKETCH- JUNE 1, 2022	02-Jun-22
84	UPPER ANGLED CABINET WITH GREY SMOKED MIRROR (STD INTERIOR SHELVES)- SEE SKETCH- JUNE 1, 2022	02-Jun-22
85	BASEMENT BATH SHOWER FLOOR- UP 2- JUNE 1, 2022	02-Jun-22
86	BASEMENT BATH JAMB- JUNE 1, 2022	02-Jun-22
87	LAUNDRY ROOM COUNTERTOP- UP 3 QUARTZ- JUNE 1, 2022 ***OVER SINK	02-Jun-22
88	LAUNDRY ROOM SINK- HORIZON 1 HOLE- 401649- SEE SPEC--JUNE 1, 2022	02-Jun-22
89	LAUNDRY ROOM FACUET-ALIGN- 7365- CHROME- SEE SPEC	02-Jun-22
90	COUNTERTOP EDGE IN MASTER,MAIN BATH, BASEMENT BATH AND LAUNDRY- JUNE 1, 2022	02-Jun-22
91	TUB- CONVERT 5FT BATHTUB INTO FRAMED GLASS SHOWER WITH STANDARD 2 X 2 TILES ON THE FLOOR, STANDARD WALL TILES, STANDARD MARBLE JAMB AND LED POTLIGHT IN SHOWER- JUNE 1, 2022	02-Jun-22
92	FIREPLACE CLARIFICATION *** INSTALL FIREPLACE 24" FROM FLOOR TO BASE, THIS MODEL DOES NOT REQUIRE A MANTLE***- FIREPLACE WALL TO BE 60 INCHES WIDE APPROX----- SEE SPEC	02-Jun-22
93	FIREPLACE TILE WALL- LAGUNA SILVER WAVE 8 X 24- UP 4- TO BE TILED HORIZONTAL ON FIREPLACE WALL. FROM FLOOR TO CEILING. WALL TO BE FINISHED APPROX 60" WIDE. J MOLD TO MATCH TILE AS CLOSE AS POSSIBLE	02-Jun-22

ANCOR HOMES COLOUR CHART

ENTRANCES				
Main Foyer - FLOORING	✓	ETERNA VOLKAS WHITE POLISHED 12 X 24- UP 4- BRICKED		
Mudroom - FLOORING		NA		
Side Hall - FLOORING		NA		
Basement Foyer - FLOORING		NA		
KITCHEN				
Kitchen - FLOORING	✓	NORTHERN SOLID SAWN WIRE BRUSHED UVF WHITE OAK 5"- ORION- UP 3		
Breakfast - FLOORING	✓	NORTHERN SOLID SAWN WIRE BRUSHED UVF WHITE OAK 5"- ORION- UP 3		
Kitchen - CABINETS	✓	VENETIAN MDF VANILLA MILKSHAKE- UP 2		
Island - CABINETS	✓	VENETIAN MDF VANILLA MILKSHAKE- UP 2		
Servery - CABINETS		NA		
Kitchen - HANDLES/KNOBS	✓	ARROHEAD MATTE BLACK- CABINETS- 128MM, DRAWERS- 320MM		
Kitchen - COUNTERTOP	✓	CALCATTÀ GOLD- UP 3		
Island - COUNTERTOP	✓	CALCATTÀ GOLD- UP 3		
Kitchen - BACKSPLASH	✓	CALCATTÀ GOLD SLAB- UP 3		
Kitchen - SINK		PRECIS U 1 3/4 LOW DIVIDE - CAFÉ- 402066		
Kitchen - FAUCET	+ SOAF Dispersal	ARBOUR SINGLE HANDLE PULLDOWN KITCHEN FAUCET 7594- BLACK		
GREAT ROOM / DINING / LIVING / DEN / OFFICE / BASEMENT				
Family / Great Room - FLOORING	✓	NORTHERN SOLID SAWN WIRE BRUSHED UVF WHITE OAK 5"- ORION- UP 3		
Main Hall - FLOORING	✓	NORTHERN SOLID SAWN WIRE BRUSHED UVF WHITE OAK 5"- ORION- UP 3		
Dining / Living Room - FLOORING		NA		
Library / Den - FLOORING		NA		
Basement Rec Room - FLOORING	✓	2055 TIMELESS JOURNEY 948- UP 2 W/ GREY GOOSE MEMORY FOAM		
STAIRS				
Railing Details - PICKETS	✓	BLACK METAL SINGLE COLLAR PLAIN- UP 2		
Railing Details - POSTS	✓	3 1/4" SQUARE OAK POST W/ REVEAL- UP 2		
Railing Details - HANDRAIL	✓	2 3/4" SQUARE OAK- UP 2		
Stair Stain - MAIN STAIRS	✓ to Basement	STAIN STAIRS TO MATCH HARDWOOD AS CLOSE AS POSSIBLE		
Stair Stain - BASEMENT STAIRS (if applicable)	✓	STAIN STAIRS TO MATCH HARDWOOD AS CLOSE AS POSSIBLE		
BEDROOMS / BATHROOMS / LAUNDRY				
Powder Room - FLOORING	✓	ETERNA VOLKAS WHITE POLISHED 12 X 24- UP 4- BRICKED		
Powder Room - CABINETS		NA		
Powder Room - HARDWARE		NA		
Powder Room - COUNTERTOP		NA		
Powder Room - SINK		STD		
Powder Room - FAUCET		STD		
LOFT WHITE 12 X 24- BRICKED				
Laundry - FLOORING		MATRIX LARICE BIANO- UP 1	Laundry - HANDLES/KNOBS	H800BC
Laundry - CABINETS- UPPERS	✓	PURE EXTRA- UP 3	Laundry - SINK	HORIZON
Laundry - COUNTERTOP	✓	na	Laundry - FAUCET	ALIGN 7365
Upper Hall - FLOORING		NA		
Master Bedroom - FLOORING	✓	NORTHERN SOLID SAWN WIRE BRUSHED UVF WHITE OAK 5"- ORION- UP 3		
Bedroom 2 - FLOORING		NA		
Bedroom 3 - FLOORING	✓	NORTHERN SOLID SAWN WIRE BRUSHED UVF WHITE OAK 5"- ORION- UP 3		
Bedroom 4 - FLOORING- BASEMENT	✓	2055 TIMELESS JOURNEY 948- UP 2 W/ GREY GOOSE MEMORY FOAM		
Bedroom 5 - FLOORING		NA		
Master Ensuite - FLOORING	✓	ETERNA VOLKAS WHITE POLISHED 12 X 24- UP 4- BRICKED		
Master Ensuite - SHOWER WALL	✓	ETERNA VOLKAS WHITE POLISHED 12 X 24- UP 4- BRICKED VERTICAL		
Master Ensuite - SHOWER FLOOR	✓	ETERNA SERIES MOSAIC MEDIUM GREY MATTE HERRIGBONE- UP 2		
Master Ensuite - SHOWER JAMB	✓	SNOW WHITE QUARTZ		
Master Ensuite - CABINETS	✓	MOSAIC MAPLE TIMBER GREY- UP 1- COMFORT HEIGHT		
Master Ensuite - HANDLES/KNOBS	✓	H1400BC		
Master Ensuite - COUNTERTOP	✓	BORGHINI GOLD- UP 5		
Master Ensuite - SINK(s)	✓	4220-CIV X 2	Master Ensuite - FAUCET(s)	ALIGN- 6190 X 2
FOR TRADE USE				
Any upgrades in the colour chart must be accompanied with a PES. It is the responsibility of all Trades to inform the builder of any discrepancies on sketches, PES and/or colour charts PRIOR to installation.		RIVERS EDGE WASAGA 116	SIGNATURES	
			PURCHASER INITIALS	VENDOR APPROVAL

JUN 15 2022

2ND FLOOR CONTINUED...

Main Bath - FLOORING	LOFT WHITE 12 X 24- BRICKED		✓
Main Bath - TUB / SHOWER WALL	LOFT WHITE 12 X 24- STACKED VERTICAL		✓
Main Bath - SHOWER FLOOR	NA		
Main Bath - SHOWER JAMB	NA		
Main Bath - CABINETS	MOSAIC TIMBER GREY- UP 1- COMFORT HEIGHT		
Main Bath - HANDLES/KNOBS	H800BC		
Main Bath - COUNTERTOP	PURE EXTRA- UP 3		
Main Bath - SINK(s)	4220-CIV X 1	Main Bath - FAUCET(s)	ALIGN- 6190 X 2
BASEMENT Bath- FLOORING	LOFT WHITE 12 X 24- BRICKED		
BASEMENT Bath- TUB / SHOWER WALL	LOFT WHITE 12 X 24- STACKED VERTICAL		
BASEMENT Bath- SHOWER FLOOR	ETERNA SERIES MOSAIC MEDIUM GREY MATTE HERRIGBONE- UP 2		
BASEMENT Bath- SHOWER JAMB	SNOW WHITE QUARTZ		
BASEMENT Bath- CABINETS	MATRIX LARICE BIANCO- COMFORT HEIGHT		
BASEMENT Bath- HANDLES/KNOBS	H800BC		
BASEMENT Bath- COUNTERTOP	PURE EXTRA- UP 3		
BASEMENT Bath- SINK(s)	4220-CIV X 1	Shared Bath - FAUCET(s)	ALIGN- 6190 X 2
Ensuite Bath - FLOORING	NA		
Ensuite Bath - TUB / SHOWER WALL	NA		
Ensuite Bath - SHOWER FLOOR	NA		
Ensuite Bath - SHOWER JAMB	NA		
Ensuite Bath - CABINETS	NA		
Ensuite Bath - HANDLES/KNOBS	NA		
Ensuite Bath - COUNTERTOP	NA		
Ensuite Bath - SINK(s)	NA	Ensuite Bath - FAUCET(s)	NA

TRIM / PAINT

Casing/Baseboards	✓	CONTEMPORARY W/ BEVEL- UP 2
Interior Door STYLE	✓	MASONITE LOGAN SMOOTH- QTY 12- MAIN FLOOR- SEE SEKTCH
Interior Door HEIGHT	✓	8 FOOT HIGH INTERIOR DOORS- SEE SKETCH
Interior Door Hardware	✓	WESIER HALIFAX SQUARE ROSE SATIN NICKLE
PAINT - Throughout		COOL WHITE

FIREPLACE

Location / Insert / Mantle	SL-5F- FUSION 36" W/ ACCESSORY PACKAGE- WALL TO BE TILED- LAGUNA \$1,195 W/ WAVE 8 X 24
----------------------------	---

ACCESSORIES

Mirrors	DO NOT INSTALL	BATH ACCESSORIES	UPGRADE
---------	----------------	------------------	---------

APPLIANCE REQUIREMENTS

GAS LINE TO BBQ	STD	ELECTRICAL for Built-in Oven	YES
GAS LINE & ELECTRICAL TO STOVE	YES	ELECTRICAL for Built-in Micro	YES
GAS LINE & ELECTRICAL TO DRYER	DECLINED	ELECTRICAL for Cooktop	YES
HOOD FAN VENT SIZE	8" VENT	ELECTRICAL for Bar Fridge	DECLINED
WATERLINE to Fridge	YES		

DISCLAIMER

INITIALS

Any changes to the colour chart after signing are subject to a \$5000 administration fee plus costs	
Purchaser has checked and acknowledged accuracy of colour and selections before signing.	

Colours of all materials are as close as possible to Builders selection but not necessarily identical due to dye lot variances in manufacturing/manufacturers. Due to construction progress some items may have been pre-selected or installed. In this event the Vendor's selection must be accepted by the purchaser

SITE / LOT:	RIVERS EDGE WASAGA	116
-------------	--------------------	-----

PURCHASER(S):	ANTHONY VENUTO
---------------	----------------

PURCHASER(S):	ENZA VENUTO
---------------	-------------

PHONE #:	416.895.8212 / 416.995.2388
----------	-----------------------------

EMAIL:	AVENUTO@INTOUCHMORTGAGESOLUTIONS.COM
--------	--------------------------------------

FOR TRADE USE

SIGNATURES / DATE

Any upgrades in the colour chart must be accompanied with a PES.

It is the responsibility of all Trades to inform the builder of any discrepancies on sketches, PES and/or colour charts PRIOR to installation.



PURCHASER SIGNATURE	
PURCHASER SIGNATURE	
DÉCOR CONSULTANT	JILLIAN

PAGE 2 OF 2	Vendor APPROVAL	JUN 1 5 2022
-----------------	-----------------	--------------

lot 116
June 3/22

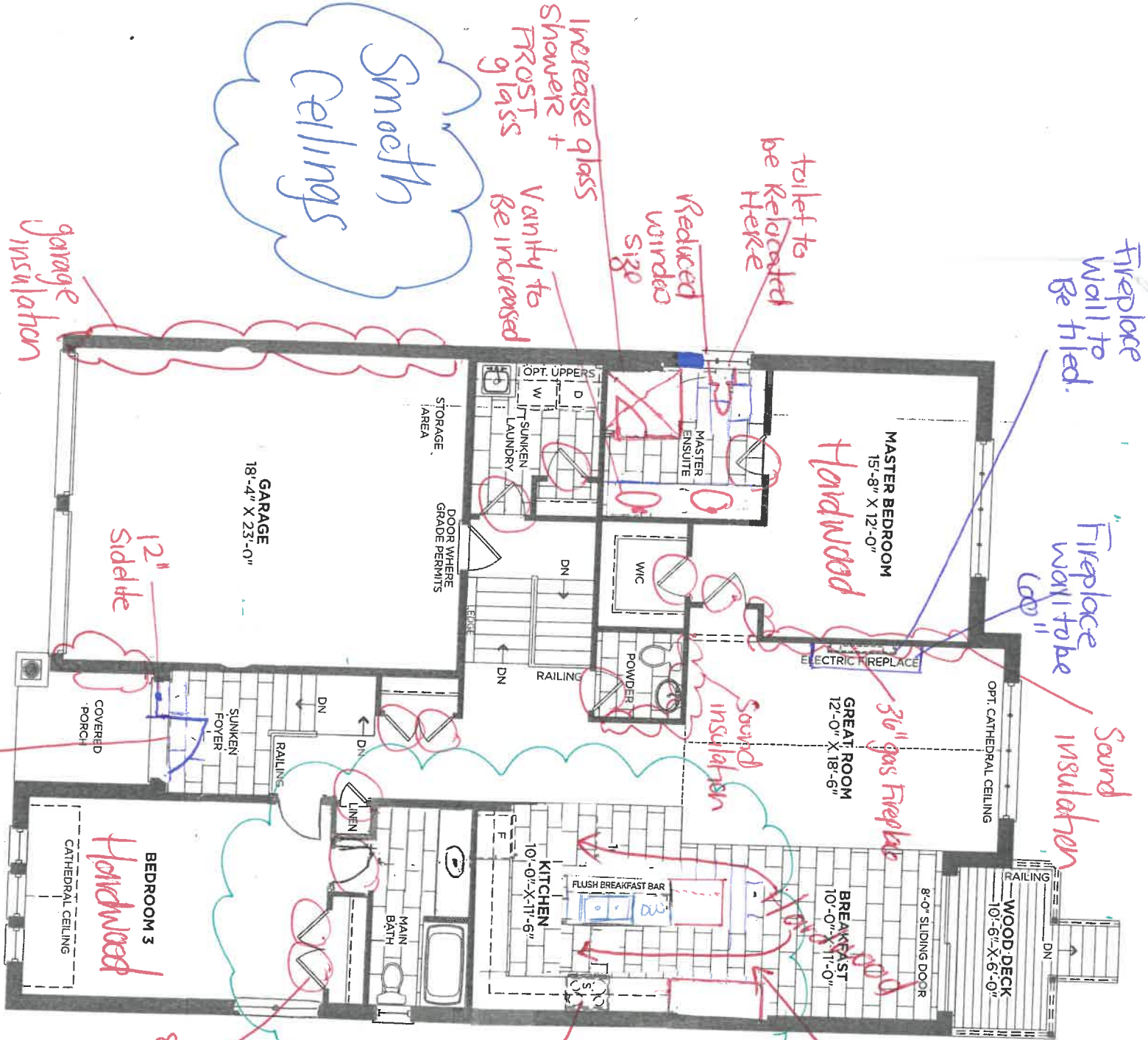

MAIN FLOOR ELEVATION A
REVISED LAYOUT
FOR KITCHEN/MAIN BATH
Memie MANS RP-42" wide
Riveredge
116

lot 116
feb 4/22

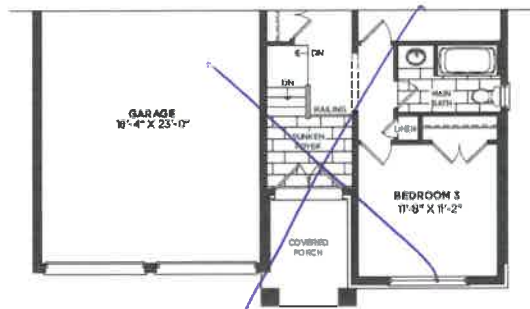

MAIN FLOOR ELEVATION B

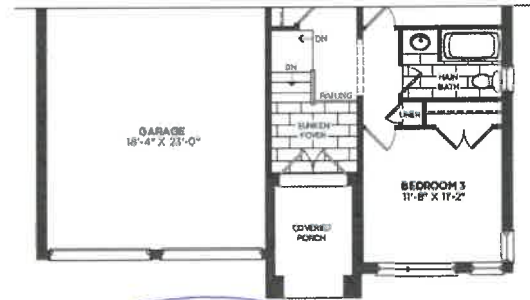

MAIN FLOOR ELEVATION C



lot 116
June 1/22

50-03 Springwater



MP

ELECTRICAL



ELEVATION C 2,260 SQ. FT.

qty 6
petlight
sep switch

qty 1
petlight on
porch
sep switch



ELEVATION A 2,267 SQ. FT.



ELEVATION B 2,260 SQ. FT.

1st 11/6
June 11/22

GALLERY
BY ZANCOR
HOMES

UPGRADED HARDWARE -
New Image Kitchens

ALL PRICES ARE PER PIECE

BERENSON - ARROWHEAD

Kitchen

CHROME



Knob	\$
96mm	\$
128mm	\$
160mm	\$
256mm	\$
320mm	\$

BRUSHED NICKEL

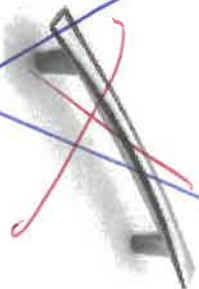

Knob	\$
96mm	\$
128mm	\$
160mm	\$
256mm	\$
320mm	\$
448mm	\$

BRUSHED BRASS

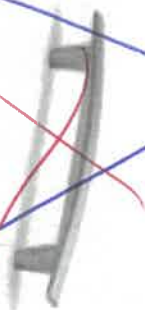

Knob	\$
96mm	\$
128mm	\$
160mm	\$
256mm	\$
320mm	\$

GRAPHITE



Knob	\$
96mm	\$
128mm	\$
160mm	\$
256mm	\$
320mm	\$

MATTE BLACK



Knob	\$
96mm	\$
128mm	\$
160mm	\$
320mm	\$

pair of knobs

per drawers



C NAME: CANOPIES
SHR ID:

PH:
CELL:

IOS NUMBER

INSTALL DATE:

PAGE

2 of 3

DRAFTED BY: FERNANDA

COMMENT

P102

DATE SUBMITTED
23 Mar 2021

TRANSITIONAL

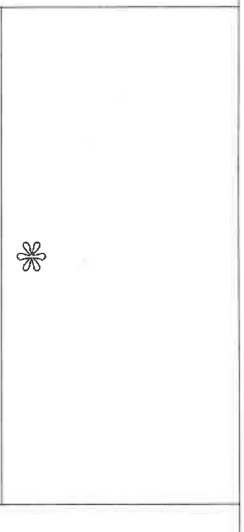

TransitionalHOOD3-900W-750h-550d

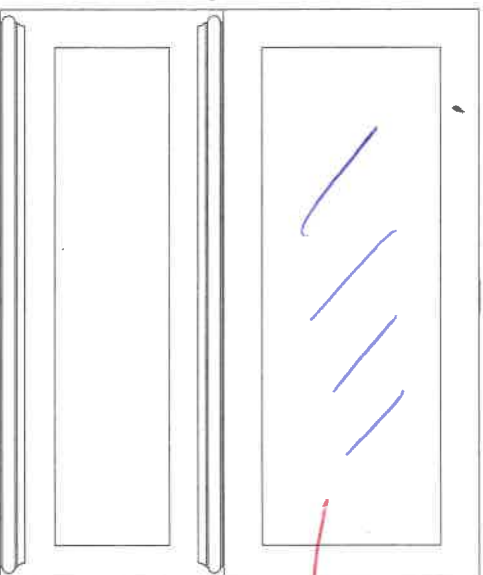

dh

smoked
gray mirror
insert

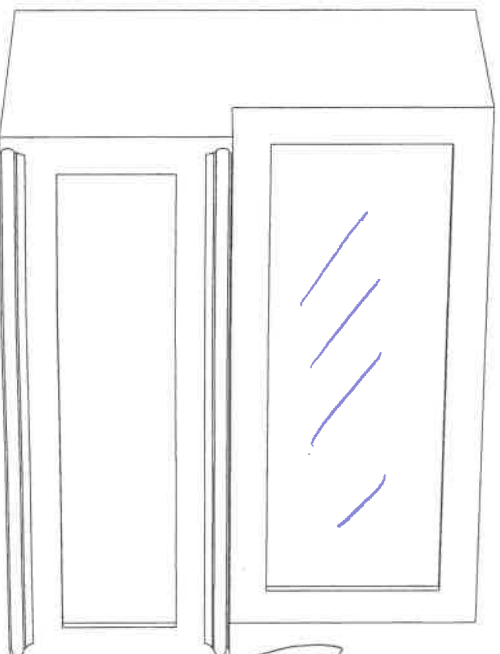

40" wide
if possible

lot 116
June 1/22

AVG

16' 116
June 1/22
AVC-276PS
30" Insert hood - MSRP: \$469.00

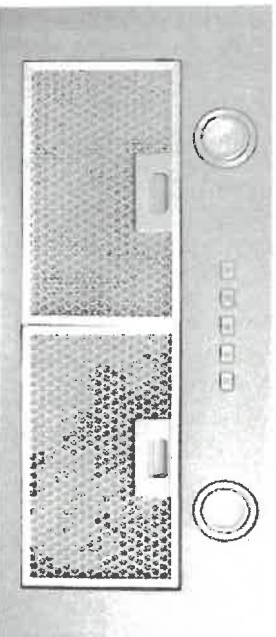

Selected Model	
Model number	AVC-276PS
Dimensions	27 1/2" (W) x 10 1/4" (D) x 12 3/8" (H)
Stainless steel grade	304
Control	Electronic push buttons
Lighting	2 bulbs, 2W LED (bulbs included)
Blower type	600 CFM, 3-speed
Blower performance	Speed 1, 298 CFM
	Speed 2, 457 CFM
	Speed 3, 600 CFM
Filter type	2 aluminium micro hole filters (included)
Duct transition	6" Round (Top)
Ducting	Ducted
Electrical requirements	120V / 60Hz / 2.7 Amps
1-year Warranty	Warranty Parts and labour, in-home service

Optional - HOOD FAN Included with
New Image Canopies

****See price book, "Cabinet Extras"**



DATE SUBMITTED

01 Mar 2022

CLIENT NAME: ZANCOR HOMES
SHIP TO: Rivers Edge Sunnisdale Trails
#50-03

PH:
CELL:

DRAFTED BY: Binita

CELL:

P/O #

JOB NUMBER

INSTALL DATE: _____

PAGE
1 of 2

Pantry

③ + ④
OVEN

1st 1/6
Apr 14/22
June 1/22

not to
scale

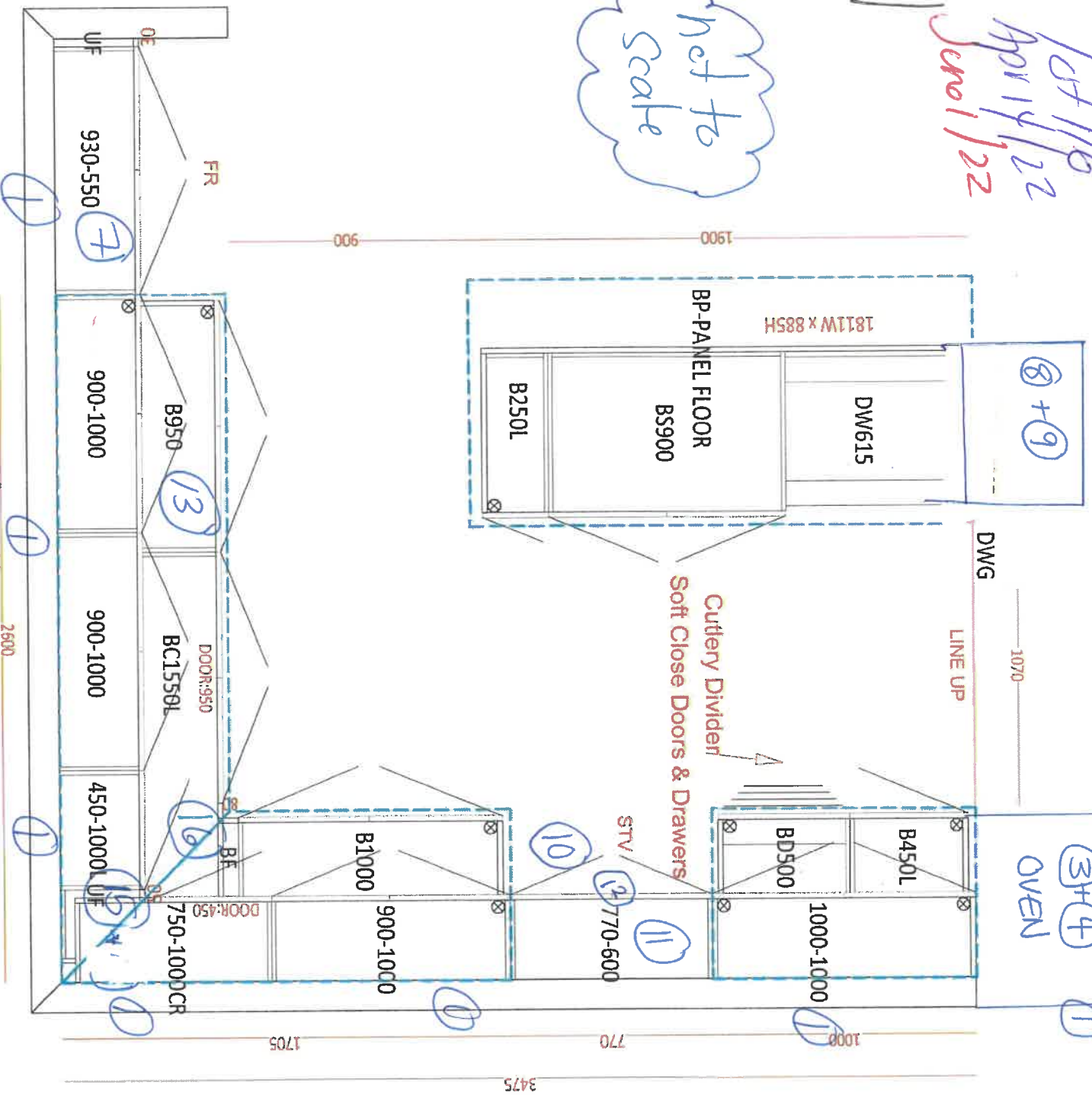

Kitchen

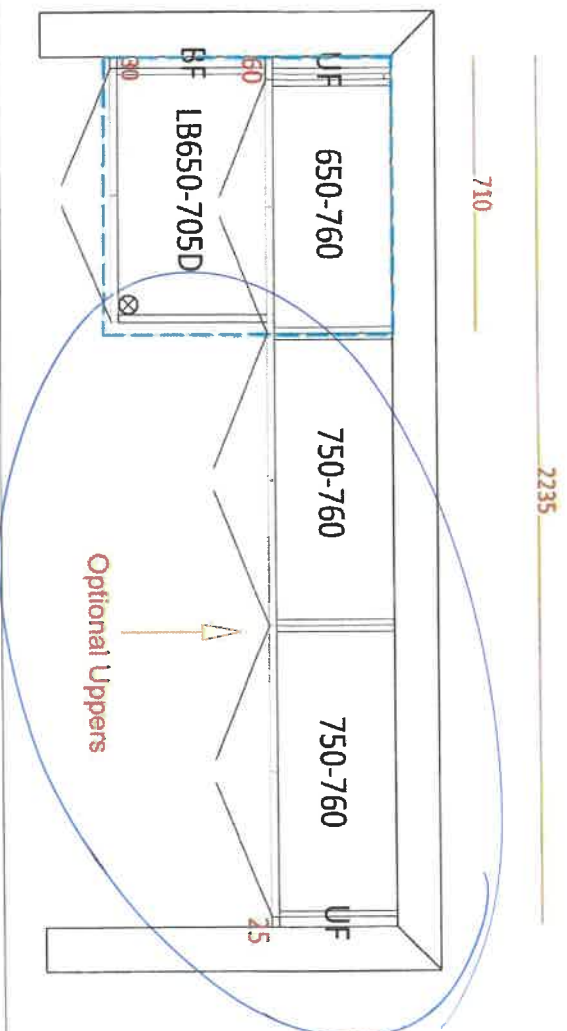

Laundry

Lot 116
June 1/22

Kitchen

① Riser and Crown installed over cabinets. install crown & ceiling. includes additional cabinets

- ② 'N.A.'
- ③ wall oven/micro w/ pot + pan drawers
- ④ 3' approx of additional upper + base cabinets for wall oven
- ⑤ Pantry - Approx 18" - Single door
- ⑥ pull out drawers - qty 3 for pantry - See sketch
- ⑦ Fridge Enclosure.
- ⑧ 2 Bin garbage / Recycling Bin
- ⑨ Approx 3' feet additional counter + base cabinet on island
- ⑩ 36" cooktop w/ pot + pan drawers
- ⑪ Hood Range w/ Fan, 40" if possible - transitional w/ grey mirror
- ⑫ Pot Filler
- ⑬ Pot drawers
- ⑭ under valance w/ LED tape lighting w/ switch
- ⑮ upper angled cabinet w/ grey smoked mirror insert
- ⑯ Base pre cut

ph

161/16
June 1/22

PANTRY

INTERIOR VIEW
TO REPRESENT INTERIOR
PULLOUTS

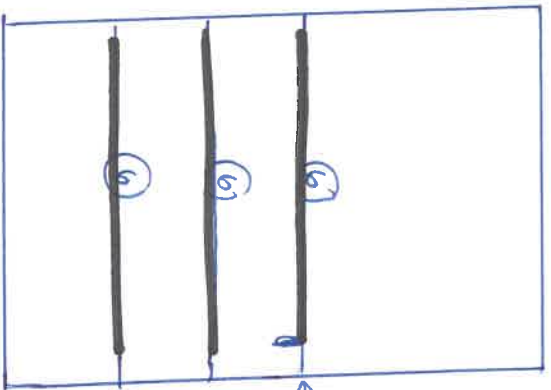

pull out drawers x 3

ph

INTERIOR

VIEW

=====



CLIENT NAME: ZANCOR HOMES

SHIP TO : Rivers Edge Sunnidle Trails

#50-03

JOB NUMBER

INSTALL DATE:

PH:

CELL :

DATE SUBMITTED

01 Mar 2022

DRAFTED BY: Binita

COMMENT

P/O #

PAGE

2 of 2

1st 11/6/22
Apr 14/22

1930

1930

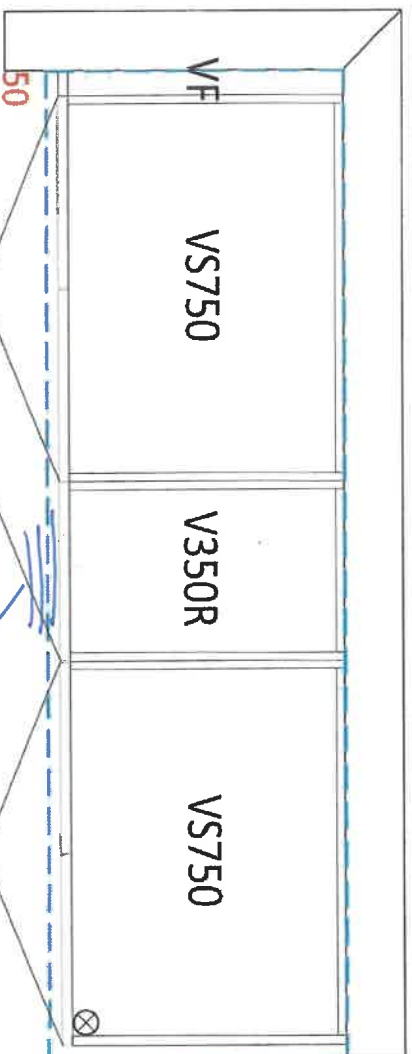

Master Ensuite - comfort Height

Bank of drawers

915

915

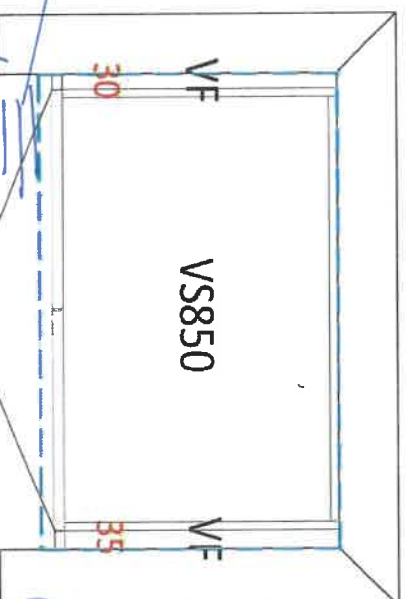

Bank of drawers

*Vanity Resized
For new layout*
See sketch

Main Bath - comfort Height

1520

1520

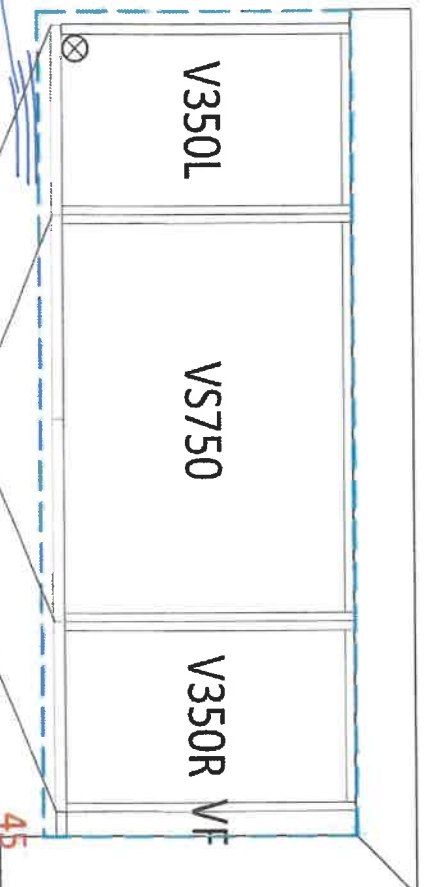

Bank of drawers

Basement Fl. Main Bath - comfort Height

211

Align®

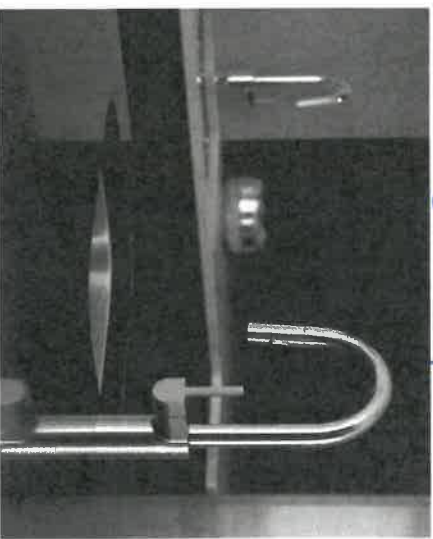
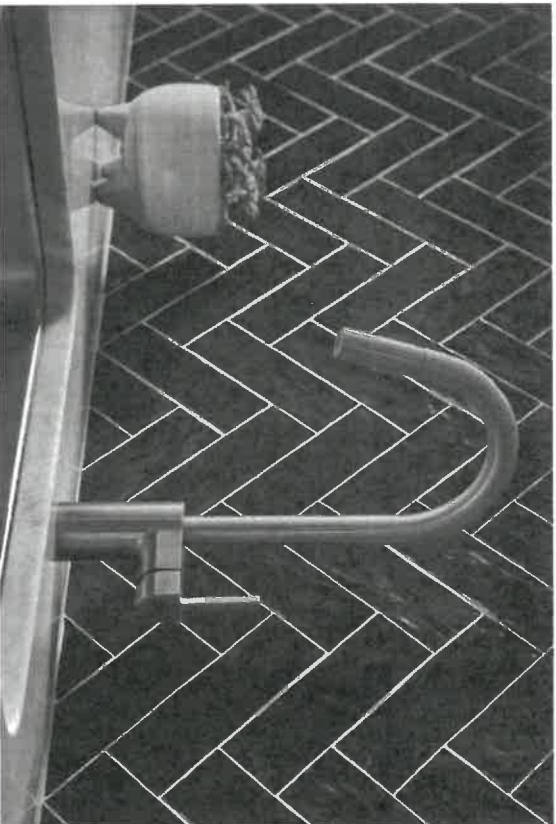

KITCHEN

lot 116
June 1/22

FAUCETS

~~Single Handle Pulldown Kitchen Faucet~~

~~7565~~

~~Chrome~~

~~Other~~

~~Black Stainless~~

~~Deckplate sold separately - 141002 series~~

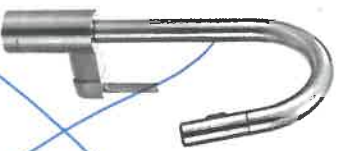

~~Single Handle Kitchen Faucet with Side Spray~~

~~7165~~

~~Chrome~~

~~Other~~

~~Not available in BLS & BG
Deckplate sold separately - 141002 series~~

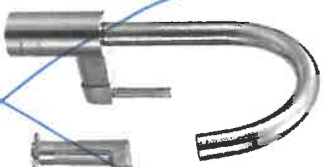

Single Handle Kitchen Faucet

7365

Chrome

Other

Not available in BLS & BG
Deckplate sold separately - 141002 series



laundry
faucet

Single Handle Bar/Prep Faucet

5965

Chrome

Other

Black Stainless

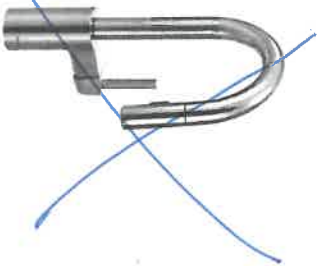

FINISH OPTIONS



Chrome (CJ), Matte Black (BL), Spot Resist™
Stainless (SRSL), Lifeshine® Brushed Gold (BG),
Black Stainless (BLSI)

To order, combine the model number with one of these finish
letter(s): Matte Black (BL), Spot Resist™ Stainless (SRSL),
Lifeshine Brushed Gold (BG) & Black Stainless (BLSI).
To order Chrome (CJ) models, use model number only.

Deckplate sold separately - 141002 series

Pot Fillers

Traditional | Transitional | Modern

Convenient flow control over a cooktop.

Dual joints allow for maximum reach and dual shut-off valves mean never reaching over a hot surface to turn it off.

*Pot Filler
Model 22*

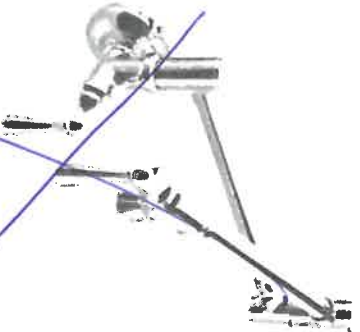

**Traditional Two Handle Pot Filler
Faucet with Dual Shut-Offs ±**

Model S664

Chrome

Other

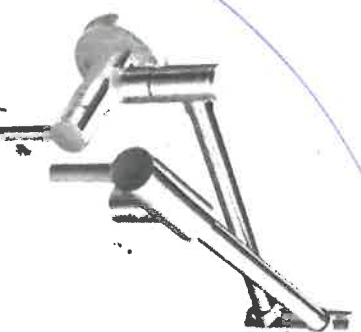

**Modern Two Handle Pot Filler
Faucet with Dual Shut-Offs ±**

Model S665

Not available in ORB finish

Chrome

Other*

Black Stainless

Pot Filler

FINISH OPTIONS:

To order, combine the model number with one of these finish letter(s):

Spot Resist™ Stainless (SRS), Polished Nickel (NL), Oil Rubbed Bronze (ORB), Matte Black (BL) & Brushed Gold (BG)

To order Chrome (C) models, use model number only.

± Single hole installation only



Align®

Traditional | Transitional | Modern

From large, open master baths to minimalist powder rooms, Align faucets and accessories bring a refreshed modern look to your home.

1st 1/16

Apr 14/22

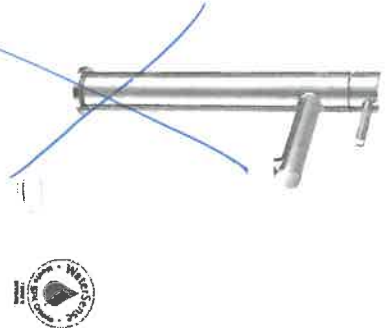

**Single Handle Vessel Lav
Faucet with Push-Button
Drain without Overflow ~
Not Available in BL
Model 6192 / 140780**

- Chrome -
- Other -



**Single Handle Lav Faucet
with Lift Rod Drain ^
Model 6190**

- Chrome -
- Other -

Master x 2
Main x 1
Bedroom
Bath x 1

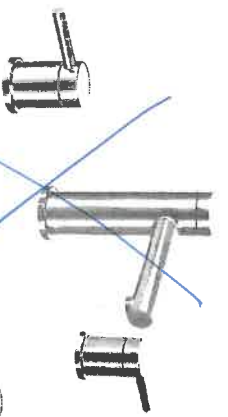

**Two Handle Adjustable
Widespread (8\" - 16\") Lav Faucet
with Lift Rod Drain
Model T6193 / 69000**

- Chrome -
- Other -

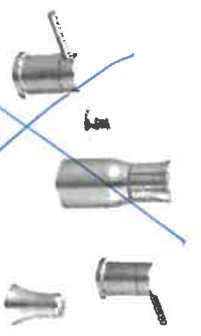

**Two Handle Bidet Faucet
Not Available in BL or BG
Model T5191 / 9265**

- Chrome -
- Other -

FINISH OPTIONS:

To order, combine the model number with one of these finish letter(s)
LifeShine® Brushed Nickel (BN), Matte Black (BL) & Brushed Gold (BG)
To order Chrome (C) model, use model number only.
** T90331 / 140680

^ Deckplate included - Deckplate sold separately - 172666 series

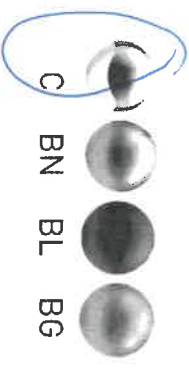

Arris™

Traditional | Transitional | Modern

Sharp angles and tubular lines dominate each piece in this modern collection.

Lot 116
Apr 14/27

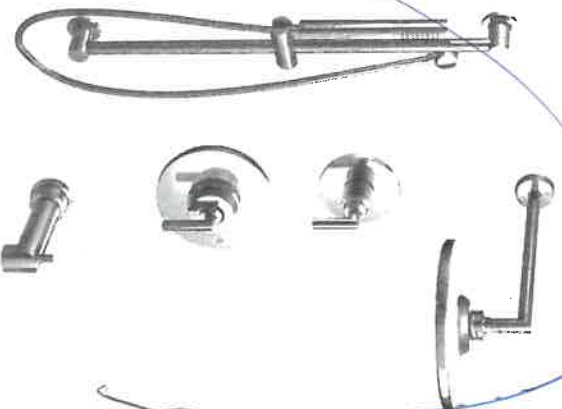

Posi-Temp® Tub/Shower Faucet
with 3 Function Transfer Valve/Trim
and Slide Bar with Hand Shower *
Model TS22003EP / U361CI /
UTS23005 / 62320 / 3887EP / A725

Chrome
Other

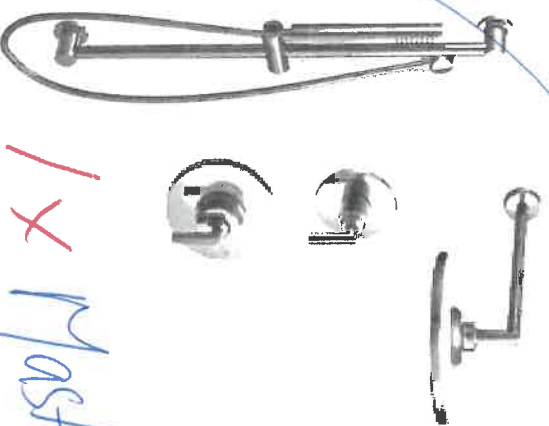

Posi-Temp® Shower Only
with 3 Function Transfer Valve/Trim
and Slide Bar with Hand Shower *
Model TS22002EP / U361CI / UTS23005 / 62320
/ 3887EP / A725

Chrome
Other

X 1 Main

1 x Master
1 x Basement Bath

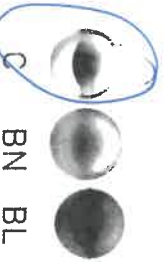

BN BL

FINISH OPTIONS:

To order, combine the model number with one of these finish letter(s):
LifeShine® Brushed Nickel (BN), Matte Black (BL).

To order Chrome (C) model, use model number only.

Please see the 2020 Shower Design Guide for installation

Align®

Traditional | Transitional | Modern

From large, open master baths to minimalist powder rooms, Align faucets and accessories bring a refreshed modern look to your home.

10/11/6
Apr 14/22



Swiveling Double Robe Hook

Model YB0402	
Not Available in BG	
Chrome	- \$
Other	- \$



Robe Hook

Model YB0403	
Chrome	- \$
Other	- \$

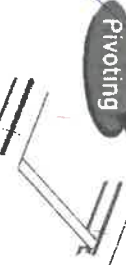

Pivoting Paper Holder

Model YB0408	
Chrome	- \$
Other	- \$



Single Post Paper Holder

Model YB0409	
Not Available in BG	
Chrome	- \$
Other	- \$



18" Towel Bar

Model YB0418	
Chrome	- \$
Other	- \$116.17



24" Towel Bar

Model YB0424	
Chrome	- \$
Other	- \$



Towel Ring

Model YB0486	
Chrome	- \$
Other	- \$



Designer Grab Bar

Models:	Chrome	Other
12" - YG0412	\$152.96	\$
18" - YG0418	\$159.77	\$
24" - YG0424	\$166.86	\$
36" - YG0436	\$189.95	\$
42" - YG0442	\$278.57	\$

Not Available in BL
Available in BG for 18" & 24"

X3 - Master,
pair
Basement
Bath

X4 - Bath

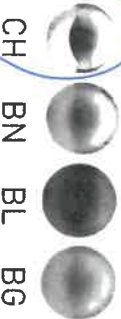

FINISH OPTIONS:

To order, combine the model number with one of these finish letter(s):
Chrome (CH), LifeShine® Brushed Nickel (BN), Matte Black (BL)
& Brushed Gold (BG)

Soap or Lotion Dispensers

Traditional Transitional Modern

However you define your faucet's style,
you can assure a coordinated look with Moen soap dispensers.

KITCHEN

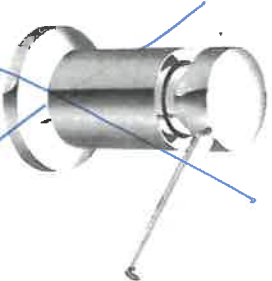

Transitional Soap or Lotion Dispenser

Model 3942

Chrome

Other

- \$171.23



C SRS BL W

NEW!

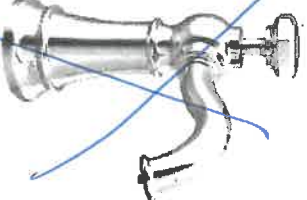

Paterson Soap or Lotion Dispenser

Model S3955

Chrome

Other



C SRS BL



Transitional Soap or Lotion Dispenser

Model 3944

Chrome

Other

- \$171.23



C SRS ORB BL

1c1 1/6
Apr 14/22

Kitchen
* install left of faucet
in Black

FINISH OPTIONS:

To order, combine the model number with one of these finish letter(s):

Chrome (C), Spot Resist™ Stainless (SRS), Oil Rubbed Bronze (ORB), Matte Black (BL) & Glacier White (W)

Arbor®

Traditional | Transitional | Modern

Arbor's smooth profile is tailored to perfection.

This classic transitional look works with a variety of decorating styles.

KITCHEN

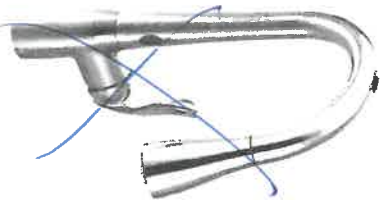

MotionSense™ Hands-Free Single Handle Pulldown Kitchen Faucet **

Model 7594E

- Chrome - \$1,084.32
- Other - \$1,193.47

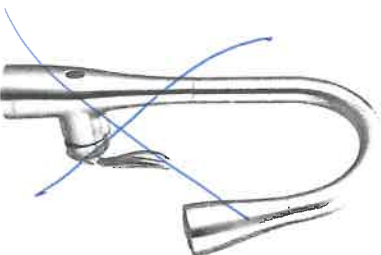

MotionSense Wave™ Hands-Free Single Handle Pulldown Kitchen Faucet **

Model 7594EW

- Available in BL
- Chrome
- Other

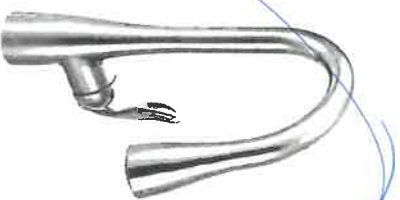

Single Handle Pulldown Kitchen Faucet **

Model 7594

- Chrome
- Other

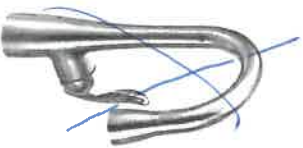

Single Handle Pulldown Bar/Prep Faucet *

Model 5995

- Use model number only for C
- Chrome
- Other

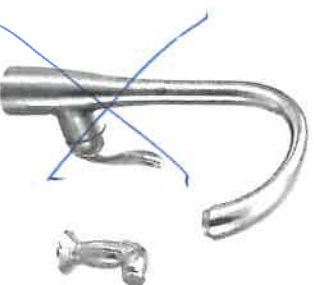

Single Handle Kitchen Faucet with Side Spray **

Model 7790

- Use model number only for C
- Available in C and SRS
- Chrome
- Other

Kitchen faucet in Black.

FINISH OPTIONS:

To order, combine the model number with one of these finish letter(s):
Chrome (C), Spot Resist™ Stainless (SRS), Oil Rubbed Bronze (ORB) & Matte Black (BL).

* Deckplate sold separately - 141002 series
** Deckplate included

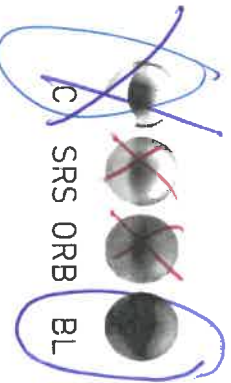

Get 1/6
June 1/22

Product Specification Sheet

PRECIS U 1 3/4 Low Divide
SILGRANIT®

PRODUCT DIMENSIONS

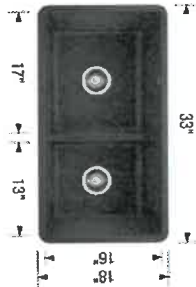

PRECIS U 1 3/4
Low Divide

Colour Finish









Model No.

FEATURES / SPECIFICATIONS

- Precis kitchen sinks are made in Canada and Germany
- Double bowl size with a lower sink partition allows you to maneuver large pots, long-handled pans or baking sheets with ease
- Centered drain position allows installation flexibility, install the large bowl on the left or the right
- Made of SILGRANIT®, a high-quality granite composite
- Heat, scratch and stain resistant
- Non-porous surface is anti-bacterial and easy to clean

DESIGN AND PLANNING TIPS

Cabinet Size: 36" (915 mm)
Bowl depth: 9 1/2" (240 mm) / 9 1/2" (240 mm)
Depending on cabinet construction, a different cabinet size may be required.
Consult the cabinet manufacturer

	White	reversible 402071
	Metallic Gray	reversible 402069
	Concrete Gray	reversible 402068
	Cinder	reversible 402264
	Café	reversible 402067
	Biscuit	reversible 402066
	Antibacite	reversible 402070
	Antibacite	reversible 402065

TRUFFLE

WARRANTY

Limited Lifetime warranty

Code/Standards Compliance

BLANCO sinks and faucets are third-party tested and certified to CSA, cUPC, ANSI/ASME and NSF standards and listed by applicable certification bodies. For more information on individual product listings, contact our office or listing organization.

BLANCO CANADA
100 Corporation Drive
Brampton, ON L6S 6B5

Tel: 905 494 2400
Fax: 905 494 2425
www.blancocanada.com

Toll Free: 1 877 425 2626
Toll Free: 1 877 825 2626

© 2016 BLANCO CANADA

Kitchen

SILGRANIT Laundry Sink

LIVEN



- Made in Canada
- Patented granite composite material made of up to 80% quartz sand
- Heat, scratch and impact resistant
- Non-porous, repellent, stain resistant - does not absorb liquids or acids
- Easy to clean – does not require harsh chemicals
- Hygienic+Plus surface protects against bacteria
- Rear-positioned and centred drain hole maximizes cabinet storage
- Includes 3½" (90 mm) stainless steel strainer, drop-in clips, cabinet template and installation instructions
- Limited Lifetime Warranty

Dual-mount		LIVEN	
	Coal Black NEW	402646	NEW
	Anthracite	401902	
	Cafe	401904	
	Cinder	401905	
	Metallic Gray	401906	
	Truffle	401907	
	Concrete Gray	402297	
	Biscuit	401903	
	White	401908	
Sink Specification			
Minimum Cabinet Size*		27" (685 mm)	
Bowl Depth		12" (305 mm)	
Cubed Weight		63 lb. (29 kg)	
Optional Accessories			
		Laundry rack 401952	

Note: 4 additional knock-out holes for accessories.
To protect from damage, this model should be shipped on a pallet.
Sink can be installed as a drop-in or undermount.

Build your BLANCO UNIT with Faucets and Accessories



ARTONA Faucet
See Page 50



I INUS Faucet
See Page 50



CapFlow
5176GG



Laundry rack
401952

Stainless Steel Laundry Sinks

QUATRUS R15, ESSENTIAL & HORIZON

lot 116
June 1/22



- German designed and engineered
- Premium 304 series
- 18/10 chrome-nickel content for exceptional lustre, durability and strength
- Rear-positioned drain hole for maximum usable bowl and cabinet storage
- Includes 3½" (90 mm) stainless steel strainer and drop-in clips
- Limited Lifetime Warranty

Dual-mount or Undermount Installation	QUATRUS R15 LAUNDRY	ESSENTIAL LAUNDRY	HORIZON LAUNDRY	HORIZON NO LEDGE LAUNDRY NEW
No Ledge NEW	-	-	-	402610
1 hole	401802	401201	401649	-
3 holes (4" centre)	-	401202	-	-
3 holes (8" centre)	-	401203	401651	-
Sink Specification				
Minimum Cabinet Size*	27" (685 mm)	27" (685 mm)	24" (610 mm)	22" (559 mm)
Bowl Depth	12" (305 mm)	12" (305 mm)	10" (254 mm)	10" (254 mm)
Cubed Weight	63 lb. (29 kg)	41 lb. (18 kg)	64 lb. (29 kg)	64 lb. (29 kg)
Stainless Steel Gauge	18	18	18	18
Optional Accessories				
	Laundry rack 401952			

Note: Sink can be installed as a drop-in or undermount.

Laundry Sink

Build your BLANCO UNIT with Faucets and Accessories



I INUS Faucet
See Page 50



ALTA Faucet
See Page 51



RIVANA HIGH ARC Faucet
See Page 52



RIVANA BAR PREP Faucet
See Page 52



CapFlow
5176GG

Handwritten notes:
X 2 - Master
X 1 - Main
X 1 - Basement Bath
Lot 116
June 1/22

COLLETTE
21 1/2" RECTANGULAR UNDERMOUNT SINK

☐ 4220CIY Undermount Sink

Product Specs:

- Vitreous china
- Front overflow hole
- Template and mounting hardware supplied

Overall Dimensions (W x D x H):

(OD): 545mm(21 1/2") x 355mm(14") x 190mm(7 1/2")
(ID): 485mm(19") x 295mm(11 5/8") x 140mm(5 1/2")

Compliance Certifications:

Meets or exceeds the following:

- IAPMO cUPC
- ASME A112.19.2 / CSA B45.1-2013

Shipping:

Cube 1.64
GW 25 lbs



Notes:

Dimensions of fixtures are nominal and may vary within the range of tolerances established by ASME standard A112.19.2. These measurements are subject to change or cancellation. No responsibility is assumed for use of superseded or voided pages.

* Bone and Biscuit available through Direct Import (CI/F) only.

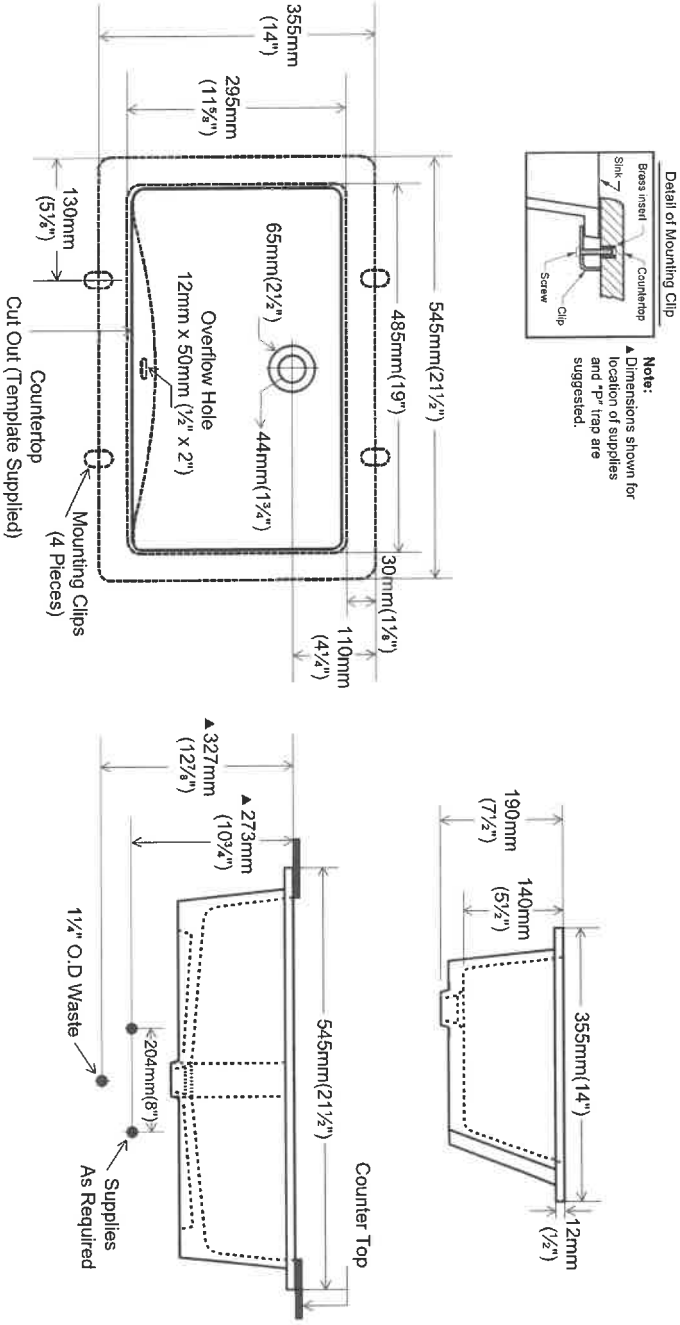

contrac®

5970 Chedworth Way, Unit A, Mississauga, ON, Canada L5R 3V5
www.contrac.ca

Revised: January 2016

lot 116
June 1/22

CALI ONE PIECE TOILET
4.8LPF / 1.28GPF

- ☐ 4710BOV Lined Tank
- ☐ 4710BOVU Unlined Tank

PRODUCT SPECS:

- High efficiency toilet
- 4.8Lpf / 1.28Gpf
- Elongated bowl with concealed skirted trapway
- Vitreous china
- 17" Plus Height for greater comfort
- Soft white tank lever
- 12" (305mm) Rough-in
- 2" Fully glazed ball pass trapway
- 3" Flapper
- Siphon jet flush action
- Water surface: 7⁵/₈" x 5⁵/₈" (198mm x 143mm)
- Decorative soft white side caps included
- Smooth close toilet seat included

DIMENSIONS:

390mm W x 725mm D x 765mm H
15³/₈" W x 28¹/₂" D x 30³/₈" H

COMPLIANCE CERTIFICATIONS

Meets or exceeds the following:

- IAPMO cUPC
- ASME A 112.19.2 / CSA B45.1
- ADA Guidelines & ANSI A117.1
- LEED Compliant
- CSA B551 barrier-free standard
- US EPA WaterSense
- Map Tested 1000g

SHIPPING

Cube 9.39
GW 92.5 lbs

TO BE SPECIFIED

Colour: ☐ Soft White

NOTES: This toilet is designed to rough-in at a minimum dimension of 305mm (12") from finished wall to C/L of outlet. Supply line not included with fixture and must be ordered separately.

Important: Dimensions of fixtures are nominal and may vary within the range of tolerances established by ASME standard A112.19.2. These measurements are subject to change or cancellation. No responsibility is assumed for use of superseded or voided pages.

Product is designed to comply with ADA / ANSI A117.1 and CSA B551 Barrier-Free Standard requirements, if installed according to the standard and local building codes. It is the responsibility of the installer to comply with the standard (and any applicable code) prior to installation.

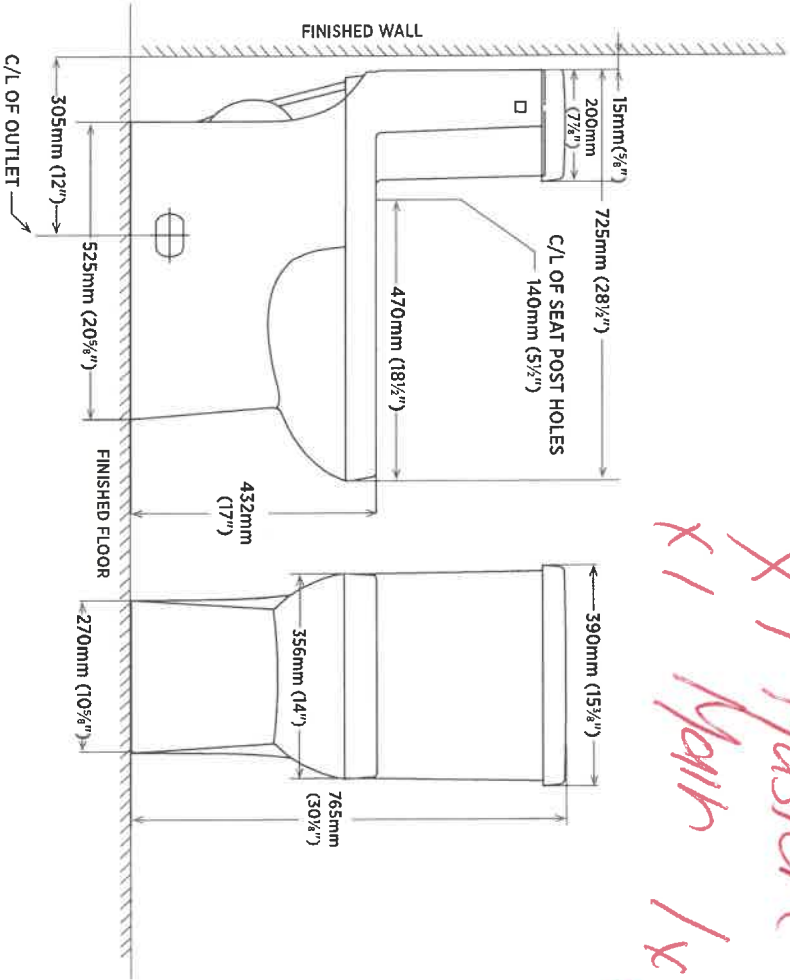

[Handwritten signature]

contrac

5970 CHEDWORTH WAY, UNIT B, MISSISSAUGA, ONTARIO, CANADA L5R 4G5 | CONTRAC.CA

REVISED MAY 2021

Set 116
Jm01/22

Interier Doors

X12 - Main Floor

LOGAN

W

SLIMLINE 550 FUSION

DIRECT VENT GAS FIREPLACE

Design | Innovative Technologies

- Heats 400-600 sq ft with 12,000-17,500 BTUs, based on climate and home efficiency
- 27-3/16" x 18-1/16" glass size
- Interior firebox design allows for style changes today, or years from now
- More than 10 finishing options allow for personalized styles

CLAREMONT

X ————

Install
24"
FROM
Floor
to Bottom



*WALL
TO BE
TILED*

24"

18-1/16"

Fireplace - No Mantle

18-1/16"
HEAT & GLO
No one builds a better fire
June 3/22

APPLIANCE ACKNOWLEDGEMENT

CONTACT: Steve Miller - Appliance Canada (905) 660-2424 / smiller@appliancecanada.com

- It is the Purchaser's responsibility to coordinate delivery, installation and hook up of appliances and to ensure they are installed as per Manufacturers specifications after closing.

STANDARD APPLIANCE OPENINGS provided by Zancor:

*Standard appliance openings are approximate and the minimum required. Sizes may vary due to onsite condition and/or when modifications have been made to the cabinetry.

- ▶ Fridge Opening 36" x 74"
- ▶ Stove Opening 30"
- ▶ Hood Fan Opening 30"
- ▶ Hood Fan & Vent 6" with Under Cabinet Hood
- ▶ Dishwasher Opening 24"

Accepts Standard
Openings **Initial☒ *SM***OPTIONAL UPGRADED APPLIANCES to be provided by Homeowner:**

- **Specs/information sheets are required and it is the responsibility of the homeowner to provide this to Zancor Homes by the due date that has been provided. If appliance specs are not submitted, Zancor Homes will not be responsible for any necessary requirements and the standard opening will be built.**

☒ *SM*

- ▶ Upgraded Appliance Specs are DUE 2 WEEKS FROM SIGNED DATE OF COLOUR CHART (if not received during appointment)

INITIAL

- ▶ ***Specs that require changes/modifications after this date will not be accepted***

- ▶ NOTE: Any upgraded appliances are to be paid by the Purchaser, directly to the appliances company.

- ▶ Additional charges to the Purchaser may apply for cabinetry, electrical and plumbing in order to accommodate the specs given by the homeowner.

FRIDGE UPGRADE

- ☐ Built-in
- ☐ Paneled **Panel to match required
- ☐ Integrated / Flush Inset
- ☒ Waterline

RANGE UPGRADE

*Larger hood fan CFM might be required, which need a larger vent

- ☐ 36" **Hood fan opening must be the same size or larger (8" vent might be required)
- ☐ 48" **Hood Fan opening must be the same size or larger (8" or 10" vent required)
- ☒ Gas Range **gas line and electrical required & sold separately
- ☐ Induction **electrical required & sold separately
- ☐ Cooktop (Apron Front) **Countertop Cut-out required & sold separately
- ☒ Cooktop (Drop-in) **countertop Cut-out required & sold separately

*48" transition Hood***HOOD FAN & VENT****UPGRADE**

- ☐ 8 Inch **Required for 600 CFM
- ☐ 10 Inch
- ☐ Chimney Hood Fan **Vent must be centred
- ☐ Insert / Liner

WALL OVEN/MICRO**UPGRADE**

**Electrical required

- ☐ Single Wall Oven **electrical required & sold separately
- ☒ Double Wall Oven **electrical required & sold separately
- ☐ Steam Oven **electrical required & sold separately
- ☐ Warming Drawer **electrical required & sold separately
- ☐ Over Then Range Microwave (OTR)
- ☐ Built-In Microwave **Trim Kit required **electrical required & sold separately

DATE

Apr 14/22

SITE

WASAGA RIVERS EDGE

LOT

716

** Any upgrades checked in this appliance form must be accompanied with specs provided by the Purchaser.

*It is the responsibility of the trade to inform the Builder of any discrepancies with specs, sketches, extras and/or colour chart PRIOR to production/installation.

ZANCOR

221 North Rivermede Road, Concord, Ontario L4K 3N7 * T: (905) 738.7010 F: (905) 738.5948

HOME AUTOMATION (Cable, CAT5/6, Telephone)

INCLUDED IN SCHEDULE "A" IN AGREEMENT OF PURCHASE AND SALE:

- Rough-in for Central Vacuum system piped to garage
- Rough-in for Telephone (2) locations
- Rough-in for Cable TV (2) locations
- Rough-in for Cat-6 Network (3) locations

CONTACT:

I/we the Homeowner(s) have chosen to contact the Home Automation Company to select the locations of the rough-ins for Cable, CAT6, Telephone as included in our Agreement of Purchase Sale.

I/we the Homeowner(s) will contact the trade within 4 weeks of the date of this release to select locations of the standard rough-ins review other optional products for purchase.

Trade: Zygya Lighting &Automation
Phone: (705) 715-1102
Email: info@zygmainc.ca
Location: 11 King Street, Unit 3
 Barrie, Ontario L4N 6B5

ACKNOWLEDGEMENT:

I/We the homeowner(s) acknowledge that if I/We the homeowners decide to not contact Zygya Lighting & Automation, locations of the standard rough-ins will be installed as per Vendors discretion.

Homeowner(s) Initial

Homeowner(s) Initial

Homeowner(s) Initial

WASAGA RIVERS EDGE

DATE

SITE

LOT

Apr 14/22
June 1/22

221 North Rivermede Road, Concord, Ontario L4K 3N7 * T: (905) 738.7010 F: (905) 738.5948

INTERIOR FINISHES ACKNOWLEDGEMENT / WAIVER

Purchaser accepts and acknowledges that the Builder reserves the right to substitute materials with those of equal or better quality where the manufacture, scheduling or delivery of materials may directly impact the Builder's ability to meet its contractual obligations under the Agreement of Purchase and Sale.

UPGRADES/EXTRAS: All upgrades and additional selections indicated on the colour chart must be accompanied by an upgrades/extras sheet (PES) and full payment otherwise the selection will be invalid. All colour charts and upgrades/extras will not proceed until verified and signed by an authorized signing officer at the Vendor's head office. **CHANGES WILL NOT BE PERMITTED UPON COMPLETION AND SUBMISSION OF THE COLOUR CHART.**

PORCELAIN & NATURAL STONES: Due to the properties of natural stones including but not limited to marble, granite, quartz, no two pieces are exactly the same. Variations in colour, tone, granularity (pitting, fissures) and pattern are to be expected, including various lighting may affect the overall finished look. Stone tops are sealed at time of installation and should never be cleaned with lemon oil or vinegar. Stones are porous materials, therefore any spilled substance require immediate attention. Stone countertops require regular seal re-application as part of home maintenance. Purchaser acknowledges colour and product variations as well as natural imperfections may exist with the selection of natural stone materials and shall not hold the Vendor liable for provision of same.

STONE COUNTERTOP JOINTS: Purchaser is aware there may be joints in stone counter tops, in kitchens and vanities if applicable as per plan. Joints will also be applicable where the length of the counter top exceeds the length of a stone slab.

CERAMIC TILES: Due to manufacturing, shade (dye lots), product variations may exist that can affect the overall look of the finished product. Although every effort will be made to ensure the colours and materials selected are as close as possible to the samples, the purchaser acknowledges that the sample tiles supplied in the Design Centre may not be identical to the materials installed in the home.

STAIR STAINS: Due to the natural properties of wood, many variables can affect the overall look of the finished product. Factors including but not limited to wood type, knotting, graining, density, age, humidity, and air temperature can result in substantial variations in stain intensity. The purchaser accepts that although the Vendor will do their best to match stain the unfinished stairs as close as possible to the pre-finished floors, it is not possible to have an identical match and that there MAY be shade differences between the two products.

CABINETRY: Due to the natural properties of wood, slight variations apparent with cabinetry are to be expected. This includes but not limited to wood species, wood grain, colour, finish, product variations, and natural imperfections are all factors that may affect the overall look of the finished product. Such factors make exact colour matching impossible. The type and intensity of lighting in the areas of designated cabinetry placement may also highlight characteristics of cabinetry finish. All cabinets shall be finished with a white melamine interior box unless a finished interior is upgraded. Due to building specifications and/or on-site conditions, certain cabinetry upgrades may not be possible. The purchaser acknowledges that the Builder cannot guarantee the cabinetry finish or provision of certain upgrades and shall not hold the Builder liable for provision of same.

UPGRADES/EXTRAS: All upgrades and additional selections indicated on the colour chart must be accompanied by an upgrades/extras sheet (PES) and full payment otherwise the selection will be invalid. All colour charts and upgrades/extras will not proceed until verified and signed by an authorized signing officer at the Vendor's head office. **CHANGES WILL NOT BE PERMITTED UPON COMPLETION AND SUBMISSION OF THE COLOUR CHART.**

HARDWOOD / LAMINATE FLOORING: Due to the properties of wood and laminate, many variables can affect the overall look of the finished product. Variations include but not limited to wood type or laminate finish, colour/stain and wood grain are significant factors that make exact colour matching impossible. The purchaser acknowledges that the hardwood flooring is a pre-finished product in a controlled environment. Expansion, compression and cupping are characteristics of hardwood flooring once installed in the home. The purchaser acknowledges these may become apparent over time and despite the Builders' efforts to install the hardwood flooring materials in keeping with good workmanship, the Builder shall not be responsible nor held liable for minor variances of fluctuation in hardwood flooring materials.

HARDWOOD / LAMINATE WAIVER:

I/We understand hardwood flooring is classified as a porous material and as such not recommended by the Builder in certain areas. I/We understand there is a concern due to possible water and other substances being frequently splashed or spilled onto the floor and in contravention of Ontario Building Code Section 9.30.1.2(1).

"Finished flooring bathrooms, kitchens, public entrance halls, laundry & general storage areas shall consist of resilient flooring, felted-synthetic-fibre floor coverings, concrete, terrazzo, ceramic tile, mastic or other types of flooring providing similar degrees of water resistance."

I/We are prepared to assume full responsibility for any damage caused to the hardwood floor or subfloor due to moisture absorbency in the mentioned areas, and agree to waive any claims against the Township of residence, TARIO and/or the Builder in relation to the matter. ****SEE COLOUR CHART FOR LOCATIONS****

DATE

WASAGA RIVERS EDGE

SITE

LOT

221 North Rivermede Road, Concord, Ontario L4K 3N7 * T: (905) 738.7010 F: (905) 738.5948

BRICK/Joint PATTERN INSTALLATION RELEASE FORM

***BRICK installation is included as a standard on the floor for 12 x 24 tiles and must be noted on the colour chart and acknowledged on this form ***

(Large tiles installation for floor and wall) – ¼ Brick

Please be advised it has come to our attention, that due to production, many of the over-sized and odd shaped, man-made tiles (i.e. porcelain & ceramic), have been found to have a slight bow in the tile. It is a standard occurrence with all suppliers and manufacturers.

It is therefore recommended, that if and when a purchaser requests to install one of these tiles in a brick-joint pattern, that it be installed on a ¼ brick pattern, to try to avoidlippage. Attached with this letter, you will find a layout of the ¼ brick installation that has been recommended.

LOCATIONS: all floors
LOCATIONS: _____
LOCATIONS: _____
LOCATIONS: _____

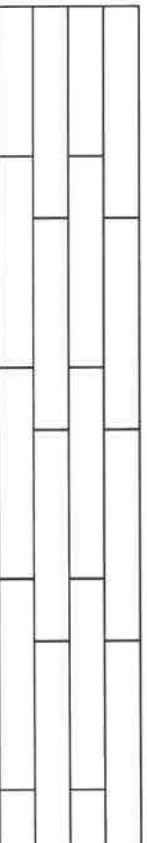

Please understand, even in using this ¼ brick installation, there may still be minimallippage which cannot fully be eliminated.

Hence, when there is a request for brick-joint installation, Zancor Homes and their contractor, cannot be held responsible for this matter.

Homeowner(s) Initial AK

(Small tile installation for walls) – ½ Brick

Purchaser requests to install small wall tiles on a backsplash or shower wall in a brick-joint pattern, that it be installed on a ½ brick pattern.

LOCATIONS: Master Shower wall - Brick vertical
LOCATIONS: _____
LOCATIONS: _____
LOCATIONS: _____

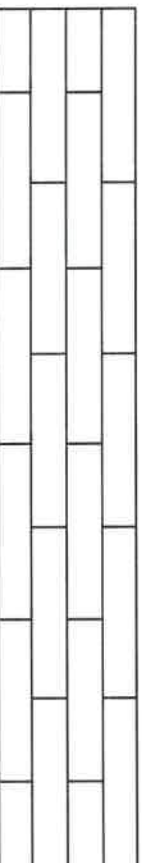

Homeowner(s) Initial AK

DATE Apr 14/22
Jun 1/22

SITE WASAGA RIVERS EDGE

LOT 116

Stone Countertop Edge Profiles

** Where applicable as per site specifications **

STANDARD EDGE FOR KITCHEN & VANITIES

Standard Countertop Edge in Kitchen

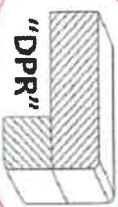

Standard Countertop Edge in Vanity

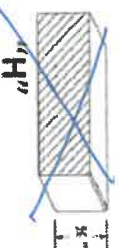

Master
- Main
- Basement
- Laundry
- Kitchen

Homeowner(s) Initial

OPTION (1) EDGE FOR KITCHEN & VANITIES \$250

Optional Edge in Kitchen

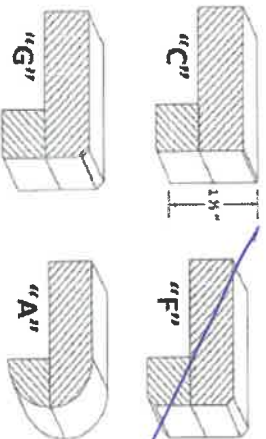

Optional Edge in Bathroom

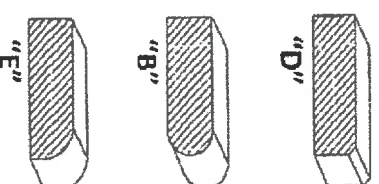

Homeowner(s) Initial

OPTION (2) EDGE FOR KITCHEN & VANITIES CUSTOM PRICING

Optional Edge for Kitchen

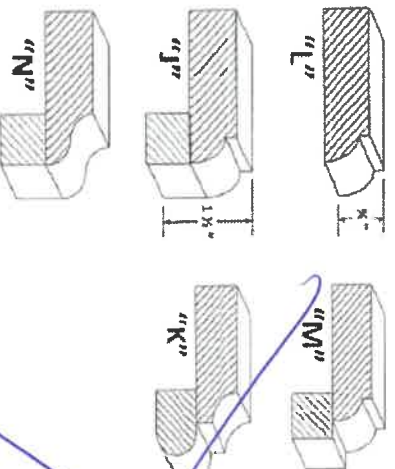

Optional Edge in Vanity

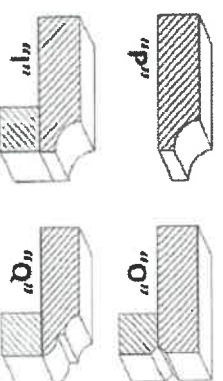

Homeowner(s) Initial

DATE

Apr 14/22
June 1/22

SITE

WASAGA RIVERS EDGE

LOT

116

36" Counter-Depth 3-Door Refrigerator

800 Series – Black Stainless B36CT80SNB

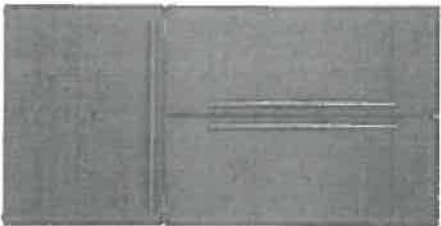

B36CT80SNB
Black Stainless

Also available in:
Stainless Steel
B36CT80SNS

Introducing the revolutionary, new FarmFresh System™, with four freshness technologies designed to work together to keep your food fresher, longer. Enjoy less food waste, new innovative features and more thoughtful design.

Features & Benefits

VitaFreshPro™ provides pre-programmed freshness settings to optimize temperature and humidity to keep meat, fish, and produce fresher, longer.

Interior Water Dispenser is thoughtfully placed inside for refreshing water at the touch of a button or a push of a nozzle.

FlexBar™ utilizes typically unused space in the upper refrigerator cavity.

General Properties		
Full 72" height and true counter depth for built-in appearance	Yes	
Lighting	Recessed LED light bars	
Number of compressors / evaporators	2 / 2	
Defrost process refrigerator section	Frost-free	
Number of shelves – refrigerator	5	
Adjustable shelves – refrigerator	4 half-width	
Shelf material – refrigerator	Tempered glass	
Type of shelves – refrigerator	Frameless split shelves with metal trim	
Flexible storage bar	FlexBar™	
Gallon storage bins	2	
Humidity control compartments	2	
Full width temp. & humidity controlled drawer	VitaFreshPro™	
Ice maker	Yes	
Water filter	UltraClarityPro™	
Internal water dispenser	Yes	
Touch control panel	Yes	
AirFresh® filter	Yes	
FreshProtect™ ethylene filter	Yes	
MultiAirFlow™	Yes	
Stainless steel back wall	Yes	
Defrost process freezer section	Automatic	
Number of drawers – freezer	3	
Wi-Fi enabled	Yes, Home Connect™ app	

Capacity		
Total capacity (cu. ft.)	20.8	
Refrigerator capacity (cu. ft.)	14.8	
Freezer capacity (cu. ft.)	6	
Technical Details		
Current (A)	15 A	
Volts (V)	115 V	
Frequency (Hz)	60 Hz	
Power cord length (in.)	91	
Plug type	120V-3 prong	
Dimensions & Weight		
Appliance dimensions with hinges, handles and doors (H x W x D) (in.)	72"" x 35 5/8" x 31 1/8"	
Appliance dimensions without hinges and doors (H x W x D) (in.)	71 1/2" x 35 5/8" x 24""	
Appliance dimensions with hinges and doors, no handles (H x W x D) (in.)	72"" x 35 5/8" x 28 3/4"	
Required cutout size (H x W x D) (in.)	72" x 36" x 25"	
Net weight (lbs)	350 lbs	
Efficiency		
Energy consumption (kWh/yr)	570	
ENERGY STAR® qualified	Yes	
Accessories		
UltraClarityPro™ Water Filter: BORPLFTR50 FlexBar™ Bottle Holder: BOFLEXBOTL FlexBar™ Deep Shelf: BOFLEXLGSH FlexBar™ Shallow Shelf: BOFLEXSMSh Ethylene Filter Refill Kit: FPETHRF50		



*When leveling legs are fully extended, add 6/8" to overall height, total 72 5/8".
**The cutout depth of 25" includes the required 1" airflow. The electrical covers on the back of unit do not require additional depth

Accessories: To purchase Bosch accessories, cleaners & parts please visit www.bosch-home.com/us/store or call 1-800-964-2904 (Mon to Fri 9 am to 6 pm PST Sat 9 am to 3 pm PST)
Notes: All height, width and depth dimensions are shown in inches. BSH reserves the absolute and unrestricted right to change product materials and specifications, at any time, without notice. Consult the product's installation instructions for final dimensional data and other details prior to making cutout.
Warranties: Please see Use & Care manual or Bosch website for statement of limited warranty.

For more information on our entire line of products, go to www.bosch-home.com/us or call 1-800-944-2904
© 2018 Home Appliances Corporation. All rights reserved. Bosch is a registered trademark of Robert Bosch GmbH.

116 81E

36" Counter-Depth 3-Door Refrigerator

800 Series – Black Stainless B36CT80SNB



Installation Details

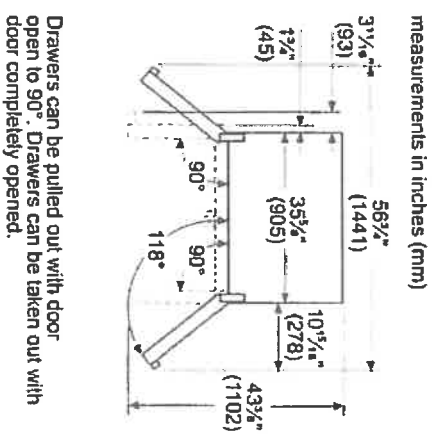
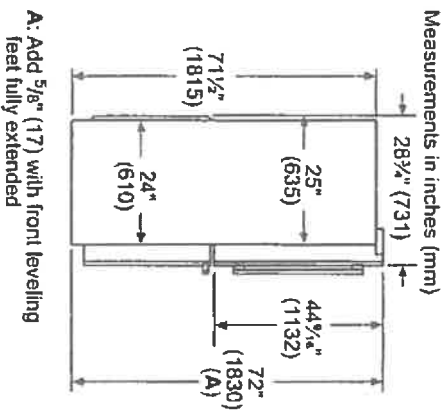
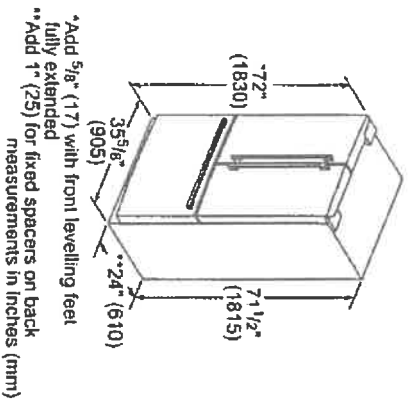

Measurements in inches (mm)

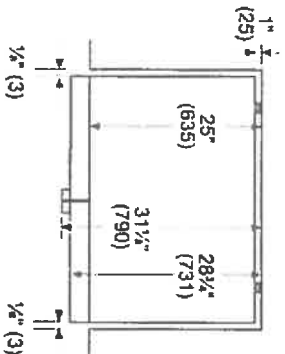

measurements in inches (mm)

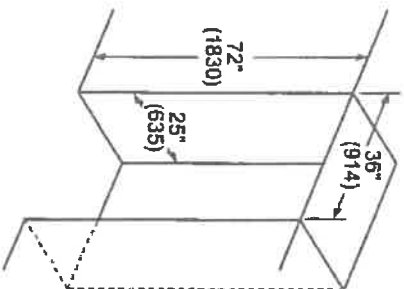

Leave 1/2" (12.7) gap at the top and 1" (25.4) behind the refrigerator for proper ventilation.

It is recommended that you do not install the refrigerator near a heat source such as a stove or a range.

Accessories: To purchase Bosch accessories, cleaners & parts please visit www.bosch-home.com/us/store or call 1-800-944-2004 (Mon to Fri 5 am to 6 pm PST, Sat 6 am to 3 pm PST)

Notes: All height, width and depth dimensions are shown in inches. BSH reserves the absolute and unrestricted right to change product materials and specifications, at any time, without notice. Consult the product's installation instructions for final dimensional data and other details prior to making cutout.

Warranties: Please see Use & Care manual or Bosch website for statement of limited warranty.

For more information on our entire line of products, go to www.bosch-home.com/us or call 1-800-944-2304

BSH Home Appliances Corporation. All rights reserved. Bosch is a registered trademark of Robert Bosch GmbH.

116 RF

Frigidaire Gallery



Induction Cooktop

36" Induction Cooktop

GCC13667AB

Available Colors : Black

Version : 01/22

Cooktop Performance		
Right Front Element Burner Size	8"	Certifications and Approvals
Right Rear Element Burner Size	6"	ADA Compliant
Left Front Element Burner Size	7"	Safety Certifications and Approvals
Left Rear Element Burner Size	7"	
Center Element Burner Size	8"	
Right Front Element Burner	2,300 / 3,600 Watts (Boost)	
Right Rear Element Burner	1,450 / 2,500 Watts (Boost)	Yes
Left Front Element Burner	1,800 / 2,600 Watts (Boost)	Yes
Left Rear Element Burner	1,800 / 2,600 Watts (Boost)	Yes
Center Element Burner	2,300 / 3,600 Watts (Boost)	Yes

Display	Front
Control Location	Red
Display Interface Color	Red

Dimensions and Volume	
Height	27/8"
Width	36 3/4"
Depth	21 3/8"
Cutout Height	3 5/8"
Minimum Cutout Width	33 7/8"
Minimum Cutout Depth	19 1/8"
Maximum Cutout Width	36 1/8"
Maximum Cutout Depth	20 1/2"

Electrical Specifications	40 Amps
Amps @ 240 Volts	40 Amps
Minimum Circuit Required	

General Specifications	Yes
Prop 65 Label	1 Year
Warranty - Labor	1 Year
Warranty - Parts	1 Year
Frigidaire Fit Promise	Yes

Note: For planning purposes only. Always consult local and national electric, gas and plumbing codes. Refer to Product Installation Guide for detailed installation instructions on the web at frigidaire.com / frigidaire.ca. Specifications subject to change. Accessories information available on the web at frigidaire.com / frigidaire.ca.

USA • 10200 David Taylor Drive • Charlotte, NC 28225 • 1-800-FRIGIDAIRE • frigidaire.com

116 PE

Frigidaire Gallery

36" Induction Cooktop

GCC13667AB

Version : 01/22

Cooktop Dimensions

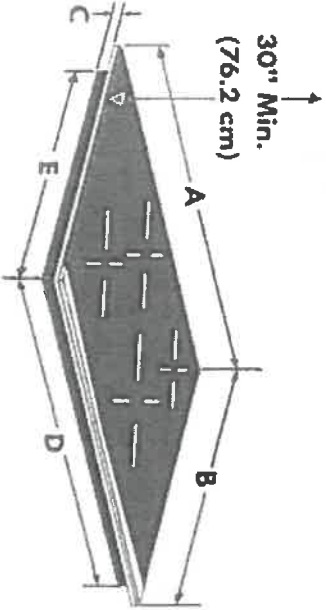

Cooktop Cutout Dimensions

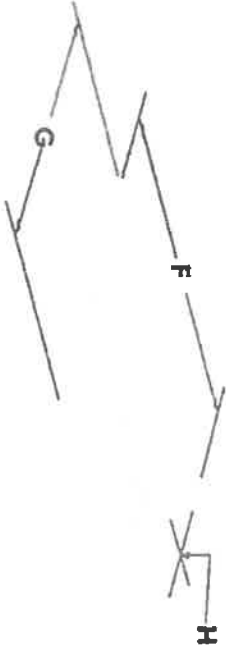

COOKTOP DIMENSIONS					CUTOUT DIMENSIONS				
A. WIDTH	B. DEPTH	C. HEIGHT	D. WIDTH	E. DEPTH	F. WIDTH		G. DEPTH		H. HEIGHT
					Min.	Max.	Min.	Max.	
36 1/2 (93.4)	21 1/8 (54.4)	2 7/8 (7.3)	33 3/4 (85.4)	18 1/8 (47.9)	33 1/8 (86.0)	36 1/8 (91.8)	19 1/8 (48.6)	20 1/2 (52.1)	3 1/8 (9.2)

Note: For planning purposes only. Always consult local and national electric, gas and plumbing codes. Refer to Product Installation Guide for detailed installation instructions on the web at frigidaire.com / frigidaire.ca. Specifications subject to change. Accessories information available on the web at frigidaire.com / frigidaire.ca.
USA - 1-800-David Taylor Drive • Charlotte, NC 28762 • 1-800-FRIGIDAIRE • frigidaire.com

11/6 PK

30" Speed Combination Oven

800 Series – Black Stainless Steel HBL8743UC

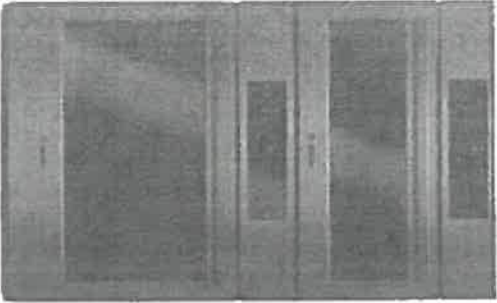

HBL8743UC
Black Stainless Steel

Also available in:
Stainless Steel HBL8753UC

Bosch speed combination ovens create an all-in-one cooking center with an upper speed oven and a Genuine European Convection oven below.

Features & Benefits

Bosch black stainless steel helps guard against scratches and fingerprints.

2-in-1 microwave and convection oven with 9 SpeedChef® programs to simplify cooking with fast results.

Lower oven's convection multi-track mode gives uniform baking results even when using all 3 racks simultaneously.

Download the Home Connect app to remotely monitor and control your Bosch wall oven with your smart phone or tablet.

General Properties	
Home Connect* – lower cavity (WiFi enabled)	Yes
Cooking modes – upper cavity	Speed oven, 12 Auto Programs (including Auto Defrost, Melt Butter, Soften Ice Cream, Pizza), 9 Sensor Cook Programs, 9 SpeedChef® Programs, Hi & Lo Broil, European Convection, Keep Warm, Frozen Foods
Cooking modes – lower cavity	Bake, Variable Broil (hi & low), Roast, Warm, Sabbath, Proof Dough, Convection Bake, Convection Broil, Convection Roast, Pizza, Multi Rack Genuine European Convection, Convection Conversion, Temperature Probe, Fast Preheat
Cleaning type	Self Clean
Telescopic rack	1
Illumination type	LED (Upper) / Halogen (Lower)
Interior lights	1 Upper / 2 Lower
Oven Performance	
Microwave power – upper cavity	1000 W
Bake / broil element wattages – upper cavity	600 / 1,750 W
Convection element wattages – upper cavity	1,700 W
Bake / broil element wattages – lower cavity	2,400 / 3,800 W
Convection element wattages – lower cavity	2,000 W
Technical Details	
Watts (W)	9,600 W
Circuit breaker (A)	40 A
Volts (V); Frequency (Hz)	240 / 208 V; 60 Hz
Power cord length (in)	50"
Plug type	Fixed Connection, No Plug
Energy source	Electric

Dimensions & Weight	
Overall appliance dimensions (HxWxD) (in)	49" x 29 3/4" x 24 1/2"
Required cutout size – Standard (HxWxD) (in)	48 5/8" x 28 1/2" x 23 1/2"
Required cutout size – Flush (HxWxD) (in)	49 1/8" x 30" x 24 1/2"
Speed oven cavity size – upper	1.6 cu. ft.
Overall upper speed oven interior dimensions (HxWxD) (in.)	9 7/8" x 16 1/2" x 16 1/2"
Metal turntable diameter (in)	13 3/4" dia.
Turntable – ceramic cookware max. – upper	12 1/2" dia.
Rack – rectangular cookware max. – upper	15" x 12"
Oven cavity size – lower	4.6 cu. ft.
Overall lower oven interior dimensions (HxWxD) (in)	17 13/16" x 24 1/8" x 18"
Usable lower oven interior dimensions (HxWxD) (in)	12 1/4" x 23 1/4" x 15 1/4"
Net weight (lbs)	259 lbs
Accessories – Included	
Upper Oven: Metal Turntable, Square rack, Ceramic Cooking Tray	
Lower Oven: 1 Telescopic and 2 Standard Oven Racks, Meat Probe	
Accessories – Optional	
 HEZTR301 30" Telescopic Rack	



Accessories: To purchase Bosch accessories, cleaners & parts please visit www.boschhome.com/us/store or call 1-800-944-2304 (Mon to Fri 5 am to 6 pm PST, Sat 6 am to 3 pm PST)

Notes: All height, width and depth dimensions are shown in inches. BSH reserves the absolute and unrestricted right to change product materials and specifications, at any time, without notice. Consult the product's installation instructions for final dimensional data and other details prior to making cutout.

Warranties: Please see Use & Care manual or Bosch website for statement of limited warranty

For more information on our entire line of products, go to www.boschhome.com/us or call 1-800-944-2304

* BSH Home Appliances Corporation. All rights reserved. Bosch is a registered trademark of Robert Bosch GmbH

11/6 R/E

30" Speed Combination Oven

800 Series - Black Stainless Steel HBL8743UC



BOSCH
Invented for life

Installation Details

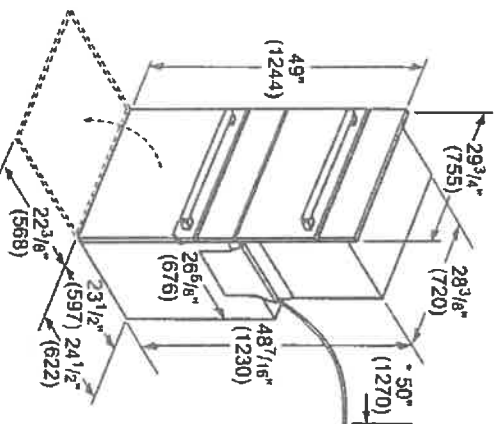

* Power cable 50" (1270 mm) from the lower oven.

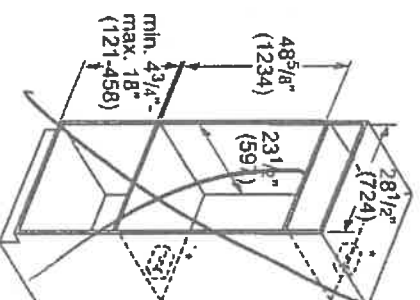

* Junction box may be installed above, below, or to the left or right of the unit within reach of the power cable

measurements in inches (mm)

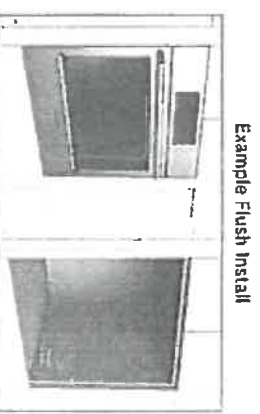
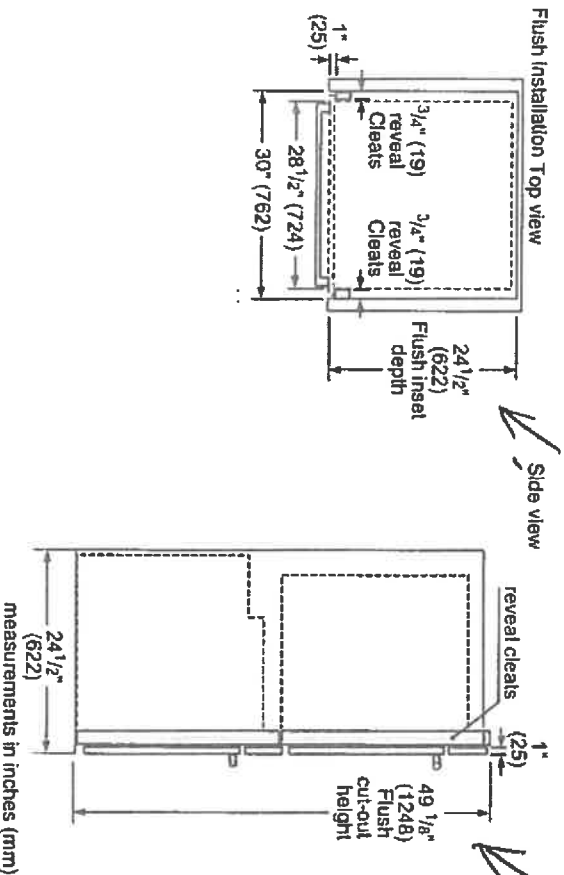

Single wall oven shown.

Accessories: To purchase Bosch accessories, cleaners & parts please visit www.bosch-home.com/us/store or call 1-800-944-2304 (Mon to Fr: 5 am to 6 pm PST, Sat: 6 am to 3 pm PST).

Notes: All height, width and depth dimensions are shown in inches. BSH reserves the absolute and unrestricted right to change product materials and specifications, at any time, without notice. Consult the product's installation instructions for final dimension data and other details prior to making cutout.

Warranties: Please see Use & Care manual or Bosch website for statement of limited warranty.

For more information on our entire line of products, go to www.bosch-home.com/us or call 1-800-944-2304

BSH Home Appliances Corporation. All rights reserved. Bosch is a registered trademark of Robert Bosch GmbH.

11/6/21

24" Pocket Handle Dishwasher

800 Series – Black Stainless Steel SHPM78Z54N

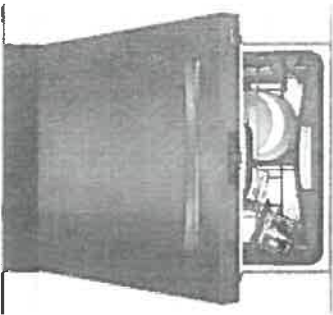

SHPM78Z54N
Black Stainless Steel

Also available in:

Stainless Steel	SHPM78Z55N
White	SHPM78Z52N
Black	SHPM78Z56N

Patented CrystalDry™ technology transforms moisture into heat to get dishes, including plastics, 60% drier.¹

Features & Benefits

42 dBA: dishwasher runs quietly so your kitchen conversations aren't interrupted.

The Flexible 3rd Rack with fold down sides adds 30% more loading area, perfect for utensils and ramekins.

The AquaStop® leak protection system contains leaks through a precisely engineered system. If a leak occurs, the system contains it by shutting down operation and pumping out water. So you have the ultimate peace of mind whether you are away or at home.

Based on aggregate average drying performance of Bosch Dishwashers with CrystalDry on combined household load including plastics, glass, steel, and porcelain as compared to Bosch Dishwashers with PureDry. Drying performance may vary by dish type.

-Compared to a Bosch dishwasher with 2 racks.

¹Certification to NSF/ANSI Standard 184 for residential dishwashers September 2020 running production change to remove adhesive coating clips for power cord. These clips and the edge protector are now included in the dishwasher accessory kit a SMZEPCC1UC

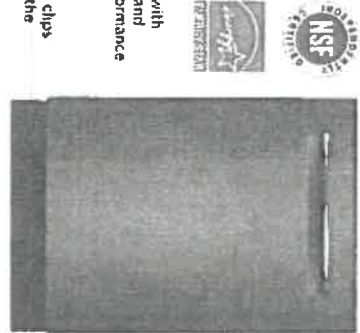

Accessories: To purchase Bosch accessories, cleaners & parts please visit www.bosch-home.com/us/store or call 1-800-944-2304 (Mon to Fri 5 am to 6 pm PST, Sat 6 am to 3 pm PST). **Notes:** All height, width and depth dimensions are shown in inches. BSH reserves the absolute and unrestricted right to change product materials and specifications, at any time, without notice. Consult the product's installation instructions for final dimensional data and other details prior to making cutout.

Warranties: Please see Use & Care manual or Bosch website for statement of limited warranty.

For more information on our entire line of products, go to www.bosch-home.com/us or call 1-800-944-2304

¹ Best Home Appliances Corporation. All rights reserved. Bosch is a registered trademark of Robert Bosch GmbH.

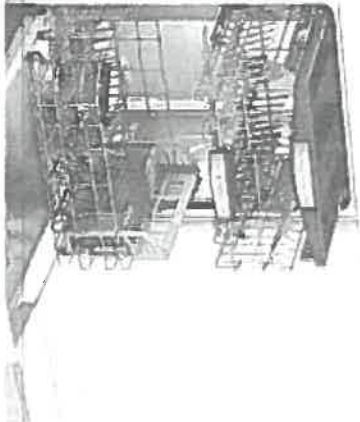

General Properties		
Number of wash cycles	6	
Number of options	5	
dBa	42	
Drying system	CrystalDry™ option	
Third rack	Flexible 3rd Rack	
Rack adjustability	Rackmatic®	
Tub material	Stainless Steel	
Control type	Touch Control	
Concealed water heating element	Yes	
Leak protection system	24/7 AquaStop®	
NSF®-certified ¹ sanitize option	Yes	
Water softener	No	
Five-level wash	Yes	
ChildLock	No	
Special features	InfoLight®	
Efficiency		
Water usage per cycle	3.5	
Energy efficiency class	Tier 1	
ENERGY STAR® qualified	Yes	
Total annual energy consumption (kwh)	269	
Total annual water consumption (g)	623.5	
Capacity		
Number of place settings	16	

Technical Details		
Watts (W)	1440 W	
Current (A)	12 Amps	
Volts (V)	120 V	
Frequency (Hz)	60 Hz	
Power cord full length	67"	
Power cord install length from edge of unit when facing the door (in): ²	Left – 45" Right – 56"	
Minimum water pressure (lb/sin)	14	
Length outlet hose (in)	79"	
Dimensions & Weight		
Overall appliance dimensions (HxWxD) (in)	33 7/8" x 23 9/16" x 23 3/4"	
Required cutout size (HxWxD) (in)	33 7/8" x 23 5/8" x 24"	
Adjustable feet	Yes	
Net weight (lbs)	102 lbs	
Accessories-Optional		
Junction Box	SMZPCJB1UC	
Bosch Dishwasher Water Supply Hose	SMZSH002UC	
Drain Hose Extension Kit	SGZ1010UC	
Dishwasher Accessory Kit	SMZ5000	
Anti-Tarnish Silverware Cassette	SMZ5002UC	
Edge Protector + Power Cord Clip Install Kit	SMZEPCC1UC	

24" Pocket Handle Dishwasher

800 Series - Black Stainless Steel SHPM78Z54N



BOSCH
Invented for life

Installation Details

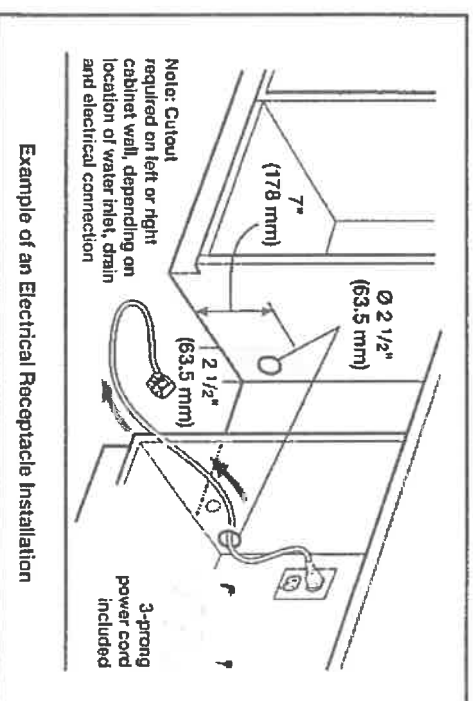
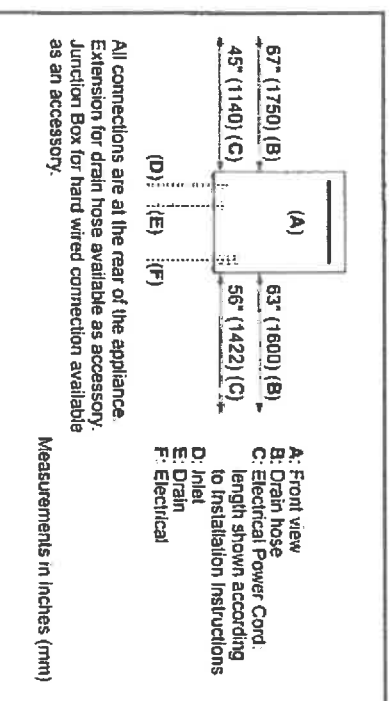
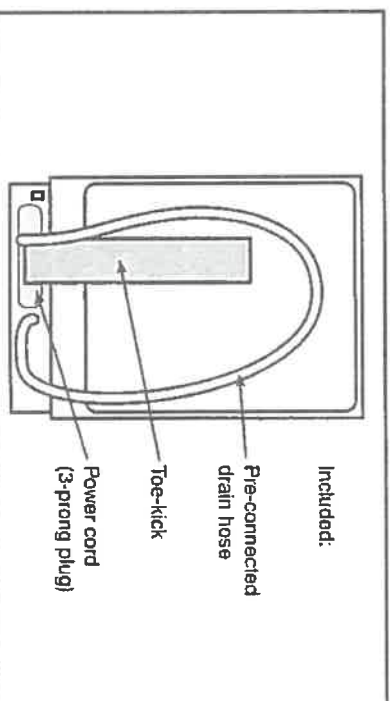
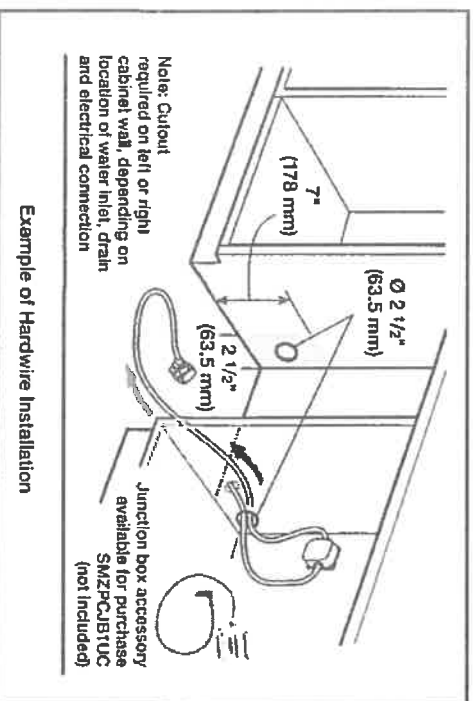
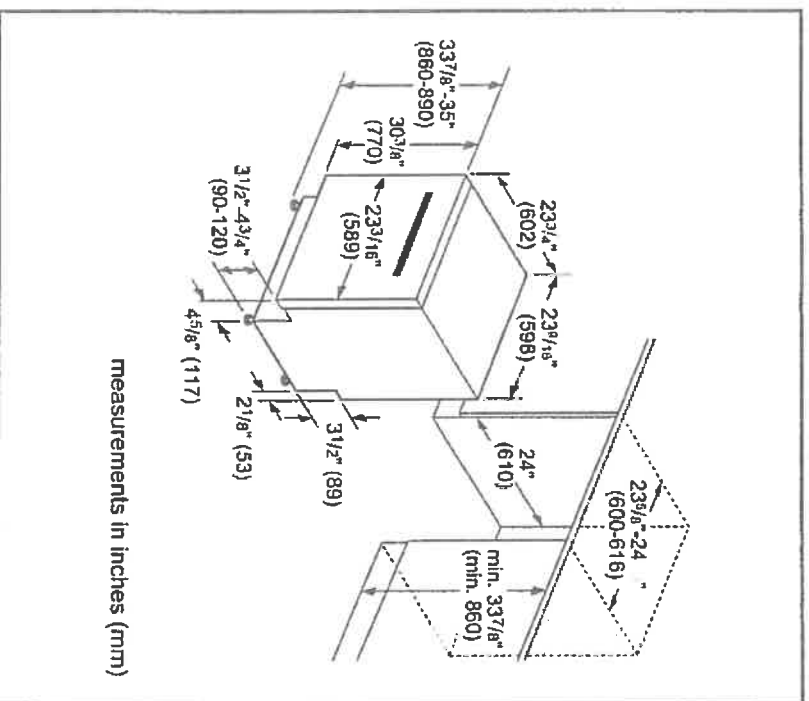

Accessories: To purchase Bosch accessories, cleaners & parts, please visit www.bosch-home.com/us/store or call 1-800-944-2504 (Mon to Fri 5 am to 6 pm PST, Sat 6 am to 3 pm PST).

Notes: All height, width and depth dimensions are shown in inches. BSH reserves the absolute and unrestricted right to change product materials and specifications, at any time, without notice. Consult the product's installation instructions for final dimensional data and other details prior to making cutout.

Warranties: Please see Use & Care manual or Bosch website for statement of limited warranty.

For more information on our entire line of products, go to www.bosch-home.com/us or call 1-800-944-2504

BSH Home Appliances Corporation All rights reserved. Bosch is a registered trademark of Robert Bosch GmbH

11/19/21

Electrolux

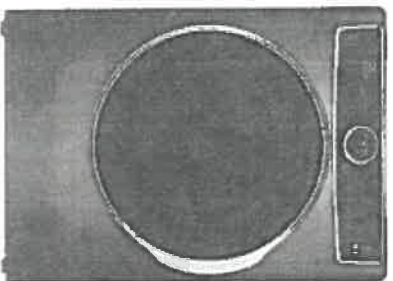

Front Load Washer

5.2 Cu.Ft. I.E.C Front Load Washer

ELFW7637AT, ELFW7637AW

Available Colors : Titanium, White

Version : 06/21

Washer			
Drum Light	Yes		
Drum Material	Stainless Steel		
Maximum Spin Speed	1,300 RPM		
Water Heater	Yes		
Water Level Adjustment	Yes		
Washer Cycles			
Act vewear	Yes		
Clean Washer	Yes		
Colors	Yes		
Cycle Count	11		
Delicates	Yes		
Fast Wash	Yes		
Hand Wash	Yes		
Heavy Duty	Yes		
Normal	Yes		
Optic Whites	Yes		
Rinse and Spin	Yes		
Towels	Yes		
Allergen	Yes		
Washer Options			
Delay Start Time	1-12 Hours		
Extended Refresh	Yes		
Extra Rinse	Yes		
Perfect Steam	Yes		
Pure Rinse	Yes		
Stain Soak	Yes		
Steam	Yes		
Soil Levels			
Extra Light	Yes		
Light	Yes		
Normal	Yes		
Heavy	Yes		
Solid Soil			Yes
Temperature Settings			
Eco Cold			Yes
Cool			Yes
Warm			Yes
Hot			Yes
Sanitize			Yes
Washer Spin Speeds			
Spin Speed Selections			5
Max			Yes
High			Yes
Medium			Yes
Low			Yes
No Spin			Yes
Controls			
Cancel			Yes
Cycle Status Lights			Yes
Delay Start			Yes
Control Lock			Yes
Pause Function			Yes
Power On/Off			Yes
Start			Yes
Dispenser			
Bleach D spenser			Yes
Detergent Dispenser			Yes
Fabric Softener Dispenser			Yes
Prewash Detergent Dispenser			Yes
PODS Dispenser			Yes
Exterior			
Door Latch			Yes
Reversible Door			Yes

High standards of quality at Electrolux Home Products, Inc. mean we are constantly working to improve our products. We reserve the right to change specifications or discontinue models without notice.

Electrolux Major Appliances, I.A.

USA • 10200 David Taylor Drive • Charlotte, NC 28262 • 1-877-Electrolux (1-877-435-3287) • electroluxappliances.com

116 RF

5.2 Cu.Ft. I.E.C Front Load Washer

ELFW7637AT, ELFW7637AW

Version : 06/21

Dimensions and Volume	
Height	38"
Width	27"
Depth	24"
Washer Drum Capacity I.E.C.	5.2 Cu. Ft.
Electrical Specifications	
Minimum Circuit Required Voltage Rating	15 Amps 120 V
Energy Data	
Integrated Water Factor kWh/year	3.2 85 kWh
Modified Energy Factor Water Usage/Year	2.92 4,248 Gallons
Installation	
Optional Pedestal Stackable	Yes Yes
General Specifications	
Chime On / Chime Off	Yes
Leveling Legs	Yes
Product Weight	217 lbs
Prop 65 Label	No
Warranty - Labor	1 Year
Warranty - Parts	1 Year
Performance Certifications and Approvals	
CEE Tier	Tier 2
ENERGY STAR Certified	Yes
ENERGY STAR Most Efficient	Yes
High Efficiency	Yes
Safety Certifications and Approvals	
UL Listed	Yes
NSF Certified	Yes
Sanitization and Allergy Reduction	Yes

High standards of quality at Electrolux Home Products, Inc. mean we are constantly working to improve our products. We reserve the right to change specifications or discontinue models without notice.

Electrolux Major Appliances, N.A.
USA • 10200 David Taylor Drive • Charlotte, NC 28262 • Charlotte, NC 28262 • 1-877-4electrolux (1-877-435-3287) • electroluxmajorappliances.com

11/10 RF

Electrolux

5.2 Cu.Ft. I.E.C Front Load Washer

ELFW7637AT, ELFW7637AW

Version : 06/21

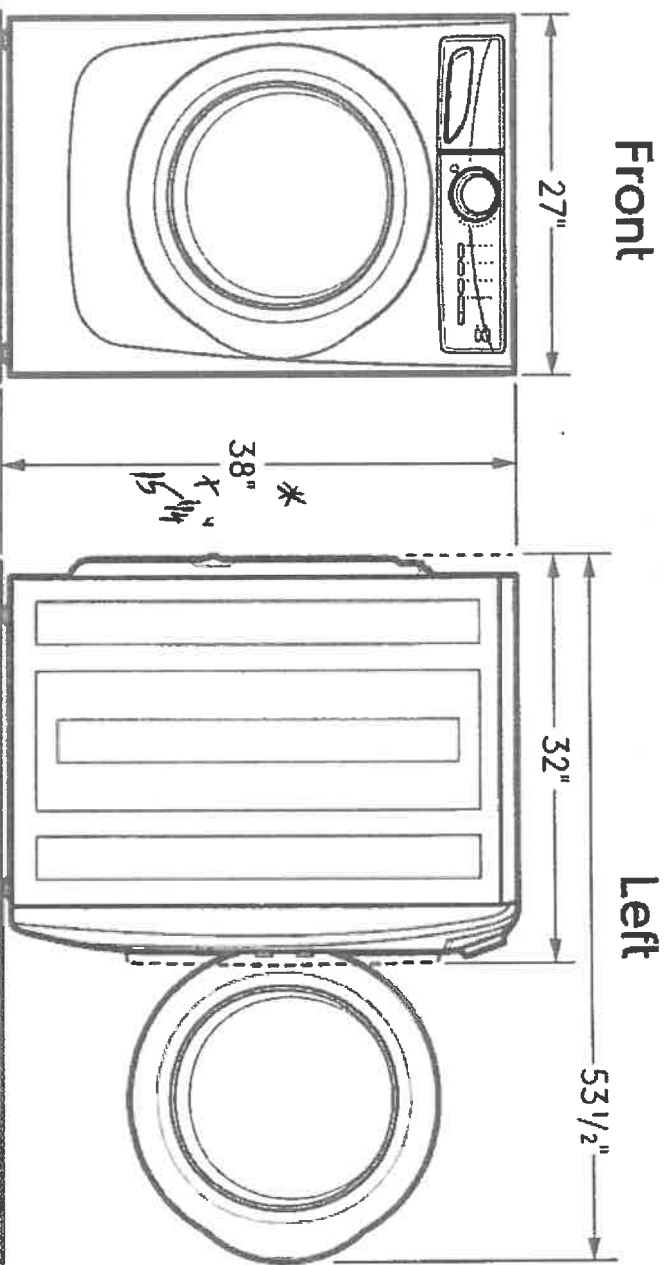

Rear

Optional 15" Pedestal Drawer

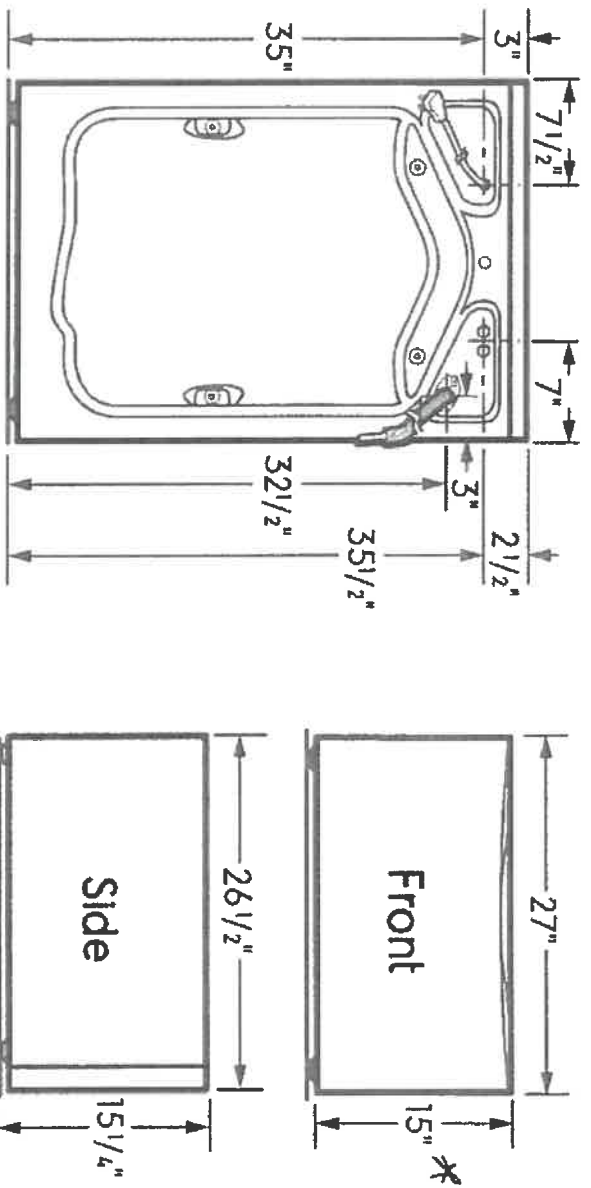

High standards of quality at Electrolux Home Products, Inc. mean we are constantly working to improve our products. We reserve the right to change specifications or discontinue models without notice.

Electrolux Major Appliances, I.A.
USA • 10300 David Taylor Drive • Charlotte, NC 28262 • 1-877-Electrolux (1-877-435-3287) • electroluxappliances.com

1160 BX

Electrolux

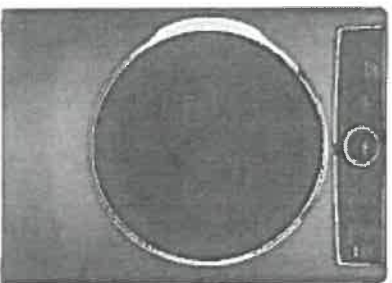

Dryer

Electric 8.0 Cu. Ft. Front Load Dryer

ELFE763CAT, ELFE763CAW

Available Colors : Titanium, White

Version : 05/21

Dryer			
Air Flow	200 CFM	Eco Dry	Yes
Balanced Dry	Yes	Dryness Level	
Drum Back Type	Painted Steel	Max	Yes
Drum Material	Stainless Steel	High	Yes
Dryness Level Selections	Yes	Normal	Yes
Lint Filter	Yes	Low	Yes
		Damp	Yes
Dryer Cycles		Controls	
Activewear	Yes	Cancel	Yes
Air Dry	Yes	Cycle Status Lights	Yes
Allergen	Yes	Delay Start	Yes
Cycle Count	11	Estimated Time Remaining	Yes
Delicates	Yes	Control Lock	Yes
Fast Dry	Yes	Pause Function	Yes
Heavy Duty	Yes	Power On/Off	Yes
Instant Refresh	Yes	Start	Yes
Mixed Load	Yes		
Normal	Yes	Exterior	
Timed Dry Time	Yes	Door Latch	Yes
Towels	Yes	Reversible Door	Yes
Dryer Options		Dimensions and Volume	
Anti Static	Yes	Height	38"
Delay Start Time	1-12 Hours	Width	27"
Drum Light	Yes	Depth	32"
Dry Boost	Yes	Dryer Drum Capacity	8 Cu. Ft.
Extended Tumble	Yes		
Perfect Steam	Yes	Electrical Specifications	
Wrinkle Release	Yes	Minimum Circuit Required	30 Amps
		Voltage Rating	240 V
Drying Temperatures		Voltage Rating	208/240v
Low	Yes	Installation	
Normal	Yes	Optional Pedestal	Yes
High	Yes		
Sanitize	Yes		

High standards of quality at Electrolux Home Products, Inc. mean we are constantly working to improve our products. We reserve the right to change specifications or discontinue models without notice.

Electrolux Major Appliances, N.A.

USA • 10200 David Taylor Drive • Charlotte, NC 28262 • Charlotte, NC 28262 • 1-877-Electrolux (1-877-435-4287) • electroluxappliances.com

11/10 BK

Electrolux

Electric 8.0 Cu. Ft. Front Load Dryer

ELFE763CAT, ELFE763CAW

Version : 05/21

General Specifications

Chime On / Chime Off	Yes
Leveling Legs	Yes
Product Weight	126 lbs
Warranty - Labor	1 Year
Warranty - Parts	1 Year

Performance Certifications and Approvals

ENERGY STAR Certified	Yes
-----------------------	-----

Safety Certifications and Approvals

UL listed	Yes
-----------	-----

High standards of quality at Electrolux Home Products, Inc. mean we are constantly working to improve our products. We reserve the right to change specifications or discontinue models without notice.

Electrolux Major Appliances, I.A.
USA • 10200 David Taylor Drive • Charlotte, NC 28262 • Charlotte, NC 28262 • 1-877-4Electrolux (1-877-435-3287) • electroluxmajorappliances.com

11/16 DE

Electrolux

Electric 8.0 Cu. Ft. Front Load Dryer

ELFE763CAT, ELFE763CAW

Version : 05/21

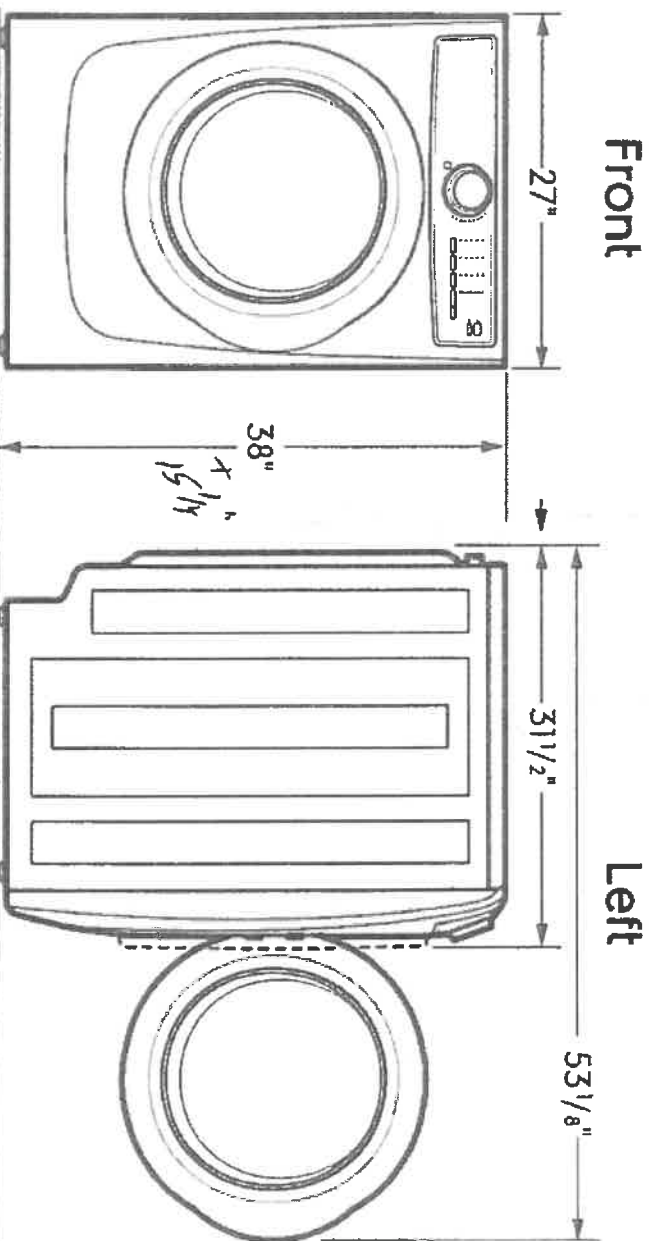

Rear

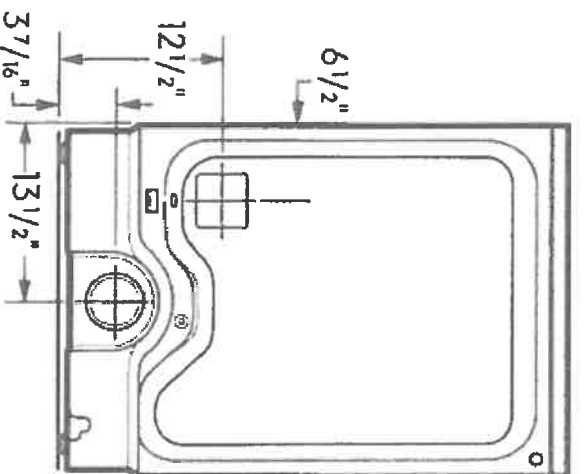

Optional 15" Pedestal Drawer

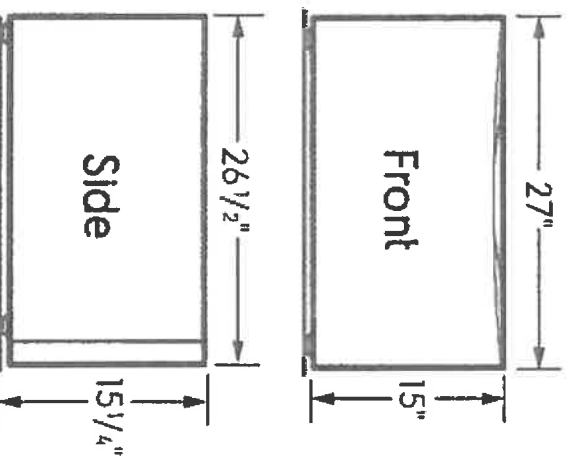

High standards of quality at Electrolux Home Products, Inc. mean we are constantly working to improve our products. We reserve the right to change specifications or discontinue models without notice.

Electrolux Major Appliances, I.A.

USA • 10200 David Taylor Drive • Charlotte, NC 28262 • Charlotte, NC 28262 • 1-877-Electrolux (1-877-435-3287) • electroluxmajorappliances.com

11/10 R2