

CONSTRUCTION SUMMARY OF EXTRAS

Printed 2021-12-08 / 3:40 PM / Page 1 of 1

Site:
Lot:
Model:
Purchaser:
Phone:
Email:

WASAGA
167
CORAL (60-04) ELEV C
GNANENDRAN SRIPATHMANATHAN
NIRAJA GNANENDRAN
416.823.3552 / 416.857.4456
NIRAJADANNY@YAHOO.COM



| DESCRIPTION | | DATE SELECTED |
|---|--|-----------------|
| BONUS PACKAGE: 3 PIECE STAINLESS STEEL APPLANCES WITH WHITE TOP LOAD WASHER & DRYER | | INCLUDED IN APS |
| BONUS PACKAGE: STAINLESS STEEL HOOD FAN | | INCLUDED IN APS |
| STRUCTURALS | | |
| 1 | GARDEN DOORS AT REAR, 8 FEET HIGH (HINGED IN CENTER, MULTI- POINT IN LIEU OF SLIDING DOOR, AS PER PLAN | 1-Dec-21 |
| 2 | SMOOTH CEILINGS MAIN FLOOR | 1-Dec-21 |
| COLOURS | | |
| 1 | KITCHEN CABINETS- UP 2 | 1-Dec-21 |
| 2 | MASTER SHOWER FLOOR- UP 2 | 1-Dec-21 |
| 3 | HARDWARE FOR CABINETS | 1-Dec-21 |
| 4 | ELECTRICAL- 2 CAPPED LIGHTS OVER KITCHEN ISLAND, ON SEPARATE SWITCH. STD LIGHT TO REMAIN | 1-Dec-21 |
| 5 | MASTER BANK OF DRAWERS | 1-Dec-21 |
| 6 | TRIM- COLONIAL- UP 1 | 1-Dec-21 |
| 7 | POS- TEMP 90 DEGREE TUB/SHOWER FAUCET WITH 3 FUNCTION TRANSFER VALAVE/TRIM AND SLIDE BAR WITH HAND SHOWER TS2713EP/ U361C1/ UTS4172/ 62320/ S3879EP/ A721- BRUSHED NICKLE---SEE SPEC--MASTER BATHROOM | 1-Dec-21 |
| 8 | 90 DEGREE TWO HANDLE ROMAN TUB FAUCET- TS903/ 4796- BRUSHED NICKLE- SEE SPEC- MASTER BATHROOM | 1-Dec-21 |
| 9 | 90 DEGREE TWO HANDLE ADJUSTABLE WIDESPREAD LAV FAUCET WITH LIFT ROD DRAIN- BRUSHED NICKLE- MASTER BATHROOM- TS6720/ 69000---- QTY 2 | 1-Dec-21 |
| 10 | METHOD MOEN 24" TOWEL BAR- YB2424- QTY 1- MAIN BATH | 1-Dec-21 |
| 11 | PIVOTING PAPER HOLDER- YB2486- QTY 2- POWDER AND MAIN | 1-Dec-21 |
| 12 | 9" TOWEL BAR-INSTALL NEAR SINK FOR HAND TOWEL- YB2408- POWDER AND MAIN | 1-Dec-21 |
| 13 | 90 DEGREE TOILET TANK LEVER- YB8801- BRUSHED NICKLE- MASTER BATH- SEE SPEC | 1-Dec-21 |
| 14 | 90 DEGREE PIVOTING PAPER HOLDER- YB8808- BRUSHED NICKLE- MASTER BATH- SEE SPEC | 1-Dec-21 |
| 15 | 90 DEGREE 18" TOWEL BAR- YB8818- BRUSHED NICKLE- MASTER BATH- SEE SPEC | 1-Dec-21 |
| 16 | HARDWOOD- UP 1- FAMILY ROOM, DINING ROOM, MAIN HALL, LIBRARY- UP 1 | |
| 17 | STAIN FOR STAIRS TO MATCH HARDWOOD AS CLOSE AS POSSIBLE | |
| 18 | WATERLINE FOR FRIDGE | |
| 19 | EXTERIOR LIGHT ROUGH IN WITH SEPARATE SWITCH- SEE SKETCH- LOCATED AT FRONT OF HOUSE. REQUESTING INSTALLATION TO BE 8" ABOVE STONE TRIM | |
| 20 | N/A | |
| 21 | N/A | |
| 22 | EXTERIOR POT LIGHT AT FRONT OF HOUSE ON SEPARATE SWITCH-- QTY 2- SEE SKETCH FOR LOCATION | |
| 23 | EXTERIOR POT LIGHT AT REAR HOUSE ON SEPARATE SWITCH- QTY 2- SEE SKETCH | |
| 24 | MASTER BATHROOM COUNTER- UP 1, INLUCED OVAL UNDERMOUNT SINKS X 2 | |

- ADDITIONAL - ELECTRICAL REQUIRED AS PER SMART-TECH
1. Outlet in family room above fireplace approx 5'5" AFF

2. Outlet in master bedroom against ensuite wall where tub is approx 5'5" AFF

3. Outlet in bedroom 2 against closet wall approx 5'5" AFF

4. Outlet in bedroom 3 against closet wall approx 5'5" AFF

ZANCOR HOMES COLOUR CHART

PRINTED 2021-12-01, 4:33 PM

| ENTRANCES | | | | |
|---|--------------|---|-----------------|--|
| Main Foyer - FLOORING | | NEW BYZNATINE PENTELLIC GREY 12 X 24- BRICKED | | |
| Mudroom - FLOORING | | NEW BYZNATINE PENTELLIC GREY 12 X 24- BRICKED | | |
| Side Hall - FLOORING | | NA | | |
| Basement Foyer - FLOORING | | NEW BYZNATINE PENTELLIC GREY 12 X 24- BRICKED | | |
| KITCHEN | | | | |
| Kitchen - FLOORING | | NEW BYZNATINE PENTELLIC GREY 12 X 24- BRICKED | | |
| Breakfast - FLOORING | | NEW BYZNATINE PENTELLIC GREY 12 X 24- BRICKED | | |
| Kitchen - CABINETS | | CAMBRIDGE MDF MOCHA GLAZE- UP 2 | | |
| Island - CABINETS | | CAMBRIDGE MDF MOCHA GLAZE- UP 2 | | |
| Servery - CABINETS | | NA | | |
| Kitchen - HANDLES/KNOBS | | H800G | | |
| Kitchen - COUNTERTOP | | 5009-50 | | |
| Island - COUNTERTOP | | 5009-60 | | |
| Kitchen - BACKSPLASH | | DECLINED | | |
| Kitchen - SINK | | STD | | |
| Kitchen - FAUCET | | STD | | |
| GREAT ROOM / DINING / LIVING / DEN / OFFICE / BASEMENT | | | | |
| Family / Great Room - FLOORING | | MIRAGE ADMIRATION CHARCOAL RED OAK 3 5/16" - UP 1 | | |
| Main Hall - FLOORING | | MIRAGE ADMIRATION CHARCOAL RED OAK 3 5/16" - UP 1 | | |
| Dining / Living Room - FLOORING | | MIRAGE ADMIRATION CHARCOAL RED OAK 3 5/16" - UP 1 | | |
| Library / Den - FLOORING | | MIRAGE ADMIRATION CHARCOAL RED OAK 3 5/16" - UP 1 | | |
| Basement Rec Room - FLOORING | | NA | | |
| STAIRS | | | | |
| Railing Details - PICKETS | | BLACK METAL SINGLE COLLAR W/ ALT PLAIN | | |
| Railing Details - POSTS | | 2 3/4" TURNED OAK POST | | |
| Railing Details - HANDRAIL | | 2 1/2" OVAL OAK HANDRAIL | | |
| Stair Stain - MAIN STAIRS | | STAIN FOR STAIRS TO MATCH HARDWOOD AS CLOSE AS POSSIBLE | | |
| Stair Stain - BASEMENT STAIRS (if applicable) | | STAIN FOR STAIRS TO MATCH HARDWOOD AS CLOSE AS POSSIBLE | | |
| Stair Stain - SERVICE STAIRS (if applicable) | | NA | | |
| POWDER ROOM | | | | |
| Powder Room - FLOORING | | NEW BYZNATINE PENTELLIC GREY 12 X 24- BRICKED | | |
| Powder Room - CABINETS | | NA | | |
| Powder Room - COUNTERTOP | | NA | | |
| Powder Room - SINK | | STD | | |
| Powder Room - FAUCET | | STD | | |
| 2ND FLOOR | | | | |
| Upper Hall - FLOORING | | NA | | |
| Master Bedroom - FLOORING | | T03 OPENING NIGHT | | |
| Bedroom 2 - FLOORING | | T03 OPENING NIGHT | | |
| Bedroom 3 - FLOORING | | T03 OPENING NIGHT | | |
| Bedroom 4 - FLOORING | | NA | | |
| Bedroom 5 - FLOORING | | NA | | |
| | | | | |
| Master Ensuite - FLOORING | | NEW BYZNATINE ASSURO BLUE 12 X 24- BRICKED | | |
| Master Ensuite - SHOWER WALL | | NEW BYZNATINE ASSURO BLUE 12 X 24- STACKED VERTICAL | | |
| Master Ensuite - SHOWER FLOOR | | MARBLE ORIENTAL WHITE 2 X 4- UP 2 | | |
| Master Ensuite - SHOWER JAMB | | BIANCO CARRARA | | |
| Master Ensuite - CABINETS | | CONT SLAB OAK TIMBER GREY | | |
| Master Ensuite - HANDLES/KNOBS | | H800G | | |
| Master Ensuite - COUNTERTOP | | GREY GALAXY- UP 1 | | |
| Master Ensuite - SINK(S) | 4220-CFY X 2 | Master Ensuite - FAUCET(S) | UPGRADE | |
| ***FOR TRADE USE*** | | | | |
| Any upgrades in the colour chart must be accompanied with a PES. It is the responsibility of all Trades to inform the builder of any discrepancies on sketches, PES and/or colour charts PRIOR to installation. | | WASAGA SHORELINE 167 | | |
| | | PURCHASER INITIALS | VENDOR APPROVAL | |

ZANCOR HOMES COLOUR CHART

PRINTED 2021-12-01, 4:33 PM

| | | | | | | | | | |
|--|--|---|--|-------------------------------|--|----------|--|--|--|
| 2ND FLOOR CONTINUED... | | | | | | | | | |
| Main Bath - FLOORING | | GENESIS LIGHT GREY 12 X 24-BRICKED | | | | | | | |
| Main Bath - TUB / SHOWER WALL | | GENESIS LIGHT GREY 12 X 24-STACKED HORIZONTAL | | | | | | | |
| Main Bath - SHOWER FLOOR | | NA | | | | | | | |
| Main Bath - SHOWER JAMB | | NA | | | | | | | |
| Main Bath - CABINETS | | EURO OLMO CARISMA | | | | | | | |
| Main Bath - HANDLES/KNOBS | | H800G | | | | | | | |
| Main Bath - COUNTERTOP | | 4945-38 | | | | | | | |
| Main Bath - SINK(s) | | STD | | Main Bath - FAUCET(s) | | STD | | | |
| Shared Bath- FLOORING | | NA | | | | | | | |
| Shared Bath- TUB / SHOWER WALL | | NA | | | | | | | |
| Shared Bath- SHOWER FLOOR | | NA | | | | | | | |
| Shared Bath- SHOWER JAMB | | NA | | | | | | | |
| Shared Bath- CABINETS | | NA | | | | | | | |
| Shared Bath- HANDLES/KNOBS | | NA | | | | | | | |
| Shared Bath- COUNTERTOP | | NA | | | | | | | |
| Shared Bath- SINK(s) | | NA | | Shared Bath - FAUCET(s) | | NA | | | |
| Ensuite Bath - FLOORING | | NA | | | | | | | |
| Ensuite Bath - TUB / SHOWER WALL | | NA | | | | | | | |
| Ensuite Bath - SHOWER FLOOR | | NA | | | | | | | |
| Ensuite Bath - SHOWER JAMB | | NA | | | | | | | |
| Ensuite Bath - CABINETS | | NA | | | | | | | |
| Ensuite Bath - HANDLES/KNOBS | | NA | | | | | | | |
| Ensuite Bath - COUNTERTOP | | NA | | | | | | | |
| Ensuite Bath - SINK(s) | | NA | | Ensuite Bath - FAUCET(s) | | NA | | | |
| LAUNDRY | | | | | | | | | |
| Laundry - FLOORING | | NEW BYZANTINE PENTELLIC GREY 12 X 24- BRICKED | | laundry - HANDLES/KNOBS | | NA | | | |
| Laundry - CABINETS | | 400 SERIES PVC WHITE | | laundry - SINK | | STD | | | |
| Laundry - COUNTERTOP | | 5003-38 | | laundry - FAUCET | | STD | | | |
| Laundry - BACKSPLASH | | NA | | | | | | | |
| TRIM / PAINT | | | | | | | | | |
| Casing/Baseboards | | UP 1- COLONIAL | | | | | | | |
| Interior Doors | | STD | | | | | | | |
| Interior Door Hardware | | STD | | | | | | | |
| PAINT - Throughout | | WARM GREY | | | | | | | |
| FIREPLACE | | | | | | | | | |
| Location / Insert / Mantle | | STD | | | | | | | |
| ACCESSORIES | | | | | | | | | |
| Mirrors | | YES | | BATH ACCESSORIES | | UPGRADE | | | |
| APPLIANCE REQUIREMENTS | | | | | | | | | |
| GAS LINE TO BBQ | | STD | | ELECTRICAL for Built-in Oven | | DECLINED | | | |
| GAS LINE & ELECTRICAL TO STOVE | | DECLINED | | ELECTRICAL for Built-in Micro | | DECLINED | | | |
| GAS LINE & ELECTRICAL TO DRYER | | DECLINED | | ELECTRICAL for Cooktop | | DECLINED | | | |
| HOOD FAN VENT SIZE | | 6" STD | | ELECTRICAL for Bar Fridge | | DECLINED | | | |
| WATERLINE to Fridge | | YES | | | | | | | |
| DISCLAIMER | | | | | | | | | |
| Any changes to the colour chart after signing are subject to a \$5000 administration fee plus costs | | | | | | | | | |
| Purchaser has checked and acknowledged accuracy of colour and selections before signing. | | | | | | | | | |
| Colours of all materials are as close as possible to Builders selection but not necessarily identical due to dye lot variances in manufacturing/manufacturers. Due to construction progress some items may have been pre-selected or installed. In this event the Vendor's selection must be accepted by the purchaser | | | | | | | | | |
| SITE / LOT: | | WASAGA | | 167 | | | | | |
| PURCHASER(S): | | GNANENDRAN SRIPATHMANATHAN | | | | | | | |
| PURCHASER(S): | | NIRAJA GNANENDRAN | | | | | | | |
| CONTACT: | | 416.823.3552 / 416.857.4456 | | NIRAJADANNY@YAHOO.COM | | | | | |
| ***FOR TRADE USE*** | | | | | | | | | |
| Any upgrades in the colour chart must be accompanied with a PES. | | | | | | | | | |
| It is the responsibility of all Trades to inform the builder of any discrepancies on sketches, PES and/or colour charts PRIOR to installation. | | | | | | | | | |
| <div>ZANCOR HOMES</div> | | PURCHASER SIGNATURE | | <div>SIGNATURES / DATE</div> | | | | | |
| | | PURCHASER SIGNATURE | | | | | | | |
| | | DÉCOR CONSULTANT | | | | | | | |
| **PAGE 2 OF 2** | | Vendor APPROVAL | | | | | | | |

SHORELINE POINT
WASAGA BEACH

CORAL 60-04

1st 167
Dec 1/21

The Coral



qty 2
exterior
pet light
on sep
switch.

ALL ELEVATIONS INCLUDE 55 SQ. FT. OF FINISHED BASEMENT

Exterior
Rough in light
Sep switch
located 8" above
stove trim, if
stove possible



Handwritten signature or initials.

SHORELINE POINT
WASAGA BEACH

CORAL 60-04

1st 167
Dec 1/21

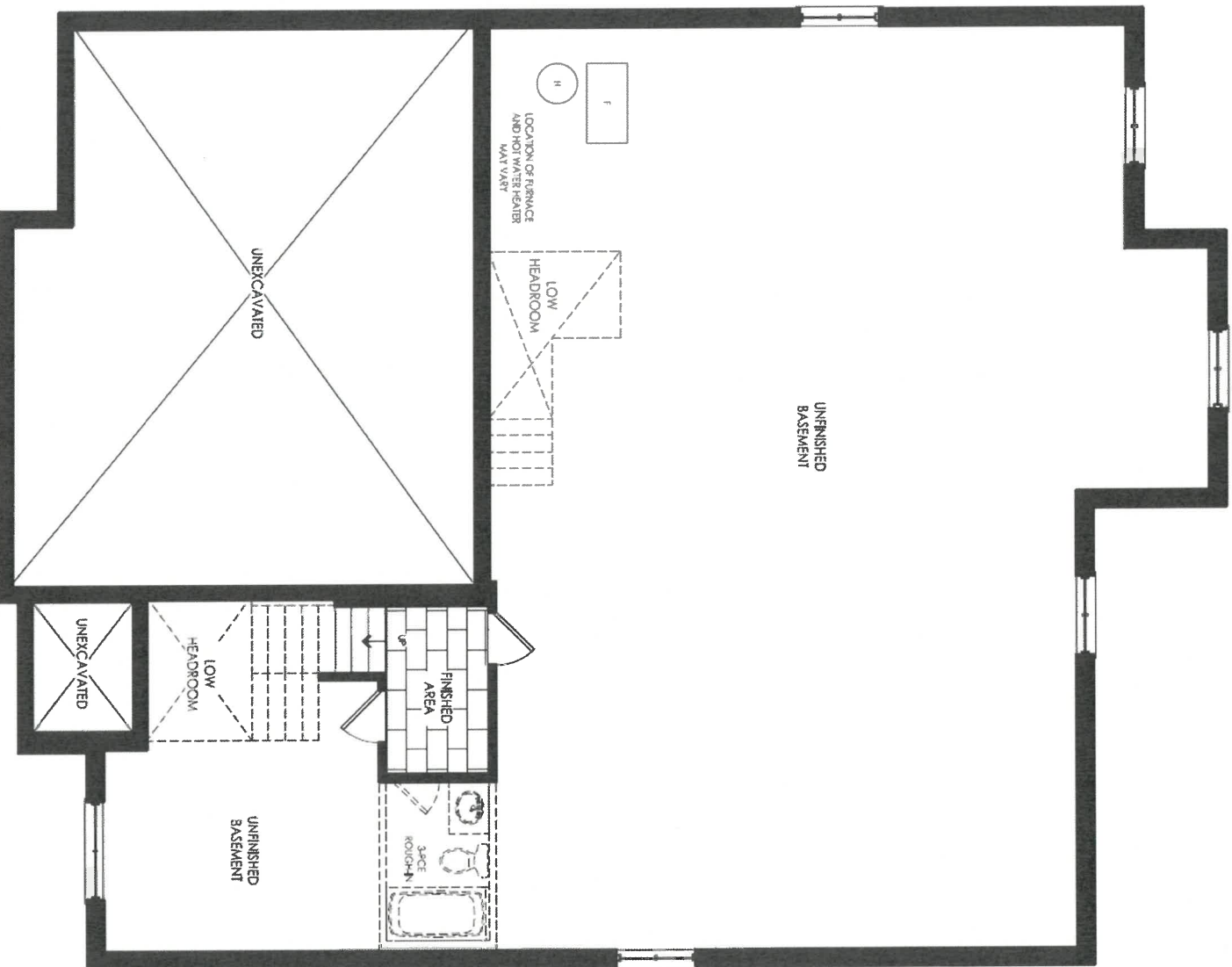

Elevation A
Basement

AK



DATE SUBMITTED

16 Jun 2021

CLIENT NAME: ZANCOR HOMES
SHIP TO : SHORELINE POINT

PH:
CELL :

DRAFTED BY: FERNANDA
COMMENT

JOB NUMBER

INSTALL DATE:

PAGE
21 of 22

P/O#

60-04

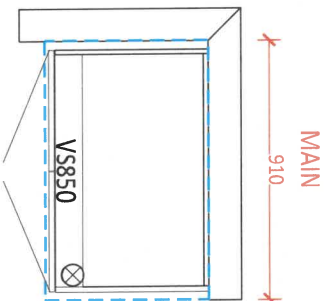

MASTER ENSUITE

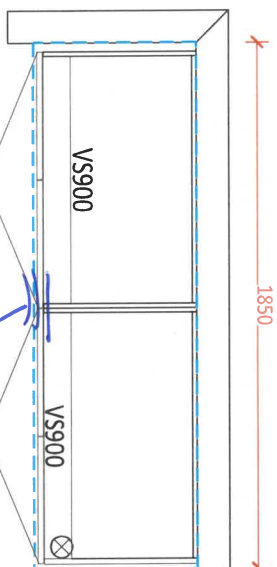

Back of drawers

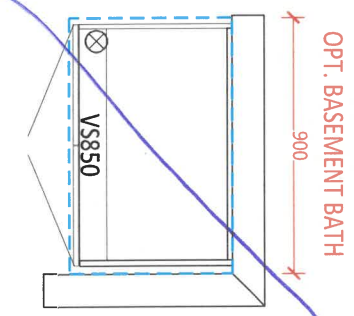
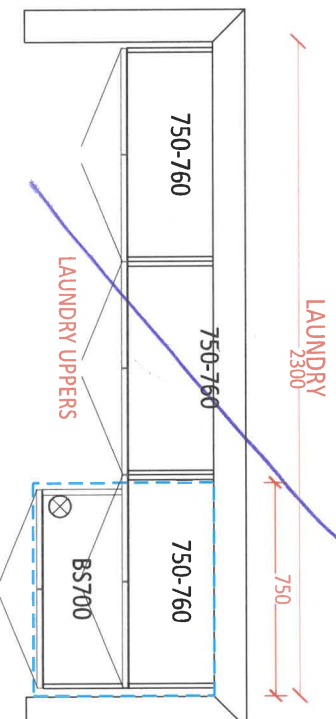

*lot 167
Dec 1/21*

[Signature]



DATE SUBMITTED
16 Jun 2021

CLIENT NAME: ZANCOR HOMES
SHIP TO : SHORELINE POINT

PH:
CELL :

DRAFTED BY: FERNANDA
COMMENT

P/O#

JOB NUMBER

INSTALL DATE:

PAGE

20 of 22

60-04
KITCHEN

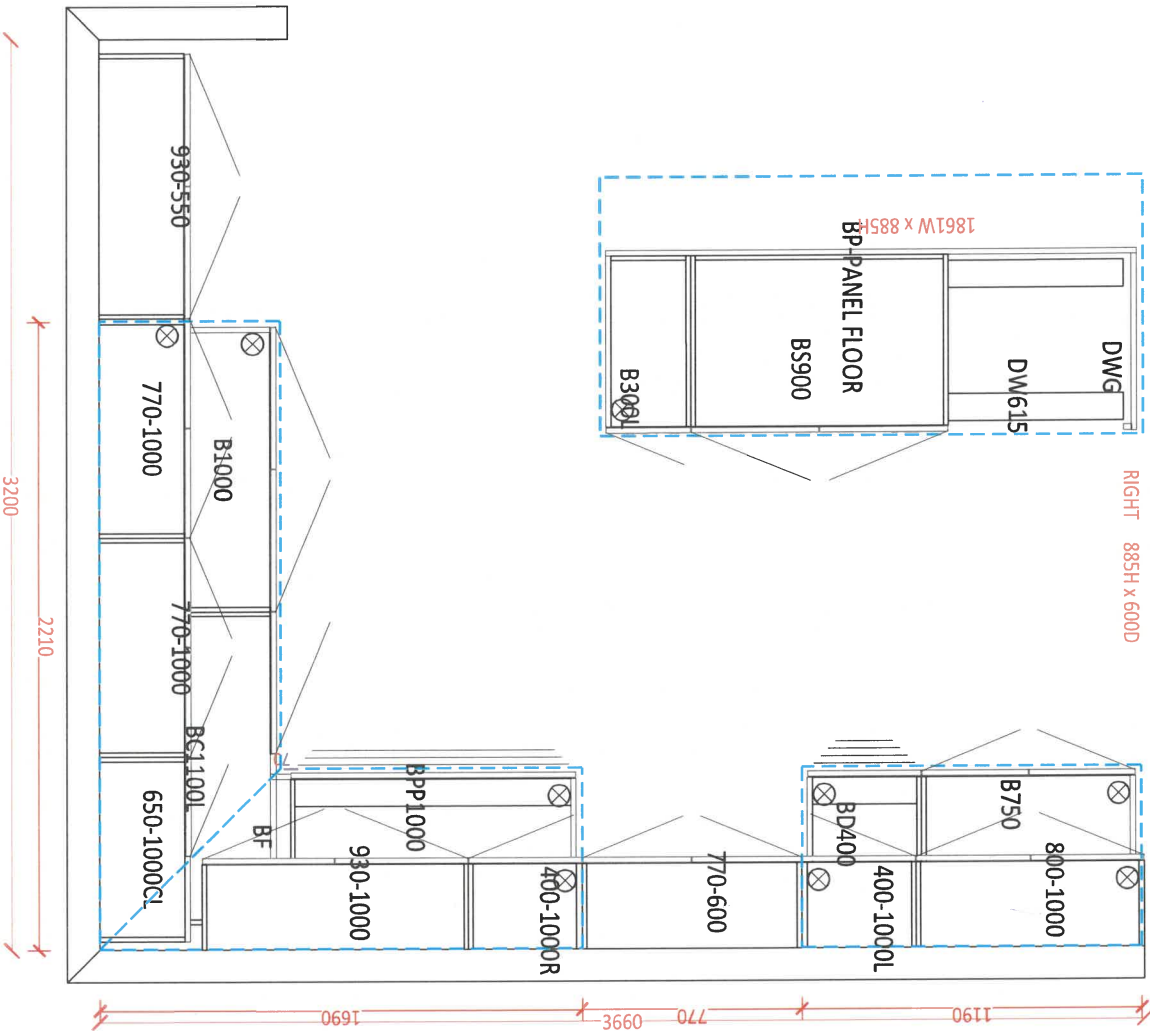

1st 1st 1st
1001/21



DATE SUBMITTED

16 Jun 2021

CLIENT NAME: ZANCOR HOMES
SHIP TO : SHORELINE POINT

PH:
CELL :

DRAFTED BY: FERNANDA
COMMENT

P/O#

JOB NUMBER

INSTALL DATE:

PAGE

22 of 22

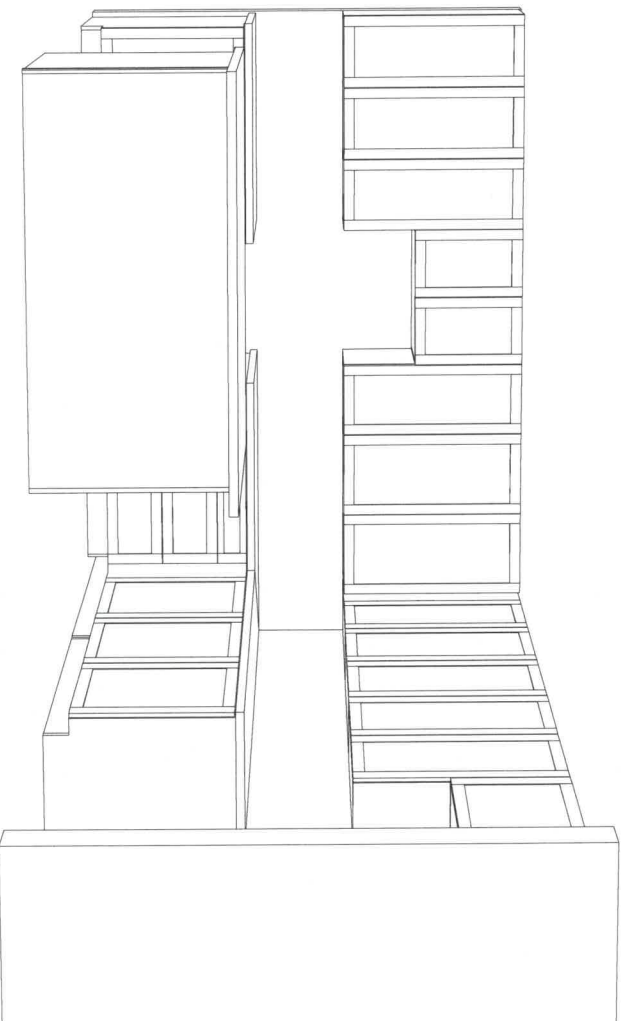

1st 167
Dec 1/21

28
p

Master Bath
Brushed
Nickel

90°™

Traditional | Transitional | Modern
Geometric forms, squared corners and straight lines create an urban focal point for today's contemporary baths.

104163
Dec 1/21



Two Handle Adjustable Widespread (8" - 16") Lav Faucet with Lift Rod Drain

Model TS6720 / 69000

Chrome - \$776.99

Other - \$1,157.22

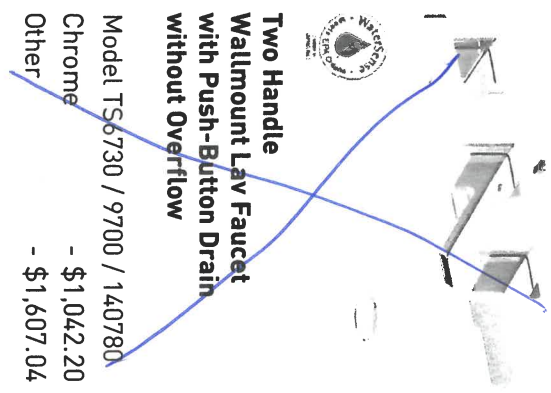

Two Handle Roman Tub Faucet with Hand Shower

Model TS904 / 9796

Chrome - \$1,852.07

Other - \$2,557.10

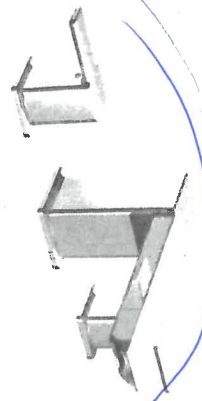

Two Handle Roman Tub Faucet

Model TS903 / 4796

Chrome - \$1,085.81

Other - \$1,474.81

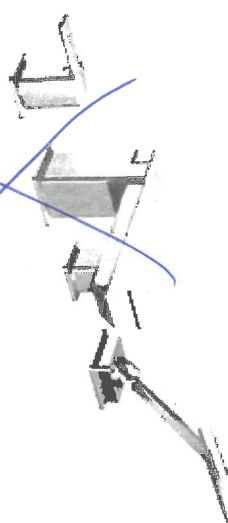

Two Handle Roman Tub Faucet with Hand Shower

Model TS904 / 9796

Chrome - \$1,852.07

Other - \$2,557.10

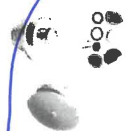

Tub Drain Half Kits Available **

Chrome - \$78.10

Other - \$195.48

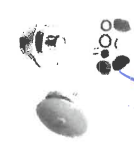

Tub Drain Half Kits Available **

Chrome - \$78.10

Other - \$195.48

FINISH OPTIONS:

To order, combine the model number with one of these finish letter(s):
LifeShine® Brushed Nickel (BN). To order Chrome (C) model, use model number only.
** T90331 / 140680

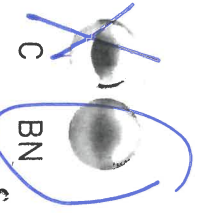

90°™

Traditional | Transitional | Modern

Geometric forms, squared corners and straight lines create an urban focal point for today's contemporary baths.

lot 163
Dec 1/21

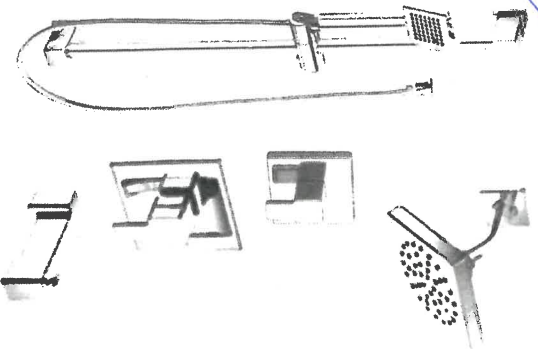

**Posi-Temp® Tub/Shower Faucet
with 3 Function Transfer Valve/Trim
and Slide Bar with Hand Shower ***

Model TS2713EP / U361CI / UTS4172 /
62320 / S3879EP / A721
Chrome - \$1,874.68
Other \$2,924.78

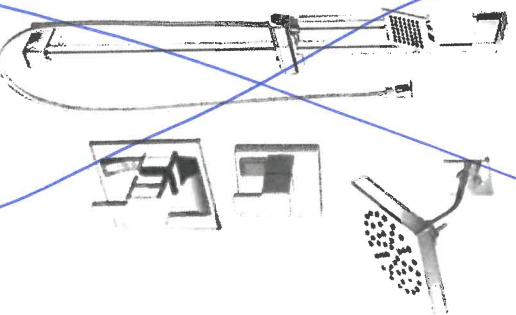

**Posi-Temp® Shower Only
with 3 Function Transfer Valve/Trim
and Slide Bar with Hand Shower ***

Model TS2712EP / U361CI / UTS4172 /
62320 / S3879EP / A721
Chrome - \$1,770.80
Other - \$2,757.24

Master Bath
Brushed Nickel

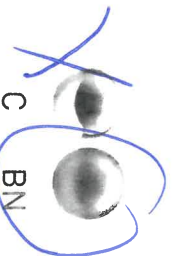

FINISH OPTIONS:

To order, combine the model number with one of these finish letter(s):

LifeShine® Brushed Nickel (BN). To order Chrome (C) model, use model number only.

* Please see the 2020 Shower Planning Guide for installation

Handwritten signature/initials.

Handwritten signature/initials.

900™

Traditional | Transitional | Modern

Geometric forms, squared corners and straight lines create an urban focal point for today's contemporary baths.

1st 167
Dec 1/21



Toilet Tank Lever

Model YB8801

Chrome - \$92.68
Other - \$97.27

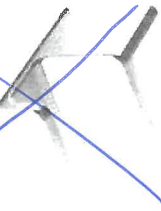

Robe Hook

Model YB8803

Chrome - \$82.42
Other - \$86.60

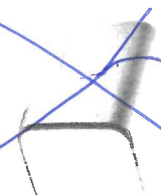

Cabinet Knob

Model YB8805

Chrome - \$16.27
Other - \$18.90

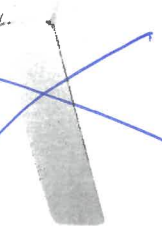

Drawer Pull

Model YB8807

Chrome - \$32.54
Other - \$35.03



Pivoting

Pivoting Paper Holder

Model YB8808

Chrome - \$156.20
Other - \$164.03

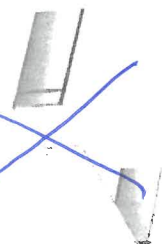

Mini Towel Bar

Model YB8886

Chrome - \$115.63
Other - \$121.43



18" Towel Bar

Model YB8818

Chrome - \$174.83
Other - \$183.60

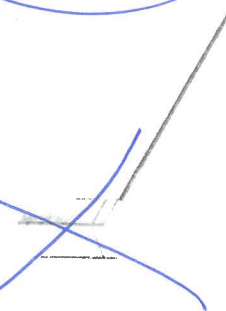

24" Towel Bar

Model YB8824

Chrome - \$180.36
Other - \$189.41



Designer Grab Bar

Models:

| | Chrome | Other |
|--------------|----------|----------|
| 12" - YG8812 | \$191.43 | \$206.89 |
| 18" - YG8818 | \$200.07 | \$216.95 |
| 24" - YG8824 | \$208.91 | \$234.16 |
| 36" - YG8836 | \$237.94 | \$263.59 |

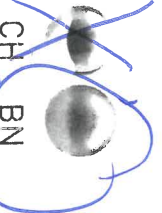

FINISH OPTIONS:

To order, combine the model number with one of these finish letter(s):
Chrome (CH), LifeShine® Brushed Nickel (BN).

Master Bath -

Brushed Nickel

✓

THE
GALLERY

SHORELINE POINT
BY ZANCOR
WASAGA BEACH

ZANCOR

INTERIOR FINISHES ACKNOWLEDGEMENT / WAIVER

Purchaser accepts and acknowledges that the Builder reserves the right to substitute materials with those of equal or better quality where the manufacture, scheduling or delivery of materials may directly impact the Builder's ability to meet its' contractual obligations under the Agreement of Purchase and Sale.

UPGRADES/EXTRAS: All upgrades and additional selections indicated on the colour chart must be accompanied by an upgrades/extras sheet (PES) and full payment otherwise the selection will be invalid. All colour charts and upgrades/extras will not proceed until verified and signed by an authorized signing officer at the Vendor's head office. **CHANGES WILL NOT BE PERMITTED UPON COMPLETION AND SUBMISSION OF THE COLOUR CHART.**

PORCELAIN & NATURAL STONES: Due to the properties of natural stones including but not limited to **marble, granite, quartz**, no two pieces are exactly the same. Variations in colour, tone, granularity (pitting, fissures) and pattern are to be expected, including various lighting may affect the overall finished look. Stone tops are sealed at time of installation and should never be cleaned with lemon oil or vinegar. Stones are porous materials, therefore any spilled substance require immediate attention. Stone countertops require regular seal re-application as part of home maintenance. Purchaser acknowledges colour and product variations as well as natural imperfections may exist with the selection of natural stone materials and shall not hold the Vendor liable for provision of same.

STONE COUNTERTOP JOINTS: Purchaser is aware that one joint will be at each corner and on either side of slide-in-range (if applicable). It will also be where the length of the counter top exceeds the length of a stone slab. Slabs are usually approximately 5' x 8'.

CERAMIC TILES: Due to manufacturing, shade (dye lots), product variations may exist that can affect the overall look of the finished product. Although every effort will be made to ensure the colours and materials selected are as close as possible to the samples, the purchaser acknowledges that the sample tiles supplied in the Design Centre may not be identical to the materials installed in the home.

STAIR STAINS: Due to the natural properties of wood, many variables can affect the overall look of the finished product. Factors including but not limited to wood type, knotting, graining, density, age, humidity, and air temperature can result in substantial variations in stain intensity. The purchaser accepts that although the Vendor will do their best to match stain the unfinished stairs as close as possible to the pre-finished floors, it is not possible to have an identical match and that there MAY be shade differences between the two products.

CABINETRY: Due to the natural properties of wood, slight variations apparent with cabinetry are to be expected. This includes but not limited to wood species, wood grain, colour, finish, product variations, and natural imperfections are all factors that may affect the overall look of the finished product. Such factors make exact colour matching impossible. The type and intensity of lighting in the areas of designated cabinetry placement may also highlight characteristics of cabinetry finish. All cabinets shall be finished with a white melamine interior box unless a finished interior is upgraded. Due to building specifications and/or on-site conditions, certain cabinetry upgrades may not be possible. The purchaser acknowledges that the Builder cannot guarantee the cabinetry finish or provision of certain upgrades and shall not hold the Builder liable for provision of same.

UPGRADES/EXTRAS: All upgrades and additional selections indicated on the colour chart must be accompanied by an upgrades/extras sheet (PES) and full payment otherwise the selection will be invalid. All colour charts and upgrades/extras will not proceed until verified and signed by an authorized signing officer at the Vendor's head office. **CHANGES WILL NOT BE PERMITTED UPON COMPLETION AND SUBMISSION OF THE COLOUR CHART.**

HARDWOOD / LAMINATE FLOORING: Due to the properties of wood and laminate, many variables can affect the overall look of the finished product. Variations include but not limited to wood type or laminate finish, colour/stain and wood grain are significant factors that make exact colour matching impossible. The purchaser acknowledges that the hardwood flooring is a pre-finished product in a controlled environment. Expansion, compression and cupping are characteristics of hardwood flooring once installed in the home. The purchaser acknowledges these may become apparent over time and despite the Builders' efforts to install the hardwood flooring materials in keeping with good workmanship, the Builder shall not be responsible nor held liable for minor variances of fluctuation in hardwood flooring materials.

HARDWOOD / LAMINATE WAIVER:

I/We understand hardwood flooring is classified as a porous material and as such not recommended by the Builder in certain areas. I/We understand there is a concern due to possible water and other substances being frequently splashed or spilled onto the floor and in contravention of Ontario Building Code Section 9.30.1.2(1).

"Finished flooring bathrooms, kitchens, public entrance halls, laundry & general storage areas shall consist of resilient flooring, felted-synthetic-fibre floor coverings, concrete, terrazzo, ceramic tile, mastic or other types of flooring providing similar degrees of water resistance."

I/We are prepared to assume full responsibility for any damage caused to the hardwood floor or subfloor due to moisture absorberency in the mentioned areas, and agree to waive any claims against the Township of residence, TARIION and/or the Builder in relation to the matter. ****SEE COLOUR CHART FOR LOCATIONS****

| | | | | | |
|--|----------|------|------------------|-----|-----|
| DATE | Dec 1/21 | SITE | WASAGA SHORELINE | LOT | 167 |
| 221 North Rivermede Road, Concord, Ontario L4K 3N7 * T: (905) 738-7010 F: (905) 738-5948 | | | | | |

THE
GALLERY

BY ZANCOR

SHORELINE POINT

WASAGA BEACH

ZANCOR

APPLIANCE ACKNOWLEDGEMENT

CONTACT: Steve Miller - Appliance Canada (905) 660-2424 / smiller@appliancecanada.com

- It is the Purchasers responsibility to coordinate delivery, installation and hook up of appliances and to ensure they are installed as per Manufacturers specifications after closing.

STANDARD APPLIANCE OPENINGS provided by Zancor:

*Standard appliance openings are approximate and the minimum required. Sizes may vary due to onsite condition and/or when modifications have been made to the cabinetry.

- Fridge Opening 36" x 74"
► Stove Opening 30"
► Hood Fan Opening 30"
► Hood Fan & Vent 6" with Under Cabinet Hood
► Dishwasher Opening 24"

Accepts Standard
Openings **Initial



OPTIONAL UPGRADED APPLIANCES to be provided by Homeowner:

- ****Specs/Information sheets are required and it is the responsibility of the homeowner to provide this to Zancor Homes by the due date that has been provided. If appliance specs are not submitted, Zancor Homes will not be responsible for any necessary requirements and the standard opening will be built.**



- **Upgraded Appliance Specs are DUE 2 WEEKS FROM SIGNED DATE OF COLOUR CHART (if not received during appointment)**

INITIAL

- ***Specs that require changes/modifications after this date will not be accepted***

- NOTE: Any upgraded appliances are to be paid by the Purchaser, directly to the appliances company.

- Additional charges to the Purchaser may apply for cabinetry, electrical and plumbing in order to accommodate the specs given by the homeowner.

FRIDGE UPGRADE

- ☐ Built-in
☐ Paneled **Panel to match required
☐ Integrated / Flush Inset
☒ Waterline

RANGE UPGRADE

*Larger hood fan CFM might be required, which need a larger vent

- ☐ 36" **Hood fan opening must be the same size or larger (8" vent might be required)
☐ 48" **Hood Fan opening must be the same size or larger (8" or 10" vent required)
☐ Gas Range **gas line and electrical required & sold separately
☐ Induction **electrical required & sold separately
☐ Cooktop (Apron Front) **Countertop Cut-out required & sold separately
☐ Cooktop (Drop-in) **countertop Cut-out required & sold separately

HOOD FAN & VENT

UPGRADE

- ☐ 8 Inch **Required for 600 CFM
☐ 10 Inch
☐ Chimney Hood Fan **Vent must be centred
☒ Insert / Liner

WALL OVEN/MICRO

UPGRADE

**Electrical required

- ☐ Single Wall Oven **electrical required & sold separately
☐ Double Wall Oven **electrical required & sold separately
☐ Steam Oven **electrical required & sold separately
☐ Warming Drawer **electrical required & sold separately
☒ Over The Range Microwave (OTR)
☐ Built-In Microwave **Trim Kit required **electrical required & sold separately

DATE Dec 1/21

WASAGA SHORLINE

SITE

LOT

167

** Any upgrades checked in this appliance form must be accompanied with specs provided by the Purchaser.

**It is the responsibility of the trade to inform the Builder of any discrepancies with specs, sketches, extras and/or colour chart PRIOR to production/installation.

ZANCOR

221 North Rivermede Road, Concord, Ontario L4K 3N7 * T: (905) 738.7010 F: (905) 738.5948

MASTER - ALL MASTER SIGN OFF FORMS 2020
Dec 17 2020

BRICK/JOINT PATTERN INSTALLATION RELEASE FORM

***BRICK installation is included as a standard on the floor for 12 x 24 tiles and must be noted on the colour chart and acknowledged on this form ***

(Large tiles installation for floor and wall) – ¼ Brick

Please be advised it has come to our attention, that due to production, many of the over-sized and odd shaped, man-made tiles (i.e. porcelain & ceramic), have been found to have a slight bow in the tile. It is a standard occurrence with all suppliers and manufacturers.

It is therefore recommended, that if and when a purchaser requests to install one of these tiles in a brick-joint pattern, that it be installed on a ¼ brick pattern, to try to avoidlippage. Attached with this letter, you will find a layout of the ¼ brick installation that has been recommended.

LOCATIONS: all floors

LOCATIONS:

LOCATIONS:

LOCATIONS:

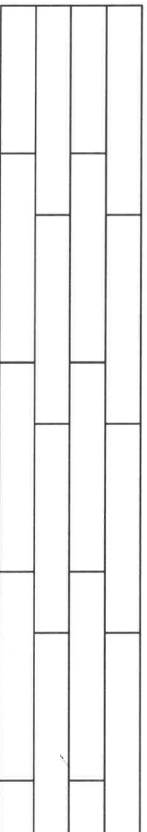

Please understand, even in using this ¼ brick installation, there may still be minimal lippage which cannot fully be eliminated.

Hence, when there is a request for brick-joint installation, Zancor Homes and their contractor, cannot be held responsible for this matter.

Homeowner(s) Initial

(Small tile installation for walls) – ½ Brick

Purchaser requests to install small wall tiles on a backsplash or shower wall in a brick-joint pattern, that it be installed on a ½ brick pattern.

LOCATIONS:

LOCATIONS:

LOCATIONS:

LOCATIONS:

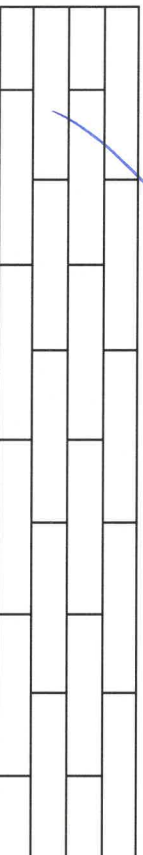

Homeowner(s) Initial

DATE

SITE

LOT

WASAGA SHORELINE