

Site: CALEDON (B)

Lot: 39B

Model: WESTMOUNT (30-06) ELEV C CORNER

Purchaser: VIBHOR ARORA

Purchaser: MOHITA JAIDKA

Phone: 416.220.4524 / 416.906.4030

Email: THEVIBHOR@GMAIL.COM



DESCRIPTION		DATE SELECTED
BONUS PACKAGE: 3 PIECE STAINLESS STEEL APPLIANCES WITH WHITE WASHER & DRYER	INCLUDED IN APS	
BONUS PACKAGE: STAINLESS STEEL HOOD FAN	INCLUDED IN APS	
BONUS PACKAGE: AIR CONDITIONER	AS PER SCH E	
STRUCTURALS		
1 (3) LARGER BASEMENT WINDOWS 30 X 24	08-Nov-21	
2 (4) 8 ft high interior doors on main floor	08-Nov-21	
3 (7) 8 ft high interior doors on 2nd floor	08-Nov-21	
4 GAS LINE TO STOVE 15 AMP INCLUDED	08-Nov-21	
COLOURS		
1 (1) CAPPED LIGHT ABOVE KITCHEN PENINSULA ON SEPARATE SWITCH	11-Jan-22	
2 WATERLINE TO FRIDGE	11-Jan-22	
3 KITCHEN ADD ADDITIONAL BANK OF DRAWERS	11-Jan-22	
4 FRIDGE ENCLOSURE	11-Jan-22	
5 KITCHEN UP # 2 QUARTZ COUNTER TOP	11-Jan-22	
6 KITCHEN UPGRADE SINK BIANCO QUATRUS U2 # 401247 IN LIEU OF STANDARD	11-Jan-22	
7 UPGRADE CABINET HARDWARE	11-Jan-22	
8 MASTER ENSUITE SHOWER FLOOR UP # 1	11-Jan-22	
9 POWDER ROOM UP # 2 QUARTZ COUNTER TOP	11-Jan-22	
10 BANK OF DRAWERS 2 SMALL ONE LARGE IN MASTER ENSUITE AND SHARED BATH	11-Jan-22	
11 COMFORT HEIGHT VANITY, POWDER ROOM, MASTER ENSUITE,SHARED BATH, ENSUITE # 2	11-Jan-22	
12 BATHROOM ACCESSORIES POWDER ROOM (1) PAPER HOLDER YB2408 (1) TOWEL BAR YB2418	11-Jan-22	
13 BATHROOM ACCESSORIES MASTER ENSUITE,SHARED BATH, ENSUITE 2 (3 ) PAPER HOLDER YB2408 (3) TOWEL BAR YB2424	11-Jan-22	
14 HARDWOOD UP # 1 FAMILY ROOM, DINING ROOM, HALLWAY, LANDINGS, UPPER HALL	11-Jan-22	
15 KITCHEN BACKPLASH UP # 3	11-Jan-22	
16 MICROWAVE SHELF IN LIEU OF UPPER (SEE SKETCH)	11-Jan-22	
17 MICROWAVE PLUG ON SEPARATE CIRCUIT 15 AMP	11-Jan-22	
18 MASTER ENSUITE UPGRADE QUARTZ SHOWER JAMB	11-Jan-22	

ZANCOR HOMES COLOUR CHART

ENTRANCES				
Main Foyer - FLOORING		NEW BYZANTINE PENTELLIC GREY 12 X 24 INSTALL STACKED		
Mudroom - FLOORING		NEW BYZANTINE PENTELLIC GREY 12 X 24 INSTALL STACKED		
Side Hall - FLOORING		NA		
Basement Foyer - FLOORING		NA		
KITCHEN				
Kitchen - FLOORING		NEW BYZANTINE PENTELLIC GREY 12 X 24 INSTALL STACKED		
Breakfast - FLOORING		NEW BYZANTINE PENTELLIC GREY 12 X 24 INSTALL STACKED		
Kitchen - CABINETS		EURO LARICE BIANCO		
Island - CABINETS		EURO LARICE BIANCO		
Servery - CABINETS		NA		
Kitchen - HANDLES/KNOBS		H 800-MB		
Kitchen - COUNTERTOP	EMERSTONE PURE GREY (NOV 7 2022)	<del>DINOS GRIS QUARTZ UP # 2</del>		
Island - COUNTERTOP	**RESELECTED DUE TO DISCONTINUED STONE	<del>DINOS GRIS QUARTZ UP # 2</del>		
Kitchen - BACKSPLASH		ONTARIO SERIES HEXAGON WHITE/TAUPE MATT UP # 3		
Kitchen - SINK		BIANCO QUATRUS U2 # 401247		
Kitchen - FAUCET		STANDARD		
GREAT ROOM / DINING / LIVING / DEN / OFFICE / BASEMENT				
Family / Great Room - FLOORING		KENTWOOD OAK STURGEON ASST LENGTHS 3 1/2" X 3/4" UP # 1		
Main Hall - FLOORING		KENTWOOD OAK STURGEON ASST LENGTHS 3 1/2" X 3/4" UP # 1		
Dining / Living Room - FLOORING		KENTWOOD OAK STURGEON ASST LENGTHS 3 1/2" X 3/4" UP # 1		
Library / Den - FLOORING		KENTWOOD OAK STURGEON ASST LENGTHS 3 1/2" X 3/4" UP # 1		
Basement Rec Room - FLOORING		NA		
STAIRS				
Railing Details - PICKETS		METAL BLACK SINGLE COLLAR WITH ALT PLAIN		
Railing Details - POSTS		2 3/4" TURNED OAK POSTS		
Railing Details - HANDRAIL		2 1/2" OVAL OAK HANDRAIL		
Stair Stain - MAIN STAIRS		STAIN TO MATCH HARDWOOD AS CLOSE AS POSSIBLE		
Stair Stain - BASEMENT STAIRS (if applicable)		NA		
Stair Stain - SERVICE STAIRS (if applicable)		NA		
POWDER ROOM				
Powder Room - FLOORING		NEW BYZANTINE PENTELLIC GREY 12 X 24 INSTALL STACKED		
Powder Room - CABINETS		EURO LARICE BIANCO COMFORT HEIGHT		
Powder Room - COUNTERTOP		DINOS GRIS QUARTZ UP # 2		
Powder Room - SINK		OVAL UNDERMOUNT 4220 CFY		
Powder Room - FAUCET		STANDARD		
2ND FLOOR				
Upper Hall - FLOORING		KENTWOOD OAK STURGEON ASST LENGTHS 3 1/2" X 3/4" UP # 1		
Master Bedroom - FLOORING		OPENING NIGHT T-03		
Bedroom 2 - FLOORING		OPENING NIGHT T-03		
Bedroom 3 - FLOORING		OPENING NIGHT T-03		
Bedroom 4 - FLOORING		OPENING NIGHT T-03		
Bedroom 5 - FLOORING		NA		
Master Ensuite - FLOORING		NEW BYZANTINE PENTELLIC GREY 12 X 24 INSTALL STACKED		
Master Ensuite - SHOWER WALL		NEW BYZANTINE PENTELLIC GREY 12 X 24 INSTALL HORIZONTAL STACKED		
Master Ensuite - SHOWER FLOOR		ONTARIO SERIES HEXAGON TAUPE MATT UP # 1		
Master Ensuite - SHOWER JAMB		SHAWDOW QUARTZ UPGRADE		
Master Ensuite - CABINETS		CONT CLAB OAK TIMBER GREY COMFORT HEIGHT		
Master Ensuite - HANDLES/KNOBS		H-800-MB		
Master Ensuite - COUNTERTOP		<del>BIANCO CARRARA</del> <del>BIANCO SANDO GRANITE</del>		
Master Ensuite - SINK(s)	(2) OVAL 4220 CFY	Master Ensuite - FAUCET(s)	STANDARD	
***FOR TRADE USE***				
Any upgrades in the colour chart must be accompanied with a PES. It is the responsibility of all Trades to inform the builder of any discrepancies on sketches, PES and/or colour charts PRIOR to installation.		CALEDON 39B		
		**PAGE 1 OF 2**		
		PURCHASER INITIALS	VENDOR APPROVAL	
		SIGNATURES		

JAN 12 2022



2ND FLOOR CONTINUED...									
Main Bath - FLOORING					NA				
Main Bath - TUB / SHOWER WALL					NA				
Main Bath - SHOWER FLOOR					NA				
Main Bath - SHOWER JAMB					NA				
Main Bath - CABINETS					NA				
Main Bath - HANDLES/KNOBS					NA				
Main Bath - COUNTERTOP					NA				
Main Bath - SINK(s)					Main Bath - FAUCET(s)				
Shared Bath - FLOORING					NEW BYZANTINE PENTELLIC GREY 12 X 24 INSTALL STACKED				
Shared Bath- TUB / SHOWER WALL					NEW BYZANTINE PENTELLIC GREY 12 X 24 INSTALL HORIZONTAL STACKED				
Shared Bath- SHOWER FLOOR					NA				
Shared Bath- SHOWER JAMB					NA				
Shared Bath- CABINETS					CONT SLAB OAK TIMBER GREY COMFORT HEIGHT				
Shared Bath- HANDLES/KNOBS					H-800-MB				
Shared Bath- COUNTERTOP					P283CA TUNDRA TAUPE				
Shared Bath- SINK(s)					STANDARD		Shared Bath - FAUCET(s)		STANDARD
Ensuite Bath - FLOORING					NEW BYZANTINE PENTELLIC GREY 12 X 24 INSTALL STACKED				
Ensuite Bath - TUB / SHOWER WALL					NEW BYZANTINE PENTELLIC GREY 12 X 24 INSTALL HORIZONTAL STACKED				
Ensuite Bath - SHOWER FLOOR					NA				
Ensuite Bath - SHOWER JAMB					NA				
Ensuite Bath - CABINETS					CONT SLAB OAK TIMBER GREY COMFORT HEIGHT				
Ensuite Bath - HANDLES/KNOBS					H-800-MB				
Ensuite Bath - COUNTERTOP					P283CA TUNDRA TAUPE				
Ensuite Bath - SINK(s)					STANDARD		Ensuite Bath - FAUCET(s)		STANDARD
LAUNDRY									
Laundry - FLOORING					NEW BYZANTINE PENTELLIC GREY 12 X 24 INSTALL STACKED				
Laundry - CABINETS					CONT SLAB OAK TIMBER GREY		Laundry - HANDLES/KNOBS		H-800-MB
Laundry - COUNTERTOP					P283CA TUNDRA TAUPE		Laundry - SINK		STANDARD
Laundry - BACKSPLASH					NA		Laundry - FAUCET		STANDARD
TRIM / PAINT									
Casing/Baseboards					STANDARD				
Interior Doors					SEE EXTRAS - INCREASED HEIGHT - (STANDARD STYLE)				
Interior Door Hardware					STANDARD				
PAINT - Throughout					WARM GREY				
FIREPLACE									
Location / Insert / Mantle					STANDARD 34" ELECTRIC				
ACCESSORIES									
Mirrors					STANDARD		BATH ACCESSORIES		UPGRADE
APPLIANCE REQUIREMENTS									
GAS LINE TO BBQ					STANDARD		ELECTRICAL for Built-in Oven		DECLINED
GAS LINE & ELECTRICAL TO STOVE					UPGRADE		ELECTRICAL for Built-in Micro		DECLINED
GAS LINE & ELECTRICAL TO DRYER					DECLINED		ELECTRICAL for Cooktop		DECLINED
HOOD FAN VENT SIZE					6" STANDARD		ELECTRICAL for Bar Fridge		DECLINED
WATERLINE to Fridge					UPGRADE				
DISCLAIMER									
Any changes to the colour chart after signing are subject to a <b>\$5000</b> administration fee plus costs									
Purchaser has checked and acknowledged accuracy of colour and selections before signing.									
Colours of all materials are as close as possible to Builders selection but not necessarily identical due to dye lot variances in manufacturing/manufacturers. Due to construction progress some items may have been pre-selected or installed. In this event the Vendors's selection must be accepted by the purchaser									
SITE / LOT:					CALEDON (B)				39B
PURCHASER(S):					VIBHOR ARORA				
PURCHASER(S):					MOHITA JAIDKA				
CONTACT:					416.220.4524 / 416.906.4030		THEVIBHOR@GMAIL.COM		
***FOR TRADE USE***									
Any upgrades in the colour chart must be accompanied with a PES. It is the responsibility of all Trades to inform the builder of any discrepancies on sketches, PES and/or colour charts PRIOR to installation.									
					SIGNATURES / DATE				
					PURCHASER SIGNATURE				
					PURCHASER SIGNATURE				
					DÉCOR CONSULTANT				
					Vendor APPROVAL				
					KATHERINE				
					JAN 12 2022				

Product Specification Sheet

QUATRUS U 2

Satin brushed finish

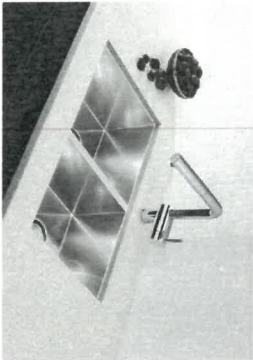

PRODUCT DIMENSIONS

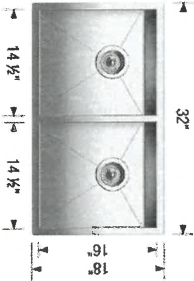

39B

QUATRUS U 2	Colour Finish	Model No.	FEATURES / SPECIFICATIONS
	Satin brushed finish	401247	<ul style="list-style-type: none"><li>• German engineered with 304 series, 18-gauge stainless steel</li><li>• Zero- radius corners; X-pattern drain grooves</li><li>• Double bowl configuration for easy multi-tasking</li><li>• 18/10 chrome-nickel content for exceptional lustre, durability and strength</li><li>• Rear-positioned drain holes maximize cabinet storage space</li></ul>

DESIGN AND PLANNING TIPS

Cabinet Size: 36" (915 mm)  
Bowl depth: 9" (230 mm) / 9" (230 mm)  
Depending on cabinet construction, a different cabinet size may be required.  
Consult the cabinet manufacturer.

WARRANTY

Limited Lifetime warranty

Code/Standards Compliance

BLANCO sinks and faucets are third-party tested and certified to CSA, cUPC, ANSI/ASME and NSF standards and listed by applicable certification bodies. For more information on individual product listings, contact our office or listing organization.

BLANCO CANADA 100 Corporation Drive Brampton, ON L6S 6B5	Tel: 905 494 2400 Fax: 905 494 2425 www.blancocanada.com	Toll Free: 1 877 425 2626 Toll Free: 1 877 825 2626	© 2016 BLANCO CANADA
--	--	--	----------------------



# CALEDON

# 30-06 WESTMOUNT



Jan 11/22

Lot 39B

Nov 12/21

# CALEDON CLUB

30-06 WESTMOUNT

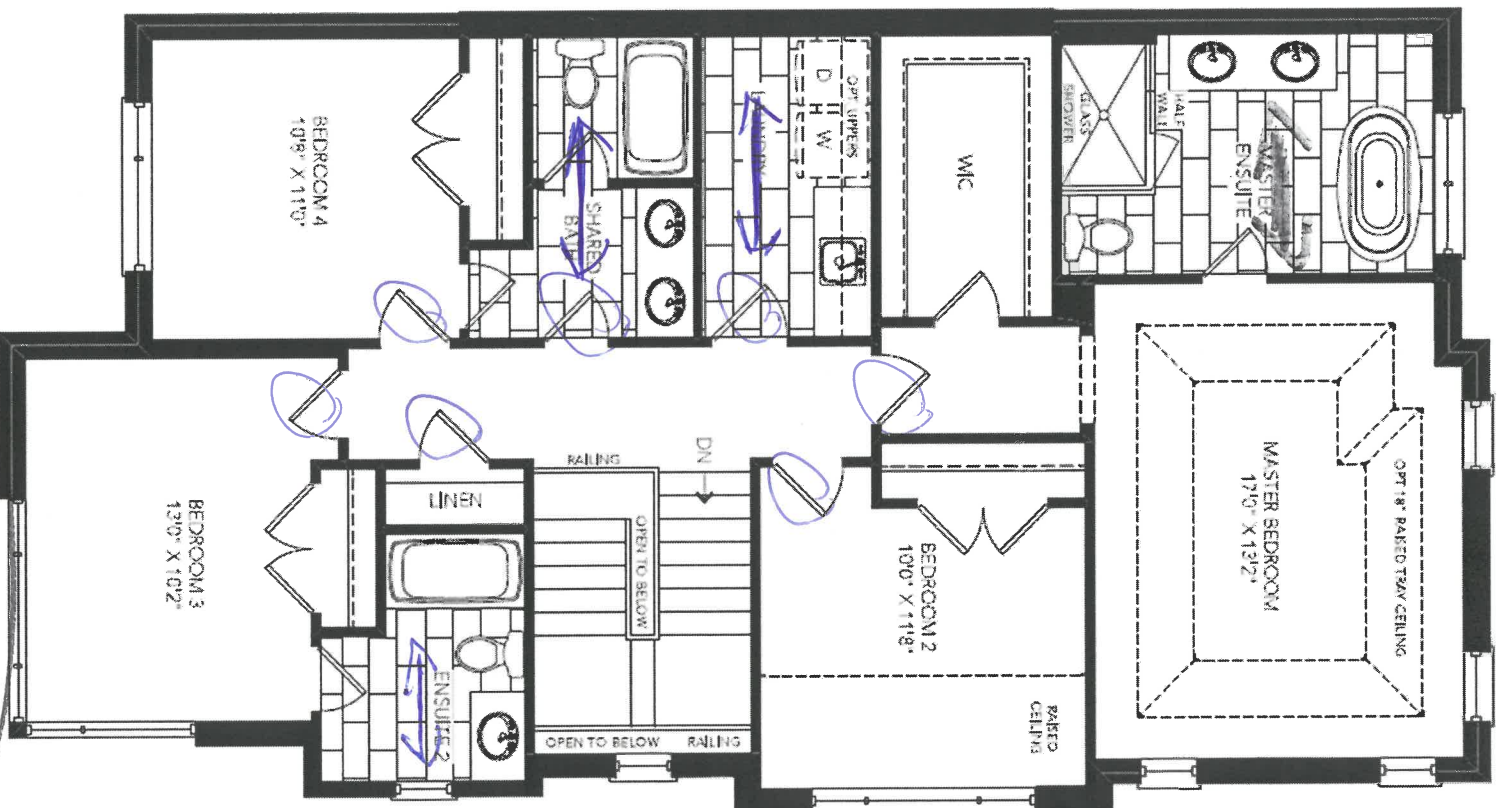

(7) 8' High Doors.

Jan 11/22

## HOME AUTOMATION (Cable, CAT5/6, Telephone)

**INCLUDED IN SCHEDULE "A" IN AGREEMENT OF PURCHASE AND SALE:**

- Rough-in for Central Vacuum system piped to garage
- Rough-in for Telephone (2) locations
- Rough-in for Cable TV (2) locations
- Rough-in for Cat-6 Network (3) locations

**OPTION 1:**

I/we the Homeowner(s) have chosen to contact the Home Automation Company to select the locations of the rough-ins for Cable, CAT5, Telephone as included in our Agreement of Purchase Sale.

I/we the Homeowner(s) will contact the trade within 4 weeks of the date of this release to select locations of the standard rough-ins review other optional products for purchase.

**Trade:** Artistic Smart Homes  
**Phone:** (905) 850-9386  
**Location:** 8601 Jane Street  
Concord, Ont L4K 5N9

Should the homeowner not make these selections within the sufficient time provided, the rough-ins as mentioned above will be installed in locations at the Vendor's discretion.

  
Homeowner(s) Initial

**OPTION 2:**

I/we the Homeowner(s) acknowledge that if we do not contact the home automation company, I/we the Homeowner(s) have agreed to the Vendor locations for the standard rough-ins for Cable, CAT6, Telephone that are included in the Agreement of Purchase and Sale.

Homeowner(s) Initial

  
DATE

CALEDON  
SITE

  
LOT

## APPLIANCE ACKNOWLEDGEMENT

CONTACT: Steve Miller - Appliance Canada (905) 660-2424 / smiller@appliancecanada.com

- It is the Purchasers responsibility to coordinate delivery, installation and hook up of appliances and to ensure they are installed as per Manufacturers specifications after closing.

## STANDARD APPLIANCE OPENINGS provided by Zancor:

\*Standard appliance openings are approximate and the minimum required. Sizes may vary due to onsite condition and/or when modifications have been made to the cabinetry.

- Fridge Opening 36" x 74"
- Stove Opening 30"
- Hood Fan Opening 30"
- Hood Fan & Vent 6" with Under Cabinet Hood
- Dishwasher Opening 24"

Accepts Standard  
Openings \*\*Initial

## OPTIONAL UPGRADED APPLIANCES to be provided by Homeowner:

- **\*\*Specs/Information sheets are required and it is the responsibility of the homeowner to provide this to Zancor Homes by the due date that has been provided. If appliance specs are not submitted, Zancor Homes will not be responsible for any necessary requirements and the standard opening will be built.**

SM

- Upgraded Appliance Specs are DUE 2 WEEKS FROM SIGNED DATE OF COLOUR CHART (if not received during appointment)

INITIAL

- \*\*\*Specs that require changes/modifications after this date will not be accepted\*\*\*

- NOTE: Any upgraded appliances are to be paid by the Purchaser, directly to the appliances company.

- Additional charges to the Purchaser may apply for cabinetry, electrical and plumbing in order to accommodate the specs given by the homeowner.

## FRIDGE UPGRADE

- ☐ Built-in
- ☐ Paneled \*\*Panel to match required
- ☐ Integrated / Flush Inset
- ☒ Waterline

## RANGE UPGRADE

\*Larger hood fan CFM might be required, which need a larger vent

☐ 36" \*\*Hood fan opening must be the same size or larger (8" vent might be required)

☐ 48" \*\*Hood Fan opening must be the same size or larger (8" or 10" vent required)

- ☐ Gas Range \*\*gas line and electrical required & sold separately
- ☐ Induction \*\*electrical required & sold separately
- ☐ Cooktop (Apron Front) \*\*Countertop Cut-out required & sold separately
- ☐ Cooktop (Drop-in) \*\*countertop Cut-out required & sold separately

HOOD FAN & VENT  
UPGRADE

- ☐ 8 Inch \*\*Required for 600 CFM
- ☐ 10 Inch
- ☐ Chimney Hood Fan \*\*Vent must be centred
- ☐ Insert / Liner

WALL OVEN/MICRO  
UPGRADE

- ☐ Single Wall Oven \*\*electrical required & sold separately
- ☐ Double Wall Oven \*\*electrical required & sold separately
- ☐ Steam Oven \*\*electrical required & sold separately
- ☐ Warming Drawer \*\*electrical required & sold separately
- ☐ Over Then Range Microwave (OTR)
- ☐ Built-In Microwave \*\*Trim Kit required \*\*electrical required & sold separately

MICROWAVE  
SINK LF

DATE

Jan 11/22

CALEDON

SITE

3913

LOT

\*\* Any upgrades checked in this appliance form must be accompanied with specs provided by the Purchaser.

\*\*It is the responsibility of the trade to inform the Builder of any discrepancies with specs, sketches, extras and/or colour chart PRIOR to production/installation.

ZANCOR

221 North Rivermede Road, Concord, Ontario L4K 3N7 \* T: (905) 738.7010 F: (905) 738.5948





CLIENT NAME: ZANCOR HOMES  
SHIP TO : CALEDON CLUB

PH:  
CELL :

30-6-ELEV. A,B,C  
STD VANITIES

POWDER  
900

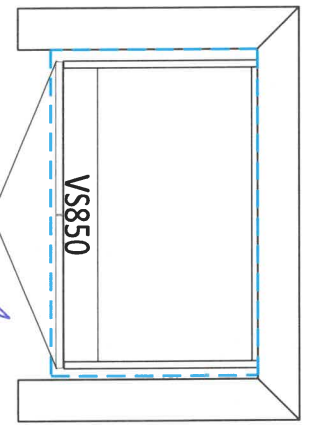

~~1560~~ 1560  
SHARED

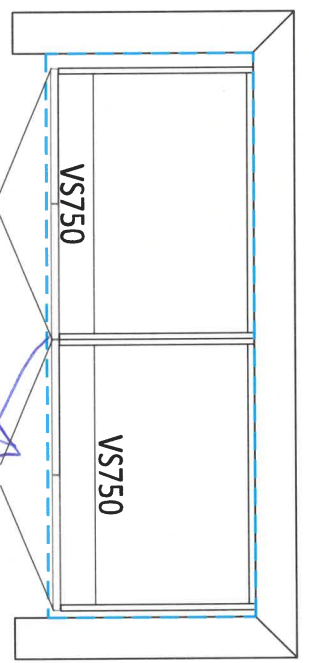

ENSUITE 2  
900

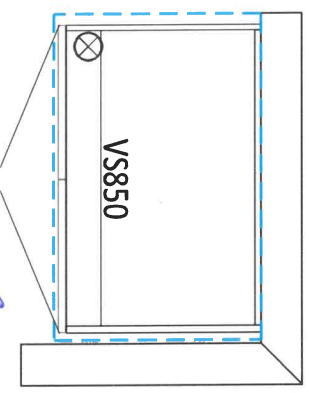

MASTER ENSUITE  
1860

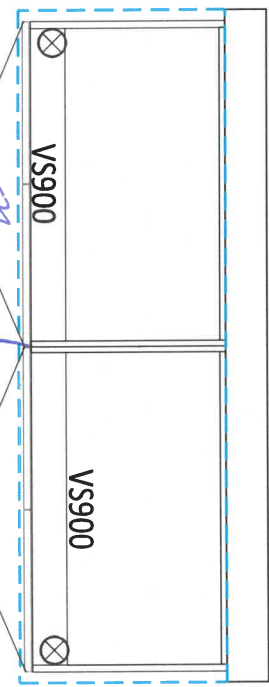

LAUNDRY ROOM  
3150 1650

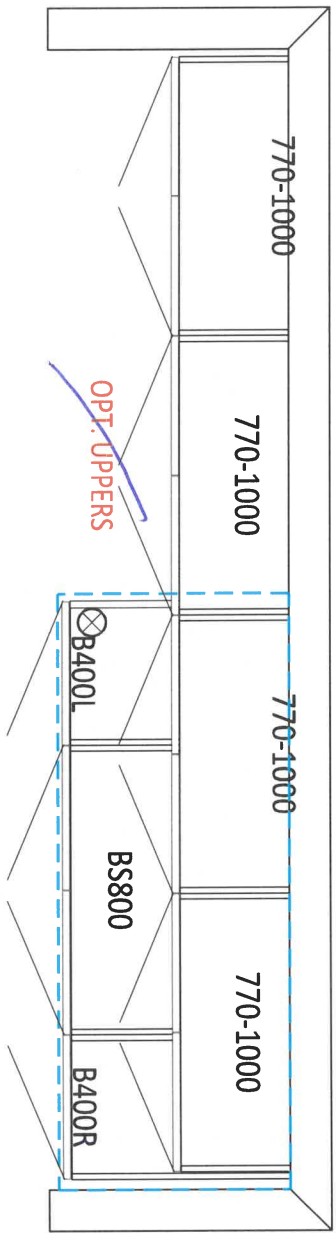

OPT. BASEMENT BATH  
900

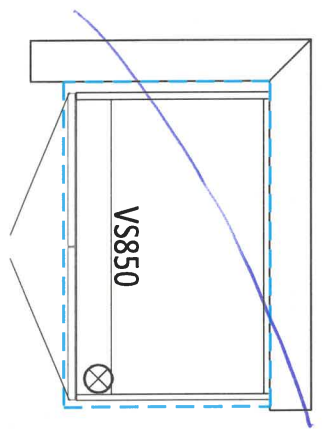

Lot 3913

Jan 11/22

comfort height  
BANK of  
DRAWERS

comfort Ht  
BANK of  
DRAWERS

Handwritten signature



DATE SUBMITTED  
25 Jun 2021

CLIENT NAME: ZANCOR HOMES  
SHIP TO : CALEDON CLUB  
DRAFTED BY: FERNANDA  
COMMENT

JOB NUMBER  
INSTALL DATE:  
PAGE  
22 of 24  
P/O #

30-6-ELEV. A,B,C  
KITCHEN

-Soft Close Doors  
and Drawers  
-Cutlery Divider

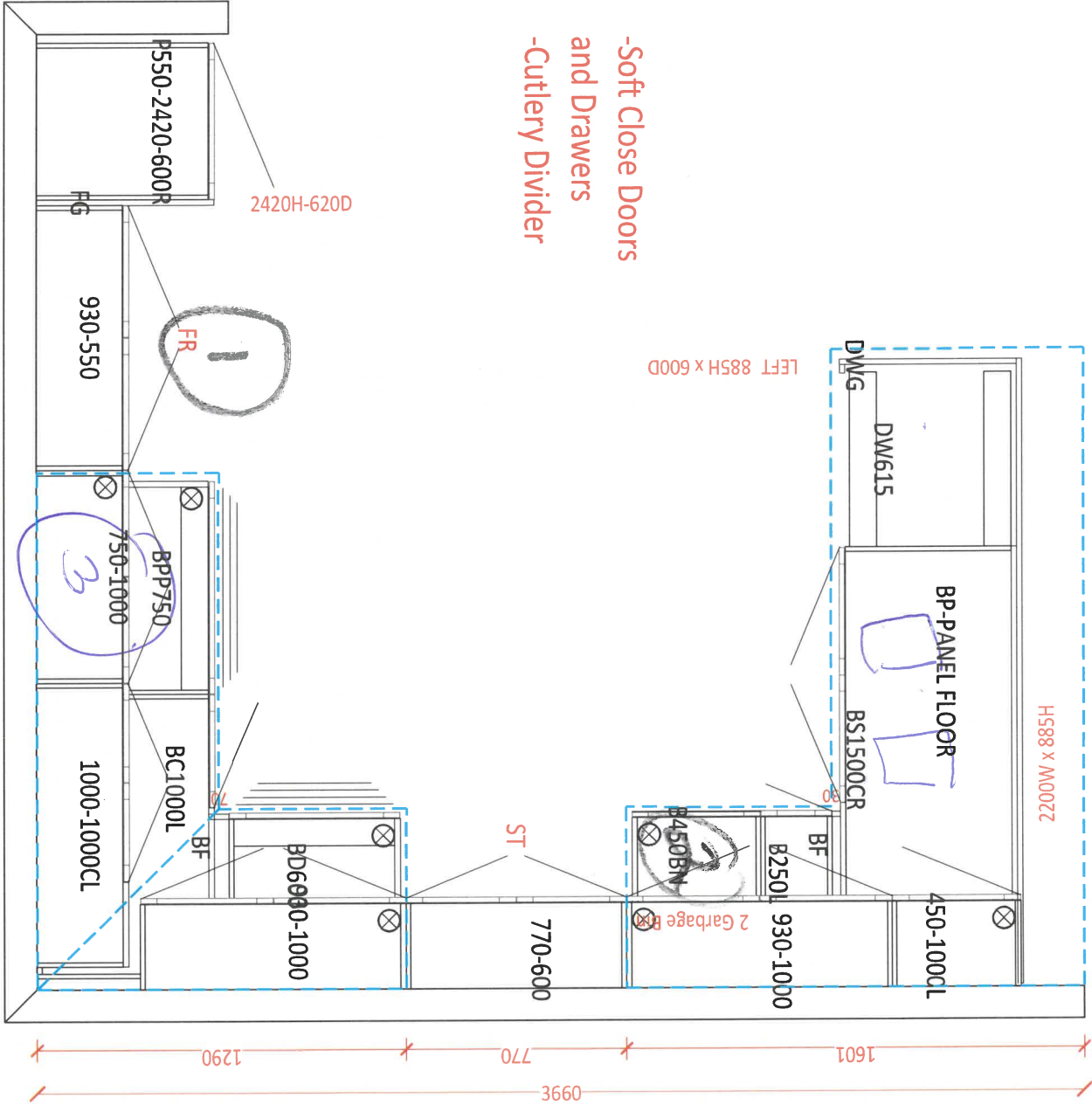

- 1 Fridge on island
- 2 Back Bank of Drawers
- 3 microwave Shelf.

W/S



CLIENT NAME: ZANCOR HOMES  
SHIP TO : CALEDON CLUB

JOB NUMBER

INSTALL DATE:

PH:  
CELL:

DRAFTED BY: FERNANDA  
COMMENT

P/O #

PAGE

23 of 24

DATE SUBMITTED  
25 Jun 2021

30-6-ELEV. A,B,C  
KITCHEN

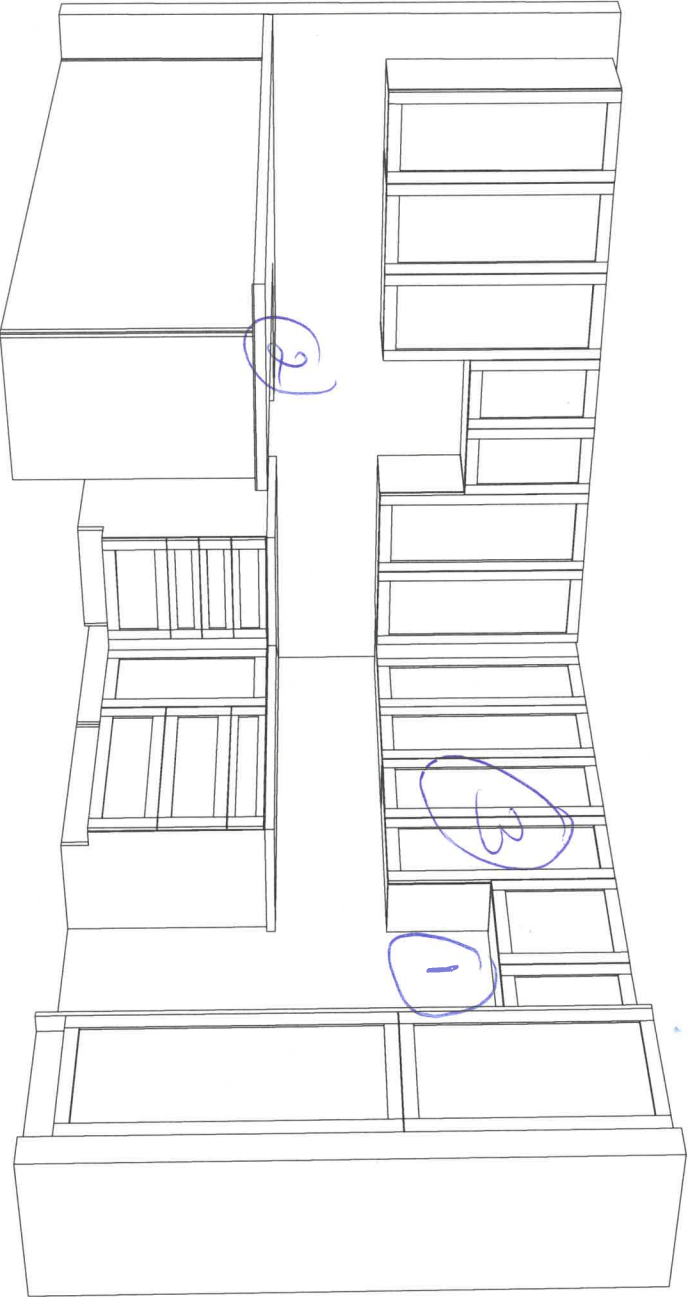

Lot 391B

2011/1/22

WJ  
VF



Stone Countertop Edge Profiles

\*\*Where applicable as per site specifications\*\*

STANDARD EDGE FOR KITCHEN & VANITIES

Standard Countertop Edge in Kitchen



Standard Countertop Edge in Vanity

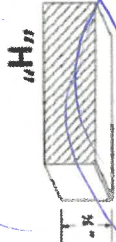

Homeowner(s) Initial

OPTION (1) EDGE FOR KITCHEN & VANITIES \$250

Optional Edge in Kitchen

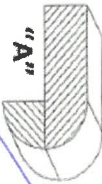
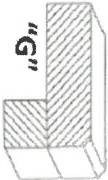
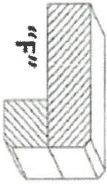
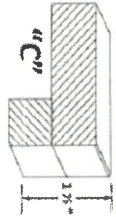

Optional Edge in Bathroom

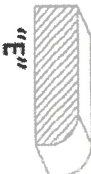

Homeowner(s) Initial

OPTION (2) EDGE FOR KITCHEN & VANITIES CUSTOM PRICING

Optional Edge for Kitchen

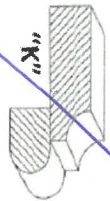
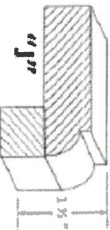
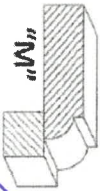

Optional Edge in Vanity

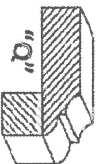
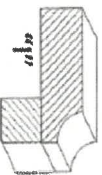
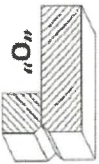

Homeowner(s) Initial

DATE

Jan 11/22

SITE

CALEDON

LOT

29B

221 North Rivermede Road, Concord, Ontario L4K 3N7 \* T: (905) 738.7010 F: (905) 738.5948

Purchaser accepts and acknowledges that the Builder reserves the right to substitute materials with those of equal or better quality where the manufacture, scheduling or delivery of materials may directly impact the Builder's ability to meet its contractual obligations under the Agreement of Purchase and Sale.

**UPGRADES/EXTRAS:** All upgrades and additional selections indicated on the colour chart must be accompanied by an upgrades/extras sheet (PES) and full payment otherwise the selection will be invalid. All colour charts and upgrades/extras will not proceed until verified and signed by an authorized signing officer at the Vendor's head office. **CHANGES WILL NOT BE PERMITTED UPON COMPLETION AND SUBMISSION OF THE COLOUR CHART.**

**PORCELAIN & NATURAL STONES:** Due to the properties of natural stones including but not limited to **marble, granite, quartz**, no two pieces are exactly the same. Variations in colour, tone, granularity (pitting, fissures) and pattern are to be expected, including various lighting may affect the overall finished look. Stone tops are sealed at time of installation and should never be cleaned with lemon oil or vinegar. Stones are porous materials, therefore any spilled substance require immediate attention. Stone countertops require regular seal re-application as part of home maintenance. Purchaser acknowledges colour and product variations as well as natural imperfections may exist with the selection of natural stone materials and shall not hold the Vendor liable for provision of same.

**STONE COUNTERTOP JOINTS:** Purchaser is aware that one joint will be at each corner and on either side of slide-in-range (if applicable). It will also be where the length of the counter top exceeds the length of a stone slab. Slabs are usually approximately 5'x 8'.

**CERAMIC TILES:** Due to manufacturing, shade (dye lots), product variations may exist that can affect the overall look of the finished product. Although every effort will be made to ensure the colours and materials selected are as close as possible to the samples, the purchaser acknowledges that the sample tiles supplied in the Design Centre may not be identical to the materials installed in the home.

**STAIR STAINS:** Due to the natural properties of wood, many variables can affect the overall look of the finished product. Factors including but not limited to wood type, knotting, graining, density, age, humidity, and air temperature can result in substantial variations in stain intensity. The purchaser accepts that although the Vendor will do their best to match stain the unfinished stairs as close as possible to the pre-finished floors, it is not possible to have an identical match and that there MAY be shade differences between the two products.

**CABINETRY:** Due to the natural properties of wood, slight variations apparent with cabinetry are to be expected. This includes but not limited to wood species, wood grain, colour, finish, product variations, and natural imperfections are all factors that may affect the overall look of the finished product. Such factors make exact colour matching impossible. The type and intensity of lighting in the areas of designated cabinetry placement may also highlight characteristics of cabinetry finish. All cabinets shall be finished with a white melamine interior box unless a finished interior is upgraded. Due to building specifications and/or on-site conditions, certain cabinetry upgrades may not be possible. The purchaser acknowledges that the Builder cannot guarantee the cabinetry finish or provision of certain upgrades and shall not hold the Builder liable for provision of same.

**UPGRADES/EXTRAS:** All upgrades and additional selections indicated on the colour chart must be accompanied by an upgrades/extras sheet (PES) and full payment otherwise the selection will be invalid. All colour charts and upgrades/extras will not proceed until verified and signed by an authorized signing officer at the Vendor's head office. **CHANGES WILL NOT BE PERMITTED UPON COMPLETION AND SUBMISSION OF THE COLOUR CHART.**

**HARDWOOD / LAMINATE FLOORING:** Due to the properties of wood and laminate, many variables can affect the overall look of the finished product. Variations include but not limited to wood type or laminate finish, colour/stain and wood grain are significant factors that make exact colour matching impossible. The purchaser acknowledges that the hardwood flooring is a pre-finished product in a controlled environment. Expansion, compression and cupping are characteristics of hardwood flooring once installed in the home. The purchaser acknowledges these may become apparent over time and despite the Builders' efforts to install the hardwood flooring materials in keeping with good workmanship, the Builder shall not be responsible nor held liable for minor variances of fluctuation in hardwood flooring materials.

**HARDWOOD / LAMINATE WAIVER:**

I/We understand hardwood flooring is classified as a porous material and as such not recommended by the Builder in certain areas. I/We understand there is a concern due to possible water and other substances being frequently splashed or spilled onto the floor and in contravention of Ontario Building Code Section 9.30.1.2(1).

*"Finished flooring bathrooms, kitchens, public entrance halls, laundry & general storage areas shall consist of resilient flooring, felted-synthetic-fibre floor coverings, concrete, terrazzo, ceramic tile, mastic or other types of flooring providing similar degrees of water resistance.*

I/We are prepared to assume full responsibility for any damage caused to the hardwood floor or subfloor due to moisture absorbency in the mentioned areas, and agree to waive any claims against the Township of residence, TARIION and/or the Builder in relation to the matter. **\*\*SEE COLOUR CHART FOR LOCATIONS\*\***

DATE		SITE	<b>CALEDON</b>	LOT	
221 North Rivermede Road, Concord, Ontario L4K 3N7 * T: (905) 738.7010 F: (905) 738.5948					