

Site: WASAGA

Lot: 129

Model: PEBBLE (40-04) ELEV. C

Purchaser: MARIE PERI

Purchaser: 0

Phone: Contact Simone 416-843-7270

Email: simone@zaoncorhomes.com



DESCRIPTION		DATE SELECTED
BONUS PACKAGE: 3 PIECE STAINLESS STEEL APPLANCES WITH WHITE TOP LOAD WASHER & DRYER	INCLUDED IN APS	
BONUS PACKAGE: STAINLESS STEEL HOOD FAN	INCLUDED IN APS	
1 FINISHED BASEMENT BATHROOM WITH STANDING FRAMELESS GLASS SHOWER, TOILET & VANITY	28-Feb-22	see note on page 2
2 FINISHED BASEMENT AS PER SKETCH (INCLUDES ROUGHINS FOR FUTURE WETBAR (SEE SKETCH) AND 12 POTLIGHTS	28-Feb-22	
3 SMOOTH CEILINGS	28-Feb-22	
4 TRAY CEILING IN MASTER BEDROOM	28-Feb-22	
5 CATHEDRAL CEILING IN GREAT ROOM	28-Feb-22	
6 9 FOOT CEILINGS IN BASEMENT	28-Feb-22	
7 ELECTIRCAL - 50 AMP PLUG IN GARAGE FOR FUTURE ELECTRIC CAR	28-Feb-22	
8 ELECTRICAL - POTLIGHTS IN GREAT ROOM (X6), DELETE STD LIGHT	28-Feb-22	
9 ELECTRICAL - POTLIGHTS IN BREAKFAST AREA (X4), DELETE STD LIGHT	28-Feb-22	
10 ELECTRICAL - POTLIGHTS IN KITCHEN (X4), DELETE STD LIGHT	28-Feb-22	
11 ELECTRICAL - POTLIGHTS IN DINING ROOM (X4), STD LIGHT TO REMAIN CAPPED	28-Feb-22	
12 ELECTRICAL - POTLIGHTS IN MAIN HALL (X2), DELETE STD LIGHT	28-Feb-22	
13 ELECTRICAL - POTLIGHTS IN SIDE HALL (X4), DELETE STD LIGHT	28-Feb-22	
14 ELECTRICAL - POTLIGHTS IN FOYER (X3), DELETE STD LIGHT	28-Feb-22	
15 ELECTRICAL - POTLIGHTS IN BEDROOM 2 (X4) ON SEP SWITCH, STD LIGHT TO REMAIN CAPPED	28-Feb-22	
16 ELECTRICAL - POTLIGHTS IN BEDROOM 3 (X4) ON SEP SWITCH, STD LIGHT TO REMAIN CAPPED	28-Feb-22	
17 ELECTRICAL - POTLIGHTS IN MASTER BED (X4) ON SEP SWITCH, STD LIGHT TO REMAIN	28-Feb-22	
18 ELECTRICAL - POTLIGHTS IN MASTER BED FOYER (X1), DELETE STD LIGHT	28-Feb-22	
19 ELECTRICAL - ADD SHOWER POTLIGHT (X1) TO MAIN BATH TUB	28-Feb-22	
20 ELECTRICAL - ADD (1) LIGHT OVER SINK IN MASTER ENSUITE, SHIFT THE STD LIGHT TO BE OVER THE OTHER SINK **BOTH LIGHTS TO BE ON WALL CENTRED OVER SINK	28-Feb-22	
21 ELECTRICAL - ADD CAPPED ROUGHIN OVER TUB ON SEP SWITCH	28-Feb-22	
22 ELECTRICAL - ADD POTLIGHTS IN LAUNDRY ROOM (2), DELETE STD LIGHT	28-Feb-22	
23 DELETE CARPET & HARDWOOD - ALL FLOORING TO BE DONE DIRECTLY WITH CARMINE AT FIRST CANADIAN HARDWOOD	28-Feb-22	
24 PAINT - ALL PAINT & STAIN TO BE SELECTED DIRECTLY WITH JOHN AT PERFECT TOUCH	28-Feb-22	
25 KITCHEN CABINETS - UPGRADE 1	28-Feb-22	
26 KITCHEN CABINETS - TWO TONE	28-Feb-22	
27 KITCHEN COUNTERTOP - STONE COUNTERTOP UPGRADE 3	28-Feb-22	
28 KITCHEN - SINK - UPGRADE TO 1-3/4" BLANCO 401520	28-Feb-22	
29 KITCHEN - FRIDGE ENCLOSURE (DEEP UPPERS WITH GABLE)	28-Feb-22	
30 KITCHEN - MAGIC CORNER	28-Feb-22	
31 KITCHEN BACKSPLASH - UPGRADE 2 *BRICK	28-Feb-22	
32 TILES - UPGRADE 2 - KITCHEN	28-Feb-22	
33 TILES - UPGRADE 2 - MAIN FOYER & BASEMENT FOYER	28-Feb-22	
34 TILES - UPGRADE 2 - MAIN BATH FLOOR & WALL	28-Feb-22	
35 TILES - UPGRADE 2 - MASTER ENSUITE FLOOR & WALL	28-Feb-22	
36 TILES - MASTER ENSUITE SHOWER FLOOR	28-Feb-22	
37 MASTER ENSUITE SHOWER JAMB	28-Feb-22	
38 MASTER ENSUITE - CABINETS - UPGRADE 1	28-Feb-22	

Site: WASAGA
Lot: 129
Model: PEBBLE (40-04) ELEV. C
Purchaser: MARIE PERI
Purchaser: 0
Phone: Contact Simone 416-843-7270
Email: simone@zaoncorhomes.com



	DESCRIPTION	DATE SELECTED
39	MASTER ENSUITE - COUNTERTOP - STONE UPGRADE 3 *INCLUDES RECTANGLE UNDERMOUNT SINKS	28-Feb-22
40	MAIN BATHROOM - COUNTERTOP - STONE UPGRADE 3 *INCLUDES RECTANGLE UNDERMOUNT SINK	28-Feb-22
41	BASEMENT BATH - COUNTERTOP - STONE UPGRADE 3 *INCLUDES RECTANGLE UNDERMOUNT SINK	28-Feb-22
42	COMFORT HEIGHT VANITIES TO ALL BATHROOMS	28-Feb-22
43	MOEN BATHROOM ACCESSORIES - CHROME TOILET PAPER HOLDER & TOWEL BAR (ALL BATHROOMS)	28-Feb-22
44	LAUNDRY ROOM - UPPERS AND BASE SINK CABINET	28-Feb-22
45	RAILINGS - UPGRADE 2 - METAL ALL PLAIN, SQUARE POST	28-Feb-22
46	INTERIOR DOORS - LOGAN	28-Feb-22
47	INTERIOR TRIM CASING & BASEBOARDS - UPGRADE 2	28-Feb-22
48	PLUMBING FAUCETS - STANDARD	28-Feb-22
49	PLUMBING - TOILET IN MASTER ENSUITE - CONTRAC CALL ONE PIECE	28-Feb-22
50	HVAC - COMPLETE AIR CONDITIONING UNIT	28-Feb-22
51	EXTEND DECK AS PER SKETCH	28-Feb-22
52	LAUNDRY - ADD STONE COUNTERTOP ACROSS WASHER & DRYER	28-Feb-22
SLAB TO MATCH COUNTERTOP TILES IN STORAGE AREA BETWEEN STAIRS AND LOW HEAD ROOM - SEE SKETCH & COLOUR CHART		

* There are 2 location options
for wet bar - see floor plan

* Basement includes Potlights as per sketch

ZANCOR HOMES COLOUR CHART

PRINTED 2022-03-14, 5:19 PM

ENTRANCES

Main Foyer - FLOORING		VERSAIS GRIS 18 X 18 (2)	
Mudroom - FLOORING		N/A	
Side Hall - FLOORING		N/A	
Basement Foyer - FLOORING		VERSAIS GRIS 18 X 18 (2)	***IN STORAGE ROOM AREA - BETWEEN STAIRS AND LOW HEADROOM - SEE PLAN***
KITCHEN			
Kitchen - FLOORING		VERSAIS GRIS 18 X 18 (2)	
Breakfast - FLOORING		VERSAIS GRIS 18 X 18 (2)	
Kitchen - CABINETS UPPERS		CONTEMPORARY SLAB - VANILLA MILKSHAKE	
Kitchen - CABINETS LOWERS		EURO ADAMELLO 1 (1)	
Servery - CABINETS		N/A	
Kitchen - HANDLES/KNOBS		H800BC	
Kitchen - COUNTERTOP		EMERSTONE BORGHINI CLASSIC (3)	
Island - COUNTERTOP		EMERSTONE BORGHINI CLASSIC (3)	
Kitchen - BACKSPLASH	SLAB TO MATCH COUNTERTOP	WHITE/GREY CANNARA GLOSSY 10 X 16 (2) ***INSTALL HORIZONTAL BRICK	
Kitchen - SINK		BLANCO 1-3/4" UNDERMOUNT	
Kitchen - FAUCET		STANDARD	
GREAT ROOM / DINING / LIVING / DEN / OFFICE / BASEMENT			
Family / Great Room - FLOORING		FIRST CANADIAN HARDWOOD - DIRECTLY	
Main Hall - FLOORING		FIRST CANADIAN HARDWOOD - DIRECTLY	
Dining / Living Room - FLOORING		FIRST CANADIAN HARDWOOD - DIRECTLY	
Library / Den - FLOORING		N/A	
Basement Rec Room - FLOORING		FIRST CANADIAN HARDWOOD - DIRECTLY	
STAIRS			
Railing Details - PICKETS		UPGRADE - METAL - ALL PLAIN BLACK	
Railing Details - POSTS		UPGRADE - SQUARE OAK WITH REVEAL	
Railing Details - HANDRAIL		UPGRADE - SQUARE OAK	
Stair Stain - MAIN STAIRS		PERFECT TOUCH - DIRECTLY	
Stair Stain - BASEMENT STAIRS (if applicable)		PERFECT TOUCH - DIRECTLY	
Stair Stain - SERVICE STAIRS (if applicable)		N/A	
POWDER ROOM			
Powder Room - FLOORING		VERSAIS GRIS 18 X 18 (2)	
Powder Room - CABINETS		PEDESTAL SINK	
Powder Room - COUNTERTOP		N/A	
Powder Room - SINK		PEDESTAL SINK	
Powder Room - FAUCET		STANDARD	
2ND FLOOR			
Upper Hall - FLOORING		N/A	
Master Bedroom - FLOORING		FIRST CANADIAN HARDWOOD - DIRECTLY	
Bedroom 2 - FLOORING		FIRST CANADIAN HARDWOOD - DIRECTLY	
Bedroom 3 - FLOORING		FIRST CANADIAN HARDWOOD - DIRECTLY	
Bedroom 4 - FLOORING		N/A	
Bedroom 5 - FLOORING		N/A	
Master Ensuite - FLOORING		VERSAIS GRIS 18 X 18 (2)	
Master Ensuite - SHOWER WALL		VERSAIS GRIS 18 X 18 (2)	
Master Ensuite - SHOWER FLOOR		ONTARIO SERIES HEX SNOW GLOSS (1)	
Master Ensuite - SHOWER JAMB		MARMOLINE SNOW	
Master Ensuite - CABINETS		EURO ADAMELLO 1 (1)	
Master Ensuite - HANDLES/KNOBS		H800BC	
Master Ensuite - COUNTERTOP		EMERSONE PURE EXTRA (3)	
Master Ensuite - SINK(S)	RECTANGLE UNDERMOUNT	Master Ensuite - FAUCET(S)	STANDARD
FOR TRADE USE		SIGNATURES	
Any upgrades in the colour chart must be accompanied with a PES. It is the responsibility of all Trades to inform the builder of any discrepancies on sketches, PES and/or colour charts PRIOR to installation.		WASAGA SHORELINE 129	<div><div></div><div>PURCHASER INITIALS</div></div> <div><div></div><div>VENDOR APPROVAL</div></div>
		PAGE 1 OF 2	

2ND FLOOR CONTINUED...				
Main Bath - FLOORING	VERSAIS GRIS 18 X 18 (2)			
Main Bath - TUB / SHOWER WALL	VERSAIS GRIS 18 X 18 (2)			
Main Bath - SHOWER FLOOR	N/A			
Main Bath - SHOWER JAMB	N/A			
Main Bath - CABINETS	CONTEMPORARY MDF - VANILLA MILKSHAKE			
Main Bath - HANDLES/KNOBS	H800BC			
Main Bath - COUNTERTOP	EMERSONE PURE EXTRA (3)			
Main Bath - SINK(s)	RECTANGLE UNDERMOUNT	Main Bath - FAUCET(s)	STANDARD	
Basement Bath- FLOORING	VERSAIS GRIS 18 X 18 (2)			
Basement Bath- TUB / SHOWER WALL	VERSAIS GRIS 18 X 18 (2)			
Basement Bath- SHOWER FLOOR	N/A			
Basement Bath- SHOWER JAMB	N/A			
Basement Bath- CABINETS	CONTEMPORARY MDF - VANILLA MILKSHAKE			
Basement Bath- HANDLES/KNOBS	H800BC			
Basement Bath- COUNTERTOP	EMERSONE PURE EXTRA (3)			
Basement Bath- SINK(s)	RECTANGLE UNDERMOUNT	Shared Bath - FAUCET(s)	STANDARD	
Ensuite Bath - FLOORING	N/A			
Ensuite Bath - TUB / SHOWER WALL	N/A			
Ensuite Bath - SHOWER FLOOR	N/A			
Ensuite Bath - SHOWER JAMB	N/A			
Ensuite Bath - CABINETS	N/A			
Ensuite Bath - HANDLES/KNOBS	N/A			
Ensuite Bath - COUNTERTOP	N/A			
Ensuite Bath - SINK(s)		Ensuite Bath - FAUCET(s)		
LAUNDRY				
Laundry - FLOORING	VERSAIS GRIS 18 X 18	laundry - HANDLES/KNOBS	H800BC	
Laundry - CABINETS	CONT. MDF - VANILLA MILKSHAKE	Laundry - SINK	STANARD	
Laundry - COUNTERTOP	EMERSTONE PURE EXTRA	laundry - FAUCET	STANARD	
Laundry - BACKSPLASH	N/A			
TRIM / PAINT				
Casing/Baseboards	UPGRADE 2 - CONTEMPORARY			
Interior Doors	UPGRADE - LOGAN			
Interior Door Hardware	STANDARD			
PAINT - Throughout	PERFECT TOUCH DIRECTLY			
FIREPLACE				
Location / Insert / Mantle	STANDARD			
ACCESSORIES				
Mirrors	YES	BATH ACCESSORIES	UPGRADE	
APPLIANCE REQUIREMENTS				
GAS LINE TO BBQ	STANDARD	ELECTRICAL for Built-in Oven	N/A	
GAS LINE & ELECTRICAL TO STOVE	YES	ELECTRICAL for Built-in Micro	N/A	
GAS LINE & ELECTRICAL TO DRYER	N/A	ELECTRICAL for Cooktop	N/A	
HOOD FAN VENT SIZE	6 INCH	ELECTRICAL for Bar Fridge	N/A	
WATERLINE to Fridge	YES			
DISCLAIMER		INITIALS		
Any changes to the colour chart after signing are subject to a \$5000 administration fee plus costs				
Purchaser has checked and acknowledged accuracy of colour and selections before signing.				
Colours of all materials are as close as possible to Builders selection but not necessarily identical due to dye lot variances in manufacturing/manufacturers. Due to construction progress some items may have been pre-selected or installed. In this event the Vendor's selection must be accepted by the purchaser				
SITE / LOT:	WASAGA		129	
PURCHASER(S):	MARIE PERI			
PURCHASER(S):				
CONTACT:				
****FOR TRADE USE****				
Any upgrades in the colour chart must be accompanied with a PES. It is the responsibility of all Trades to inform the builder of any discrepancies on sketches, PES and/or colour charts PRIOR to installation.		SIGNATURES / DATE		
<div>ZANCOR HOMES</div>		PURCHASER SIGNATURE		
		PURCHASER SIGNATURE		
		DÉCOR CONSULTANT		
		SIMONE		
PAGE 2 OF 2		Vendor APPROVAL		

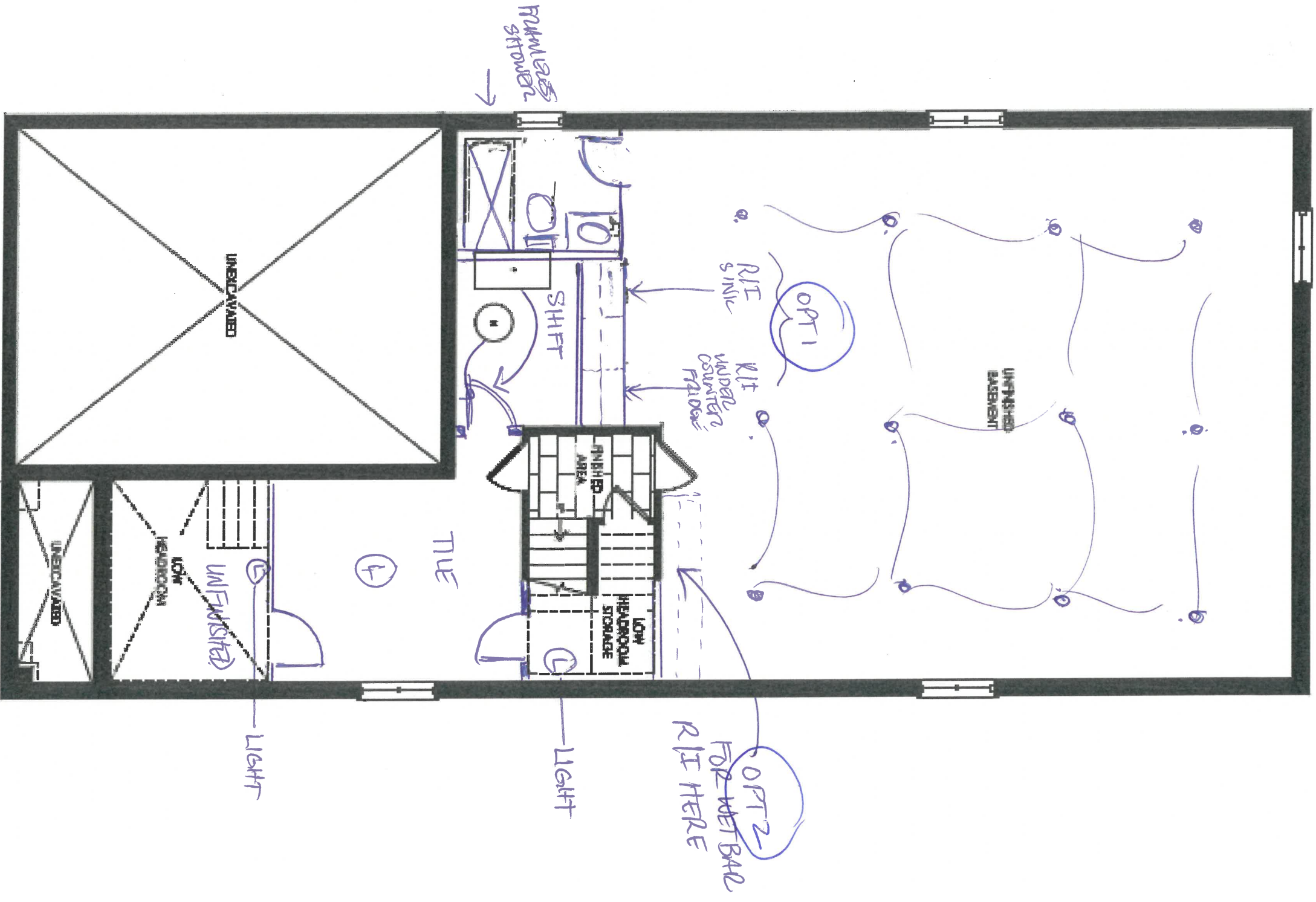

Elevation A, B & C
Basement

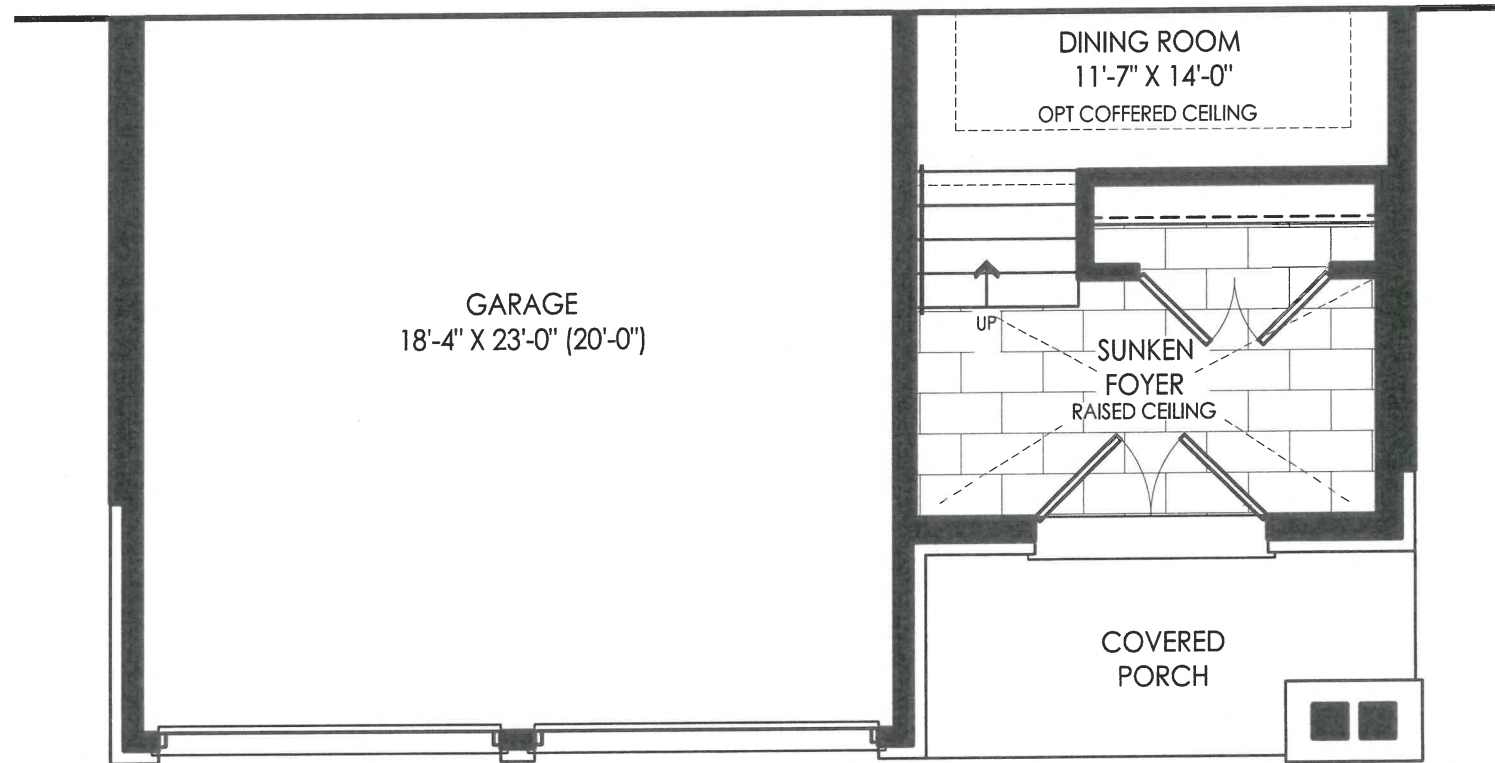

Elevation C
Ground Floor

129
40-04 ©

C



40-04 ©

189



CLIENT NAME: ZANCOR HOMES
SHIP TO: SHORELINE POINT

DRAFTED BY: FERNANDA
COMMENT

PH:
CELL:

DATE SUBMITTED
16 Jun 2021

JOB NUMBER

INSTALL DATE:

PAGE
10 of 12

P/O #

40-04
KITCHEN

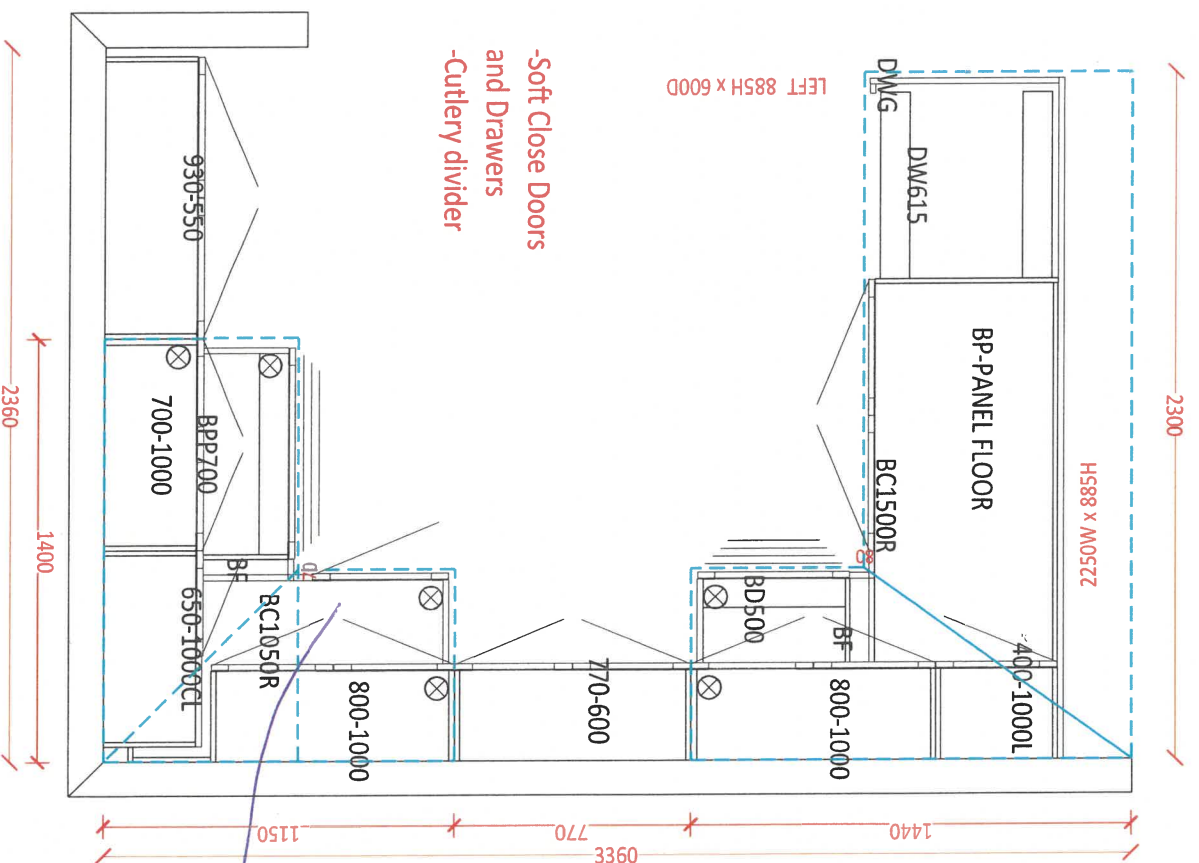

MAGIC
CORNER

- TWO TONE
- WPG 1

129.



CLIENT NAME: ZANCOR HOMES
SHIP TO : SHORELINE POINT

JOB NUMBER

INSTALL DATE:

PH:
CELL :

PAGE
12 of 12

DRAFTED BY: FERNANDA

P/O #

DATE SUBMITTED
16 Jun 2021

40-04

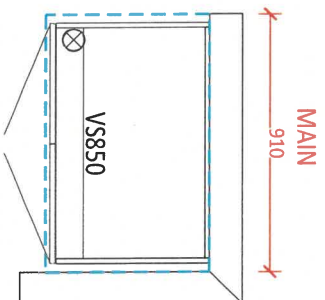

Comfort height

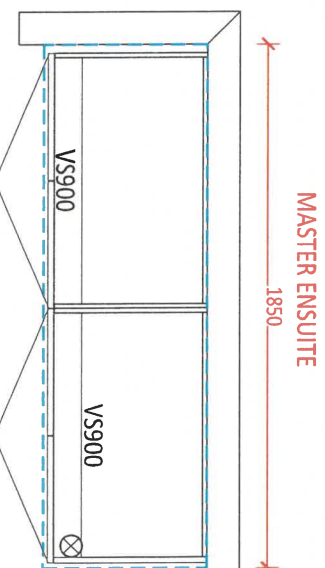

Comfort height

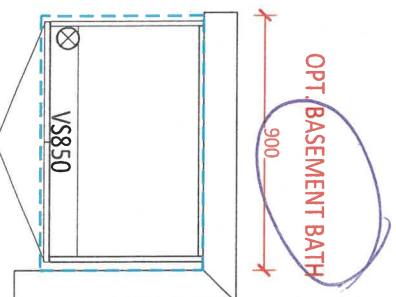
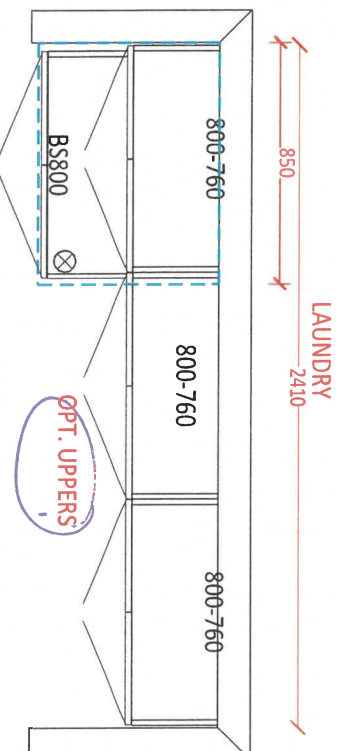

Comfort height



Prism Series

34" Linear Electric Fireplace

BLF3451

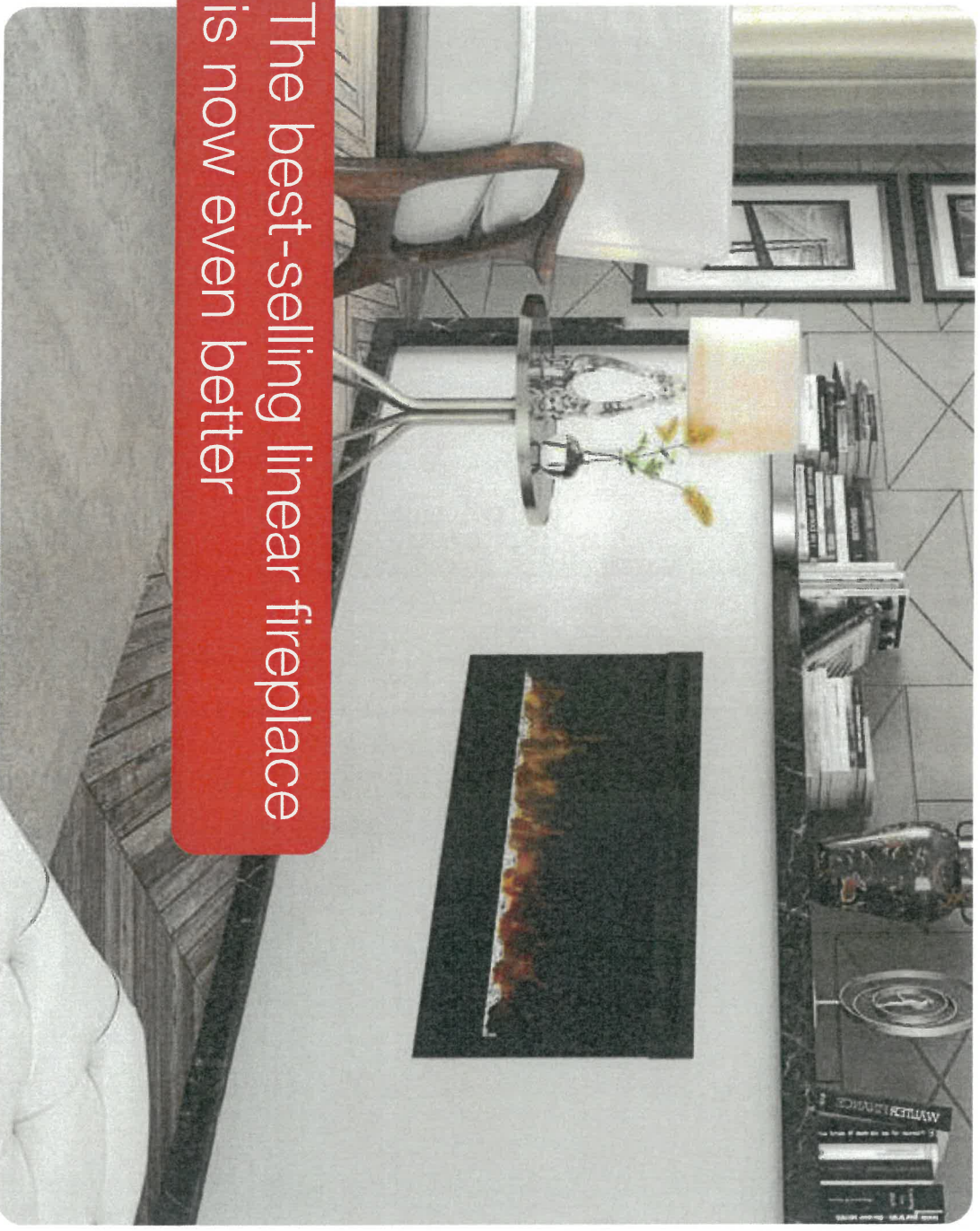

The best-selling electric linear fireplace just got better with the all new Prism Series. Sparkling with intensity in a full spectrum of colors, the Prism effect illuminates the diamond-like acrylic ice ember bed in a show-stopping effect. Plug-in or hard-wire, hung on the wall or built-in; the Prism Series is beautifully versatile.

 **PRISM**
series

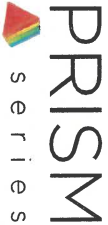

Prism Series

34" Linear Electric Fireplace

BLF3451

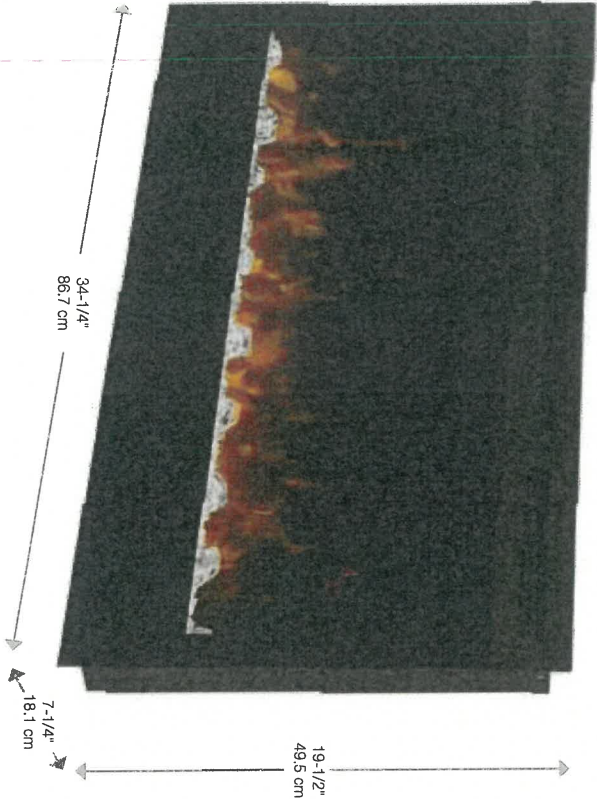

Accessories



Driftwood and River Rock Accessory Package - 34" LF34DWS-KIT

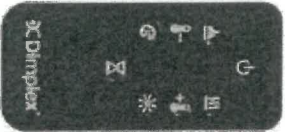

Multi-function Remote

120 Volts | 1,220 Watts | 4,163 BTU

Model #	Description	Lbs / Kg	UPC	Wty. ¹	Carton Dimensions (WxHxD)		Cube	
					Inches	cm	ft ³	m ³
BLF3451	34" Linear Electric Fireplace	60 / 27.2	781052 098763	2 yr.	39 x 23-1/4 x 13	99.1 x 58.9 x 33	6.8	0.2
LF34DWS-KIT	34" Driftwood and River Rock Accessory Kit	6.1 / 2.7	781052 102835		33-1/4 x 4-7/8 x 8-1/8	84.5 x 12.45 x 20.6		

Specifications, finishes and dimensions are subject to change. ¹Limited warranty. ©2020 Glen Dimplex Americas
Glen Dimplex Americas | 1-800-668-6663 | www.dimplex.com

Features

- The Original Dimplex Flame Effect**
A blend of technology, artistry and craftsmanship that sets the standard for realism.
- Acrylic Ice Media Bed**
Light plays through different size pieces and sparkle in a spectrum of colors.
- Media Accent Colors**
Choose from a variety of brilliant color themes or cycle through a range of colors using the custom mode, freezing on the hue of your choice.
- Flexible Installation**
Simply surface mount and plug-in or fully-recess and direct wire for a seamless installation
- Hanging Glass Design**
Detachable glass trim easily finishes rough openings and provides access to media.
- Remote Thermostat Control**
Temperature control at your fingertips for convenient comfort.
- Multi-function Remote**
Control the flame, heat and thermostat from the comfort of your chair.
- LED Lighting**
Flame and lights use brilliant, low-energy LED's that require zero maintenance.
- All-season Flames**
Enjoy the unique charm of a fireplace 365 days a year using the flames without the heat.
- Cool-touch Glass**
Glass remains cool making it safe for any location and any user.
- Low Carbon Footprint**
The most sustainable fireplace option; no emissions and 100% efficient.

SE-021-R04-041520

129



Prism Series

34" Linear Electric Fireplace

BLF3451

Product Dimensions:

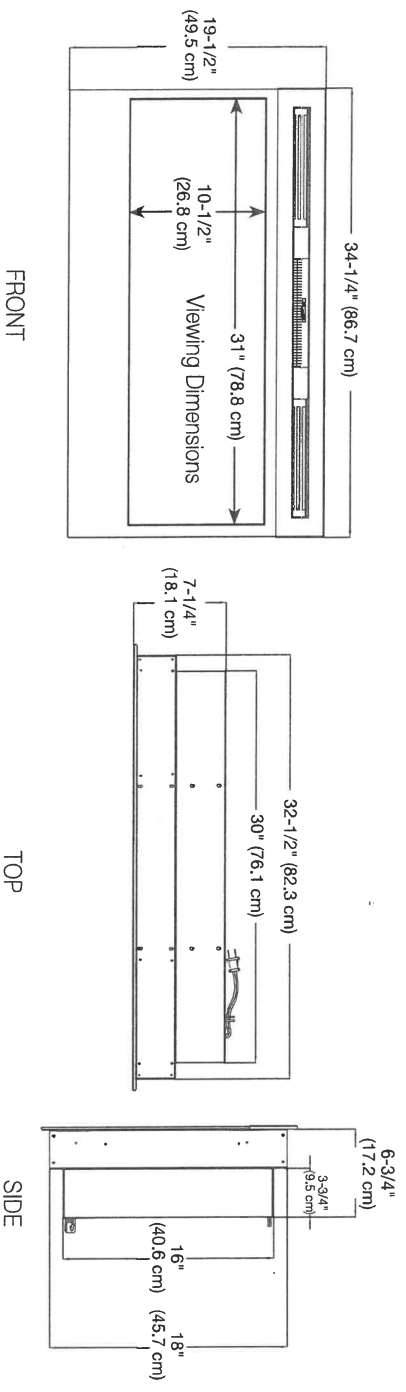

Installation Options and Framing Dimensions

3 Mounting Options

