

OAKVILLE - THE BRANCH WORK ORDER FOR SELECTIONS

MODEL:	CEDAR 708
SUITE:	239

WORK / PURCHASE ORDER

STANDARD PACKAGE - LIGHT (1) * All item below are applicable as per plan

*Cabinets	
Kitchen	Sierra White PVC
Island *as per plan	N/A
Master Ensuite	Sierra White PVC
Main	Sierra White PVC
*Countertops	
Kitchen	Emerstone Quartz Carrara White
Master Ensuite	Emerstone Quartz Carrara White
Main	Emerstone Quartz Carrara White
*Tile/Hardwood	
Laminate Flooring	Highland Willowbrook Oak 8 Inch
Kitchen Bk.Splash	Colours & Dimensions Silver Grey Matte 4 x 16
Laundry	Lily White Tile 12 x 12
Master Glass Shower	Framed Glass Shower
Master Ensuite Floor	Genesis Light Grey 12 x 24
Master Ensuite Shower Wall	Genesis Light Grey 12 x 24
Master Shower Floor	Volkas White Matte 2 x 2
Main Bath Floor	Genesis Light Grey 12 x 24
Main Bath Wall	Genesis Light Grey 12 x 24

*Trim, Kitchen, Bathrooms	
Trim	Flat MDF 2-3/4" Casing X 5-1/4" Baseboard
Kitchen Sink	Cantrio KSS2018 Undermount
Kitchen Faucet	Peerless P7919LF CHROME, Pulldown Faucet
Master Ensuite Sink	PS161C Undermount, rectangle
Master Ensuite Faucet	Peerless P1519LF CHROME
Master Ensuite Tub	ADORA Skirted Tub
Master Shower Faucet	Peerless PT14419 CHROME
Master Ensuite Toilet	WC-382 WHITE, Elongated, Soft-Close, One Piece
Main Bath Sink	PS161C Undermount, rectangle
Main Bath Faucet	Peerless P1519LF CHROME
Main Bath Tub	ADORA Skirted Tub
Main Tub Faucet	Peerless PT14419 CHROME
Main Toilet	WC-382 WHITE, Elongated, Soft-Close, One Piece
Fridge	SEE SPEC
Stove	SEE SPEC
Dishwasher	SEE SPEC
Microwave	SEE SPEC
Washer/Dryer	SEE SPEC

[illegible]

DISCLAIMER & CONDITIONS

FOR TRADE USE

Any upgrades in the colour chart must be accompanied with a PES. It is the responsibility of all Trades to inform the builder of any discrepancies on sketches, PES and/or colour charts PRIOR to installation.

SCHEDULE "B"

To Agreement of Purchase and Sale
The Branch Condominiums
Oakville, ON

RESIDENTIAL SUITE

Suite Number: 239 Unit: 39 Level: 2

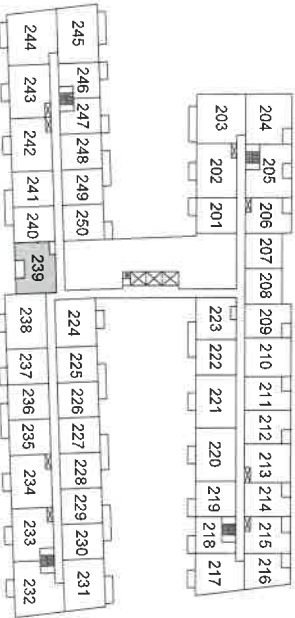

2nd Floor

Vendor's Initial: _____ Purchaser's Initial: *RS* Date: *21/Apr/2022*

This plan is not to scale and is subject to architectural review and revision, including without limitation, the Unit being constructed with a layout that is the reverse of that set out above. All details are approximate and subject to change without notice in order to comply with building site conditions and municipal, structural, and Vendor and/or architectural requirements. Balconies are exclusive use common elements, shown for display purposes only and location and size of such are subject to change without notice. Window location, size and type may vary without notice. E. & O. E.

OAKVILLE

INTERIOR FINISHES ACKNOWLEDGEMENT

ZANCOR
HOMES

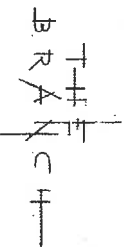

The BRANCH - Oakville

SUITE: 239

DATE: April. 21/22

INTERIOR FINISHES ACKNOWLEDGEMENT

Purchaser accepts and acknowledges that the Builder reserves the right to substitute materials with those of equal or better quality where the manufacture, scheduling or delivery of materials may directly impact the Builder's ability to meet its' contractual obligations under the Agreement of Purchase and Sale. The purchaser acknowledges and agrees to proceed forthwith with reselections in the event the original selections cannot be incorporated into the interior finishing of the home upon notice by the Builder.

Every effort will be made to ensure the materials selected are as close as possible to the samples provided, however due to variances in manufacturing and properties of natural materials we do not guarantee identical colour matching.

PORCELAIN & NATURAL STONES: Due to the properties of natural stones including but not limited to **marble, granite, quartz**, no two pieces are exactly the same. Variations in colour, tone, granularity (pitting, fissures) and patterns are to be expected, including various lighting may affect the overall finished look. Stone should never be cleaned with lemon oil or vinegar. The purchaser acknowledges colour and product variations as well as natural imperfections that may exist with the selection of natural stone materials and shall not hold the Vendor liable for provision of same.

STONE COUNTERTOP JOINTS: Purchaser is aware that one joint may be at each corner and on either side of slide-in-range (if applicable). It will also be where the length of the counter top exceeds the length of a stone slab. Slabs are usually approximately 5' x 8'.

TILES: Due to manufacturing, shade (dye lots), product variations may exist that can affect the overall look of the finished product. Although every effort will be made to ensure the colours and materials selected are as close as possible to the samples, the purchaser acknowledges that the sample tiles supplied in the Design Centre may not be identical to the materials installed in the home.

LAMINATE / HARDWOOD FLOORING: Due to the natural properties of wood & laminate, many variables can affect the overall look of the finished product. Variations include but not limited to wood type or laminate finish, colour/stain and wood grain are significant factors that make exact colour matching impossible. The purchaser acknowledges that the hardwood flooring and laminate is a pre-finished product in a controlled environment. Expansion, compression and cupping are characteristics of hardwood flooring once installed in the home. The purchaser acknowledges these may become apparent over time and despite the Builders' efforts to install the hardwood flooring materials in keeping with good workmanship, the Builder shall not be responsible nor held liable for minor variances of fluctuation in hardwood flooring materials.

CABINETRY: Due to the natural properties of wood, slight variations apparent with cabinetry are to be expected. This includes but not limited to wood species, wood grain, colour, finish, product variations, and natural imperfections are all factors that may affect the overall look of the finished product. Such factors make exact colour matching impossible. The type and intensity of lighting in the areas of designated cabinetry placement may also highlight characteristics of cabinetry finish. All cabinets shall be finished with a white melamine interior box unless a finished interior is upgraded. Due to building specifications and/or on-site conditions, certain cabinetry upgrades may not be possible. The purchaser acknowledges that the Builder cannot guarantee the cabinetry finish or provision of certain upgrades and shall not hold the Builder liable for provision of same.

UPGRADES/EXTRAS: All upgrades and additional selections indicated on the colour chart must be accompanied by an upgrades/extras sheet (PES) and full payment otherwise the selection will be invalid. All colour charts and upgrades/extras will not proceed until verified and signed by an authorized signing officer at the Vendor's head office. **CHANGES WILL NOT BE PERMITTED UPON COMPLETION AND SUBMISSION OF THE COLOUR CHART.**

Suite 239

APPLIANCE PACKAGE

2 Bedroom Suite
2 Bedroom + Den Suite

THE
BRANCH

PURCHASER NAME BILAL SHAIKH

PURCHASER NAME [Signature]

DATE 21 April 2022



24" Fridge
(Panel Ready)
GE - M2E9FPMKII



30" Range, Smooth top
Frigidaire CFEH3054U



30" Over The Range
Microwave
Frigidaire FFMV1846VS



24" Dishwasher
(Panel Ready)
GBT412SIM1



24" Washer
WM7200WW



24" Dryer
DV7600WW