

OAKVILLE - THE BRANCH
WORK ORDER FOR SELECTIONS

MODEL: CEDAR 830

SUITE: 332

WORK / PURCHASE ORDER

CUSTOM PACKAGE - MEDIUM (2) * All item below are applicable as per plan

*Cabinets		*Trim, Kitchen, Bathrooms	
Kitchen	Mosaic Maple - Timber Grey	Trim	Flat MDF 2-3/4" Casing X 5-1/4" Baseboard
Island *as per plan	N/A	Cabinet Handles	Standard
Master Ensuite	Mosaic Maple - Timber Grey ***Comfort Height	Kitchen Sink	KSS005 UNDERMOUNT SINK
Main	Mosaic Maple - Timber Grey ***Comfort Height	Kitchen Faucet	P7919LF MATTE BLACK, PULLDOWN FAUCET
*Countertops		Master Ensuite Sink	PS161C Undermount, rectangle
Kitchen	Emerstone Quartz Statuario - 1-1/2 Thick edge	Master Ensuite Faucet	Peerless P1519LF CHROME
Master Ensuite	Emerstone Quartz Statuario	Master Ensuite Tub	N/A
Main	Emerstone Quartz Statuario	Master Shower Faucet	Peerless PT14419 CHROME
*Tile/Hardwood		Master Ensuite Toilet	WC-382 WHITE, Elongated, Soft-Close, One Piece
Laminate Flooring	Highland Alderson Oak 8"	Main Bath Sink	PS161C Undermount, rectangle
Kitchen Bk.Splash	Colours & Dimensions Tender Grey Matte ***4 x 16 - Brick Layout	Main Bath Faucet	Peerless P1519LF CHROME
Laundry	Lily White Tile 12 x 12	Main Bath Tub	ADORA Skirted Tub
Master Glass Shower	Frameless Glass Shower	Main Tub Faucet	Peerless PT14419 CHROME
Mstr Ensuite Floor	Genesis Taupe 12 x 24	Main Toilet	WC-382 WHITE, Elongated, Soft-Close, One Piece
Mstr Ens. Shower Wall	Genesis Taupe 12 x 24 - Brick Layout	Fridge	SEE SPEC
Master Shower Fir	Volkas White Matte 2 x 2	Stove	SEE SPEC
Main Bath Floor	Genesis Taupe 12 x 24	Dishwasher	SEE SPEC
Main Bath Wall	Genesis Taupe 12 x 24 - Brick Layout	Microwave	SEE SPEC
		Washer/Dryer	SEE SPEC

LOCATION	DESCRIPTION OF UPGRADES	
KITCHEN	P7919LF MATTE BLACK, PULLDOWN FAUCET - Already paid for	
KITCHEN	KSS005 UNDERMOUNT SINK - Already paid for	
KITCHEN	Add Gable beside fridge in lieu of wall **See sketch**	
KITCHEN	Add deeper upper cabinets above fridge ** see new appliance specs**	
KITCHEN	Emerstone Quartz Statuario - 1-1/2 Thick edge	
Kitchen, Main & Ensuite	Mosaic Maple - Timber Grey	
Kitchen Bk.Splash	Colours & Dimensions Tender Grey Matte ***4 x 16 - Brick Layout	
Mstr Ens. Shower Wall	Genesis Taupe 12 x 24 - Brick Layout	
Master Ensuite		
Main Bath Wall	Genesis Taupe 12 x 24 - Brick Layout	
Master Ensuite	Comfort Height Vanity	
Main Bath	Comfort Height Vanity	
ZANCOR HOMES		

DISCLAIMER & CONDITIONS

FOR TRADE USE

Any upgrades in the colour chart must be accompanied with a PES. It is the responsibility of all Trades to inform the builder of any discrepancies on sketches, PES and/or colour charts PRIOR to installation.

→ Delete one wall - see sketch

* Appliance Specs Included

SCHEDULE "B"

To Agreement of Purchase and Sale
The Branch Condominiums
Oakville, ON

RESIDENTIAL SUITE

Suite Number: 332 Unit: 32 Level: 3

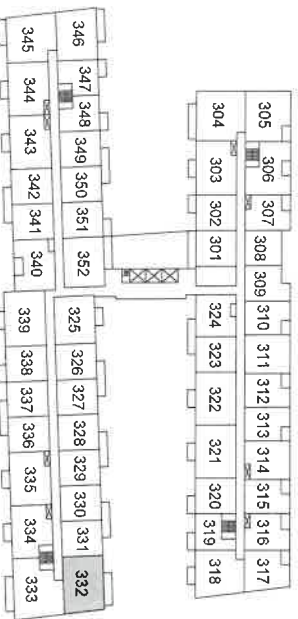
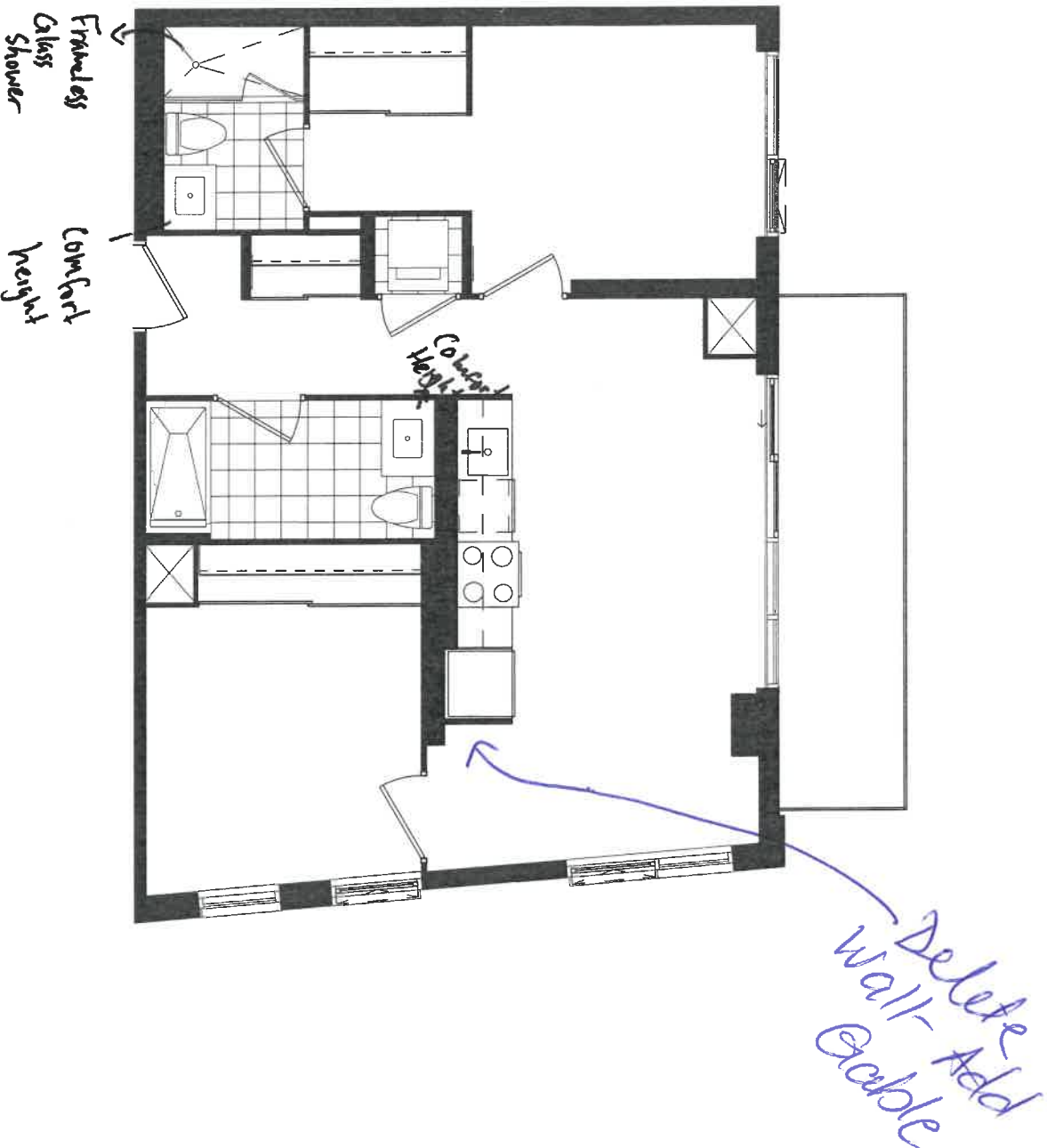

Vendor's Initial: _____ Purchaser's Initial: TS Date: May 4, 2022

This plan is not to scale and is subject to architectural review and revision, including without limitation, the Unit being constructed with a layout that is the reverse of that set out above. All details are approximate and subject to change without notice in order to comply with building site conditions and municipal, structural, and Vendor and/or architectural requirements. Balconies are exclusive use common elements, shown for display purposes only and location and size of such are subject to change without notice. Window location, size and type may vary without notice. E. & O. E.

CLIENT NAME: ZANCOR HOMES
SHIP TO: THE BRANCH

PH:
CELL:

DATE SUBMITTED
23 Oct 2021

DRAFTED BY: Binita

P/O#

JOB NUMBER: _____

INSTALL DATE: _____

PAGE 1 of 2

2B-D.2(BF) **x2**

332 Suite

KITCHEN

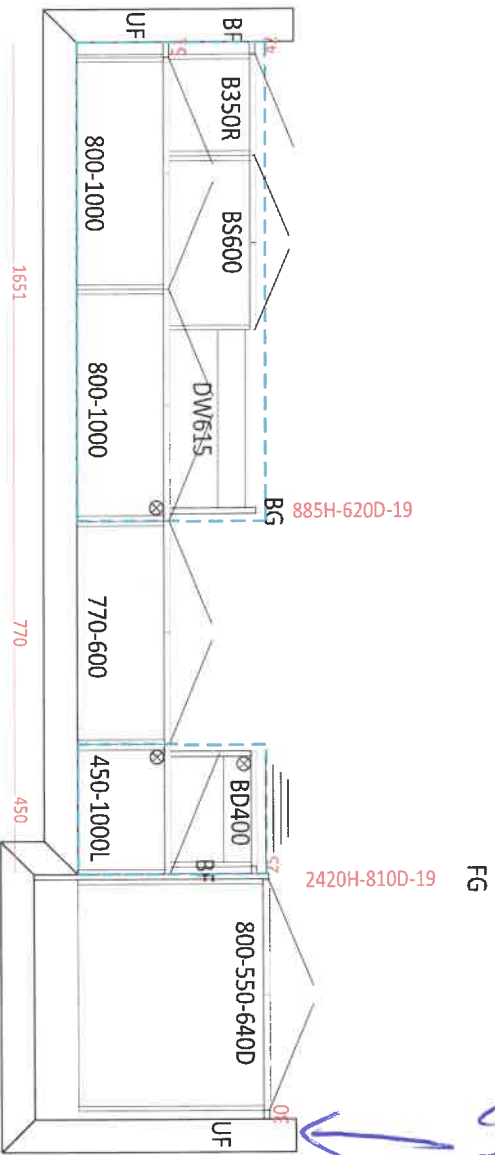

~~Wait~~
~~Add~~
~~Deep~~ ~~Upms~~ ~~Table~~

BDPQ: +1-3707

SUBMITTAL BDP.					
REVIEW					
Quadrangle					
PREPARED BY:	DATE:	RECEIVED AT OFFICE:	BY WHOM:	FOR WHAT PURPOSE:	
Robert J. Hillbill	10/19/87	X			

MAIN VANITY

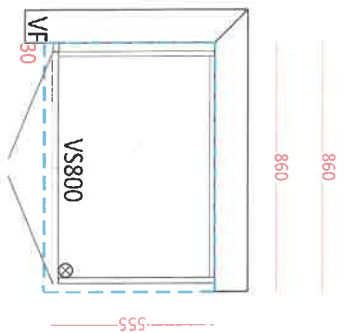

ENSUITE

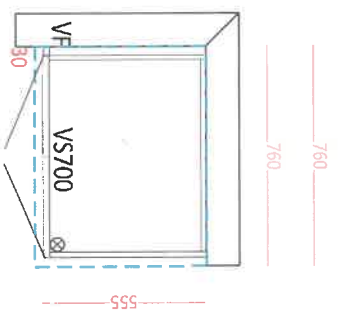

OAKVILLE

INTERIOR FINISHES ACKNOWLEDGEMENT

ZANCOR
HOMES

T-H
B R A N C H

The BRANCH - Oakville

SUITE: 332

DATE: May. 4/2022

INTERIOR FINISHES ACKNOWLEDGEMENT

Purchaser accepts and acknowledges that the Builder reserves the right to substitute materials with those of equal or better quality where the manufacture, scheduling or delivery of materials may directly impact the Builder's ability to meet its' contractual obligations under the Agreement of Purchase and Sale. The purchaser acknowledges and agrees to proceed forthwith with reselections in the event the original selections cannot be incorporated into the interior finishing of the home upon notice by the Builder.

Every effort will be made to ensure the materials selected are as close as possible to the samples provided, however due to variances in manufacturing and properties of natural materials we do not guarantee identical colour matching.

PORCELAIN & NATURAL STONES: Due to the properties of natural stones including but not limited to **marble, granite, quartz**, no two pieces are exactly the same. Variations in colour, tone, granularity (pitting, fissures) and patterns are to be expected, including various lighting may affect the overall finished look. Stone should never be cleaned with lemon oil or vinegar. The purchaser acknowledges colour and product variations as well as natural imperfections that may exist with the selection of natural stone materials and shall not hold the Vendor liable for provision of same.

STONE COUNTERTOP JOINTS: Purchaser is aware that one joint may be at each corner and on either side of slide-in-range (if applicable). It will also be where the length of the counter top exceeds the length of a stone slab. Slabs are usually approximately 5'x 8'.

TILES: Due to manufacturing, shade (dye lots), product variations may exist that can affect the overall look of the finished product. Although every effort will be made to ensure the colours and materials selected are as close as possible to the samples, the purchaser acknowledges that the sample tiles supplied in the Design Centre may not be identical to the materials installed in the home.

LAMINATE / HARDWOOD FLOORING: Due to the natural properties of wood & laminate, many variables can affect the overall look of the finished product. Variations include but not limited to wood type or laminate finish, colour/stain and wood grain are significant factors that make exact colour matching impossible. The purchaser acknowledges that the hardwood flooring and laminate is a pre-finished product in a controlled environment. Expansion, compression and cupping are characteristics of hardwood flooring once installed in the home. The purchaser acknowledges these may become apparent over time and despite the Builders' efforts to install the hardwood flooring materials in keeping with good workmanship, the Builder shall not be responsible nor held liable for minor variances of fluctuation in hardwood flooring materials.

CABINETRY: Due to the natural properties of wood, slight variations apparent with cabinetry are to be expected. This includes but not limited to wood species, wood grain, colour, finish, product variations, and natural imperfections are all factors that may affect the overall look of the finished product. Such factors make exact colour matching impossible. The type and intensity of lighting in the areas of designated cabinetry placement may also highlight characteristics of cabinetry finish. All cabinets shall be finished with a white melamine interior box unless a finished interior is upgraded. Due to building specifications and/or on-site conditions, certain cabinetry upgrades may not be possible. The purchaser acknowledges that the Builder cannot guarantee the cabinetry finish or provision of certain upgrades and shall not hold the Builder liable for provision of same.

UPGRADES/EXTRAS: All upgrades and additional selections indicated on the colour chart must be accompanied by an upgrades/extras sheet (PES) and full payment otherwise the selection will be invalid. All colour charts and upgrades/extras will not proceed until verified and signed by an authorized signing officer at the Vendor's head office. **CHANGES WILL NOT BE PERMITTED UPON COMPLETION AND SUBMISSION OF THE COLOUR CHART.**

The BRICK.
COMMERCIAL DIVISION



A Division of The Brick Warehouse LP

Specifications for Project

Peter

Salesperson

John Chua

jchua@thebrick.com



REMINDER:

To ensure a smooth project it is the responsibility of the homeowner / purchaser of appliances for this project to share all the attached specifications to ensure the cabinet provider, contractor, or any other tradesperson have all the information required to complete their work accurately.

Specifications are subject to change. If any tradesperson has questions regarding the attached specifications please contact our sales associate.

Powered by SteelCod

332

Full Spec Package

Peter



Contents	Page no.	
RF22A4221SR Samsung Refrigeration	3-4	The Brick Commercial Division/Midnorthern Appliance brickcommsales.com
22 cu. ft. Smart 3-Door French Door Refrigerator with External Water Dispenser in Fingerprint Resistant Stainless Steel		John Chua Regional Sales Manager 647-223-7031
NE63A6711SS Samsung Range	5-6	Search 20220727170233482SC Version 1.1
6.3 cu.ft. Freestanding Electric Range with True Convection and Air Fry		Wed, Jul 27, 2022 1:02 PM EDT
DW80R9950USAC Samsung Dishwasher	7-8	
ME11A7710DS/AC Samsung Microwave	9-10	 enterprise.steelcod.com/sp/brickZK4CEOH3
1.1 cu.ft. Low Profile Over the Range Microwave with 550CFM		

Note about page numbers:
Because the original manufacturer's documents are not altered in any way, the page numbers displayed on the page may not correspond to the page number within this package.

All specifications are intended for initial planning purposes only.
Manufacturers reserve the right to change specifications at any time without notice. Always consult the installation instructions found on the manufacturer's website or included with the appliances before installation.

332

RF22A422ISR

SAMSUNG

22 cu. ft. Smart 3-Door French Door Refrigerator with External Water Dispenser

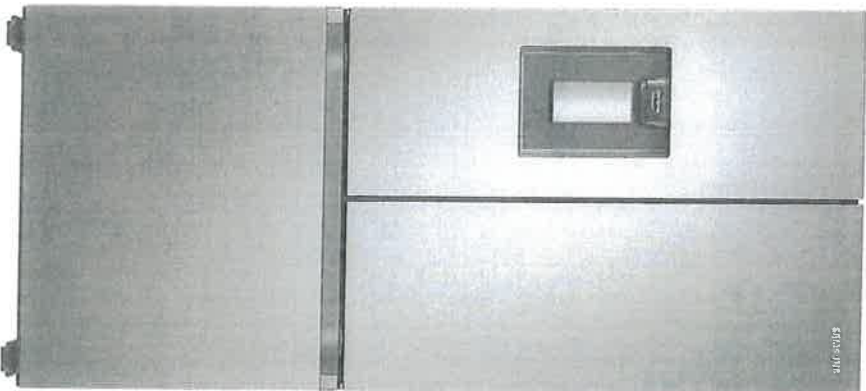

Signature Features

Modern Design

Clean lines and modern form blend beautifully into your kitchen.

External Water Dispenser

Easy access to chilled and filtered water with plenty of room to fill a large bottle.

Wi-Fi Connectivity

Use the Samsung SmartThings App¹ on your smartphone to control the temperature of your refrigerator and monitor it remotely.

¹Available on Android and iOS devices. A Wi-Fi connection and a Samsung account are required.

All-Around Cooling

Multi-vent technology keeps items evenly cooled on every shelf.

Available Colors

-  Fingerprint Resistant Stainless Steel (shown)
-  Fingerprint Resistant Black Stainless Steel

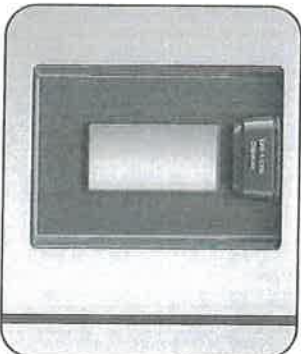

External Water Dispenser



Fingerprint Resistant Finish

Design

- Modern Design
- Fingerprint Resistant Finish
- Narrow 30" Width
- LED Lighting
- Gallon Door Bins
- 2 Humidity-Controlled Crispers
- CoolSelect Pantry™

Technology

- Wi-Fi Connectivity
- Door Alarm
- Power Cool & Power Freeze

Performance

- All-Around Cooling
- External Water Dispenser
- Automatic Ice Maker - Stores up to 6.6 lbs of ice

Rating

 ENERGY STAR® rated:
585 kWh/yr

 ADA Compliant

332

RF22A4221SR

SAMSUNG

22 cu. ft. Smart 3-Door French Door Refrigerator with External Water Dispenser

Installation Specifications

1. Measure the height, width and depth of the opening, making sure to include baseboards, molding tile, countertop overhang, etc. Check to be sure there is enough room to open the door (consider walls, islands or other obstacles when measuring).
2. Refer to illustration below to determine dimensions.
3. Allow 1½" of clearance on hinge side of refrigerator when installing next to a wall where door may make contact.
4. Allow 2" minimum clearance at rear for proper air circulation and water/electrical connections. Allow a ¾" minimum clearance at sides and top for ease of installation.
5. Ensure each door and entryway in the home is wide enough for the refrigerator to be moved through easily.

For optimal usage and ability to open refrigerator doors completely, do not install next to a wall.

Please note: The following dimension and cutout information is for planning purposes only. For complete installation details, consult manual packed with product or download manual online at samsung.com.

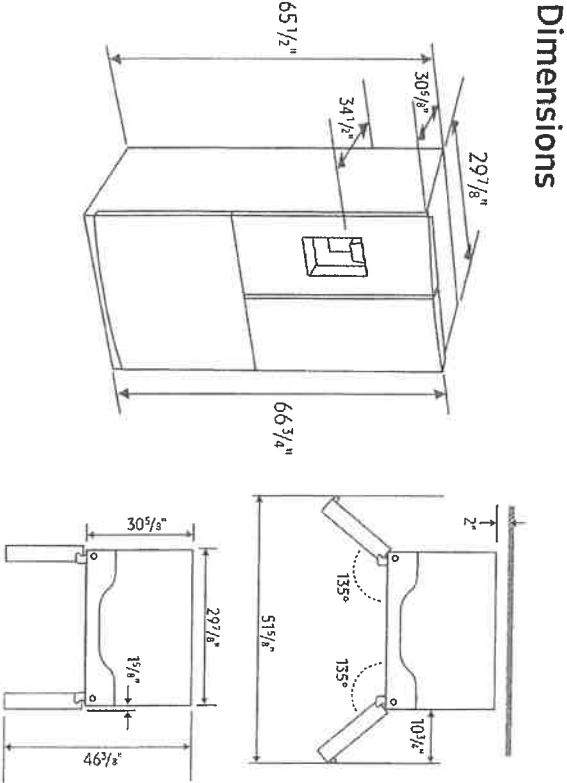
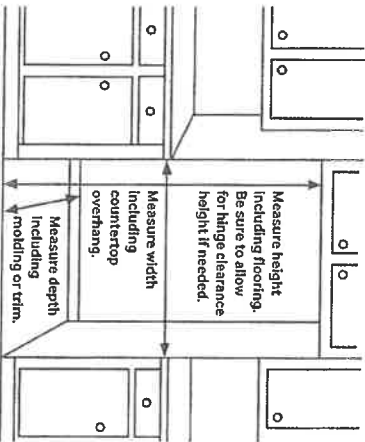

Dimensions

Total Capacity: 22.0 cu. ft.		
Refrigerator: 15.0 cu. ft.		
• External Water Dispenser		
• 3 Tempered Glass Spill-Proof Shelves		
• 2 Humidity-Controlled Crispers		
• CoolSelect Pantry™ Drawer		
• 6 Door Bins		
– Right Door: 1 Gallon Bin, 2 Regular Bins		
– Left Door: 3 Regular Bins		
• LED Lighting		
Freezer: 7 cu. ft.		
• Automatic Ice Maker		
• 1 Drawer Divider		
• LED Lighting		
Accessories		
Water Filter: HAF-QIN		
Warranty		
One (1) Year Parts and Labor on Refrigerator		
Five (5) Years Parts and Labor on		
Sealed Refrigeration System Only*		
Ten (10) Years Parts and Five (5) Years		
Labor on Digital Inverter Compressor		
*Compressor, evaporator, condenser, drier and connecting tubing.		
Product Dimensions & Weight		
Dimensions (WxHxD with hinges and doors):		
29 7/8" x 66 3/4" x 34 7/8"		
Dimensions (WxHxD without hinges and door):		
29 7/8" x 65 1/2" x 30 5/8"		
Weight: 227.7 lbs		
Shipping Dimensions & Weight (WxHxD)		
Dimensions: 30 1/2" x 71 7/8" x 36 1/4"		
Weight: 237.2 lbs		
Color	Model #	UPC Code
Fingerprint Resistant	RF22A4221SR	887276546049
Stainless Steel		
Fingerprint Resistant	RF22A4221SG	887276546032
Black Stainless Steel		

Actual color may vary. Design, specifications, and color availability are subject to change without notice. Non-metric weights and measurements are approximate.
©2027 Samsung Electronics America, Inc., 85 Challenger Road, Ridgefield Park, NJ 07660. Tel: 800-SAMSUNG, samsung.com. Samsung is a registered trademark of Samsung Electronics Co., Ltd.

332

NE63A671SS

SAMSUNG

6.3 cu. ft. True Convection Electric Range with Wi-Fi and Air Fry

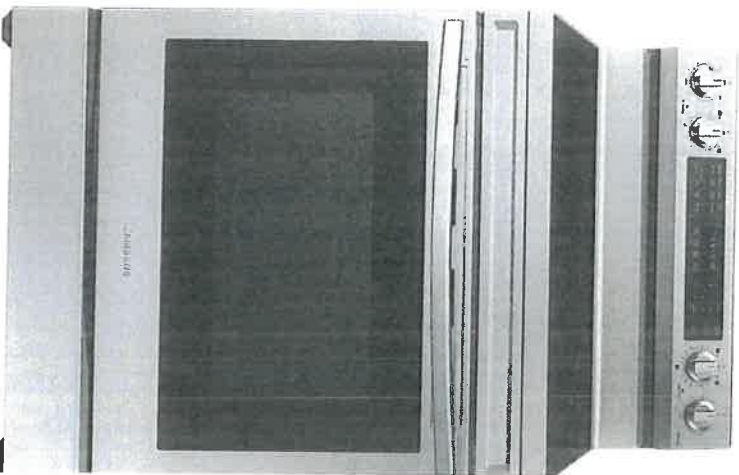

Signature Features

Air Fry

Enjoy better fried food with the Air Fry feature. With the provided Air Fry tray, the hot air circulation envelops the food placed on the tray.

Wi-Fi Connectivity and Voice Control

Monitor and control the oven using the SmartThings App¹. And control the oven with your voice using a voice assistant², such as Samsung Bixby³, Amazon Alexa or Google Assistant.

True Convection

A heated fan distributes heat all around the oven and keeps the temperature constant so dishes are cooked quickly and thoroughly.

Fingerprint Resistant Finish

Prevents surfaces from becoming covered in fingerprints and smudges.

Self Clean

A Self Cleaning system heats the cavity to a high temperature to burn off grease and food residue.

Available Colours



Stainless Steel (shown)



Black Stainless Steel

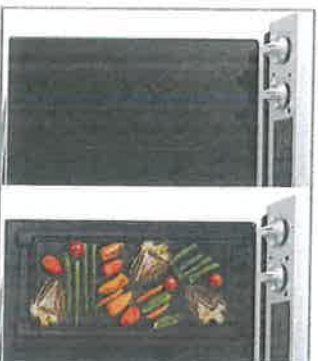

Bridge Element + Aluminum Griddle



Wi-Fi Connectivity and Voice Control

Features

- Flexible Cooktop
 - Five Electric Elements
 - 1 Triple Element (6" / 9" / 12")
 - 1 Bridge Element
 - 1 Single 6" Element
 - Warming Zone (7")

- Wide View Window
- Hidden Bake Element
- Storage Drawer
- Air Fry + Tray
- 2 Chrome Racks
- Flat Handle
- Aluminum Griddle

Convenience

- Wi-Fi Connectivity and Voice Control
- Delay Bake
- Hot Surface Indicator Light
- Auto Oven Light
- Kitchen Timer
- Fingerprint Resistant
- Self & Steam Clean
- Sabbath Mode
- Proofing
- Dehydrate

¹ Available on Android and iOS devices. A Wi-Fi connection and a Samsung account are required.

² A Wi-Fi connection is required.

³ Bixby is Samsung's brand of artificial intelligence (AI) / Internet of Things (IoT) voice assistant. A Samsung account is required.

232

NE63A671SS

SAMSUNG

6.3 cu. ft. True Convection Electric Range with Wi-Fi and Air Fry

Installation Specifications

IMPORTANT: To eliminate the risk of burns or fire caused by reaching over heated surface units, avoid having cabinet storage space located above the surface units. If you have cabinet storage space over the heating elements, you can reduce the risk by installing a range hood that projects horizontally a minimum of 5 inches beyond the bottom of the cabinets.

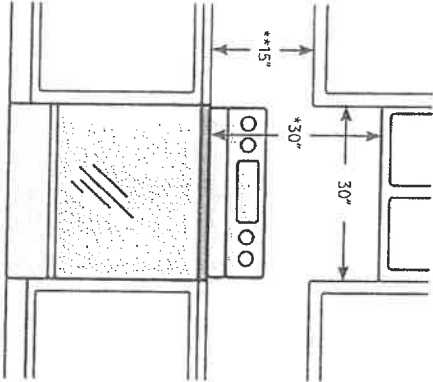

* A minimum of 30" is required between the top of the cooking surface and the bottom of an unprotected wood or metal cabinet; a minimum of 24" is required if the bottom of the wood or metal cabinet is protected by not less than 1/4" of flame retardant millboard covered with not less than no.28 MSG of sheet steel, 0.015" of stainless steel, 0.024" of aluminum, or 0.020" of copper.

** A minimum of 15" is required between the countertop and the adjacent cabinet bottom.

Dimensions

CAUTION: This range has been designed to comply with the maximum allowable wood cabinet temperature of 194 °F (90 °C). Make sure the wall covering, countertops, and cabinets around the range can withstand the heat (up to 194 °F (90 °C)) generated by the range. If not, discolouration, delamination, or melting may occur.

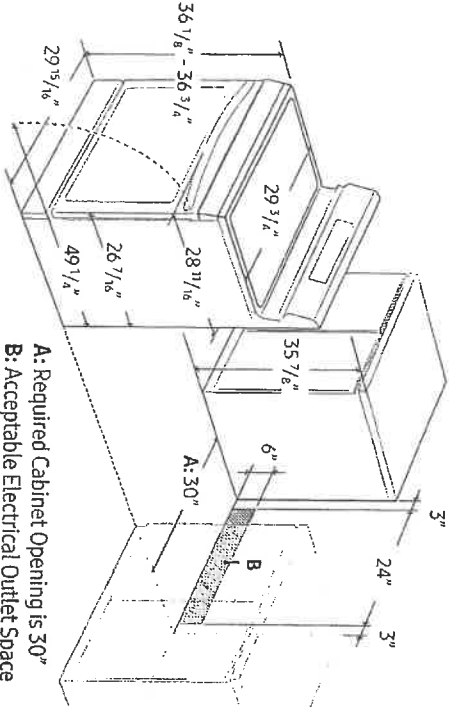

A: Required Cabinet Opening is 30"
B: Acceptable Electrical Outlet Space

Range Rating Watts		Specified Rating of Power-Supply-Cord Kit and Circuit Protection Amps	Diameter(Inches) of Range Connection Opening		Plug Type	Power Cord Length
120/240 Volts 3-Wire	120/208 Volts 3-Wire		Power Cord	Conduit		
8750-16500	7801-12500	40 or 50 A	1 3/8"	1 1/8"	4 Prong	39.4"

A range cord rated at 40 amps with 125/250 minimum volt range is required. A 50 amp range cord is not recommended but if used, it should be marked for use with nominal 1 3/8" diameter connection openings. Care should be taken to center the cable and strain relief within the knockout hole to keep the edge from damaging the cable.

Actual colour may vary. Design, specifications and colour availability are subject to change without notice. Non-metric weights and measurements are approximate.
© 2021 Samsung Electronics Canada Inc. All rights reserved. Samsung is a registered trademark of Samsung Electronics Co., Ltd., used with permission.

Shipping Dimensions & Weight (WxHxD)			
Dimensions: 33 1/16" x 50 9/16" x 30 5/16"			
Weight: 187.4 lbs (85 Kg)			
Colour	Model #	UPC Code	
Stainless Steel	NE63A671SS	887276509495	
Black Stainless Steel	NE63A671SG	887276509471	

Product Dimensions & Weight (WxHxD)
Cavity Dimensions: 24 13/16" x 22 7/16" x 19 3/4"
Net Dimensions: 29 15/16" x 46 5/16" - 47 1/16" x 26 7/16"
Weight: 163.8 lbs (74.3 Kg)

Storage Drawer
Capacity: 0.8 cu. ft.

Oven
Capacity: 6.3 cu. ft.
Hidden Bake Element: 3000W
Bake: 175°F -550°F
Broil: Low/High, 4200W
Sabbath Mode

Radiant Ceramic Cooktop
Right Front: 6" /9" /12" Triple Element, 3000W
Left Front: Bridge Element, 1800W
Right Rear: 6" Element, 1200W
Left Rear: Bridge Element, 1800W

232

DW80R9950US

SAMSUNG

Samsung AquaBlast™ 39 dBA Dishwasher

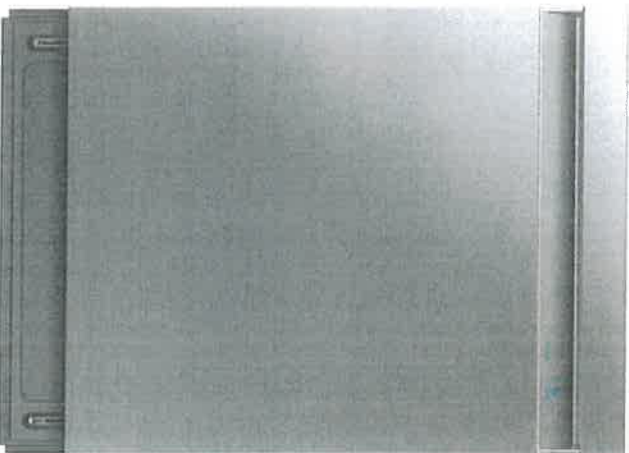

Signature Features

AquaBlast™ System

- AquaBlast™ jets provide corner-to-corner coverage for superb cleaning.

Flexible 3rd Rack

- The flexible 3rd rack provides extra space to load silverware. Use the adjustable section for oversized utensils.

Gliding Rail

- Enjoy effortless loading and unloading with this Samsung dishwasher. The rack is designed with a soft rail feature that glides in and out for greater comfort and less shaking. Whether under the strain of heavy pots and pans or cradling a delicate load of stemware, the rack pulls out smoothly.

Available Colours



Fingerprint Resistant
Stainless Steel (shown)



Fingerprint Resistant
Black Stainless Steel

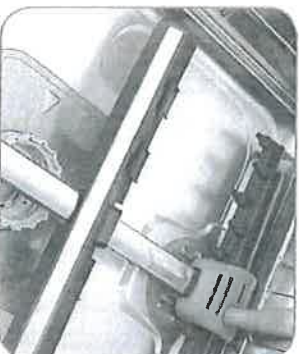

AquaBlast™ System

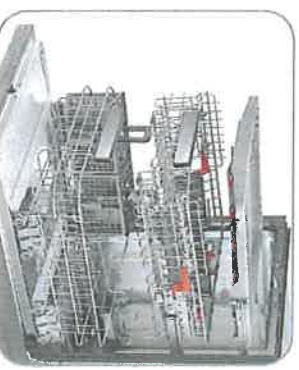

Flexible 3rd Rack

Features

- AquaBlast™ System
- Flexible 3rd Rack
- Gliding Rail
- Fingerprint Resistant Stainless Finish
- Zone Booster™
- Touch Control
- Quiet Operation: 39 dBA
- Wi-Fi Connectivity
- 7 Wash Cycles
- 8 Options
- Half-Load Cycle
- Express Cycle: 60 Minutes
- One-Touch Adjustable Racking System
- Full Stainless Steel Interior
- 15 Place Settings
- 3 Spray Wash Arms (Upper, Middle, Lower)
- AutoRelease™ Door

Convenience

- LED Time Display
- Control Lock
- Delay Start
- Digital Leak Sensor

Rating

ENERGY STAR®-rated:
239 kWh/yr

232

DW80R9950US

SAMSUNG

Samsung Aquablast™ 39 dBA Dishwasher

Installation Specifications

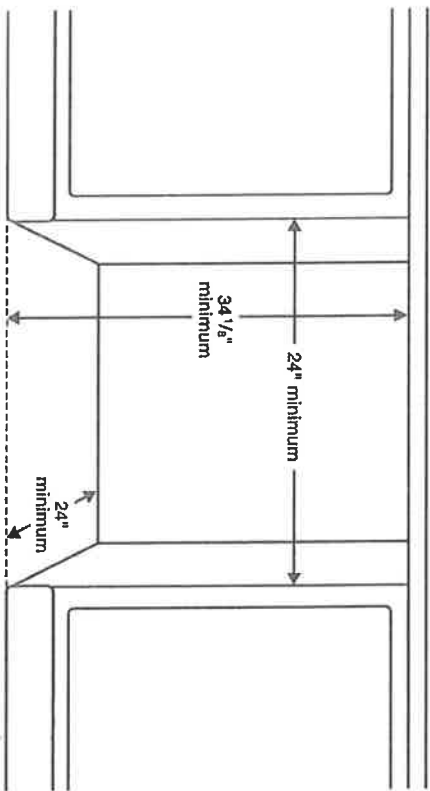

Dimensions

Side View

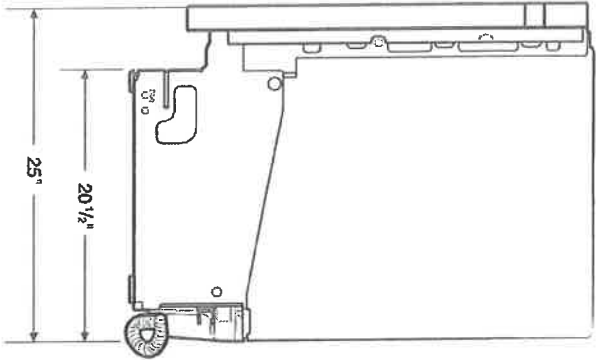

Rear View

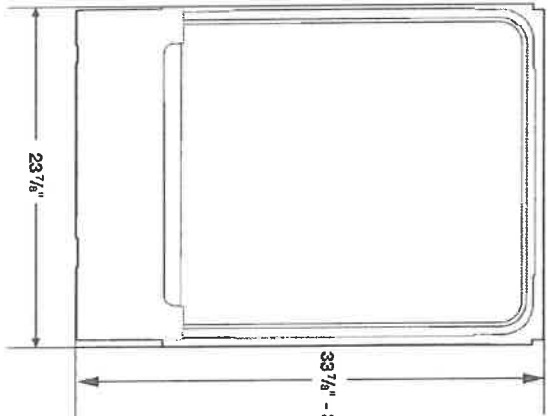

Features

- 7 Wash Cycles: Auto, Normal, Heavy, Delicate, Express 60, Rinse Only, Self Clean
- 8 Options: Half-Load Wash (Lower Rack), Zone Booster™ (Left), Speed Booster, Hi-Temp Wash, Sanitize (Anti-bacterial – NSF), Delay Start, Control Lock, Smart Control (Wi-Fi App)
- AutoRelease™ Door
- Hidden Heat Element
- Stainless Steel Interior Tub

Convenience

- Control Lock
- Digital Water Leakage Sensor
- Flexible Third Rack
- One-Touch Adjustable Racking System
- Silverware Basket
- Upper Rack: Foldable Cup Shelves, 2 Adjustable Tines
- Lower Rack: Fold-Down Tines

Warranty

One (1) Year All Parts and Labour
Five (5) Year Limited on Printed Circuit Board and Interior Nylon Racks
Five (5) Year Warranty on Linear Motion Parts
Lifetime on Stainless Steel Tub

Product Dimensions & Weight (WxHxD)

Dimensions (height is adjustable):
23 7/8" x 33 7/8" – 35" x 25"

Weight: 95 lbs

Shipping Dimensions & Weight (WxHxD)

Dimensions:
26" x 34 3/4" x 29 3/4"
Weight: 101 lbs

Colour	Model #	UPC Code
Fingerprint Resistant Stainless Steel	DW80R9950US	887276296654
Fingerprint Resistant Black Stainless Steel	DW80R9950UG	887276296630

Assets

Access DW80R9950US assets on Box.com -
<https://app.box.com/folder/65193082715>
DW80R9950UG -
<https://app.box.com/folder/65192686633>

If you do not have a BOX account, please email
boxinvites@cheil.com for access.

Actual colour may vary. Design, specifications, and colour availability are subject to change without notice. Non-metric weights and measurements are approximate.
© 2019 Samsung Electronics Canada Inc. All rights reserved. Samsung is a registered trademark of Samsung Electronics Co., Ltd. used with permission.

232

ME1A7710DS

SAMSUNG

1.1 cu. ft. Low Profile Over-the-Range Microwave

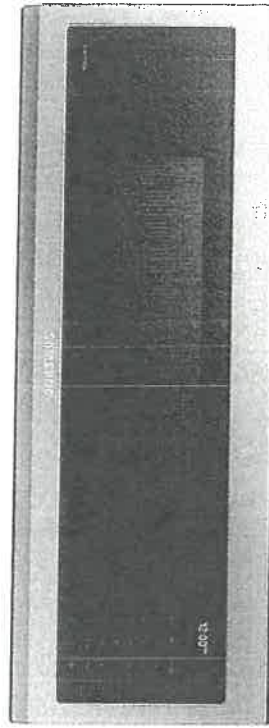

Signature Features

Space saving design

Accommodates a variety of snacks and meals. Enough room to accommodate everyday meals.

Powerful Suction

Powerful ventilation system that eliminates steam, fumes, and odour from the kitchen. Quiet system clears the air with 550 cubic feet per minute of turbo ventilation.

Effortless Control with Auto Hood Connectivity

Striking ice blue LED display provides a stylish accent to enhance any kitchen interior. Time and setting are clearly visible for greater cooking convenience.

Available Colours



Stainless Steel



Black Stainless Steel

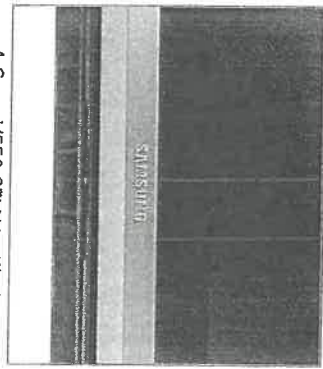

4-Speed/550 CFM Ventilation

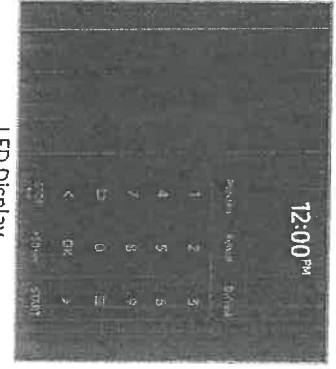

LED Display

Features

- 1.1 cu. ft. Microwave Capacity
- 4-Speed/550 CFM Ventilation
- System LED Display
- Cooking Presets
- Eco Mode
- Auto Connectivity

Convenience

- Wi-Fi
- Voice Control
- SmartThings Cooking
- Vent Fan Control: On/Off

0334

ME1A7710DS

SAMSUNG

1.1 cu. ft. Low Profile Over-the-Range Microwave

Dimensions

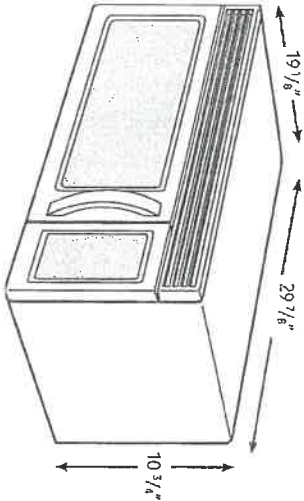

Specifications:

- Power Output: 1000 W
- Power Consumption: 1,500 W
- Power Source: 120V/60 Hz
- Plug Type: 3 prong plug
- Power Cord Length: 1 m
- Control Method: Digital Glass Touch
- Display: LED
- Cooking Control: 10 power levels including defrost
- Cooking Timer: Digital, up to 99 minutes, 99 seconds
- Microwave Distribution System: Turntable
- Vent Fan: 550 CFM
- Vent Fan Control: On/Off

Warranty

- One (1) Year Parts and Labour
- Five (5) Years Parts on Magnetron

Product Dimensions & Weight (WxHxD)

- Dimensions: 29 7/8" x 10 3/4" x 19 1/8"
- Dimensions (without filter): 29 7/8" x 15 5/8" x 16 1/2"
- Cavity Dimensions: 18 1/2" x 6 15/16" x 14 15/16"
- Weight: 55.8 lbs (25.3 kg)

Shipping Dimensions & Weight (WxHxD)

- Dimensions: 35 1/5" x 15 2/5" x 22 1/10"
- Weight: 65.3 lbs (29.6 kg)

Colour	Model #	UPC
Stainless Steel	ME1A7710DS/AC	887276582153
Black Stainless Steel	ME1A7710DG/AC	887276582146

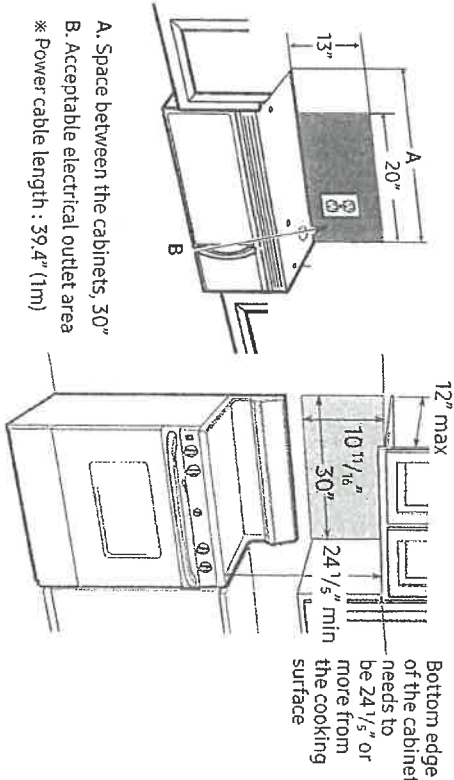

This microwave oven is designed for adaptation to the following three types of ventilation:

- A. Outside Top Exhaust (Vertical Duct)
- B. Recirculating (Non-Vented Ductless)
- C. Outside Back Exhaust (Horizontal Duct)
- The space between the cabinets must be 30" wide and free of obstructions.
- This microwave oven is for installation over ranges up to 36" wide.
- If you are going to vent your microwave oven to the outside, see the Hood Exhaust Section for exhaust duct preparation.

FOR EASIER INSTALLATION AND PERSONAL SAFETY, WE RECOMMEND THAT TWO PEOPLE INSTALL THIS MICROWAVE OVEN.

CAUTION: For personal safety, remove the house fuse or open the circuit breaker before beginning the installation to avoid severe or fatal shock injury.

CAUTION: For personal safety, the mounting surface must be capable of supporting the cabinet load in addition to the added weight of this 69 pound product, plus additional oven loads of up to 50 pounds or a total weight of 109 pounds.

CAUTION: For personal safety, do not install this product in cabinetry configured as an island or a peninsula. The microwave oven must be mounted to BOTH a top cabinet AND a wall.

Actual colour may vary. Design, specifications and colour availability are subject to change without notice. Non-metric weights and measurements are approximate.
© 2021 Samsung Electronics Canada Inc. All rights reserved. Samsung is a registered trademark of Samsung Electronics Co., Ltd., used with permission.

1528



Suite # 332

WORK ORDER

SEP 28 2022
Date: _____

Re: Zancor Oakville Ltd.
221 North Rivermede Road
Concord, Ontario L4K 3N7
Cost Code: _____

1. Zancor Oakville Ltd. (the “Owner”), issues this Work Order to enter into a contract (the “Contract”) with **TECHNICAL GLASS** for Supply and Installation of the following purchase upgrades (the “Works”) for the Project located at 2450 Old Bronte Road, Oakville, Ontario for the contract price of **see attached** (the “Contract Price”). The Owner and **TECHNICAL GLASS** are collectively referred to as the “Parties” and individually as a “Party”.
2. If **TECHNICAL GLASS** agrees with the terms set forth above and wishes to proceed with executing the Contract, it should sign this Work Order in the space provided below for “Acknowledgement and Acceptance” and return an executed copy to the attention of Melanie Worsdale at melanie@zancorhomes.com.
3. Upon signing this Work Order, **TECHNICAL GLASS** is to submit the following documentation to the attention of Melanie Worsdale at melanie@zancorhomes.com
4. If applicable:
 - i. WSIB clearance certificate
 - ii. Proof of insurance coverage
 - iii. Progress billing breakdown/Schedule of values
 - iv. HST number
 - v. A completed Registration of Constructors and Employers Engaged in Construction form
 - vi. Safety policy
 - vii. Name and contact information for the individual responsible for accounts receivable
 - viii. Statutory declaration

Trusting the above is in order.

Per: Anthony Pignetti _____
Title: Director

Acknowledgement and Acceptance:

_____ acknowledges receipt of the subject work order and any related enclosures or documents incorporated by reference.
_____ accepts the subject work order and all related enclosures and documents incorporated by reference and agrees to enter the Contract with the Owner prior to the commencement of the Work.

Print Name _____ Title _____

Signature _____ Date _____



Suite #

332

WORK ORDER

SEP 28 2022
Date: _____

Re: Zancor Oakville Ltd.
221 North Rivermede Road
Concord, Ontario L4K 3N7
Cost Code: _____

1. Zancor Oakville Ltd. (the "Owner"), issues this Work Order to enter into a contract (the "Contract") with **AV CLASSIC** for Supply and Installation of the following purchase upgrades (the "Works") for the Project located at 2450 Old Bronte Road, Oakville, Ontario for the contract price of **see attached** (the "Contract Price"). The Owner and **AV CLASSIC** are collectively referred to as the "Parties" and individually as a "Party".
2. If **AV CLASSIC** agrees with the terms set forth above and wishes to proceed with executing the Contract, it should sign this Work Order in the space provided below for "Acknowledgement and Acceptance" and return an executed copy to the attention of Melanie Worsdale at melanie@zancorhomes.com.
3. Upon signing this Work Order, **AV CLASSIC** is to submit the following documentation to the attention of Melanie Worsdale at melanie@zancorhomes.com
4. If applicable:
 - i. WSIB clearance certificate
 - ii. Proof of insurance coverage
 - iii. Progress billing breakdown/Schedule of values
 - iv. HST number
 - v. A completed Registration of Constructors and Employers Engaged in Construction form
 - vi. Safety policy
 - vii. Name and contact information for the individual responsible for accounts receivable
 - viii. Statutory declaration

Trusting the above is in order.

Per: Anthony Pignetti _____
Title: Director _____

Acknowledgement and Acceptance:

_____ acknowledges receipt of the subject work order and any related enclosures or documents incorporated by reference.

_____ accepts the subject work order and all related enclosures and documents incorporated by reference and agrees to enter the Contract with the Owner prior to the commencement of the Work.

Print Name _____

Title _____

Signature _____

Date _____

Suite #

332



WORK ORDER

Date SEP 28 2022

Re: Zancor Oakville Ltd.
221 North Rivermede Road
Concord, Ontario L4K 3N7
Cost Code: _____

1. Zancor Oakville Ltd. (the “Owner”), issues this Work Order to enter into a contract (the “Contract”) with **CONNOLLY MARBLE & GRANITE LTD.** for Supply and Installation of the following purchase upgrades (the “Works”) for the Project located at 2450 Old Bronte Road, Oakville, Ontario for the contract price of **see attached** (the “Contract Price”). The Owner and **CONNOLLY MARBLE & GRANITE LTD.** are collectively referred to as the “Parties” and individually as a “Party”.
2. If **CONNOLLY MARBLE & GRANITE LTD.** agrees with the terms set forth above and wishes to proceed with executing the Contract, it should sign this Work Order in the space provided below for “Acknowledgement and Acceptance” and return an executed copy to the attention of Melanie Worsdale at melanie@zancorhomes.com.
3. Upon signing this Work Order, **CONNOLLY MARBLE & GRANITE LTD.** is to submit the following documentation to the attention of Melanie Worsdale at melanie@zancorhomes.com
4. If applicable:
 - i. WSIB clearance certificate
 - ii. Proof of insurance coverage
 - iii. Progress billing breakdown/Schedule of values
 - iv. HST number
 - v. A completed Registration of Constructors and Employers Engaged in Construction form
 - vi. Safety policy
 - vii. Name and contact information for the individual responsible for accounts receivable
 - viii. Statutory declaration

Trusting the above is in order.

Per: Anthony Pignetti _____
Title: Director

Acknowledgement and Acceptance:

_____ acknowledges receipt of the subject work order and any related enclosures or documents incorporated by reference.

_____ accepts the subject work order and all related enclosures and documents incorporated by reference and agrees to enter the Contract with the Owner prior to the commencement of the Work.

Print Name _____

Title _____

Signature _____

Date _____



Suite #332

WORK ORDER

SEP 7 8 2022

Date: _____

Re: Zancor Oakville Ltd.
221 North Rivermede Road
Concord, Ontario L4K 3N7
Cost Code: _____

1. Zancor Oakville Ltd. (the “Owner”), issues this Work Order to enter into a contract (the “Contract”) with **NEW IMAGE KITCHENS** for Supply and Installation of the following purchase upgrades (the “Works”) for the Project located at 2450 Old Bronte Road, Oakville, Ontario for the contract price of **see attached** (the “Contract Price”). The Owner and **NEW IMAGE KITCHENS** are collectively referred to as the “Parties” and individually as a “Party”.
2. If **NEW IMAGE KITCHENS** agrees with the terms set forth above and wishes to proceed with executing the Contract, it should sign this Work Order in the space provided below for “Acknowledgement and Acceptance” and return an executed copy to the attention of Melanie Worsdale at melanie@zancorhomes.com.
3. Upon signing this Work Order, **NEW IMAGE KITCHENS** is to submit the following documentation to the attention of Melanie Worsdale at melanie@zancorhomes.com
4. If applicable:

i. WSIB clearance certificate

ii. Proof of insurance coverage

iii. Progress billing breakdown/Schedule of values

iv. HST number

v. A completed Registration of Constructors and Employers Engaged in Construction form

vi. Safety policy

vii. Name and contact information for the individual responsible for accounts receivable

viii. Statutory declaration

Trusting the above is in order.

Per: Anthony Pignetti
Title: Director

Acknowledgement and Acceptance:

_____ acknowledges receipt of the subject work order and any related enclosures or documents incorporated by reference.

_____ accepts the subject work order and all related enclosures and documents incorporated by reference and agrees to enter the Contract with the Owner prior to the commencement of the Work.

Print Name _____ Title _____

Signature _____ Date _____



Suite # 392

WORK ORDER

Date: SEP 28 2022

Re: Zancor Oakville Ltd.
221 North Rivermede Road
Concord, Ontario L4K 3N7
Cost Code: _____

1. Zancor Oakville Ltd. (the "Owner"), issues this Work Order to enter into a contract (the "Contract") with **MALEAR** for Supply and Installation of the following purchase upgrades (the "Works") for the Project located at 2450 Old Bronte Road, Oakville, Ontario for the contract price of **see attached** (the "Contract Price"). The Owner and **MALEAR** are collectively referred to as the "Parties" and individually as a "Party".
2. If **MALEAR** agrees with the terms set forth above and wishes to proceed with executing the Contract, it should sign this Work Order in the space provided below for "Acknowledgement and Acceptance" and return an executed copy to the attention of Melanie Worsdale at melanie@zancorhomes.com.

3. Upon signing this Work Order, **MALEAR** is to submit the following documentation to the attention of Melanie Worsdale at melanie@zancorhomes.com
4. If applicable:
- i. WSIB clearance certificate
 - ii. Proof of insurance coverage
 - iii. Progress billing breakdown/Schedule of values
 - iv. HST number
 - v. A completed Registration of Constructors and Employers Engaged in Construction form
 - vi. Safety policy
 - vii. Name and contact information for the individual responsible for accounts receivable
 - viii. Statutory declaration

Trusting the above is in order.

Per: Anthony Pignetti _____
Title: Director

Acknowledgement and Acceptance:

_____ acknowledges receipt of the subject work order and any related enclosures or documents incorporated by reference.

_____ accepts the subject work order and all related enclosures and documents incorporated by reference and agrees to enter the Contract with the Owner prior to the commencement of the Work.

Print Name _____

Title _____

Signature _____

Date _____

CANTRIO KONCEPTS
AFFORDABLE LUXURY

KSS-005

FEATURES:

- * Sink Size: 23" x 18" x 10 1/4"
- * Material: 304 Stainless Steel, 18 Gauge
- * Single Basin Undermount 0 Radius Sink
- * Handmade construction
- * High Luster finish
- * Strainer Drain Provided
- * Warranty: Limited Lifetime Warranty

CODES / STANDARDS APPLICABLE

- * CSA B45
- * ASME A112.19.2

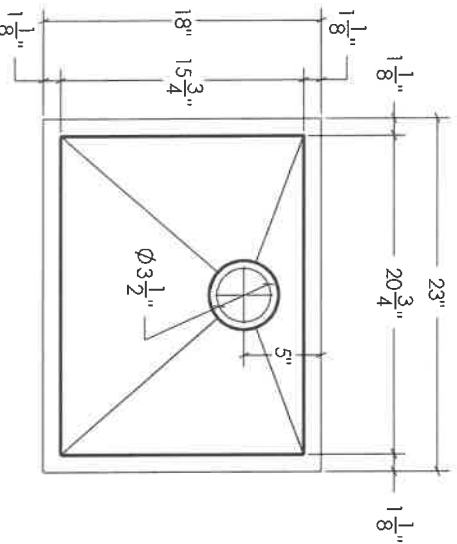

TOP VIEW

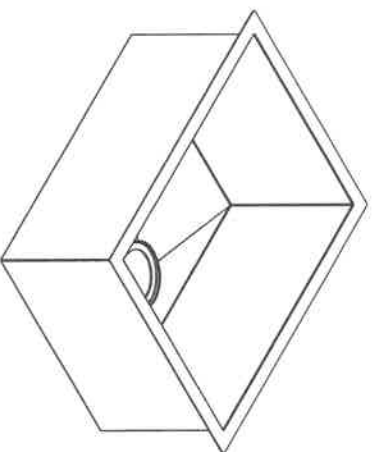

3D VIEW

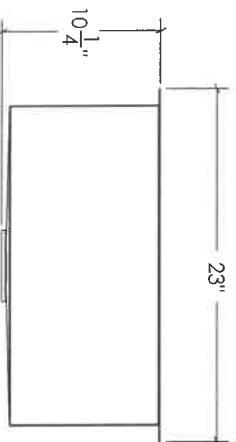

FRONT VIEW

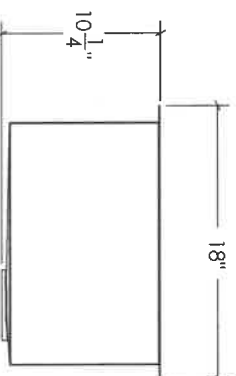

SIDE VIEW

JOB INFORMATION:

Job Name _____
Date Specified _____
Contractor _____

* Specifications and drawings provided on this sheet are for illustration only. Cantrio Concepts will not be held responsible for cutouts made without the actual product or product template.