

OAKVILLE - THE BRANCH WORK ORDER FOR SELECTIONS

MODEL:		SUITE:	612
--------	--	--------	-----

WORK / PURCHASE ORDER

STANDARD PACKAGE - LIGHT (1) * All item below are applicable as per plan

* Cabinets	
Kitchen	Sierra White PVC
Island *as per plan	N/A
Master Ensuite	Sierra White PVC
Main	Sierra White PVC
*Countertops	
Kitchen	Emerstone Quartz Carrara White 1-1/2 Edge
Master Ensuite	Emerstone Quartz Carrara White
Main	Emerstone Quartz Carrara White
*Tile/Hardwood	
Laminate Flooring	Highland Willowbrook Oak 8 Inch
Kitchen Bk.Splash	FULL SLAB - Emerstone Quartz Carrara White
Laundry	Lily White Tile 12 x 12
Master Glass Shower	FRAMELESS GLASS SHOWER
Master Ensuite Floor	Genesis Light Grey 12 x 24
Master Ensuite Shower Wall	Genesis Light Grey 12 x 24
Master Shower Flr	Volkas White Matte 2 x 2
Main Bath Floor	Genesis Light Grey 12 x 24
Main Bath Wall	Genesis Light Grey 12 x 24
*Trim, Kitchen, Bathrooms	
Trim	Flat MDF 2-3/4" Casing X 5-1/4" Baseboard
Cabinet Handles	Standard
Kitchen Sink	KSS005 UNDERMOUNT SS SINK w/SQUARE CORNERS
Kitchen Faucet	Peerless P79J9LF CHROME, Pulldown Faucet
Master Ensuite Sink	PS161C Undermount, rectangle
Master Ensuite Faucet	Peerless P15J9LF CHROME
Master Ensuite Tub	
Master Shower Faucet	Peerless PT14419 CHROME
Master Ensuite Toilet	WC-382 WHITE, Elongated, Soft-Close, One Piece
Main Bath Sink	PS161C Undermount, rectangle
Main Bath Faucet	Peerless P15J9LF CHROME
Main Bath Tub	ADORA Skirted Tub
Main Tub Faucet	Peerless PT14419 CHROME
Main Toilet	WC-382 WHITE, Elongated, Soft-Close, One Piece
Fridge	SEE SPEC
Stove	SEE SPEC
Dishwasher	SEE SPEC
Microwave	SEE SPEC
Washer/Dryer	SEE SPEC

[illegible]

DISCLAIMER & CONDITIONS

FOR TRADE USE

Any upgrades in the colour chart must be accompanied with a PES. It is the responsibility of all Trades to inform the builder of any discrepancies on sketches, PES and/or colour charts PRIOR to installation.

SCHEDULE "B"

To Agreement of Purchase and Sale
The Branch Condominiums
Oakville, ON

Suite Number: 612 Unit: 12 Level: 6

RESIDENTIAL SUITE

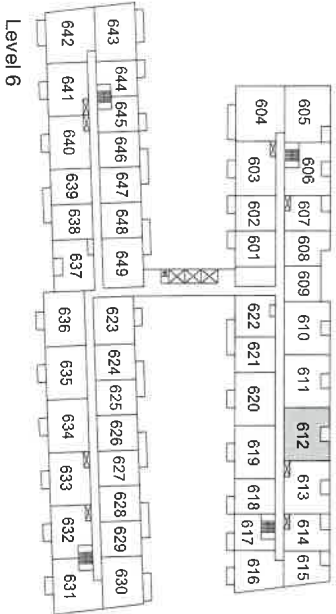

Vendor's Initial: _____

Purchaser's Initial: _____

Date: _____

This plan is not to scale and is subject to architectural review and revision, including without limitation, the Unit being constructed with a layout that is the reverse of that set out above. All details are approximate and subject to change without notice in order to comply with building site conditions and municipal, structural, and Vendor and/or architectural requirements. Balconies are exclusive use common elements, shown for display purposes only and location and size of such are subject to change without notice. Window location, size and type may vary without notice. E. & O. E.

Suite 612

APPLIANCE PACKAGE

2 Bedroom Suite
2 Bedroom + Den Suite

THE
BRANCH

PURCHASER NAME Navin Lobo

PURCHASER Initial NL

DATE July 26/22



24" Fridge
(Panel Ready)
GE - M2E9FPMKII



30" Range, Smooth top
Frigidaire CFEH3054U



30" Over The Range
Microwave
Frigidaire FFMV1846VS



24" Dishwasher
(Panel Ready)
GBT412SIM1



24" Washer
WM7200WW



24" Dryer
DV7600WW

OAKVILLE

INTERIOR FINISHES ACKNOWLEDGEMENT

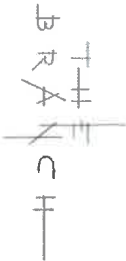

The BRANCH - Oakville

SUITE:

612

DATE:

July 26/22

INTERIOR FINISHES ACKNOWLEDGEMENT

Purchaser accepts and acknowledges that the Builder reserves the right to substitute materials with those of equal or better quality where the manufacture, scheduling or delivery of materials may directly impact the Builder's ability to meet its' contractual obligations under the Agreement of Purchase and Sale. The purchaser acknowledges and agrees to proceed forthwith with reselections in the event the original selections cannot be incorporated into the interior finishing of the home upon notice by the Builder.

Every effort will be made to ensure the materials selected are as close as possible to the samples provided, however due to variances in manufacturing and properties of natural materials we do not guarantee identical colour matching.

PORCELAIN & NATURAL STONES: Due to the properties of natural stones including but not limited to **marble, granite, quartz**, no two pieces are exactly the same. Variations in colour, tone, granularity (pitting, fissures) and patterns are to be expected, including various lighting may affect the overall finished look. Stone should never be cleaned with lemon oil or vinegar. The purchaser acknowledges colour and product variations as well as natural imperfections that may exist with the selection of natural stone materials and shall not hold the Vendor liable for provision of same.

STONE COUNTERTOP JOINTS: Purchaser is aware that one joint may be at each corner and on either side of slide-in-range (if applicable). It will also be where the length of the counter top exceeds the length of a stone slab. Slabs are usually approximately 5' x 8'.

TILES: Due to manufacturing, shade (dye lots), product variations may exist that can affect the overall look of the finished product. Although every effort will be made to ensure the colours and materials selected are as close as possible to the samples, the purchaser acknowledges that the sample tiles supplied in the Design Centre may not be identical to the materials installed in the home.

LAMINATE / HARDWOOD FLOORING: Due to the natural properties of wood & laminate, many variables can affect the overall look of the finished product. Variations include but not limited to wood type or laminate finish, colour/stain and wood grain are significant factors that make exact colour matching impossible. The purchaser acknowledges that the hardwood flooring and laminate is a pre-finished product in a controlled environment. Expansion, compression and cupping are characteristics of hardwood flooring once installed in the home. The purchaser acknowledges these may become apparent over time and despite the Builders' efforts to install the hardwood flooring materials in keeping with good workmanship, the Builder shall not be responsible nor held liable for minor variances of fluctuation in hardwood flooring materials.

CABINETRY: Due to the natural properties of wood, slight variations apparent with cabinetry are to be expected. This includes but not limited to wood species, wood grain, colour, finish, product variations, and natural imperfections are all factors that may affect the overall look of the finished product. Such factors make exact colour matching impossible. The type and intensity of lighting in the areas of designated cabinetry placement may also highlight characteristics of cabinetry finish. All cabinets shall be finished with a white melamine interior box unless a finished interior is upgraded. Due to building specifications and/or on-site conditions, certain cabinetry upgrades may not be possible. The purchaser acknowledges that the Builder cannot guarantee the cabinetry finish or provision of certain upgrades and shall not hold the Builder liable for provision of same.

UPGRADES/EXTRAS: All upgrades and additional selections indicated on the colour chart must be accompanied by an upgrades/extras sheet (PES) and full payment otherwise the selection will be invalid. All colour charts and upgrades/extras will not proceed until verified and signed by an authorized signing officer at the Vendor's head office. **CHANGES WILL NOT BE PERMITTED UPON COMPLETION AND SUBMISSION OF THE COLOUR CHART.**

CANTRIO KONCEPTS
AFFORDABLE LUXURY

KSS-005

FEATURES:

- * Sink Size: 23" x 18" x 10 1/4"
- * Material: 304 Stainless Steel, 18 Gauge
- * Single Basin Undermount 0 Radius Sink
- * Handmade construction
- * High Luster finish
- * Strainer Drain Provided
- * Warranty: Limited Lifetime Warranty



CODES / STANDARDS APPLICABLE

- * CSA B45
- * ASME A112.19.2

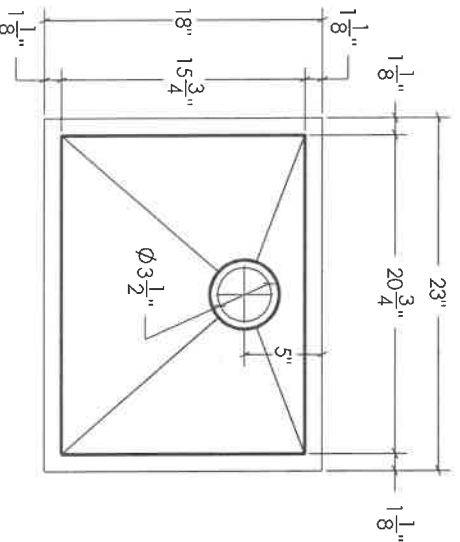

TOP VIEW

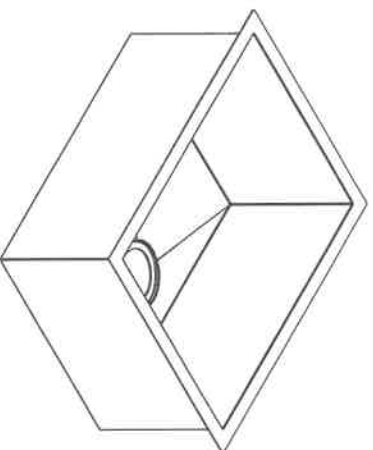

3D VIEW

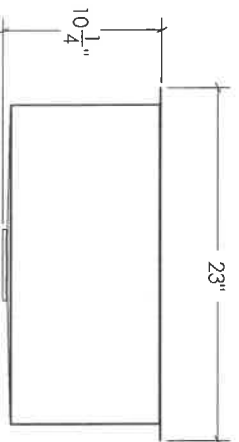

FRONT VIEW

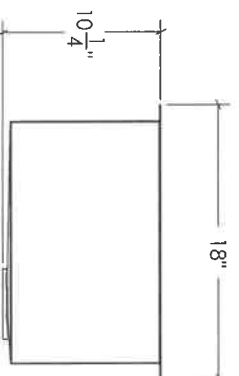

SIDE VIEW

JOB INFORMATION:

Job Name _____
Date Specified _____
Contractor _____

* Specifications and drawings provided on this sheet are for illustration only. Cantrio Koncepts will not be held responsible for cutouts made without the actual product or product template.

612



Suite #

612

WORK ORDER

Date: Aug 04, 2022

Re: Zancor Oakville Ltd.
221 North Rivermede Road
Concord, Ontario L4K 3N7
Cost Code: _____

1. Zancor Oakville Ltd. (the "Owner"), issues this Work Order to enter into a contract (the "Contract") with **TECHNICAL GLASS** for Supply and Installation of the following purchase upgrades (the "Works") for the Project located at 2450 Old Bronte Road, Oakville, Ontario for the contract price of **see attached** (the "Contract Price"). The Owner and **TECHNICAL GLASS** are collectively referred to as the "Parties" and individually as a "Party".
2. If **TECHNICAL GLASS** agrees with the terms set forth above and wishes to proceed with executing the Contract, it should sign this Work Order in the space provided below for "Acknowledgement and Acceptance" and return an executed copy to the attention of Melanie Worsdale at melanie@zancorhomes.com.
3. Upon signing this Work Order, **TECHNICAL GLASS** is to submit the following documentation to the attention of Melanie Worsdale at melanie@zancorhomes.com
4. If applicable:
 - i. WSIB clearance certificate
 - ii. Proof of insurance coverage
 - iii. Progress billing breakdown/Schedule of values
 - iv. HST number
 - v. A completed Registration of Constructors and Employers Engaged in Construction form
 - vi. Safety policy
 - vii. Name and contact information for the individual responsible for accounts receivable
 - viii. Statutory declaration

Trusting the above is in order.

Per: Anthony Pignetti _____
Title: Director

Acknowledgement and Acceptance:

_____ acknowledges receipt of the subject work order and any related enclosures or documents incorporated by reference.

_____ accepts the subject work order and all related enclosures and documents incorporated by reference and agrees to enter the Contract with the Owner prior to the commencement of the Work.

Print Name _____

Title _____

Signature _____

Date _____



Suite # 612

WORK ORDER AUG 04 2022

Re: Zancor Oakville Ltd.
221 North Rivermede Road
Concord, Ontario L4K 3N7
Cost Code: _____

Date: _____

1. Zancor Oakville Ltd. (the "Owner"), issues this Work Order to enter into a contract (the "Contract") with **CONNOLLY MARBLE & GRANITE LTD.** for Supply and Installation of the following purchase upgrades (the "Works") for the Project located at 2450 Old Bronte Road, Oakville, Ontario for the contract price of **see attached** (the "Contract Price"). The Owner and **CONNOLLY MARBLE & GRANITE LTD.** are collectively referred to as the "Parties" and individually as a "Party".
2. If **CONNOLLY MARBLE & GRANITE LTD.** agrees with the terms set forth above and wishes to proceed with executing the Contract, it should sign this Work Order in the space provided below for "Acknowledgement and Acceptance" and return an executed copy to the attention of Melanie Worsdale at melanie@zancorhomes.com.
3. Upon signing this Work Order, **CONNOLLY MARBLE & GRANITE LTD.** is to submit the following documentation to the attention of Melanie Worsdale at melanie@zancorhomes.com
4. If applicable:
 - i. WSIB clearance certificate
 - ii. Proof of insurance coverage
 - iii. Progress billing breakdown/Schedule of values
 - iv. HST number
 - v. A completed Registration of Constructors and Employers Engaged in Construction form
 - vi. Safety policy
 - vii. Name and contact information for the individual responsible for accounts receivable
 - viii. Statutory declaration

Trusting the above is in order.

Per: Anthony Pignetti _____
Title: Director

Acknowledgement and Acceptance:

_____ acknowledges receipt of the subject work order and any related enclosures or documents incorporated by reference.

_____ accepts the subject work order and all related enclosures and documents incorporated by reference and agrees to enter the Contract with the Owner prior to the commencement of the Work.

Print Name _____ Title _____

Signature _____ Date _____



Suite # 612

WORK ORDER

AUG 04 2022
Date: _____

Re: Zancor Oakville Ltd.
221 North Rivermede Road
Concord, Ontario L4K 3N7
Cost Code: _____

1. Zancor Oakville Ltd. (the "Owner"), issues this Work Order to enter into a contract (the "Contract") with **MALFAR** for Supply and Installation of the following purchase upgrades (the "Works") for the Project located at 2450 Old Bronte Road, Oakville, Ontario for the contract price of **see attached** (the "Contract Price"). The Owner and **MALFAR** are collectively referred to as the "Parties" and individually as a "Party".
2. If **MALFAR** agrees with the terms set forth above and wishes to proceed with executing the Contract, it should sign this Work Order in the space provided below for "Acknowledgement and Acceptance" and return an executed copy to the attention of Melanie Worsdale at melanie@zancorhomes.com.
3. Upon signing this Work Order, **MALFAR** is to submit the following documentation to the attention of Melanie Worsdale at melanie@zancorhomes.com
4. If applicable:
 - i. WSIB clearance certificate
 - ii. Proof of insurance coverage
 - iii. Progress billing breakdown/Schedule of values
 - iv. HST number
 - v. A completed Registration of Constructors and Employers Engaged in Construction form
 - vi. Safety policy
 - vii. Name and contact information for the individual responsible for accounts receivable
 - viii. Statutory declaration

Trusting the above is in order.

Per: Anthony Pignetti _____
Title: Director

Acknowledgement and Acceptance:

_____ acknowledges receipt of the subject work order and any related enclosures or documents incorporated by reference.

_____ accepts the subject work order and all related enclosures and documents incorporated by reference and agrees to enter the Contract with the Owner prior to the commencement of the Work.

Print Name _____ Title _____

Signature _____ Date _____